

Crystal LED Lamp

User Guide

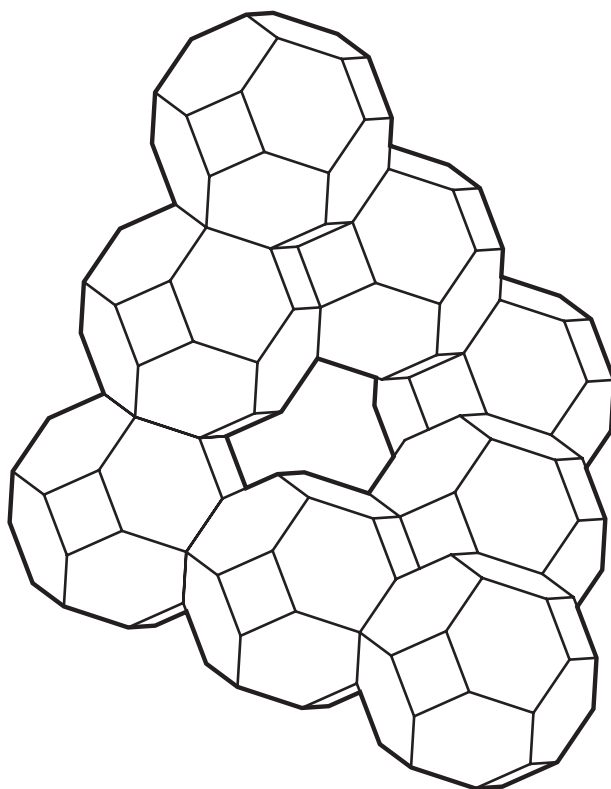

English

QISDESIGN

Introduction

Thank you for purchasing the Coral LED (Light-Emitting Diode) Table Lamp. To ensure your safety against any potential hazards and to optimize your lighting experience, please read this guide carefully prior to use, and keep it in a safe place for future reference.

Features

The features of this lamp include:

- Modular units that can be assembled: units of Crystal LED Lamp can be assembled to create various combinations either while on or off.
- Two pre-programmed lighting modes: Gradient (default), Full Spectrum.
- Semiconductive solid light source: no heat radiation and no fragile components inside (shatter-free)
- No ultraviolet (UV) emissions. No need to worry about the risk of developing skin cancer
- Energy-conserving switching-type power supply
- CE certified

Package Contents

Check the packaging for the following items. If any is missing or damaged, please contact the place of purchase immediately.

(A)

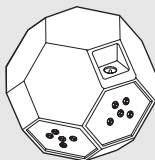

Crystal LED Table Lamp
Master Unit
(with DC power socket) x 1

(B)

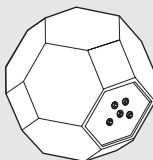

Check the number of Slave Units (without DC power socket) included, according to the purchased model:

- NV01_6: 5
- NV01_8: 7
- NV01_12: 11

(C)

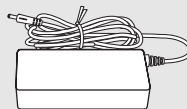

Power Adapter x 1

(D)



Power Cord x 1

(E)

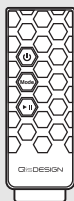

Remote Control
x 1, including 1
mercury battery
(CR2025 3V)

(F)

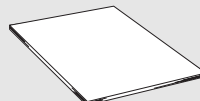

User Guide x 1

For Your Safety

This lamp has been tested and certified under strict regulations and standards for illuminating devices. To ensure your safety, please pay attention to the warnings and cautions below, and follow the instructions in this guide when using the lamp.

- To prevent electric shock, do not disassemble the lamp for any reasons.
- Do not attempt to modify the lamp. Doing so may cause the lamp to malfunction or result in irrecoverable damage.
- Use only the supplied power adapter and connect only to a suitable outlet power (Model: FSP024-DMCE1). Otherwise the lamp will fail to work normally or result in fire.
- Do not pull the power cord out of the power outlet by grasping the cable itself, as you may damage the cable and the power outlet. Only ever remove the power cord by grasping the plug on the end of the cable.
- Do not place any foreign objects inside any parts of the lamp. Doing so may cause the lamp to malfunction.
- To avoid potential injuries, do not touch contact pins with wet objects or fingers.
- Place the lamp only on a flat and stable surface. Otherwise the lamp may topple over and cause damage to it.



In case of the following situations, unplug the lamp from the power outlet immediately and contact the authorized service center or a qualified service person for inspection or repair:

- When the outer casing of the lamp is broken
- When there are strange odors coming from the lamp
- When the lamp flickers
- When the insulation of the lamp's wiring is damaged or frayed, and the metal strings inside can be seen.
- When unknown chemical liquids are spilled on the lamp



- Do not use the lamp in a humid environment (like in a bathroom or outdoors). Otherwise the components inside may short-circuit and result in accidents.
- The lamp contains magnets. To avoid any damage or malfunction, the lamp should be kept away from objects containing iron or magnetic materials (e.g. paperclips or magnets).
- To prevent electric shock and product damage, never put wet objects on the connectors (contact pins) on the unit.
- This lamp is designed for indoor use only. Do not use it outdoors.
- This lamp is not a toy. Keep it away from children.
- Never disassemble the lamp or remove any components from it, as doing so may result in accidents and will void the product warranty.

Installation: Please follow the procedures below

1. Connecting the power cord to the master unit

- ① Take the master unit and locate the power socket. Then, connect the DC output on the power adapter to the power socket.
- ② Connect the power cord to the AC input on the power adapter.
- ③ Plug the power cord into the wall outlet. When the lamp is successfully connected, the master unit will start to flash to indicate: the lamp is on the standby status and can be operated by remote control.

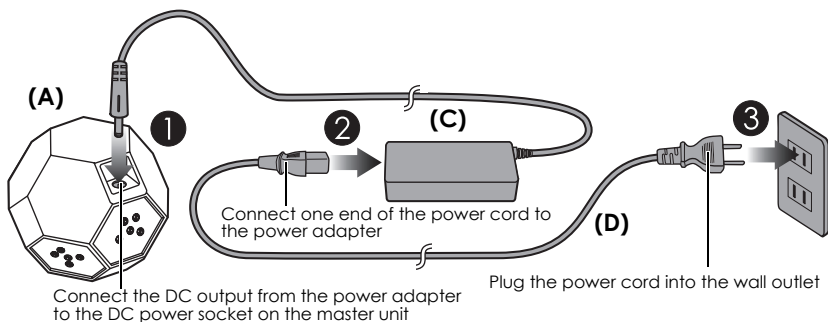

Make sure "the master unit of Crystal LED lamp flashes" as a confirmation for being connected. Afterwards, you can start to operate the Crystal LED Lamp with the remote control.

2. Assembling the Crystal LED Lamp units

Each unit of Crystal LED Lamp can be connected to other units. Therefore, you can follow these instructions to assemble units and create various combined integral:

- a. Align the contact faces on the two units (as illustrated contact pins), in order to assemble the two units. Pay attention to the polarity of magnets: Opposite polarities on the units will attract and like polarities will repel.

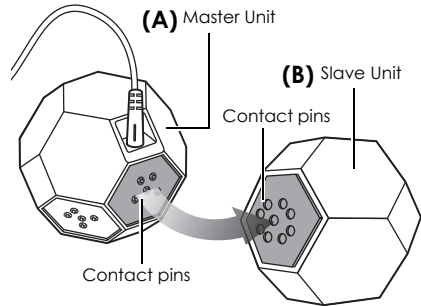

- b. Apply this method to assemble other slave units. You can refer to the "Assembly Examples" for ideas on how to create your own Crystal LED Lamp integral.



- The Crystal LED Lamp can be assembled in any combination either while on or off.
- To avoid toppling over or being damaged, you should assemble the Crystal LED Lamp units on a flat and stable surface. Make sure that the Crystal LED Lamp assembly is also stable.
- **You may combine up to 16 units with more than one master unit. But only one power cord can be connected. Do not connect more than one power cord to a set of interconnecting Crystal LED Lamps; otherwise the Crystal LED Lamp will malfunction.**

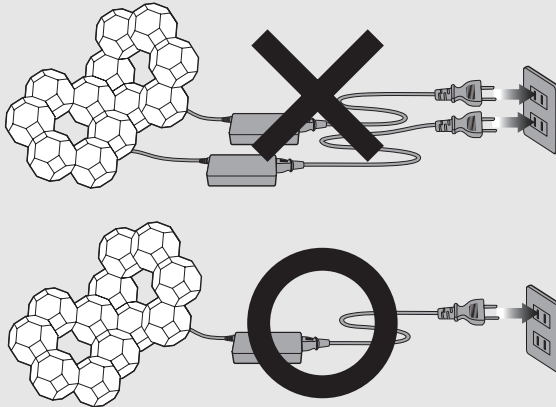

3. Get ready to use the Remote Control

Prior to first use of the remote control, pull out the insulating piece on the remote control (refer to the illustration).

Effective distance of the remote control is 6 meters. Use the remote control to operate the Crystal LED Lamp within this distance.

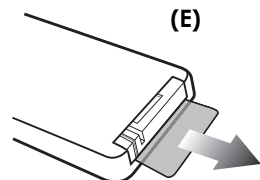

Operate the Crystal LED Lamp with remote control

Turning on the Crystal LED Lamp

When the Crystal LED Lamp is on standby, push the Power

 button on the remote control to turn on the Crystal LED Lamp.

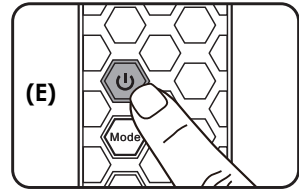

Turning off the Crystal LED Lamp

When the Crystal LED Lamp is turned on, push the Power

 button on the remote control again to turn off the Crystal LED Lamp (dimmed).

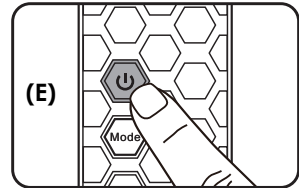

Switch the Lighting Mode

Gradient (default)

When the Crystal LED Lamp is turned on, it will be activated to the gradient mode.

Full Spectrum

When the Lamp is on the gradient mode, push the Mode

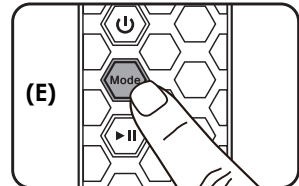

 button on the remote control, Crystal will turn into to the full spectrum mode.

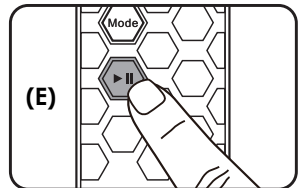

Keep the lighting effect

When the Crystal LED Lamp is on, push the Pause  button on the remote control, the lamp will keep showing the same color effect.



- Use the remote control to control the lighting modes. Attention: "pushing on the contact points on the Crystal LED Lamp master and slave units" cannot and will not control the lighting mode.
- You can disassemble or reassemble units while the Crystal LED lamp is turned on (without the need to turn the lamp off.)
- If the assembled unit does not light up, push the Power  button on the remote control to turn off the Crystal LED Lamp. Then push the Power  button again to restart the Crystal LED Lamp.

Maintenance and Troubleshooting

Cleaning the Lamp

Turn off the lamp first, and unplug the lamp from the power outlet. Use a soft and dry cloth to wipe any smears or dusts off the lamp's outer casing. Do not use any chemical solvents like kerosene, naphtha and so on, as the lamp's casing may become damaged.

Cleaning the Wiring

- Use only a dry and soft cloth to wipe the lamp's wiring clean. Never use a wet cloth, as it may cause an electric shock.
- Do not rinse the lamp or any of its components directly with water.

Troubleshooting

If you encounter problems when using the lamp, check the following:

- Are there loose connections between the DC output of power cord and the power socket on the Crystal LED Lamp master unit?
- Do not simultaneously plug the power cords of two master units to the wall outlet. If the Crystal LED Lamp set includes two master units, make sure that "only one master unit is connected to the wall outlet by the power cord".
- If a single unit in the combination does not light up, make sure that the contact faces between each unit are tightly secured.
- If the remote control does not work, try using it at a closer distance to the Crystal LED Lamp master unit, and check the battery. Replace the battery when necessary.

If the problem persists, please contact your nearest authorized service center for help.

Replacing the battery on the remote control

If the remote control is not working or if the effective distance has become shorter, follow the instructions and illustrations below to replace the battery:

1. Remove the battery tray in the direction illustrated:

Locate the battery tray at the back of the remote control.

- ① Use your finger to push the latch and slide it out. ② Pull out the battery tray.

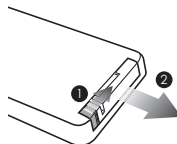

2. Replace the battery (type: CR2025 3V).

When inserting the new battery, take note of the polarity so that the "+" sign is facing up.

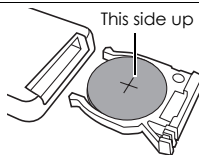

3. Reinsert the battery tray:

Note the direction of the battery tray.

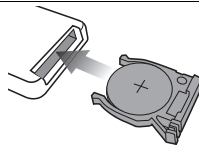

- To reduce adverse impact on the environment and prevent health hazards, please properly discard the battery according to your local recycling regulations.
- Do not place the battery near a fire, under direct sunlight, or in locations over 60°C.
- Do not submerge the battery in water or store in a humid location.
- Do not disassemble, hit, or make modifications to this battery or it may short circuit and pose a hazard.
- Do not attempt to recharge discarded batteries or expose them to fire.
- Remove the battery if the battery is depleted or if the remote control will not be used for a long period of time; otherwise chemicals inside the battery may leak and damage the remote control.

Specifications

- Model: NV01, NV01 _6, NV01 _8, or NV01 _12
- Unit Dimensions (Lx Wx H): 73mm x 73mm x 73mm
- Power input: AC Input 100-240V 50-60Hz 0.6A, DC Output 15V 1.6A
- Power Adapter: FSP024-DMCE1
- Max Power Consumption (16 units): 15W
- Operating Temperature: 0°C - 40°C

Assembly Examples

You may use different combinations of master and slave units to create your Crystal LED Lamp assembly. The following are possible combination examples and the number of units for your reference:

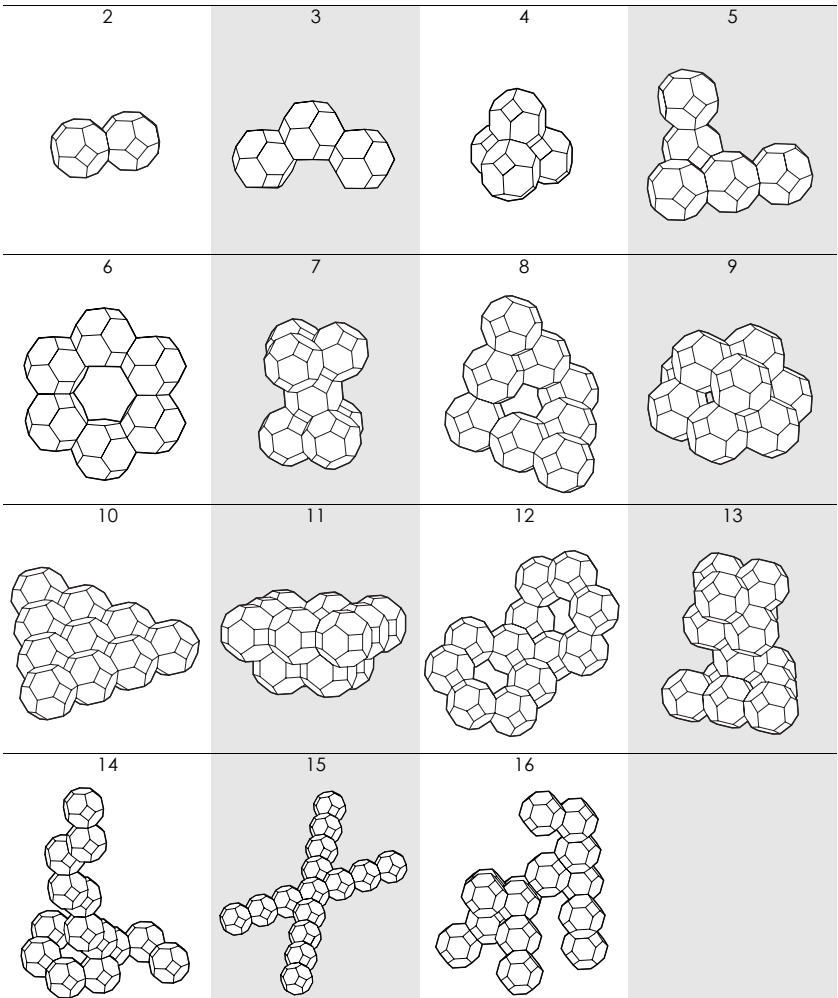

Regulatory Information

FCC Compliance Notice

This device complies with part 15 of FCC Rules. Operation is subject to the following two conditions: (1) this device may not cause harmful interference, and (2) this device must accept any interference received, including interference that may cause undesired operation.

This equipment has been tested and found to comply with the limits for a Class B digital device, pursuant to part 15 of the FCC Rules. These limits are designed to provide reasonable protection against harmful interference in a residential installation. This equipment generates, uses, and can radiate radio frequency energy, and if not installed and used in accordance with the instructions, may cause harmful interference to radio communications. However, there is no guarantee that interference will not occur in a particular installation. If this equipment does cause harmful interference to radio or television reception, which can be determined by turning the equipment off and on, the user is encouraged to try to correct the interference by one or more of the following measures:

- Reorient or relocate the receiving antenna.
- Increase the separation between the equipment and receiver.
- Connect the equipment into an outlet on a circuit different from that to which the receiver is connected.
- Consult the dealer or an experienced radio/TV technician for help.

Warning: You are cautioned that changes or modifications not expressly approved by the party responsible for compliance could void your authority to operate the equipment.