



**54001**

Ages: 8+

PCS: 425

**Model  
POWER**

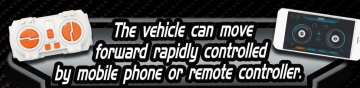

2.4G Remote control Technology building blocks Route planning



**REMOTED-CONTROL SUPERCAR**

Pictures are for your reference only. The delivered goods shall prevail.

**Product Summary | 产品概览:**

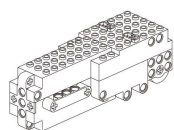

Smart Creative Module  
主控模块



Remote Control  
遥控器



USB-Micro Charging Cable  
USB-Micro 充电线



Building Blocks Instructions  
搭建手册



Building Block Parts  
积木零件包

**Smart creative module | 主控模块:**



Front View  
正面

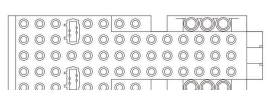

Vertical View  
顶面

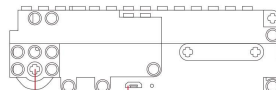

Side View  
侧面

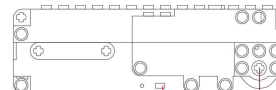

Power  
电源开关

Rotary360°A  
动力孔A

5V 2A  
Charging Port  
充电孔

Rotary360°B  
动力孔B

**Remote Control | 遥控器:**

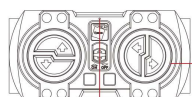

Indicator Light  
指示灯  
Front View  
正面

Direction Button  
操控盘

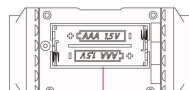

Battery Case  
电池盒

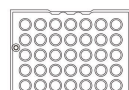

Rear view  
背面

Pictures are for your reference only.  
The delivered goods shall prevail.  
图片仅供参考, 请以实物为准。

## Method Of Operation | 产品概述:

### On/Off 开关机

Turn on the power switch and indicator lights when starting.  
打开电源开关键, 启动时指示灯亮。

#### NOTE:

Please turn off the power and use it outside .IT is forbidden to work for a long time .It will stop when working state is longer than 24 hours.Second, you need to charge the Smart creative module.

注意:主控模块使用后关闭电源, 请勿长时间待机, 在待机24小时之后启动电池保护, 停止主控模块工作, 重新启动需要对主控模块进行充电操作, 才能恢复正常工作。

### Remote Control Operation | 遥控手柄操作

Use a Phillips screwdriver to unscrew the screw on the battery cover at the back of the remote control counterclockwise, open the battery cover, load 2 1.5V "AAA" batteries with correct polarity, close the battery cover, and tighten the screws.

用十字螺丝刀按逆时针方向拧开遥控器后面的电池盖上的螺丝, 打开电池盖, 按正确的极性装入2节1.5V "AAA" 电池, 盖上电池盖, 拧紧螺丝。

After installation, the indicator light flashes and lights up when the link is successful.  
安装后指示灯闪烁, 链接成功后长亮。

Direction button control: Front /back /left /right  
遥控器按键控制前、后、左、右方向。

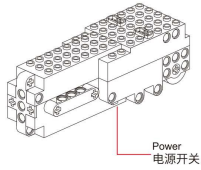

Power 电源开关

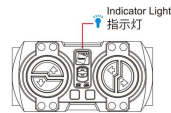
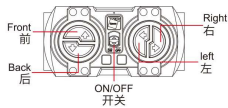
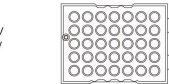
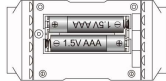

#### NOTE:

If the power is not turned on for a long time ,repeat the installation of the remote battery connection .  
注意:如长时间没使用产品, 建议重新安装遥控器电池。

### Charging Operation | 充电操作

Use usb charging ,connect the main Smart creative module and the computer usb port .  
When charging ,the light is on and the light is off.The charging time is 120 minutes.

圆孔接头连接主控模块充电口, USB连接电脑端口  
充电时主控模块指示灯亮, 充电完成后指示灯熄, 充电时间大约为120分钟, 充电完成后请拔出接头。

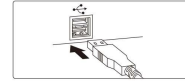

#### NOTE:

The charging input voltage should not exceed 5V and current should not exceed 2A.  
注意:USB充电接口输入电压不能超过5V, 电流不能超过2A。

### NOTE | 注意事项

Precautions Smart creative module is not removable and must not subject the product to mechanical shock;

Smart creative module contains batteries, away from heat sources and locations above 60 °C ;

Smart creative module cannot be charged for a long time to avoid danger;

The USB charging cable is an electronic component and cannot be used for play;

This product contains small parts and is prohibited for use by children under the age of three to avoid the risk of suffocation.

The charging cable should be checked periodically for damage to its wires, plugs, housing and other components. If any damage is found, it should be stopped using it until it's repaired.

主控模块不可拆卸, 不得使产品受到机械冲击;

主控模块包含电池, 远离热源、火源以及高于60°的场所;

主控模块不能长时间充电, 以免发生危险;

专用USB充电线为电子元件, 不可以拿来玩耍;

本产品含有细小零件, 禁止3岁以下儿童使用, 以免发生窒息危险;

充电线需定期检查其电线、插头、外壳和其他部件是否损坏,

发现损坏时应停止使用, 直至修复完好。

The remote control function keys vary with the product series.

遥控器功能按键随产品系列不同有所差异。

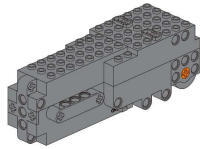

+

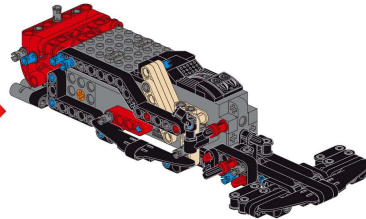

### 拆件器使用方法, 仅为示例

Usage of Brick Separator, Just for the sample

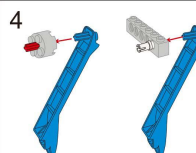
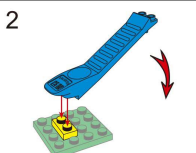
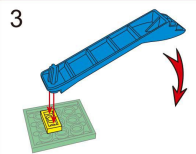
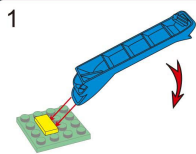

1



1x



2x



1x

2



1x



1x



1:1

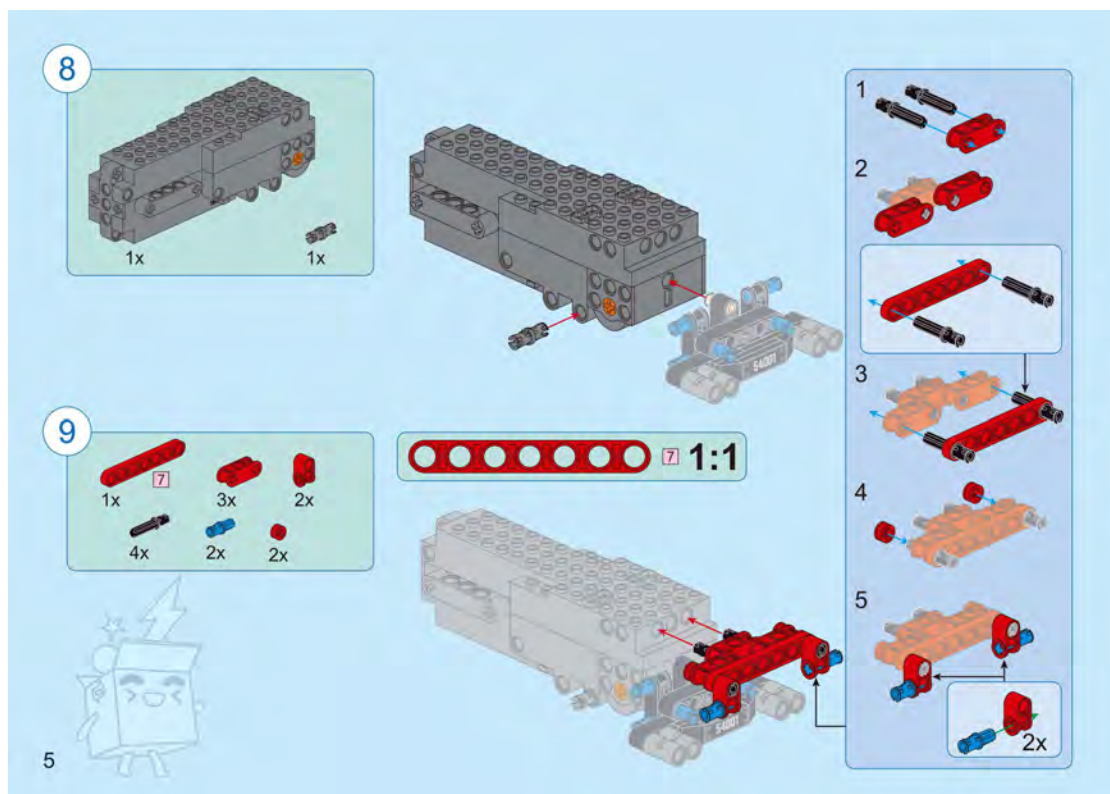
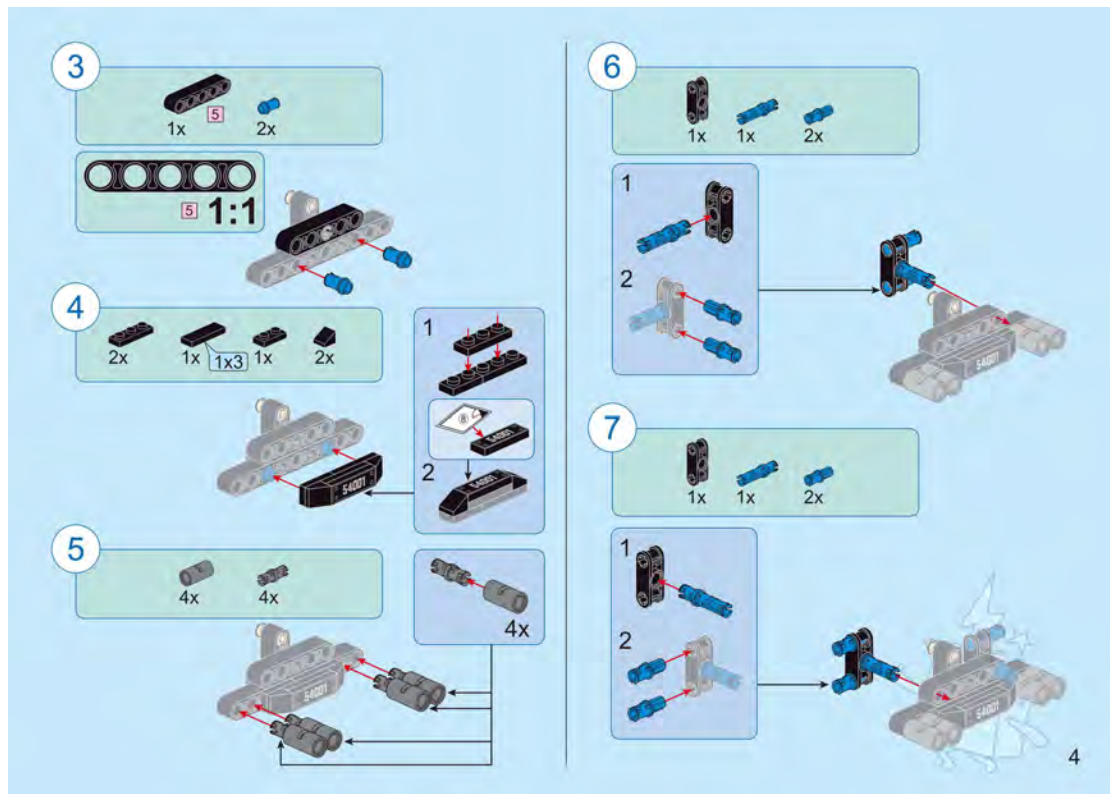





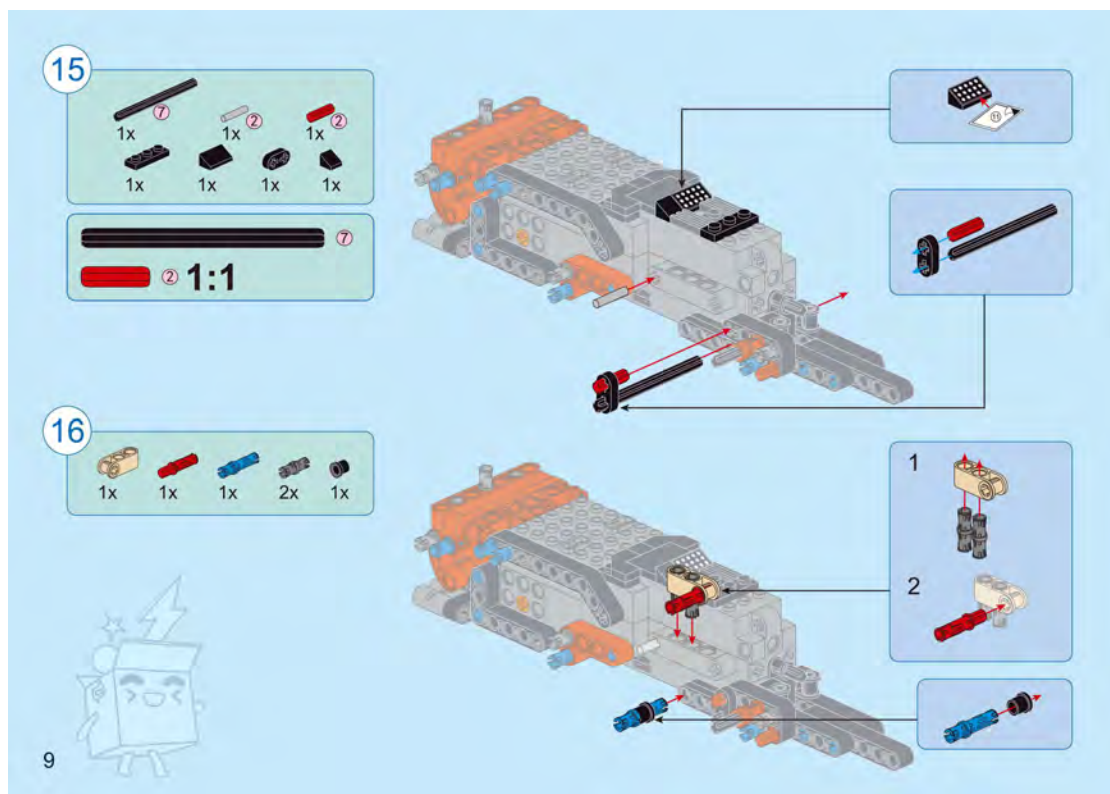
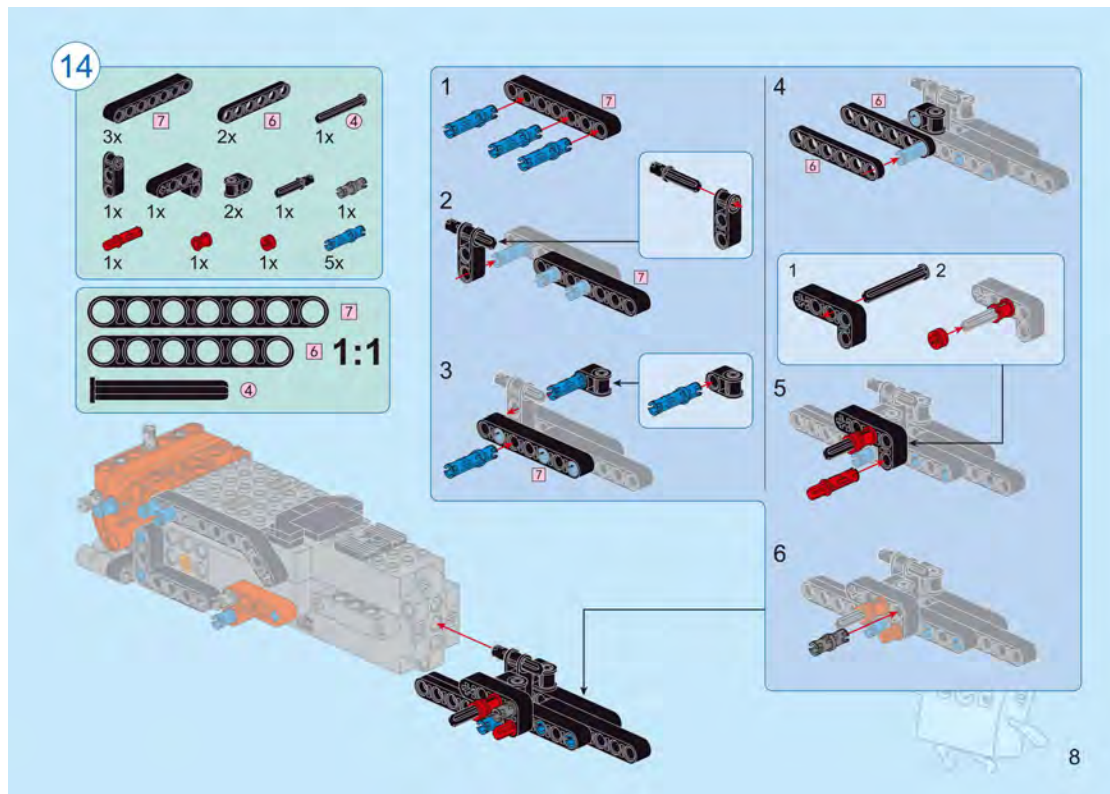





21

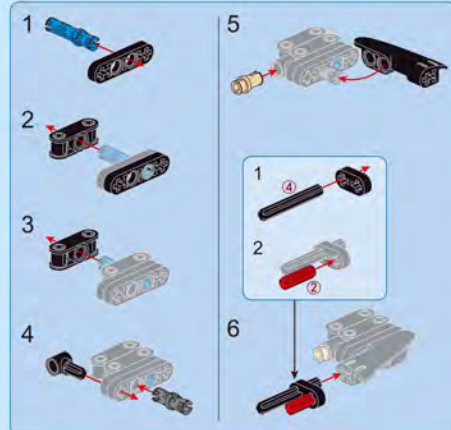
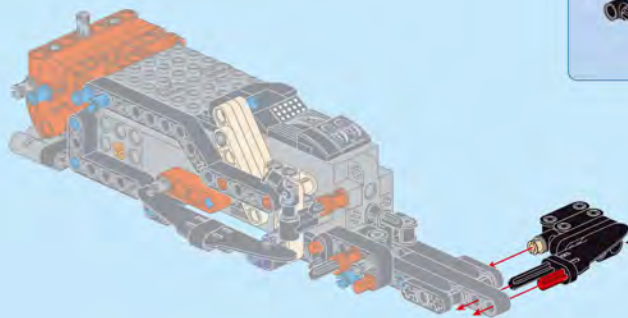
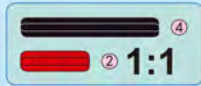

12

22

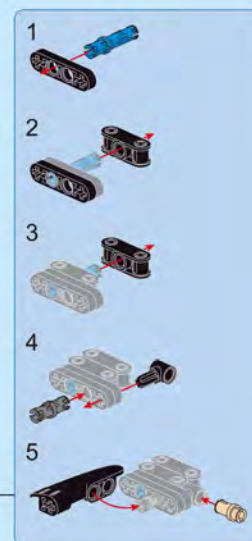
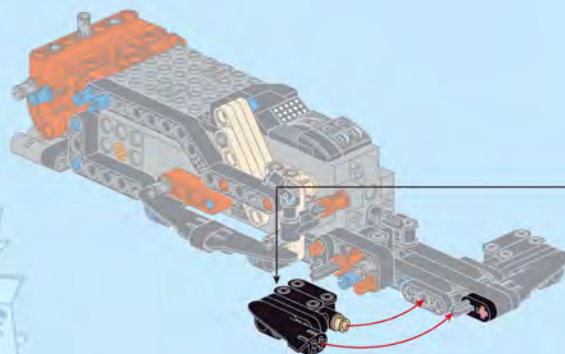

13



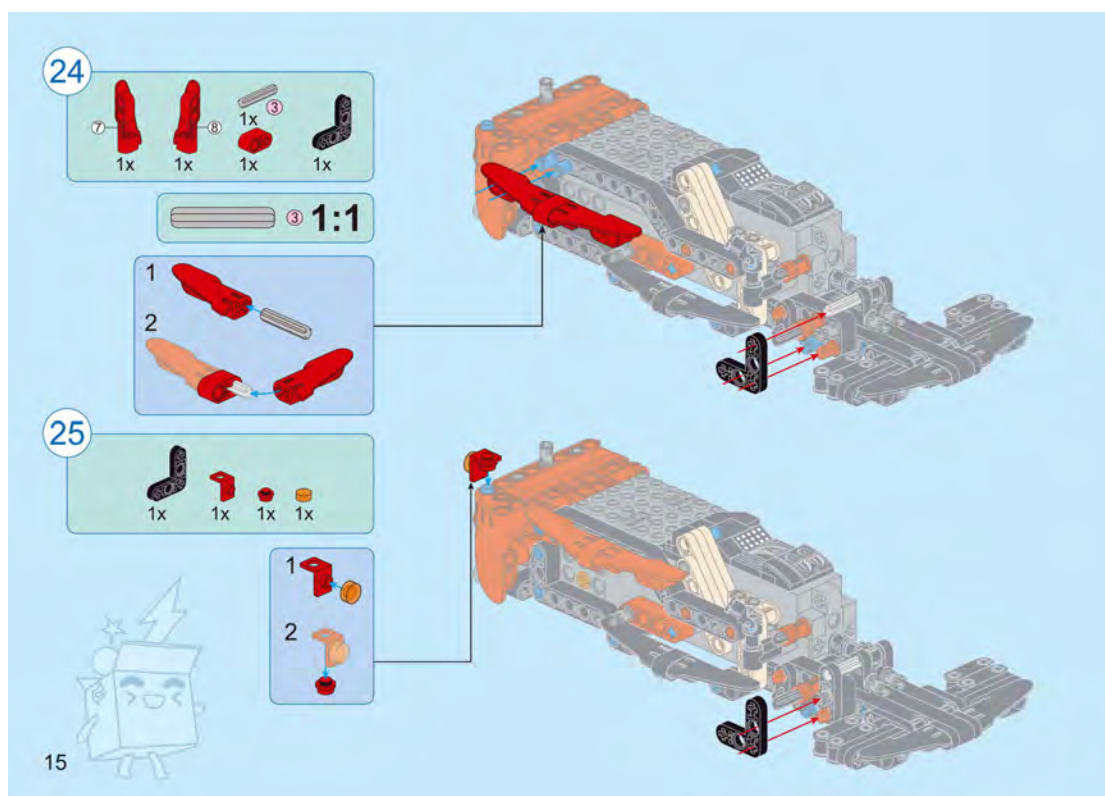
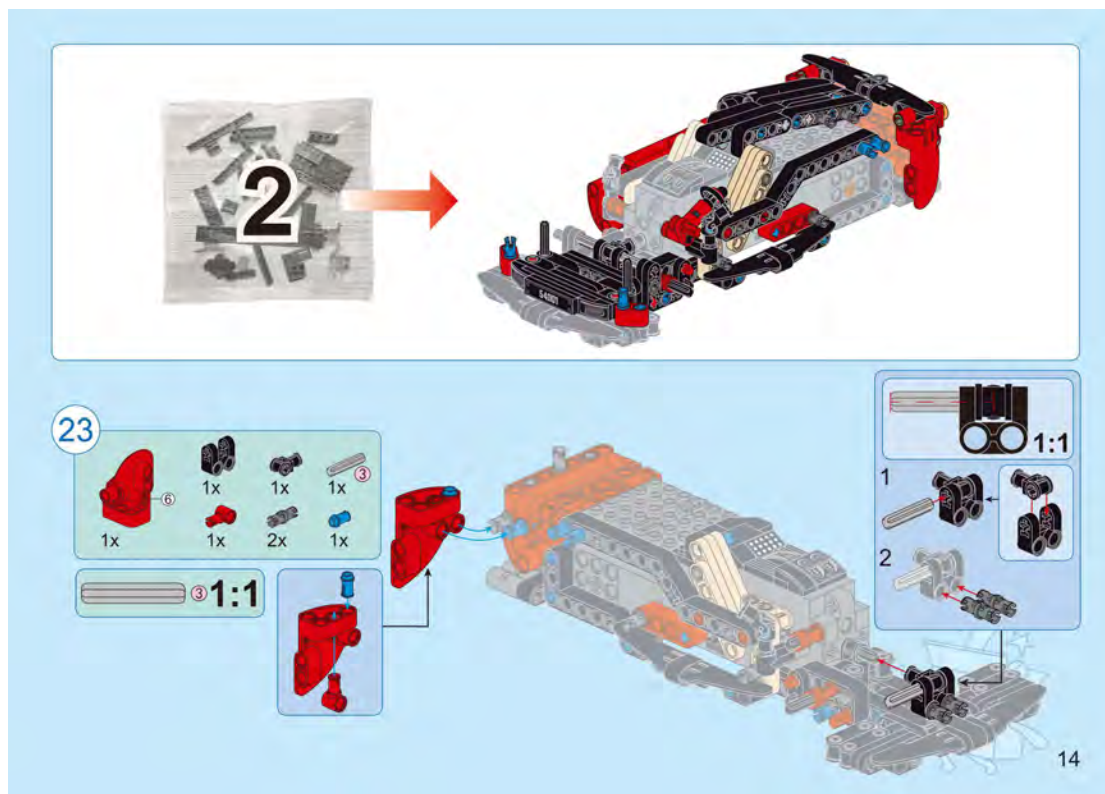



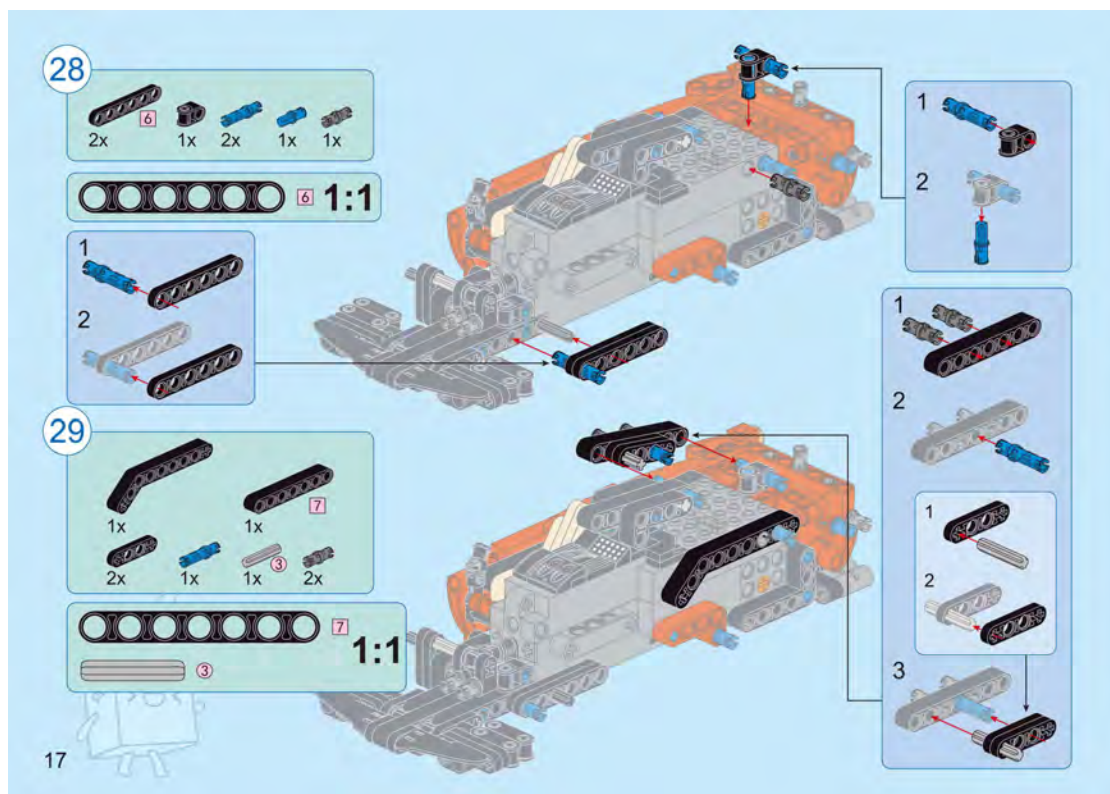
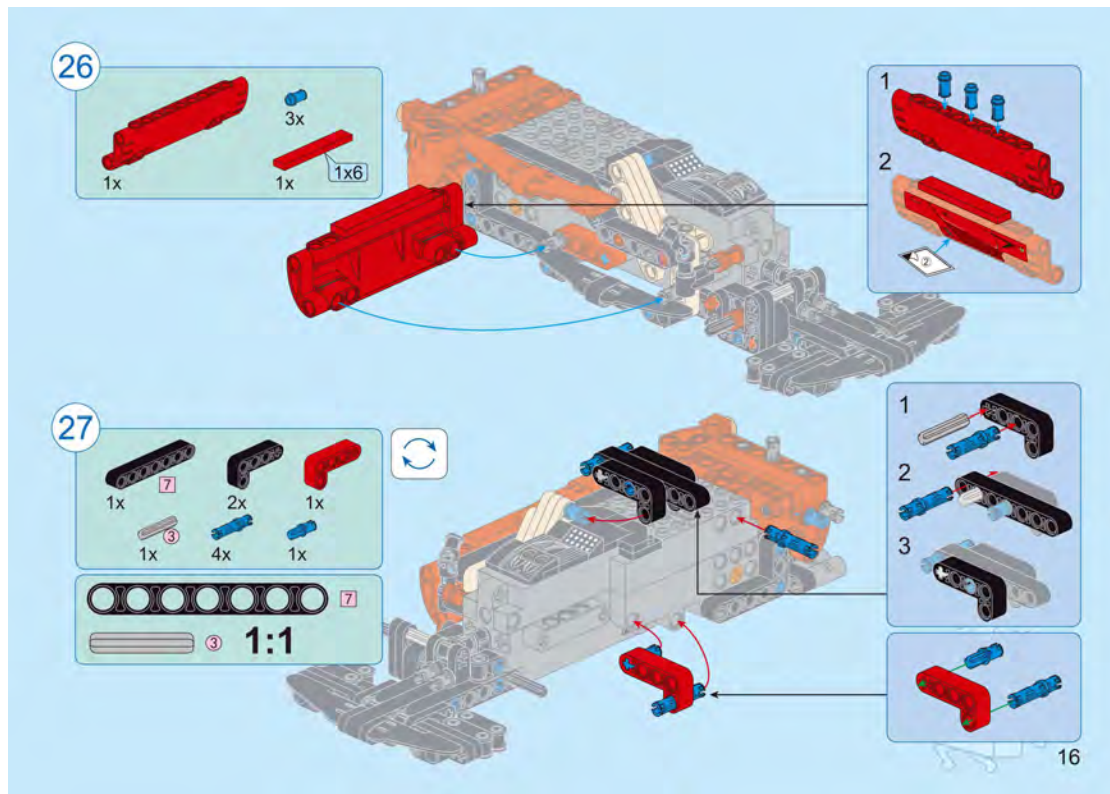

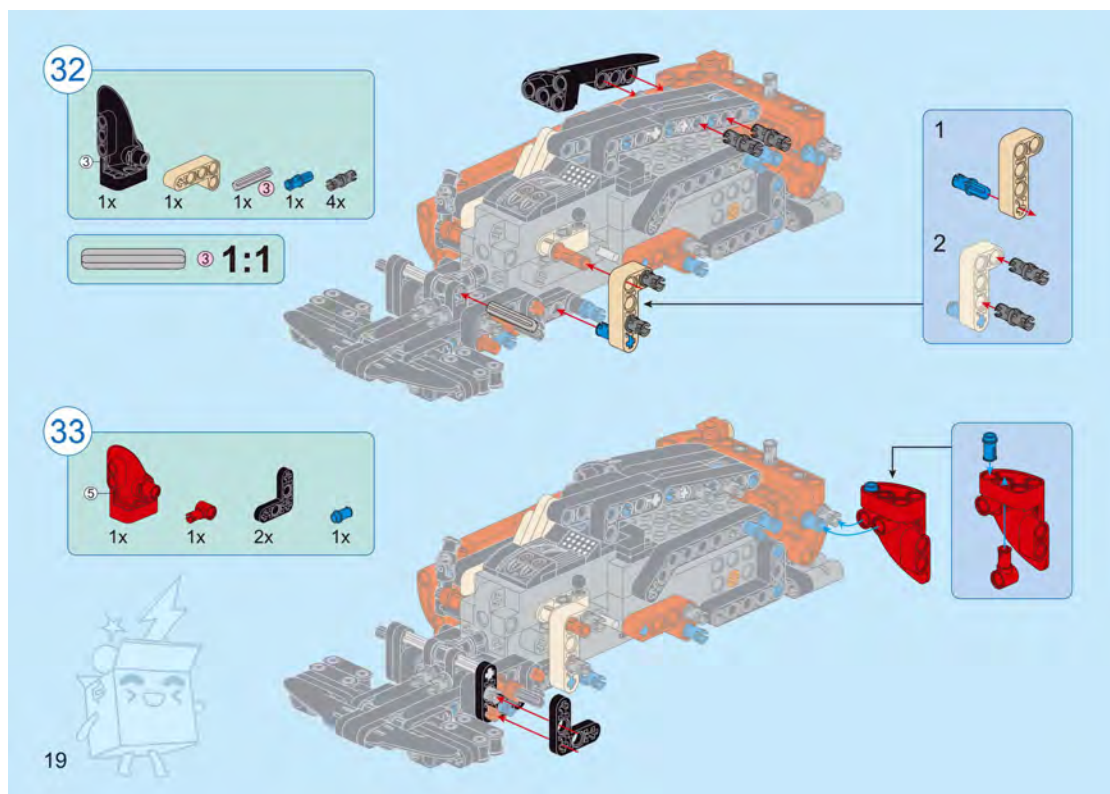
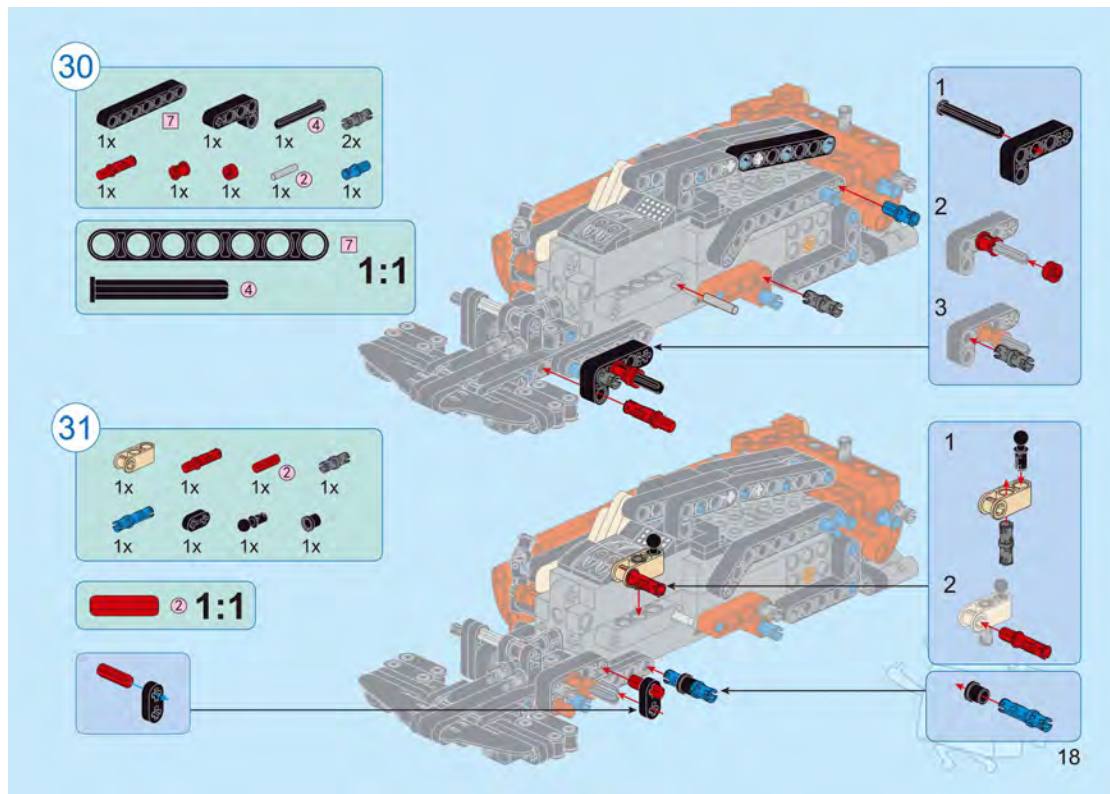



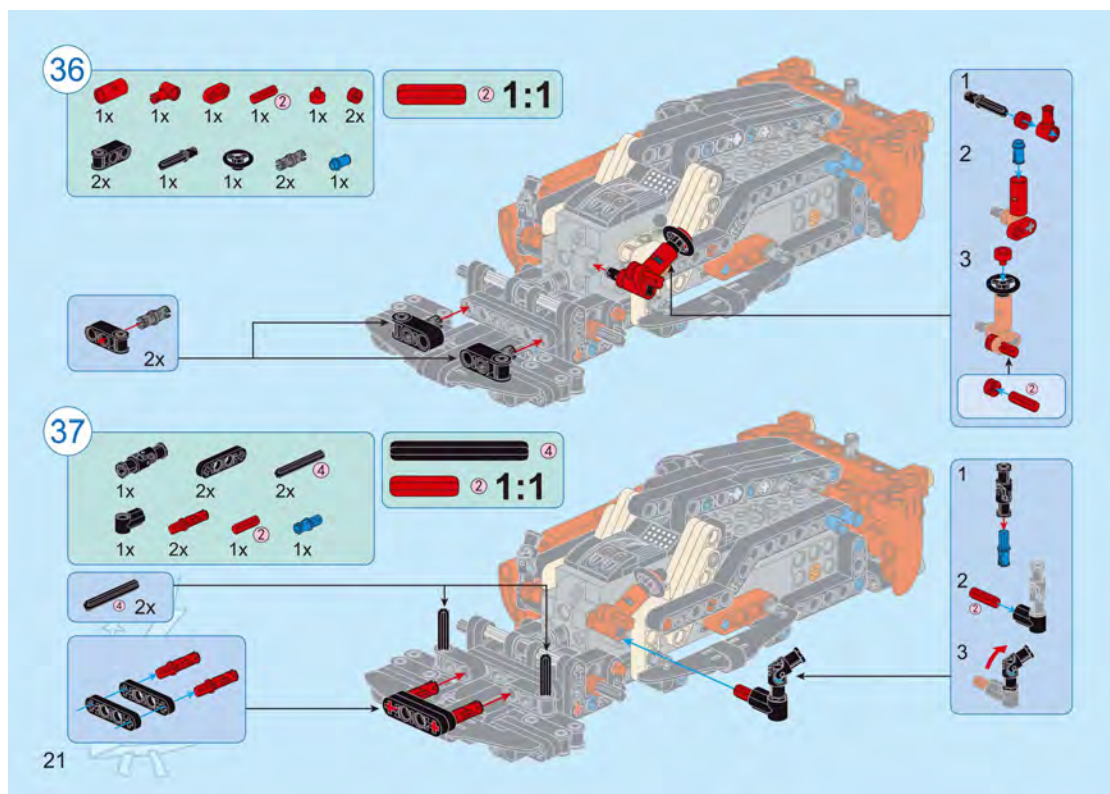
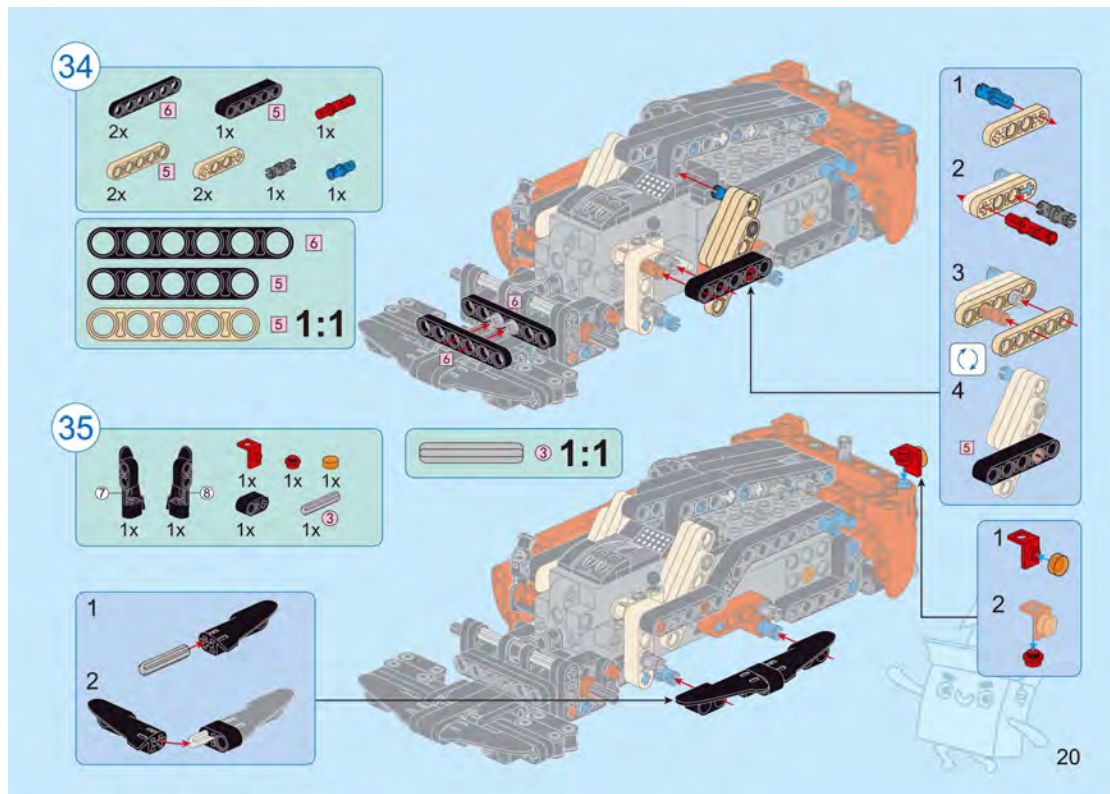



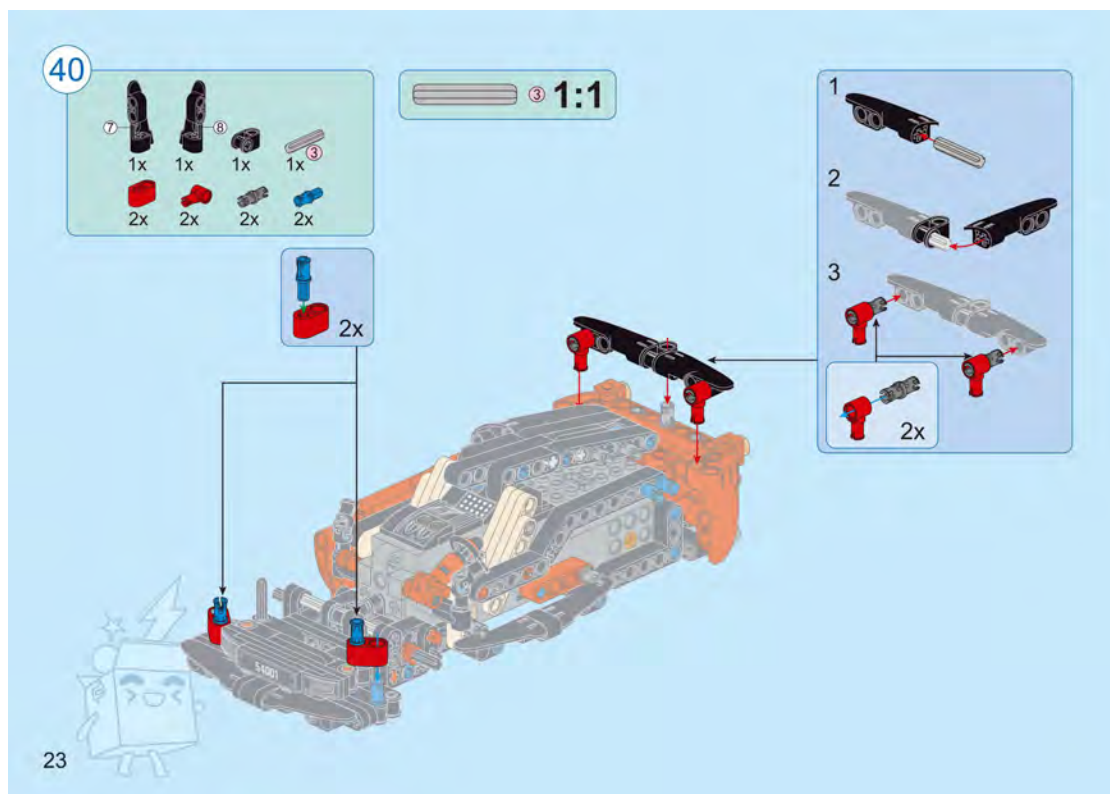
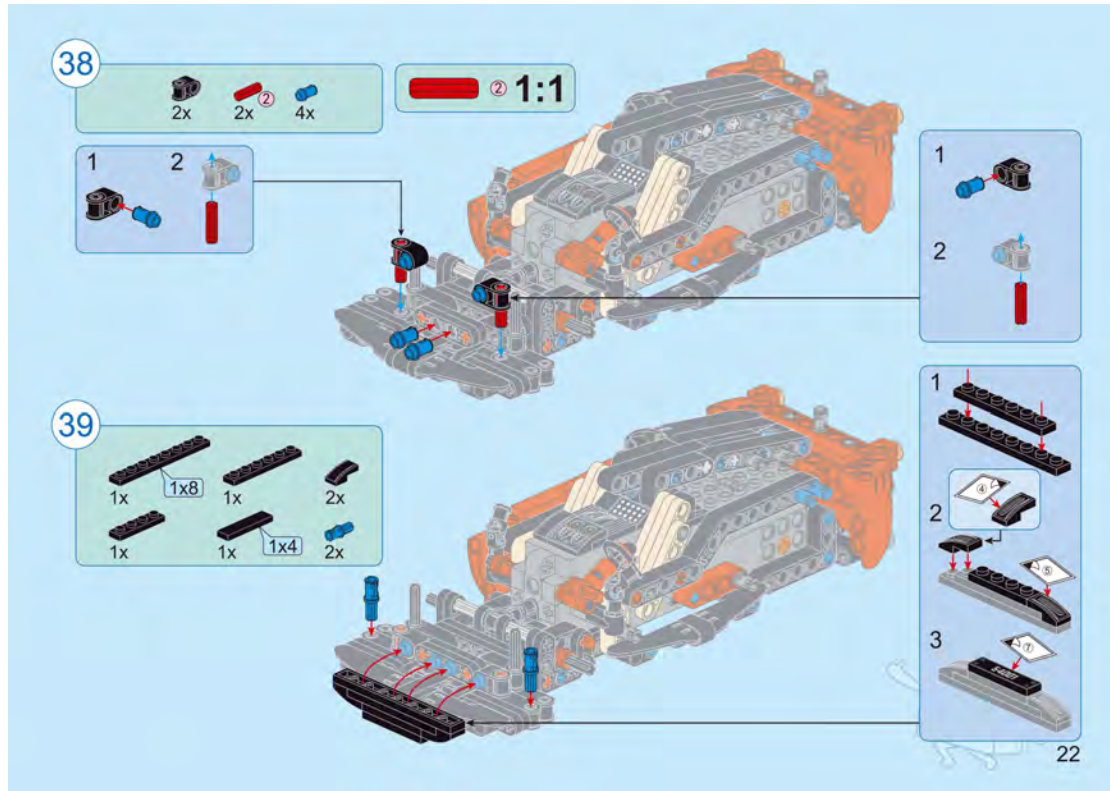

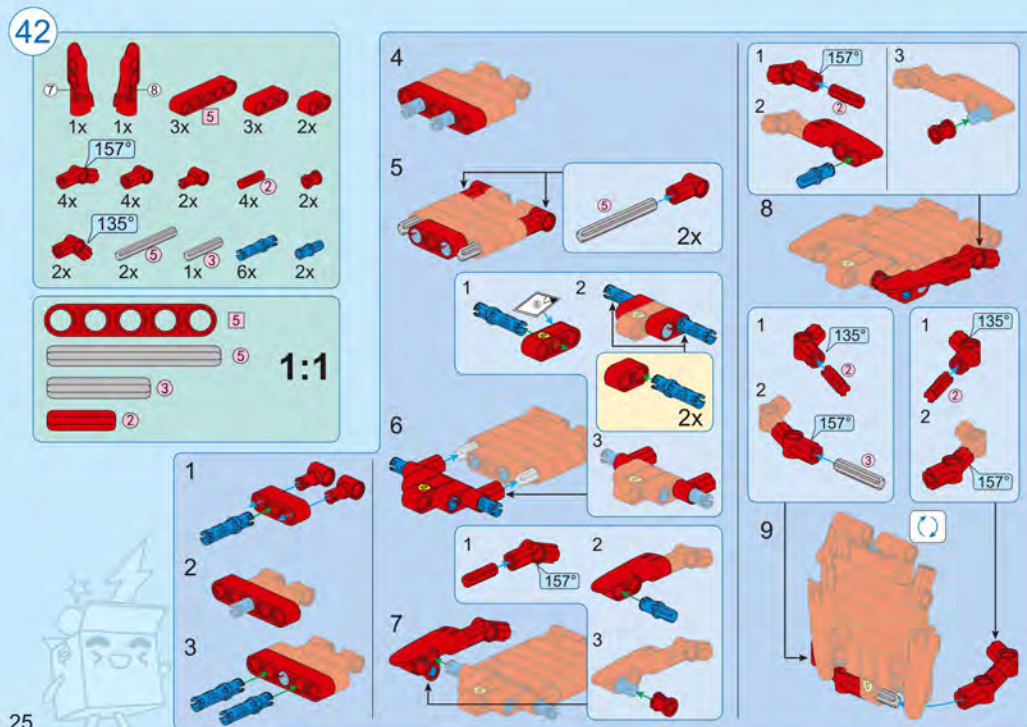
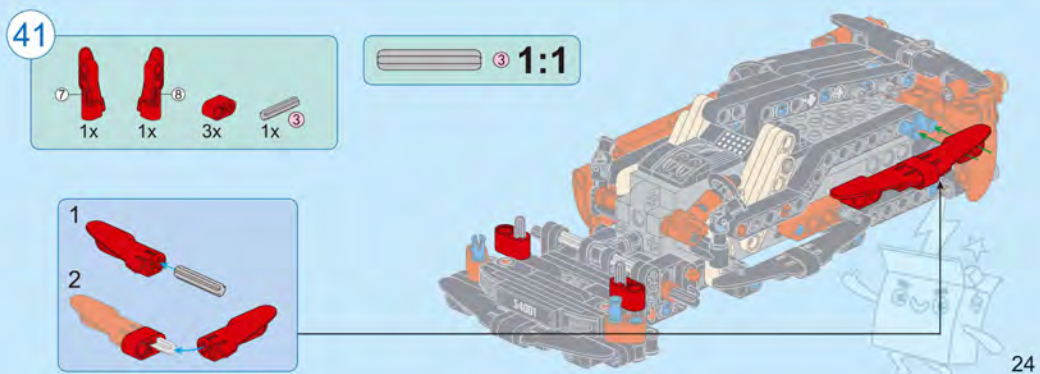



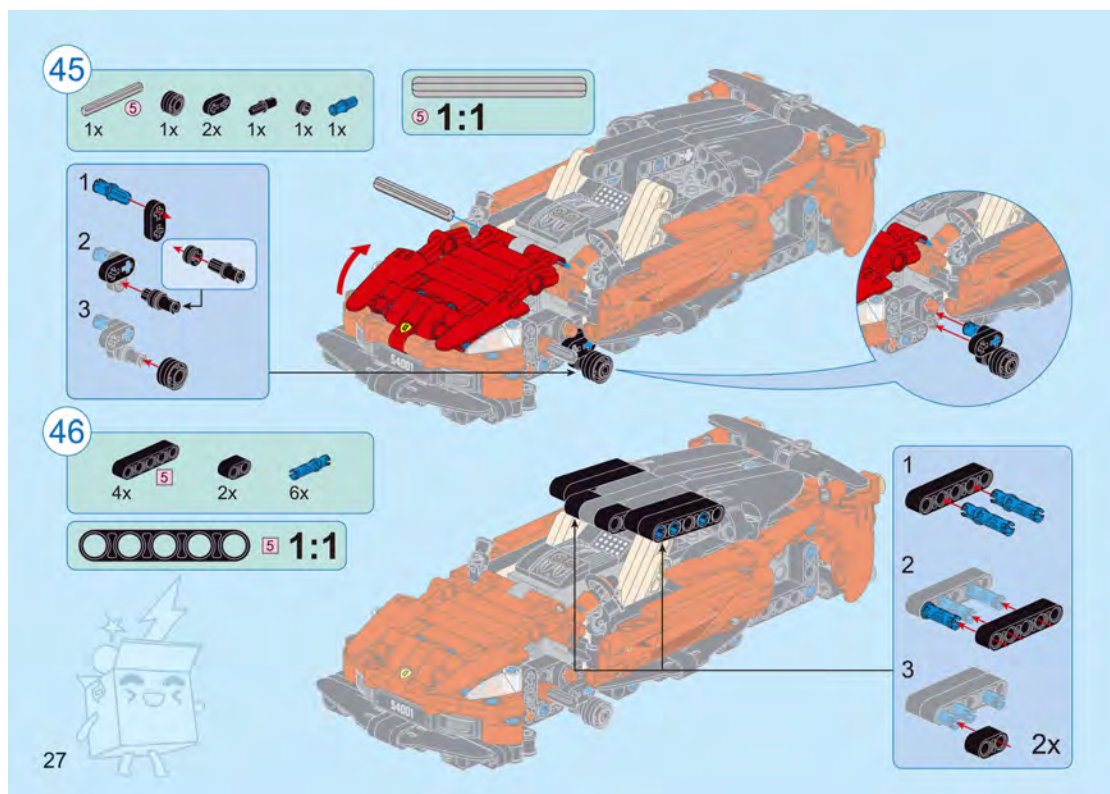
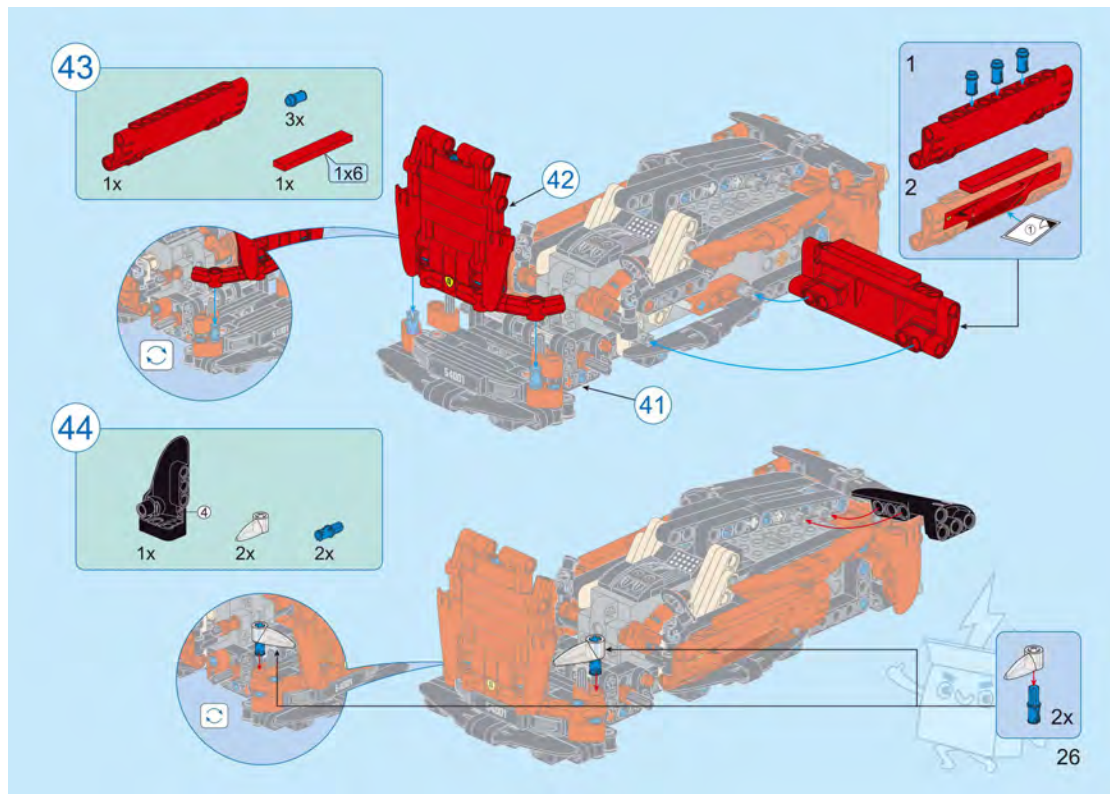



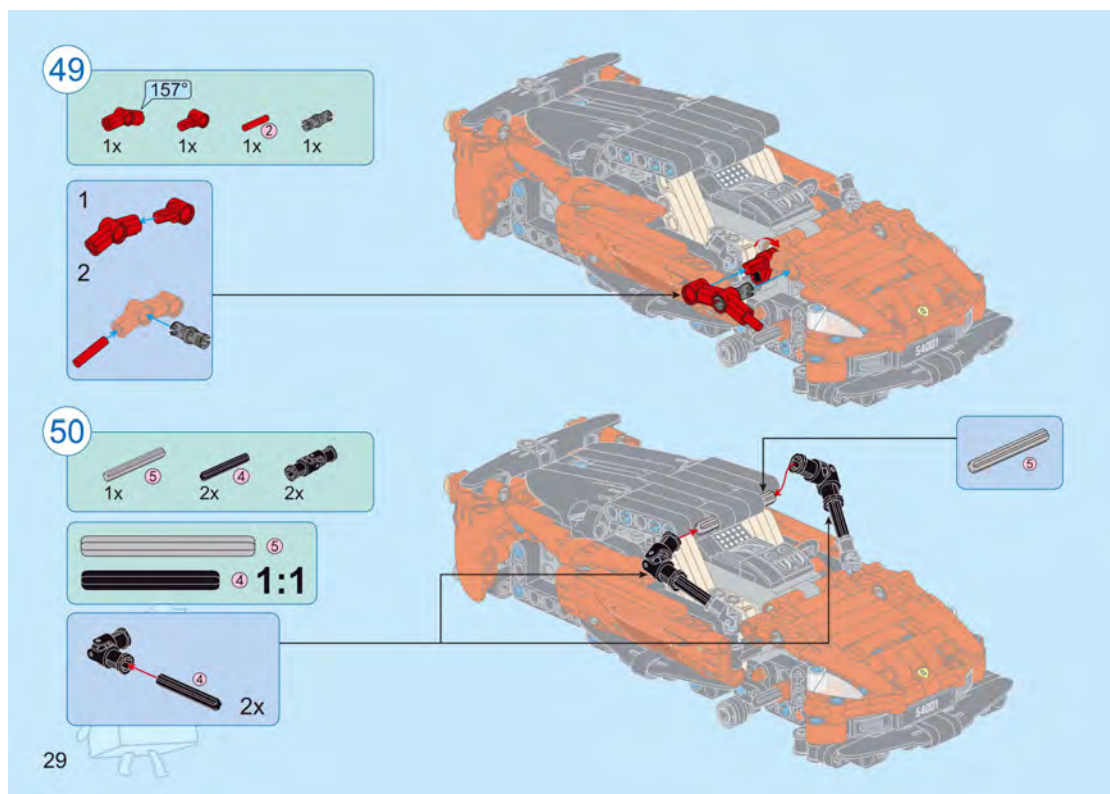
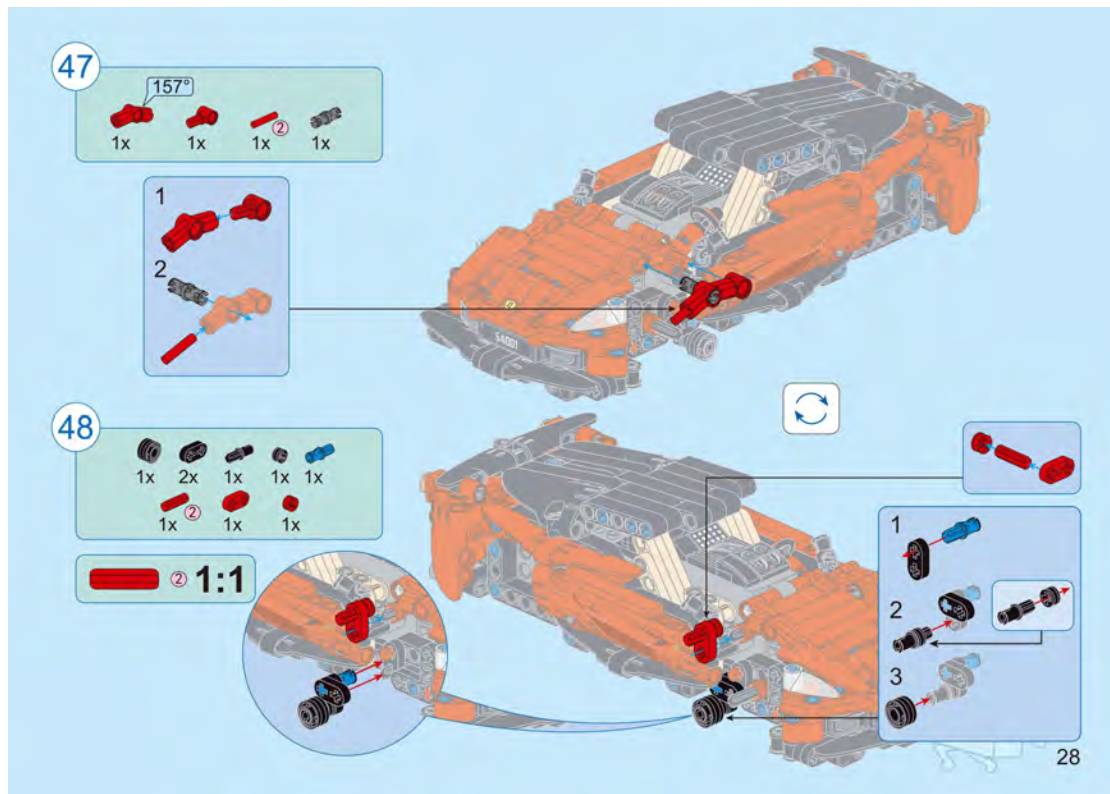

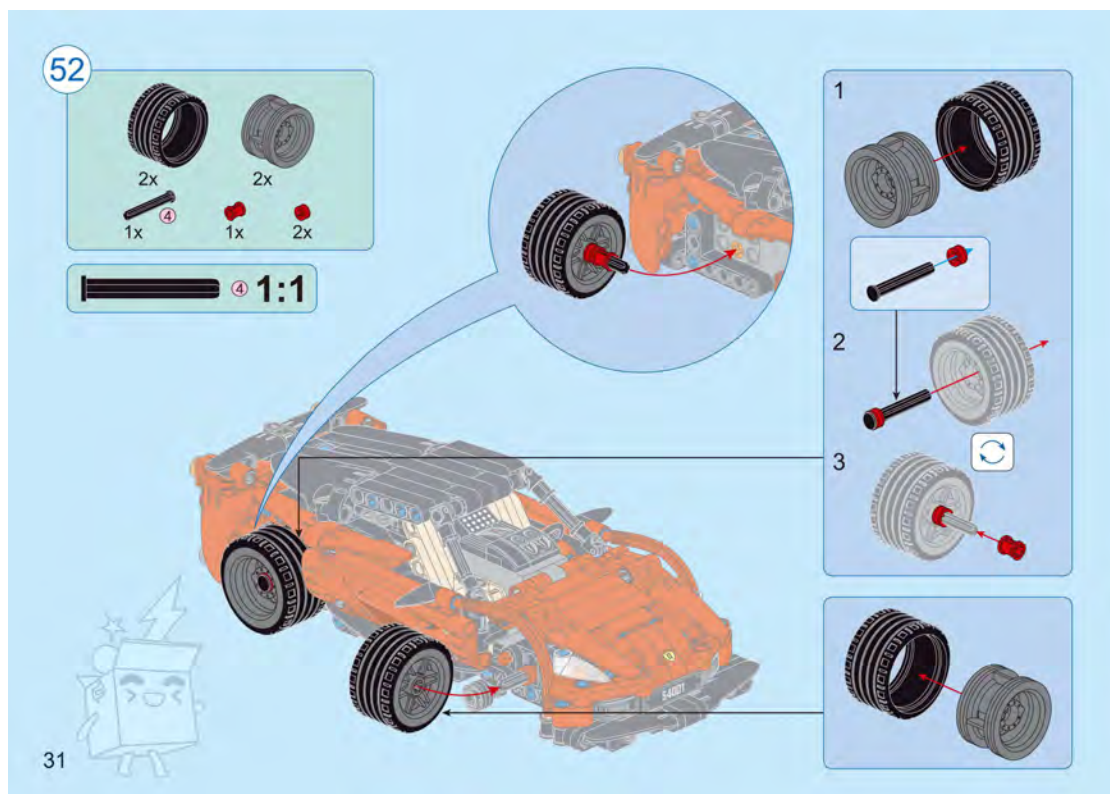
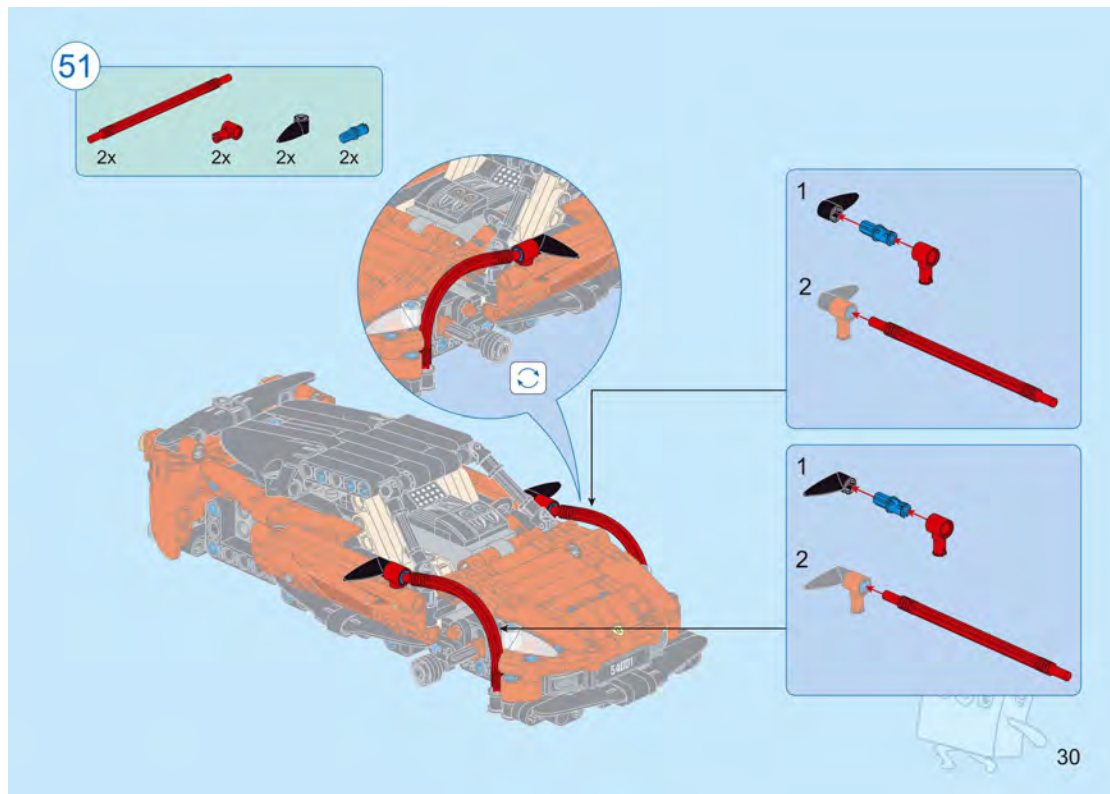



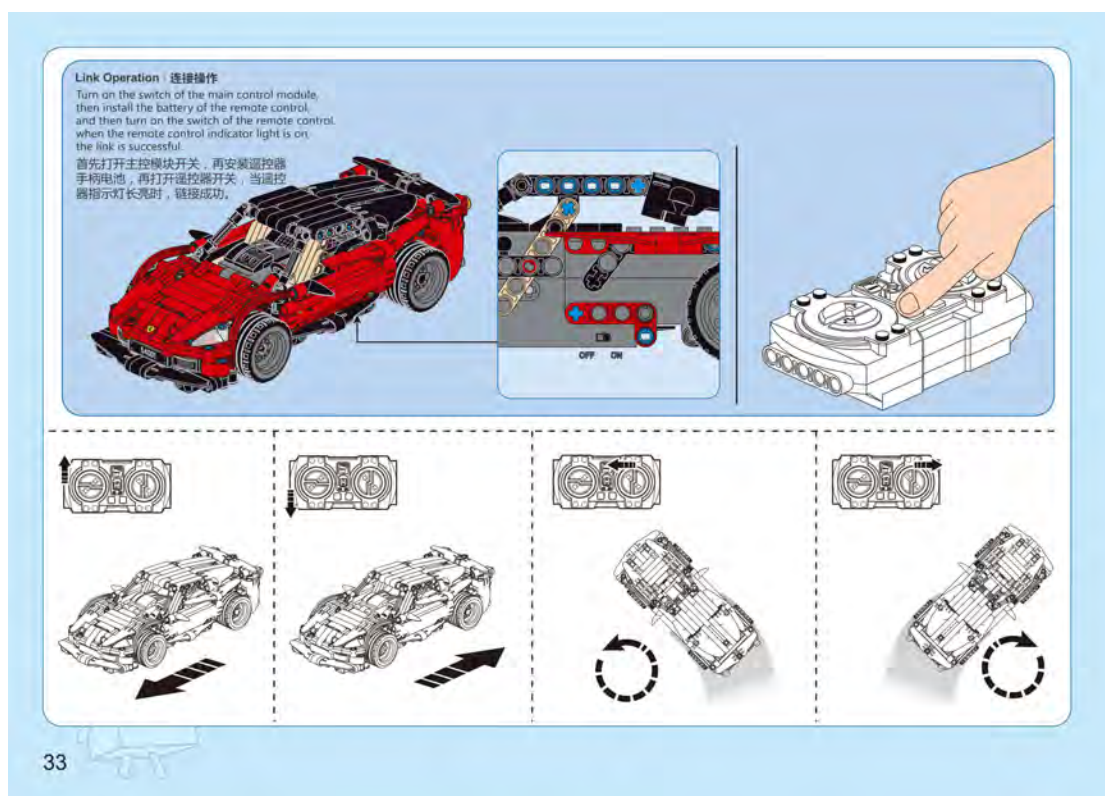
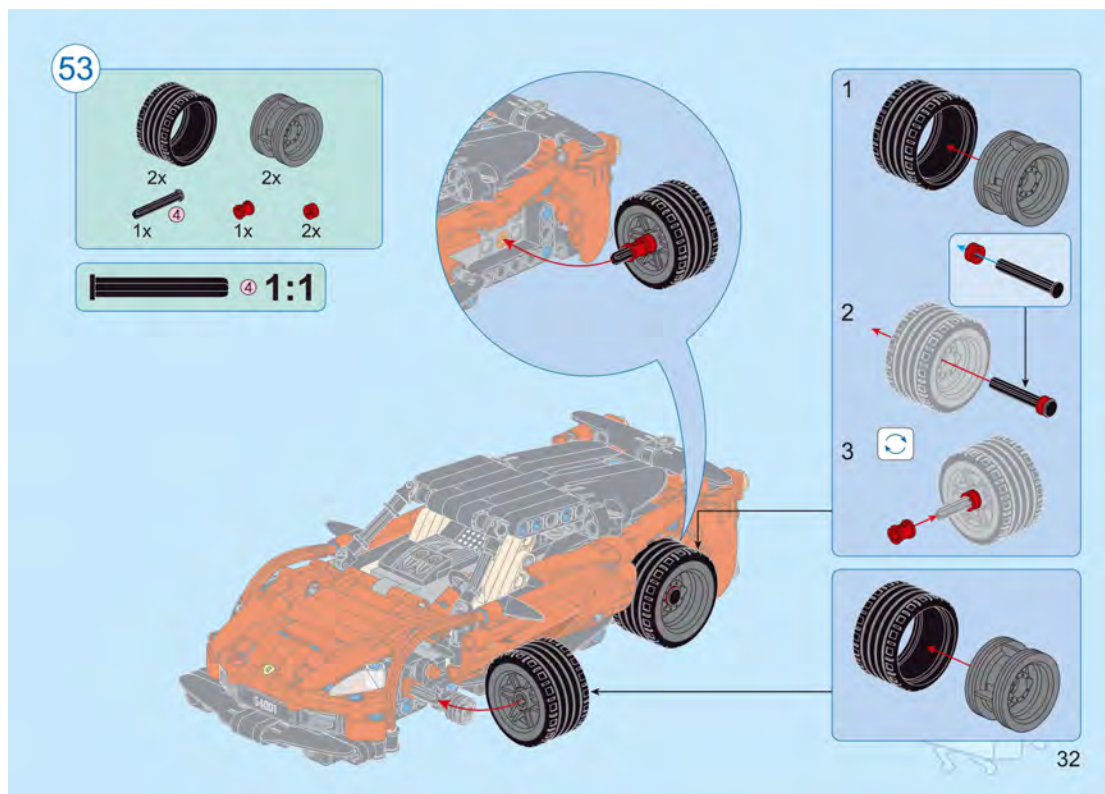



#### APP Installation | 安装APP:

This product needs to be used with your mobile phone or tablet  
本产品需要搭配您的手机或平板使用

Scan QR code, install "MODEL POWER!"  
扫一扫安装二维码,  
即可安装“启蒙模动力”!

APP Store

Android App Store  
安卓应用商店

Note: The instructions contain  
important information. Please  
keep it properly. It will take  
some time for installation.  
Please wait patiently.  
注意:此说明书含有重要信息,  
请妥善保管,遗失不补,安装  
需要一些时间,请耐心等待。

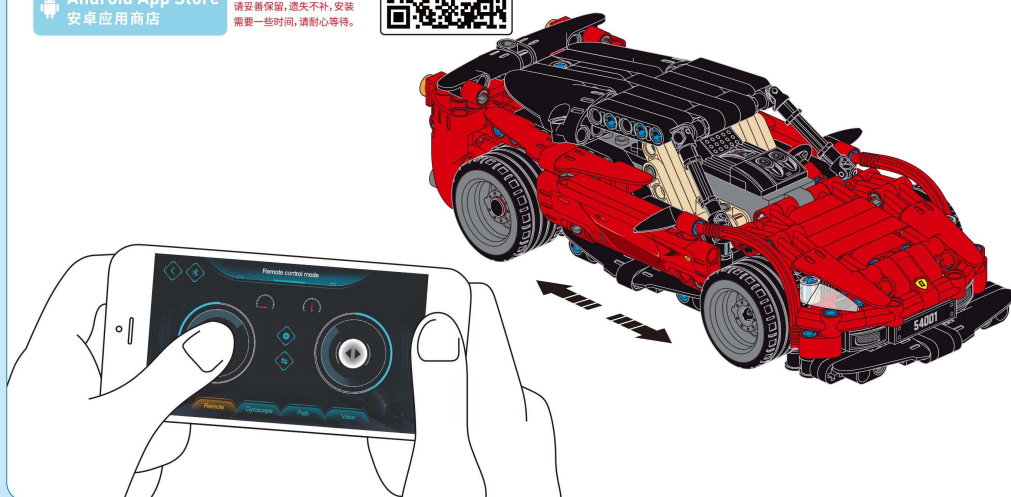

34

## MODEL POWER



54001-Remoted-control Supercar



54002-Aoying SUV remote control car

changes or modifications not expressly approved by the party responsible for compliance could void the user's authority to operate the equipment.

This equipment has been tested and found to comply with the limits for a Class B digital device, pursuant to Part 15 of the FCC Rules. These limits are designed to provide reasonable protection against harmful interference in a residential installation. This equipment generates, uses and can radiate radio frequency energy and, if not installed and used in accordance with the instructions, may cause harmful interference to radio communications. However, there is no guarantee that interference will not occur in a particular installation.

If this equipment does cause harmful interference to radio or television reception, which can be determined by turning the equipment off and on, the user is encouraged to try to correct the interference by one or more of the following measures:

- Reorient or relocate the receiving antenna.
- Increase the separation between the equipment and receiver.
- Connect the equipment into an outlet on a circuit different from that to which the receiver is connected.
- Consult the dealer or an experienced radio/TV technician for help.

This equipment complies with FCC radiation exposure limits set forth for an uncontrolled environment. This transmitter must not be co-located or operating in conjunction with any other antenna or transmitter.