



SECURITY & SMARTHOME

We hope you enjoy your new IQ Panel security and smarthome platform. It will serve as the “brain” of your home for many years to come. With it you can control your lights, locks, thermostat, security and much more.

You won't need a manual to operate your IQ Panel, but you can use this guide to learn more about the features of this amazing new device. We hope it will add to your home's decor and make your home smarter and more energy efficient!

Document: IQP2-07-16
Revised on: 9/19/16
Software Version: 2.0
Qolsys Part #: TBD

-The Qolsys team

Let's start by connecting your power. (note: if your panel has been professionally installed, skip this page)

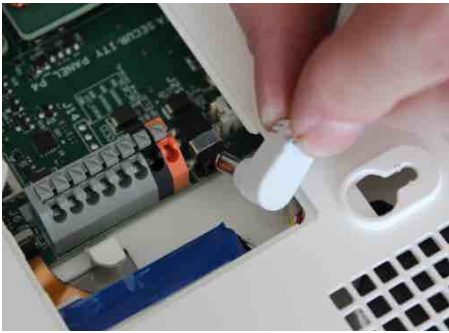

Plug in the power connector

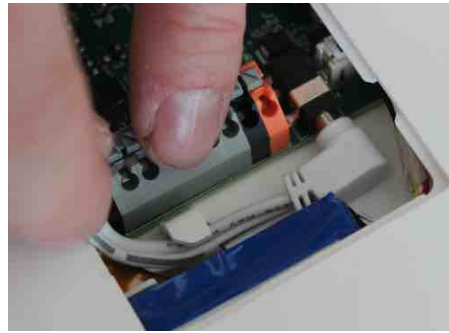

Route the wire behind the retainer clip

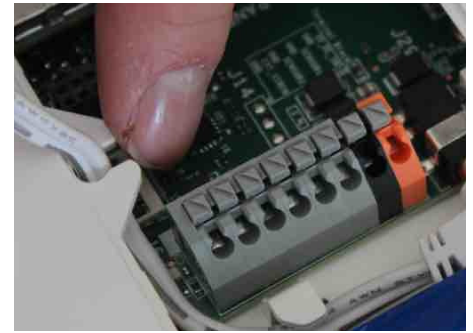

Insert the wire into the strain-relief

Now let's put on your cover and attach the table stand.



Place the top of the cover onto the panel's back plate



Push the cover down until it snaps in place



Insert the table stand into the mounting holes and push upward until it snaps into place

Plug in your panel, power it on



Plug in the power supply provided with your panel



Push and hold the standby button on the side of the panel for 3 seconds



Once the panel powers up, the home screen will appear.

Navigation

Move from page to page and access information on each page using finger touches, swipes, and scrolling.

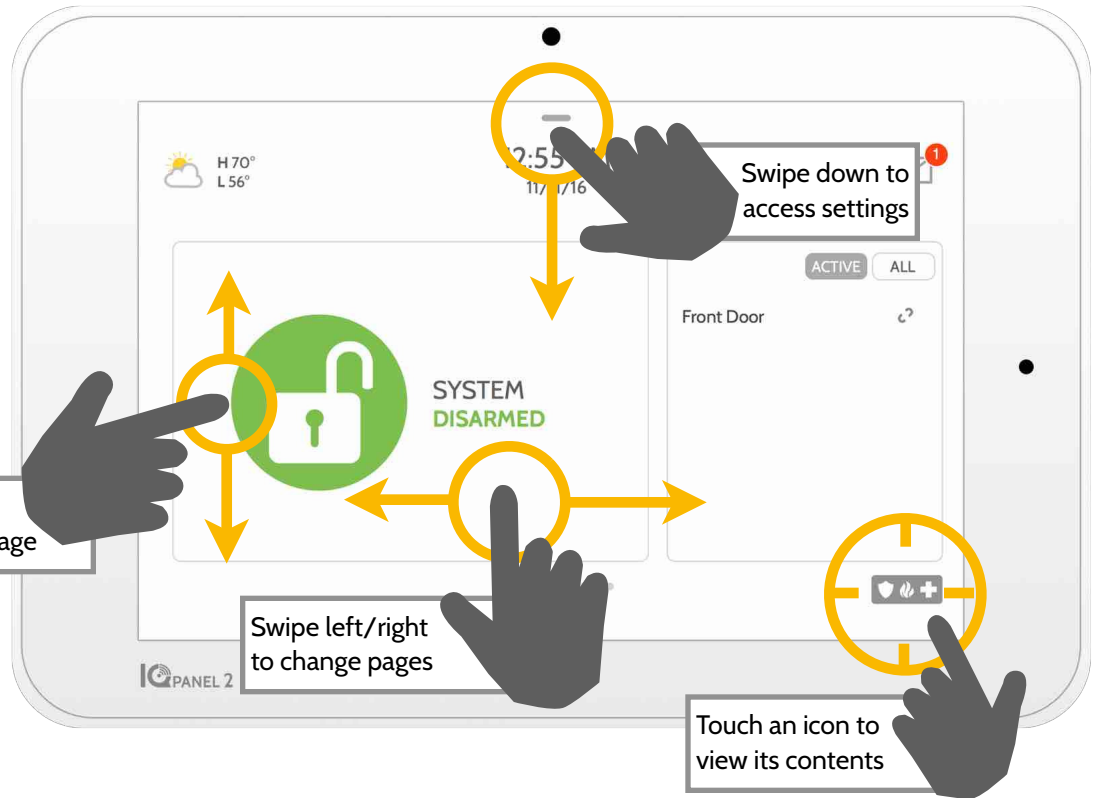

Scroll up/down to reveal additional content on a page

Swipe left/right to change pages

Touch an icon to view its contents

Dismiss

To dismiss a pop up when you are done, swipe left or right to dismiss.

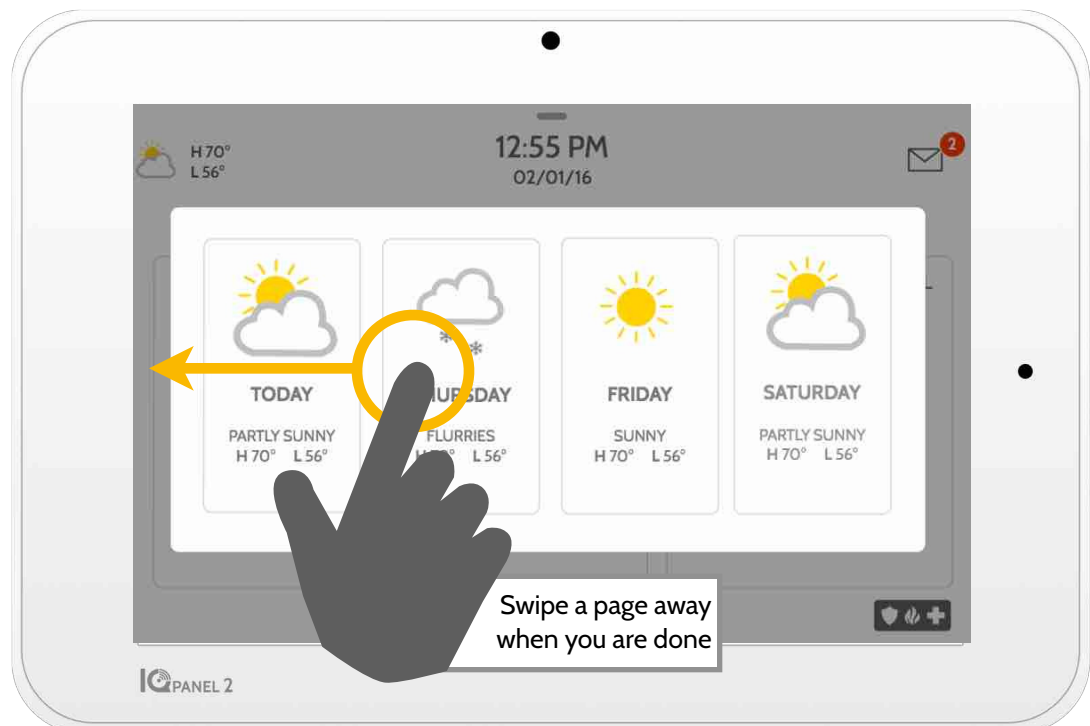

Swipe a page away when you are done

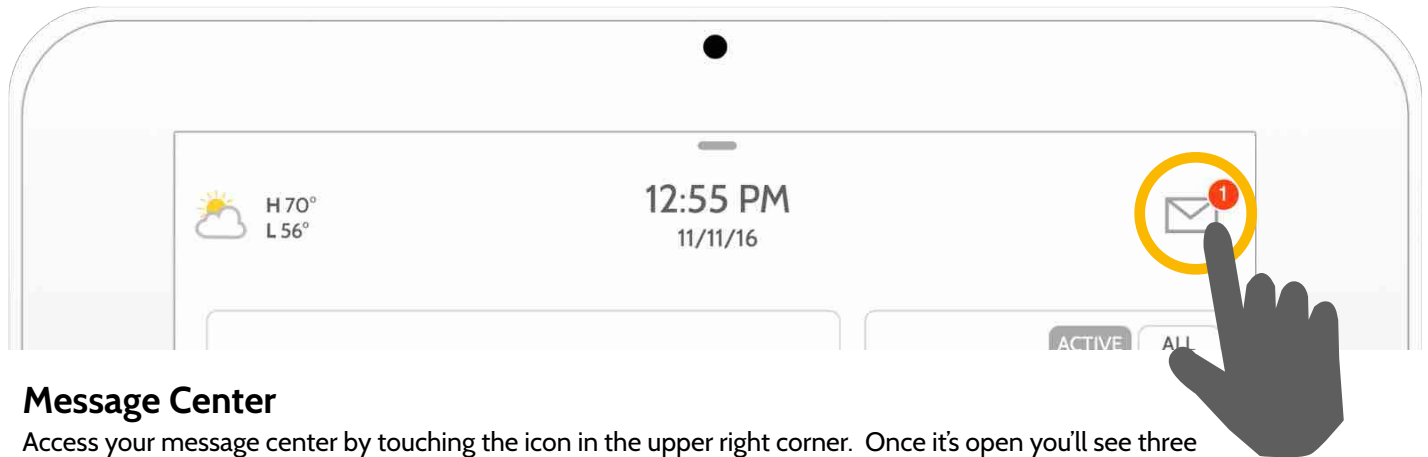

Message Center

Access your message center by touching the icon in the upper right corner. Once it's open you'll see three sections: Contact, Video Tutorials, and Messages/Alerts/Alarms

(Note: This icon may appear different than shown, depending on your provider's settings)



Contact

Easy access to your provider's contact information, including phone number, email, and website.

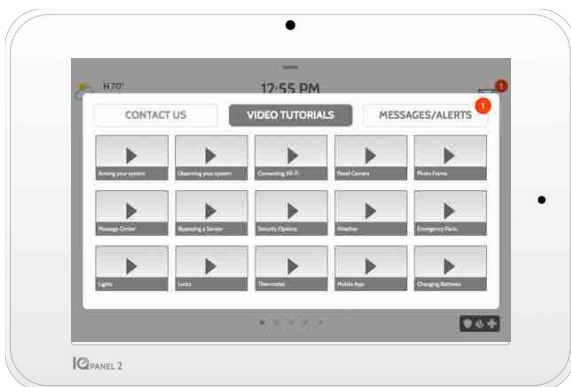

Video Tutorials

Watch videos to help you understand your system and service better.

To watch a video, touch a thumbnail. Video will begin playing automatically.

Video controls appear on screen. To exit, touch the "back" button.

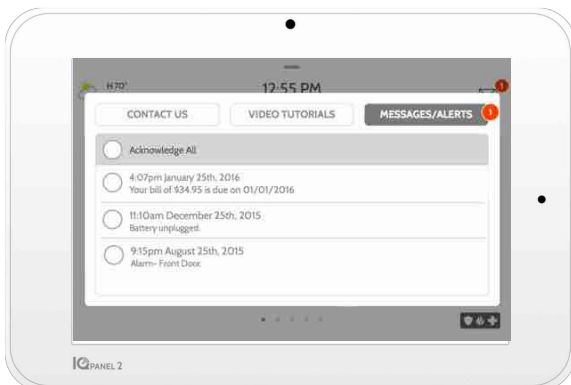

Messages/Alerts/Alarms

Get messages from your system like low battery alerts, alarms, and power failures. Messages from your provider will also appear here.

To dismiss, touch the circle to the left of the message and touch "OK" to remove it from your message center.

You can also remove all messages at once by touching "Acknowledge All"

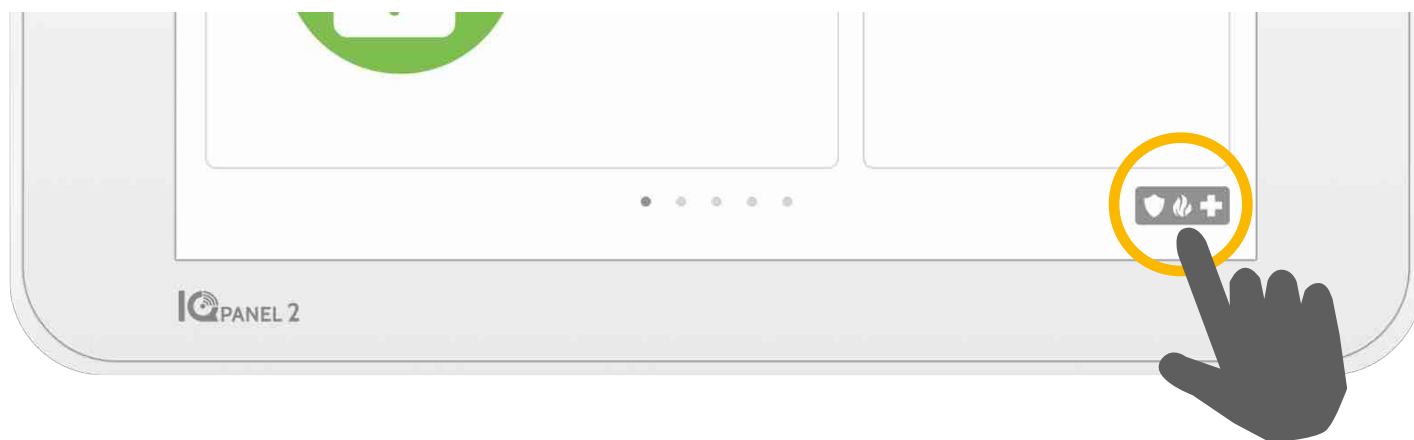

Emergency Panic

If you have a police, fire, or medical emergency and your system is not armed or a sensor has not been triggered, you can send a manual emergency panic by touching the icon in the bottom right corner and selecting the type of emergency you are experiencing. *(Note: based on your location, not all options may appear or be available to you.)*

There's a stranger in my backyard!



Two-Way Voice

If your provider offers Two-Way Voice service you'll be able to speak to the monitoring agent from the speakers and microphone built right into your panel.

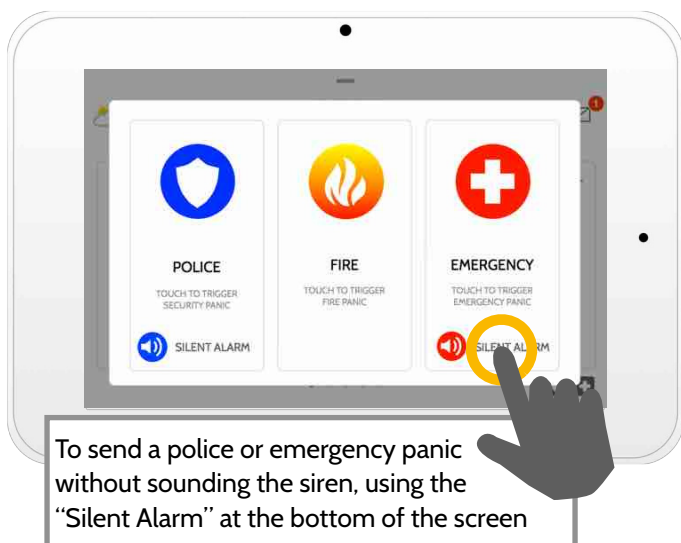

Alarm Types



Police: When touched it triggers the "Police" siren pattern and sends a police emergency signal to your provider's monitoring station.



Fire: When touched it triggers the "Fire" siren pattern and sends a fire emergency signal to your provider's monitoring station.



Emergency: When touched it triggers the "Emergency" siren pattern and sends an emergency signal to your provider's monitoring station.



Canceling an Emergency Panic
To cancel an emergency panic, touch the "cancel" button and enter a valid user code.

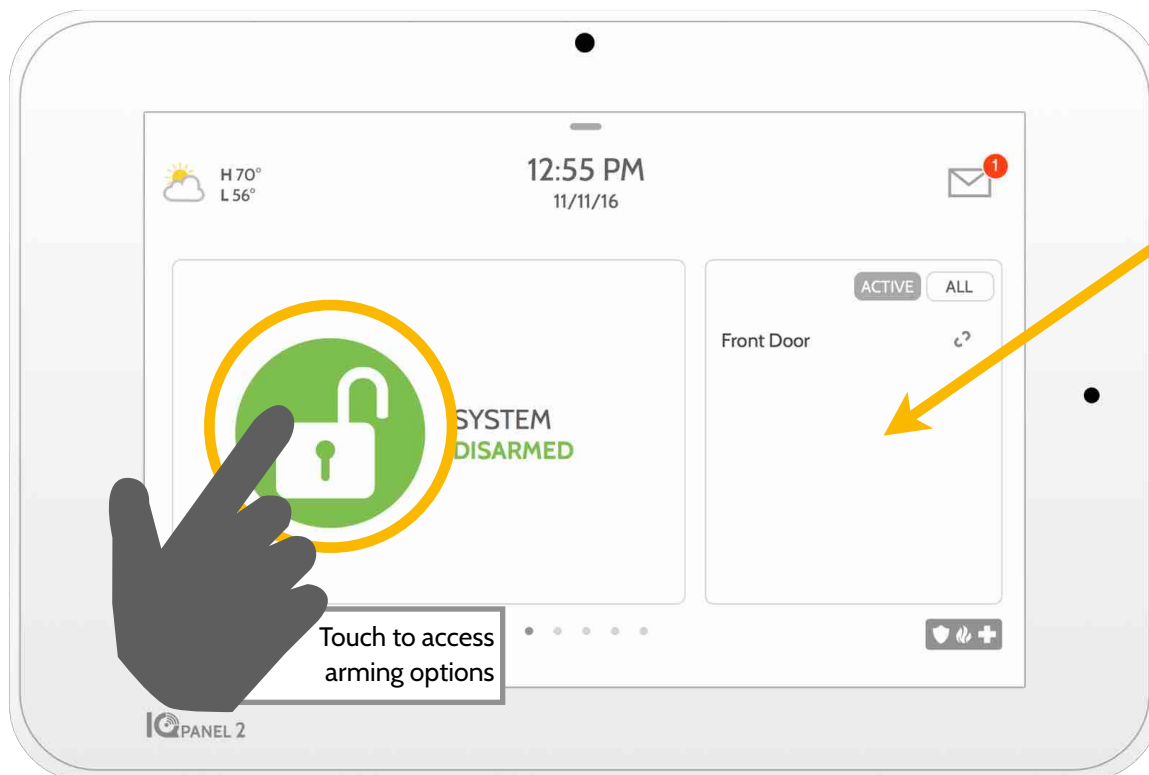

Sensor List

Open or active sensors appear in a scrollable list on the right. Touch the icons in the upper right corner to switch your view to either "Active" or "All" sensors.

Sensor status:

- Open
- Closed
- Active
- Idle
- Unreachable
- Tampered

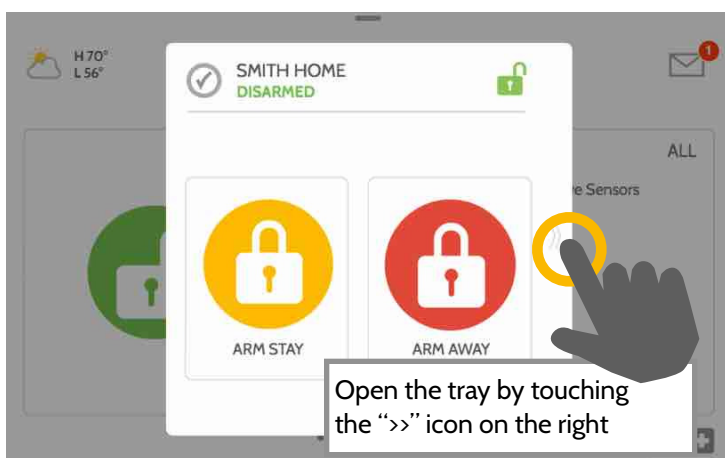

Open the tray by touching the ">>" icon on the right

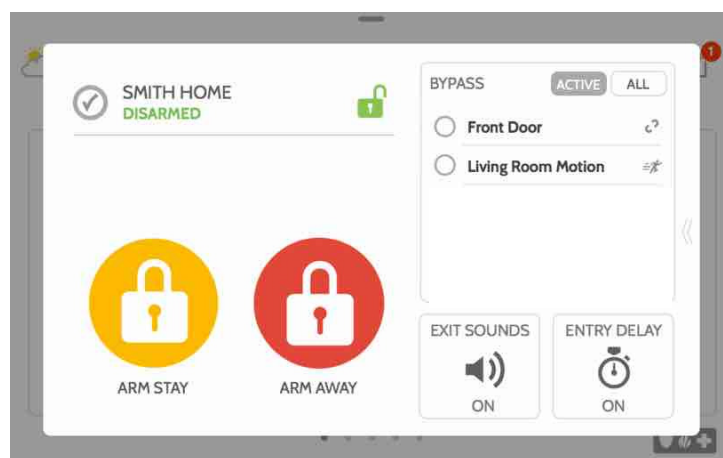

Arming Options

Quickly choose from "stay" or "away"



Arming Stay

Arms doors and windows only



Arming Away

Arms doors, windows and motions



Additional Options

View additional arming options by touching the ">>" icon on the right side

Additional Arming Options

Select these options before choosing your arming type



Bypass

Touch the circle next to a sensor to bypass it during the arming sequence



Exit Sounds

The panel beeps as the timer counts down. Silence these beeps before you choose the arming type.



Entry Delay

The panel will give you time to disarm once a "delay door" has been opened. Turn this off with a touch.

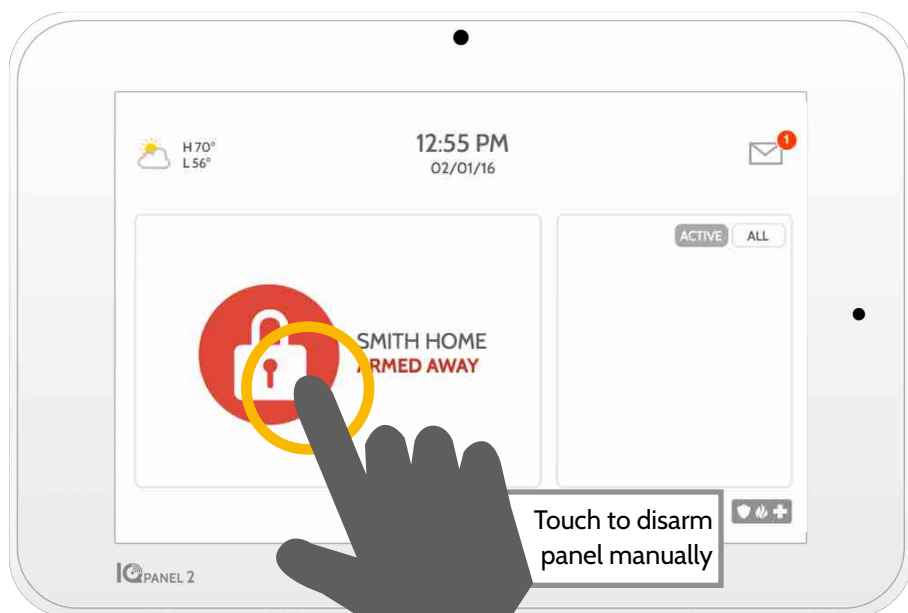

Disarming your System

When your system is armed, there are multiple ways to disarm:



Disarming Manually

To manually disarm your panel, touch the icon in the center of the screen. You will be prompted to enter a valid code. Failure to enter a valid code with the time required will trigger the alarm.

- When someone manually disarms the panel the built in camera will take a photo and save it on the camera page along with the date, time, and name of the user.



Disarming Remotely

To remotely disarm your panel, login to your mobile app and touch the "disarm" icon.



Download the Alarm.com app in the App store or Google Play

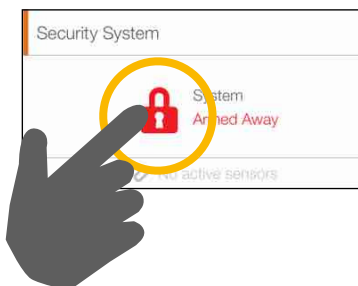

Disarming Automatically

You can connect your smartphone using Bluetooth and it will automatically disarm your IQ Panel from an "Armed Away" state when it comes within range. To connect a phone, follow the steps shown.



Bluetooth Touchless Disarming

- Step 1:** Swipe down to access settings tray
- Step 2:** Touch "SETTINGS"
- Step 3:** Touch "ADVANCED SETTINGS"
- Step 4:** Enter your code
- Step 5:** Touch "BLUETOOTH DEVICES"
- Step 6:** Put your Bluetooth device in "pairing" mode.
- Step 7:** Touch "ADD DEVICE" The panel will begin searching for new devices in range (It may take up to 60 seconds)
- Step 8:** Select your device from the list
- Step 9:** Touch "Pair"
- Step 10:** When the messages appear on your phone and IQ Panel, ensure the numbers match and touch "Pair" on each.

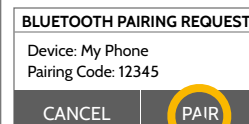
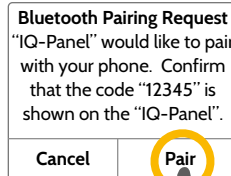

*You can connect up to five (5) smartphones for touchless disarming. Before you begin you must enable this setting in your Bluetooth settings.

Alarms

If the alarm is triggered the IQ Panel will sound the siren and display a red alarm screen.



If your provider offers monitoring service, the panel will automatically contact your monitoring center using the dual path LTE and Wi-Fi connection.

To disarm, touch the screen and enter your passcode.

Two Way Voice

The built in microphones on the bottom of the panel and the Two-Way Voice speaker on the side of the panel activate after a connection to the monitoring station has been made.

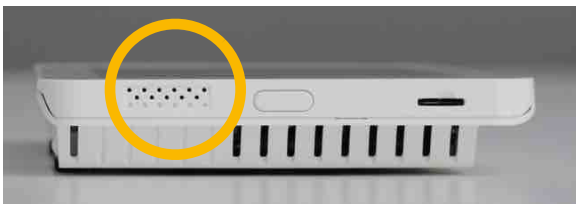

Speakers are located on each side of the panel



Microphones are located on the bottom of the panel

False Alarms

In the event of a false alarm, press disarm and enter your user code. If your system is monitored, be ready to provide your verbal password to your security provider's monitoring agent if they contact you. If you are NOT able to provide the correct verbal passcode, the authorities may be contacted.



Police

When the system is armed and the alarm is tripped or you touch the "Police" emergency button the alarm sounds with the "Intrusion" siren and then activates the Two-Way Voice microphone and speaker, if available.



Fire

When a Smoke or Carbon Monoxide detector is triggered or someone taps the "Fire" panic on the IQ Panel the alarm sounds with the "Fire" siren and then activates the Two-Way Voice microphone and speaker, if available.

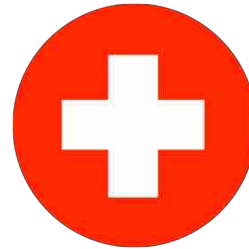

Emergency

When you press an IQ Pendant or trigger an emergency signal from the IQ Panel, the alarm sounds with the "Emergency" siren and then activates the Two-Way Voice microphone and speaker.

Preventing false alarms:

False alarms are a terrible waste of your public service resources, and can erode your relationship with local authorities. In some areas, authorities even charge a fee for false dispatches.

Here's some tips for avoiding false alarms:

- Use your system regularly, be comfortable with its operation.
- Make sure everyone who has access to your home has a valid access code and is familiar with how to use the system.
- Ensure the doors you use the most are set up with delays to give you enough time to disarm the system when you open a door.
- Test your system regularly
- Develop a routine.
- Use alternative methods for arming and disarming (mobile app, bluetooth disarming, etc.)

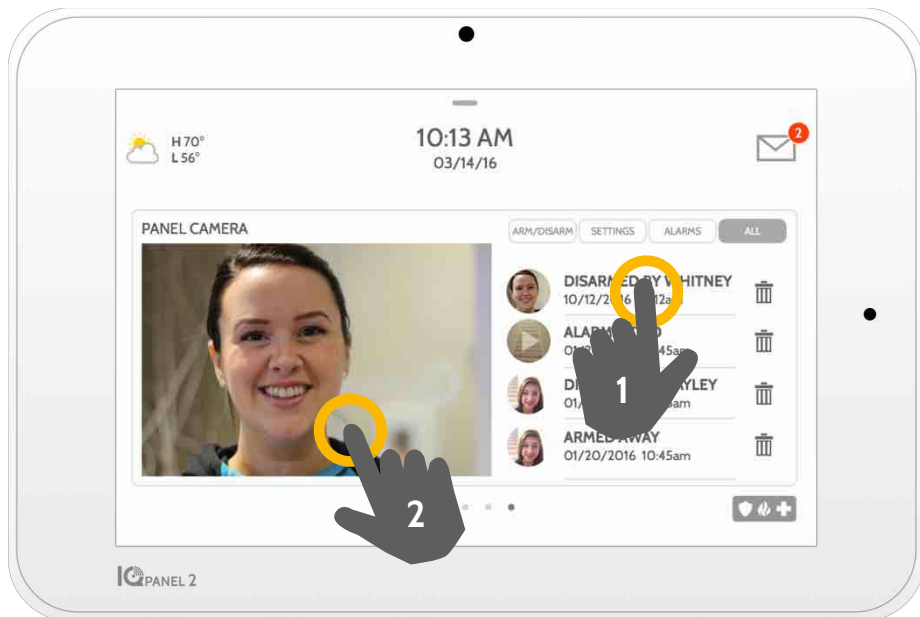

1- View Photo

Touch a photo thumbnail on the right to view it on the left.

2- Full Screen

Touch the photo on the left to view it full screen. Touch it again to return to the camera page.

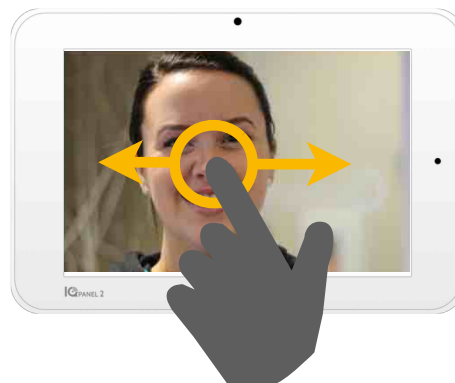

Note: While viewing photos full screen you can swipe left/right to view additional photos

Camera Page

Your IQ Panel's built in camera captures photos in a variety of situations:



Disarm Photos

When the panel is disarmed manually, the built in camera takes a photograph and saves it in the "ARM/DISARM" section. These photos are accompanied by the username of the individual who's code was used, the date, and the time.



Settings Photos

When someone attempts to access your panel settings with an invalid code, the built in camera takes a photograph and saves it in the "SETTINGS" section. These photos are accompanied by the date and time.



Alarm Photos

When the alarm is triggered, the built in camera takes a photograph and saves it in the "ALARMS" section.

Photos to your Phone



Customer Login

Password

Sign In

Remember Me [Login Help?](#)

Alarm.com/Login
Get your username and password from your provider



Click the "Image Sensor" tab



Click "Rules & Alerts"



Click "Capture Alarm And Disarm Images" to customize

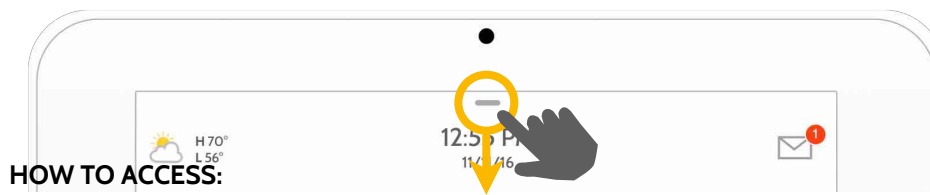

Settings Tray

Access common settings by swiping down from the top of the screen.

HOW TO ACCESS:

Security Status

See your panel's security status in the upper right. Touch it to go directly to the security page

Battery & Radios

Touch an icon to get more information
 -Battery level
 -Wi-Fi connection
 -Bluetooth status
 -Cellular connection

Volume

Slide left/right to adjust the panel voice

Brightness

Slide left/right to adjust the screen brightness

Settings

Touch to access the full settings page. From there you can also access "Advanced settings" (which will require a passcode)

Language

Touch to change panel language (may not be available)



Messages & Alerts

Touch to access the message center including your provider's contact information, video tutorials, and system messages

Photo Frame

Touch to access the photo frame where you can customize the panel's screensaver

Close Tray

Swipe up to close the tray

Clean Screen

Disables the screen for 30 seconds to allow you to clean it without accidentally touching anything. (Touch the "standby" button on the side of the panel to cancel)

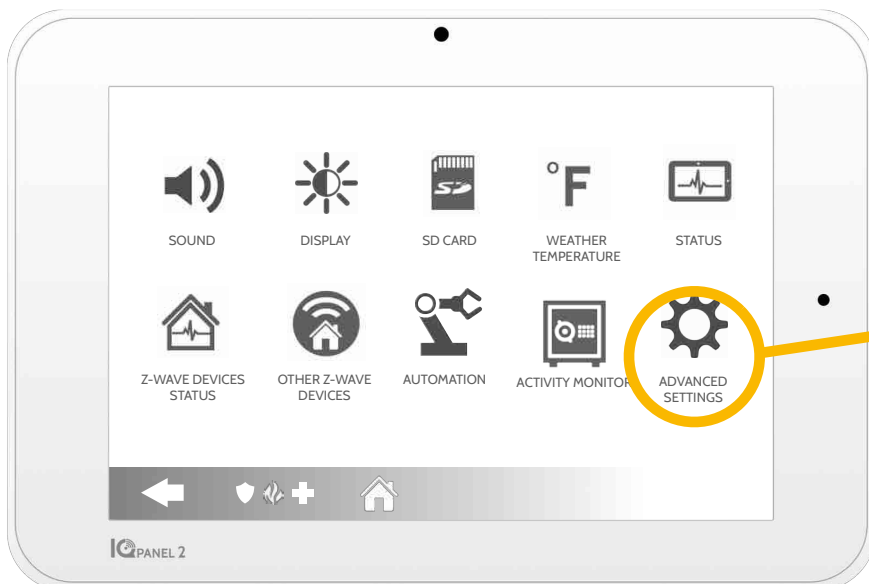

Settings Page

From here you can adjust individual sound settings, change your weather temperature from Fahrenheit to Celsius, see the status of your security and smarthome devices, and more.

Advanced Settings

Only the Master code can access this area. From here you can manage users, run system tests, reboot your system, connect Bluetooth and Wi-Fi and more.

Photo Frame

When your panel is not in use, it turns into a customizable photo frame.

Settings

Inside settings you can choose whether you want photos or a weather clock, if you want the panel to turn itself off automatically in the evenings, and more.

Add Photos

To add your own photos:

- 1 Save your Photos onto a Micro SD card in a folder called "Photos"
- 2 Insert your SD card into the slot on the side of the panel



- 3 Touch "ADD"

- 4 Touch each photo you wish to use or choose "Select All"

- 5 Choose either "Add" or "Replace"

Add: Does not delete the photos already on the panel, only adds the photos you selected

Replace: Deletes the photos already on the panel and replaces them with the new photos you selected

- 6 Wait at least 60 seconds after the photos have copied to remove the SD Card

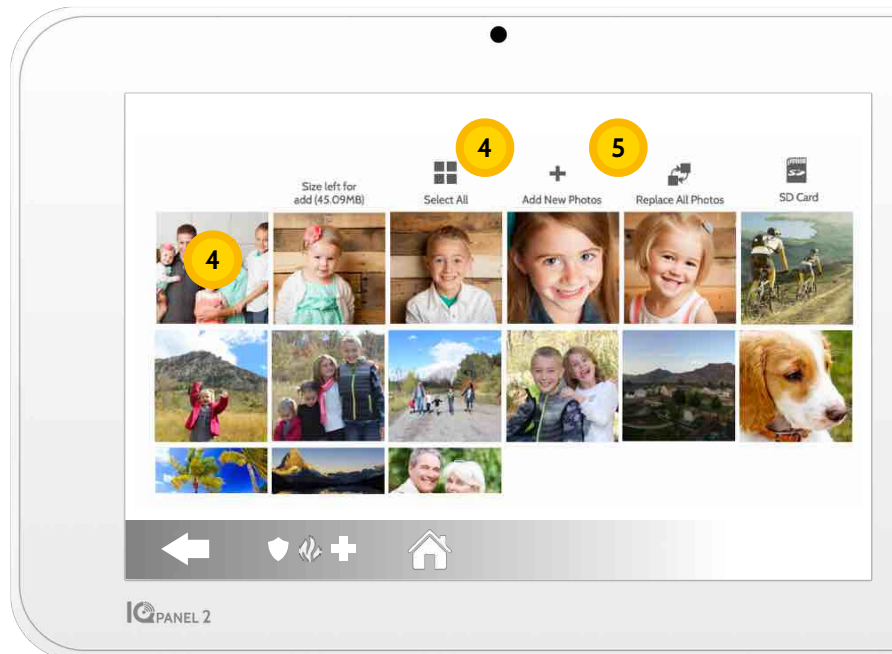
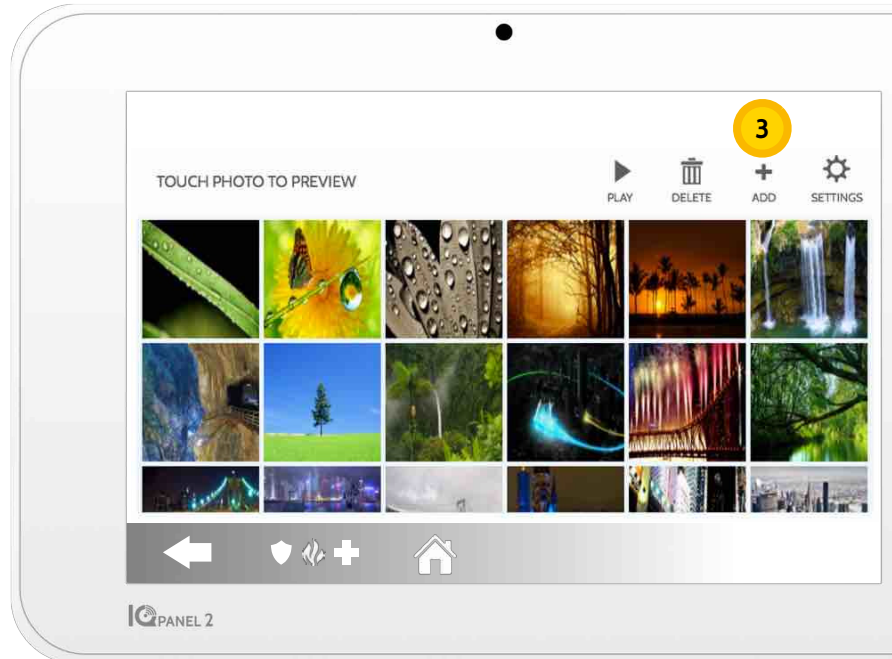

Delete

Touch a photo to select it. Touch "Delete" to delete it from your panel

User Types

You can add up to 242 users to your system, each with a custom name and access you allow.

Master: Access panel functions, camera, and system settings.

User: Access panel functions, camera, but NOT system settings.

Guest: Used to give arm and disarm access to those users who will use the panel on a temporary basis



Notifications

By creating individual users, you can set up custom text notifications when they access or use your system, keeping you connected no matter where you are.

How to Add a New User

Step 1:
Swipe down to access settings tray

Step 2:
Touch "SETTINGS"

Step 3:
Touch "ADVANCED SETTINGS"

Step 4:
Enter your code*

Step 5:
Touch "User Management"

Step 6:
Touch "Add User"

Name	<input type="text" value="Enter Name"/>
User Code	<input type="text" value="Please enter User Cod"/>
Confirm User Code	<input type="text" value="Please confirm User C"/>
Type	<input type="text" value="User"/>
Expiration Date	<input type="text" value="Unlimited"/>

Add User Screen

Once on the "Add User" screen you can create a custom name and user code and indicate whether you want this person to be a Master, User, or Guest.

*Default master code is 1234. For security purposes this code should be changed once the system has been installed in your home

Testing Regularly

You should test your system regularly to ensure it is operating at peak efficiency. The IQ Panel has a number of tests built in that are easy to perform:



Wi-Fi Test

Run this test every 30 days or if the IQ Panel's Wi-Fi connection seems to be failing.



Sensor Test

Run this test every 30 days. As you start the test, open and close your doors, windows, and move in front of your motion sensors to ensure they work as expected.



Cellular Test

Run this test if your panel seems to have lost its ability to send and receive signals.



Image Sensor Config

Run this test if your image sensors stop working



Z-Wave Test

A series of Z-Wave tests to optimize your smarthome network. "Reconfigure network" is your most useful test, repairing your network for you.



Dual Path Test

Run this test if your panel seems to have lost its ability to send and receive signals.



Panel Glass Break Test





Use this to test your panel's microphone

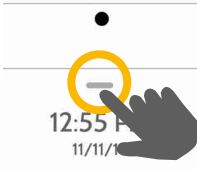

Panel Test

Use this every 30 days to test a variety of panel functions

How to Access System Tests

-  **Step 1:**
Swipe down to access settings tray
-  **Step 2:**
Touch "SETTINGS"
-  **Step 3:**
Touch "ADVANCED SETTINGS"
-  **Step 4:**
Enter your master code*
-  **Step 5:**
Touch "System Tests"

Encounter a Problem?

If you encounter a problem with your system, contact your provider right away.



Touch "Message Center" in the upper right corner of your panel to get your provider's contact information



*Default master code is 1234. For security purposes this code should be changed once the system has been installed in your home

Light Control

You can add up to 80 Z-Wave lights, lamp modules, or lightbulbs to your IQ Panel. This will allow you to control your lights locally on the panel and also from your mobile app. Once your first light is added to your system, the lights page will appear. Simply swipe over to access it.



Dimmer

Touch the slider from left to right to adjust the brightness of a single dimmer

ON/OFF

Touch a bulb or outlet icon to turn it on or off

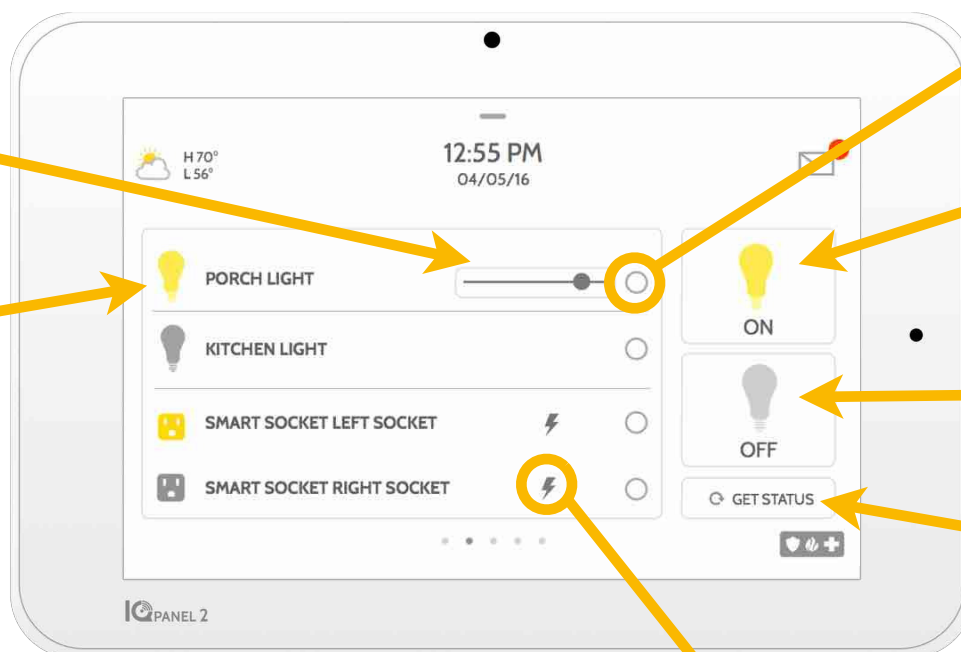

Select

Touch the circle next to a light to select it

ON

Touch turn on all selected lights

OFF

Touch turn off all selected lights

GET STATUS

Touch to check the status of all selected lights

Energy

Touch the energy icon to see how much energy the outlet is currently using

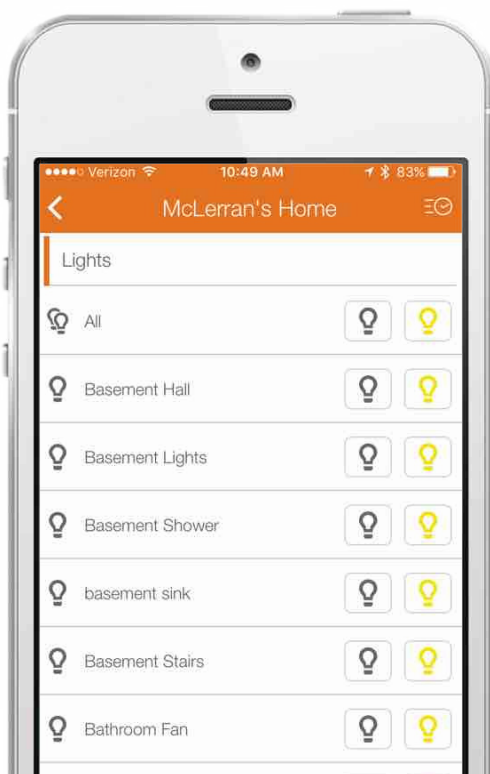
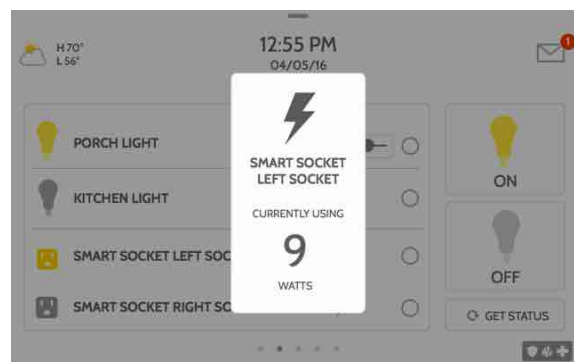

Mobile Access

You can also control your lights from your mobile app.

Lock Control

You can add up to 6 Z-Wave locks to your IQ Panel. This will allow you to control your locks locally on the panel and also from your mobile app. Once your first lock is added to your system, the lock page will appear. Simply swipe over to access it. If you have more than one lock swipe up and down to access each one.



ON/OFF
Touch the key icon to unlock or lock it

Change Locks
If you have more than one lock, swipe up and down to access each one.

Get Status
Touch the refresh icon to check the lock's current status

UNLOCK ALL
Touch to unlock all your locks at once

LOCK ALL
Touch to lock all your locks at once

The image shows the IQ Panel 2 interface for lock control. At the top, it displays weather (H 70°, L 56°), time (12:55 PM), and date (04/05/16). The main area features a large green key icon labeled 'FRONT DOOR UNLOCKED'. To the right, there are 'UNLOCK ALL' and 'LOCK ALL' buttons, each with a key icon. A refresh icon is located above the 'UNLOCK ALL' button. At the bottom left, there are three dots indicating a list of other locks. At the bottom right, there are icons for home, back, and a plus sign.

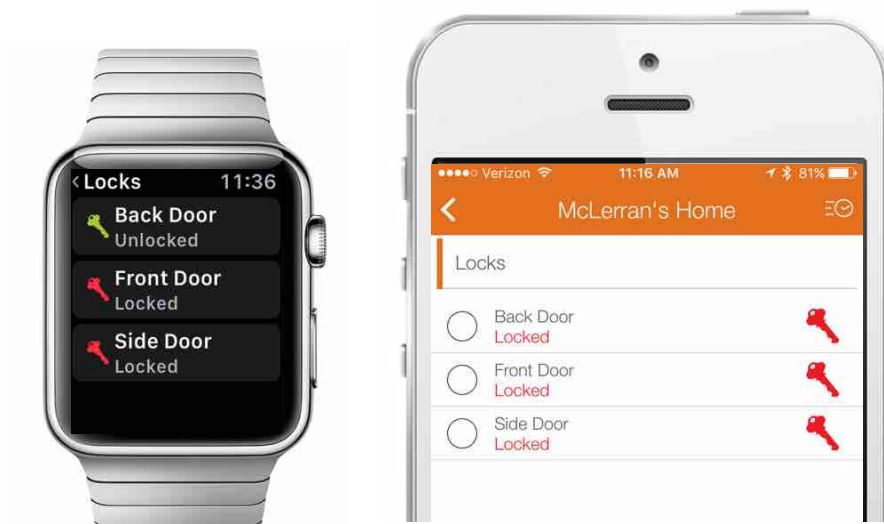

Mobile Access
You can also control your locks from your mobile app.

Thermostat Control

You can add up to 6 thermostats to your IQ Panel. This allows you to control the temperature in your home locally on the panel and also from your mobile app. Once your first thermostat is added to your system, the thermostat page will appear. Simply swipe over to access it. If you have more than one thermostat swipe up and down to access each one.

Up/Down
Touch the arrows to adjust the target temperature

Switch
If you have more than one thermostat, swipe up and down to access each one.

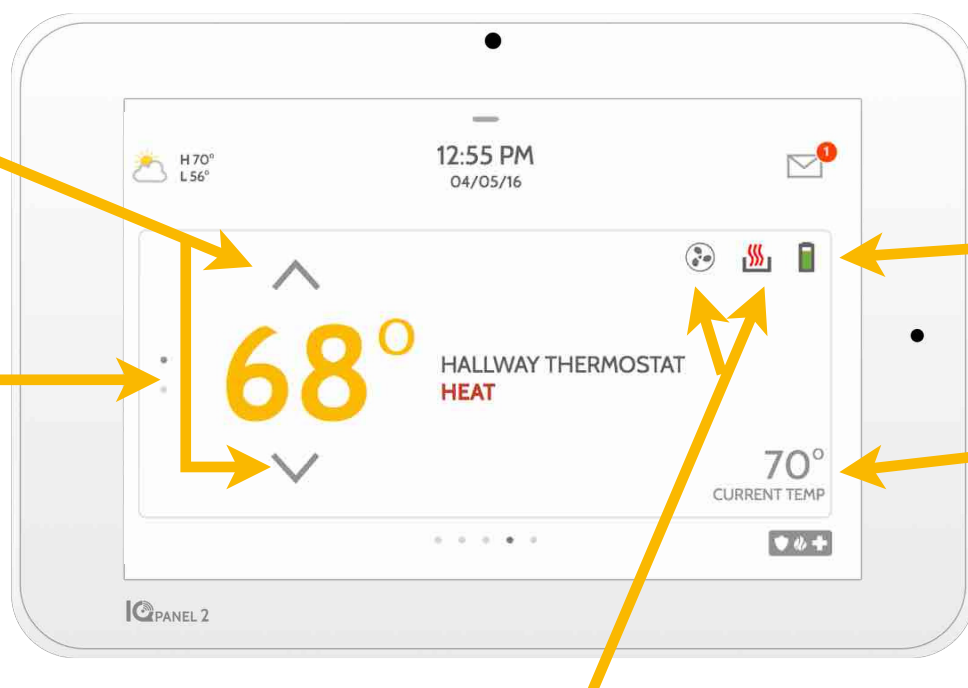

Battery level
Displays how much battery is left in your thermostat

Current Temp
Displays the current temperature in your home



Fan
Touch to change to "On" or "Automatic"

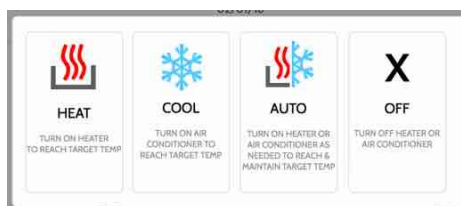

Mode
Touch to change this thermostat from heat to cool (or off) or use "automatic" which switches from heat to cool as needed to maintain your target temperature.

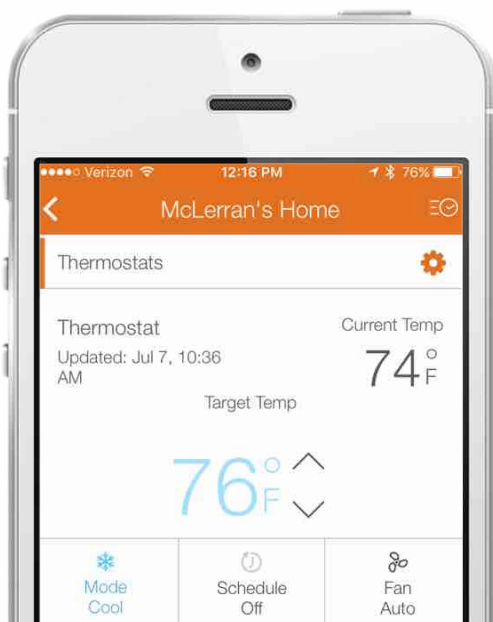

Mobile Access
You can also control your thermostat from your mobile app.

Garage Control

You can add up to 10 Z-Wave overhead garage door controllers to your IQ Panel. This allows you to control the door from your panel and also from your mobile app. Once your first thermostat is added to your system, the thermostat page will appear. Simply swipe over to access it. If you have more than one overhead garage door swipe up and down to access each one.



Open/Close
Touch the icon to open or close the garage door

Switch
If you have more than one thermostat, swipe up and down to access each one.

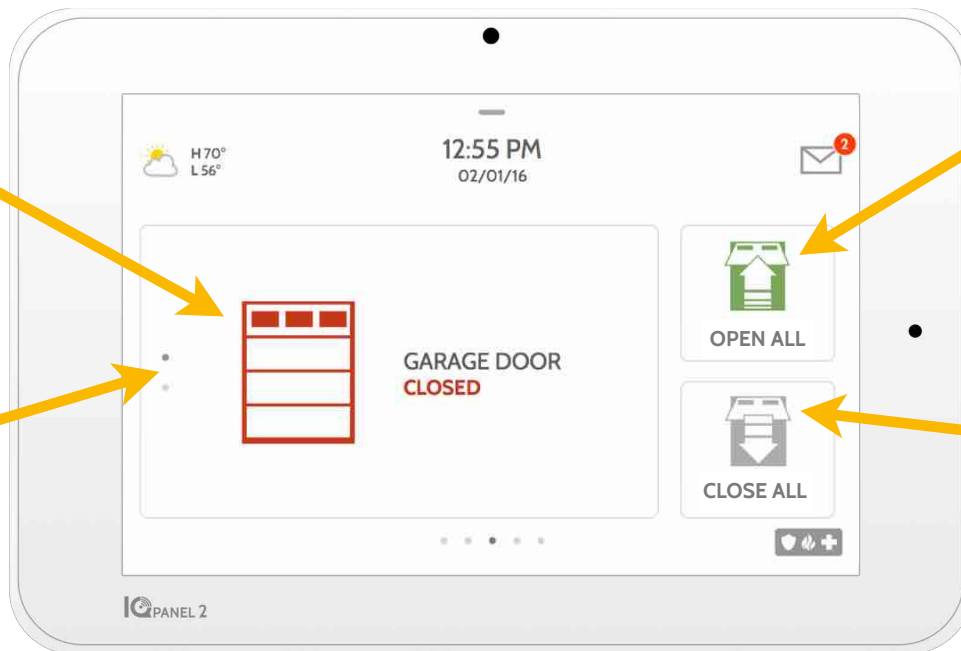

Open
Touch the icon to open the garage door (not available when the garage door is already closed)

Close
Touch the icon to close the garage door (not available when the garage door is already closed)



Image Sensors

You can add up to 5 Image Sensors to your IQ Panel. This allows you to see the photos taken by your image sensors locally on the panel and also from your mobile app. Once your first Image Sensor is added to your system, the Image Sensor page will appear. Simply swipe over to access it. If you have more than one Image Sensor your photos will all be combined into this list.

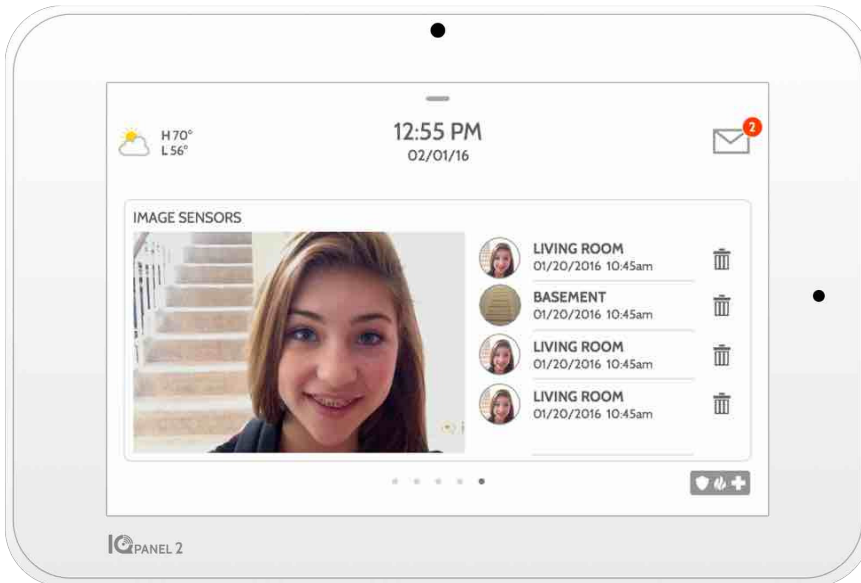

Peek-in Now

Use this command to take a picture now.



Peek-In Next Motion

Use this command to take a picture the next time the Image Sensor's motion sensor detects movement.



Alarm Photos

When the alarm is triggered the Image Sensor will take photos if/when it detects motion

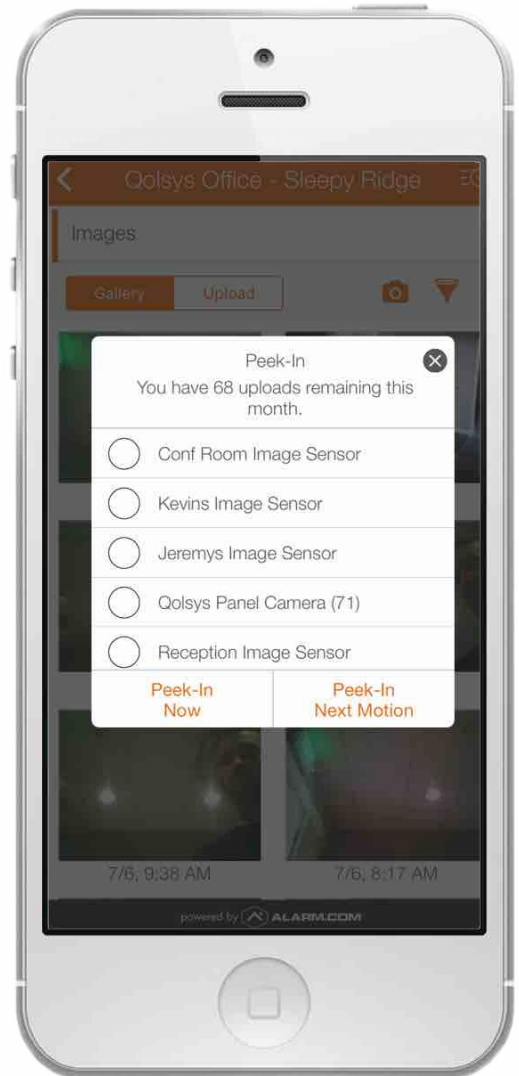

Peek in Request

Request a "Peek-In" from your app.

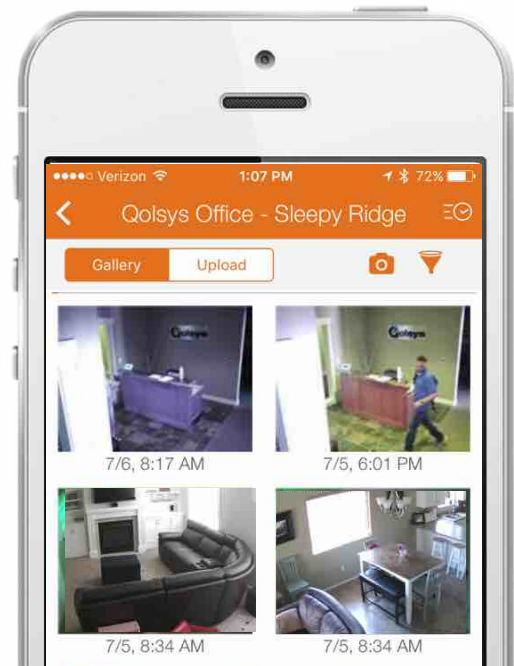

View Images Remotely

You can view your image gallery from the "Image Sensor" section of your mobile app.

Rebooting your panel

If you experience any problems with your panel, you can reboot the operating system

How to Reboot

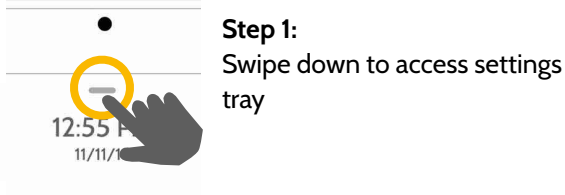

Step 2:
Touch "SETTINGS"



Step 3:
Touch "ADVANCED SETTINGS"



Step 4:
Enter your master code



Step 5:
Touch "Panel Reboot"

The panel will power down and then reboot.

Software Updates

Be sure your panel is always using the latest software

How to check for updates

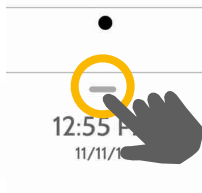

Step 1:
Swipe down to access settings tray



Step 2:
Touch "SETTINGS"



Step 3:
Touch "ADVANCED SETTINGS"



Step 4:
Enter your master code



Step 5:
Touch "Software Upgrade"

Step 6:
Touch "Update Using Network." If a software update is available, it will download automatically and the panel will reboot

FCC REGULATORY INFORMATION

This device complies with part 15 of the FCC Rules. Operation is subject to the following two conditions: (1) This device may not cause harmful interference, and (2) this device must accept any interference received, including interference that may cause undesired operation.

NOTE: This equipment has been tested and found to comply with the limits for a Class B digital device, pursuant to part 15 of the FCC Rules. These limits are designed to provide reasonable protection against harmful interference in a residential installation. This equipment generates, uses and can radiate radio frequency energy and, if not installed and used in accordance with the instructions, may cause harmful interference to radio communications. However, there is no guarantee that interference will not occur in a particular installation. If this equipment does cause harmful interference to radio or television reception, which can be determined by turning the equipment off and on, the user is encouraged to try to correct the interference by one or more of the following measures:

- Reorient or relocate the receiving antenna.
- Increase the separation between the equipment and receiver.
- Connect the equipment into an outlet on a circuit different from that to which the receiver is connected.
- Consult the dealer or an experienced radio/TV technician for help.

This equipment complies with radiation exposure limits set forth for uncontrolled environment. The antenna(s) used for this transmitter must be installed to provide a separation distance of at least 20 cm from all persons and must not be collocated or operating in conjunction with any other antenna or transmitter.

IMPORTANT: Changes or modifications not expressly approved by Golsys, Inc. could void the user's authority to operate the Product.

IC REGULATORY INFORMATION:

This device complies with Industry Canada license-exempt RSS standard(s). Operation is subject to the following two conditions: (1) this device may not cause interference, and (2) this device must accept any interference, including interference that may cause undesired operation of the device.

Cet appareil est conforme aux normes d'exemption de licence RSS d'Industry Canada. Son fonctionnement est soumis aux deux conditions suivantes : (1) cet appareil ne doit pas causer d'interférence et (2) cet appareil doit accepter toute interférence, notamment les interférences qui peuvent affecter son fonctionnement

CAN ICES-3 (B)/NMB-3(B)

Cet équipement est conforme aux limites d'exposition aux rayonnements IC établies pour un environnement non contrôlé. Cet équipement doit être installé et utilisé avec un minimum de 20 cm de distance entre la source de rayonnement, votre corps, et d'autres antennes ou transmetteurs.

FCC/IC STATEMENT

Changes or modifications not expressly approved by Golsys can void the user's authority to operate the Product. This Product has been tested and found to comply with FCC Rules.

This Product generates, uses, and can radiate radio frequency energy and, if not installed and used in accordance with the instructions, may cause harmful interference to radio communications. However, there is no guarantee that interference will not occur in a particular installation.

If this Product does cause harmful interference to radio or television reception, which can be determined by turning the equipment off and on, the user is encouraged to try to correct the interference by one or more of the following measures: Reorient or relocate the receiving antenna.

Increase the separation between the Product and receiver.

Connect the affected equipment and the Product to separate outlets, on different branch circuits. Consult the dealer or an experienced radio/TV technician for help.

Household Fire Safety Audit

Read this section for important information about fire safety. Most fires occur in the home. To minimize this danger, we recommend that a household fire safety audit be conducted and a fire escape plan be developed.

1. Are all electrical appliances and outlets in a safe condition? Check for frayed cords, overloaded lighting circuits, etc. If you are uncertain about the condition of your electrical appliances or household service, have a professional evaluate these units.
2. Are all flammable liquids stored safely in closed containers in a well-ventilated cool area? Cleaning with flammable liquids should be avoided.
3. Are fire-hazardous materials (e.g., matches) well out of reach of children?
4. Are furnaces and wood-burning appliances properly installed, clean and in good working order? Have a professional evaluate these appliances.

Fire Escape Planning

There is often very little time between the detection of a fire and the time it becomes deadly. It is thus very important that a family escape plan be developed and rehearsed.

1. Every family member should participate in developing the escape plan.
2. Study the possible escape routes from each location within the house. Since many fires occur at night, special attention should be given to the escape routes from sleeping quarters.
3. Escape from a bedroom must be possible without opening the interior door.

Consider the following when making your escape plans:

1. Make sure that all border doors and windows are easily opened. Ensure that they are not painted shut, and that their locking mechanisms operate smoothly.
2. If opening or using the exit is too difficult for children, the elderly or handicapped, plans for rescue should be developed. This includes making sure that those who are to perform the rescue can promptly hear the fire warning signal.
3. If the exit is above the ground level, an approved fire ladder or rope should be provided as well as training in its use.
4. Exits on the ground level should be kept clear. Be sure to remove snow from exterior patio doors in winter; outdoor furniture or equipment should not block exits.

5. Each person should know the predetermined assembly point where everyone can be accounted for (e.g., across the street or at a neighbor's house). Once everyone is out of the building, call the fire department.

6. A good plan emphasizes quick escape. Do not investigate or attempt to fight the fire, and do not gather belongings as this can waste valuable time. Once outside, do not re-enter the house. Wait for the fire department.

7. Write the fire escape plan down and rehearse it frequently so that should an emergency arise, everyone will know what to do. Revise the plan as conditions change, such as the number of people in the home, or if there are changes to the building's construction.

8. Make sure your fire warning system is operational by conducting weekly tests. If you are unsure about system operation, contact your installer.

9. We recommend that you contact your local fire department and request further information on fire safety and escape planning. If available, have your local fire prevention officer conduct an in-house fire safety inspection.