



## MULTIMEDIA SPEAKER SYSTEM

PS-8322



Thank you for choosing our product!  
Please read the Manual carefully before using.

## SPECIFICATIONS

Output Power (RMS): 80 Watts + 30 Watts X 2

Power Supply: ~110V 60Hz

Speaker Units: 1 X 8" Woofer, 2 X 3" Tweeter

Frequency Response: Woofer 20Hz - 170Hz  
Tweeter 120Hz - 20KHz

Separation:  $\geq 40$  dB

S/N:  $\geq 70$  dB

Distortion Rate:  $\leq 0.5\%$  (1K, 1W)

Dimensions: Speaker: W314xH895xD398 (mm)

- High-Quality Multimedia Speaker with built-in Amplifier.
- Full Audio Spectrum Performance, Ideal for your Favorite Entertainments
- Specially Designed Woofer Cabinet For Excellent Performance of Bass
- Remote Controller & 3.5mm Stereo Cable included

## Package Contents:

Speaker .....	1 PCS
Wired Microphone .....	1 PCS
Remote Controller .....	1 PCS
3.5mm Input Cable .....	1 PCS
FM Antenna .....	1 PCS
User Manual .....	1 PCS

NO.1

## PLAYBACK CONTROLLER

1. ST-BY/▶|
2. SOURCE
3. ▶▶/VOL+
4. ◀◀/VOL-

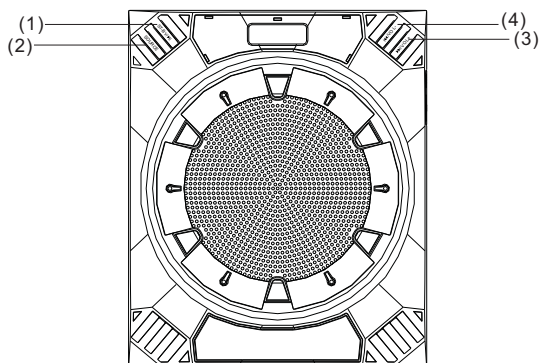

**ST-BY/▶|:** In MEMORY CARD/BT Mode, short press to play or pause.

In FM Radio Mode, short press to search FM channels automatically. In AUX Mode, short press to mute.

**SOURCE:** Turn to the MEMORY CARD/BT/FM/AUX Mode as you want.

**▶▶/VOL+:** In MEMORY CARD/BT Mode, short press to play the next song.

In FM Radio Mode, short press to play the next FM channel. In all Modes, long press to increase the volume.

**◀◀/VOL-:** In MEMORY CARD/BT Mode, short press to play the previous song.

In FM Radio Mode, short press to play the previous FM channel. In all Modes, long press to decrease the volume.

NO.2

## HOW TO USE THE REMOTE CONTROLLER?

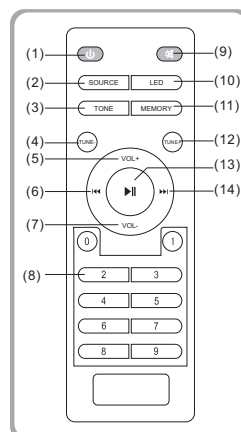

1. ST-BY
2. SOURCE
3. TONE
4. TUNING-
5. VOL+
6. PREVIOUS
7. VOL-
8. 0~9
9. MUTE
10. LED effect
11. MEMORY
12. TUNING+
13. PLAY/PAUSE
14. NEXT

1. Press "ST-BY" LED showing "AU18", it is AUX mode playing state.

2. "MUTE" means to activate or deactivate mute.

3. "SOURCE" means you can choose AUX, Multi-media, MEMORY CARD, FM, BT input mode, at the same time, the LED will show "Au18" means AUX mode, "Du18" means Multi-media mode. "87.5" means FM mode, "Bi18" means BT mode.

4. "TONE" means you can choose "TREBLE" and "BASS" "VOL+/-" means you can increase or decrease volume of "TREBLE" or "BASS".

5. When enter into FM mode, press "MEMORY" the number on the LED will Blink. this means the machine is under save channel state. You can change the blinking number by pressing "NEXT" or "PREV", press "PLAY/PAUSE" you can save the channel into same number. it will enter into automatic search channel and automatic save channel when pressing "MEMORY" for 3-5 seconds (noted: the channel which you saved before will be deleted when you press "MEMORY" for 3-5 seconds).

NO.3

6. When entering into MEMORY CARD mode. "NEXT" means next song; "PREV" means previous song; "PLAY/PAUSE" means play/pause; pressing the number "0-9" on the remote control, you can choose the corresponding song.
7. VOL+/- means you can increase or decrease volume.
8. "TUNING-" means decrease the frequency of channel selection. Press "TUNING-" for a long time means decrease the frequency of channel selection continuously
9. "TUNING+" means increase the frequency of channel selection. Press "TUNING+" for a long time means increase the frequency of channel selection continuously.
10. "PLAY/PAUSE" means play/pause for MEMORY CARD.
11. "PREV" means previous song for MEMORY CARD.
12. "NEXT" means next song for MEMORY CARD.
13. Press "SOURCE" buttons on the remote to convert to Bluetooth input mode, LED display right bottom start to flashing (2 seconds) to search the Bluetooth device. Turn on the BT Mode on your mobile first and search the device named "PS-8322" to pair it. It will sound out a TICK while the devices get paired successfully, then you can play music with the PLAYBACK CONTROLLER that contains multi-functions as we mentioned above. Press "▶| " for 3 seconds to disconnect the devices in BT Mode.
14. LED: Short press to change 7 LED effects.

NO.4

## BACKSIDE PANEL

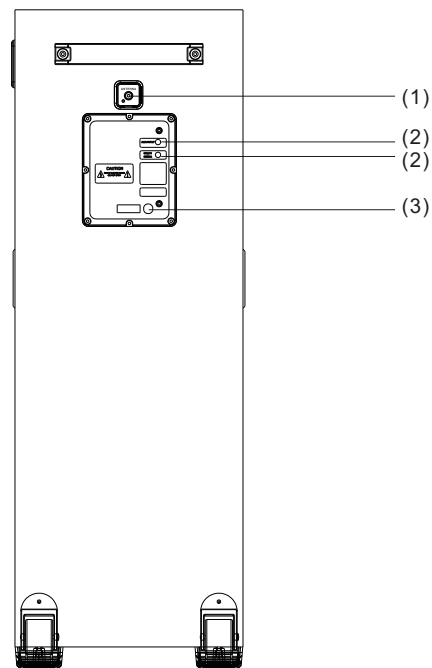

1. ANTENNA
2. AUX/MULTI-MEDIA INPUT:  
Connect to amplify the sound from others devices.
3. AC IN: AC Power cord

NO.5

## DIAGRAM FOR THE IDEAL PLACEMENT

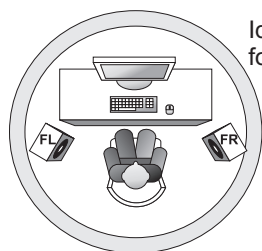
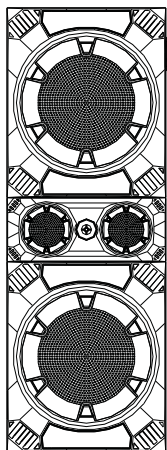

Ideal Placements for the Speakers

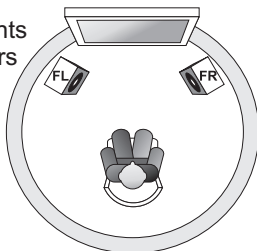

FL - Front Left  
FR - Front Right

### SPEAKER

Place the Main Speaker any position on the floor. No directional requirement for the bass effect.

NO.6

## PAY ATTENTIONS TO THE FOLLOWING CASES

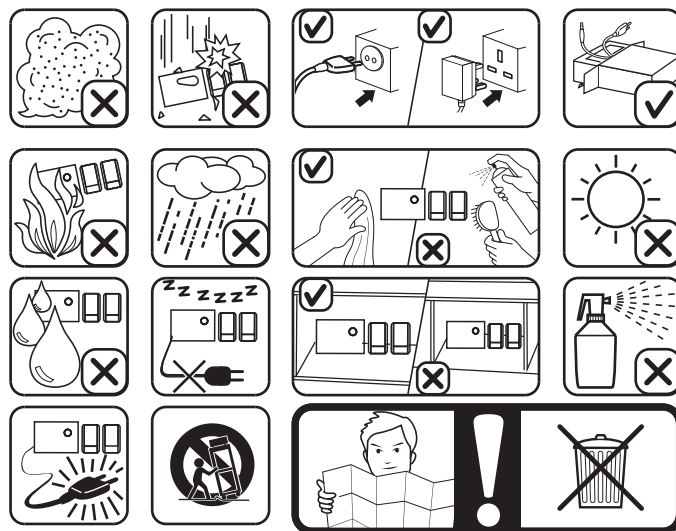

\*If the Remote Controller do not work, please change a new battery. Thank you!

NO.7

#### FCC Part 15.19 Warning Statement

THIS DEVICE COMPLIES WITH PART 15 OF THE FCC RULES. OPERATION IS SUBJECT TO THE FOLLOWING TWO CONDITIONS: (1) THIS DEVICE MAY NOT CAUSE HARMFUL INTERFERENCE, AND (2) THIS DEVICE MUST ACCEPT ANY INTERFERENCE RECEIVED, INCLUDING INTERFERENCE THAT MAY CAUSE UNDESIRE OPERATION.

#### FCC Part 15.21 Warning Statement

NOTE: THE GRANTEE IS NOT RESPONSIBLE FOR ANY CHANGES OR MODIFICATIONS NOT EXPRESSLY APPROVED BY THE PARTY RESPONSIBLE FOR COMPLIANCE. SUCH MODIFICATIONS COULD VOID THE USER'S AUTHORITY TO OPERATE THE EQUIPMENT.

#### FCC Part 15.105 Warning Statement

Note: This equipment has been tested and found to comply with the limits for a Class B digital device, pursuant to part 15 of the FCC Rules. These limits are designed to provide reasonable protection against harmful interference in a residential installation. This equipment generates, uses and can radiate radio frequency energy and, if not installed and used in accordance with the instructions, may cause harmful interference to radio communications. However, there is no guarantee that interference will not occur in a particular installation. If this equipment does cause harmful interference to radio or television reception, which can be determined by turning the equipment off and on, the user is encouraged to try to correct the interference by one or more of the following measures:

- Reorient or relocate the receiving antenna.
- Increase the separation between the equipment and receiver.
- Connect the equipment into an outlet on a circuit different from that to which the receiver is connected.
- Consult the dealer or an experienced radio/TV technician for help.

#### RF warning statement:

The device has been evaluated to meet general RF exposure requirement.

To maintain compliance with FCC's RF exposure guidelines, this equipment should be installed and operated with a minimum distance of 20cm between the radiator and your body.