

Technical Specification

Model:SP900-RS20

This is Class II apparatus

Input Voltage:120V,60Hz

Transmitter Power Supply: AAA x 6 or AC Adaptor120V-DC12V

Frequency of Transmitter : 49.86MHz

Speaker Power Supply: AA x 4 or AC Adaptor 120V-DC5V

Important Safety Instructions:

- 1) Pay attention to all the warnings that have been mentioned in this user-manual !
- 2) Do not use this apparatus near water.
- 3) Clean only with a dry cloth.
- 4) Do not block any ventilation openings.Install by referring to the manufacturer's instructions.
- 5) Do not install near heat sources such as radiatore,heat registers,stoves or other apparatus including amplifiers that produce heat.
- 6) Do not ignore the main purpose of a polarized or grounding-type plug. A polarized plug has two blades with one wider than the other.A grounding-type plug has two blades and a third grounding prong.The wider blade or the third prong are provided for your safety. If the provided plug does not fit into your outlet, consult an electrician for replacement of the obsolete outlet.
- 7) Do not walk on the power cord and do not pinch any plugs or convenience receptacles(including the point at which they exit from the apparatus.)
- 8) Only use attachments and accessories specified by the manufacturer.
- 9) Unplug the apparatus during thunder storms or when not in use for long periods of time.
- 10) Refer all servicing to qualified service personnel.Servicing is required when the apparatus has been damaged.The following are examples of when certain situations arise and it is necessary to contact a qualified personnel for servicing.
 - When the power-supply cord is damaged.
 - Liquid has been spilled onto the apparatus.
 - Objects have fallen into the apparatus.
 - The apparatus has been exposed to rain or moisture.
 - The apparatus has been dropped.

WARNING: To reduce the risk of fire or electric shock,do not expose the apparatus to rain or moisture.Also,batteries should not be exposed to excessive heat
The main plug is used as a disconnect device.The disconnect device will remain readily operable.

Limited One-year Warranty:Sentry warrants this product to be free from defects in materials and workmanship for one year from the date of original purchase.
This warranty does not pertain to damage resulting from accident,abnormal use, misuse or neglect.'Any defective product will be replaced if returned to an authorized Sentry dealer or to Sentry directly at :PO BOX 885,1 Bridge Street,Hillburn,

VISIT US ONLINE : WWW.SENTRYINDUSTRIES.COM

SENTRY

WIRELESS 2.1
SPEAKER SYSTEM

wireless

2.1 SPEAKER SYSTEM



MODEL:SP900-RS20

Congratulations on your purchase of Sentry's SP900 wireless speaker system ! Each unit has been meticulously designed and tested to provide you with years of dependable operation. Please review this manual carefully before operating your wireless speaker system and store it in a safe place for future reference.

Connecting the speaker

The speaker power supply with 4 x AA battery or AC Adaptor 120V-DC5V 1000mA.

- 1) Open the battery compartment on the back side of your speaker.
- 2) Insert four AA battery in the direction shown.

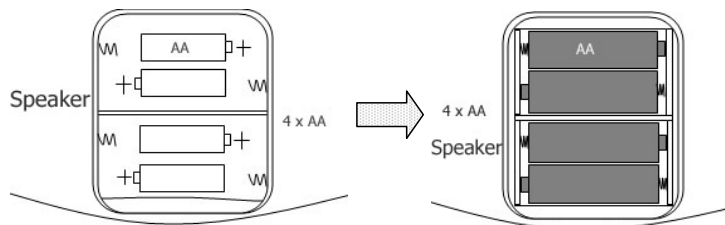

- 3) Replace the battery compartment cover.
- 4) Or use attached AC/DC adaptor insert to "DC 5V" at right side of speaker.
- 5) Press the power button "ON" with red cycle lighter on the top of speaker.

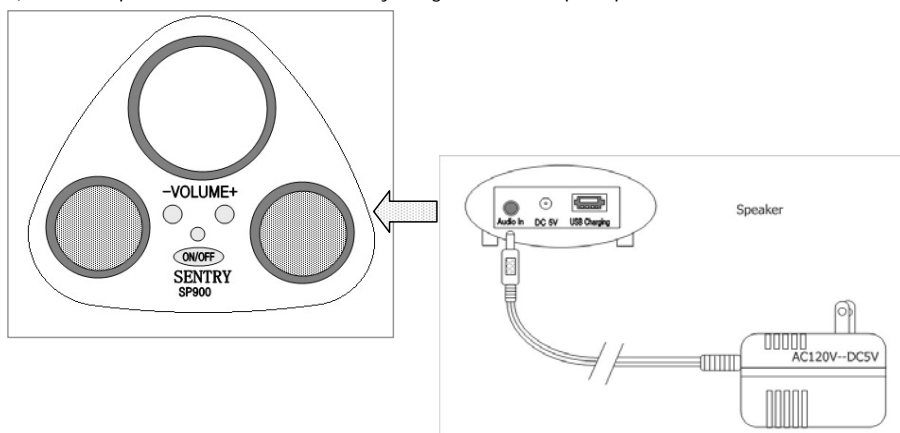

Connecting the transmitter

The transmitter power with 6 x AAA battery or AC Adaptor 120V-DC12V 500mA.

- 1) Open the battery compartment on the bottom of transmitter.
- 2) Insert six AAA battery in the direction shown.
- 3) Replace the battery compartment cover.
- 4) Or use attached AC/DC adaptor insert to "DC12V" at right side of transmitter.
- 5) Press the power button "ON" with red LED indicator on.

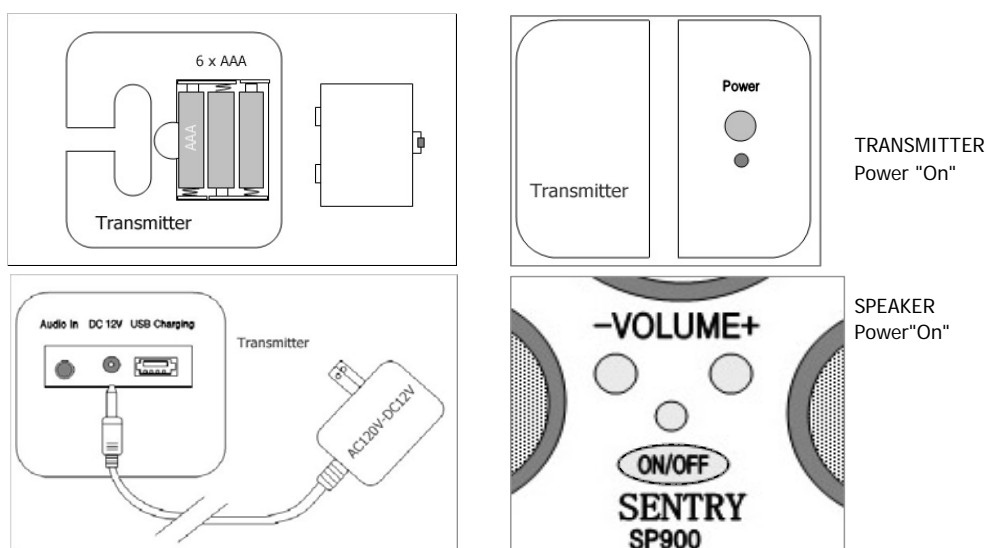

Playing music

You may connecting the any audio device,such as Ipod,MP3, CD...or TV,DVD player.
Connecting any audio source to speaker "Audio In" then you start enjoy the excellent sound with 2.1 channel stereo sound through build in subwoofer speaker.

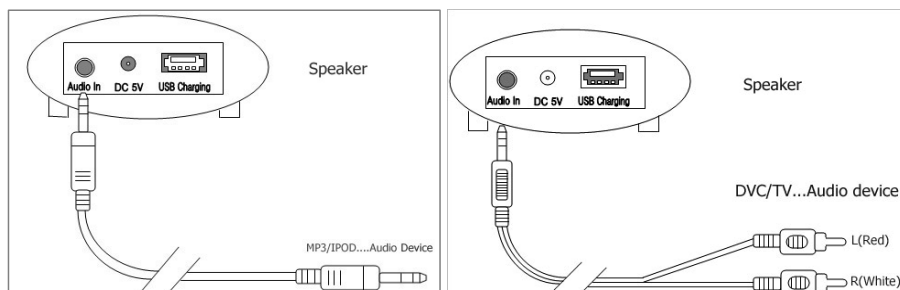

How to operating the wireless system ?

- 1) Connecting any audio source to transmitter "Audio In" jack on side with attached
- 2) Connecting from TV or DVD audio output(L,R) with attached RCA x 2-3.5mm stereo cable to transmitter "Audio In" jack.
- 3) Turn on the speaker then your audio is up to 100 feet,through walls and doors wirelessly !

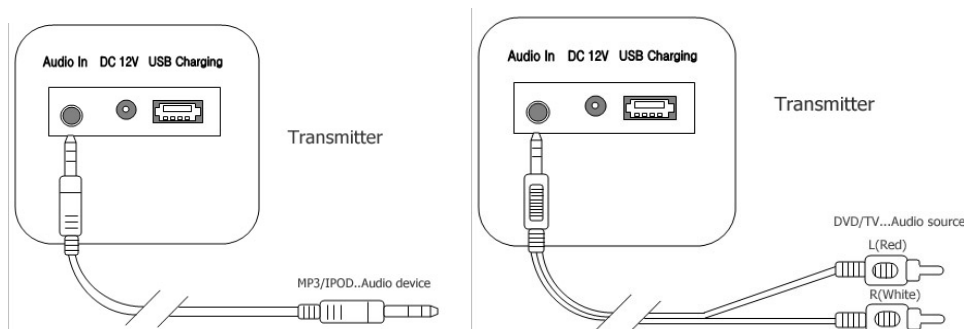

Warning:

This device complies with part 15 of the FCC Rules. Operation is subject to the following two conditions:

(1) This device may not cause harmful interference, and (2) this device must accept any interference received, including interference that may cause undesired operation.

Changes or modifications to this unit not expressly approved by the party responsible for compliance will void the user's authority to operate the equipment. Any change to the equipment will void FCC grant.

This equipment has been tested and found to comply with the limits for a Class B digital device, pursuant to part 15 of the FCC Rules. These limits are designed to provide reasonable protection against harmful interference in a residential installation. This equipment generates, uses and can radiate radio frequency energy and, if not installed and used in accordance with the instructions, may cause harmful interference to radio communications. However, there is no guarantee that interference will not occur in a particular installation. If this equipment does cause harmful interference to radio or television reception, which can be determined by turning the equipment off and on, the user is encouraged to try to correct the interference by one or more of the following measures:

- Reorient or relocate the receiving antenna.
- Increase the separation between the equipment and receiver.
- Connect the equipment into an outlet on a circuit different from that to which the receiver is connected.
- Consult the dealer or an experienced radio/TV technician for help.

The equipment complies with FCC radiation exposure limit set forth for uncontrolled Environment