

AUVIO™

THE PERFORMANCE YOU NEED™

FM Transmitter/Charger for iPod® or iPhone®

Please read this user's guide before using your new transmitter.

User's Guide

1200769



Package contents

- FM Transmitter
- User's Guide
- Quick Start

Features

- Charges your iPod or iPhone while wirelessly transmitting the music so you can listen to it through your vehicle's speakers.
- Auto-scan feature searches with the push of a button for a clear frequency to help eliminate interference.

IMPORTANT SAFETY INFORMATION

Connect and operate this product BEFORE operating your vehicle. Pay attention to the road. Attempting to drive and operate your transmitter at the same time can cause a serious traffic accident! Please drive responsibly.

Connect to your car's power outlet.

Press any button to turn the backlight on for ten seconds.

Connect to your iPod/iPhone.

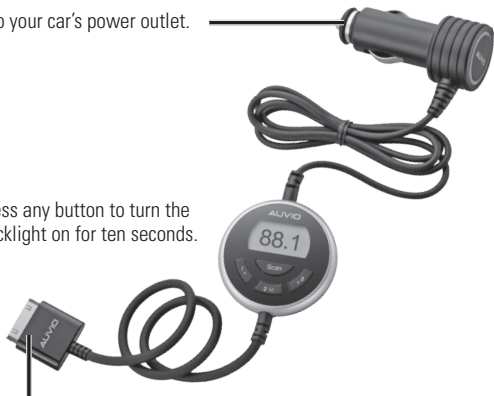

① Connect the Transmitter

1. Insert the transmitter's power plug into your car's power outlet. The backlight turns on and the transmitter displays the last used frequency.
2. Insert the 30-pin connector into your iPod with the arrow facing up. Your iPod will start charging.



Note: You may need to remove the protective case of the iPod/iPhone to fully connect the FM transmitter.

② Tune your Transmitter

Interference caused by your car's antenna, design, and physical location (such as under steel bridges and inside parking garages) can prevent the transmitter from detecting frequencies and limit sound quality. In these cases, you may need to select a saved frequency, autoscan for a clear frequency, or manually tune a frequency.

Auto-scanning for a Frequency

Hold down **Scan** until the display changes. Your FM transmitter starts searching for about 30 seconds automatically and stops at a clear frequency.

Manually Tuning a Frequency

1. Hold down **2M** until **M1**, **M2**, and **M3** all flash on the display.
2. Press, but do not hold down **1▲** or **3▼** to find the desired frequency.
3. Wait until the display stops flashing.

Saving Frequencies

To save the displayed frequency:

1. Hold down **2M** until **M1**, **M2**, and **M3** all flash on the display.

2. Hold down **1▲**, **2M**, or **3▼** for two seconds to save the displayed frequency to **M1**, **M2**, or **M3** respectively.

Selecting a Saved Frequency

Press **1▲**, **2M** or **3▼** to select a saved frequency. The display shows **M1**, **M2**, or **M3** and its corresponding frequency.

③ Tune your radio

Tune your car's FM radio to the frequency displayed on the transmitter.

④ Listen to music

Use your iPod's controls to listen to music. If the sound is distorted, you can tune your transmitter and radio to a new frequency.

RBDS Transmission

RBDS protocol transmits both audio and track information from your iPod/iPhone to your radio receiver. If your radio is RBDS capable, "**AUVIO**" appears in the Program Service Name area and the currently playing music title is shown in the Radio Text area.



Note: Actual operation to view display text may vary according to individual radio receivers. Please refer to the user's guide of your receiver for details.

Use with iPhone Application

If you are using the transmitter with iPod Touch or the iPhone with OS3.0 or above, you can download FM Navi from Apple App Store. This application allows you to control all functions of the transmitter through your iPod Touch/iPhone screen. Your saved channels will upload to the application automatically, and all your application settings are stored in the transmitter in turn.

Download FM Navi

Download FM Navi from Apple App store then follow the on-screen instruction to install. (Refer to the iPhone/iPod instructions for more details.)

Use FM Navi





1. Plug the FM transmitter into your iPod/iPhone.
2. Choose a song to play and start playback. The transmitter turns on.
3. Return to your iPhone/iPod's home screen. Find and tap the FM Navi icon to run the application.



 **Note:** After the transmitter is plugged in, run the FM Navi application or start music playback to turn on the transmitter. If FM Navi is not running, the transmitter turns off 2 minutes after music is paused or stopped.

After your music playlist is created in iPhone/iPod application, FM Navi allows you to control music playback and FM transmission in the same screen.

Music Controls

-  - Tap repeatedly to select repeat all tracks, current track or turn off repeat.
-  - Tap to start and pause playback.
-  - Tap to skip to previous song or touch and hold to fast backwards.
-  - Tap skip to next song or touch and hold to fast forward.
-  - Tap repeatedly to shuffle all tracks or turn off shuffle.

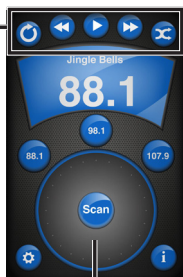

Control your Transmitter

Tune Frequency

- Tune Up : Touch and rotate the wheel clockwise.

- Tune Down: Touch and rotate the wheel anticlockwise.

Store Channel Frequency



- Touch and hold the frequency shown on the FM Navi display until a white cursor appears, then drag it to the desired memory location to save the current frequency.



Select a Stored Channel Frequency

- Tap any of the 3 memory buttons to select frequency. The selected memory is enlarged.

Change Background Color

1. Tap the  icon to show available background colors.
2. Tap the desired color.
3. Tap  to close.

More Information

- Tap the  icon for help.



Note: Update your iPod or iPhone to the latest firmware version for the best use of this FM transmitter.

Specifications

Audio input 30-pin iPod connector

Transmitting frequency 88.1–107.9 MHz with 0.2 MHz step

Modulation..... FM stereo, RBDS

Specifications are subject to change and improvement without notice. Actual product may vary from the images found in this document.

RoHS
COMPLIANT

Complies with the European Union's "Restriction of Hazardous Substances Directive," which protects the environment by restricting specific hazardous materials and products.

FCC Information

This equipment has been tested and found to comply with the limits for a Class B digital device, pursuant to Part 15 of the FCC Rules. These limits are designed to provide reasonable protection against harmful interference in a residential installation. This equipment generates, uses and can radiate radio frequency energy and, if not installed and used in accordance with the instructions, may cause harmful interference to radio communications. However, there is no guarantee that interference will not occur in a particular installation. If this equipment does cause harmful interference to radio or television reception, which can be determined by turning the equipment off and on, the user is encouraged to try to correct the interference by one or more of the following measures:

- Reorient or relocate the receiving antenna.
- Increase the separation between the equipment and receiver.
- Connect the equipment into an outlet on a circuit different from that to which the receiver is connected.
- Consult the dealer or an experienced radio/TV technician for help.

Changes or modifications not expressly approved by Ignition L.P. may cause interference and void the user's authority to operate the equipment.

This device complies with Part 15 of the FCC Rules. Operation is subject to the following two conditions: (1) This device may not cause harmful interference, and (2) this device must accept any interference received, including interference that may cause undesired operation.

Limited Warranty

Ignition L.P. warrants this product against defects in materials and workmanship under normal use by the original purchaser for **ninety (90) days** after the date of purchase. IGNITION L.P. MAKES NO OTHER EXPRESS WARRANTIES.

This warranty does not cover: (a) damage or failure caused by or attributable to abuse, misuse, failure to follow instructions, improper installation or maintenance, alteration, accident, Acts of God (such as floods or lightning), or excess voltage or current; (b) improper or incorrectly performed repairs by persons who are not a Ignition L.P. Authorized Service Facility; (c) consumables such as fuses or batteries; (d) ordinary wear and tear or cosmetic damage; (e) transportation, shipping or insurance costs; (f) costs of product removal, installation, set-up service, adjustment or reinstallation; and (g) claims by persons other than the original purchaser.

Should a problem occur that is covered by this warranty, take the product and the sales receipt as proof of purchase date to the place of purchase. Ignition L.P. will, at its option, unless otherwise provided by law: (a) repair the product without charge for parts and labor; (b) replace the product with the same or a comparable product; or (c) refund the purchase price. All replaced parts and products, and products on which a refund is made, become the property of Ignition L.P. New or reconditioned parts and products may be used in the performance of warranty service. Repaired or replaced parts and products are warranted for the remainder of the original warranty period. You will be charged for repair or replacement of the product made after the expiration of the warranty period.

IGNITION L.P. EXPRESSLY DISCLAIMS ALL WARRANTIES AND CONDITIONS NOT STATED IN THIS LIMITED WARRANTY. ANY IMPLIED WARRANTIES THAT MAY BE IMPOSED BY LAW, INCLUDING THE IMPLIED WARRANTY OF MERCHANTABILITY AND, IF APPLICABLE, THE IMPLIED WARRANTY OF FITNESS FOR A PARTICULAR PURPOSE, SHALL EXPIRE ON THE EXPIRATION OF THE STATED WARRANTY PERIOD.

EXCEPT AS DESCRIBED ABOVE, IGNITION L.P. SHALL HAVE NO LIABILITY OR RESPONSIBILITY TO THE PURCHASER OF THE PRODUCT OR ANY OTHER PERSON OR ENTITY WITH RESPECT TO ANY LIABILITY, LOSS OR DAMAGE CAUSED DIRECTLY OR INDIRECTLY BY USE OR PERFORMANCE OF THE PRODUCT OR ARISING OUT OF ANY BREACH OF THIS WARRANTY, INCLUDING, BUT NOT LIMITED TO, ANY DAMAGES RESULTING FROM INCONVENIENCE AND ANY LOSS OF TIME, DATA, PROPERTY, REVENUE, OR PROFIT AND ANY INDIRECT, SPECIAL, INCIDENTAL, OR CONSEQUENTIAL DAMAGES, EVEN IF IGNITION L.P. HAS BEEN ADVISED OF THE POSSIBILITY OF SUCH DAMAGES.

Some States do not allow limitations on how long an implied warranty lasts or the exclusion or limitation of incidental or consequential damages, so the above limitations or exclusions may not apply to you. This warranty gives you specific legal rights, and you may also have other rights which vary from State to State. You may contact Ignition L.P. at: Ignition L.P., 3102 Maple Ave. Suite 450, Dallas, TX 75201 02/09

For product support, call **1-866-315-0426**

“Made for iPod” and “Made for iPhone” mean that an electrical accessory has been designed to connect specifically to iPod or iPhone, respectively, and has been certified by the developer to meet Apple performance standards. Apple is not responsible for the operation of this device or its compliance with safety and regulatory standards. iPod, iPhone and iTunes are trademarks of Apple Inc., registered in the U.S. and other countries.



Protect the environment by recycling used electronics. Go to E-CyclingCentral.com to find an electronic recycling center near you.

Get more from your audio and video equipment. See what you've been missing. With Auvio, **you control the experience.**

Auvio was established by a group of technophiles to provide **high quality audio and video products** without the high sticker price. The Auvio philosophy is for you to experience audio and video as it was intended to be: **pure and distortion free.**

We know electronics can be intimidating. Auvio **simplifies your experience** by providing the right products, with the right specs, to work with your equipment.

Be confident about your purchase: your new Auvio product incorporates the **latest technology**, is built to the **highest quality** standards, and **reduces environmental impact** by complying with RoHS environmental restrictions.