



Portable Digital Wireless Stereo Headphones

Please read this user's guide before using your new headphones.

User's Guide

33-283



Package contents

- Headphones
- Transmitter
- AC Adapter
- Charging Hub
- Carrying Pouch
- User's Guide
- Quick Start

Features

- Up to 30-foot (9.14m) wireless range (based on line-of-sight operation)
- Padded earcups and adjustable headband for comfort
- Charging hub charges the transmitter's built-in battery, as well as the headphones if rechargeable batteries (not included) are used

1 Install batteries

- Slide the battery compartment cover on the left ear cup in the direction of the arrow and open it.
- Insert two AAA alkaline or NiMH rechargeable batteries (neither included), matching the polarity symbols (+ and -) marked.
- Use a small tool to switch **ALK/RCH** to **ALK** for alkaline or **RCH** for rechargeable batteries.
- Replace the cover.

Warning: Never install alkaline batteries with the **ALK/RCH** switch set to **RCH**. Alkaline batteries can get hot or explode if you try to recharge them.

2

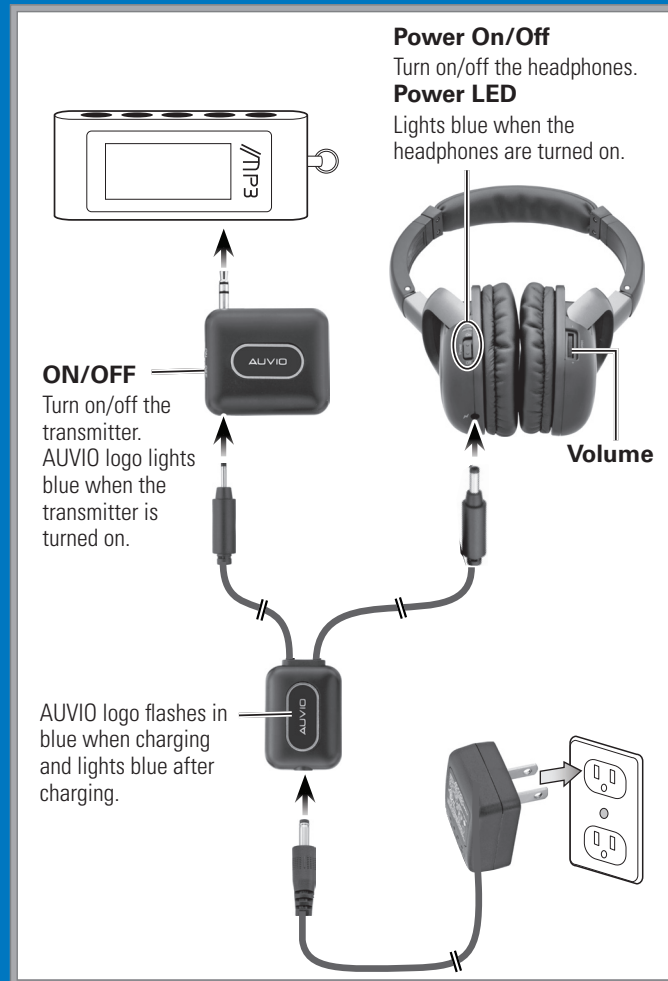

3

2 Charge

- Connect the AC adapter plug into your charging hub's **DC 5.0V** jack.
- Connect the charging hub's larger plug to your headphones' **⚡** jack. Make sure rechargeable batteries are installed and **ALK/RCH** is set to **RCH**.
- Connect the charging hub's smaller plug to your transmitter's **⚡** jack.
- Connect the AC adapter to a standard power outlet. **AUVIO** logo on the charging hub flashes blue when charging and lights blue after charging.

Notes:

- Charge the built-in battery for at least 2 hours before the first time.
- Music does not play while charging.
- Charge your transmitter when the **AUVIO** logo does not light.



Recycle your old rechargeable batteries at one of the many collection sites in the U.S. and Canada. To find the site nearest you, visit www.call2recycle.org or call toll-free 1-877-2-RECYCLE.

4

3 Use your headphones

- Connect the transmitter to the 3.5mm headphones jack on your audio device.
- Turn on the transmitter. **AUVIO** logo lights blue.
- Turn on the headphones. The power LED lights blue.
- Set the headphone volume to minimum.
- Turn on the audio source, and gradually increase the volume to a comfortable level.

Notes:

- Remove objects between the transmitter and headphones.
- To preserve battery life, be sure to turn off the headphones and transmitter when you are not using them.

Handling and Disposal:

- Do not burn or bury batteries. Do not puncture or crush. Do not disassemble.
- Recycle lithium batteries. Do not dispose of in the trash.
- Never allow loose cells to short circuit against battery tabs or other conductive items. Keep loose cells and battery packs out of reach of children.
- If the electrolyte in the cells should get on your skin, thoroughly wash with soap and water. If in the eyes, rinse thoroughly with cool water. Immediately seek medical attention.

Charging

- Use only the supplied charging hub for the transmitter built-in lithium battery charging. Be sure the charging hub is powered by the provided AC adapter.
- Charge batteries on a fireproof surface away from flammable items or liquids.
- Do not charge inside an automobile, especially while driving.

5

- Follow the manufacturer's instructions for charging the product and do not charge longer than recommended. Unplug the charger when the battery is charged.

Listening Safely

- Set the headphone volume to the lowest setting before listening. After you begin listening, adjust the volume to a comfortable level.
- Do not listen at extremely high volume levels. Extended high-volume listening can lead to permanent hearing loss.
- If you connect the transmitter to an audio source headphone jack, set the audio source's volume to the middle position. Then adjust **VOLUME** on the headphones to the desired level.
- Turn off the headphones before turning off the transmitter. This prevents you hearing a loud click that may be generated when you turn off the transmitter.

Specifications

Operating Frequency	2.4GHz
Headphones Playtime	about 5 hours
Frequency Response (6dB)	80Hz – 20KHz
Audio S/N	70dB
Audio Resolution	16 bit
Audio Sample Rate	44.1KHz

Specifications are subject to change and improvement without notice. Actual product may vary from the product images in this document.

FCC Information

This equipment has been tested and found to comply with the limits for a Class B digital device, pursuant to Part 15 of the FCC Rules. These limits are designed to provide reasonable protection against harmful interference in a residential installation. This equipment generates, uses and can radiate radio frequency energy and, if not installed and used in accordance with the instructions, may cause harmful interference to radio communications. However, there is no guarantee that interference will not occur in a particular installation. If this equipment does cause harmful interference to radio or television reception, which can be determined by turning the equipment off and on, the user is encouraged to try to correct the interference by one or more of the following measures:

- Reorient or relocate the receiving antenna.
- Increase the separation between the equipment and receiver.
- Connect the equipment into an outlet on a circuit different from that to which the receiver is connected.

6

Consult the dealer or an experienced radio/TV technician for help. Changes or modifications not expressly approved by Ignition L.P. may cause interference and void the user's authority to operate the equipment. This device complies with part 15 of the FCC Rules. Operation is subject to the following two conditions: (1) This device may not cause harmful interference, and (2) this device must accept any interference received, including interference that may cause undesired operation.

Limited Warranty

Ignition L.P. warrants this product against defects in materials and workmanship under normal use by the original purchaser for **one (1) year** after the date of purchase. IGNITION L.P. MAKES NO OTHER EXPRESS WARRANTIES. This warranty does not cover: (a) damage or failure caused by or attributable to abuse, misuse, failure to follow instructions, improper installation or maintenance, alteration, accident, Acts of God (such as floods or lightning), or excess voltage or current; (b) improper or incorrectly performed repairs by persons who are not a Ignition L.P. Authorized Service Facility; (c) consumables such as fuses or batteries; (d) ordinary wear and tear or cosmetic damage; (e) transportation, shipping or insurance costs; (f) costs of product removal, installation, set-up service, adjustment or reinstallation; and (g) claims by persons other than the original purchaser. Should a problem occur that is covered by this warranty, take the product and the sales receipt as proof of purchase date to the place of purchase. Ignition L.P. will, at its option, unless otherwise provided by law: (a) repair the product without charge for parts and labor; (b) replace the product with the same or a comparable product; or (c) refund the purchase price. All replaced parts and products, and products on which a refund is made, become the property of Ignition L.P. New or reconditioned parts and products may be used in the performance of warranty service. Repaired or replaced parts and products are warranted for the remainder of the original warranty period. You will be charged for repair or replacement of the product made after the expiration of the warranty period. IGNITION L.P. EXPRESSLY DISCLAIMS ALL WARRANTIES AND CONDITIONS NOT STATED IN THIS LIMITED WARRANTY. ANY IMPLIED WARRANTIES THAT MAY BE IMPOSED BY LAW, INCLUDING THE IMPLIED WARRANTY OF MERCHANTABILITY AND, IF APPLICABLE, THE IMPLIED WARRANTY OF FITNESS FOR A PARTICULAR PURPOSE, SHALL EXPIRE ON THE EXPIRATION OF THE STATED WARRANTY PERIOD. EXCEPT AS DESCRIBED ABOVE, IGNITION L.P. SHALL HAVE NO LIABILITY OR RESPONSIBILITY TO THE PURCHASER OF THE PRODUCT OR ANY OTHER PERSON OR ENTITY WITH RESPECT TO ANY LIABILITY, LOSS OR DAMAGE CAUSED DIRECTLY OR INDIRECTLY BY USE OR PERFORMANCE OF THE PRODUCT OR ARISING OUT OF ANY BREACH OF THIS WARRANTY, INCLUDING, BUT NOT LIMITED TO, ANY DAMAGES RESULTING FROM INCONVENIENCE AND ANY LOSS OF TIME, DATA, PROPERTY, REVENUE, OR PROFIT AND ANY INDIRECT, SPECIAL, INCIDENTAL, OR CONSEQUENTIAL DAMAGES, EVEN IF IGNITION L.P. HAS BEEN ADVISED OF THE POSSIBILITY OF SUCH DAMAGES. Some States do not allow limitations on how long an implied warranty lasts or the exclusion or limitation of incidental or consequential damages, so the above limitations or exclusions may not apply to you. This warranty gives you specific legal rights, and you may also have other rights which vary from State to State. You may contact Ignition L.P. at: Ignition L.P., 3102 Maple Ave. Suite 450, Dallas, TX 75201 02/09

For product support, call
1-866-315-0426

7

Protect the environment by recycling used electronics. Go to E-CyclingCentral.com to find an electronic recycling center near you.

Get more from your audio and video equipment. See what you've been missing. With Auvio, **you control the experience**. Auvio was established by a group of technophiles to provide **high quality audio and video products** without the high sticker price. The Auvio philosophy is for you to experience audio and video as it was intended to be: **pure and distortion free**. We know electronics can be intimidating. Auvio **simplifies your experience** by providing the right products, with the right specs, to work with your equipment. **Be confident** about your purchase: your new Auvio product incorporates the **latest technology**, is built to the **highest quality** standards, and **reduces environmental impact** by complying with RoHS environmental restrictions.

© 2009. Ignition L.P. All rights reserved. Auvio is a trademark used by Ignition L.P.

Printed in China 12A09
AO0422AAA1 33-283