

# AUVIO™

THE PERFORMANCE YOU NEED

## Wireless Amplified Stereo Speakers

*Please read this user's guide before using your new speakers*



User's Guide

40-268

# Contents

Package Contents.....	4
Features .....	5
Setup.....	5
1. Select a location .....	5
2. Attach rubber feet to speakers.....	6
3. Power the system .....	6
4. Connect to an audio source.....	8
5. Stereo/Mono Setup .....	10
6. Select Channel .....	11
7. Mount the Speakers.....	12
Basic Operation.....	13
Turn On.....	13
Additional Information .....	14
Listening Safety .....	14

Care.....	14
Troubleshooting.....	15
Specifications.....	16
FCC Information.....	17
Limited Warranty.....	18

## Package contents



Speaker



Transmitter



RCA jack to 3.5mm Plug  
(Y-Adapter)



AC Adapter for Speakers (2)



AC Adapter for Transmitter



3.5mm to 6.3mm adapter



Stereo audio cable



Rubber feet (8)

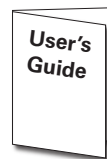

## Features

- Ideal for use as rear-channel speakers in your surround-sound home theater.
- Enables you to listen to your stereo in any room of your home.
- True stereo sound, with individual bass and treble controls.

## Setup

### ① Select a location

In order to achieve the best performance:

- Position the transmitter as far as possible from other electronic devices such as TVs, receivers, or DVD players. Radio interference from these devices could affect your system's performance.
- Position the transmitter away from large metal objects, as these could block the transmitter's signals.
- Try several locations for the transmitter and select the location that provides the best performance.

## ② Attach rubber feet to speakers

Remove the backing on the bottom of the rubber feet and attach them to the four corners on the bottom of each speaker.



## ③ Power the system

Connect the supplied AC power adapters into the DC 12V jacks on the transmitter and speakers, then plug the adapters into standard AC outlets.

**Transmitter** 12V, 250mA  
AC Adapter



**Speakers** 12V, 1250mA  
AC Adapter

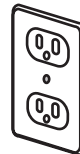

 **Note:** Use the adapter labeled "12V 250 mA" for the transmitter, and the one marked "12V, 1250 mA" for the speakers.

You also can use 16 (8 for each speaker) D size batteries (not supplied) to power the speakers.

**To install the batteries:**

1. Remove the battery cover.
2. Insert 8 batteries for each speaker with correct polarities.
3. Replace the cover when finished.

**⚠ Caution:**

*You must use a Class 2 power source that supplies 12 volts DC and delivers at least 250mA or 1250mA. Its center tip must be set to positive and its plug must fit the transmitter's DC 12V jack. The supplied adapter meets these specifications. Using an adapter that does not meet these specifications will damage the transmitter or the adapter.*

*Always connect the AC adapter to the transmitter before you connect it to AC power. When you finish, disconnect the adapter from AC power before you disconnect it from the transmitter.*

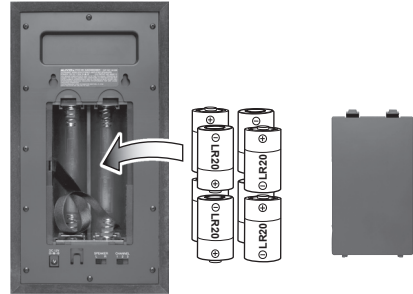



### **Battery Notes**

- *Using the AC adapter overrides any installed batteries.*
- *When the speakers **POWER LED** blinks, replace the batteries.*
- *Do not burn or bury batteries. Do not puncture or crush. Do not disassemble.*
- *Use only fresh batteries of the required size and recommended type.*
- *Do not use batteries of different types, capacities, or chemistry.*
- *Remove the batteries if you do not plan to use the product for an extended time.*
- *If the electrolyte in the cells gets on your skin, thoroughly wash with soap and water. If in the eyes, rinse thoroughly with cool water. Immediately seek medical attention.*

## **④ Connect transmitter to an audio source**

Connect the transmitter to your audio source's left and right audio output jacks or to its headphone jack.



1. Connect one end of the supplied audio cable to the transmitter's audio jacks (white plug to **L AUDIO IN** and red plug to **R AUDIO IN**).
2. **Connect to your audio source's output jacks:**  
Connect the white and red plugs at the other end of the cable into the corresponding left (white) and right (red) audio jacks on your audio source.

**Connect to your audio source's stereo headphone jack:**

Connect the audio cable's white and red plugs to the white and red jacks on the stereo side of the  $\frac{1}{8}$ -inch (3.5mm) supplied adapter.

**If your audio source has a  $\frac{1}{8}$ -inch (3.5mm) headphone jack:**

Insert the adapter's  $\frac{1}{8}$ -inch (3.5mm) stereo plug into the headphone jack.

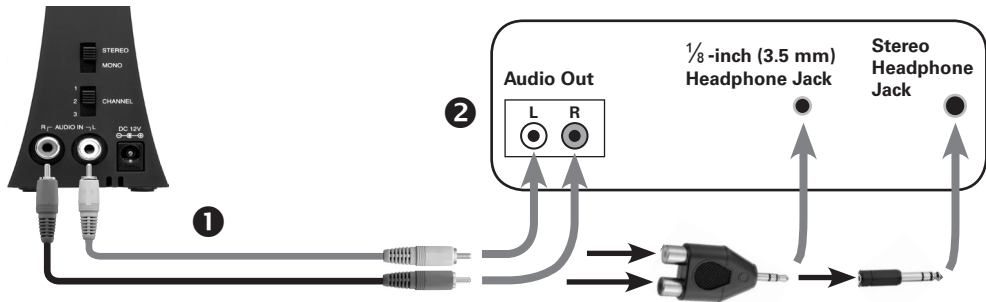

**⚠ Caution:**

- Do not connect the transmitter to your audio source's speaker output. It could damage the transmitter and the audio source.
- If you connected the transmitter to an audio source's headphone jack, set the audio source's volume control to its middle position.

**⑤ Stereo/mono setup**

For normal stereo use, set **STEREO/MONO** on the back of the transmitter to **STEREO**. If you are using a monaural system, set **STEREO/MONO** to **MONO**.

**If you select STEREO:**

Set **SPEAKER** on the back of each speaker to either **L** (for the Left stereo speaker) or **R** (for the Right stereo speaker).

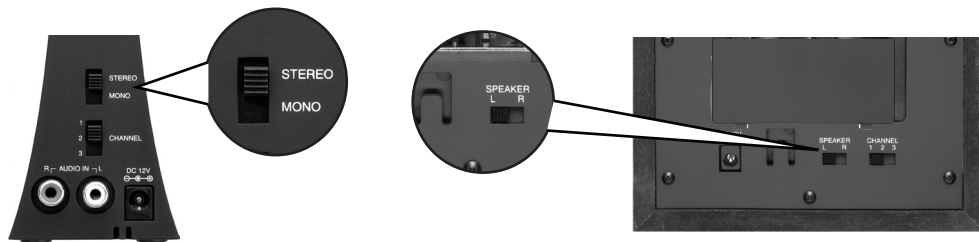

## ⑥ Select channel

1. Set the transmitter to a frequency channel (**CHANNEL 1, 2, or 3**) that has no interference.
2. Set the speaker to the same channels as the transmitter.

 **Note:** If you receive interference, try changing the channel number on the transmitter and the speakers.

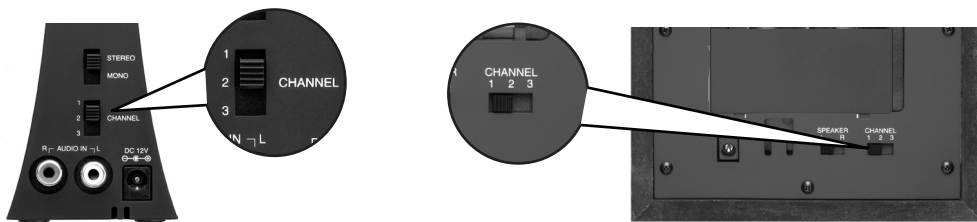

## ⑦ Mount the speakers

To mount a speaker on the wall, you need two screws (not supplied) with a head that fits into the keyhole slot on the back of the speaker.

1. Select a location and drill a hole to fit your screws.
2. Thread each screw into the hole until the screw's head extends about  $\frac{3}{5}$  inch (15mm) from the wall.
3. Align the keyhole on the speaker with the screw head in the wall, then slide the speaker down gently to secure it.

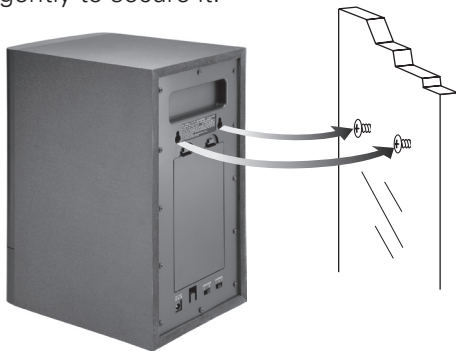

# Basic Operation

## Turn on

1. Turn on your audio source.

The transmitter has a built-in automatic **ON/OFF** controller. When the AC adapter is plugged in and the transmitter receives audio signals from the audio source, the transmitter's power LED lights blue. The transmission stops if the transmitter does not receive audio signals from the audio source for about one minute. The transmitter's power LED turns off.

2. Rotate **VOLUME** to **ON** to turn on your speakers. The power indicator lights blue.
3. Adjust **TREBLE** and **BASS** on each speaker between **-** (minimum) to **+** (maximum) to a desired level.
4. To turn off each speaker, rotate **VOLUME** to **OFF**. The power indicator turns off.



## Additional Information

### Listening Safety

To protect your hearing, follow these guidelines when you use the speaker system.

- Set the volume to the lowest setting before you begin listening. After you begin listening, adjust the volume to a comfortable level.
- Do not listen at extremely high volume levels. Extended high-volume listening can lead to permanent hearing loss.
- Once you set the volume, do not increase it. Over time, your ears adapt to the volume level, so a volume level that does not cause discomfort might still damage your hearing.

### Care

- Keep the system dry; if it gets wet, wipe it dry immediately.
- Use and store the system only in normal temperature environments.
- Handle the system carefully; do not drop it.

- Keep the system away from dust and dirt, and wipe it with a damp cloth occasionally to keep it looking new.

 **Caution:** *You might permanently damage your speakers by cleaning them with a vacuum cleaner. Use a feather duster or a soft cloth instead.*

## Troubleshooting

We do not expect you to have problems with your speaker system; however, if you do have problems, try these troubleshooting tips.

Problem	Solution
<b>No sound</b>	<ul style="list-style-type: none"><li>■ Make sure the speakers are turned on.</li><li>■ Replace the speakers' batteries and/or make sure the AC adapters are plugged in and have power.</li><li>■ Make sure all audio cables are securely connected.</li><li>■ Make sure the audio source is turned on and turned to an active channel.</li><li>■ Speakers and transmitter should be set to the same frequency channel (1–3).</li><li>■ Adjust the speakers' volume control.</li></ul>

**Audio is distorted**

- Be sure the speakers and transmitter are set to the same channel.
- If the transmitter is connected to an audio source's headphone jack, reduce the audio source's volume.
- Change the position of the transmitter.
- The speakers are placed beyond the transmitter's effective range (approximately 300 feet). Move the speakers closer to the transmitter.
- Other 900 MHz transmissions are being picked up by the speaker's receiver (possibly from a 900 MHz cordless telephone). Change the transmitter's and the speaker's frequency channel.
- The speaker's batteries are low. Replace the batteries.

## Specifications

**Transmitter**

Carrier Frequency .....	910.7–919.2 MHz
Power Source .....	unregulated 12V DC, center tip set to positive (+), 250 mA
Modulation Method .....	FM modulation
Frequency Response .....	50 Hz–20 kHz (6 dB)
Approximate Measurement (HWD) .....	4½ × 4 × 4 inches (116 × 106.2 × 107.2 mm)



## Speaker

Sensitivity .....	<2 $\mu$ V (with 20 dB S/N)
S/N Ratio (@-50 dBm) .....	$\geq$ 70 dB (A weight)
Audio Distortion .....	<2%
Max. Audio output .....	$\geq$ 10W
Approximate Measurement (HWD) .....	11 × 6 × 7½ in (280 × 150 × 195 mm)
Power Source .....	2 regulated AC adapters (AC 120/60Hz; DC 12V 1250mA) or DC 8 x D Size 1.5V alkaline batteries (not supplied)

Specifications are subject to change and improvement without notice. Actual product may vary from the images found in this document.

## FCC Information

This equipment has been tested and found to comply with the limits for a Class B digital device, pursuant to Part 15 of the FCC Rules. These limits are designed to provide reasonable protection against harmful interference in a residential installation. This equipment generates, uses and can radiate radio frequency energy and, if not installed and used in accordance with the instructions, may cause harmful interference to radio communications. However, there is no guarantee that interference will not occur in a particular installation. If this equipment does cause harmful interference to radio or television reception, which can be determined by turning the equipment off and on, the user is encouraged to try to correct the interference by one or more of the following measures:

- Reorient or relocate the receiving antenna.
- Increase the separation between the equipment and receiver.

- Connect the equipment into an outlet on a circuit different from that to which the receiver is connected.
- Consult the dealer or an experienced radio/TV technician for help.

Changes or modifications not expressly approved by Ignition L.P. may cause interference and void the user's authority to operate the equipment.

This device complies with part 15 of the FCC Rules. Operation is subject to the following two conditions:

(1) This device may not cause harmful interference, and (2) this device must accept any interference received, including interference that may cause undesired operation

## Limited Warranty

Ignition L.P. warrants this product against defects in materials and workmanship under normal use by the original purchaser for **one (1) year** after the date of purchase. IGNITION L.P. MAKES NO OTHER EXPRESS WARRANTIES.

This warranty does not cover: (a) damage or failure caused by or attributable to abuse, misuse, failure to follow instructions, improper installation or maintenance, alteration, accident, Acts of God (such as floods or lightning), or excess voltage or current; (b) improper or incorrectly performed repairs by persons who are not a Ignition L.P. Authorized Service Facility; (c) consumables such as fuses or batteries; (d) ordinary wear and tear or cosmetic damage; (e) transportation, shipping or insurance costs; (f) costs of product removal, installation, set-up service, adjustment or reinstallation; and (g) claims by persons other than the original purchaser.

Should a problem occur that is covered by this warranty, take the product and the sales receipt as proof of purchase date to the place of purchase in the U.S. Ignition L.P. will, at its option, unless otherwise provided by law: (a) repair the product without charge for parts and labor; (b) replace the product with the same or a comparable product; or (c) refund the purchase price. All replaced parts and products, and products on which a refund is made, become the property of Ignition L.P. New or reconditioned parts and products may be used in the performance of warranty service. Repaired or replaced parts and products

are warranted for the remainder of the original warranty period. You will be charged for repair or replacement of the product made after the expiration of the warranty period.

IGNITION L.P. EXPRESSLY DISCLAIMS ALL WARRANTIES AND CONDITIONS NOT STATED IN THIS LIMITED WARRANTY. ANY IMPLIED WARRANTIES THAT MAY BE IMPOSED BY LAW, INCLUDING THE IMPLIED WARRANTY OF MERCHANTABILITY AND, IF APPLICABLE, THE IMPLIED WARRANTY OF FITNESS FOR A PARTICULAR PURPOSE, SHALL EXPIRE ON THE EXPIRATION OF THE STATED WARRANTY PERIOD.

EXCEPT AS DESCRIBED ABOVE, IGNITION L.P. SHALL HAVE NO LIABILITY OR RESPONSIBILITY TO THE PURCHASER OF THE PRODUCT OR ANY OTHER PERSON OR ENTITY WITH RESPECT TO ANY LIABILITY, LOSS OR DAMAGE CAUSED DIRECTLY OR INDIRECTLY BY USE OR PERFORMANCE OF THE PRODUCT OR ARISING OUT OF ANY BREACH OF THIS WARRANTY, INCLUDING, BUT NOT LIMITED TO, ANY DAMAGES RESULTING FROM INCONVENIENCE AND ANY LOSS OF TIME, DATA, PROPERTY, REVENUE, OR PROFIT AND ANY INDIRECT, SPECIAL, INCIDENTAL, OR CONSEQUENTIAL DAMAGES, EVEN IF IGNITION L.P. HAS BEEN ADVISED OF THE POSSIBILITY OF SUCH DAMAGES.

Some States do not allow limitations on how long an implied warranty lasts or the exclusion or limitation of incidental or consequential damages, so the above limitations or exclusions may not apply to you.

This warranty gives you specific legal rights, and you may also have other rights which vary from State to State. You may contact Ignition L.P. at:

Ignition L.P., 3102 Maple Ave Suite 450, Dallas, TX 75201

02/09

For product support, call **1-866-315-0426**



Protect the environment by recycling used electronics. Go to [E-CyclingCentral.com](http://E-CyclingCentral.com) to find an electronic recycling center near you.

**Get more** from your audio and video equipment. See what you've been missing. With Auvio, **you control the experience.**

Auvio was established by a group of technophiles to provide **high quality audio and video products** without the high sticker price. The Auvio philosophy is for you to experience audio and video as it was intended to be: **pure and distortion free.**

We know electronics can be intimidating. Auvio **simplifies your experience** by providing the right products, with the right specs, to work with your equipment.

**Be confident** about your purchase: your new Auvio product incorporates the **latest technology**, is built to the **highest quality** standards, and **reduces environmental impact** by complying with RoHS environmental restrictions.

© 2009. Ignition L.P. All rights reserved. Auvio is a trademark used by Ignition L.P.  
Package and user's guide are recyclable. User's guide contains recycled material.

06A09  
40-268  
AO0367AAA1  
Printed in China