

Attacker

60-4329

OWNER'S MANUAL — Please read before using this equipment.

! IMPORTANT !

If an icon appears at the end of a paragraph, go to the box on that page with the corresponding icon for pertinent information.

- | | |
|-------------|---------------|
| ⚠ — Warning | ! — Important |
| ⚡ — Caution | 💡 — Hint |
| 📄 — Note | |

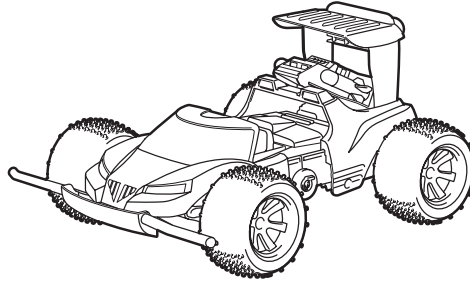

Thank you for purchasing the RadioShack Attacker. It will fool all your friends as it transforms from a monster truck into a high-profile race car and back at the touch of a button! The Attacker comes in two frequencies, 27 MHz and 49 MHz, so you can race with your friends. Check the box for the frequency listing. 💡

💡 HINTS 💡

- Running your car for long periods generates high heat levels. Heat causes wear and tear on the motor. To keep heat levels down, when your Attacker's battery power dies, let the car cool at least 10 minutes before installing a newly charged battery pack.
- If someone uses a CB nearby, it might interfere with control of the Attacker. If this happens, move the car and transmitter away from the CB.
- You cannot operate your Attacker near devices with transmitters that use the same frequency as the Attacker (either 27 MHz or 49 MHz).
- If the Attacker moves slowly, and you just installed a fully charged battery pack, check the wheel mechanisms for lint, thread, hair or dust.

THE FCC WANTS YOU TO KNOW

This equipment has been tested and found to comply with the limits for a Class B digital device, pursuant to Part 15 of the *FCC Rules*. These limits are designed to provide reasonable protection against harmful interference in a residential installation. This equipment generates, uses, and can radiate radio frequency energy and, if not installed and used in accordance with the instructions, may cause harmful interference to radio communications.

However, there is no guarantee that interference will not occur in a particular installation. If this equipment does cause harmful interference to radio or television reception, which can be determined by turning the equipment off and on, the user is encouraged to try to correct the interference by one or more of the following measures:

- Reorient or relocate the receiving antenna.

RadioShack®
www.radioshack.com

© 2002 RadioShack Corporation.

All Rights Reserved.

RadioShack and RadioShack.com are trademarks used by RadioShack Corporation.

⚠ WARNING ⚠

Dispose of old batteries promptly and properly. Do not burn or bury them.

⚡ CAUTION ⚡

- Use only a fresh battery/ battery pack of the required size and recommended type.
- If you will not be using the Attacker for a week or more, remove the battery from the transmitter and the battery pack from the Attacker. Batteries can leak chemicals that can damage electronic parts.
- Never leave dead or weak batteries in the Attacker or the transmitter.

📄 NOTE 📄

When the transmitter's range decreases, replace its battery.

⚡ CAUTION ⚡

- Be sure the battery pack's connectors and wires do not touch the Attacker's moving parts.
- Use only the recommended battery pack and charger.
- Do not charge or recharge the battery pack while it is in the Attacker.
- After you charge or recharge the battery pack, disconnect it from the charger. Overcharging the battery pack could damage it.
- When you disconnect the battery pack from the charger, do not pull on the connector's wires. You might damage the battery pack.

- Increase the separation between the equipment and receiver.
- Consult your local RadioShack store or an experienced radio/TV technician for help.
- If you cannot eliminate the interference, the FCC requires that you stop using your vehicle.

Changes or modifications not expressly approved by RadioShack may cause interference and void the user's authority to operate the equipment.

INSTALLING BATTERIES

IN THE TRANSMITTER

The transmitter requires one 9-volt battery (not supplied). For the best performance and longest life, we recommend a RadioShack alkaline battery. ⚠ ⚡

1. Press down and slide the battery compartment cover in the direction of the arrow to remove it.
2. Place a battery in the battery compartment according to the polarity symbols (+ and -) marked inside.
3. Replace the cover and snap it into place. 📄

IN THE VEHICLE

The Attacker requires a 9.6-volt rechargeable battery pack (not supplied, available at your local RadioShack store) for power. You must charge the battery pack before you can use it to power your Attacker. To charge it, follow the battery charger's instructions. ⚡

1. Slide **ON/OFF** on the bottom of the Attacker to **OFF**.
2. Press the battery lid stopper and slide it in the direction of the **OPEN** arrow to lift it.
3. Place the battery pack with its connector on the same side as the vehicle's matching connector and push it in all the way.

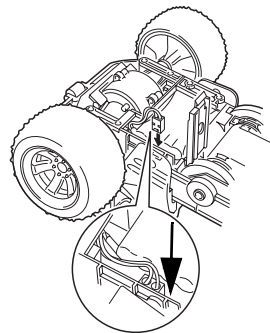

4. Connect the battery pack's connector to the vehicle's connector. The connector fits only one way.
5. Replace the battery lid stopper. If the Attacker loses power or does not respond to the transmitter, recharge the battery pack. ⚠!

ATTACHING THE TRANSMITTER ANTENNA

Attach the antenna to the transmitter by screwing the threaded end into the transmitter's antenna connector.

ATTACHING THE VEHICLE ANTENNA TUBE

The antenna tube holds up the antenna wire for the best reception and range.

1. Push the antenna wire's loose end through the tube.
2. Insert the tube securely into the vehicle's tube holder. Let the extra antenna wire hang freely.

INSTALLING THE MISSILES

Be sure **ON/OFF** is set to **OFF**. Gently push the missile into the missile compartment until you hear a click.

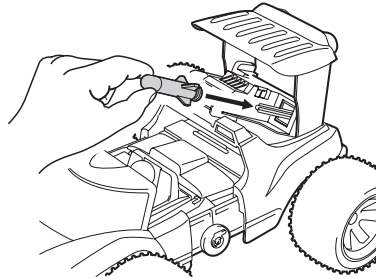

DRIVING THE ATTACKER

1. Fully extend the transmitter's antenna. For maximum range, hold the transmitter with the antenna pointing straight up. ⚠
2. Slide **ON/OFF** on the vehicle to **ON**. The vehicle's light flashes when it is turned on and lights steadily when it moves.

NOTE

- To run your vehicle for extended periods of time, we suggest you purchase an extra battery pack. You can charge one while you use the other.
- Occasionally let the battery pack fully discharge before recharging it. Otherwise the battery pack may lose its ability to fully charge.

! IMPORTANT !

Important: The EPA certified RBRC® Battery Recycling Seal on the nickel-cadmium (Ni-Cd) battery indicates RadioShack is voluntarily participating in an industry program to collect and recycle these batteries at the end of their useful life, when taken out of service in the United States or Canada. The RBRC program provides a convenient alternative to placing used Ni-Cd batteries into the trash or the municipal waste stream, which may be illegal in your area. Please call 1-800-THE-SHACK (1-800-843-7422) for information on Ni-Cd battery recycling and disposal bans/restrictions in your area. RadioShack's involvement in this program is part of the company's commitment to preserving our environment and conserving our natural resources.



⚠ WARNING ⚠

Never play with your Attacker in the street.

Attaching the Transmitter Antenna

CAUTION

- If you make the Attacker transform while it is moving, it might change the vehicle's direction.
- Never insert your finger or other object inside the chassis while the Attacker is transforming.
- Never aim the missiles at people or animals.
- Do not look into the missile launching gate.
- If the Attacker gets stuck under an object, immediately release the transmitter's control levers and retrieve the car.

NOTE

Care

Keep the Attacker dry; if it gets wet, wipe it dry immediately. Use and store the Attacker only in normal temperature environments. Handle the Attacker carefully; do not drop it. Keep the Attacker away from dust and dirt, and wipe it with a damp cloth occasionally to keep it looking new.

Service and Repair

If your Attacker is not performing as it should, take it to your local RadioShack store for assistance. Modifying or tampering with the Attacker's internal components can cause a malfunction and might invalidate its warranty and void your FCC authorization to operate it.

3. The transmitter has no power switch. When you press either control lever, the Attacker responds and the red indicator lights.

TRANSFORM — Press while the vehicle is stopped to make the Attacker transform from a monster truck to a race car and back again.

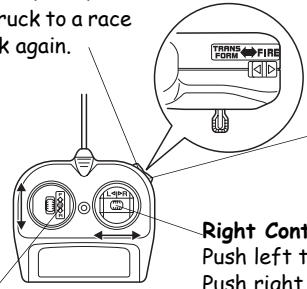

FIRE — Press to launch a missile.

Right Control Lever — Push left to move left. Push right to move right. Release to go straight.

Left Control Lever — Push forward to move forward. Pull backward to move backward. Release to stop.

4. When you finish driving the Attacker, slide ON/OFF to OFF.

ADJUSTING THE WHEEL ALIGNMENT

If the Attacker does not drive in a straight line when you release the right control lever, adjust the wheel alignment. Turn the control toward L if the car is pulling right, or toward R if the car is pulling left.

Limited Ninety-Day Warranty

This product is warranted by RadioShack against manufacturing defects in material and workmanship under normal use for ninety (90) days from the date of purchase from RadioShack company-owned stores and authorized RadioShack franchisees and dealers. EXCEPT AS PROVIDED HEREIN, RadioShack MAKES NO EXPRESS WARRANTIES AND ANY IMPLIED WARRANTIES, INCLUDING THOSE OF MERCHANTABILITY AND FITNESS FOR A PARTICULAR PURPOSE, ARE LIMITED IN DURATION TO THE DURATION OF THE WRITTEN LIMITED WARRANTIES CONTAINED HEREIN. EXCEPT AS PROVIDED HEREIN, RadioShack SHALL HAVE NO LIABILITY OR RESPONSIBILITY TO CUSTOMER OR ANY OTHER PERSON OR ENTITY WITH RESPECT TO ANY LIABILITY, LOSS OR DAMAGE CAUSED DIRECTLY OR INDIRECTLY BY USE OR PERFORMANCE OF THE PRODUCT OR ARISING OUT OF ANY BREACH OF THIS WARRANTY, INCLUDING, BUT NOT LIMITED TO, ANY DAMAGES RESULTING FROM INCONVENIENCE, LOSS OF TIME, DATA, PROPERTY, REVENUE, OR PROFIT OR ANY INDIRECT, SPECIAL, INCIDENTAL, OR CONSEQUENTIAL DAMAGES, EVEN IF RadioShack HAS BEEN ADVISED OF THE POSSIBILITY OF SUCH DAMAGES.

Some states do not allow limitations on how long an implied warranty lasts or the exclusion or limitation of incidental or consequential damages, so the above limitations or exclusions may not apply to you.

In the event of a product defect during the warranty period, take the product and the RadioShack sales receipt as proof of purchase date to any RadioShack store. RadioShack will, at its option, unless otherwise provided by law: (a) correct the defect by product repair without charge for parts and labor; (b) replace the product with one of the same or similar design; or (c) refund the purchase price. All replaced parts and products, and products on which a refund is made, become the property of RadioShack. New or reconditioned parts and products may be used in the performance of warranty service. Repaired or replaced parts and products are warranted for the remainder of the original warranty period. You will be charged for repair or replacement of the product made after the expiration of the warranty period.

This warranty does not cover: (a) damage or failure caused by or attributable to acts of God, abuse, accident, misuse, improper or abnormal usage, crash, collision, impact, violent contact, failure to follow instructions, improper installation or maintenance, alteration, lightning or other incidence of excess voltage or current; (b) any repairs other than those provided by a RadioShack Authorized Service Facility; (c) consumables such as fuses or batteries; (d) cosmetic damage; (e) transportation, shipping or insurance costs; or (f) costs of product removal, installation, set-up service adjustment or reinstallation.

This warranty gives you specific legal rights, and you may also have other rights which vary from state to state.
RadioShack Customer Relations, 200 Taylor Street, 6th Floor, Fort Worth, TX 76102

12/99