



61-140

Two-Bell Wireless Door Chime



wireless door chime



remote doorbell

Thank you for purchasing your Two-Bell Wireless Door Chime from RadioShack. You can use it as a doorbell, remote pager and panic switch.

what's included

wireless door chime
remote mounting brackets (2)
lanyard (strap)

remote doorbell 1
remote doorbell 2
user's guide

M 3 screw* (4)



M 2.6 brass screw* (2)



M 3.5 screw* (5)



anchor* (5)



* all screws shown at actual size

installing your batteries

- 1 Install 3 C batteries in your wireless door chime.



- 2 Install 3 AAA batteries in each remote doorbell.



NOTE Use only fresh batteries of the required size and type.

Remove old or weak batteries that might leak and damage electronic circuits.

Don't mix old and new batteries or battery chemistries.

mounting your chime

Mount your chime on a wall...

- 1 Drill a 1/4-inch hole and insert an anchor.
- 2 Screw an M3.5 screw into the anchor, leaving the head extended about 1/8-inch.



- 3 Align the chime's rear keyhole slot to the screw head and slide the chime down.

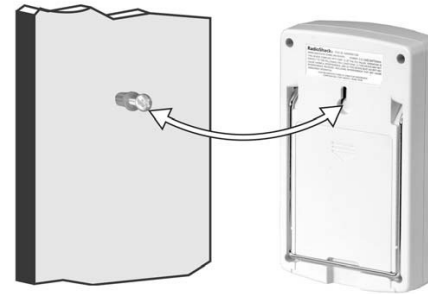

OR set your chime on a flat surface using the supplied stand



mounting your doorbell

carry a doorbell with you as a panic alarm or to let someone you frequently visit (such as an elderly parent) know you have arrived coming...
OR mount your doorbell

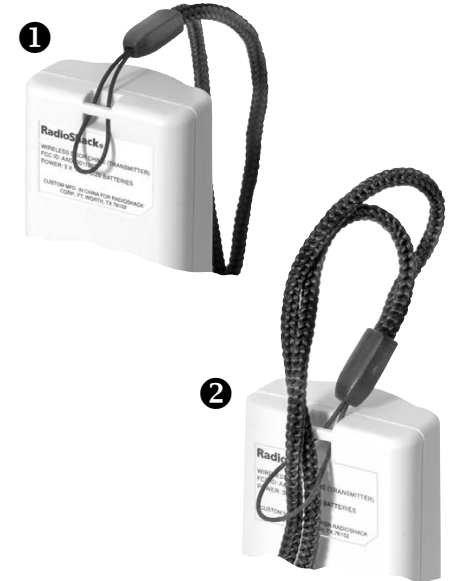

- 1 Mark two holes using your doorbell holder. Drill a 1/4-inch hole at each mark. Insert an anchor in each hole.
- 2 Align your doorbell holder with the anchors and screw an M3.5 screw into each anchor.
- 3 Slide your doorbell into the holder. To lock the doorbell in place, insert an M2.6 screw into the bottom of the doorbell holder.

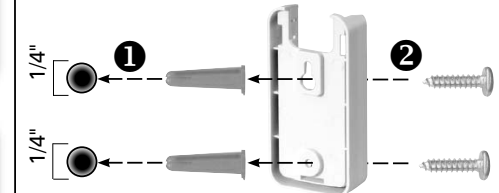

you will also need

drill
C battery (3)*

flathead screwdriver
AAA battery (6)*

*Batteries not supplied

changing the channel

In the event you need to change or reset the channel or your chime and doorbell, use the following instructions.

- 1 Select the same channel (1, 2, or 3) in the wireless door chime and remote **doorbell 1**.
- 2 Repeat step 1 for remote **doorbell 2**.

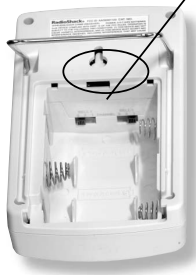
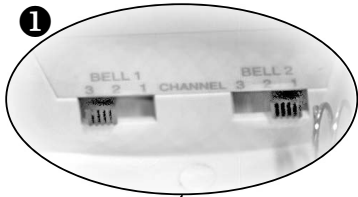

If your door chime rings when no one presses one of the remotes, you may be receiving interference. Switch the affected chime and remote to another channel.

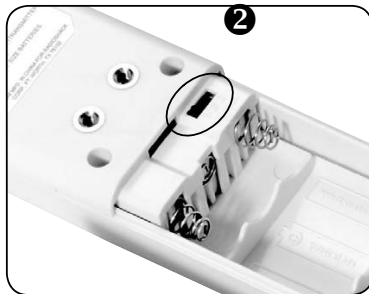

using your chime and doorbells

- 1 Slide your chime to ON.



Slide your chime to OFF when you don't want to hear it ring.



- 2 Press one of your two doorbells. Your chime will "ding dong" for **doorbell 1** and play "Home Sweet Home" for **doorbell 2**.



adding another alarm

You can expand your doorbells to sound an additional alarm. To do this, you will need to wire one or both doorbells to an alarm that contains a normally open contact.

- 1 Connect both tips of a 2-conductor wire (not supplied) to a doorbell, as shown, using two M3 screws.



- 2 Connect both tips of the other end of the 2-conductor wire to the extra alarm.

Now, when you press your doorbell, both the chime and the alarm will sound.

the FCC wants you to know

This equipment has been tested and found to comply with the limits for a Class B digital device, pursuant to Part 15 of the FCC Rules. These limits are designed to provide reasonable protection against harmful interference in a residential installation. This equipment generates, uses, and can radiate radio frequency energy and, if not installed and used in accordance with the instructions, may cause harmful interference to radio communications. However, there is no guarantee that interference will not occur in a particular installation. If this equipment does cause harmful interference to radio or television reception, which can be determined by turning the equipment off and on, the user is encouraged to try to correct the interference by one or more of the following measures:

- Reorient or relocate the receiving antenna.
- Increase the separation between the equipment and receiver.
- Connect the equipment into an outlet on a circuit different from that to which the receiver is connected.

This device complies with Part 15 of the FCC Rules.

Operation is subject to the following two conditions:

- (1) this device may not cause harmful interference, and
 - (2) this device must accept any interference received, including interference that may cause undesired operation.
- Consult your local RadioShack store or an experienced radio/TV technician for help. If you cannot eliminate the interference, the FCC requires that you stop using your door chime. Changes or modifications not expressly approved by RadioShack may cause interference and void the user's authority to operate the equipment.

limited one-year warranty

This product is warranted by RadioShack against manufacturing defects in material and workmanship under normal use for one (1) year from the date of purchase from RadioShack company-owned stores and authorized RadioShack franchisees and dealers. For complete warranty details and exclusions, check with your local RadioShack store.

RadioShack Customer Relations
200 Taylor Street, 6th Floor, Fort Worth, TX 76102
04/04

specifications

Frequency	433.92 MHz ± 600KHz
Doorbell current consumption	<10mA
Chime current consumption	<2mA @ standby < 130mA @ sound playing
Chime battery low	2.4V ± 0.1V
Chime audio power	> 80dBA @ 25cm
Doorbell operating temperature	-20°C to 60°C (-4°F to 140°F)

Specifications are typical; individual units might vary. Specifications are subject to change without notice.



©2004, RadioShack Corporation.
All rights reserved. RadioShack and
RadioShack.com are trademarks
used by RadioShack Corporation.

61-140

AO0185ABA1
06A04

Printed in China