



protect. teach. love.™

AutoTrainer™

BARK CONTROL WHILE YOU'RE AWAY!

Operating and Training Guide

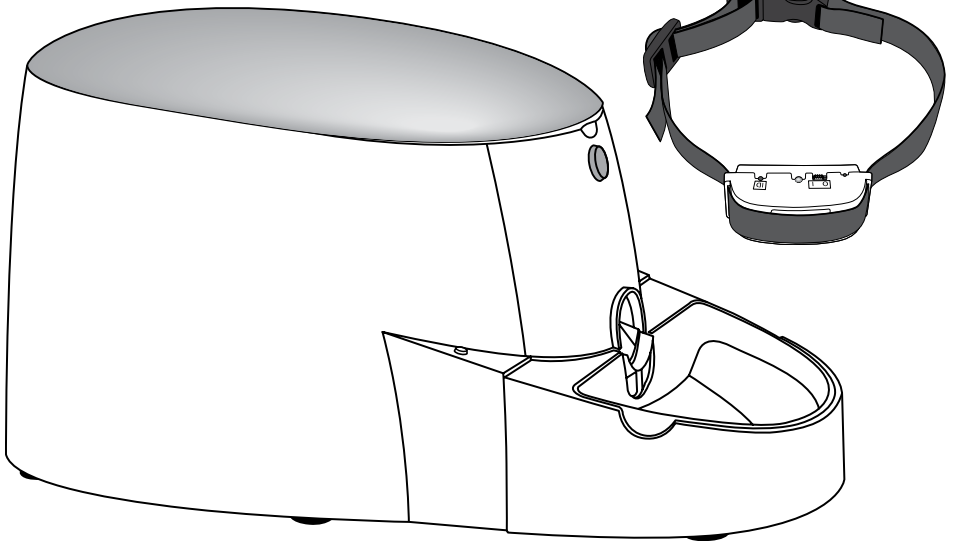

Model Number
AUTO

PLEASE READ THIS ENTIRE GUIDE BEFORE BEGINNING

Important Safety Information

Explanation of Attention Words and Symbols used in this guide

 This is the safety alert symbol. It is used to alert you to potential personal injury hazards. Obey all safety messages that follow this symbol to avoid possible injury or death.

WARNING WARNING indicates a hazardous situation which, if not avoided, could result in death or serious injury.

CAUTION CAUTION, used with the safety alert symbol, indicates a hazardous situation which, if not avoided, could result in minor or moderate injury.

CAUTION CAUTION, used without the safety alert symbol, indicates a hazardous situation which, if not avoided, could result in harm to your pet.

WARNING **Risk of explosion.** Do not short circuit, mix old and new batteries, dispose of in fire, or expose to water. When batteries are stored or disposed, they must be protected from shorting. Dispose of used batteries properly.

WARNING **Not for use with aggressive dogs.** Do not use this Product if your dog is aggressive, or if your dog is prone to aggressive behavior. Aggressive dogs can cause severe injury and even death to their owner and others. If you are unsure whether this product is appropriate for your dog, please consult your veterinarian or certified trainer.

CAUTION **Save these instructions for future reference. Read all instructions before operating product.**

- For indoor use only.
- For dry treats/kibble use only.
- Do NOT use the *AutoTrainer* with puppies or dogs with any physical disability.
- Intended for use with pets only.
- Do NOT allow small children to play with, in or around the *AutoTrainer*.
- Before leaving for an extended time, always replace used batteries with new batteries to insure continual operation.
- Do NOT place any foreign object in the *AutoTrainer*.
- *AutoTrainer* should always be leveled.
- Do NOT disassemble the *AutoTrainer* except as instructed in the manual.
- Dispose of all packaging material properly. Some items may be packed in poly bags; these bags could cause suffocation; keep away from children and pets.
- Initially check operation frequently to be sure the *AutoTrainer* is dispensing properly.
- The *AutoTrainer* and *AutoTrainer* collar should NOT be submerged in water at any time, this may damage electronic components.

CAUTION The power cord should be used at the owner's discretion. Do not use the power cord if your dog has a history of destroying power cords by chewing them.

Thank you for choosing the PetSafe® brand. You and your pet deserve a companionship that includes memorable moments and a shared understanding together. Our products and training tools promote a lifestyle of protection, teaching, and love—essentials that influence memories for a lifetime. If you have any questions about our products or training your pet, please visit our website at www.petsafe.net or contact our Customer Care Center at 1-800-732-2677.

To get the most protection out of your warranty, please register your product within 30 days at www.petsafe.net. By registering and keeping your receipt, you will enjoy the product's full warranty and should you ever need to call the Customer Care Center, we will be able to help you faster. Most importantly, we will never give or sell your valuable information to anyone. Complete warranty information is available online at www.petsafe.net.

Table of Contents

History of the <i>AutoTrainer</i>	4
How the <i>AutoTrainer</i> Works.....	4
Components, Parts and Features	5
Set up.....	6-8
Training Tips	9
About the Modes	9
Reviewing the History.....	10
Frequently Asked Questions	11
Care and Cleaning.....	12
Terms of Use and Limitation of Liability	12
Battery Disposal	13
FCC	13
Warranty	14

Image A

Note: Batteries not included.
(4) D cell, (2) CR 2032

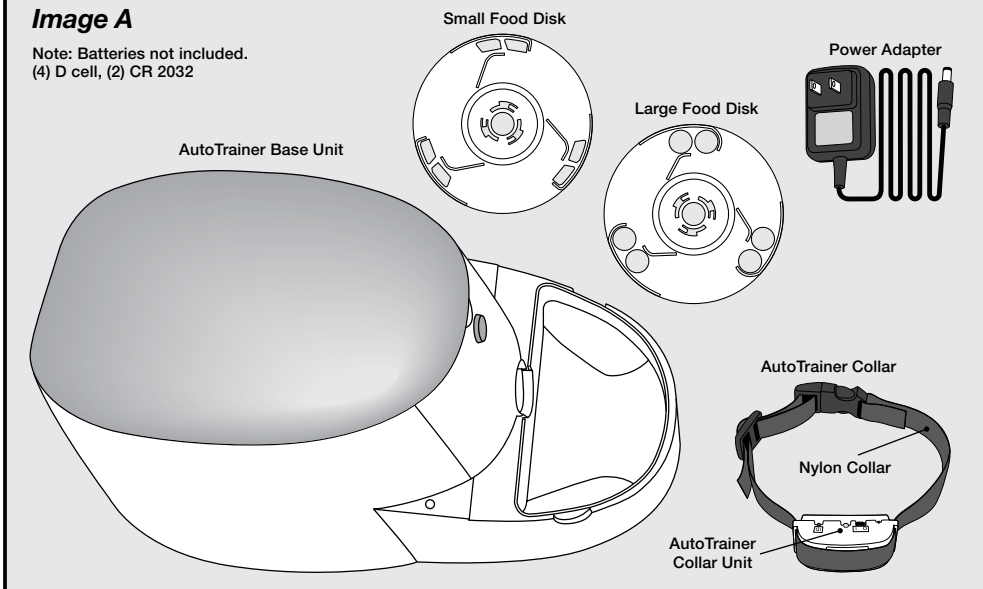

History of the AutoTrainer

Years ago, during a chance meeting on a flight from Chicago to San Francisco, Dr. Ian Dunbar and Dr. John Watson struck up a conversation about whether marking a dog's bark by immediately interrupting a progressive tone sequence that predicts food delivery would reduce the frequency of barking and number of barks per day. Back in the Bay Area, Dr. Watson promptly engineered a computerized prototype, which the Doctors tested on barking dogs, primarily at the Berkeley Humane Society. Amazingly, not only did the tone sequence itself drastically reduce the frequency and number of barks, but also hyperactivity; many dogs would pace less and instead, settle down next to their electronic buddy.

How the AutoTrainer Works

It's not easy leaving your dog at home when they're prone to anxiety. Separation-induced behaviors such as barking, whining and pacing can adversely affect your dog's health.

The *AutoTrainer*™ is a fully automatic, reward-based training device that requires no prior training for yourself or your dog. The *AutoTrainer* works by rewarding your dog for quiet behavior, therefore creating a pleasant environment. By rewarding for increasingly longer periods of quiet, your dog will soon learn to calmly wait for the signal that means a small treat is being delivered. The *AutoTrainer* trains your dog to offer calm, quiet behavior while you are away.

For many dogs, all you have to do is fill the hopper with kibble, turn on the power and the *AutoTrainer* will do the rest. Your dog will soon learn to settle down calmly and quietly, waiting patiently for the next food reward.

Components, Parts and Features

Image A

AutoTrainer Base Unit: The main portion of the *AutoTrainer* unit. The part of the product that houses the Display Screen, Food Hopper, Muzzle Detector and D Batteries.

AutoTrainer Collar: Includes the Nylon Collar and *AutoTrainer* Collar Unit. Transmits information to the *AutoTrainer* Base Unit.

Food Disk – 2 sizes: used to assist food through the Food Dispenser.

Power Adapter: Option for use without batteries.

AutoTrainer Collar Unit: The unit on the *AutoTrainer* Collar that transmits barking to the *AutoTrainer* Base Unit.

Image B

Food Hopper: Holds dry treats/kibble in the *AutoTrainer* Base Unit, approximately 3.5 cups of medium sized kibble.

Food Dish Attachment: Removable piece that holds the Food Dish.

Food Dish: Catches food that has been passed through the Food Dispenser and Food Disk.

Muzzle Detector: Located under the Food Dispenser. Senses when the dog takes the food from the Food Dish.

Lid Release Button: Located on the Front of the *AutoTrainer*, opens the *AutoTrainer* Hopper Lid.

Battery Cover: Located on *AutoTrainer* Base Unit: Remove to add/replace the batteries (4-D).

Food Dispenser: Channel that the food travels to reach the Food Dish.

Hopper Lid: Encloses dry treats/kibble and Display screen in the *AutoTrainer*.

Display Screen: Displays information about training progress and history.

Speaker: Emits tones from the *AutoTrainer*.

Suction Feet: Six rubber feet located at the bottom of the *AutoTrainer* Base Unit that suction to the floor and prevent the *AutoTrainer* Base Unit from moving.

Session: The period of time between the start of a mode and the end.

Sequence: A single series of tones, followed by kibble dispensing.

“Uh-Oh” tone: This tone plays when the dog barks, jiggles or paws the machine. In Teach Me mode, this tone occurs during those behaviors. In Calm Me mode, this tone also occurs during those behaviors, but also signals the machine to delay the delivery of food.

Tone(s): The sounds emitted by the *AutoTrainer* Base Unit

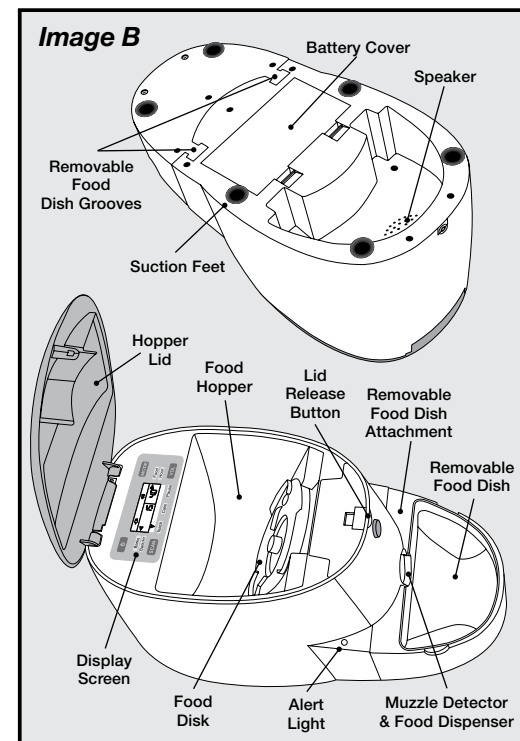

Display:

Collar Signal : An icon displayed to alert the connection of the *AutoTrainer* Collar Unit to the *AutoTrainer* Base unit, as indicated by the icon on the display screen.

Barks: The number of Barks recorded

Barks Per Hour: The number of barks recorded per hour

Scan: Assists with selection of modes and viewing of history

Vol: Volume control button

Food: Amount of food dispensed during a session

Mode: Press to select Teach Me or Calm Me modes. Press to Pause and Un-Pause

Teach Me Mode: A series of sequences, the introductory mode that prepares the dog for Calm Me mode.

This mode teaches your dog to associate the tones with food delivery and associate other behaviors (barking, pawing the machine) with an “Uh-Oh” tone.

Calm Me Mode: This mode continues to play the series of sequences from Teach Me mode, however, when the dog barks or moves the machine, the “Uh-Oh” tone restarts the sequence and delays the delivery of food. This mode teaches the dog that they will be rewarded for quiet behavior.

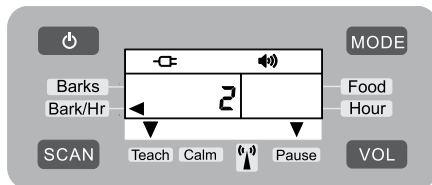

Setup

NOTICE If your dog has special dietary needs, consult your veterinarian before using this product. Please use with dry food only. Kibble size should not exceed ¼ inch for Small Food Disk and ½ inch for Large Food Disk.

NOTICE The *AutoTrainer* Collar is not guaranteed to fit properly on dogs under 10 lbs.

Step 1

Remove the Food Dish Attachment from the bottom of the *AutoTrainer* Base Unit (1A) and attach it to the front of the *AutoTrainer* (1B). Be sure to lock it in securely so the Muzzle Detector and Food Dispenser are not blocked. Place the Food Dish securely inside of the Food Dish Attachment.

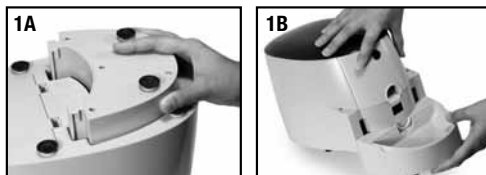

Step 2

Install 4 D batteries into the battery compartment, located on the bottom of the *AutoTrainer* Base Unit (2A). An AC Power Adapter is provided as an alternative way to power the *AutoTrainer* Base Unit. On the *AutoTrainer* Collar, insert two CR2032 batteries, positive side up, into the battery compartment (2B). Replacement batteries (3-volt, CR2032) can be found at most retailers. Battery compartment is located under the strap on the curved side of the collar.

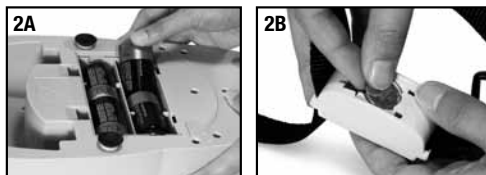

WARNING Risk of explosion if batteries are replaced by an incorrect type. Do not short circuit, mix old and new batteries, dispose of in fire, or expose to water. When batteries are stored or disposed, they must be protected from shorting. Dispose of used batteries properly.

Step 3

Prepare the hopper. Open the lid by pressing the Lid Release Button on the front of the *AutoTrainer*:

- Select the appropriate sized Food Disk and insert it into the Food Hopper. Twist to the left to lock. To unlock a Food Disk, twist it to the right.
- Insert your dog's daily amount of kibble into the food hopper. The Food Hopper can hold approximately 3.5 cups of medium-sized kibble. Be sure to feed your pet their entire recommended daily serving of kibble each day. Servings over 3.5 cups may need to be given separately, once the *AutoTrainer* has been turned off.

Step 4

Turn the *AutoTrainer* Base Unit on by pressing down the Power button (4A) for 3 seconds.

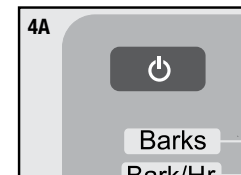

Turn the power for the *AutoTrainer* Collar on to synchronize with the *AutoTrainer* Base Unit. Move from 0 - 1 to power on (4B).

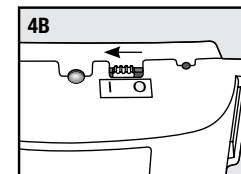

A red LED light will turn on for a few moments, then off again (4C).

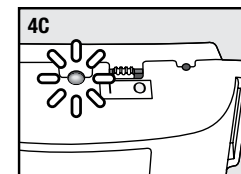

Note: When the *AutoTrainer* detects the *AutoTrainer* Collar's signal, an arrow will appear over the *AutoTrainer* Collar signal icon (4D). If the *AutoTrainer* Collar loses connection with the *AutoTrainer* Base Unit as indicated on the LCD screen, restart the *AutoTrainer* Collar and *AutoTrainer* Base Unit at approximately the same time while pressing the ID button on the *AutoTrainer* Collar (4E) with the tip of a paper clip (or similar item) for 2 seconds. The ID will update immediately and the LCD will show an arrow over the *AutoTrainer* Collar icon (4D).

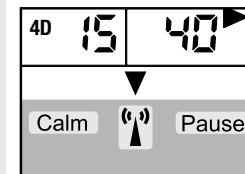

Step 5

To change modes, press the Mode key within 7 seconds of powering on the *AutoTrainer* Base Unit. The *AutoTrainer* Base Unit will begin Calm Me mode if no buttons have been pressed for 7 seconds. Hold the Power button for one second to start immediately.

An arrow underneath the collar signal icon will indicate which mode is active (5A). No mode will begin until the *AutoTrainer* Collar unit is connected to the *AutoTrainer* Base Unit.

Adjust the volume by pressing the Volume key (VOL). The volume icon on the top right of the screen (5B) will indicate what level is selected. There are three volume levels.

A dog should experience Teach Me Mode at least 5 times before beginning Calm Me Mode. Only continue from Teach Me to Calm Me if your dog is comfortable eating food from the machine.

Step 6

Important: The proper fit and placement of your *AutoTrainer* Collar is important for effective training.

To assure a proper fit, please follow these steps:

1. Have your pet standing comfortably (6A).
2. The *AutoTrainer* Collar should fit snugly to your dog's neck, with the transmitter placed directly over your dog's throat (6B).
3. The *AutoTrainer* Collar should fit snugly, yet loose enough to allow one finger to fit between the strap and your pet's neck (6C).
4. Allow your pet to wear the collar for several minutes then recheck the fit. Check the fit again as your pet becomes more comfortable with the *AutoTrainer* Collar.
5. Trim the collar as follows (6D):
 - A. Mark the desired length of the collar with a pen. Allow for growth if your pet is young or grows a thick winter coat.
 - B. Remove the *AutoTrainer* Collar from your pet and cut off the excess.
 - C. Before placing the *AutoTrainer* Collar back onto your pet, seal the edge of the cut collar by applying a flame along the frayed edge.

Note: The *AutoTrainer* Collar will work in a range up to 100 feet. If your dog leaves this range, or if the *AutoTrainer* Collar battery dies, the *AutoTrainer* Base Unit will turn off after 30 minutes. The history from the most current session will be saved. If the dog reenters the range of the *AutoTrainer* Base Unit, or the battery is replaced in the *AutoTrainer* Collar Unit, the *AutoTrainer* Base Unit will restart in the 1st sequence and resume tracking history.

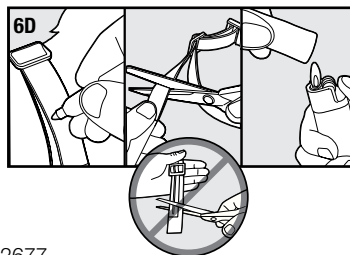
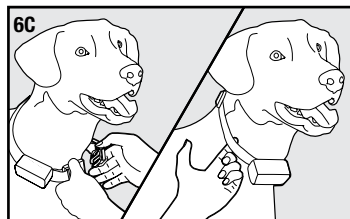
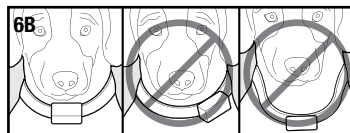
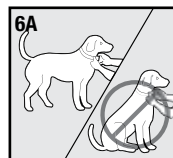
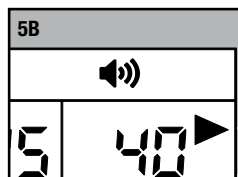
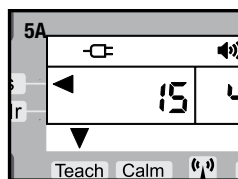

- **Jamming** - If the red lights on each side of the *AutoTrainer* Base Unit are blinking, the Food Disk is jammed. Unjam the Food Disk by removing the Disk and clearing any food that has gotten stuck. Press Mode to restart if the *AutoTrainer* Base Unit has been jammed for less than 10 minutes. If the *AutoTrainer* Base Unit has been jammed for over 10 minutes, only one light will be blinking. Manually turn the *AutoTrainer* Base Unit off, then back on. **Don't forget to read and record all data before powering off.**
- **Empty** - If the red lights on each side of the *AutoTrainer* Base Unit are steadily on, the *AutoTrainer* Base Unit is empty and needs to be refilled. Refill the *AutoTrainer* Base Unit and press Mode to start over if the *AutoTrainer* Base Unit has been empty for less than 10 minutes. If the *AutoTrainer* Base Unit has been empty for more than 10 minutes, manually turn the *AutoTrainer* Base Unit off, then back on. **Don't forget to read and record all data before powering off.**

Training Tips

- Before beginning training, be sure your dog has not eaten for at least a 4 hour period.
- Introduce your dog to the *AutoTrainer* by letting him eat near the *AutoTrainer* Base Unit. Place some of his daily amount of food in the bowl of the *AutoTrainer* Base Unit, do not turn it on yet, and let him eat from the bowl. Once you have done this 1-2 times proceed to the Teach Me mode.
- Use only **dry** treats/kibble.
- For multi dog households, train one dog at a time. Separate the dog in training from any other dogs.
- Most dogs are not used to eating from a bowl that beeps and makes some sounds and might be apprehensive about the unit at first. Please start with the volume low and plan some time to be with the dog these first few times during the Teach Me phase.
- After each session, be sure your dog has received any unfinished food or the remainder of their daily food allowance.
- For more step by step instructions on acclimating your dog to the *Autotrainer*, and other helpful tips, see <http://store.petsafe.net/training-behavior/bark-control/AutoTrainer>

About the Modes

Each mode is made up of sequences of tones. At the end of each sequence, kibble will dispense. Your dog will learn that the tones of each mode predict a reward.

What To Expect During A Training Session:

*Once you have completely assembled the *AutoTrainer*, followed the step-by-step instructions, and prepared your dog, what should you expect from a training session?*

During a training session, the *AutoTrainer* will emit sequences of tones. Each sequence was designed to build up to the next sequence. The sequences consist of many different, unique tones. At the end of each sequence, the *AutoTrainer* should dispense 1-4 pieces of kibble, teaching your dog that the end of a sequence means a reward.

The sequences will not continue until the dog *AutoTrainer* detects the dog's muzzle at the food dish. The *AutoTrainer* sequences will stop if the food is not taken. If the dog barks, the *AutoTrainer* Collar transmits that to the *AutoTrainer* Base Unit which then emits an "Uh-Oh" sound. A light on the collar will flash when it registers a bark.

What is the difference between Teach Me Mode and Calm Me Mode?

Teach Me Mode

Teach Me Mode consists of sequences of tones that results in a food reward, just like the Calm Me Mode. However, in the initial sequences of this mode, if the dog barks, they hear the “Uh-Oh” tone, and the sequences continue. A dog should begin training in this mode and continue for at least 5 training sessions so they are able to learn what the tones mean. If the dog is catching on quickly and seems comfortable eating from the *AutoTrainer*, they may continue to Calm Me Mode. If the dog is not yet comfortable eating from the *AutoTrainer* Food Dish, do not move on to Calm Me Mode. Instead, repeat sessions in Teach Me Mode.

Calm Me Mode

Calm Me Mode, like Teach Me Mode, also consists of sequences of tones resulting in a food reward. During Calm Me Mode, when the dog barks, the “Uh-Oh” tone restarts the sequence, delaying the food reward. This teaches the dog that barking delays their food and they will only receive a reward for quiet behavior.

Every time you turn the *AutoTrainer* Base Unit off, be sure to feed your dog the remainder of their food to ensure they meet their daily calorie intake requirements.

Reviewing the History

Note: When the AutoTrainer Base Unit is turned off, the data stored will be deleted and cannot be recovered. If you wish to keep your data, write it down after every session before the AutoTrainer Base Unit is turned off.

1. To Pause the *AutoTrainer* Base Unit, press the Mode button for one second (7A). The *AutoTrainer* Base Unit will remain in Pause for 10 minutes.

2. To read the History:

A. The screen will show a total number of Barks for the entire session (on left), and total pieces of dispensed food for the entire session (on right) (7B).

B. Press the Scan button to view the Average Barks/Hour.

C. Press the Scan button again to view the number of barks during the first hour of the session. Continue to press the Scan to view the number of barks for each hour of the session. After each hour of the session has displayed, the History will return to the Barks/Food screen.

D. The *AutoTrainer* Base Unit holds 36 hours of data at a time.

3. To Unpause the *AutoTrainer* Base Unit, press the Mode button again within 10 minutes. After 10 minutes, the *AutoTrainer* Base Unit will go to sleep. In Sleep, the LCD screen light will blink and you will not be able to restart the Calm Me or Teach Me mode. In order to resume training after 10 minutes in pause, the *AutoTrainer* Base Unit will need to be powered off and on manually.

4. If the *AutoTrainer* Base Unit is powering off from Pause mode, review history and write it down. **All data is deleted when the AutoTrainer Base Unit is turned off and cannot be recovered.**

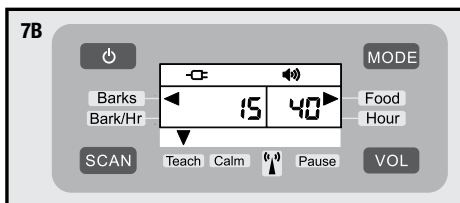
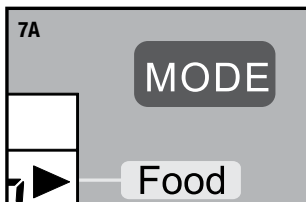

Frequently Asked Questions

I came home to find the AutoTrainer Base Unit not dispensing food, kibble in the dish, and the AutoTrainer Base Unit playing 1 tone every 60 seconds. What does this mean?

- If the dog doesn't approach the *AutoTrainer* Base Unit to eat the kibble when it is dispensed, the device will “go to sleep” and emit a tone every 60 seconds to remind the dog that it's listening/watching. If the dog eats kibble, the *AutoTrainer* Base Unit will “wake up” and restart where it left off in the session

How do I properly size the AutoTrainer Collar to my dog's neck?

- The *AutoTrainer* Collar should fit snugly to your dog's neck, with the transmitter placed directly over your dog's throat. This is to ensure that the *AutoTrainer* Collar detects the vibration and sound from your dog's barking.

What do I do if I live in a multiple dog household?

- You will need to separate the dog that is using the *AutoTrainer* from the rest of the pets. Only one dog should be able to access and hear the *AutoTrainer* at one time.

The AutoTrainer Collar won't connect to the AutoTrainer Base Unit. What do I do?

- If the *AutoTrainer* Collar loses connection with the base *AutoTrainer* Base Unit as indicated in the LCD screen, restart the *AutoTrainer* Collar and *AutoTrainer* Base Unit at the same time while holding the ID button on the *AutoTrainer* Collar with the tip of a paperclip (or similar item) for 2 seconds. The ID will update immediately and the LCD should show an arrow over the *AutoTrainer* Collar icon. See page 7, image 2E.

I feed my dog wet food or a raw diet. Can I use the AutoTrainer with wet or raw food?

- No, the *AutoTrainer* will only function properly when dry kibble or dry/semi-dry treats are used.

What happens if food bounces out of the Food Dish when dispensed?

- While rare, this could potentially happen. If the food bounces out of the dish, your dog should eat it from the ground and could potentially go back to the dish to look for more food, signaling the Muzzle Detector to continue. If your dog does not check the dish, the Muzzle Detector will not indicate that the dog ate the treat, therefore will emit the reminder tone until the dog puts their muzzle in the dish. If you return home and the *AutoTrainer* Base Unit is beeping without a treat in the dish, simply record existing history from the *AutoTrainer* Base Unit and manually restart.

My dog is barking at the AutoTrainer Base Unit. Is this normal?

- At first, it is possible that your dog may bark at the *AutoTrainer* Base Unit until they figure out the game, most commonly in Teach Me mode. Once in Calm Me mode, your dog should soon learn that this behavior delays the arrival of food. Once they've figured out the game, barking will decrease more and more.

Collar LED Light Guide

Action	Red LED Light	Green LED Light
Power On	ON	OFF
Update ID/Connect Collar	OFF	ON
Low Battery	Flashing	OFF

Care and Cleaning

AutoTrainer Base Unit: Do not submerge the *AutoTrainer* Base Unit in water. Wipe down with damp cloth to clean.

Food Dish: Remove the dish from the *AutoTrainer* Base Unit and wash in warm, soapy water. Dry thoroughly before reattaching to the *AutoTrainer* Base Unit.

Food Hopper: Do not submerge the *AutoTrainer* Base Unit in water. Wipe down the inside of the Food Hopper with a damp cloth and dry thoroughly.

Food Disks: Remove food disks and wash in warm, soapy water. Dry thoroughly before reattaching to the *AutoTrainer* Base Unit.

Food Dish Attachment: Wipe down with damp cloth.

Customer Care

USA & Canada - Tel: 800-732-2677

Monday - Friday 8 AM - 8 PM / Saturday 9 AM - 5 PM

Terms of Use and Limitation of Liability

1. Terms of Use

This Product is offered to you conditioned upon your acceptance without modification of the terms, conditions and notices contained herein. Usage of this product implies acceptance of all such terms, conditions, and notices.

2. Proper Use

This Product is designed for use with pets where training is desired. The specific temperament of your pet may not work with this product. We recommend that you not use this product if your pet is aggressive. If you are unsure whether this is appropriate for your pet, please consult your veterinarian or certified trainer.

Proper use includes reviewing the entire Operating and Training Guide provided with your product and any specific Caution statements.

3. No Unlawful or Prohibited Use

This Product is designed for use with pets only. This pet training device is not intended to harm, injure, or provoke. Using this product in a way that is not intended could result in violation of Federal, State or local laws.

4. Limitation of Liability

In no event shall Radio Systems® Corporation be liable for any direct, indirect, punitive, incidental, special or consequential damages, or any damages whatsoever arising out of or connected with the use or misuse of this Product. Buyer assumes all risks and liability from the use of this Product.

5. Modification of Terms and Conditions

Radio Systems® Corporation reserves the right to change the terms, conditions and notices under which this Product is offered.



Battery Disposal

Separate collection of spent batteries is required in many regions; check the regulations in your area before discarding spent batteries. At the end of the product life, please contact our Customer Care Center to receive instructions on proper disposal of the unit. Please do not dispose of the unit in household or municipal waste. For a listing of Customer Care Center telephone numbers in your area, visit our website at www.petsafe.net.

Perchlorate Battery

Perchlorate Material – special handling may apply. See www.dtsc.ca.gov/hazardouswaste/perchlorate.

FCC NOTE:

This device complies with Part 15 of the FCC Rules.

Operation is subject to the following two conditions: (1) this device may not cause harmful interference, and (2) this device must accept any interference received, including interference that may cause undesired operation.

conditions:
ference received,

Systems® Corporation

THE MANUFACTURER IS NOT RESPONSIBLE FOR ANY RADIO OR TV INTERFERENCE CAUSED BY UNAUTHORIZED MODIFICATIONS OR CHANGE TO THIS EQUIPMENT. SUCH MODIFICATIONS OR CHANGE COULD VOID AND CHANGE AN ANTENNA WHICH THE MANUFACTURER PROVIDES. IT IS THE USER'S AUTHORITY TO OPERATE THE EQUIPMENT.

device, pursuant to
rmful interference in a
and, if not installed and
ons. However, there is
to radio or television
d to try to correct the

IC NOTE:

This device complies with Industry Canada licence-exempt RSS standard(s). Operation is subject to the following two conditions: (1) this device may not cause interference, and (2) this device must accept any interference, including interference that may cause undesired operation of the device.

receiver is connected.
p.

One Year Non-Transferable Limited Warranty

WHAT IS COVERED: Radio Systems Corporation, owner of the PetSafe Brand, (hereinafter referred to as “PetSafe”) warrants to the original retail consumer purchaser, and not any other purchaser or subsequent owner, that its PetSafe product, when subject to normal and proper residential use, will be free from defects in material or workmanship for a period of one (1) year from the purchase date. An “original retail consumer purchaser” is a person or entity who originally purchases the product, or a gift recipient of a new product that is unopened and in its original packaging. When serviced by PetSafe Customer Service, PetSafe covers labor and parts for the first year of ownership; after the first year, a service or upgrade charge will apply relative to replacement of the product, with new or refurbished items at PetSafe’s sole discretion. The limited warranty is non-transferable and shall automatically terminate if the original retail consumer purchaser resells the PetSafe product or transfers the property on which the PetSafe product is installed. In the event of defect, these are your exclusive remedies.

PROPER PRODUCT USE: This product is designed only for use with domesticated animals; do not use this product for any other purpose. However, the specific temperament of your animal may not work with this product.

We recommend that you do not use this product if your animal is aggressive. If you are unsure whether this product is appropriate for your animal, please consult with your veterinarian or certified trainer before you use this product. Please see the instruction manual for additional important information.

WHAT IS NOT COVERED: This non-transferrable limited warranty does not provide protection against, and PetSafe will have no liability under this non-transferrable limited warranty for any damage to or defects in the products caused by any animal, loss of product(s), failure, defect or damage caused by events and situations beyond normal residential exposure conditions, including, but not limited to: commercial use, misuse, abuse, neglect, improper installation or installation not in accordance with PetSafe's instructions, use of non-PetSafe accessories, impacts of foreign objects, acts of God, abnormal or improper use, improper storage, attempted repair or service by anyone other than PetSafe Customer Service, accident, alteration, defects in or failure of the surface the PetSafe product is installed in or upon, discoloration or other damage caused by pollution, sunlight, other environmental conditions, mold, dirt, mildew, or exposure to harmful chemicals and any other cause not involving manufacturing defects in the PetSafe product.

REGISTERING THE PRODUCT: Within thirty (30) days of purchase, please go to www.petsafe.net/register product to register your purchase. A sales receipt shall be required to obtain warranty coverage. Please keep this information in a safe place.

MAKING A WARRANTY CLAIM: To obtain warranty service, call the PetSafe Customer Care center. In the United States or Canada, 1-800-732-2677 begin_of_the_skype_highlighting 1-800-732-2677 FREE end_of_the_skype_highlighting; in Australia, 1800 786 608; in New Zealand, 0800 543 054.

Pursuant to this non-transferrable limited warranty, PetSafe will replace the part with a new or refurbished part. This non-transferrable limited warranty will then apply to either the new or refurbished part for the remainder of the original non-transferrable limited warranty period.

DISCLAIMERS: Replacement as provided under this non-transferrable limited warranty is the exclusive remedy of the consumer. Neither labor to remove the part nor labor to install the refurbished or replaced part is covered.

This non-transferrable limited warranty is in lieu of all other express warranties. PetSafe expressly disclaims and excludes all other warranties, express or implied, including without limitation, the warranties of merchantability and fitness for a particular purpose. PetSafe also disclaims and excludes all liability for incidental, consequential, punitive, direct, indirect, special or any other damages arising out of or connected with the purchase, use or misuse of this product or for the breach of any express or implied warranties or breach of contract or otherwise. Purchaser assumes all risks and liabilities from the use or misuse of this product. PetSafe does not authorize any other person or agent to make any other express or implied warranties.

Furthermore, PetSafe will not be liable for any loss, damage or injury resulting from delay in delivery of replacement parts or for any failure by PetSafe to perform covered repair work due to circumstances beyond PetSafe's control.

GOVERNING LAW: This non-transferrable limited warranty shall be governed by the law of the State of Tennessee, U.S.A., and by the laws of the United States of America, excluding their conflicts of laws principles. Furthermore, the United Nations Convention on Contracts for the International Sale of Goods is hereby excluded in its entirety from application to this non-transferrable limited warranty. Jurisdiction and venue shall be exclusive to the courts of Knox County, Tennessee.

These warranties give you specific legal rights, and you may also have other rights that vary from state to state or country to country. Some states or countries do not allow the exclusion or limitation of incidental or consequential damages, so the above limitation or exclusion may not apply to you.

Radio Systems® Corporation
10427 PetSafe Way
Knoxville, TN 37932
1-800-732-2677
www.petsafe.net
400-1723

©2013 Radio Systems Corporation