

Wireless Pet Containment Transmitter

GIF00-16917 | Product Manual

FCC ID: KE3IF100A

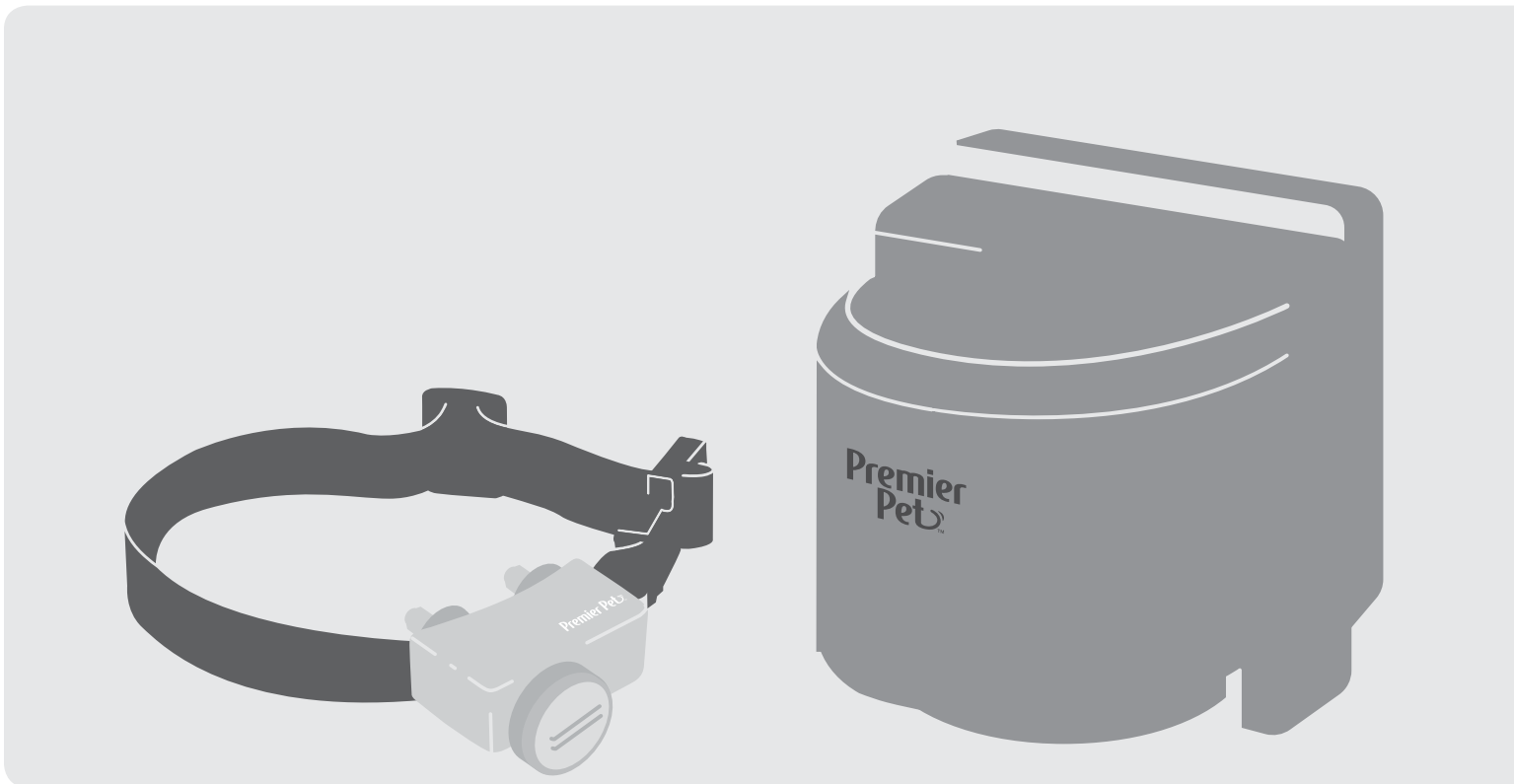

Have questions about your Wireless Fence or need training tips for your pet?

Our Customer Care representatives are here to help you.

Call our USA-based Customer Care Center at

+1 (866) 381-2785

USA & Canada: Mon–Fri 8am–8pm EST | Sat 9am–5pm EST

This product includes a one year warranty.
Call, click, or chat with us before you return your product.

premierpet.com

Important Safety Information

Explanation of Attention Words and Symbols used in this guide

 This is the safety alert symbol. It is used to alert you to potential personal injury hazards. Obey all safety messages that follow this symbol to avoid possible injury or death.

⚠ WARNING **WARNING** indicates a hazardous situation which, if not avoided, could result in death or serious injury.

⚠ CAUTION **CAUTION**, used with the safety alert symbol, indicates a hazardous situation which, if not avoided, could result in minor or moderate injury.

CAUTION **CAUTION**, used without the safety alert symbol, indicates a hazardous situation which, if not avoided, could result in harm to your pet.

NOTICE **NOTICE** is used to address safe use practices not related to personal injury.

⚠ WARNING

- Do not use this product if your dog is prone to aggressive behavior. Aggressive dogs can cause severe injury or death to their owners and others. If you are not sure that this product is right for your dog, please talk to your veterinarian or a certified trainer.
- Risk of electric shock. Use the fence transmitter indoors in dry location only.
- Risk of explosion if battery is replaced by an incorrect type. Do not short circuit, mix old and new batteries, dispose of in fire, or expose to water. When batteries are stored or disposed, they must be protected from shorting. Dispose of used batteries properly.

⚠ CAUTION

This Premier Pet™ Wireless Fence is NOT a solid barrier. The system is designed to act as a deterrent to remind pets by static correction to remain in the boundary established. It is important that you reinforce training with your pet on a regular basis. Since the tolerance level to static correction varies from pet to pet, Radio Systems Corporation CANNOT guarantee that the system will, in all cases, keep a pet within the established boundary. Not all pets can be trained to avoid crossing the boundary! Therefore, if you have reason to believe that your pet may pose a danger to others or harm himself if he is not kept from crossing the boundaries, you should NOT rely solely upon the Premier Pet™ Wireless Fence to confine your pet. Radio Systems Corporation shall NOT be liable for any property damage, economic loss or any consequential damages, sustained as a result of any animal crossing the boundary.

- This product is not a toy. Keep it away from the reach of children.

CAUTION

Proper fit of the receiver collar is important. A receiver collar worn for too long or made too tight on the pet's neck may cause skin damage, ranging from redness to pressure ulcers. This condition is commonly known as bed sores.

- **Avoid leaving the receiver collar on the dog for more than 12 hours per day.**
- When possible reposition the receiver collar on the pet's neck every 1 to 2 hours.
- Check the fit to prevent excessive pressure; follow the instructions in this manual.
- You may need to trim the hair in the area of the contact points. Never shave the dog's neck; this may lead to a rash or infection.
- Never connect a leash to the receiver collar; it will cause excessive pressure on the contact points.
- When using a separate collar for a leash, don't put pressure on the receiver collar.
- Wash the dog's neck area and the contact points of the receiver collar weekly with a damp cloth.
- Examine the contact area daily for signs of a rash or a sore.
- If a rash or sore is found, discontinue use of the receiver collar until the skin has healed.
- If the condition persists beyond 48 hours, see your veterinarian.
- For additional information on bed sores and pressure necrosis, please visit our website.
- Proper training of your pet is essential to successfully using the system. During the first 2 weeks of training, do not use the system without direct supervision of your pet.
- Always remove your dog's receiver collar before performing any fence transmitter testing.
- The receiver collar should not be on your dog when the system is tested. If it is, your pet may receive an unintended correction.
- The boundary zone must be tested whenever an adjustment is made to the fence transmitter setting to prevent unintended corrections to your pet.
- Remove the receiver collar from your pet when indoors to avoid activation of the receiver collar.
- If you use a collar and leash for training, be sure the extra collar does not put pressure on the contact points.
- Never remove power from the system when the receiver collar is on the pet. This may activate the receiver collar.

Radio Systems Corporation recommends the use of an Uninterruptible Power Supply (UPS) for use with your wireless fence. Should the power go out at your home, your pet will be unprotected. Power outages can be unpredictable, and the use of a UPS will provide you with some time to properly restrain your pet.

In rare instances, if your pet is near the boundary at the time when the power fails, it is possible that your pet will receive a correction. This correction will stop after a 30 second timeout period has been reached. This is due to the operation of the collar: the collar is activated by the absence of the containment signal.

While results will vary depending on the UPS manufacturer's specifications the following are typical examples to guide your choice of UPS:

- Using a 400 VA UPS a consumer should expect 3 hours of backup time.
- Using a 900 VA UPS a consumer could expect 8 hours of backup time.

If settings below maximum fence size are used, additional backup time will result. At minimum fence size settings backup time may be more than two times the backup time estimated at maximum fence size.

NOTICE

- To prevent an unintended correction, after the boundary flags have been placed, be sure to set the static correction on the receiver collar back to level 1, tone-only.
- Do not place anything on the top of the fence transmitter or cover any ventilation holes. This may overheat the fence transmitter and cause early transmit failure.
- Do not place fence transmitter in a closet or any other confined, unventilated area.
- Do not place fence transmitter on or near a metal surface.

TABLE OF CONTENTS

What's Included	4
How It Works	4
Key Definitions	5
Set Up the Transmitter	6
Prepare the Receiver Collar	6
Adjust the Pet Area to Desired Size	8
Transmitter Range Chart	9
Record Your Settings	9
Place the Boundary Flags	9
Fit the Receiver Collar	10
Training Guide	11
Wireless - To - Go	11
FREQUENTLY ASKED QUESTIONS	12
Terms of Use and Limitation of Liability	16
Warranty	16
Perchlorate Battery	17
Battery Disposal	17
Compliance	17
Mounting Template	19

What's Included

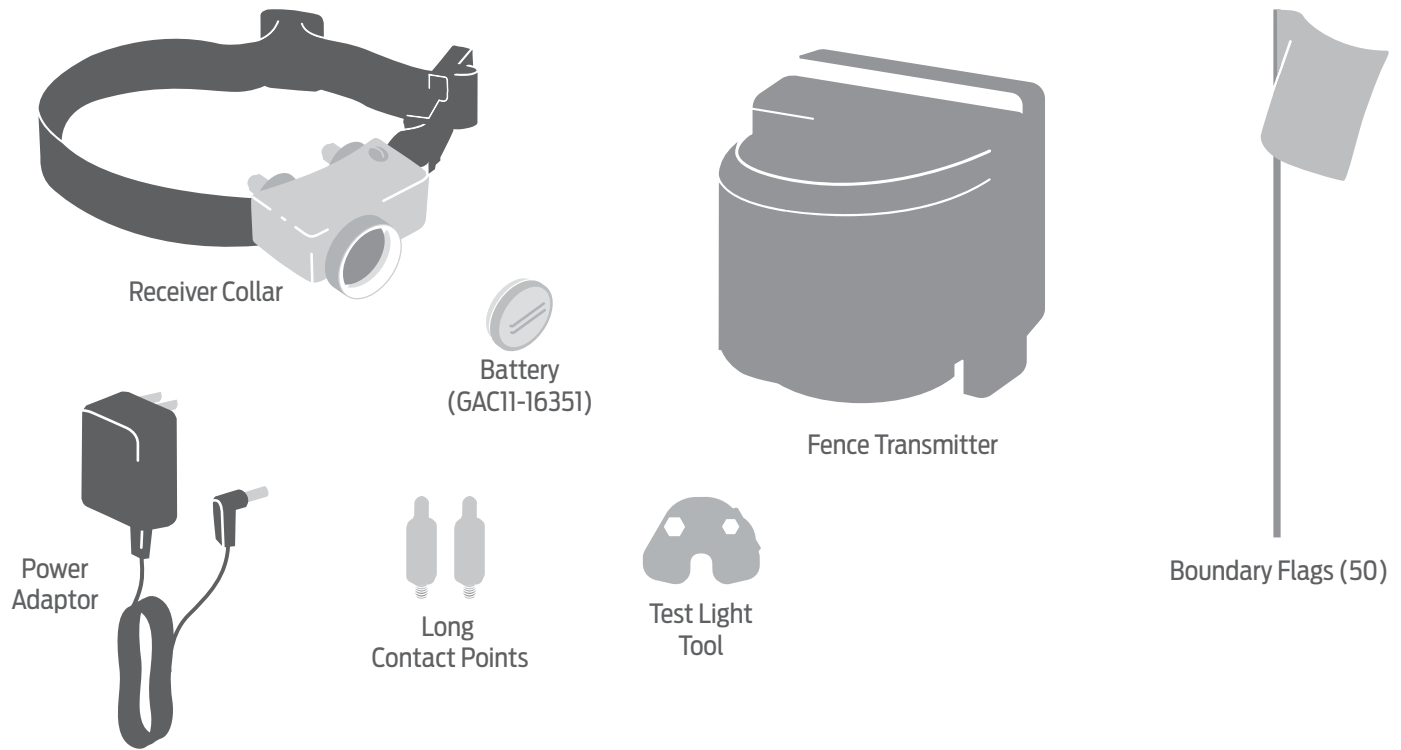

Items You May Need

- Pliers
- Scissors
- Lighter
- Drill & mounting hardware
- Tape measure
- Non-metallic collar and leash

Set up and training help: www.premierpet.com

How It Works

The Premier Pet™ Wireless Fence has been proven safe, comfortable, and effective for pets over 8 lb. The system works by transmitting a radio signal up to 90 ft. in all directions. You temporarily define the pet area with boundary flags for a visual aid in training your pet. Your pet wears a receiver collar with contact points that touch his neck, and, once trained, is allowed to roam freely in the pet area. When your pet reaches the boundary zone, the receiver collar gives a warning beep before delivering a safe static correction through the contact points to get his attention until he returns to the pet area.

Key Definitions

Fence Transmitter: Transmits the radio signal and is the center of the pet area.

Pet Area: Distance from the fence transmitter where your pet can roam freely.

Boundary Zone: 2 to 3 ft. wide area outside the pet area where your pet's receiver collar will begin to beep and then begin to deliver a static correction.

NOTE: The correction will start in the boundary zone and continue anywhere beyond the pet area. The receiver collar is equipped with a safety time-out feature that will stop correcting after 30 seconds if your pet remains outside the pet area.

Receiver Collar: Receives the radio signal from the fence transmitter.

Correction level Button: Adjusts the level of static correction your pet receives outside the pet area.

Receiver Indicator Light: Indicates the level of correction at which the receiver collar is set. This light also serves as a low battery indicator.

Contact Points: Deliver the safe static correction when your pet moves into the boundary zone.

Power Jack: Where the power adapter plugs into the fence transmitter.

Boundary Switch/Range: Adjust according to the size of the pet area desired.

NOTE: Adjusting the switch does not change the level of static correction on the receiver collar.

Power Light: Indicates when the fence transmitter is on.

Boundary Control Dial: Adjusts the distance from the fence transmitter to the boundary zone.

NOTE: Adjusting the dial does not change the level of static correction on the receiver collar.

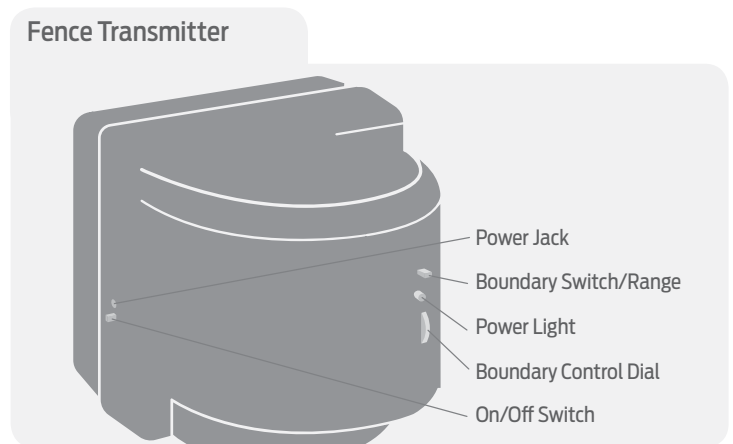
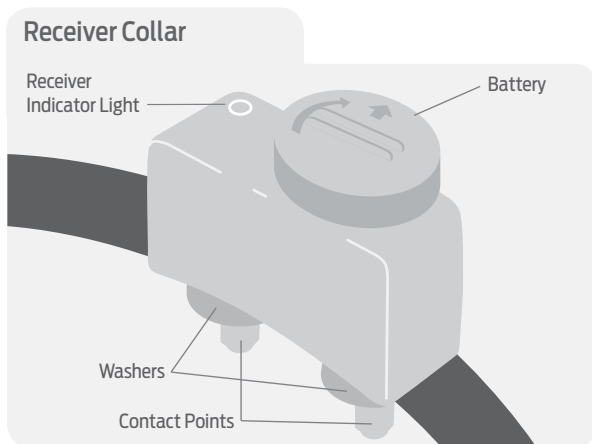
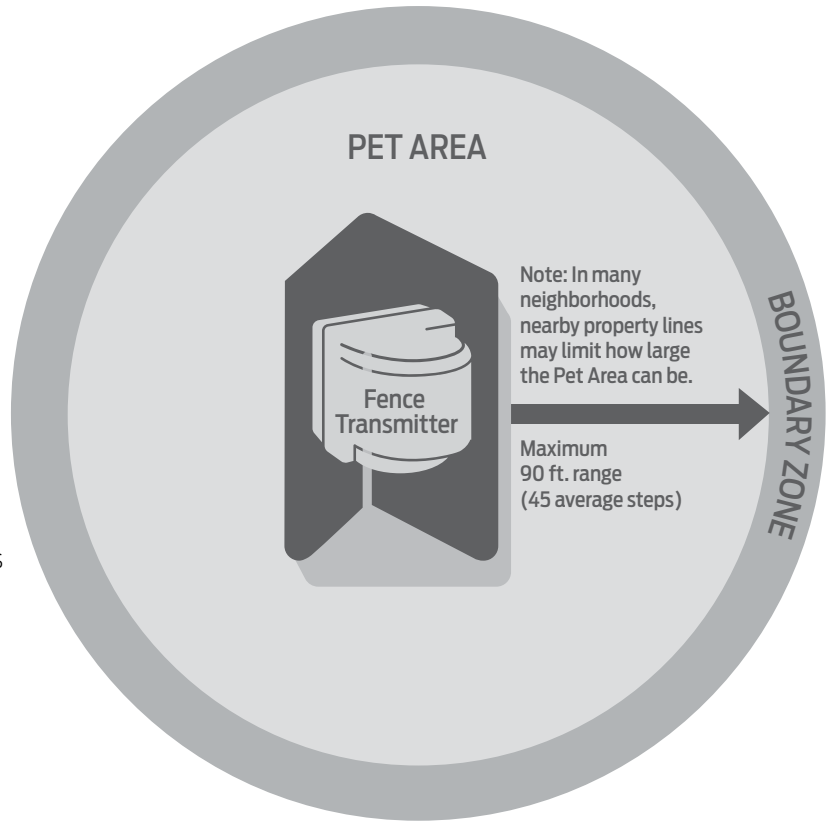

Set Up the Transmitter

Important: You may need to move the transmitter several times before determining the final location. The fence transmitter is located at the exact center of the pet area.

Place the fence transmitter:

- At least 2 ft. above the floor located on the ground floor of your home.
- In a dry, well ventilated, protected area.
- In an area where temperatures do not fall below -10°F (-23°C) or above 140°F (40°C).
- On a non-metal table/hard surface (to ensure proper ventilation) or mount on a wall (1A). A mounting template is included on the back of this guide.
- At least 3 ft. from large metal objects, as these items may reduce the size and shape of your pet area (1B). Placing the transmitter inside a metal building or shed can reduce the maximum range of the system.

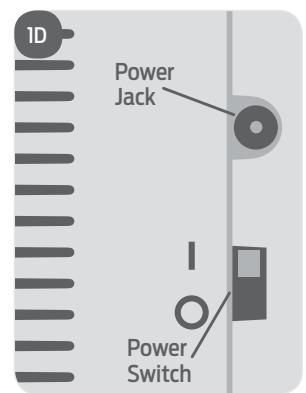
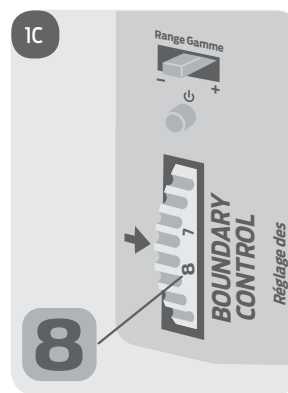
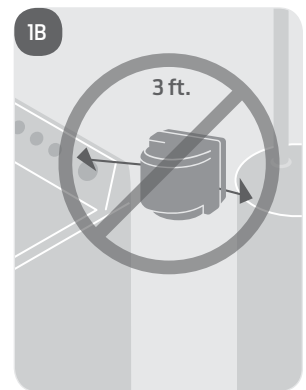
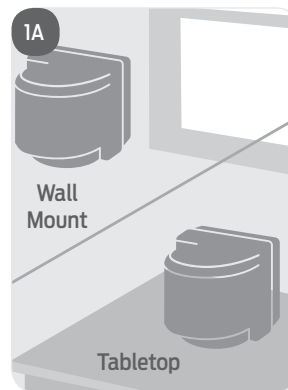

NOTICE

- Do not place anything on top of fence transmitter or cover any ventilation holes. This may overheat the fence transmitter and cause early transmit failure.
- Do not place fence transmitter in a closet or any other confined, unventilated area.
- Do not place fence transmitter on or near a metal surface.

To maximize your pet area, make sure the boundary switch/range is on High (+) and the boundary control dial is set to 8 (1C). Plug power adapter into power jack and a standard outlet. Turn the fence transmitter on (1D).

Prepare the Receiver Collar

Your receiver collar comes with short contact points installed. Use the long contact points for pets with long or thick hair. Tighten the contact points using the test light tool (2A) one-half turn beyond finger tight. Check the tightness weekly.

Insert and Remove the Receiver Collar Battery

NOTE: Do not install the battery while the receiver collar is on your pet.

This receiver collar utilizes a replaceable battery (GAC11-16351). This unique battery is designed to make battery replacement easier and increase water protection.

To insert the battery, align the symbols on the battery (arrow) and receiver collar (triangle) (2B). Use the edge of the test light tool (2B) to turn the battery clockwise until the arrow lines up with the lock symbol on the housing.

To remove or replace the battery, turn the battery counter-clockwise using the edge of the test light tool (2B). DO NOT attempt to cut into or pry open the battery. Be sure to discard the used battery properly. When removing the old battery from the receiver collar, discharge all power by holding the static level button down until the light is no longer illuminated. Replace with a new battery.

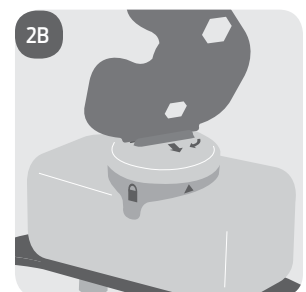
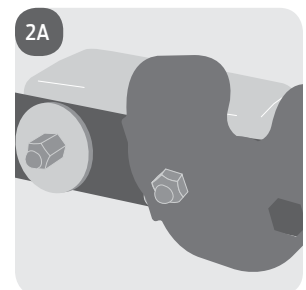

WARNING Risk of explosion if batteries are replaced by an incorrect type. Do not short circuit, mix old and new batteries, dispose of in fire, or expose to water. When batteries are stored or disposed, they must be protected from shorting. Dispose of used batteries properly.

A replacement battery (GAC11-16351) can be found at many retailers. Contact the Customer Care Center or visit our web site at www.premierpet.com to locate a retailer near you.

Set the Static Correction Level

Read all steps before attempting to set the static correction level.

1. Remove the clear plastic cover with the edge of the test light tool to expose the correction level button (**2C**).
2. With the battery installed, press the correction level button and release when the receiver LED indicator light lights up (**2D**).
3. The receiver LED indicator light will emit a series of flashes representing the static correction level.
4. Increase the static correction level by pressing and releasing the correction level button within 5 seconds of the previous series of flashes.
5. After setting the static correction level, replace the cover to protect the correction level button.

The static correction levels increase in strength from 1 to 6. Pushing the correction level button while the receiver collar is on level 6 will cause the receiver collar to revert to level 1. Refer to the static correction level Table to choose the static correction level that best fits your pet.

The receiver indicator light acts as a low battery indicator. The light will flash every 4 to 5 seconds when battery replacement is required.

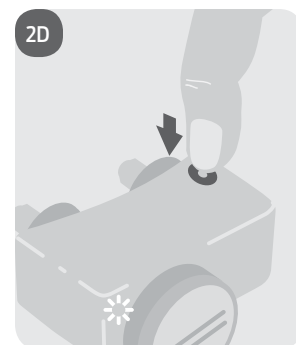
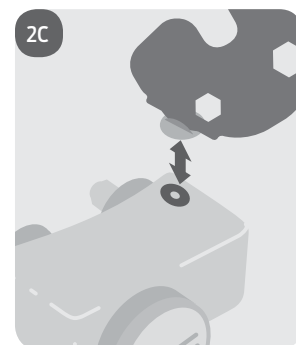

Battery Contact Verification

Remove the receiver collar from your pet. Press the button and verify that the LED light illuminates. If the LED light does not come on remove the battery. Locate the metal tabs in the battery compartment. Gently lift the tabs to ensure that the battery will make good contact. Replace the battery into the receiver collar. Press the button and check that the LED light illuminates.

Static Correction Level Table		
Static Correction Level	Indicator Light Response	Receiver Collar Function
1	1 Flash	No Static Correction, Tone-only
2	2 Flashes	Low Static Correction
3	3 Flashes	Medium-Low Static Correction
4	4 Flashes	Medium Static Correction
5	5 Flashes	Medium-High Static Correction
6	6 Flashes	High Static Correction
	Flashes once every 4 to 5 seconds	Indicates Low Battery

Over Correction Protection

If your pet enters the boundary zone or continues anywhere beyond the pet area, this feature limits the static correction duration to 30 seconds.

In the unlikely event that your pet leaves the pet area, he will not receive a static correction upon return to the pet area.

Adjust the Pet Area to Desired Size

Make sure the entire pet area lies within your property boundaries (**3A**). Always start determining the boundary zone at the shortest distance from fence transmitter. Place the boundary switch/range on Low (-) if the boundary zone will be less than 45 ft. from the fence transmitter.

Make sure the receiver collar battery is properly installed, the static correction level is set at 2 or greater, and the test light contacts are touching the contact points (**3B**).

NOTE: If your next-door neighbor has an in-ground containment system, see "Troubleshooting" section.

Test Light Instructions

1. Set the correction level to 2 or above.
2. Hold the test light contacts to the contact points.
3. Walk toward the boundary zone holding the receiver collar at your pet's neck level until the test light flashes. Save test light for future testing.

NOTE: If the test light does not flash, install a new battery and re-test. If test light still does not flash, contact the Customer Care Center.

To maximize your pet area, make sure the boundary switch/range is on High (+) and the boundary control dial is set to 8. Plug power adapter into power jack and standard outlet.

Two-Person Method

Hold the receiver collar at your pet's neck height (**3C**) with logo side facing away from the fence transmitter and contact points facing upwards. Walk to the edge of the desired pet area. Facing away from the fence transmitter, hold the receiver collar at the edge of the desired pet area (**3D**). Starting with the boundary control dial set to 8, have a second person turn the dial down SLOWLY. When the receiver collar starts to beep, tell the person to stop turning the boundary control dial. Record your settings below for future reference.

One-Person Method

Measure the shortest distance from the desired boundary zone to the fence transmitter. Find the distance on the fence transmitter range chart and set the boundary switch/range and boundary control dial. Hold the test light contacts to the contact points (**3B**). Take the receiver collar to the boundary zone with the logo side facing away from the fence transmitter and contact points facing upwards (**3C**). Hold the receiver collar at your pet's neck level (**3D**) until the receiver collar beeps and the test light flashes. If the receiver collar beeps before or after the desired boundary zone, return to the fence transmitter and adjust the boundary control dial. Repeat this process until the receiver collar is beeping at the desired location. Record your settings for future reference.

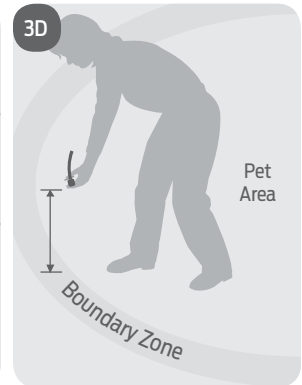
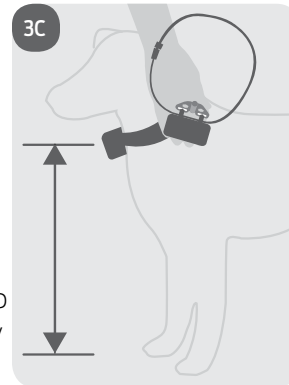
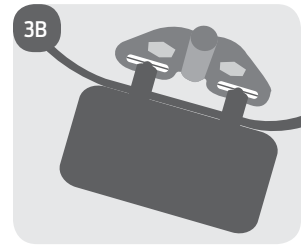
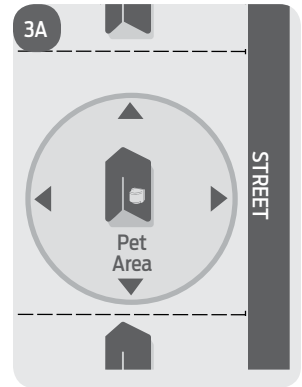

Transmitter Range Chart

Boundary Control Dial Position	Boundary Switch/Range LOW (-)	Boundary Switch/Range HIGH (+)
1	5–10 ft.	5–10 ft.
2	5–10 ft.	5–10 ft.
3	15–20 ft.	25–35 ft.
4	20–25 ft.	42–55 ft.
5	25–30 ft.	55–65 ft.
6	35–40 ft.	75–85 ft.
7	40–45 ft.	85–90 ft.
8	40–45 ft.	85–90 ft.

Record Your Settings

	Final Boundary Switch Setting HIGH (+) or LOW (-)	Final Boundary Control Dial Position (1-8)	Receiver Static Correction level (1-6)
Home			
Camping			
Vacation			
Other			
Other			
Other			

NOTE: These distances are approximate.

Place the Boundary Flags

The boundary flags are visual reminders for your pet of where the boundary zone is located. The receiver collar will activate within 2 to 3 ft. of the boundary flags.

- Using the test light, with the static correction level set at 2 or greater, hold the receiver collar at your pet's neck height with Premier Pet™ logo side facing away from the fence transmitter.
- Walk towards the boundary zone until the receiver collar beeps and the test light flashes (**4A**).
- Place a boundary flag in the ground (**4B**).
- Walk back into the pet area until the beeping stops.
- Repeat this process around the boundary zone until it is marked with boundary flags every 10 ft.

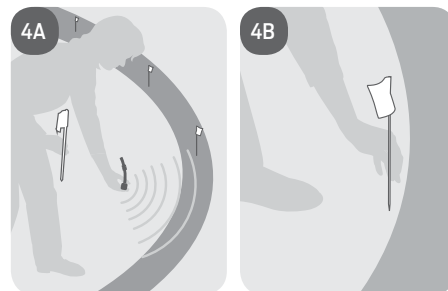

The boundary flags may be in different parts of the boundary zone and may not be in a line. The boundary zone is 2 to 3 ft. wide.

Fit the Receiver Collar

Important: The proper fit and placement of your receiver collar is important for effective training. The contact points must have direct contact with your pet's skin on the underside of his neck.

CAUTION Please read the front of this guide for Important Safety Information regarding the receiver collar.

To assure a proper fit, please follow these steps:

1. Make sure that the battery is not installed in the receiver collar.
2. Start with your pet standing comfortably.
3. Place the receiver collar on your pet so that the Premier Pet™ logo is facing your pet's chin.
4. Center the contact points underneath your pet's neck, touching the skin. If your pet has a long or thick coat, use the enclosed long contact points to reach through the hair (**5A**).

CAUTION

- You may need to trim the hair in the area of the contact points. Never shave the pet's neck; this may lead to a rash or infection.
- You should not make the receiver collar any tighter than is required for good contact. A receiver collar that is too tight will increase the risk of pressure necrosis in the contact area.

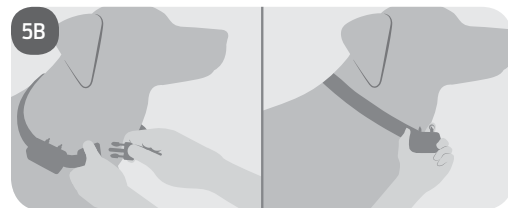
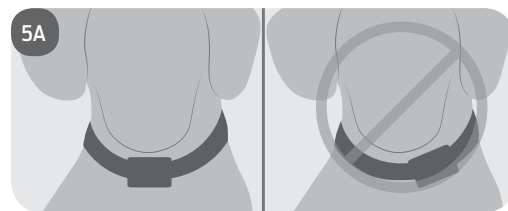

5. The receiver collar should fit snugly, yet loose enough to allow one finger to fit between a contact point and your pet's neck (**5B**).
6. Allow your pet to wear the collar for several minutes then recheck the fit. Check the fit again as your pet becomes more comfortable with the receiver collar.
7. Once you are satisfied with the fit of the receiver collar, then you may trim any excess collar strap as follows:
 - A. Mark the desired length of the receiver collar with a pen. Allow for growth if your pet is young or grows a thick winter coat.
 - B. Remove the receiver collar from your pet and cut off the excess.
 - C. Before placing the receiver collar back onto your pet, seal the edge of the cut collar by applying a flame along the frayed edge.
8. Put battery in receiver collar.

Re-Thread the Collar

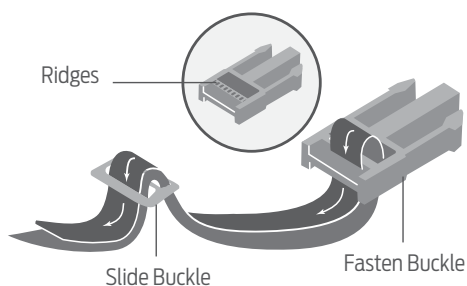

The Slide Buckle prevents the collar from becoming loose around your pet's neck.

The Ridges must be facing up; the collar will slip if it is not properly threaded.

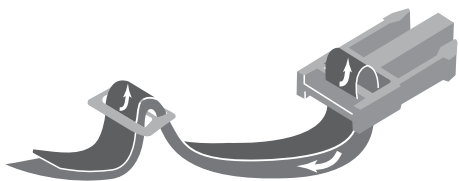

To loosen: Slide the strap through the Slide and Fasten Buckles and pull down.

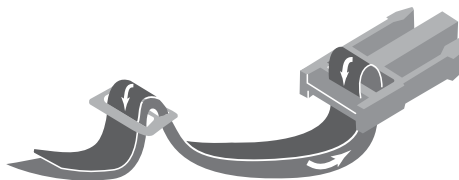

To tighten: Slide the strap up through the Fasten Buckle and pull through the Slide Buckle.

Training Guide

- Proper training of your pet is essential to the success of the system.
- Remove the collar after each training session.
- Be sure to place the collar on your dog's neck with the Premier Pet™ logo facing up.
- If your pet shows signs of stress, slow down the training schedule, add additional days of training or increase the amount of play time with your pet in the pet area. Common stress signals include the pet pulling on the leash toward the house, ears tucked or pulled back, tail down or tucked between legs, body lowered, nervous/frantic movement or stiffening of the pet's body, lip-licking or yawning.

Day 1

For the first day, start with the collar set to level 1, tone-only. With your pet on a leash and his favorite treats on hand, allow him to explore the pet area. Let him cross the boundary and hear the tone from the collar, then ask him to come back into the pet area and reward him. Aim to teach your dog that being inside the pet area is rewarding, while being outside it is not. Keep your mood upbeat as dogs can understand when you are happy or upset. Do 2 or 3 training sessions for about 10-15 minutes each. Do not try to do too much too quickly. More frequent short sessions are better than less frequent, longer sessions.

Days 2–4

On days 2 through 4, repeat this process but with the collar set to level 2: the mildest level of static correction. Observe whether or not your dog responds to the correction. Indicators of a response are looking around in curiosity, flicking his ears or scratching at the collar. If he does not respond, check the collar fit to make sure the contact points are making contact with his skin. If it fits correctly and your dog does not respond, move up to the next level and repeat the process. Do 2 or 3 training sessions for about 10-15 minutes each.

Days 5–8

On days 5 through 8, continue where you left off on day 4, but now add in some staged distractions. The goal is to have your pet stay within the boundary even with these new temptations. Start with lower value temptations and work your way up. Some examples are:

- Have a family member cross from inside the boundary out of it.
- Place a toy outside the boundary.
- Have a friend or neighbor walk another pet outside the boundary area.
- Remember, it is important to keep your pet on a leash throughout this process while he is still learning the boundary. Also, never coax your pet to leave the pet area.

Days 9–30

Once your pet consistently avoids the boundary regardless of distractions or temptations, he is ready for the next step: unleashed supervision. Stay close by with a leash at hand. Play with your pet for a while during the first few sessions. If your dog does not try to leave the boundary, occupy yourself with another task in the yard, and allow him to freely explore. Continue watching your pet. If he escapes, remove the receiver collar and lead him back into the pet area. Start these sessions at about 15 minutes and gradually work up to an hour or more.

When your pet proves trustworthy, you can let him out on his own. Continue to check on him regularly. You can remove every other boundary flag every 4 days until all the flags are removed. Save them in case you move or need to train another pet.

Wireless - To - Go

Your Premier Pet™ Wireless Fence is completely portable. Follow the set-up procedures wherever you wish to have containment of your pet. Reestablish the pet area and mark it with boundary flags so your pet knows his boundary zone. *NOTE: If setting up in a metal building or vehicle, the maximum size of the pet area may be reduced. Be sure to remove the receiver collar battery before turning off the fence transmitter. If you want to power the fence transmitter from a car or other DC source, use an inverter rated for 50 watts or more.*

FREQUENTLY ASKED QUESTIONS

Is the receiver collar waterproof?	<ul style="list-style-type: none"> Yes. When changing the battery, be sure to keep the battery area free from dirt and debris.
Will the Premier Pet™ Wireless Fence cover a larger circle than 180 ft. across?	<ul style="list-style-type: none"> You can use another Wireless fence transmitter with overlapping boundaries of at least 30 ft. to increase the size of the pet area.
Will a sloping yard or hills affect the pet area?	<ul style="list-style-type: none"> The fence transmitter signal extends 90 ft. in all directions. A sloping yard or a yard with hills can cause the pet area to appear less or more than expected. Consider repositioning the fence transmitter to maximize your pet area.
Can I use more than one receiver collar with the Wireless Fence transmitter?	<ul style="list-style-type: none"> Yes. There is no limit to the number of pets you can contain with the Wireless Fence transmitter. You must purchase an additional Wireless Fence receiver collar for each pet. Contact the Customer Care Center or visit our website to locate a retailer near you.
Will the Wireless Fence keep other pets out of my yard?	<ul style="list-style-type: none"> No. The Wireless Fence is only effective on pets who wear the receiver collar.
Is there a hand-held remote trainer that will work with the Wireless Fence receiver collar?	<ul style="list-style-type: none"> No. You would need to purchase a separate Remote Training System. Contact the Customer Care Center or visit our website to locate a retailer near you.
If I have a question about my Wireless Fence or need replacement parts, where can I get answers or service?	<ul style="list-style-type: none"> Contact the Customer Care Center or visit our web site.
Can I use the Wireless Fence on an aggressive pet?	<ul style="list-style-type: none"> We do not recommend using any electronic training devices on aggressive pets. If you are unsure if your dog is aggressive, please consult your veterinarian or a certified trainer.
Can I use the Wireless Fence on a cat?	<ul style="list-style-type: none"> The Wireless System can be used as long as the cat can comfortably wear the receiver collar.
What happens if the power goes out?	<ul style="list-style-type: none"> The Wireless System is designed to recognize power outages and shuts down without activating the receiver collar. However, if your pet is near the boundary zone during the power failure, he may receive a static correction.
What can happen if I turn off or unplug the fence transmitter power?	<ul style="list-style-type: none"> If your dog is wearing the receiver collar, he may receive an unintended correction. Always remove your dog's receiver collar before removing power from the fence transmitter or before performing any fence transmitter testing.
What if I lose the clear plastic cover for the correction level button?	<ul style="list-style-type: none"> The clear plastic cover prohibits the static correction level from accidentally being changed and also helps keep the receiver waterproof. Contact the Customer Care Center for a replacement.
If my pet leaves the pet area, how long will he be corrected?	<ul style="list-style-type: none"> Your pet will receive static correction as long as he is outside the pet area, for up to 30 seconds. The receiver collar has a safety time-out to stop correcting and toning after 30 seconds until it is returned to the pet area.
How often do I need to replace the receiver collar battery?	<ul style="list-style-type: none"> Battery life depends on how frequently your pet tests the boundary zone. The receiver indicator light acts as a low battery indicator, flashing every 4 to 5 seconds when replacement is required. Typical battery life lasts 1- 2 months.

FREQUENTLY ASKED QUESTIONS

<p>Can I place the receiver on another collar?</p>	<ul style="list-style-type: none"> • Yes. You may use any non-metallic collar. Make 2 holes in the collar to attach the receiver. Use the collar in the kit as a template to locate the holes on the new collar.
<p>Do I need to perform maintenance on my Wireless Pet Fence?</p>	<ul style="list-style-type: none"> • Check your pet's neck daily for irritation from the contact points. • Check the contact points on the receiver collar weekly to make sure they are tight and clean. • Check the fit of the receiver collar weekly. • The receiver indicator light acts as a low battery indicator, flashing every 4 to 5 seconds when replacement is required.
<p>How do I know the battery in the receiver collar is still working?</p>	<ul style="list-style-type: none"> • Take the receiver collar off your pet and walk into the boundary zone. The receiver collar should tone. If not, replace the battery.
<p>Will vehicles, buildings and landscape features (trees, shrubs, etc.) affect the performance of the Wireless Pet Fence?</p>	<ul style="list-style-type: none"> • Yes. Placing the fence transmitter inside a metal building can reduce the maximum range of the Wireless System. • Parking a vehicle within the pet area, can reduce the range of the system and cause your pet to receive a static correction where it otherwise would not if the vehicle was not there. • Fixed large metal objects such as metal sheds can affect the signal by reducing the maximum range of the system at the location of the object. As a result, your pet may receive a static correction.
<p>What do I do if my pet's neck becomes red and irritated?</p>	<ul style="list-style-type: none"> • This condition is due to the contact points irritating the skin. Discontinue use of the receiver collar for a few days. If the condition persists beyond 48 hours, see your veterinarian. Once the skin returns to normal, replace the receiver collar and monitor the skin condition closely.
<p>Can I attach a leash to the receiver collar?</p>	<ul style="list-style-type: none"> • No. This can result in pulling the contact points too tightly against your pet's neck. Attach a leash to a separate, non-metallic collar positioned above the receiver collar.
<p>Why does my receiver collar have a tone-only mode?</p>	<ul style="list-style-type: none"> • The tone-only mode can be used in training your pet to his boundary or for well-trained pets that no longer require static correction.

TROUBLESHOOTING

<p>The receiver collar is not beeping when setting up the boundary zone.</p>	<ul style="list-style-type: none"> • The tone may be difficult to hear in a noisy environment. • Use test light as explained in the "Test Light Instructions" section, and use it to determine the location of boundary zone. • Check that the fence transmitter is set up according to directions and install a new battery while standing within 5 to 10 ft. of the fence transmitter.
<p>The receiver collar is not beeping or administering a static correction.</p>	<ul style="list-style-type: none"> • Check that the fence transmitter is plugged into a working outlet, turned on, the power light is on, and the fence transmitter controls are set at your desired settings. • Check receiver battery to make sure it is installed properly. • When replacing the battery, do so while standing within 5 to 10 ft. of the fence transmitter.

TROUBLESHOOTING

<p>The receiver collar is beeping everywhere.</p>	<ul style="list-style-type: none"> ▪ Check that the fence transmitter is plugged into a working standard outlet, turned on, the power light is on, and the fence transmitter controls are set at your desired settings. ▪ Bring receiver collar while standing within 5 to 10 ft. of the fence transmitter to reset.
<p>The receiver collar is beeping inside the house.</p>	<ul style="list-style-type: none"> ▪ It is recommended to remove the receiver collar from your pet when indoors to avoid activation of the receiver collar. ▪ Make sure the fence transmitter is on and set up according to the directions. ▪ Ensure the entire house is within the pet area. The fence transmitter may need to be moved to adjust the pet area to include the entire house. ▪ If relocating the fence transmitter, remove the receiver collar from your pet before turning the fence transmitter off.
<p>My pet is receiving a static correction in his metal crate.</p>	<ul style="list-style-type: none"> ▪ The receiver collar activates when it loses the fence transmitter signal. The metal crate may block the fence transmitter signal which causes the receiver collar to activate. ▪ Remove the receiver collar from your pet when placing him in his metal crate.
<p>The boundary zone seems to fluctuate.</p>	<ul style="list-style-type: none"> ▪ This is normal for the electro magnetic field of the Wireless System. The field may be affected by surrounding “electronic noise,” which can cause it to fluctuate up to 5%. ▪ Where the receiver collar activates is influenced by the speed and orientation of the receiver collar as your pet enters the boundary zone.
<p>The receiver collar activates in the middle of the yard.</p>	<ul style="list-style-type: none"> ▪ The receiver collar activates when it loses the fence transmitter signal. This sometimes occurs if a large metal object is between the receiver collar and fence transmitter, if the orientation of the receiver collar changes near the boundary zone, or if the surrounding “electronic noise” interferes with the signal. If this continues to occur, consider relocating the fence transmitter and resetting the pet area.
<p>The receiver collar is beeping but my pet is not responding to the static correction.</p>	<ul style="list-style-type: none"> ▪ Make sure the static correction level is set at 2 or above. ▪ Test the receiver collar with the test light. ▪ If the test light flashes, check the fit of the receiver collar. ▪ Trim your pet’s fur where the contact points touch the neck and/or switch to the longer contact points. ▪ Increase the static correction level. ▪ Repeat training steps to reinforce training.
<p>My pet reacts strongly to the static correction and has become fearful.</p>	<ul style="list-style-type: none"> ▪ Lower the static correction level. ▪ Make sure you are in control of the situation when your pet receives his first static corrections (have him on a leash attached to a separate, non-metallic collar) and lead him into the pet area and praise him. If your pet remains fearful, suspend training and start again the next day. Make sure to end all training sessions on a positive note with lots of praise and play.
<p>The power light is not on.</p>	<ul style="list-style-type: none"> ▪ Make sure the fence transmitter On/Off Switch is on and the power adapter is plugged into the fence transmitter and a working standard outlet.

TROUBLESHOOTING

I was setting up the pet area and after I turned down the boundary control dial, the receiver collar would no longer beep or correct.

- You may have turned the boundary control dial down too quickly, causing the receiver collar to go into power-fail mode. This is a safety feature designed to protect your pet when power to the fence transmitter goes out. With the receiver collar while standing within 5 to 10 ft. meters of the fence transmitter, turn the boundary control dial to 8 and reset the boundary zone, making sure to turn the dial down slowly.

My next-door neighbor has an In-Ground Containment System and the receiver collar does not activate near their property.

- Your neighbor's In-Ground Fence signal may interfere with the operation of the receiver collar preventing activation close to their fence. To minimize the interference, reduce the size of the pet area or move the fence transmitter away from the In-Ground Fence System.
- Adjust the pet area so that the receiver collar activates for at least 5 ft. beyond the reduced boundary setting when walking towards the In-Ground Fence.

The receiver collar has injured my pet's neck.

- Failing to follow the important safety information at the front of the Operating and Training Guide has caused pressure ulcers. Some descriptions of advanced pressure ulcers describe the sores as looking like burns on the dog's neck. Be assured that electronic collars do not use enough energy to create electrical burns. The energy in an output pulse is only a few thousandths of a Joule; it is similar in nature to the static pulse that you may feel when getting out of your car. In some cases, pressure ulcers are described as chemical burns. The battery is sealed when installed in the receiver collar housing. This sealing makes it virtually impossible, without misuse or abuse, for your receiver collar battery to leak onto your pet's neck. Please review and follow the important safety information at the front of this guide and the instructions under the heading "Fit the receiver collar."

Terms of Use and Limitation of Liability

1. **Terms of Use**

This Product is offered to you conditioned upon your acceptance without modification of the terms, conditions and notices contained herein. Usage of this Product implies acceptance of all such terms, conditions, and notices.

2. **Proper Use**

This Product is designed for use with pets where training is desired. The specific temperament of your pet may not work with this Product. If you are unsure whether this is appropriate for your pet, please consult your veterinarian or certified trainer.

3. **No Unlawful or Prohibited Use**

This Product is designed for use with pets only. This pet training device is not intended to harm, injure or provoke. Using this Product in a way that is not intended could result in violation of Federal, State or local laws.

4. **Limitation of Liability**

In no event shall Radio Systems Corporation be liable for any direct, indirect, punitive, incidental, special or consequential damages, or any damages whatsoever arising out of or connected with the use or misuse of this Product. Buyer assumes all risks and liability from the use of this Product.

5. **Modification of Terms and Conditions**

Radio Systems Corporation reserves the right to change the terms, conditions and notices under which this Product is offered.

Warranty

One Year Non-Transferrable Limited Warranty

This Product has the benefit of a limited manufacturer's warranty. Complete details of the warranty applicable to this Product and its terms can be found at premierpet.com.

Perchlorate Battery

Perchlorate Material – special handling may apply. See www.dtsc.ca.gov/hazardouswaste/perchlorate.



Battery Disposal

Separate collection of spent batteries is required in many regions; check the regulations in your area before discarding spent batteries. The collar receiver operates on a 6-volt lithium coin cell battery. Replace only with equivalent battery available from the Customer Care Center. For a listing of Customer Care Center telephone numbers in your area, visit www.premierpet.com.

Compliance FCC

This device complies with part 15 of the FCC Rules. Operation is subject to the following two conditions: (1) This device may not cause harmful interference, and (2) this device must accept any interference received, including interference that may cause undesired operation.

NOTE: This equipment has been tested and found to comply with the limits for a Class B digital device, pursuant to part 15 of the FCC Rules. These limits are designed to provide reasonable protection against harmful interference in a residential installation. This equipment generates, uses, and can radiate radio frequency energy and, if not installed and used in accordance with the instructions, may cause harmful interference to radio communications. However, there is no guarantee that interference will not occur in a specific installation. If interference does occur to radio or television reception, which can be determined by turning the equipment off and on, the user is encouraged to try to correct the interference by one or more of the following measures:

- Reorient or relocate the receiving antenna.
- Increase the separation between the equipment and the receiver.
- Connect the equipment to an outlet on a circuit different from that to which the receiver is connected.
- Consult customer care, the dealer, or an experienced radio/TV technician for help.

CAUTION: Modification or changes to this equipment not expressly approved by Radio Systems Corporation may void the user's authority to operate the equipment.

For a list of patents protecting this product, please visit: <http://www.radiosystemscorporation.com/patents>

Premier PetTM



Mounting Template

6.75 inches

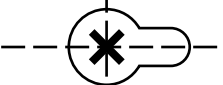
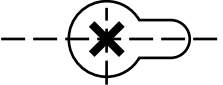

Premier PetTM

Radio Systems Corporation
10427 PetSafe Way | Knoxville, TN 37932 | +1 (866) 381-2785 | premierpet.com
L400-2382
©2019 Radio Systems Corporation