

2.4 GHz Wireless Keyboard Mouse

User's Manual

Be sure to carefully read this User's Manual for the proper use and keep it for future reference.



Thank you for choosing this **2.4GHz Wireless Keyboard Mouse**. This genuinely palm-sized 3-in-1 device has three (3) function including standard American QWERTY keyboard, Laser mouse, Multi-touchpad and Presentation control. With our superb 2.4GHz technology, the wireless control distance is **up to 70 meters** (line of sight) with extreme low power consumption. Please read through this manual and then start enjoying the marvel and convenience this device brings at home, office or on travel.

©2010 All rights reserved.

FEDERAL COMMUNICATIONS COMMISSION

This device complies with Part 15 of the FCC Rules. Operation is subject to the following two conditions:(1) this device may not cause harmful interference, and (2) this device must accept any interference received, including interference that may cause undesired operation.

NOTE

This equipment has been tested and found to comply with the limits for a Class B digital device, pursuant to Part 15 of the FCC Rules. These limits are designed to provide reasonable protection against harmful interference in a residential installation. This equipment generates, uses and can radiated radio frequency energy and, if not installed and used in accordance with the instructions, may cause harmful interference to radio communications. However, there is no guarantee that interference will not occur in a particular installation. If this equipment does cause harmful interference to radio or television reception, which can be determined by turning the equipment off and on, the user is encouraged to try to correct the interference by one or more of the following measures:

- Reorient or relocate the receiving antenna.
- Increase the separation between the equipment and receiver.
- Connect the equipment into an outlet on a circuit different from that to which the receiver is connected.
- Consult the dealer or an experienced radio/TV technician for help.

Changes or modifications not expressly approved by the party responsible for compliance could void the user's

authority to operate the equipment.

EU DECLARATION OF CONFORMITY

This product: is carrying the CE-Mark in accordance with the related European Directives.

TRADEMARKS

Windows are registered trademark of Microsoft Corporation.

Package Contents

1. Wireless Keyboard Mouse	X	1
2. USB Receiver (Embedded onto the battery cover)	X	1
3. BL-5C Rechargeable Battery	X	1
4. Mini USB Charging Cable	X	1
5. User's Manual	X	1

System Requirements

- Windows® 2000 / XP / Vista™ / 7
- An available USB port in PC

Getting Started

1. Plug the USB receiver to PC USB port

Take out the USB receiver embedded onto the battery cover and plug the USB receiver to your PC USB port.

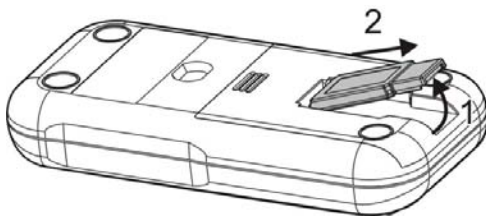

Steps of taking out USB receiver

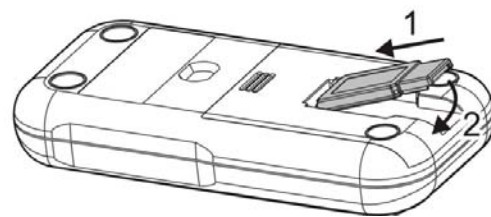

Steps of inserting USB receiver

2. Insert the battery

Slightly press and slide the battery cover and insert the battery firmly with the correct polarity. Replace the battery cover firmly back into place.

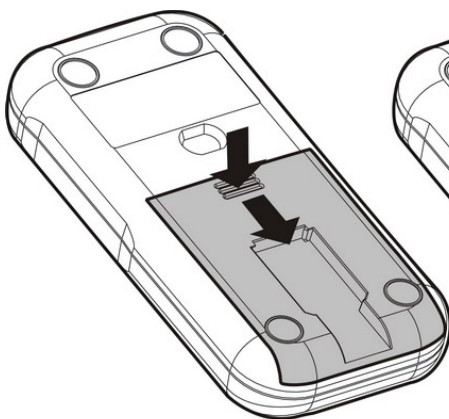

Slightly press and slide the battery cover

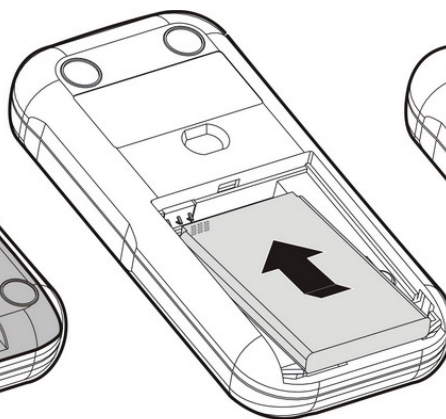

Insert the battery

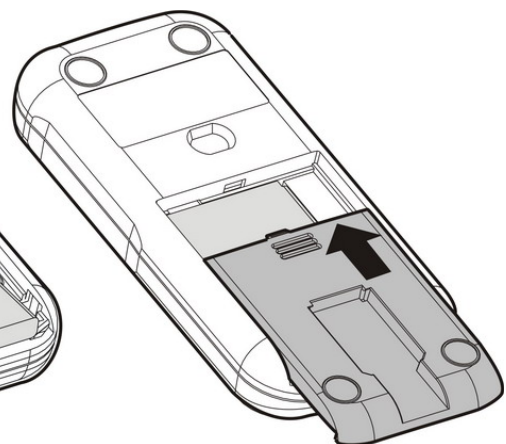

Replace the battery cover

Special notice

Before 1st time use, please connect the battery charging cable to charge the battery

about 2 hours. See the introduction of **“Low Battery Indication and Charge Battery”** for battery charging.

Now you can start to use this Wireless Keyboard Mouse. Please note that the default mode of computer mouse is at Multi-Touchpad. For details of mouse mode change and other function and operation, please read the introduction of **“Function and Operation”**.

Function and Operation

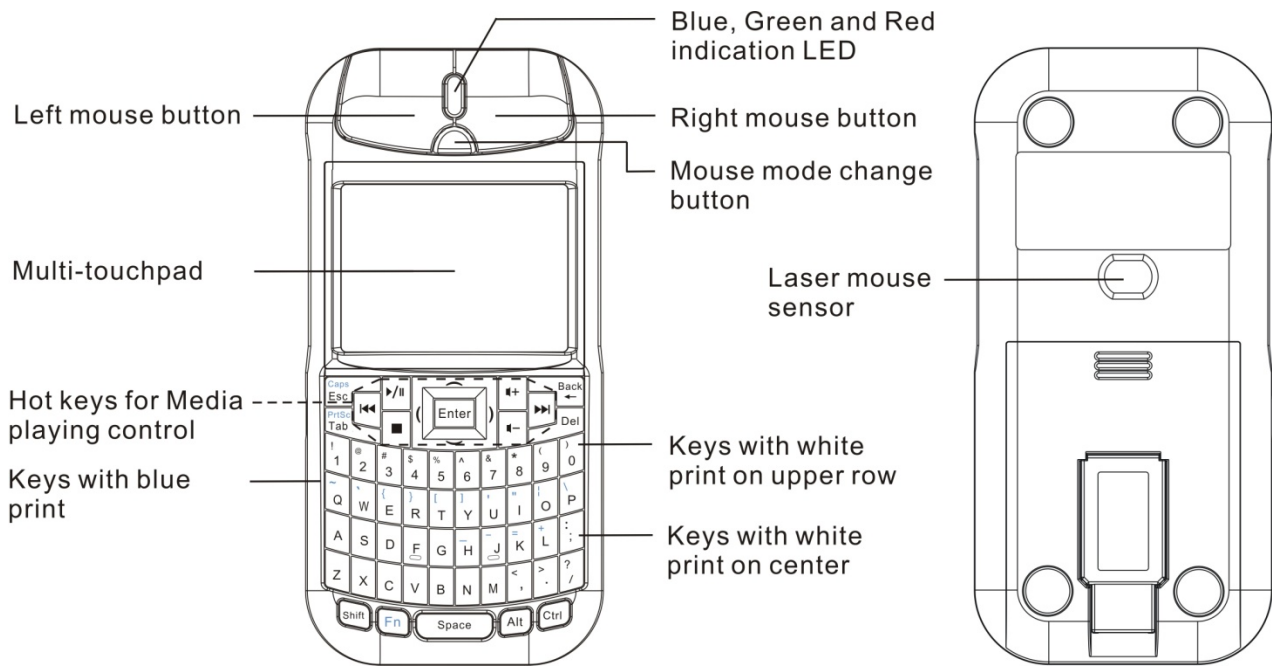

Images of Laser mouse operation

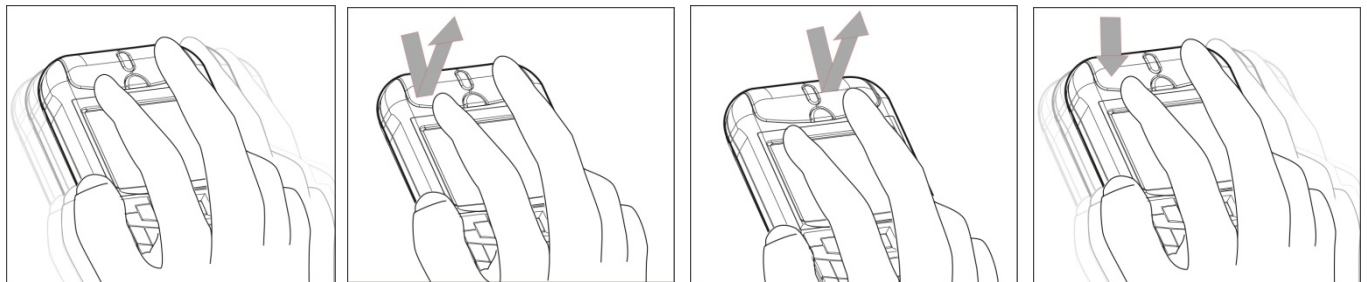

Move cursor (Fig 1)

Left click (Fig 2)

Right click (Fig 3)

Drag : Press left mouse and move (Fig 4)

Images of Multi-touchpad operation

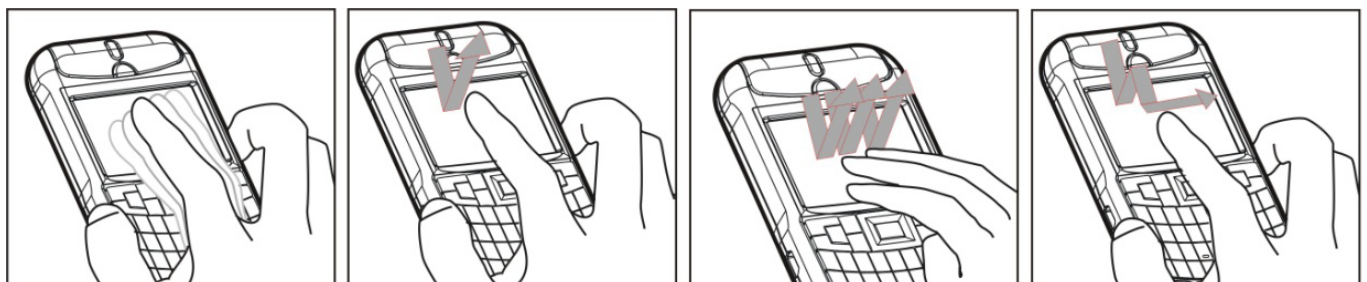

Move cursor (Fig 5)

Left click (Tap) (Fig 6)

Right click : Three fingers tap simultaneously

Drag : Tap-and-slide



Scroll (Fig 9)

1. QWERTY keyboard

QWERTY keyboard function is always available no matter the computer mouse is set at Laser mouse mode or Multi-touchpad mode or even mouse function is turned off.

Key print	Function and Operation
White print on key center	Directly press the key to have print function
White print on upper row	Press and hold "Shift" key and then press the key to have print function
Blue print on key upper row	Press and hold "Fn" key and then press the key to have print function
F1~F10 function (numeral key 1~10)	Press and hold "Fn" key, then press the numeral key 1~10 to have F1~F10 function
Media playing control hot keys	When at Media playing application, directly press the key to have print function (Note 4 arc-shape keys around "Enter" key i.e. "() ^ _ " have the same function as 4 arrow keys i.e. "←→↑↓" on PC keyboard.)

Note1 The "Alt" key is normal "Alt" function, not "Alt Gr" function. You can press "Ctrl+Alt" together to have "Alt Gr" function.

Note2 Only 8 keys including "Back", "Del", 4 arc-shape keys "() ^ _ ", "⏪" and "⏩" have repeated function when they are press-and-hold.

2. Laser mouse (Match with blue indication LED)

When switch to Laser mouse mode, not only main / left / right mouse but also part of multi-touchpad function can be used.

Function	Operation
Mouse mode change	(1) Press and hold this button until blue and green LEDs both light up (PS : It may look like white LED) to turn off mouse function. Click this button to turn on mouse function at default Multi-touchpad mode (Note 1~2 seconds is needed to activate touchpad function from mouse off mode). Note Keyboard function is still available even mouse function is turned off. (2) When the mouse function is activated, click the button to switch modes between Laser mouse and Multi-touchpad.
Blue indication LED	Light up when mouse or touchpad is under use
Cursor move	See Fig 1
Left mouse click	See Fig 2 and Fig 6 Note At Laser mouse mode, left click function can be operated by above either way
Right mouse click	See Fig 3
Mouse drag	See Fig 4 and Fig 8 Note At Laser mouse mode, drag function can be operated by above either way

Scroll	See Fig 9 Note Two (2) fingers <u>simultaneously</u> slides (or one finger puts on touchpad while the other finger slides) up or down on touchpad.
Mouse dpi selection	Press and hold “ Fn ” key and then click the mouse mode change button to change mouse dpi among 1700, 2500 and 3400 Note This dpi selection function is only available at Laser mouse mode. Default dpi is 3400. Take out and insert battery again, mouse dpi will return to default figure.





3. Multi-touchpad (Match with **green** indication LED)

When you switch to Multi-touchpad mode, not only touchpad but also left / right mouse buttons can be used.

Function	Operation
Mouse mode change	Please refer to the “ Mouse mode change ” at the introduction “ 2. Laser mouse ”
Green indication LED	Light up when touchpad is under use
Cursor move	See Fig 5
Left mouse click	See Fig 2 and Fig 6 Note At Multi-touchpad mode, left click function can be operated by above either way
Right mouse click	See Fig 3 and Fig 7 Note At Multi-touchpad mode, right click function can be operated by above either way.
Mouse drag	See Fig 8
Scroll	See Fig 9 Note Two (2) fingers <u>simultaneously</u> slides (or one finger puts on touchpad while the other finger slides) up or down on touchpad.

4. Presentation control device

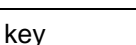
Use this product at PowerPoint slide show as wireless presentation remote. Turn to the slide page of PowerPoint file you want to present and let it at slide start screen (i.e. full screen). Use following keys and buttons to enjoy a wireless and my-pace slide show.

Key or button	Function and Operation
Fn + 5	Press and hold Fn , then press the numeral key “ 5 ” to have “ F5 ” function to start the slide show
Caps Esc	Click this key to exit slide show
Left mouse button  or 	Click any of left button or key to go to next slide
 or 	Click either key to go to previous slide
B key	Click this key to show black screen : click again to come back
W key	Click this key to show white screen : click again to come back
PrtSc “ Tab + Alt ” keys	Press and hold “ Alt ” key and then click “  ” key to cruise all opened files one by one. When cruising at the file you want to switch, just release 2 keys and file will be switched. Use the same process to other file or return to slide show

Low Battery Indication and Charge Battery

1. Low battery indication

When battery power is detected at low capacity, press any key, button or touchpad of keyboard mouse, its **red** indication **LED** will light up to remind you battery power is low. Please charge the battery soon to have a stable performance.

2. Charge battery

Connect supplied battery charging cable between this product and the USB port in your PC to charge the battery. During charging, red LED will regularly blink and when the battery is fully charged, the red LED will off.

Note Battery charging time depends on remaining battery power, operation condition and working environment etc. Besides, the rechargeable battery has a certain life of charging cycles and when you find charging time becomes extra longer, you may need to replace with new rechargeable battery.

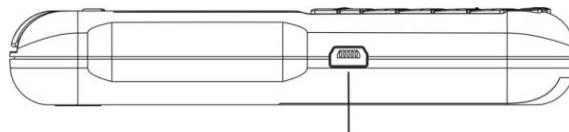

Connection port for battery

ID Pairing

Note No need to conduct ID pairing whenever you want to use this product, **UNLESS** following operation situation.

Battery power is normal and keyboard mouse and USB receiver is within connection distance but the product cannot be operated OR when you want to use plural of this product at the same time. You need to conduct ID pairing with following two (2) steps to shun interference :

- (1) Click the ID Link button on USB receiver and its red LED will light up and enter into **20-second** ID pairing stand-by time. **Note** If pressing again the ID Link button during 20-second stand-by time, ID pairing action will be discontinued.
- (2) Within the 20-second stand-by time, press the pairing button in the battery chamber of keyboard mouse until the red LED of USB receiver becomes blinking for 3 times which means the ID pairing has been successfully done.

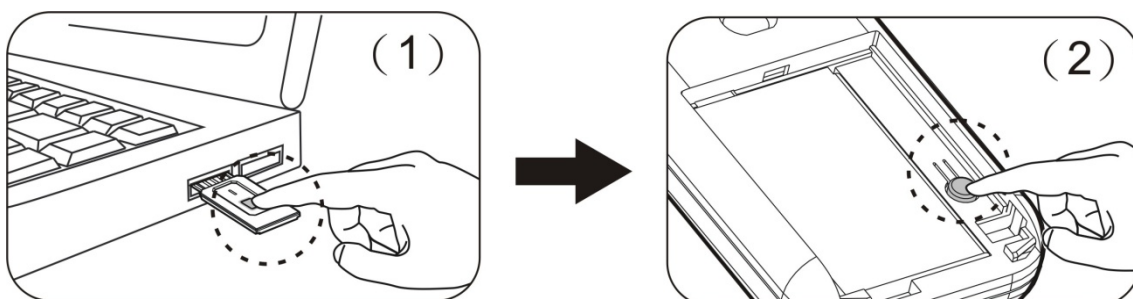

Specifications

Frequency	2400 ~ 2483 MHz
Channel number	16
ID number per Channel	65,535
Modulation	GFSK
Antenna type	PCB track
Wireless range	Up to 230 feet (70 meters) (line of sight)
Working voltage	DC 3.0V ~ 3.8V
Battery	BL-5C 850mA-hour Li-Ion rechargeable battery
Transmission power	1mW
Power consumption / Battery continuous operation hours	Standby(Non-operation) : 0.4mA / 2125 hour
	Keyboard mode : 1mA / 850 hours
	Touchpad mode : 10mA / 85 hours
	Laser mouse & Touchpad mode : 30mA / 28.3 hours
Weight	About 92 grams (including BL-5C battery and USB receiver)
Dimension	Approximately 116 (L) x 56 (W) x 19.8 (H) mm
Operation temperature	0°C(32°F)~60°C (140°F)
Operation humidity	10%~85% RH

FAQ

Q1. Need to install software before using this product?

A: No need. This is Plug-and-Play product.

Q2. Why sometimes touchpad can not be operated smoothly?

A: Touchpad is quite sensitive about moistness. In order to have a stable performance on touchpad, please always keep touch finger(s) dry.

Q3. Can not control laser mouse, touchpad and keyboard

A: It may be caused by low battery or interference by other 2.4GHz product. Please see introductions "**Low Battery Indication and Charge Battery**" and "**ID Pairing**" to verify and resolve.

Q4. Possible to know the mouse dpi?

A: It is no way to know mouse dpi and you can only feel laser mouse speed after selected dpi.

Patent Pending