

## FCC Information

**WARNING**  
**RISK OF ELECTRIC SHOCK.**  
**DO NOT OPEN**

This symbol indicates "dangerous voltage" inside the product that presents a risk of electric shock or personal injury.

To reduce risk of electrical shock, do not remove cover or back (no user serviceable parts inside). Refer servicing to qualified personnel.

This symbol indicates important instructions accompanying the product.

## FCC INFORMATION

**NOTE:** This equipment has been tested and found to comply with the limits for a Class B digital device, pursuant to Part 15 of the FCC Rules. These limits are designed to provide reasonable protection against harmful interference in a residential installation. This equipment generates, uses and can radiate radio frequency energy and, if not installed and used in accordance with the instructions, may cause harmful interference to radio communications. However, there is no guarantee that interference will not occur in a particular installation. If this equipment does cause harmful interference to radio or television reception, which can be determined by turning the equipment off and on, the user is encouraged to try to correct the interference by one or more of the following measures:

- Reorient or relocate the receiving antenna.
- Increase the separation between the equipment and receiver.
- Connect the equipment into an outlet on a circuit different from that to which the receiver is connected.
- Consult the dealer or an experienced radio/TV technician for help.

**WARNING:** Changes or modifications to this unit not expressly approved by the party responsible for compliance could void the user's authority to operate the equipment.

This class B digital apparatus meets all requirements of the Canadian Interference-Causing Equipment Regulations.

The Shock Hazard Marking and Associated Graphical Symbol is provided on the bottom panel of the unit. Refer to the identify cautioning label located on the back panel of your product for its proper operating voltage.

**IMPORTANT:** The power cord can be unplugged from the main power to the unit. It should also be easily accessible in an emergency.

**WARNING:** To reduce the risk of fire or electric shock, do not expose this apparatus to rain or moisture.

## For Your Safety

The AC power plug is polarized (one blade is wider than the other) and only fits into AC power outlets one way. If the plug won't go into the outlet completely, turn the plug over and try to insert it the other way. If it still won't fit, contact a qualified electrician to change the outlet, or use a different one. Do not attempt to bypass this safety feature.

**CAUTION:** To prevent electric shock, match wide blade of plug to wide slot, fully insert.

## Technical Specification

Product: Audio Receiver with Dolby Digital  
Brand: RCA  
Model: RT2870

## Electrical Consumption

Power Supply: 120V ~ 60Hz  
Power consumption: 90 Watts

This audio system has earned the ENERGY STAR.

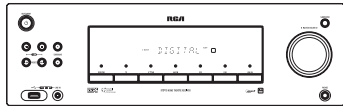

It is important to read this instruction book prior to using your new product for the first time.

## EXPORTER

RVC Multimedia Inc.  
Unit 6, 170 Esna Park Drive,  
Northham, Ontario L3R 1E3  
© 2008 AVC Multimedia Inc.  
Trademark (R) Registered  
Marcado (R) Registrado  
Marques (R) Depositee  
www.rcaaudiovideo.com  
Printed in China / Impreso en China

RT2870 V1.1.3 (EN)

## Important Safety Instructions

### Please read and save for future reference

Some of the following information may not apply to your particular product; however, as with any electronic product, precautions should be observed during handling and use.

- Read these instructions.
- Keep these instructions.
- Heed all warnings.
- Follow all instructions.
- Do not use this apparatus near water.
- Clean only with dry cloth.
- Do not block any ventilation openings. Install in accordance with the manufacturer's instructions.
- Do not install near any heat sources such as radiators, heat registers, stoves, or other apparatus (including amplifiers) that produce heat.
- Do not defeat the safety purpose of the polarized or grounding-type plug. A polarized plug has two blades with one wider than the other. A grounding-type plug has two blades and a third grounding prong. The wide blade or the third prong is provided for your safety. If the provided plug does not fit into your outlet, consult an electrician for replacement of the obsolete outlet.
- Protect the power cord from being walked on or pinched particularly at plugs, convenience receptacles, and the point where they exit from the apparatus.
- Only use attachments/accessories specified by the manufacturer.
- Use only with the cart, stand, tripod, bracket, or table specified by the manufacturer, or sold with the apparatus. When a cart is used, use caution when moving the cart/apparatus combination to avoid injury from tip-over.

- Unplug this apparatus during lightning storms or when unused for long periods of time.
- Refer all servicing to qualified service personnel. One qualified service person, one pair of rear speakers, one center speaker and one subwoofer.
- One pig tail antenna wire
- One AM loop antenna
- One 3.5mm stereo cable for line-in
- One Quick Start Guide

**Additional safety information**

- Apparatus shall not be exposed to dripping or splashing and no objects filled with liquids, such as vases, shall be placed on the apparatus.
- Always leave sufficient space around the product for ventilation. Do not place product in or on a bed, rug, in a bookcase or cabinet that may prevent air flow through vent openings.
- Do not place lighted candles, cigarettes, cigars, etc. on the product.
- Connect power cord only to AC power source as marked on the product.
- Care should be taken so that objects do not come in contact with the product.
- Do not attempt to disassemble the cabinet. This product does not contain customer serviceable components.

**If your product operates on batteries, adhere to the following precautions:**

- Any battery may leak electrolyte if mixed with a different battery type, if inserted incorrectly, or if all batteries are not replaced at the same time.
- Any battery may leak electrolyte or explode if discharged, or if an attempt is made to charge a battery not intended to be recharged.
- Circular leaky batteries immediately. Leaking batteries can cause skin burns or other personal injury. When discarding batteries, be sure to dispose of them in the proper manner, according to your state/provincial and local regulations.
- Battery shall not be exposed to excessive heat such as sunshine, fire or the like

**Protect your components from overheating**

- Do not block ventilation holes in any component. Arrange the components so that air can circulate freely.
- Do not stack components directly on top of each other.
- Do not place the unit near other components that generate heat such as heating vents.
- Allow adequate ventilation when placing your components in a stand.
- Place an amplifier near the top shelf of the stand so heated air rising from it will not affect other components. If you have a satellite receiver, you should place it on the top shelf.

**Protect your components from overheating**

- Do not block ventilation holes in any component. Arrange the components so that air can circulate freely.
- Do not stack components directly on top of each other.
- Do not place the unit near other components that generate heat such as heating vents.
- Allow adequate ventilation when placing your components in a stand.
- Place an amplifier near the top shelf of the stand so heated air rising from it will not affect other components. If you have a satellite receiver, you should place it on the top shelf.

**Protect your components from overheating**

- Do not block ventilation holes in any component. Arrange the components so that air can circulate freely.
- Do not stack components directly on top of each other.
- Do not place the unit near other components that generate heat such as heating vents.
- Allow adequate ventilation when placing your components in a stand.
- Place an amplifier near the top shelf of the stand so heated air rising from it will not affect other components. If you have a satellite receiver, you should place it on the top shelf.



## Connections and Setup

### Digital Connections

The digital audio jacks can accept Dolby Digital (AC-3) or PCM signals when compatible components are connected.

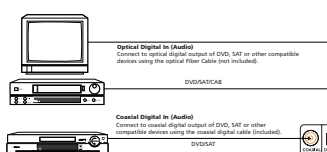

### TV Connections

TV's with RF input may accept a RF modulator (not included) for inputting audio signals.

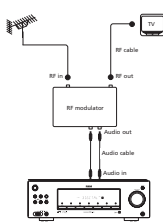

The illustration shown above may vary from your actual RF modulator; please refer to your RF modulator manual.

## Connections and Setup

### Content of Box

- One main unit
- One remote control with batteries
- One pair of front speakers, one pair of rear speakers, one center speaker and one subwoofer
- One pig tail antenna wire
- One AM loop antenna
- One 3.5mm stereo cable for line-in
- One Quick Start Guide

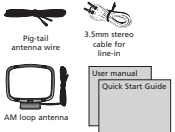
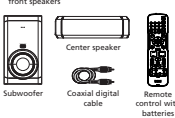
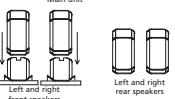

## Connections and Setup

### Positioning Speakers

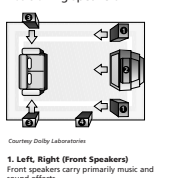

- 1. Left, Right (Front Speakers)**  
Front speakers carry primarily music and sound effects.
- 2. Center**  
In surround mode, the center speaker carries the most of the dialog as well as music and effects. It should be set between the left and right speakers.
- 3. Surround (Rear Speakers)**  
The rear speakers' overall sound balance should be as close as possible to the front speakers. Proper placement is vital to establish an evenly distributed sound field.

**Subwoofer**  
A subwoofer is designed to reproduce powerful low bass effects (Explosions, the rumble of spaceships, etc.) which dramatically heighten the action on the screen.

**Magnetic Shielding**  
Speakers placed less than two feet from the TV set must be magnetically shielded in order to prevent picture distortion. Front speakers provided with this unit are magnetically shielded to protect your TV set.

**Note:** Place the rear speakers and subwoofer a foot or more away from TV when using the Front Surround sound Effect (PSE).

## Connections and Setup

### Connecting to Audio Components

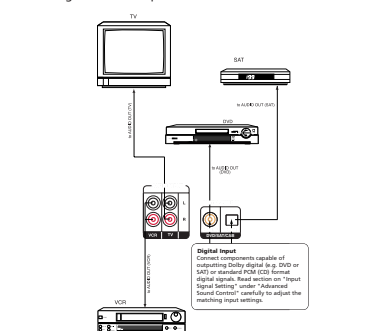

**Digital Connection**  
• This unit provides one optical and one coaxial digital input jacks for the connection of your components.  
• To connect a SAT receiver or DVD player with a digital output, use an optical digital cable (not included) or coaxial digital cable (included) to carry the digital signal and enjoy Dolby Digital sound quality.  
• One optical or coaxial cable is needed for each SAT receiver or DVD player.

**Note:** Optical and coaxial cables carry only the audio portion of the signal.

## Connections and Setup

### Better Surround Placement

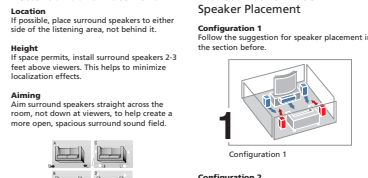

### Alternative Surround Placement

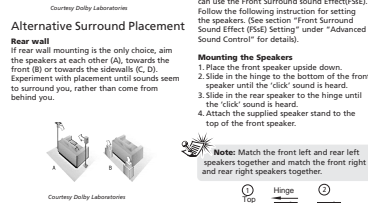

**No adjacent walls**  
Surround speakers can go on stands facing each other to approximate sidewall mounting (A), or to the sides or rear of the viewing area, aimed upwards; they can go right on the floor, or preferably, a few feet off the floor such as on end tables (B).

## FCC Information

**Service Information**  
This product should be serviced only by those specially trained in appropriate servicing techniques. For instructions on how to obtain service, refer to the warranty included in this user manual.

## Connecting for Power

Make sure you connect all your other electronic components and the speakers before plugging your unit into the outlet. Plug the power cord in the wall outlet, matching the wide blade of the plug with the wide slot in the outlet. Be sure to insert the plug completely.

## Headset Safety

- Do not play your headset at a high volume. Hearing experts warn against extended high-volume play.
- If you experience a ringing in your ears, reduce volume or discontinue use.
- You should use extreme caution or temporarily discontinue use in potentially hazardous situations.
- Even if your headset is an open air type designed to let you hear outside sounds, don't turn up the volume so high that you are unable to hear what is around you.
- Excessive sound pressure from earphones and headphones can cause hearing loss.

## Connections and Setup

### Connecting the Speakers

Speaker wires are color-coded to match the terminals. Connect the speaker wire from the back of each speaker to the corresponding color terminal at the back of the unit. Press down the tab to open the terminal and insert the wire. Release the tab to lock wire in the terminal.

When connecting subwoofer, connect subwoofer control cable (red/black striped) at the back of the subwoofer to the subwoofer control jack on the unit's rear panel, then press **POWER ON/OFF** on the subwoofer speaker to turn it on.

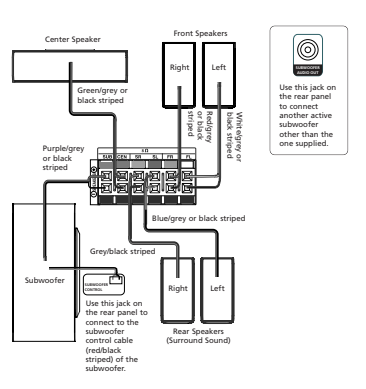

## Connections and Setup

### Front Surround Mode Speaker Placement

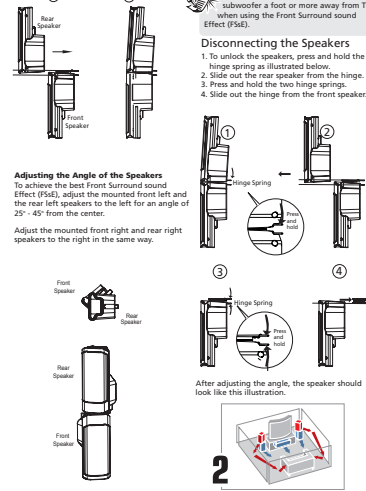

## General Controls

### Main Unit

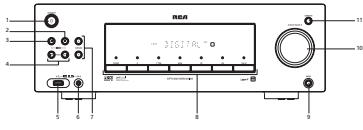

**1. ON/STANDBY**  
Turns off the unit. When the unit is turned on, the unit will go to the mode it was in before powered off.

**2. HI**  
Starts and pauses playback in USB mode.

**3. ■**  
Stops playback in USB mode.

**4. [PRESET]**  
Selects preset stations in AM/FM mode. Directly accesses the previous or next track in USB mode.

**5. USB Jack**  
Connects USB devices.

**6. LINE IN**  
Connects components for audio input.

**7. ▲/▼ (SURROUND)**  
Selects among digital surround systems (STEREO, HALL, CHURCH, CLUB, STADIUM, STEREO, 3 STEREO, DOLBY PL EMULATION, DOLBY PL II MUSIC, DOLBY PL II MOVIE)

**8. D/DVDR, TV, SAT/CAB, AM/FM, VCR**  
USB and AM/FM (SOURCE buttons)  
Selects sound source.

**9. Headphones Jack**  
Connects headphones.

**10. MASTER VOLUME**  
Adjusts the volume.

**11. SUBWOOFER**  
Selects among subwoofer output levels. (SOFT SUBWOOFER, BALANCE SUBWOOFER, STRONG SUBWOOFER, POWERFUL SUBWOOFER)

**12. ON/OFF**  
Turns off the unit.

**13. Number buttons**  
Directly accesses a preset station in AM/FM mode.

**14. MEMORY**  
Stores stations in AM/FM mode.

**15. MONOST**  
Selects between Stereo and Mono sound in FM mode.

**16. EQ**  
Selects among preset equalizer mode (FLAT, POP/JAZZ, ROCK, CLASSIC, BASS and TREBLE).

**17. TEST TONE**  
Speaker test tone setting. Refer to "Advanced Sound Control" for details.

**18. NIGHT**  
Selects among night mode options (DCR OFF, SOFT) and ON which compresses the volume difference between normal voices and sounds such as explosions. (Available only during Dolby Digital signal playback)

**19. SETUP**  
Select among night mode options (DCR OFF, SOFT) and ON which compresses the volume difference between normal voices and sounds such as explosions. (Available only during Dolby Digital signal playback)

## General Controls

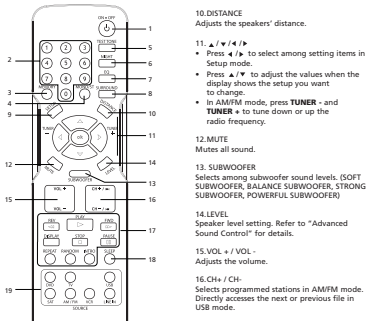

10. DISTANCE  
Adjusts the speaker's distance.
11. ▲/▼/■/□  
Press ▲/▼ to select among setting items in Setup mode. Press ■/□ to adjust the values when the display shows the setup you want to change. In AM/FM mode, press TUNER - and TUNER + to tune down or up the radio frequency.
12. MUTE  
Mutes all sound.
13. SUBWOOFER  
Selects among subwoofer sound levels. (SOFT SUBWOOFER, BALANCE SUBWOOFER, STRONG SUBWOOFER, POWERFUL SUBWOOFER)
14. LEVEL  
Speaker level setting. Refer to "Advanced Sound Control" for details.
15. VOL + / VOL -  
Adjusts the volume.
16. CH / CH -  
Selects programmed stations in AM/FM mode. Directly accesses the next or previous file in USB mode.
17. Operation Buttons (In USB mode only)  
Press **PLAY, STOP** and **PAUSE** to access the same function as the corresponding buttons in USB mode.  
Press **REV** or **FWD** starts reverse or forward playback.  
Press **DISP** to access MP3/WMA/DJ information and current play time, current play folder and Track number/Play Mode.  
Press **REPEAT** to access the repeat function. This function is only available in Stereo mode.  
Press **NRVO** to enter into mode.
18. SLEEP  
Enters sleep mode and selects sleep time.
19. Source buttons  
Selects audio sources.

## Operating Your Unit

### Selecting Source

When one of the SOURCE buttons on the front panel or on the remote control is pressed, the input corresponding to the name will be activated.

The unit acts as a switching device between all the sources that are plugged into it.

**Example 1:**  
If you have connected a DVD player to the DVD input on the unit, press **DVD/VIDEO** on the front panel or on the remote control to receive the sound transmitted by the DVD.

**Example 2:**  
Based on the example 1, the DVD is playing, if a VCR is connected to the VCR input of the unit, press **VCR** on the front panel or on the remote control. The sound from the VCR source will replace the DVD.

You can connect up to 6 audio sources to this amplifier.

SOURCE	SOURCE button/Corresponding buttons on front panel	on remote control	connector at the back panel
DVD/VIDEO	DVD	DVD	DVD
VCR	VCR	VCR	VCR
SAT/CAB	SAT/CAB	SAT/CAB	SAT/CAB
AM/FM	AM/FM	AM/FM	built-in
VCR	VCR	VCR	VCR
USB	USB	USB jack at front panel	USB
LINE IN	LINE IN	Line in jack at front panel	LINE IN

The source name selected shown on the display.

**Notes:**

- Your unit has a built-in tuner. Just connect the appropriate antenna to the back of the unit and you will be able to listen to radio stations. (See "Radio section".)
- Other sources can be connected to the above standard source.
- Connections at the back panel can be interchanged if sources have the same audio input. Example, you can connect a TV to VCR inputs and connect a VCR to TV input.

## Operating Your Unit

### Selecting Source

When one of the SOURCE buttons on the front panel or on the remote control is pressed, the input corresponding to the name will be activated.

The unit acts as a switching device between all the sources that are plugged into it.

**Example 1:**  
If you have connected a DVD player to the DVD input on the unit, press **DVD/VIDEO** on the front panel or on the remote control to receive the sound transmitted by the DVD.

**Example 2:**  
Based on the example 1, the DVD is playing, if a VCR is connected to the VCR input of the unit, press **VCR** on the front panel or on the remote control. The sound from the VCR source will replace the DVD.

You can connect up to 6 audio sources to this amplifier.

SOURCE	SOURCE button/Corresponding buttons on front panel	on remote control	connector at the back panel
DVD/VIDEO	DVD	DVD	DVD
VCR	VCR	VCR	VCR
SAT/CAB	SAT/CAB	SAT/CAB	SAT/CAB
AM/FM	AM/FM	AM/FM	built-in
VCR	VCR	VCR	VCR
USB	USB	USB jack at front panel	USB
LINE IN	LINE IN	Line in jack at front panel	LINE IN

The source name selected shown on the display.

**Notes:**

- Your unit has a built-in tuner. Just connect the appropriate antenna to the back of the unit and you will be able to listen to radio stations. (See "Radio section".)
- Other sources can be connected to the above standard source.
- Connections at the back panel can be interchanged if sources have the same audio input. Example, you can connect a TV to VCR inputs and connect a VCR to TV input.

## Advanced Sound Control

### Sound Enhancement Systems

This unit is equipped with several built-in sound enhancement systems.



Manufactured under license from Dolby Laboratories. "Dolby", "Pro Logic", and the double-D symbol are trademarks of Dolby Laboratories.

**Stereo**  
The 3 Stereo mode will redirect the Surround signal to the front left and right speakers when only the front and center speakers are used.

**Dolby Digital**  
The Dolby Digital mode lets you enjoy full digital surround from software processed in the Dolby Digital format. Dolby Digital provides better sound quality and more powerful presence than conventional Dolby Surround.

This unit is equipped with Dolby Digital 5.1-channel so that you can enjoy enhanced full digital surround sound, being different from Dolby Pro Logic in which only four channels (Front Left, Front Right, Center and Rear) are used, the new system provides stereo separation of the rear speakers (Rear-Right, Rear-Left). These 5 channels, together with the subwoofer channel for bass sounds (outed as 0.1 channel), constitute as a 5.1 channel (or 6 Channels) input for Dolby Digital that brings you the most sophisticated surround enjoyment.

**Dolby Pro Logic II**  
The Pro Logic II mode uses the built-in circuit to steer the Left, Center, Right and Surround left and right channel audio signals and uses all five speakers with stereo and Dolby Pro Logic program source, such as TV and VCR. Center channel II includes Dolby Pro Logic II Music, Dolby Pro Logic II Music and Dolby Pro Logic II Movie.

The Pro Logic II mode uses the built-in circuit to steer the Left, Center, Right and Surround left and right channel audio signals and uses all five speakers with stereo and Dolby Pro Logic program source, such as TV and VCR. Center channel II includes Dolby Pro Logic II Music, Dolby Pro Logic II Music and Dolby Pro Logic II Movie.

With "Dynamic Bass Amplified System" (DBAS), the discrete amplifier is located in the unit so the subwoofer keeps the power needed to give you different feels of size and types of listening environment.

**Dynamic Bass Amplified System (DBAS)**  
With "Dynamic Bass Amplified System" (DBAS), the discrete amplifier is located in the unit so the subwoofer keeps the power needed to give you different feels of size and types of listening environment.

**PRE SUBWOOFER** to select the subwoofer (DBAS) effects level according to your needs.



**Listening**



**Listening**

**Listening**

## Technical Specifications

### Amplifier Section

RMS Output Power: Dolby Digital Mode with 10% Total Harmonic Distortion  
167 Watts per Channel (1kHz, 8 Ohm)  
Subwoofer Channel: 167 Watts (100Hz, 8 Ohm)  
Total RMS Output Power:  
Dolby Digital mode: 1000 W

FTC Output Power: Dolby Digital Mode with 10% Total Harmonic Distortion  
Front Channels (L and R): 75 Watts per channel (1kHz, 8 Ohm)  
Rear Channels (L and R): 75 Watts per channel (1kHz, 8 Ohm)  
Center Channel: 155 Watts (1kHz, 8 Ohm)  
Subwoofer Channel: 155 Watts (80Hz, 8 Ohm)  
Total FTC Output Power:  
Dolby Digital mode: 650W

Muting Attenuation: 65dB  
Frequency Response: 200Hz/31.3dB, 1kHz ref.  
Subwoofer Frequency Response:  
Ref: -3dB, 80Hz ref.  
Signal to Noise Ratio: 65dB  
(Dolby digital mode)

### AM Tuner Section

Frequency Response: 20kHz-47.6dB, 1kHz ref.  
Useable Sensitivity: 800uV/m @ 5N 20dB  
Signal to Noise: 35dB  
IF Rejection: 35dB

### FM Tuner Section

Frequency Response: 15kHz-47.3dB, 1kHz ref.  
Quiescent: 24dBu  
Signal to Noise: 60dB(stereo) / 65dB(mono)  
IF Rejection: 50dB

### Dimensions (H x W x D mm)

Unit: 430 x 140 x 347  
Front and Center Channels: 200 x 77 x 85  
Center Speaker: 85 x 300 x 77  
Subwoofer: 360 x 195 x 328.5

## Advanced Sound Control

### Fine Setting of the Components

You can select the surround mode by pressing SURROUND repeatedly to select among different options. (STEREO, HALL, CHURCH, CLUB, STADIUM, STUDIO, 3 STEREO, DOLBY PL EMULATION, DOLBY PL II MUSIC, DOLBY PL II MOVIE)

The default surround modes for different components are listed in the table below the unit will keep the last selection in memory.

Source Input	If digital input is (optical or coaxial) is selected	If analog input is selected
DVD/VIDEO	Dolby Digital	N/A
SAT/CAB	N/A	Pro Logic II Movie
AM/FM	Dolby Digital	N/A
VCR	N/A	Pro Logic II Movie
USB	N/A	Pro Logic II Movie
LINE IN	N/A	Stereo

**Source Input** If digital input (optical or coaxial) is selected

**Source Input** If analog input is selected

**Analog Input**  
This unit is defaulted to play analog signals from TV, VCR and Line-in.

### Fine Setting of the Speakers

All the bass settings have already been pre-set for the speakers included in the box.

Also, to make the surround sound more effective and suit the acoustic conditions in your listening room, you may need to delay the signal coming from some of the speakers. Channel delay compensates for center or surround speakers that are closer to the listening position than the front speakers.

**Testing Speaker Loudness**  
You can listen to the loudness of the individual speakers.

1. Press **TEST TONE** on the remote control. A short noise will be heard in the speakers one by one. The speaker having the noise at that moment will be shown in the display.

2. Turn the **VOLUME** knob or press **VOL +** or **VOL -** on the remote control to adjust the master volume (if necessary).

3. Press **TEST TONE** to exit.

**Adjust Individual Speaker Volume**  
1. To adjust individual speaker volume level, press **LEVEL** on the remote control.  
2. Continue to press **LEVEL** on the remote control to select the channel to be adjusted, then press ▲/▼ to adjust the level.

## Advanced Sound Control

### Speaker Configurations

You can also change the setup of the speakers. Use a subwoofer to enjoy optimum sound.

For optimum surround experience measure the distance between the speaker and your favorite listening position. Press **DISTANCE** to adjust the speaker's distance.

1. Press the **DISTANCE** button to show setup options.

2. Press the **DISTANCE** until the speaker you want to change is displayed.

3. Press ▲/▼ to change the speaker settings. Your selection will be stored automatically.

4. Repeat step 2 and 3 to set up the rest speakers. You may adjust the distance between the following ranges:  
• Front Speaker distance (FRONT): 0-30 ft.  
• Center Speaker distance (CENTER): 0-30 ft.  
• Rear Speaker distance (REAR): 0-30 ft.

5. When set up is done, wait for five seconds to automatically save your settings or press any button to save your selection and set up mode.

**Factory defaulted Advanced setting indication from VFD**  
The unit has defaulted the following distances:  
• Front speakers (FRONT) 15 ft  
• Center speaker (CENTER) 15 ft  
• Rear speakers (REAR) 10 ft



**Notes:**  
• FCIR stands for Center Speaker selection  
• SUB stands for Surround Speaker selection  
• Speakers are set to YES. If you decide not to use them, set the ones you do not intend to use to NO so the sound performance is not affected.

### VFD Dimmer Setup

1. Press **SETUP** button on remote control to show setup options.  
2. Press ▲/▼ until **DIMMER 0** is displayed.  
3. Press ▲/▼ to select between **0** and **1**.

## Troubleshooting Tips

### Unit/AM/FM Operation

**ST indicator is off.**  
• Adjust the antenna.  
• Reposition antenna to insure you are not outpacing in FM.

**The signal is Mono. Severe hum or noise.**  
• The signal is too weak. Connect an external antenna.  
• Adjust the antenna.  
• Reposition antenna away from any electronics.

**There is interference to FM reception.**  
• Turn off other electrical units (e.g. DVD, CD player) near the unit.

**Remote Control Operation**  
The remote control does not operate the unit.  
• No batteries installed. (Included with your system) install the batteries before attempting to operate the remote. Be sure to match the + and - ends of each battery to the symbols shown in the remote battery compartment.  
• The batteries are weak. Replace all batteries.

**No audio from one channel.**  
• Check the speaker level setting.  
• Check the speaker wire or external source cable connections.  
• Noise occurs when the TV is turned on.  
• The TV is too close to the audio system.

**General**  
• Make sure the speakers are connected.  
• Check the input connections.  
• Check the power cord connections.  
• Make sure MUTE is off.  
• Make sure the digital setting (optical, coaxial or analog) is correct.  
• Check that the headphone is not inserted.

**Care and Maintenance**  
Disconnect the audio system from the power source before performing any maintenance.

**Cleaning the Exterior**  
Clean the system from AC power before cleaning the exterior of the system with a soft dust cloth, or with a slightly damp leather cleaner. Never use strong solvents.

**Important Battery Information**  
Remove the batteries to avoid leakage if you do not use your remote control for more than one month.  
Discard leaky batteries immediately as they may cause skin burns or other personal injuries.

**Note**

## Limited Warranty

### LIMITED WARRANTY

**Your Responsibility**  
You must retain the original sales receipt to provide proof of purchase.  
These warranties are effective only if the product is purchased and operated in the U.S.A. or Canada.  
3. Warranties extend only to defects in material or workmanship, and do not extend to any product or parts which have been lost or discarded, or damage to product or parts caused by misuse, accident, improper operation or maintenance, or in any violation of instructions provided with the product, or to product which has been altered or modified without authorization of AVC, or to products or parts thereof which have had the serial number removed or changed.

**Out of Warranty**  
In the event your product requires repair after the limited warranty period has expired, please contact our Customer Support Center at 1-866-444-5746, 1-800-252-6123 or www.1800customersupport.com/RCA Monday-Thursday, 9am-7pm, Friday: 9am-5pm, Saturday: 9am-NOON Eastern time.

**Important:** You are responsible for any transportation, shipping or insurance relative to the return of product to our Product Returns Center.

All warranties implied by state law, including the implied warranties of merchantability and fitness for a particular purpose, are expressly limited to the duration of the limited warranties set forth above. With the exception of any warranties implied by state law, the limited foregoing warranty is exclusive and in lieu of all other warranties, guarantees, agreements and similar obligations of manufacturer or seller with respect to the repair or replacement of any parts. In no event shall AVC be liable for consequential or incidental damages.

No person, agent, distributor, dealer or company is authorized to change, modify or extend the terms of these warranties in any manner whatsoever. The time within action must be commensurate to enforce any obligation of AVC arising under the warranty or under any statute, or law of the United States or any state thereof, is hereby limited to one year from the date of purchase. This limitation does not apply to implied warranties arising under state law.

This warranty gives you specific legal rights and you may also have other rights, which may vary from state to state. Some states do not allow limitation on how long an implied warranty lasts, when an action may be brought, or the exclusion or limitation of incidental or consequential damages, so the above provisions may not apply to you.

For more information on other products and services, please visit our web site at [www.1800customersupport.com/RCA](http://www.1800customersupport.com/RCA)

**Important:** Also keep your "Bill of Sale" as proof of purchase.  
Model no..... Product name.....  
Type of sale..... Invoice no.....  
Serial no..... Invoice no.....  
Date purchased..... Dealer name.....  
FOR SERVICE AND REPAIR, PLEASE VISIT [www.1800customersupport.com/RCA](http://www.1800customersupport.com/RCA)  
Specifications and external appearance is subject to change without notice.