

1. FUNCTION & FEATURES

1) Long range cordless phone with 900MHz

900MHz cordless phone provide a longer distance than 46/49 Mhz phone. When you visit your neighborhood, you can carry the Music phone and use this phone even though you are in your neighborhood.

2) Miniature type

Small size and light weight can gives you for easy hand-carry.

3) Low battery indication

During you call, if the battery capacity drops to a certain level you may listen a beeper sound and "LOW BAT" LED will turn ON at which you must charge the battery.

4) 40Channel auto scanning

Before using the music phone, the unit selects the empty channel which has no interference out of 40 channels automatically. You can call without any interference.

5) Auto talk/stand-by

When the hand-set is ringing while it is on the cradle of base-set unit, if you pick-up the hand-set unit, the unit will go to TALK mode automatically(Auto Talk) and if you put the hand-set unit on the base-set unit, after calling it will go to standby mode automatically. (Auto Stand-by)

6) Auto alarm for escape from communicable distance

The hand-set unit locate far from base-set unit, then alarm beep will ringing. You can not call in that area, The Music phone designed for disconnect, after alarm beep. You must move near area from the base-set unit.

7) Noise cancellation

The music phone adapt a noise cancellation circuit to provide better sound quality.

8) Any key

When there is an incoming call, you can make conversation by pressing any key button

9) MEMORY

Memory for short number:from stand-by status

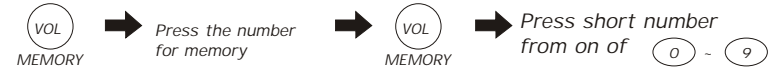

*Can memory 16 digit telephone number

*Can memory 0-9 short number

*If you memory a new number then memorized number will be erased.

*If the setting finished, then you can listen the beeper sound

Memory for PABX or key-phone connected case

If the Music phone connect with PABX or Key-phone, then most of case you must dial external local connection number(Normally"9") before dial telephone number.

When you memory the telephone number you must insert "PAUSE" between local connection number and telephone.

(Ex: You want memory "1" address with 123-4567)



Dialling from short number



To store favorite channel at e-dio mode:

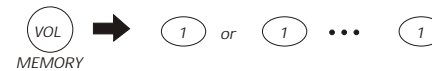

10) Volume control

-The Music phone set an initial sound value, when we shipped.

-Louder : VOL → *iã

-Basic sound : VOL → #iã

- E-dio mode volume control
 "ç To increase volume :



"è To decrease volume :



10) Channel up/down

- To channel up in e-dio mode :



- To channel down in e-dio mode :



10) Favorite channel selection

If you press any number key button in e-dio mode then e-dio phone will be service your favorite channel.

2. PACKAGES

Please check the contents as soon as you buy the Music phone

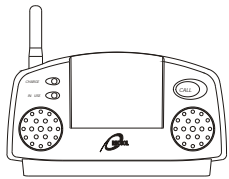

Base-Set Unit



Hand-set Unit



Adapter



Local cord



Audio/232C code

3. LOCATION OF CONTROLS

1) Base-Set Unit

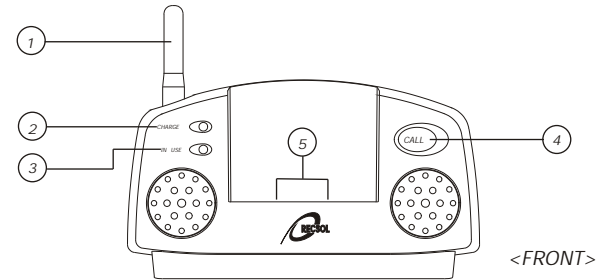

1. Antenna : This is for communication terminal between base-set & Hand-set unit.

2. Charge LED : When the hand-set is ON the cradle of base-set unit for charge, the LED will light, when charge the battery

3. IN USE LED : The LED will turn ON when you are in TALK mode.

4. CALL : If you press this button, you may listen a beep sound from hand-set so you may use for paging also.

5. CHARGE TERMINAL : The power is being supplied through these terminals.

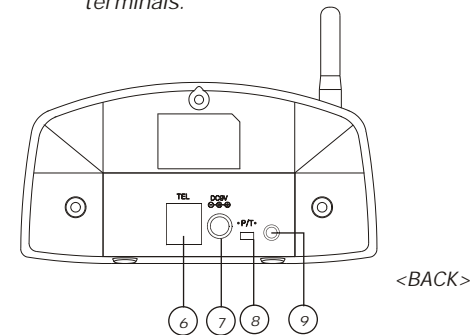

6. PHONE JACK (TEL):To connect to the telephone line

7. ADAPTER JACK:To connect with the adapter(DC9V, 200mA)

8. TONE/PULSE SWITCH:For select a telephone exchanger for tone/pulse

9. AUDIO/232C JACK :To connect with the computer.

2) Hand-set unit

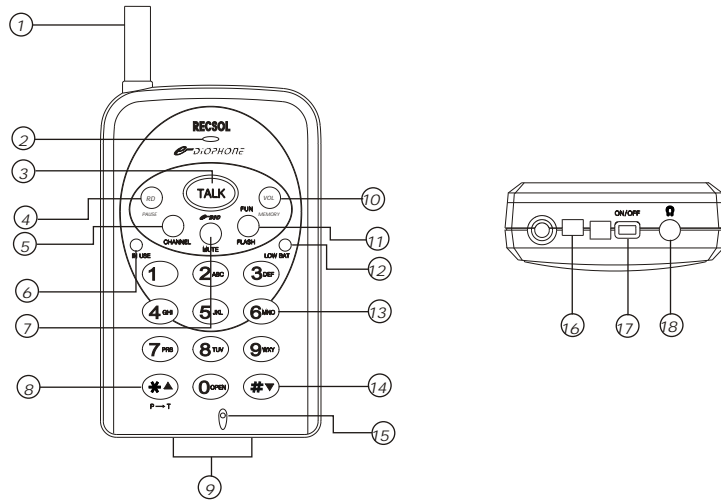

1. **ANTENNA:** This is for communication terminal between base-set & hand-set unit
2. **RECEIVER UNIT:** Same as a hand-set of normal telephone. (You can listen counter-partner's voice through receiver unit.)
3. **TALK/STAND-BY:** If you press this button, it will be a TALK mode, which you can communicate with you counter-partner and press this button again, then it will go to STAND-BY mode.
4. **REDIAL/PAUSE**
 - REDIAL: Redial for the last number, which you dialed.
 - PAUSE: To stop the dialing in a few seconds, it is convenient for PABX application.

∅ If the music phone connect to a PABX or key phone, then you have to dial the local number "9" in front of telephone number.

Ex) If you want dial to 123-4567



5. **CHANNEL:** You can select another empty channel while you are conversation with someone.
6. **IN USE LAMP:** To indicate the current status for TALK/STAND_BY
7. **MUTE:** During pressed this button, then your counter-partner can not listen your voice
8. **VOLUME UP/CHANNEL UP/TONE<PULSE SWITCH(*jã/PjæT)**
 - VOLUME UP(jã): To increase volume level
 - TONE/PULSE SWITCH(PjæT): To adjust tone/pulse method connection.
 - CHANNEL UP(jã): To increase channel level.
9. **CHARGE TERMINAL:** For battery charging.
10. **VOLUME CONTROL/MEMORY**
 - VOLUME CONTROL: For adjust the volume level
 - MEMORY: To store 10 sets of a frequently using telephone number.
11. **FLASH:** Can use when you want to make a call-transfer and get special service from telephone company.
12. **LOW BAT LAMP:** The LED indicates low battery when you listen a beeper & LED turn ON
13. **DIAL BUTTON:** To dial key-pad.
14. **VOLUME DOWN(jã):** To reduce the volume level
CHANNEL DOWN(jã): To reduce the channel level
15. **C-MIC:** Same as a transmitter in the phone. Transfer voice signal to an electric signal
16. **BELL:** When there is an incoming call and paging from base-set unit, the hand-set will be ringing.
17. **ON/OFF SWITCH**
18. **EAR-PHONE JACK()** Ω

4. INSTALLATION

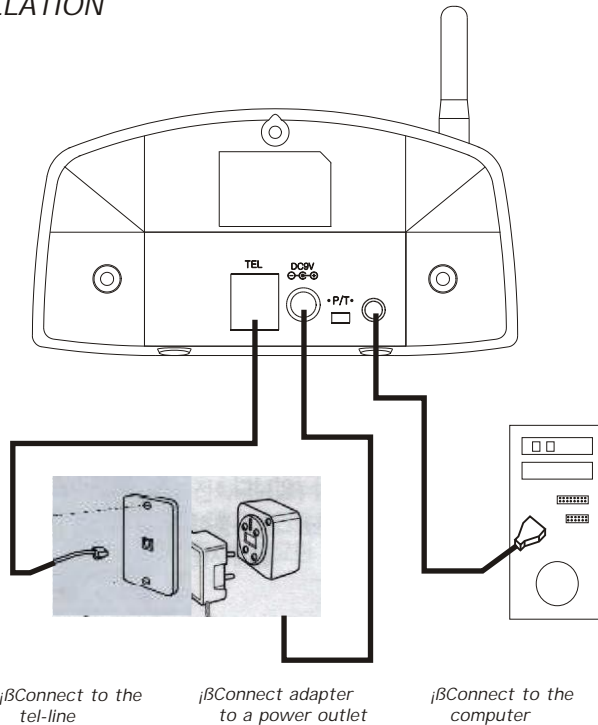

1. Connect the adapter to the well power outlet. You must check the correct voltage before connection to your power outlet.
2. Connect to the telephone line.
3. Connect the 232C cable between computer and input/output jack of base unit correctly.
3. Switch ON in the hand-set unit ON/OFF switch.
4. Place the hand-set unit on the base-set unit, then you can listen a beeper sound.

5. CHARGING METHOD

1. For the first using the music phone

Sometimes the battery already discharged during transportation, we recommend to charge more than 12 Hrs before use.

2. CHARGING

* Check the "CHARGE" LED ON after place the hand-set unit on the hand-set unit.

* 8Hrs charging time is enough for charging the battery.

* We recommend to place the hand-set unit on the base-set unit when you are sleep.

*∅*The battery is a kinds of consumer product and 6 months guarantee.

*∅*The battery efficiency reduce to an half, then you had better replace the battery.

*∅*If you do not use in a long time, you must disconnect battery from music phone.

6. MAKING A CALL

1) How to make a call from hand-set

Press the "TALK" button and check the dial tone sound, then dialing.

2) How to receive a call from hand-set

*ç*When the hand-set unit does not place on the base-set unit

After ring the bell, press any key and call

*è*When the hand-set unit place on the base-set unit

After ring the bell, pick-up the hand-set unit & call

*∅*After call, please turn OFF the IN USE LAMP by pressing the TALK button

*∅*After pick-up the hand-set unit from base-set unit, if you press the TALK key again, then you may be disconnect.

*∅*The bell will be ring 3-4 seconds delayed than normal telephone so we recommend to receive after ringing.

7. TROUBLE SHOOTING

1) When you can not make conversation by pressing the TALK button of hand-set

• Check if the power is connected to the base-set unit properly.

• Check whether the telephone line of the base-set unit is connected correctly to the wall plug phone jack.

• Check hand-set unit whether the power ON/OFF switch is on position.

• Check if you press the TALK button after ringing at hand-set unit.

• Put the hand-set unit on the cradle of base-set unit at which you will hear a beep sound. If you can not hear this beep sound, please take out the hand-set unit and put on the cradle again until you get the beep sound.

• Check if charging LED is lighting. When you get a warning tone for low battery, you must charge the battery fully.

2) When you can not dial tone.

• Please check the above points 1 again.

• Move the hand-set unit to the base-set unit more closely.

3) When there is an interference and noise.

• Check if the charging LED is lighting in the hand-set.

• Move the hand-set to the base unit more closely.

• Change the location of base unit to other place.

• Make sure that there is no obstacle near Music phone. (Ex: elevator, High power electric line, Electric game machine, or electric fish cage etc.) The telephone should be installed far from these equipments.

• In case the unit does not work momentarily or can not operate any button even though the power is being supplied, please pull-off the power plug and plug in again.

4) When the hand-set does not ring?

Please check the above points 1 and 2 again.

8. CAUTIONS

1) Location of installation

Do not install 900MHz Music phone at following places to use more safely.

• Partitioned place with thick wall or steel beam structure. (Ex: Elevator)

• Exposed place from heat or sunny place by directly.

• Serious vibrating place or dusty or humidity place.

2) Cautions

• The battery can be discharged which is normal condition at which set the power On/Off switch of hand-set to ON position then charge the battery fully (about 8 hour) before use.

• Wipe the charge contacts of base unit and hand-set with clear clothes regularly for better charging condition.

• When you clean the Cabinet, use 2 or 3 drops of vinegar water, then it will prevent an electric discharge. Do not use benzene or alcohol when you clean the cabinet.

• When you have a severe thunderstorm, you must pull out the power plug.

• After finishing of phone call, do not turn off the power switch of the hand-set. If you turn off, you can not receive the incoming call.

• If you want not to use for a long period, we recommend to Turn off the Hand-set.

• When you hear a warning sound while you are making conversation and the charge LED is lighting, it means low battery so you must recharge the hand-set fully (more than 4 hours).

• Do not dis-assemble.

• Do not install at humidity & wet place.

• After fully charged, you can use 3HRs on talk mode, 5HRs for audio listening mode and 12HRs at stand-by mode.