

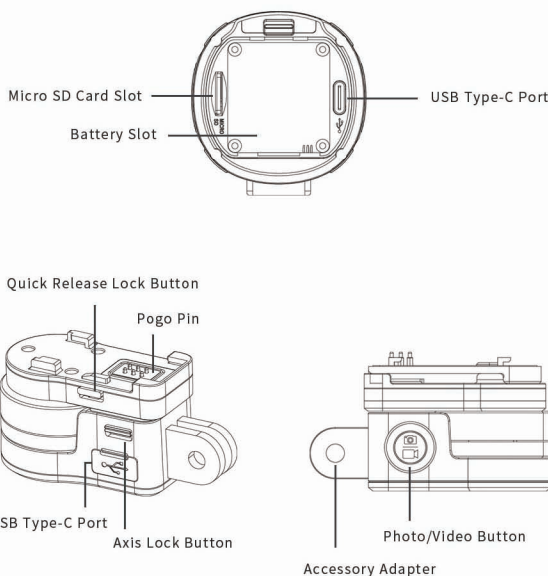

RedFox O₂ Quick Guide

1 APPEARANCE

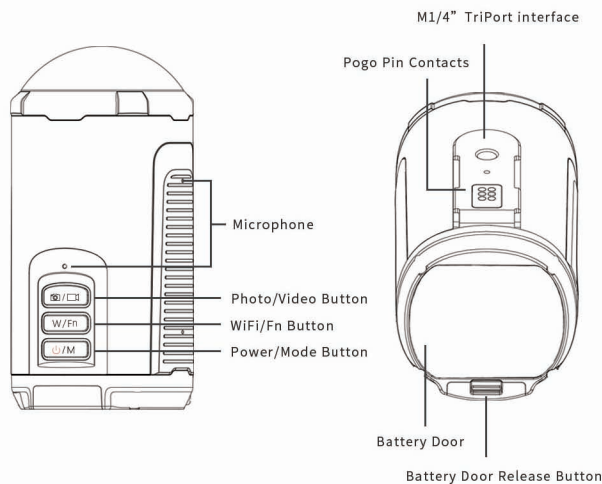

2 CHARGE THE BATTERY

- For your best experience, it's highly recommended to fully charge the battery before use for the first time.
- The charging LED on charging base will turn red to indicate charging in process, when charging is complete, the light will turn green.

- ① The battery can only be charged by REDFOX charging base; both USB type-C ports on device and the third axis can only be used for data transfer, do not use them for charging.
- ② Use universal 5V 2A charger for power supply.
- ③ For battery safety, you could refer to <Battery Safety Instructions>.

3 INSTALLING THE BATTERY AND MICRO SD CARD

- Push up the battery door release button, the battery door will slightly pop out, then pull out the battery door via the two grooves on top of the door.
- Put the battery into the battery slot, making sure the "REDFOX" label is in upright position. Push the Micro SD card into the slot until it clicks into place, with the contacts side to the left. Then install the battery door.

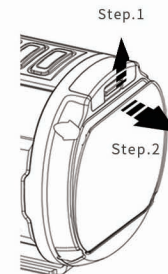

- ① Do not put the battery inversely.

4 INSTALLING THE THIRD AXIS

- Press bottom of the camera onto the Pogo pin of the third axis hard, push along the slot until it clicks.
- Push down the axis lock button each time when using to make it ready for use. After you install the third axis correctly, the camera can adapt to accessories of mainstream action cameras in market via the accessory adapter for versatile scenarios.

- Power on the camera, click the power button three times to enable the third axis.
- Turn off the camera before installing or releasing the third axis.

- ① To remove the third axis, push down the quick release lock button and then pull out the third axis.
- ② When not using the third axis, fix the movable part upright to the base, then push up the axis lock button to put it in order.

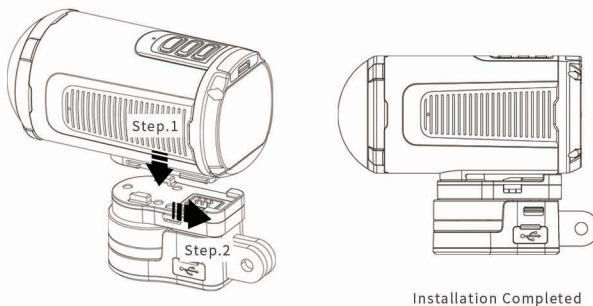

5 POWER ON/OFF

- Power On:** Long press and hold the Power/Mode button until its LED flashing blue, the buzzer will beep and the camera will be ready for use.
- Power Off:** Long press and hold the Power/Mode button until all LED lights go out and buzzer beeps to turn it off.

- ① By default, the camera will be in tilt-tracking mode.
- ② After power is on, LED indicator light color of the Power/Mode button will indicate battery power level, blue will indicate the battery is sufficient, blue and red alternately flash will indicate the battery is under 10%.

6 VIDEO RECORDING /PHOTO MODE

- After power on, LED of Photo/Video button will be in Solid red(in video mode) or blue(in photo mode).
- In video recording mode, press the Photo/Video button once, the camera will start recording, the LED will turn slow flash and the buzzer will beep once; press it again to stop recording, the LED indicator light will turn back into a solid red light and the buzzer will beep twice.
- In photo mode, press the Photo/Video button once to take a photo, the blue LED indicator light will flash once and the buzzer will beep once accordingly.

- ① Cycling between modes: long press the Photo/Video

- button to cycle between two modes, the LED will switch between blue and red and the buzzer will beep.
- ② To revise shooting parameters, press key combinations (more details in user manual) or download Redfox APP to set.

7 INSTALLING REDFOX APP (FOR ANDROID AND IOS)

- To have better experience, enable more advanced features, please use Redfox APP.
- For Apple (iOS) devices, search "Redfox" in App Store to install.
- For Android devices, download from <http://www.redfoxuav.com/en/instruction.html>

- ① "Redfox" App will support Android 4.4 version and above, iOS 8.1 version and above.

8 HOW TO CONNECT THE CAMERA TO THE MOBILE DEVICE

- Long press WiFi/Fn button until its LED turns blue and buzzer beeps, the camera WiFi will be ready for use.
- Open WiFi settings page of your mobile phone, connects to camera's SSID.
- Open Redfox APP, choose Redfox O₂ in devices section and tap "Connect" on main interface, then it will switch to control/preview page of the camera.

- ① By default, SSID of the camera will be redfox-XXX, default password will be "12345678", you can rename SSID and revise password in the APP.

- ② To remove the Micro SD card, press the tail of the card inward softly and it will eject from the camera.
- ③ Micro SD card will need to be purchased separately, please select according to below requirements:
1. Micro SD, Micro SDHC or Micro SDXC.
 2. Class 10 at least.
 3. Not exceeding maximum storage 128G.

FCC STATEMENT :

This device complies with Part 15 of the FCC Rules. Operation is subject to the following two conditions:

- (1) This device may not cause harmful interference, and
- (2) This device must accept any interference received, including interference that may cause undesired operation.

Warning: Changes or modifications not expressly approved by the party responsible for compliance could void the user's authority to operate the equipment.

NOTE: This equipment has been tested and found to comply with the limits for a Class B digital device, pursuant to Part 15 of the FCC Rules. These limits are designed to provide reasonable protection against harmful interference in a residential installation. This equipment generates uses and can radiate radio frequency energy and, if not installed and used in accordance with the instructions, may cause harmful interference to radio communications. However, there is no guarantee that interference will not occur in a particular installation. If this equipment does cause harmful interference to radio or television reception, which can be determined by turning the equipment off and on, the user is encouraged to try to correct the interference by one or more of the following measures:

- Reorient or relocate the receiving antenna.

- Increase the separation between the equipment and receiver.

- Connect the equipment into an outlet on a circuit different from that to which the receiver is connected.

- Consult the dealer or an experienced radio/TV technician for help.

FCC Radiation Exposure Statement:

This equipment complies with FCC radiation exposure limits set forth for an uncontrolled environment. This equipment should be installed and operated with minimum distance 20cm between the radiator & your body.

- English: "

This device complies with Industry Canada licence-exempt RSS standard(s). Operation is subject to the following two conditions:

- (1) this device may not cause interference, and
- (2) this device must accept any interference, including interference that may cause undesired operation of the device."

- French:"

Le présent appareil est conforme aux CNR d'Industrie Canada applicables aux appareils radio exempts de licence. L'exploitation est autorisée aux deux conditions suivantes :

- (1) l'appareil nedit pas produire de brouillage, et
- (2) l'utilisateur de l'appareil doit accepter tout brouillage radioélectrique subi, même si le brouillage est susceptible d'en compromettre le fonctionnement."