

Support

If you are having problems with your product, please contact customer support before contacting your retailer.  
support@lifemade.com

life made Limited Warranty Statement

life made warrants this product against defects in workmanship and material for a period of 12 months from the original date of purchase. If the product fails during normal and proper use within the warranty period, life made will repair or replace any products or parts determined to be defective in workmanship or material at its option. All components repaired or replaced by life made' service site will be under warranty for the remaining period of warranty.

This Limited Warranty covers only the accessory components packaged with this product. This Limited Warranty does not include failure caused by improper installation, operation, cleaning or maintenance, accident, damage caused by extreme temperature, humidity or extreme electrical stress, misuse, abuse unauthorized modifications to the product, software faults ,normal wear and tear or any other event, act, default or omission outside of life made' control or if the serial number has been defaced, altered or removed and the casing has been opened.

To obtain warranty service, please contact life made for specific instructions at the telephone number below. Dated, documented proof of the original purchase is required.

life made Customer Service Representatives are available by emailing support@lifemade.com

QUICK START GUIDE

life made....  
simple • better • easier

WORKS WITH  
ALL  
TABLETS &  
E-READERS

iCozy  
Lap Tunes



Bean Bag Speaker with  
Bluetooth® Wireless Technology

To Charge

- 1. Insert the USB end of the charging cable into a computer or USB wall charger.
- 2. Insert the other side into the DV 5v port on the back of your iCozy.
- 3. Charge for 4-6 hours for a maximum battery charge.

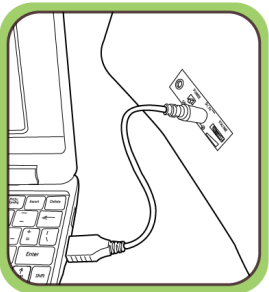

Instructions:

- 1. Position your Tablet on the iCozy so that the back of your Tablet is resting on the pillow and the bottom of your Tablet is on the Support Tab.
- 2. Turn ON the speakers by placing the power switch to the ON position. The power switch is located on the back of your iCozy.
- 3. Once the iCozy beeps you are ready to pair the Bluetooth connection.
- 4. On your mobile device access the Bluetooth pairing menu and select “BT speaker”.
- 5. Your iCozy will now be paired.
- 6. To adjust the volume of the speakers, rotate the Volume Dial found on the back of your iCozy or adjust the volume on your mobile device.
- 7. The iCozy Lap Tunes can also be used as a wired speaker using a 3.5mm audio cable.
  - a. Insert a 3.5mm aux cable into the Line In port found on the back of your iCozy.
  - b. Insert the other end of your 3.5mm aux cable into your mobile device.
- 8. Relax and enjoy!

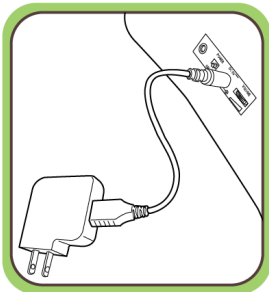

This device complies with Part 15 of the FCC Rules.  
Operation is subject to the following two conditions:

- (1) This device may not cause harmful interference, and
- (2) This device must accept any interference received, including interference that may cause undesired operation.

changes or modifications not expressly approved by the party responsible for compliance could void the user’s authority to operate the equipment.

This equipment has been tested and found to comply with the limits for a Class B digital device, pursuant to Part 15 of the FCC Rules. These limits are designed to provide reasonable protection against harmful interference in a residential installation. This equipment generates, uses and can radiate radio frequency energy and, if not installed and used in accordance with the instructions, may cause harmful interference to radio communications. However, there is no guarantee that interference will not occur in a particular installation.

If this equipment does cause harmful interference to radio or television reception, which can be determined by turning the equipment off and on, the user is encouraged to try to correct the interference by one or more of the following measures:

- Reorient or relocate the receiving antenna.
- Increase the separation between the equipment and receiver.
- Connect the equipment into an outlet on a circuit different from that to which the receiver is connected.
- Consult the dealer or an experienced radio/TV technician for help.

iPad® is a registered trademark of Apple Computers, Inc. This product is not licensed, sponsored, endorsed, or manufactured by Apple Computers, Inc.

Made in China of Man Made Materials

www.lifemade.com • 21 Englehard Dr, Monroe, NJ 08831