

# Dog remote trainer

Dog Friendly, Safe and Healthy

## USER MANUAL

Model: RT505



### ◆ Product Interface

#### Transmitter

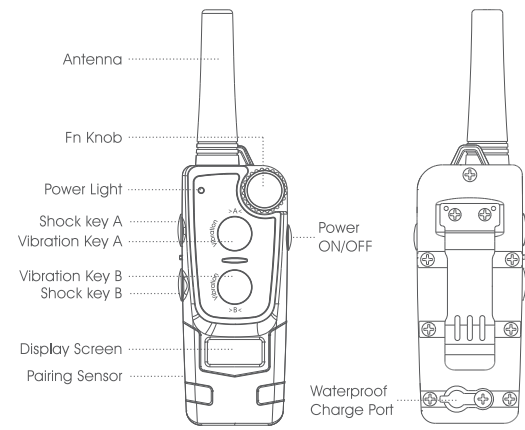

IV

### ◆ Quick Guide

#### 1 Wireless Pairing

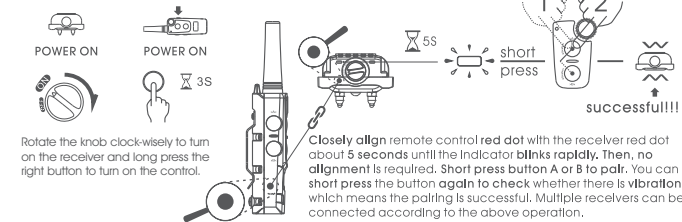

#### 2 Strap installation



#### 3 Put on the collar

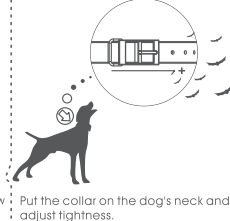

#### 4 How to use ?



V

Thanks for your selecting Petfere Dog Remote Trainer. This is specially designed for you to manage and train your dog. You only need to put the receiver on your dog's neck and train it with the transmitter. Of course you should adjust the sensitivity grade on the Receiver(also named Dog Bark Control) based on the dog's size and weight(Pls refer to the user manual for detailed explanation) and adjust the collar to a proper tightness. After that, the trainer can work. Pls definitely don't worry about its safety. The vibration and shock of this trainer do not harm your dog. Pls read the user manual carefully before operation.

II

### ◆ Features

- Intelligent design, Simple and Easy to operate
- Harmless to the dogs.
- Automatic protection.
- Elegant, Simple and Portable.

### ◆ Packing contents

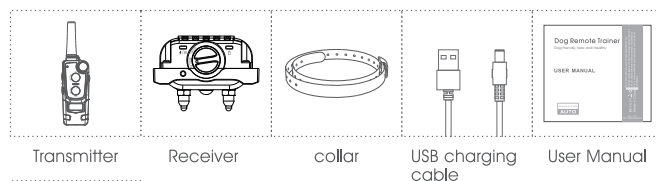

Intensity Testing Indicator

III

### ◆ FAQ

- Q1: Is the electric shock harmful to the dogs?  
A: No, the maximum electric shock power is 0.7mW. Do not shock the dog with maximum degree(degree 127) too often.
- Q2: Can the dog wear the dog trainer when bathing?  
A: Yes, the dog trainer is waterproof.
- Q3: Why the receiver does not respond to the transmitter?  
A: When the transmitter and the receiver are powered on and paired successfully, the transmitter degree can not be set at 0.
- Q4: What is the transmission distance of the transmitter?  
A: In the open air and good weather, the direct transmission is up to 1KM if there is no obstacle blocking signal; in most circumstances, the direct distance is 500 meters.
- Q5: Can it be used to control multiple dogs?  
A: Yes, one remote has two channels. Each channel can be paired with multiple receivers.

VI

### ◆ Specification

- Product name: Dog remote trainer
- Product size: 168x45x36mm
- Main Unit Size/Weight: 75x49x56mm/2.9x1.9x2.2in/95g
- For Dogs Weight for 60-120pounds
- Main Unit Size/Weight: 70x46x56mm/2.7x1.8x2.0in/90g
- For Dogs Weight for 15-59pounds
- Product weight: 120g
- Input voltage: DC 5V
- Working voltage: DC 3 3V-4 2V
- Working current: <220mA (3.7V)
- Stand by current: <2mA (3.7V)
- Sleep mode current: <500uA (3.7V)
- Working current: <220MA (5V)
- Electric shock level: 0-127 level
- Control distance: >500m(up to 1KM if there is no obstacle)
- Working frequency: 868MHz
- Electric Shock Power: <0.7W

VII

### ◆ Receiver

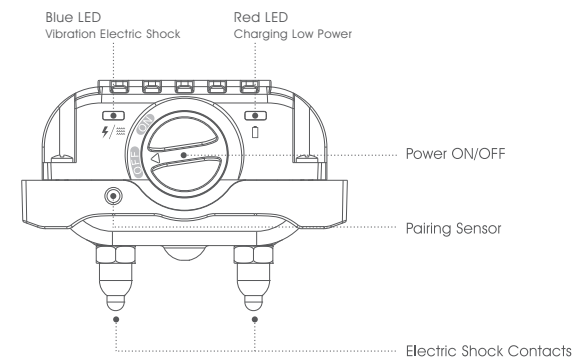

VIII

### ◆ Operation Instruction

- Transmitter**
1. Adjust the Fn knob to the ON area for power on.
  2. Keep the pairing sensor of transmitter closing to the pairing sensor of receiver for 5s. Take away the transmitter when the indicator light of receiver flashes quick, push vibration key A/B of the receiver to repair with transmitter. If the receiver keeps shaking, that means repair successfully. Note, if you push vibration key A when repairing, that means A group repairs successfully. The same to key B group.
  3. If you want to use shock function, pls push shock keys when repairing.
  4. There are vibration keys and shock keys in both 2 channels, which controls Vibration function and shock function separately.
  5. Power indicator:
    - 3.7 - 4.2V, 100% Capacity when fully charged, 60% ≤ capacity < 100%. In usage, indicator light flashes blue;
    - 3.4-3.5V, remaining Capacity show 20%, indicator light flashes red;Note: The device will turn off automatically when the power is lower than 3.4V

IX

6. Charging: when charging, the red light will be on. The green light will be on when it's fully charged, and then you can pull out the charging cable.
7. Backlit: when transmitter is in standby mode, backlit will turn off automatically if there is no pressing keys more than 6 seconds. And backlit will turn on when press any key.

### ◆ Receiver

1. Adjust the Fn knob to the ON area for power on.
  2. Power Indicator:
    - Normal operation, indicator light flashes blue;
    - Low battery, indicator light flashes red.Note: Receiver will turn off automatically when power is lower than 3.4V.
  3. Range of the signal: > 500m (air line distance without interference)
- Note: The receiver has bark control function (Another user manual is attached), Pls read the receiver user manual for detailed information!

X

### ◆ Matters needing attention

1. When it is used for the first time, if the dog is allergic to the circle, please do not use any more.
2. Do not set the collar too tight, to avoid dog choking. Please check whether there is scratch or wound after use, and stop using or loose the collar if there is.
3. This bark control is not a common collar. If you use a chain for the dog, please use a common collar.
4. Please make sure the dog will not bite the device to avoid damage.
5. The bark control Fn knob should be placed facing the sky.
6. Please remove the bark control when bathing the dog.

XI

### ◆ Recycling



The disposal and recycling must be done as per local area or country regulation; we strive for continued research and development. Thus, we reserve the right to amend this user manual without prior notification.

### ◆ After-sale service

Thanks again for your purchasing of our products. We are willing to offer you the most outstanding products and service and allow you to enjoy a pleasant high technology life. Since the date of purchase, if there is quality problem caused by production defectiveness, it has a 12-month repair warranty. For any doubt, please resort to sale service.

XII

<p><b>FCC Statement:</b></p> <p>This equipment has been tested and found to comply with the limits for a Class B digital device, pursuant to part 15 of the FCC Rules. These limits are designed to provide reasonable protection against harmful interference in a residential installation. This equipment generates, uses and can radiate radio frequency energy and, if not installed and used in accordance with the instructions, may cause harmful interference to radio communications. However, there is no guarantee that interference will not occur in a particular installation. If this equipment does cause harmful interference to radio or television reception, which can be determined by turning the equipment off and on, the user is encouraged to try to correct the interference by one or more of the following measures:</p> <ul style="list-style-type: none"><li>--- Reorient or relocate the receiving antenna.</li><li>--- Increase the separation between the equipment and receiver.</li><li>--- Connect the equipment into an outlet on a circuit different from that to which the receiver is connected.</li><li>--- Consult the dealer or an experienced radio/TV technician for help.</li></ul> <p>Caution: Any changes or modifications to this device not explicitly approved by manufacturer could void your authority to operate this equipment.</p> <p>This device complies with part 15 of the FCC Rules. Operation is subject to the following two conditions: (1) This device may not cause harmful interference, and (2) this device must accept any interference received, including interference that may cause undesired operation.</p> <p>The device has been evaluated to meet general RF exposure requirement. The device can be used in portable exposure condition without restriction.</p>	
