

Mini Wireless Mouse Keyboard Combo i5 User Manual

New Product With MULTI TOUCH & SCROLL WHEEL



Overview

Thank you for purchasing this Wireless Mini QWERTY Keyboard & Touchpad Combo. You can use it for emails, chat, remote control, message input and games. It is compatible with PC, Laptop, Raspberry Pi 2, Mac OS, Linux, HPC, IPTV, Google Android Smart TV Box, XBMC, Windows 2000 XP Vista 7 8 10. Use it with your Android box or smart TV on your sofa or browse the internet in the most comfortable fashion.

System Requirements

- HID compatible device
- Terminal with USB port
- Windows 2000 • Windows XP
- Windows Vista, Windows CE, Windows 7, Windows 8, Windows 10
- Linux (Debian 3, Redhat 9.0, Ubuntu 8.10, Fedora-7.0 tested)
- Android OS (With standard USB interface)

Descriptions

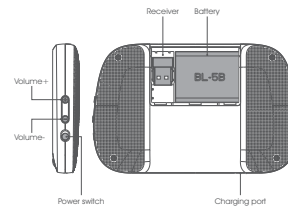
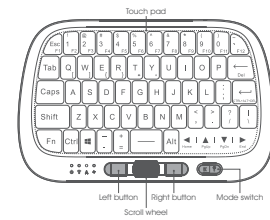

Specifications

Receiver (dongle): Nano style
 Connection port: With USB 2.0 or above
 Transmission mode: GFSK 2.4GHz wireless, up to 10 meters
 Transmission Power: ±5db
 Power supply: Rechargeable polymer lithium-ion battery
 Charging voltage: 4.4V - 5.25V
 Charging current: 300mA
 Sleeping current class1: 12uA
 Operation voltage:3.7v
 Operating current:<56mA
 Product weight: 112.5g
 Product size: 138*96*21mm

Installation

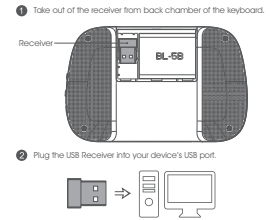

1. Turn on the keyboard.

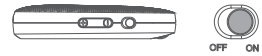

- Note:
1. If the Blue LED keeps flashing, it means the keyboard was not be paired with your device. As for how to pair, please try following steps:
 Step 1: Press right button and turn on the keyboard at the same time, then release the right button and the Blue LED will flash fast.
 Step 2: Plug in the USB dongle, the flashing blue LED will become off once paired with success within 60 seconds. If it fails for the first time, you can repeat Step 1-2 again. Please make sure the keyboard is fully charged before pairing.

2. LED Indicator

- Green LED** - Power on/off status.
 Blue LED - It will be off when connected, and flash when you touch the touch area. It will be quick flashing when pairing or battery low, and slow flashing when un-connected.
Orange LED - Capial indicator.
Red LED - charging status. It is on when charging. After fully charged, it'll be off.
- Green Blue Orange Red
-

3. About signal interference: when working with android TV box or smart TV, big monitor device may have some signal interference. Signal interference may result in short distance and buttons do not work as well. In this case you can try to move the receiver from back of your device to the front USB port then re-pair and use this keyboard.

4.Shortcut keys:

FN + ESC = F1	FN + 1 = F2	FN + 2 = F3
FN + 3 = F4	FN + 4 = F5	FN + 5 = F6
FN + 6 = F7	FN + 7 = F8	FN + 8 = F9
FN + 9 = F10	FN + 0 = F11	FN + - = F12
FN + ← = DEL	FN + ← = CTR+ALT+DEL	FN + ← = Home
FN + ▲ = PgUp	FN + ▼ = PgDn	FN + ► = End
FN + 0 = (FN + W =)	FN + E = (
FN + R =)	FN + T = -	FN + Y = .

5. Special keys used in special layout such as @ in UK layout this keyboard has different layout. Please know exactly which layout you want. For example, if you want and buy UK layout. And you want to use @. You need to first change your device's system language to British English, then it can work by shift+@.
6. Auto Sleep Mode
 This keyboard has auto sleep / wake up function, when there is no any operation in 3 minutes, it will into sleep automatically. Press any button to wake it up. Make sure it is an enough power.

Multi-finger Functions Touchpad

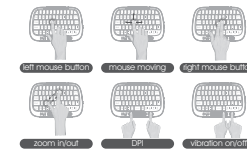

Auto Sleep and Wake-up feature

The keyboard supports auto sleep and wake-up. Without operation around 3 minutes, the keyboard will enter sleep mode. In sleep status, all LED indicators are off. Pressing any key can wake it up.

Switching off the keyboard after use

After use, push the switch to the "OFF" position. The USB receiver does not need to be pulled out from the terminal. You can use it next time directly.

Charging the battery

The device uses built-in lithium-ion battery. Please use only approved USB cables and charges.
 Note: Fully charge the unit before initial operation. This device can be used when charging. But charging time will be extended. When the battery is low, the low-voltage light will blink to warn the user. The unit will be automatically turned off if the battery has been depleted.

Scroll wheel

This new design can help you scroll through long documents or web pages faster and easier, same as using your mouse.

Disposal

Always dispose the used appliance at a recycling center. Do not dispose the used appliance together with the household waste.

Note:
 Due to 2.4G wave technology adoption, the connection can be subject to interference from obstacles, like walls, metals, or other electronic devices. Please keep the space between the keyboard and USB receiver free of obstacles. In line with the policy of continued development, the manufacturer reserves the right to amend the specifications without prior notification. The illustrations in the user manual are for reference only. Please operate according to the real design.

Warning

- The attached USB cable just can be used for charging. It can not be used for data transfer.
- When charging finishes, pull out the charging cable.
- Never try to open or repair this product yourself.
- Keep this device away from fluids, such as water.

FCC Warning

This device complies with Part 15 of the FCC Rules. Operation is subject to the following two conditions:

(1) This device may not cause harmful interference, and (2) this device must accept any interference received, including interference that may cause undesired operation.

NOTE 1: Any changes or modifications to this unit not expressly approved by the party responsible for compliance could void the user's authority to operate the equipment.