



Reolink Argus Quick Start Guide

Technical Support

For advanced setup, please download the user manual:
<https://reolink.com/software-and-manual/>

For more troubleshooting, please go to FAQs on our website:
<https://reolink.com/faqs/>

To get the latest firmware, please download it from:
<https://reolink.com/firmware/>

For other technical support, please contact us at
support@reolink.com

QG1_A

Welcome to Reolink
Easy Setup Within Minutes!

What's in the Box

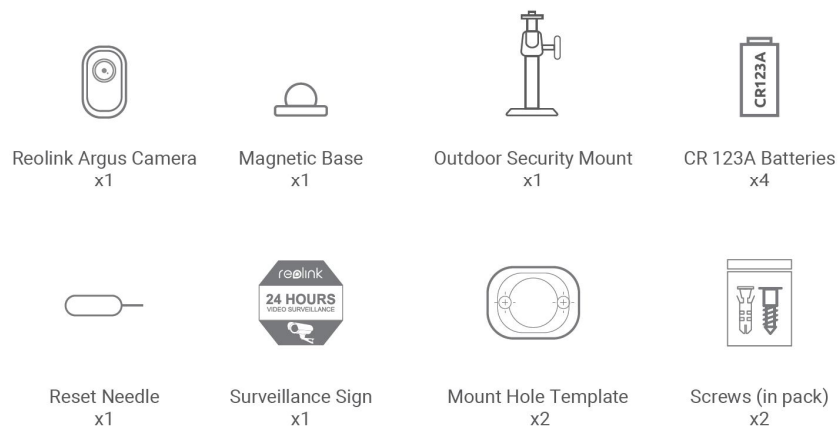

General Introduction

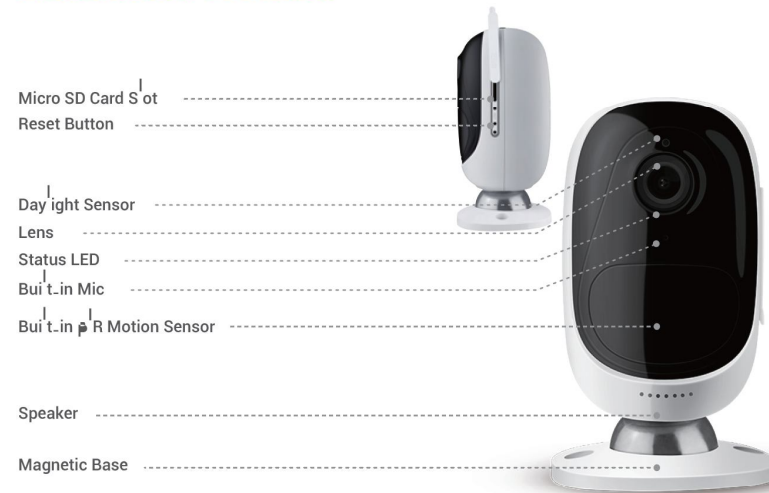

Red LED:

Blinking Standby status -- WiFi connection failed.

Solid Working status -- WiFi connection failed.

Blue LED:

Blinking Standby status -- WiFi connection succeeded.

Solid Working status -- WiFi connection succeeded.

Insert the Batteries into the Camera



Step 1
Press the white button and separate the back casing from the camera.



Step 2
Insert four batteries into the battery slot.



Step 3
Close the back casing.

Battery Specification:

Non-rechargeable lithium battery of Model No.CR123A, with the nominal voltage of 3V;
Rechargeable lithium battery, with the nominal voltage of 3.6V or 3.7V.

⚠ Important Safeguards on Battery Use:

- The batteries must be placed in the right direction of polarity;
- Do not use batteries of different brands and different models together;
- Do not use new and old batteries together;
- If you don't use the product for long periods, please remove the batteries in avoidance of erosion resulting from battery leakage.

Install Reolink App

There are two ways to get the Reolink App:

- Search "Reolink" in App Store (for iOS), or Google Play (for Android), download and install the app.
- Scan the QR code below to download and install the app.



Set up the Camera

Please follow the prompt tone to configure the camera

// Camera has been started up. Please run Reolink App. Click the "Add New Device" button, and follow the instructions to set up the camera. //

1. Click the "Add New Device" button.

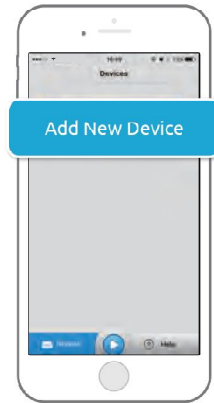

2. Scan QR code on the camera.

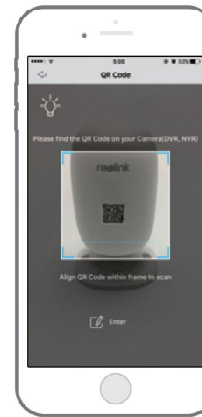

3. Click "Set Up Camera" to continue.

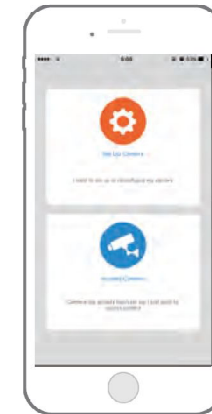

Note: In the dark environment please open flashlight.
If the scan fails, please click "Enter" to enter the UID manually.

4. Click the button "I have heard the voice prompt" to enter the next page.

If you did not hear the voice prompt, please press "I did not hear the voice prompt" for help.

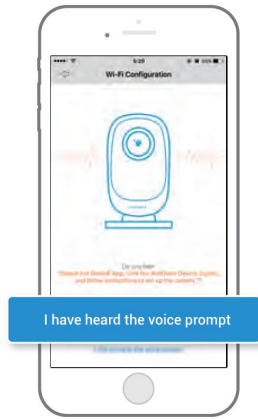

5. Enter the Wi-Fi password of the selected Wi-Fi network and press "I have entered the correct information" to enter the next page.

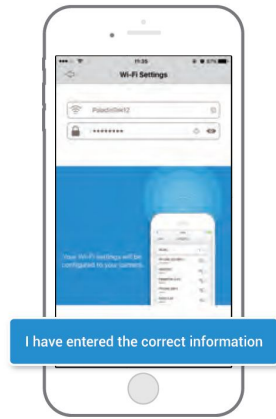

“ Scan succeeds. Camera is connecting to the router. ”

6. A QR code will be generated on the phone. Please place the QR code on your phone towards Reolink camera's lens at a distance of about 20cm for scanning.

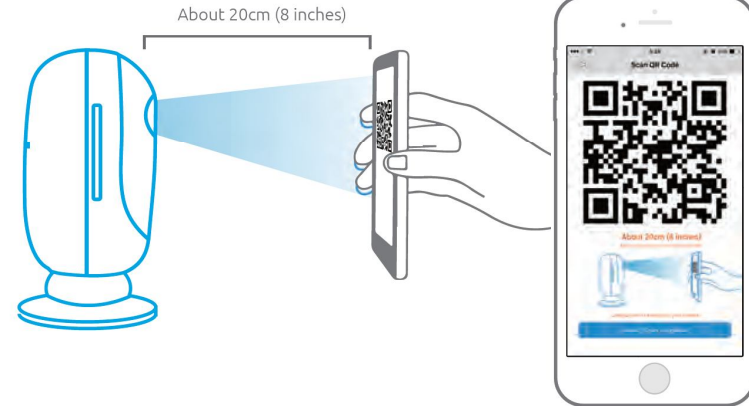

“ Wi-Fi connection failed! Please check the Wi-Fi settings and try again. ”

7. If you hear the above tone, please press “I heard ‘Wi-Fi connection failed’ ” for help.



“ Wi-Fi connection succeeds! Welcome to Reolink! ”

8. If you hear the above tone, please press “I heard ‘Wi-Fi connection succeeds’ ” to finish the quick setup.



Live Video

You can view the video now.

- Battery Status
- Delete Device
- Push Notification
- Enable/Disable PIR
- Wi-Fi Configuration
- Device Settings
- Edit Device



Create Password

Press the camera icon  on the Device list. A pop-up window will show as the right. Create a new password for your camera, and click OK.

Note: For your account's security, please create a strong password (at least 6 characters) that contains letters and numbers.

Create Password

Please create the password using at least 6 characters.

Cancel **OK**

FCC Statement

This equipment has been tested and found to comply with the limits for a Class B digital device, pursuant to Part 15 of the FCC Rules. These limits are designed to provide reasonable protection against harmful interference in a residential installation. This equipment generates uses and can radiate radio frequency energy and, if not installed and used in accordance with the instructions, may cause harmful interference to radio communications. However, there is no guarantee that interference will not occur in a particular installation. If this equipment does cause harmful interference to radio or television reception, which can be determined by turning the equipment off and on, the user is encouraged to try to correct the interference by one or more of the following measures:

- Reorient or relocate the receiving antenna.
- Increase the separation between the equipment and receiver.
- Connect the equipment into an outlet on a circuit different from that to which the receiver is connected.
- Consult the dealer or an experienced radio/TV technician for help.

This device complies with part 15 of the FCC Rules. Operation is subject to the following two conditions:(1) This device may not cause harmful interference, and (2) this device must accept any interference received, including interference that may cause undesired operation.

Changes or modifications not expressly approved by the party responsible for compliance could void the user's authority to operate the equipment.

The device has been evaluated to meet general RF exposure requirement. The device can be used in portable exposure condition without restriction.