

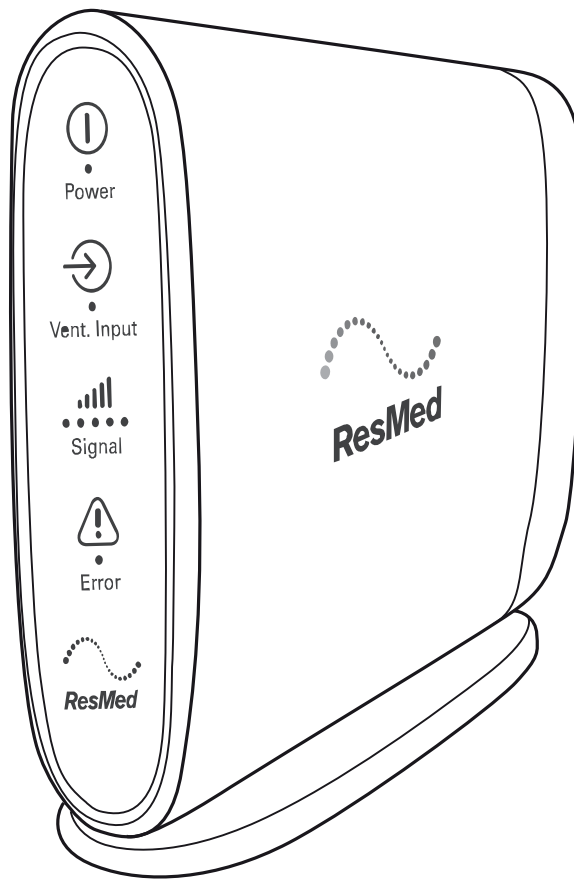

ResMedConnectivityModule

ResMed

ResMedConnectivityModule



User guide

User guide
English

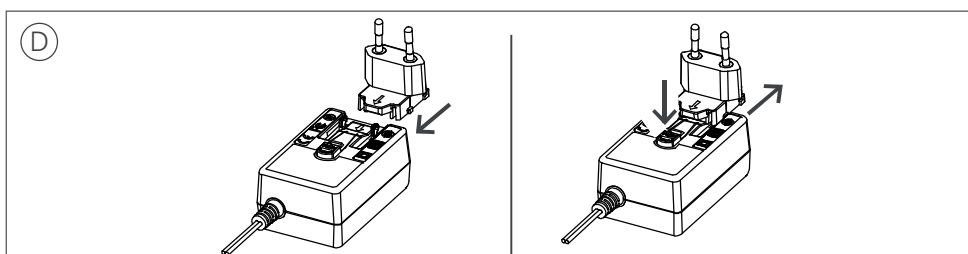
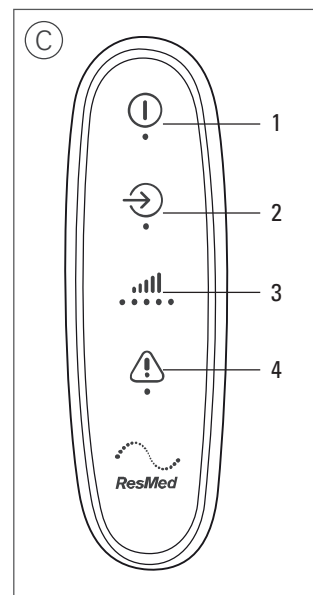
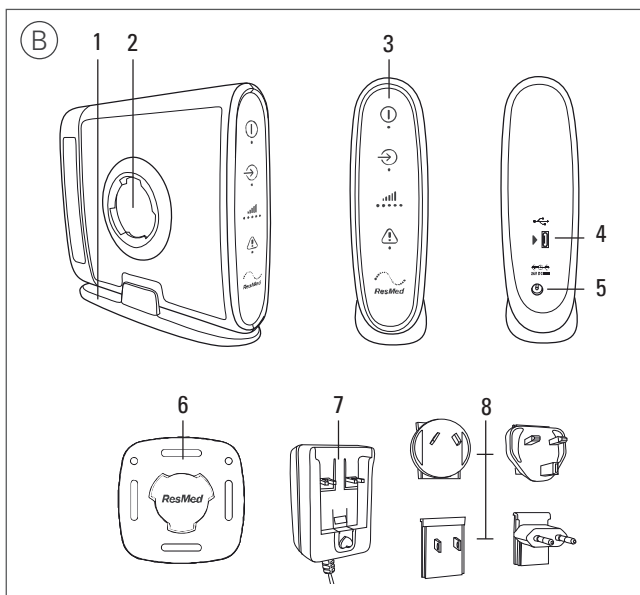
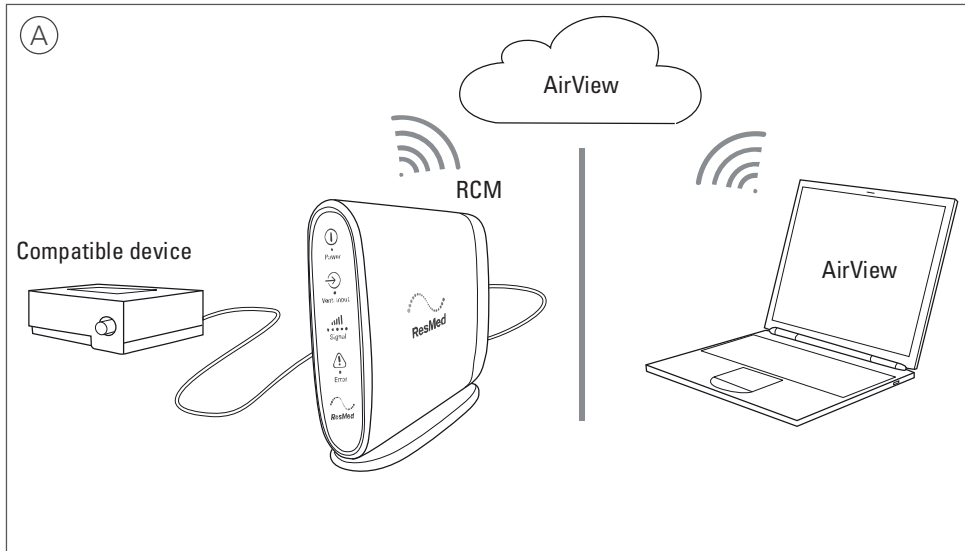

Introduction

Refer to illustration A.

ResMed Connectivity Module (RCM) provides cellular connection between a compatible ResMed ventilation device and the ResMed AirView™ system.

RCM sends therapy and device data recorded in the ventilation device to the cloud-based AirView system once a day from home, wirelessly and automatically, to assist the remote display of patient data.

RCM also sends data to AirView on demand when requested via AirView (eg, for remote display and troubleshooting).

CAUTION

In the US, Federal law restricts this device to sale by or on the order of a physician.

Compatible devices

RCM is compatible with the following ventilation devices:

- Astral™ 100/150
- Stellar™ 100/150.

Intended use

RCM is intended to be used in the home environment, for the collection and transmission of respiratory data to AirView. RCM will not control any clinical devices, nor provide interpretation of data.

RCM is not intended for use on an aircraft.

General warnings and cautions

The following are general warnings and cautions. Specific warnings, cautions and notes appear with the relevant instructions in the guide.

WARNING

- Only use the power supply unit and plug blade attachments provided with RCM.
- Beware of electrocution. Do not immerse RCM or any of its components in water. Always unplug RCM before cleaning and make sure that all parts are dry before plugging it back in.
- Do not open or modify the device. There are no user serviceable parts inside. Repairs and servicing should only be performed by an authorized ResMed service agent.

CAUTION

Do not use RCM outdoors.

RCM at a glance

Refer to illustration B.

1. Stand
2. Wall mounting socket
3. Indicator panel
4. USB port
5. Power inlet
6. Wall mount
7. Power Supply Unit (PSU)
8. Plug blade attachments
9. USB cable (not shown)

Indicators

Refer to illustration C.

RCM provides indication of the current operating state. When the **Power** and **Vent. Input** indicators illuminate and you have network reception, RCM is ready to use.

| Indicator | Status |
|--|--|
| 1 Power – Green | |
| Indicates whether RCM is powered on. | On: The power is on. Off: The power is off. |
| 2 Vent. Input – Blue | |
| Indicates whether RCM is connected to the powered-on ventilation device. | On: Connected to the ventilation device. Off: Disconnected from the ventilation device. Blinking: Establishing connection to the ventilation device. |
| 3 Signal – Blue | |
| Indicates connectivity to the cellular network and the signal strength. | On: Connected to the cellular network. The signal strength is indicated by the number of blue dots (more dots mean a stronger signal). Off: No cellular network detected. |
| 4 Error – Yellow | |
| Indicates whether RCM has an error. | On: An error has occurred. Off: No error |

Note: The **Vent. Input** and **Signal** indicators will dim in 5 minutes and will return to full brightness when RCM is connected to the ventilation device or powered on again.

Assembling the PSU

Refer to illustration D.

1. Insert the plug blade attachment suitable for your region into the PSU.
2. To remove the plug blade attachment from the PSU, press the button under the arrow and slide it out.

CAUTION

- Do not leave the plug blade attachment in a power outlet alone.
- Do not plug the PSU upside down into a power outlet. Ensure that the power cord extends downward.

Setup

Refer to illustration E.

RCM can only be connected to one ventilation device at a time.

1. Connect RCM to the power using the PSU. The **Power** indicator will illuminate.
2. Position RCM where the **Signal** indicator shows that you have network reception, and ensure that RCM is:
 - more than 0.8' (2 cm) away from the body during operation.
 - in an area that will not be affected by moisture.

- ideally 12" (30 cm) away from the ventilation device or other electrical equipment and 3'3" (1 m) from mobile communication devices.
3. Secure RCM with the stand or wall mount. (Refer to the Using the stand/wall mount section.)
 4. Connect one end of the USB cable to the micro USB port of RCM, and the other end to the mini USB port at the rear of the powered-on ventilation device (refer to the illustration). Ensure that the **Vent. Input** indicator illuminates.
 5. To ensure correct times are shown in AirView, ensure that the clock on the ventilation device is correct (change if appropriate).

Notes:

- For further assistance, contact your care provider or ResMed representative.
- To stop RCM, unplug the power cord from the power outlet.

Using the stand/wall mount

Stand

Refer to illustration F.

1. Place the stand on a stable level surface.
2. Insert the longer edge of the stand into RCM, ensuring that it clicks into place.
3. To remove the stand, release the clip on the stand.

Wall mount

Refer to illustration G.

Use appropriate fittings to attach the wall mount. For example, use the round holes or the slots of the wall mount for screws or cable ties (not provided).

WARNING

Ensure that the wall mount is securely fixed in place.

1. Hold RCM at an angle and push it onto the wall mount. Adjust the angle to fit RCM in place.
2. Turn RCM clockwise until it clicks into place.
3. To remove RCM from the wall mount, turn it counterclockwise.

Sending data to AirView

RCM automatically sends the previous 24 hours of data to AirView once a day from approximately 12 pm (based on the clock of the connected ventilation device).

If automatic data transmission is missed or interrupted, it will resume when the connection is re-established. No data will be lost.

To ensure daily automatic data transmission, ResMed recommends you to connect RCM once a day for one hour, with the **Vent. Input** and **Signal** indicators on.

Note: Data more than seven calendar days old will not be sent to AirView.

Cleaning and maintenance

The exterior of RCM and the PSU can be cleaned with a damp cloth and an approved mild cleaning solution.

The following cleaners and disinfectants are compatible for use when cleaning external surfaces of RCM:

- isopropyl alcohol

- bleach (1:10) (may also be known as 'diluted hypochlorite').

Always follow the manufacturer's recommended cleaning instructions.

WARNING

Ensure that the RCM and PSU are dry before reconnecting to the power outlet and ventilation device.

Troubleshooting

| Problem/possible cause | Solution |
|---|---|
| The Power indicator does not illuminate. | <p>Check that the PSU is connected correctly to the power outlet and the rear of RCM.</p> <p>Check that the plug blade attachment is inserted into the PSU correctly.</p> <p>Check that the PSU is the one provided with RCM.</p> |
| The Vent. Input indicator does not illuminate. | <p>Check that the ventilation device is turned on.</p> <p>Check that the USB cable is connected correctly to the rear of RCM and the ventilation device.</p> |
| The Signal indicator does not illuminate. | <p>Change the position of RCM.</p> <p>Check that you have network reception.</p> <p>Ensure that RCM is ideally 12" (30 cm) away from the ventilation device or other electrical equipment.</p> |
| The Error indicator is on. | <p>Switch RCM off, then on again, to see if this removes the error. If the Error indicator displays again, contact your care provider or ResMed representative.</p> |
| Automatic data transmission was interrupted or missed at 12 pm (eg, no signal, RCM/ventilation device disconnected or powered off). | <p>Re-establish the connection between RCM, ventilation device, and AirView (refer to the Setup section). Automatic data transmission will resume to send any outstanding data.</p> |

If the problem cannot be solved, contact your care provider or ResMed representative.

Technical specifications













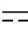



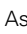

| | |
|---------------------------------|---|
| Dimensions (H x W x L) | RCM only: 5.28" x 1.73" x 5.91" (134 mm x 44 mm x 150 mm) The stand will add 0.12" (3 mm) to the height and 0.24" (6 mm) to the width. |
| Weight | RCM only: 0.62 lb (280 g) The stand will add 0.07 lb (30 g) and the wall mount will add 0.02 lb (10 g). |
| Power supply unit (PSU) | AC 100–240 V, 0.35–0.70 A, 50–60 Hz DC 24 V, 1.25 A Cable length 5'10" (1.8 m) Class II, suitable for continuous operation Typical power consumption: <3W Maximum power consumption: <5W |
| Housing construction | Flame retardant engineering thermoplastic and silicon |
| Environmental conditions | |
| Operating temperature: | +32°F to +104°F (+0°C to +40°C) |
| Operating humidity: | 10%–95% non-condensing |

| | |
|--|--|
| Operating altitude: | Sea level to 9842.5 ft (3000 m) |
| Storage and transport temperature: | -13°F to 158°F (-25°C to +70°C) |
| Storage and transport humidity: | 10%–95% non-condensing |
| Electromagnetic compatibility | Product complies with all applicable electromagnetic compatibility requirements (EMC) according to IEC60601-1-2, for residential, commercial and light industry environments. It is recommended that mobile communication devices are kept at least 3'3" (1 m) away from the device. Information regarding the electromagnetic emissions and immunity of these ResMed devices can be found on www.resmed.com/downloads/devices . Click on the PDF file for your language. |
| IEC 60601-1 classification | Non-transit operable, portable equipment |
| Compatible software versions | AirView: 4.1 or higher Astral: SX544-0401 or higher Stellar: SX483-0250 or higher |
| Wireless module | Technology used: 3G/2G |
| FCC ID: 2ACHL-RCM3G | The RCM device complies with FCC Rules. Additional information regarding the FCC Rules for this device can be found on www.resmed.com/downloads/devices . |
| IC ID: 9103A-RCM3G | The RCM device complies with Industry Canada license-exempt RSS standards. Additional information regarding the Industry Canada license-exempt RSS standards for this device can be found on www.resmed.com/downloads/devices . |
| Declaration of Conformity to 1999/5/EC (DoC to the R&TTE Directive) | ResMed declares that the RCM device is in compliance with the essential requirements and other relevant provisions of Directive 1999/5/EC. A copy of the declaration of conformity (DoC) can be found on www.resmed.com/downloads/devices . |
| Separation | The RCM device should be used at a minimum distance of 0.8" (2 cm) from the body and ideally 12" (30 cm) from the ventilation device during operation. |
| Design life | 5 years The RCM and PSU do not contain any user serviceable parts. |

Note: The manufacturer reserves the right to change these specifications without notice.

Symbols

The following symbols may appear on the product or packaging:

 Follow instructions for use.  Manufacturer. **EC REP** European Authorized Representative.
LOT Batch code. **REF** Catalog number. **SN** Serial number.  Direct current.  Humidity limitation.  Temperature limitation. **Rx Only** Prescription only (In the US, Federal law restricts these devices to sale by or on the order of a physician).  European RoHS. **IP21** Protection against insertion of fingers and against vertically dripping water.  Keep dry.  Fragile, handle with care.
 RCM certification.  Canadian Standards Associations.  Non-ionising radiation.  USB connector.  Power indicator.  Vent. Input (Ventilator Input) indicator.  Signal indicator.
 ⁰¹²³
 ₀₆₈₂ CE labelling in accordance with EC directive 93/42/EEC and Radio Equipment Directive 2014/53/EU.  Polarity of DC power connector.  Indicates a warning or caution.



■ Environmental information

This device should be disposed of separately, not as unsorted municipal waste. To dispose of your device, you should use appropriate collection, reuse and recycling systems available in your region. The use of these collection, reuse and recycling systems is designed to reduce pressure on natural resources and prevent hazardous substances from damaging the environment.

If you need information on these disposal systems, please contact your local waste administration. The crossed-bin symbol invites you to use these disposal systems. If you require information on collection and disposal of your ResMed device please contact your ResMed office, local distributor or go to www.resmed.com/environment.

Limited warranty

ResMed Ltd (hereafter 'ResMed') warrants that your ResMed product shall be free from defects in material and workmanship for a period of 12 months from the date of purchase by the initial consumer. This warranty is not transferable.

If the product fails under conditions of normal use, ResMed will repair or replace, at its option, the defective product or any of its components.

This Limited Warranty does not cover: a) any damage caused as a result of improper use, abuse, modification or alteration of the product; b) repairs carried out by any service organization that has not been expressly authorized by ResMed to perform such repairs; c) any damage or contamination due to cigarette, pipe, cigar or other smoke; and d) any damage caused by water being spilled on or into an electronic device.

Warranty is void on product sold, or resold, outside the region of original purchase.

Warranty claims on defective product must be made by the initial consumer at the point of purchase.

This warranty replaces all other expressed or implied warranties, including any implied warranty of merchantability or fitness for a particular purpose. Some regions or states do not allow limitations on how long an implied warranty lasts, so the above limitation may not apply to you.

ResMed shall not be responsible for any incidental or consequential damages claimed to have resulted from the sale, installation or use of any ResMed product. Some regions or states do not allow the exclusion or limitation of incidental or consequential damages, so the above limitation may not apply to you.

This warranty gives you specific legal rights, and you may also have other rights which vary from region to region. For further information on your warranty rights, contact your local ResMed dealer or ResMed office.

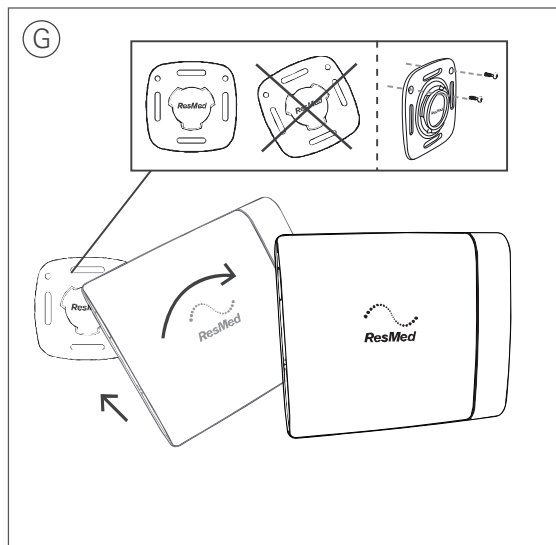
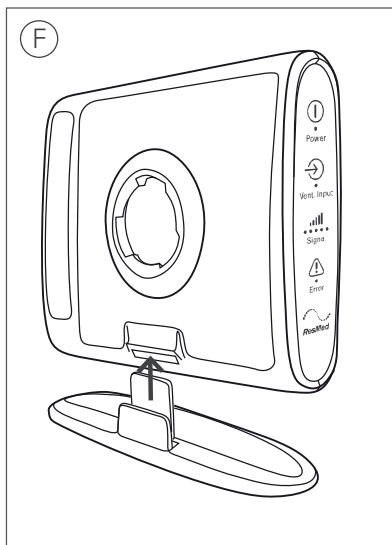
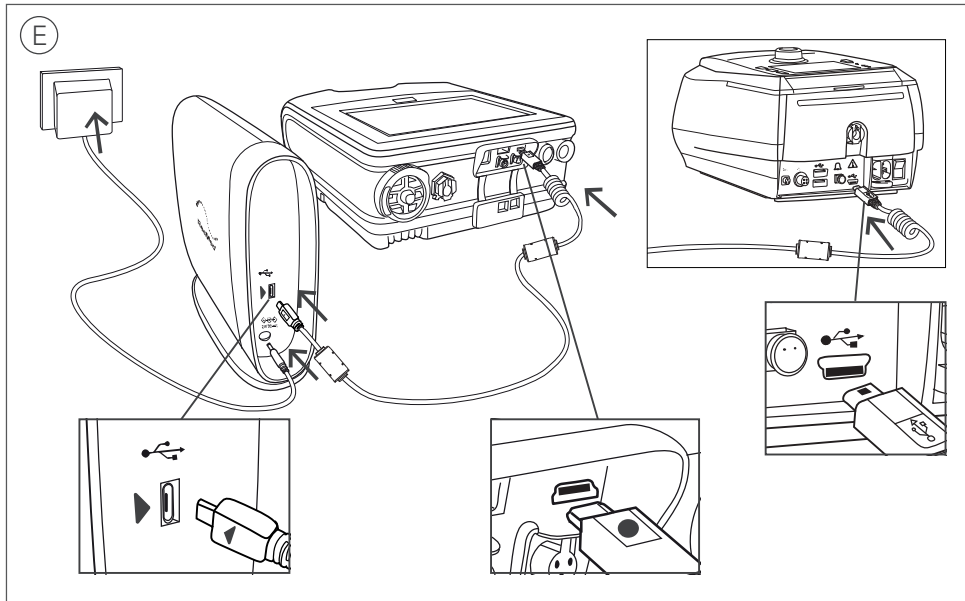



 **ResMed Ltd**
1 Elizabeth Macarthur Drive
Bella Vista NSW 2153 Australia

Distributed by
ResMed Corp 9001 Spectrum Center Boulevard San Diego CA 92123 USA
EC REP ResMed (UK) Ltd 96 Jubilee Ave Milton Park Abingdon Oxfordshire OX14 4RW UK

See ResMed.com for other ResMed locations worldwide. AirView, Astral and Stellar are trademarks and/or registered trademarks of the ResMed family of companies. For patent and other intellectual property information, see ResMed.com/ip.
© 2016 ResMed Ltd. 278175/5 2016-01

 0123
0682

ResMed.com

