

Revolabs Solo™ Single-Channel – Polycom® SoundStation 2 Setup Guide

NOTES AND CAUTIONS:

This setup guide will guide you through the steps needed to properly connect a Revolabs Single-Channel device to a Polycom SoundStation 2 speakerphone.

1. Connecting the Cables
2. Configuring the SoundStation 2 speakerphone

Note: *It is important to carefully follow these instructions in order and completely. Otherwise, your Single-Channel System and/or the phone may not function properly. Please read through these instructions completely before proceeding. Contact Revolabs Technical Support if you have any questions.*

IMPORTANT: *This will only work with the SoundStation 2 with LCD screen (expandable version – P/N 2201-16200-601). The SoundStation 2 models without LCD screen or the expandable capability do not have the ability to activate an external wireless microphone.*

Requirements for connecting systems:

1. Revolabs Single-Channel system
2. Polycom SoundStation 2 speakerphone with LCD screen
3. Qty 1 Revolabs 2.5mm to RCA breakout cable (provided with single-channel system)

Connecting the Cables

CONNECTING A REVOLABS FUSION TO SOUNDSTATION 2 SPEAKERPHONE

1. Connect Single-Channel to SoundStation 2 Auxiliary Audio Port using Revolabs 2.5mm to RCA cable

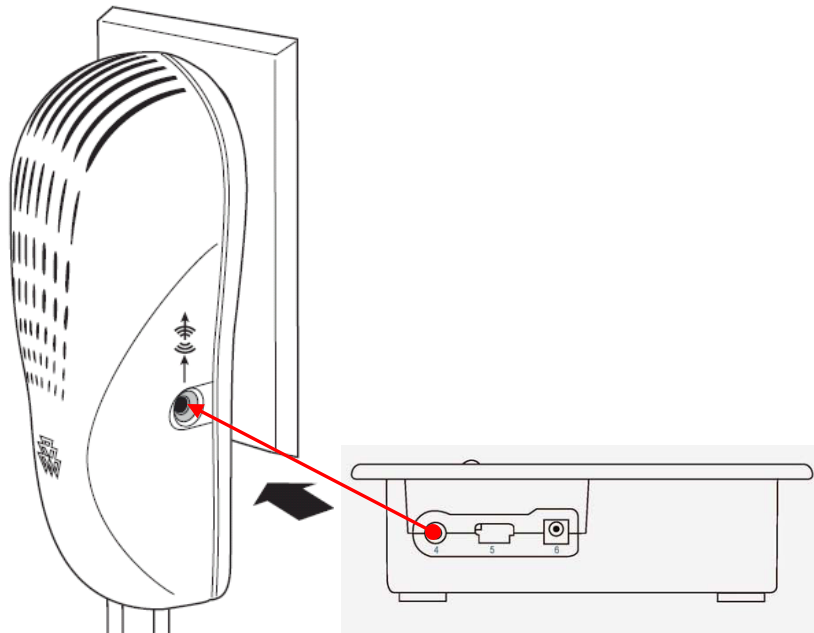

Configuring the SoundStation 2 Speakerphone

CONFIGURING THE AUDIO MENUS OF THE SOUNDSTATION 2 SPEAKERPHONE

1. Press MENU Button
2. Press SELECT (Checkmark) for Settings
3. Scroll down to AUX AUDIO then Press SELECT
4. Use Soft Keys Right to select WIRELESS MIC then press SAVE

NOTES:

- 1. In this case, Revolabs only recommends using the wearable lapel microphone or using a third-party dynamic microphone with the Revolabs XLR adapter module. Please note that the volume levels of the Revolabs microphones are not adjustable.**
- 2. The use of Revolabs boundary microphones (omnidirectional or directional versions) has been tested and found to be significantly louder than the SoundStation 2 microphones at a 3' distance. Use of these microphones may overpower other users on the Polycom microphones (built-in console microphone and/or external microphones). As above, the volume levels of the Revolabs microphones are not adjustable.**