

# *Artesia*

- Deluxe Upright Digital Piano
- **AP-120e**

# Precaution

Thank you for purchasing this digital instrument. For correct use, please read the manual carefully and keep it for future reference. please read the manual carefully and keep it for future reference.

## Safety Precautions



The lightning flash with arrowhead symbol within an equilateral triangle is intended to alert the user to the presence of uninsulated “dangerous voltage” Within the product s enclosure that may be of sufficient magnitude to constitute a risk of electric shock to persons.



The exclamation point within an equilateral triangle is intended to alert the user to the presence of important operating and maintenance (servicing) instructions in the literature accompanying the product.

## Important Safety Instructions



(Figure 1)

- 1) Read these instructions.
- 2) Keep these instructions.
- 3) Heed all warnings.
- 4) Follow all instructions.
- 5) Do not use this apparatus near water.
- 6) Clean only with dry cloth.
- 7) Do not block any ventilation openings, and install in accordance with the manufacturer's instructions.
- 8) Do not install near any heat sources such as radiators, heat registers, stoves, or other apparatus (including amplifiers) that produce heat.
- 9) Do not defeat the safety purpose of the polarized or grounding-type plug. A polarized plug has two blades with one wider than the other. A grounding type plug has two blades and a third grounding prong. The wide blade or the third prong is provided for your safety. If the provided plug does not fit into your outlet, consult an electrician for replacement of the obsolete outlet.
- 10) Protect the power cord from being walked on or pinched particularly at plugs, convenience receptacles, and the point where they exit from the apparatus.
- 11) Only use attachments/accessories specified by the manufacturer.
- 12) Use only with the cart, stand, tripod, bracket, or table specified by the manufacturer or sold with the apparatus. When a cart is used, use caution when moving the cart/apparatus combination to avoid injury from tip-over (Figure 1) .
- 13) Unplug this apparatus during lightning storms or when unused over a long period of time.
- 14) Refer all servicing to qualified service personnel. Servicing is required when the apparatus has been damaged in any way, such as power-supply cord or plug is damaged, liquid has been spilled or objects have fallen into the apparatus, the apparatus has been exposed to rain or moisture, does not operate normally, or has been dropped.

**WARNING:** To reduce the risk of fire or electric shock, do not expose this equipment to rain or moisture.

**CAUTION:** Equipment must not be exposed to liquid dripping or splashing and also no objects filled with liquids, such as vases, or beverages may be placed.

Always make sure all batteries are inserted the correct way around to match the +/- polarity markings.

Always replace all of the batteries at the same time. Do not combine old and new batteries, also do not mix battery types, as this can cause overheating, or fire, or battery fluid leakage.

Remove the batteries from the instrument if it is not to be used for a long time.

## **Thanks for Using Our digital piano**

Your piano is a high quality digital piano featuring an 88 Standard touch sensitive keyboard and the most advanced PCM tone generation technology that combined will provide you with a rich performing and playing experience. You can also record your own performances or record your own accompaniment to play along to. To get the most out of your instrument, please read this manual thoroughly and try out the various functions as we take you through them.

# Contents

<b>Contents</b> .....	1
<b>Panel Control</b> .....	2
<b>Set Up</b> .....	4
<b>Basic Operation</b> .....	5
Power Switch .....	5
Foot Pedals .....	5
Adjusting the Main Volume .....	6
Bass&Treble .....	6
Playing Demo Songs .....	7
[+ / YES] & [- / NO] .....	8
<b>The Connector Box</b> .....	9
Headphones .....	9
MIDI OUT .....	9
Line OUT .....	10
Using USB-MIDI .....	10
Aux In .....	10
Blue tooth .....	11
<b>Voices</b> .....	12
Selecting the Voice .....	12
Load the preset data .....	13
Switch to BANK .....	13
Preset Save preset .....	13
Style Freeze .....	13
Save To .....	14
KBD.Vol Button .....	15
Layer Button .....	16
Split Button .....	17
DUET Button .....	17
<b>Effect</b> .....	18
Reverb .....	18
Chorus .....	19
Touch .....	20
<b>Style</b> .....	20
Selecting Styles .....	20
<b>Function</b> .....	22
<b>Auto Accompaniment</b> .....	41
Style Selection .....	41
Starting a Style .....	41
Stopping a Style .....	43
Change the Tempo .....	43
Metronome .....	44
Chord Function .....	44
O.T.S Function .....	46
Acc.Vol Function .....	47
<b>Recording</b> .....	48
Record .....	48
<b>Teaching Function</b> .....	54
<b>Factory Reset</b> .....	56
<b>Appendix</b> .....	57
Percussion Voice List .....	57
Voice List.....	58
Style List .....	59
Troubleshooting Hints .....	60
Specifications .....	61
Assembly Instruction .....	62

# Panel Control

## **Front Panel**

1. STANDBY/ON
2. DEMO Button
3. MASTER VOLUME
4. BASS
5. TREBLE
6. STYLES SELECT  
BALLAD Button  
COMBO Button  
POP Button  
LATIN Button
7. METRONOME Button
8. TAP/TEMPO Button
9. ACCOMPANIMENT CONTROL  
CHORD/O.T.S Button  
SYNCHRO Button  
INTRO/ENDING Button  
START/STOP Button  
FILL IN1 Button  
FILL IN2/VARIATION Button
10. Acc.Vol Button
11. KB.Vol Button
12. REVERB Button
13. CHORUS Button
14. KEYBOARD CONTROL  
LAYER Button  
TOUCH Button  
SPLIT Button  
DUET Button
15. FUNCTION Button
16. ENTER Button
17. +/YES Button
18. -/NO Button

19. DATA Wheel
20. VOICES SELECTION  
GRAND PIANO/M1  
E.PIANO/M2  
VIBES/M3  
A/M4  
HARPSI/STORE/BANK  
ORGAN/M5  
STRINGS/M6  
USER/STYLE HOLD  
STORE/SAVE TO
21. RECORD SELECTION  
RECORD  
MEMORY  
PLAY/STOP  
TRACK
22. SONG  
TRACK1  
TRACK2
23. LCD Display

## **Rear Panel**

24. HEADPHONES1/2 Jacks
25. MIDI OUT Jacks
26. USB TO HOST Jack
27. Bluetooth Jack
28. AUX IN Jacks
29. LINE OUT Jacks
30. Input Level
31. PEDAL
32. POWER INPUT  
AC110V~60Hz

# Interface Panel

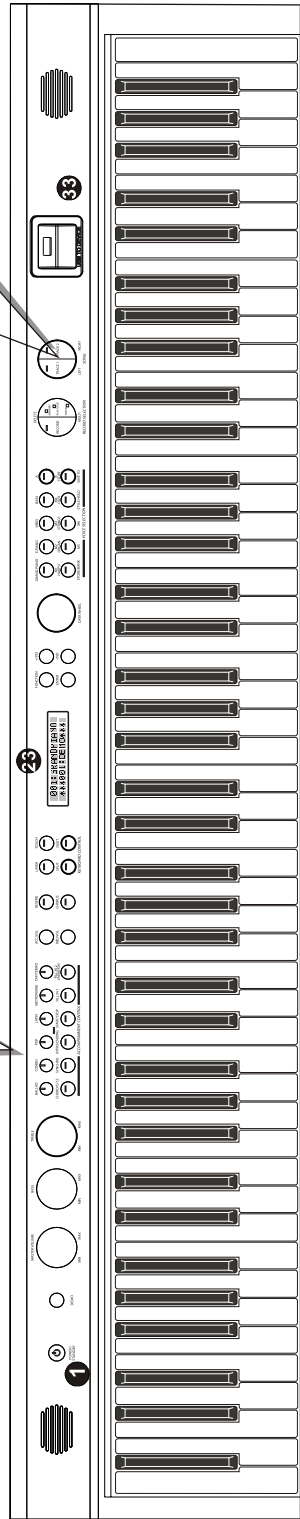
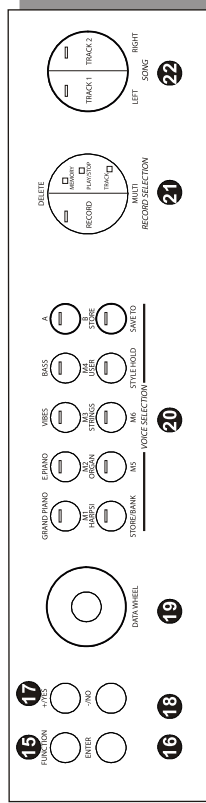
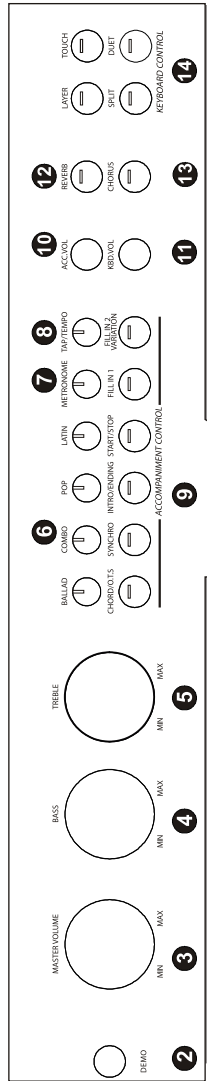
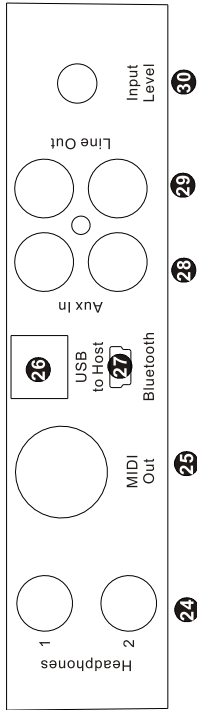
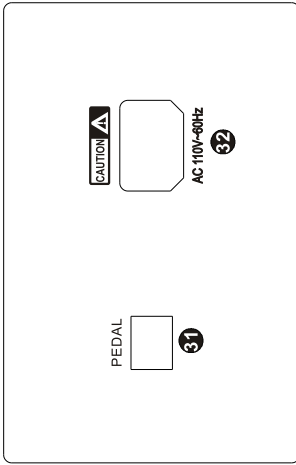

# SET UP

You are no doubt eager to play your piano, but first please make sure you have completed the following basic setup steps:

- 1) Follow the assembly instructions as outlined on page 46 in the appendix of this manual.
- 2) Once the piano is securely assembled, connect the plug of the foot pedal unit to the pedal jack on the rear panel.

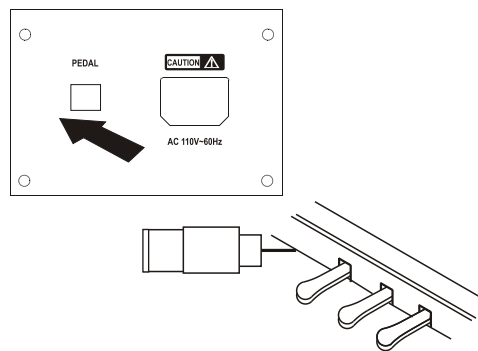

- 3) Plug in the included power chord to the rear of the piano body as illustrated below. Position the piano in the desired location, making sure that the power chord can reach a AC power connection point.

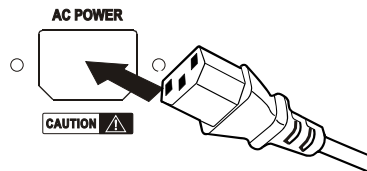

- 4) Then plug the other end of the power cable into the AC power outlet.

**NOTE:**

1. Ensure the piano is turned off when connecting and disconnecting the power.
2. Turn the volume knob to its minimum level before turning on the power.

# Basic Operation

## Power Switch

Press the [STANDBY/ON] button to turn on the power and the LCD display will light.



## Auto Standby

Your piano will switch off automatically in 30 minutes after no any operation on it. In this case, press the [STANDBY/ON] button again to turn on the power.

### **NOTE:**

*When you are playing the Demo song, it will not switch off automatically in 30 minutes after no any operation on it.*

## Deactivate Auto Standby Function

Hold the first white key and first black key on the left side of the keyboard at the same time and then press the [STANDBY/ON] button to deactivate the Auto Standby function. (Reference: Auto Power off time P39)

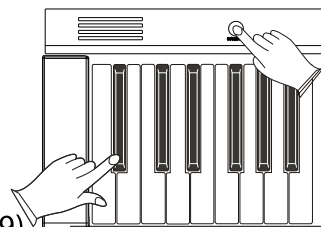

## Foot Pedals

Connect the plug of the foot pedal unit to the pedal jack in the button panel.

PEDAL

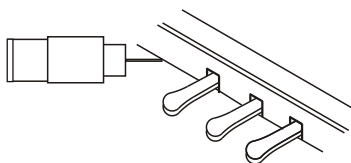

### ■ Damper Pedal (Right)

It performs the same function as the damper pedal on an actual acoustic piano, letting you sustain the sound of the voices even after releasing your fingers from the keys.

Your piano has Half-pedal function. You may release your foot from the pedal to different position to change the sustain time. The less you release your foot from the pedal, the longer the sustain effect lasts. (Reference:Function(Half-sustain P38))



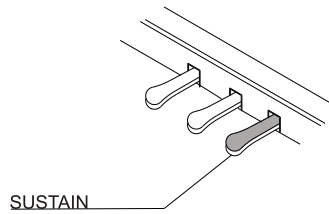

### ■ Sostenuto Pedal (Center)

If you play a note or chord on the keyboard and press the sostenuto pedal while the notes are held, those notes will be sustained as long as the pedal is held, but all subsequently played notes will not be sustained.

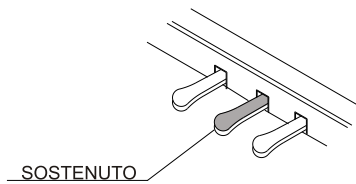

### ■ Soft Pedal (Left)

The Soft Pedal controls the sound volume. Press the pedal to decrease the output sound volume.

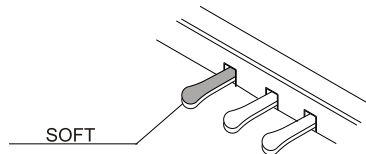

## Adjusting Volume

Turn the [MASTER VOLUME] knob to adjust the volume to your desired level.

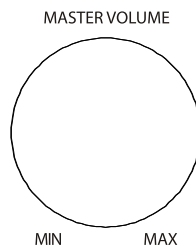

## Bass & Treble

With the Bass and Treble controls you can adjust the sound of your piano to your room or according to your taste. As a starting point, set both controls to their neutral 12 o'clock position. If you want more bass move the Bass control to the right and if you want less, move it to the left.

If you prefer a brighter sound move the Treble control to the right or move it to the left if you prefer a slightly darker tone.

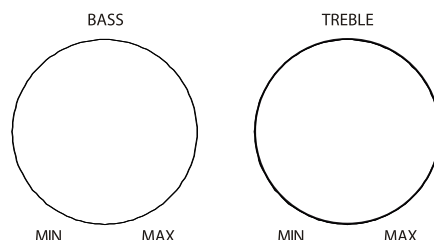

## Playing Demo Songs

There are 10 demo songs for you to play individually. Here's how to select and play the demo songs.

### ■ Listen to Demo Songs

Press the [DEMO] button to enter Demo Mode.

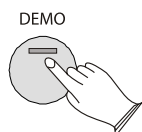

The display will show “DEMO,” and the button will flash, then the demo songs will play in sequence. You can use the [+ / YES] / [- / NO] buttons or [DATA WHEEL] Knob to select the song you want to play.



Press the [DEMO] button again to stop playing.

You may play songs from USB disk. Reference USB Recording.

**[+ / YES] & [- / NO]**

Parameter adjusting button.

# The Connector Box

The piano features a connection box which allows you to connect external audio equipment, a computer, other MIDI equipment or headphones. The following describes each option in more detail.

## Headphones

Two sets of standard stereo headphones can be plugged in here for private practice or late-night playing. The internal speaker system is automatically shut off when a pair of headphones is plugged into PHONES jacks.

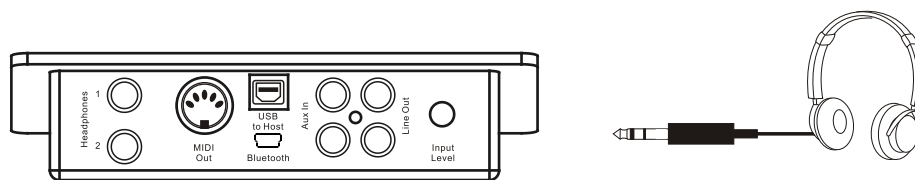

### **NOTE:**

*Never use headphones at a high volume, because high volume levels may cause permanent hearing damage.*

## MIDI OUT

MIDI (Musical Instrument Digital Interface) is a world-standard communication interface which allows electronic musical instruments to communicate with each other, by sending and receiving compatible note, program change and other types of MIDI data. You should only plug the MIDI out in to another device featuring a MIDI input.

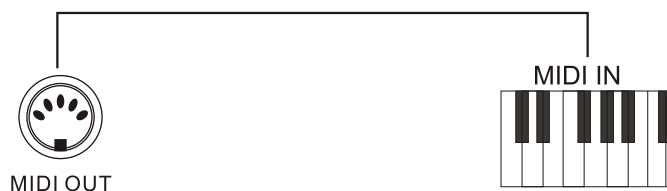

### **NOTE:**

*MIDI OUT Transmits MIDI data to another MIDI device.*

## Line OUT

The piano's stereo RCA line output can be used to deliver the output of the piano to a keyboard amplifier, stereo sound system, mixing console or tape recorder. The piano's internal sound system will remain on unless headphones are plugged in to the 1. Headphone jack.

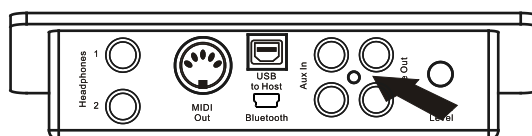

## Using USB-MIDI

This product allows the transfer of MIDI information over USB to a computer. As complicated this might sound, it's actually pretty straight forward. Because your piano is USB Class Compliant, there is no need to install a driver to enable it to work with compute. Simply just plug it in and the OS will do the rest. The piano will work with all standard MIDI based computer software.

USB AUDIO interface is a digital audio interface. By USB cable, you can digitally transfer intact audio signals of PC to this instrument, and enjoy it on this instrument or use it for accompany when you play this instrument; likewise, you can transfer intact audio signals of the instrument to PC to record and edit music.

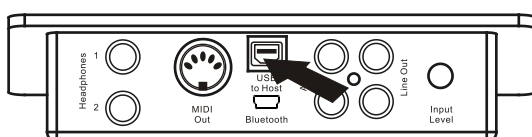

### **NOTE:**

*The piano also support the USB Audio.*

## Aux In

The Aux In stereo RCA connectors allow you to mix an external sound source (such as a CD player, MP3 player or computer output) with the piano's internal sounds, for playback through the piano's built-in speakers or headphone outputs.

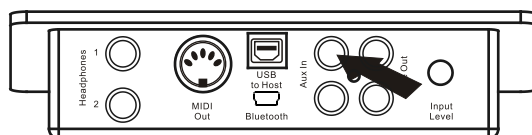

The Aux In signal level can be adjusted using the Input Level knob.

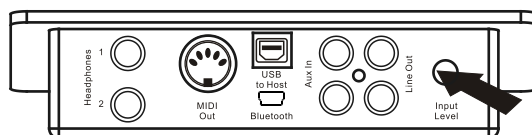

## Blue tooth

This piano can support Blue tooth with the Connection of the Blue tooth jack,  
Reference: Blue tooth.

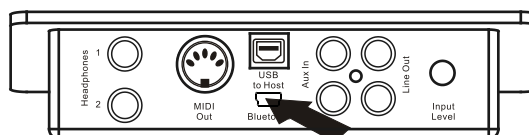

# Voices

The piano has 137 voices and a variation of each voice pattern to choose from. There is a complete list of all 137 voices. (Reference: Appendix (Voice List) P58)

There are 8 direct voice select buttons (including a USER button), you can use [+ / YES] and [- / NO] buttons or [DATA WHEEL] knob to select the desired voice.

## Selecting the Voice

You can switch by [A/B] button to select the 8 direct-selecting voice buttons and [M1]/[M2]/[M3]/[M4]/[STORE/BANK]/[M5]/[M6]/[STYLE HOLD]/[SAVE TO] buttons.

● When the indicator of [A/B] button is off, the 8 buttons can be used to directly select the desired voice and you can use [+ / YES] and [- / NO] buttons or [DATA WHEEL] knob to select the desired voice.

Hold the **GRAND PIANO** button for 2 seconds to restore to Grand Piano voice.

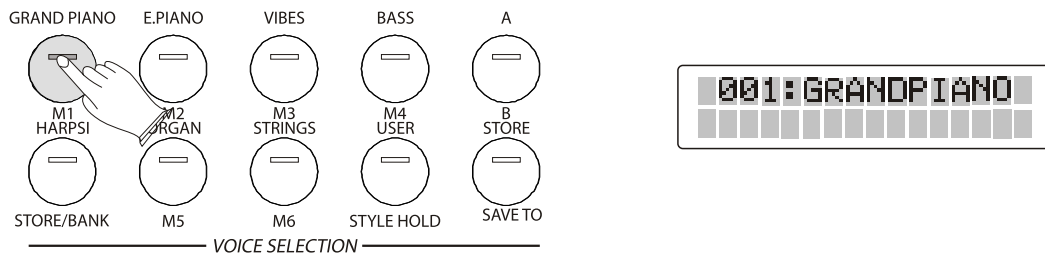

The [USER] button is the direct-selecting-voice button for users to define its function. Its default selected voice is nylon guitar. Press the [USER] button and the LCD will show its current corresponding voice, then you may press the [+ / YES] and [- / NO] buttons or the data dial to select your desired voice. Hold the [store] button and press the [USER] button, then the selected voice will be saved and set to the [USER] button which has the power-down save function. The saved voice will be still there in the next power-on.

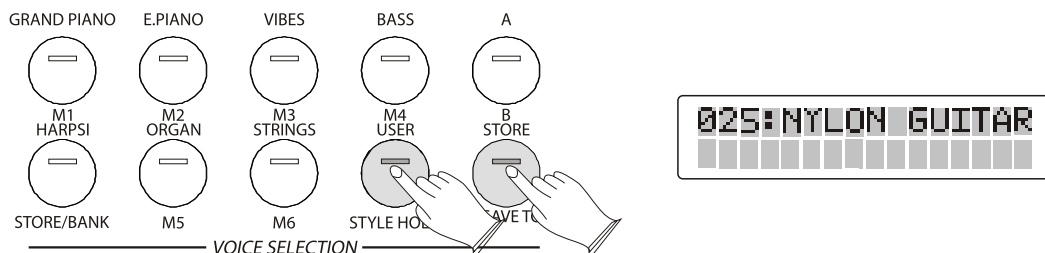

● Press the **【A/B】** button and its indicator is on. Then the 8 direct-selecting-voice buttons can be used as M1/M2/M3/M4/STORE.BANK/M5/M6/STYLE HOLD/SAVE TO.

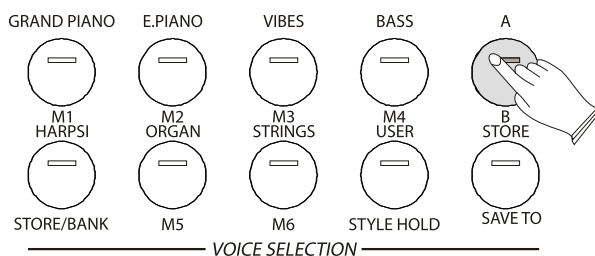

## Load the preset data

Press the **【A】** button and the indicator is light. Then press one of the **【M1】**-**【M5】** button to load corresponding PRESET data.

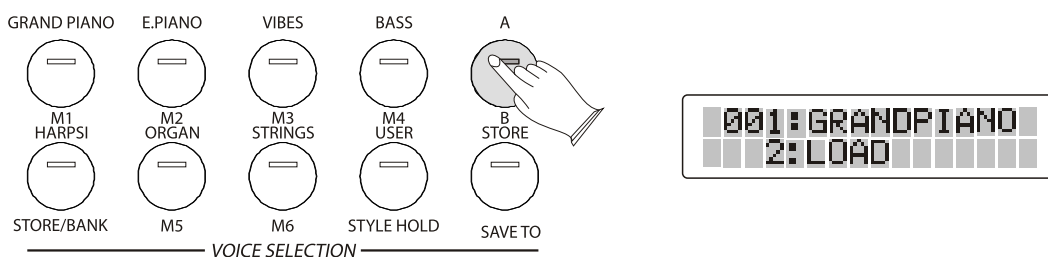

Preset Data:

MainVoice	Tune	SplitOctave	MainReverb Level	StyleHold	ChordSplit Point
SplitVoice	MainPan	LayerOctave	SplitReverb Level	StyleNumber	VoiceSplit Point
LayerVoice	SplitPan	Metronome Volume	LayerReverb Level	Tempo	Touch OnOff
MainVolume	LayerPan	Reverb/chorus OnOff	MainChorus Level	Chord OnOff	Split/Layer OnOff
SplitVolume	Transpose	ReverbType	SplitChorus Level	Variation OnOff	DUET OnOff
LayerVolume	MainOctave	ChorusType	LayerChorus Level	Style Volume	Uservoice

## Switch to BANK

Press the **【STORE/BANK】** button to switch between banks. One BANK corresponds 6 PRESET sheets, and your instrument has 6 banks and it has 36 PRESET sheets in total.

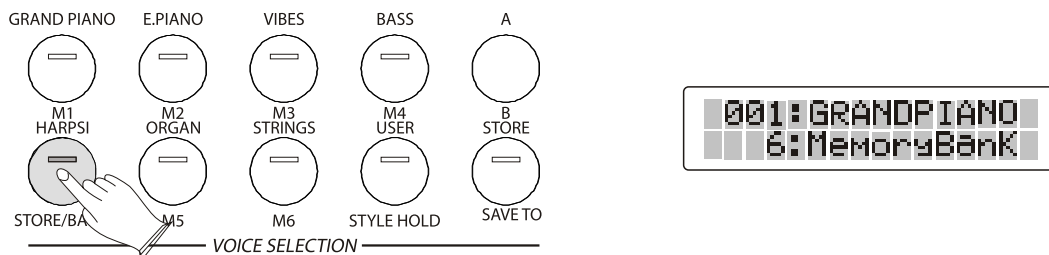



## Preset Save

Press the [A] button and the indicator is light. Then hold down the **【STORE/BANK】** button and press one of the **【M1】** - **【M6】** buttons; then the current data will be saved to the selected M buttons.

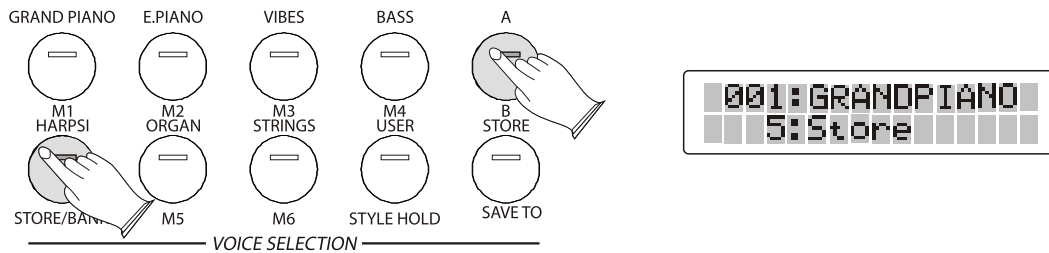

Example, save the current data to the **【M5】** button of the BANK 2:  
 Press the **【STORE/BANK】** button to switch to BANK 2.  
 Hold the **【STORE/BANK】** button and press the **【M5】** button.  
 You have saved the current data to the **【M5】** button of the BANK 2.

## Style Freeze

Press the [A] button and the indicator is light. Then press the [STYLE HOLD] button to start the function. If you load the PRESET data, your instrument will shield the following relevant style data: Style Number, Tempo, Chord On/Off, Variation On/Off, StyleVolume, ChordSplitPoint.

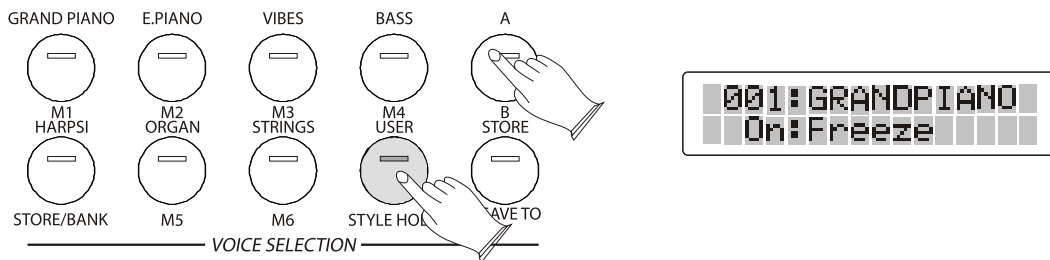

## Save To

This button is used to operate the transferred store between USB and internal recording or internal registered file. The operation must after the insertion of USB and the press of Memory.

### 1.Save TRACK to USB

You can save internal recording track data to USB as a MIDI file .

Press the [A] button and the indicator is light, then press

[STORE/SAVE TO] button repeatedly to select "Save TCK TO USB? "

Press the [+ /YES] button to confirm it and the LCD display "SAVE OK ".

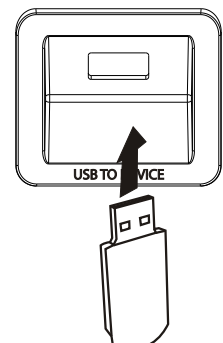

### 2.Load Midi File

Load midi file to internal recording track.

Press the [A] button and the indicator is light, then press [STORE/SAVE TO] button repeatedly to select "Load MIDI File? ".

Press the [+ /YES] button to confirm it and the LCD display "LOAD OK".

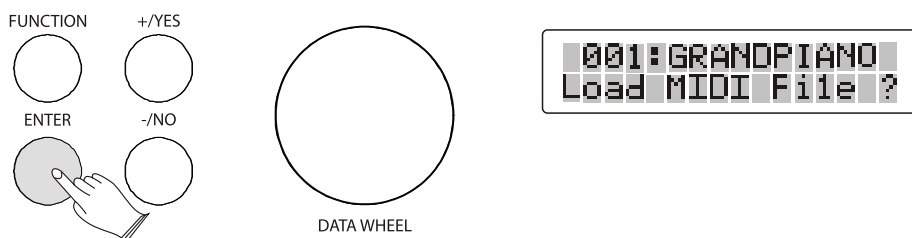

### 3.Save REG to USB

Save thirty six PRESET data table into REG\_xx file and save it to USB.

Press the [A] button and the indicator is light, then press the [STORE/SAVE TO] button repeatedly to select "Save REG TO USB? ".

Press the [+ /YES] button to confirm it and the LCD display "SAVE OK".

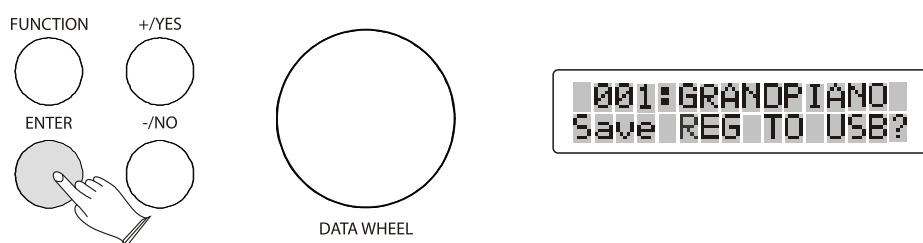

#### **NOTE:**

*The operation of loading REG file: choose the REG\_XX file ,which needs loading, by using 【+】 【-】 or data in turns .Press 【PLAY】 button and load thirty six sheet of PRESSET file to MEMORY.*

## KBD.Vol Button

Use this function can adjust the Split Voice Volume, Dual Voice Volume and the Main Voice Volume.

### ■ Main Voice Volume

You can adjust the main voice volume by pressing [KBD.VOL] button and the LCD will display "100:Main.Volume", then you can use the [+ /YES] and [- /NO] buttons or the [DATA WHEEL] knob to set the main voice value:0-127.(Default:100)

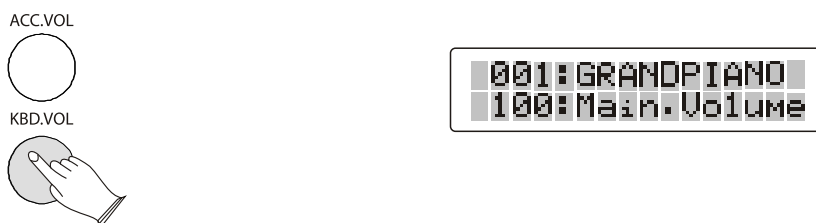

### ■ Split Voice Volume

- Press the [SPLIT] button to select split mode and the indicator is flashing.
- In this mode, you can press the [KBD.VOL] button and the LCD will display "80:Split.Volume",

you can use the [+ / YES] and [- / NO] buttons or the [DATA WHEEL] knob to set the split voice value:0-127.(Default:80)

When the Split indicator is not flashed, then press the [KBD.VOL] button to set the Main Voice Volume.



## ■ Dual Voice Volume

- Press the [LAYER] button to select Layer mode and the Layer Cursor is flashing.
- In this mode, you can press the [KBD.VOL] button and the LCD will display "50:Layer.Volume", then you can use the [+ / YES] and [- / NO] buttons or the [DATA WHEEL] knob to set the layer voice value:0-127.(Default:50)

When the Layer indicator is not flashed, then press the [KBD.VOL] button to set the Main Voice Volume.



## Layer Button

In Layer mode two voices may be played simultaneously, each at selected volumes. To enter Layer mode by either of two methods: a. Press the [LAYER] button and the indicator is flashing, then press the voice button to select the second voice.

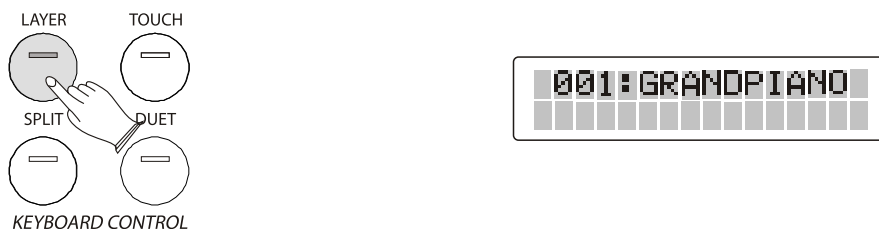

b. In Layer mode, press the [LAYER] button and hold 2 seconds and the indicator is flashing, then press the voice button to select the second voice. You should press the [LAYER] button again to enter Layer mode.

If you don't choose the layer voice within 5 seconds after entering the Layer mode, it will quit this menu automatically.

When the Layer indicator is unlighted, then press the voice select button to select the Main voice.

Press the [LAYER] again, the Layer indicator turns off and the Layer mode is no longer active.

## Split Button

Press the [SPLIT] button to select split mode, your keyboard will be split into two sections which means different voices can be played with the left and right hands at the same time.

In Split mode, press the [SPLIT] button, the Split indicator is flashing, then press the voice select button to select the left hand voice.

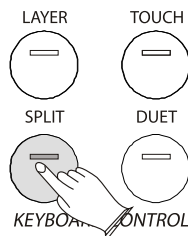

If you don't choose the left voice within 5 seconds after entering the split mode, it will quit this menu automatically.

When the Split indicator is unlighted, then press the voice select button to select the Main voice.

Press [SPLIT] again, the Split indicator turns off and the Split mode is no longer active.

## DUET Button

Press the [DUET] button to select DUET mode. In this mode, the keyboard will be separated into two playing areas.

Right: from C#3 to C7

Left: from A-1 to C3

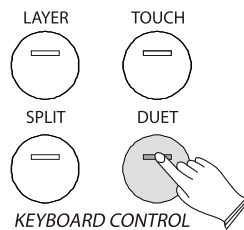

This will be very helpful when the instrument is used by two players at the same time and they will be able to play the same piano sound in the same octave.

Press [DUET] button again to exit the DUET mode.

While the DUET feature is selected using the optional 3 lever pedal, the pedals automatically switch in a different configuration where there are 2 Sustain pedals, one for the left and one for the right part of the keyboard.

# Effect

## Reverb

The [REVERB] button selects a number of digital reverb effects that you can use for extra depth and expressive power.

Press the [REVERB] button can turn on or turn off the reverb effect.(Default: 7:stage2)

When the reverb mode is turned off, you can press the [REVERB] button again and then use the [+ /YES] and [- /NO] buttons or [DATA WHEEL] knob to select reverb type.

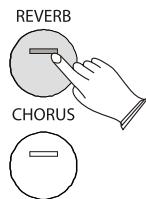

The reverb types in the list below can be selected from the reverb display.

0	1	2	3	4	5	6	7	8
Off	Hall1	Hall2	Room1	Room2	Room3	Stage 1	Stage2	Plate

## Chorus

Shimmering, broadening effect.

Press the [REVERB] button can turn on or turn off the reverb effect.(Default:3:Chorus3)

When the chorus mode is turned off, you can press the [CHORUS] button again and then use the [+ /YES] and [- /NO] buttons or [DATA WHEEL] knob to select chorus type.

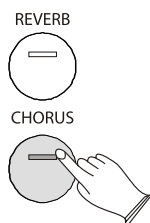

The chorus types in the list below can be selected from the chorus display.

0	1	2	3	4	5	6	7	8
off	Chorus1	Chorus2	Chorus3	Feedback	Flanger1	ShortDelay	ShortDe- layFb	Flanger2

## Touch

The touch function provides three different types of keyboard touch sensitivity and you may match them with different playing styles: Normal, Soft , Hard (Default: Normal).

When your piano is in power-on state, the default touch sensitivity is on and the indicator will light. You press the [TOUCH] button repeatedly to turn touch sensitivity on or off as required.

When [TOUCH] is off, the indicator is unlighted. Press the [TOUCH] button repeatedly to select : 100 Fixed, then you can use [+ /YES] and [- /NO] buttons or the [DATA WHEEL] knob to select the fixed touch sensitivity. Range: 00~127.

