

# Wireless Bluetooth Audio Music Receiver

## User's manual

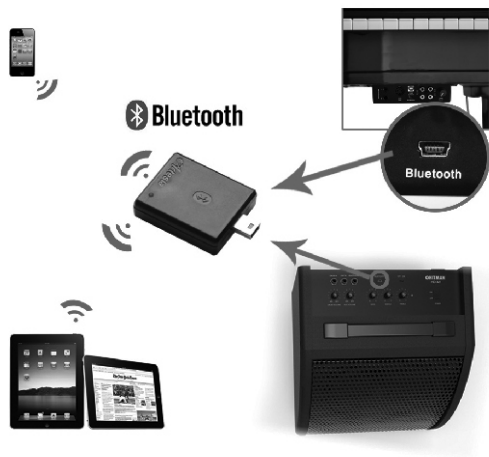

All brand names and trademarks are properties of their  
Respective owners.

## Feature description

- Compliant with Bluetooth 2.1 specification
- -80dBm receiver sensitivity
- Operates in 2.402-2.480 GHz ISM band

## Compatible with:

- most A2DP stereo Bluetooth-enabled devices

## Installation

1. Make sure that the digital piano is powered off, and connect the Bluetooth- Receiver to your digital piano.
2. Turn on the digital piano, switch on the Bluetooth power according to Bluetooth instructions.
3. When the Bluetooth power is on , blue power indicator lamp should flash -quickly, which lasts about five seconds. Then it will flash again after every 0.7 second until matching successfully. At this time , the Bluetooth enters into the pairing mode.
4. After entering into pairing mode, pair your device with our Bluetooth Receiver, find Artesia-BT1 and connect them.
5. When you see the blue indicator lamp of Bluetooth Receiver burn steady, the matching has been successful.

## Caution

1. If unable to pair or connect, make sure that another previously paired / connected device has been disconnected.
2. If still unable to pair or connect, disable Bluetooth on your device - re-enable Bluetooth and attempt to pair / connect again.
3. If you need to change the play device during normal operation, disconnect the connected Bluetooth PC and cell phone, and then perform pairing connection for other Bluetooth devices.

FCC Caution.

#### § 15.19 Labelling requirements.

This device complies with part 15 of the FCC Rules. Operation is subject to the following two conditions: (1) This device may not cause harmful interference, and (2) this device must accept any interference received, including interference that may cause undesired operation.

#### § 15.21 Information to user.

Any Changes or modifications not expressly approved by the party responsible for compliance could void the user's authority to operate the equipment.

#### § 15.105 Information to the user.

Note: This equipment has been tested and found to comply with the limits for a Class B digital device, pursuant to part 15 of the FCC Rules. These limits are designed to provide reasonable protection against harmful interference in a residential installation. This equipment generates uses and can radiate radio frequency energy and, if not installed and used in accordance with the instructions, may cause harmful interference to radio communications. However, there is no guarantee that interference will not occur in a particular installation. If this equipment does cause harmful interference to radio or television reception, which can be determined by turning the equipment off and on, the user is encouraged to try to correct the interference by one or more of the following measures:

- Reorient or relocate the receiving antenna.
- Increase the separation between the equipment and receiver.
- Connect the equipment into an outlet on a circuit different from that to which the receiver is connected.
- Consult the dealer or an experienced radio/TV technician for help.

RF warning for Portable device:

The device has been evaluated to meet general RF exposure requirement. The device can be used in portable exposure condition without restriction.