

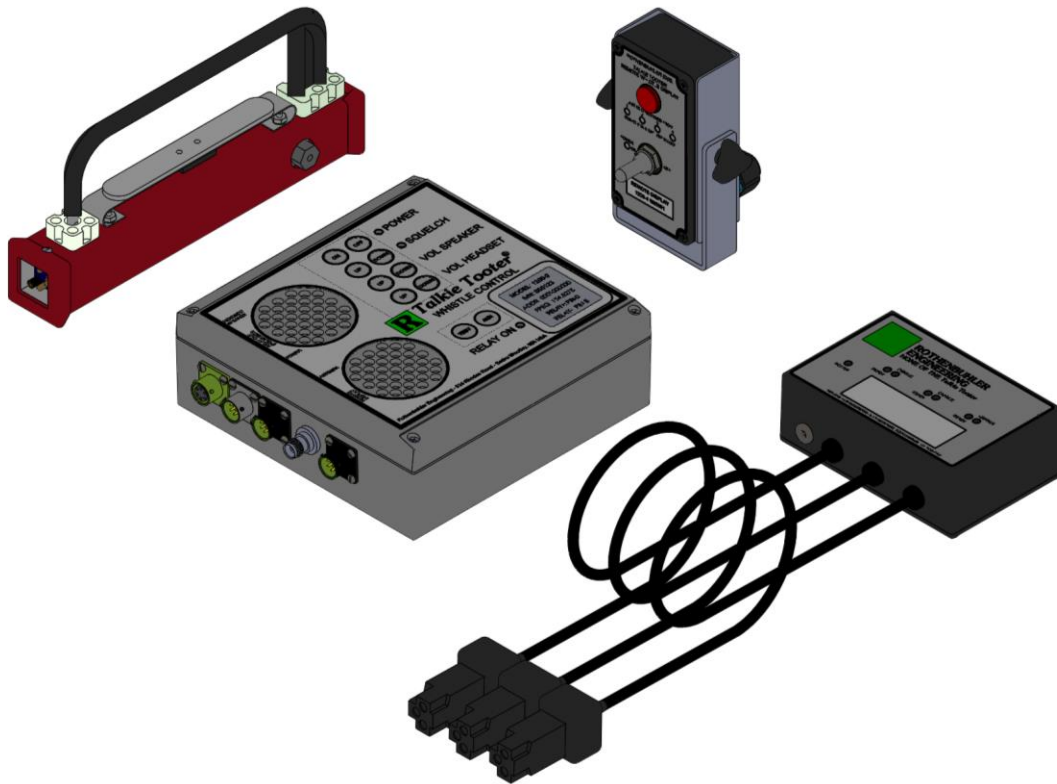

**ROTHENBUHLER  
ENGINEERING®**

## ***TALKIE TOOTER WHISTLE USER MANUAL***



The information contained in this document is subject to change without notice. In no event shall Rothenbuhler Engineering Company be liable for errors contained herein or for special, indirect, or consequential damages or injuries of any nature resulting from use of information in this document.

ROTHENBUHLER ENGINEERING  
P.O. BOX 708  
524 RHODES ROAD  
SEDRO WOOLLEY, WA 98284

1200-A19  
1/23/2020

©2020 Rothenbuhler Engineering  
All Rights reserved

## Table of Contents

Safety Warnings .....	3
Limited Warranty .....	4
Regulatory Information .....	5
Introduction to the 1200 Whistle System .....	8
The 1200-2 Whistle Receiver .....	9
1200-1 Whistle Transmitter .....	11
Li-Ion Battery Charger .....	13
1200-4 Remote Display Panel.....	16

## Table of Figures

FIGURE 1 1200-2 WHISTLE RECEIVER.....	9
FIGURE 2 WHISTLE RECEIVER PANEL .....	10
FIGURE 3 1200-1 WHISTLE TRANSMITTER.....	11
FIGURE 4 WHISTLE TRANSMITTER ANATOMY.....	13
FIGURE 5 1200-8 LI-ION CHARGER .....	14
FIGURE 6 1200-4 REMOTE DISPLAY PANEL .....	16

## Table of Tables

TABLE 1 WHISTLE RECEIVER PANEL.....	11
TABLE 2 WHISTLE TRANSMITTER ANATOMY .....	13
TABLE 3 LI-ION CHARGER .....	14

## Safety Warnings

- 1) Always follow your local safety regulations. This manual and its procedures are secondary to governmental regulations, local regulations or company safety regulations and procedures. The operation procedures in this manual are only suggestions and should be checked against the above safety regulations and procedures. Company training should include the proper use of this equipment and only trained personnel should use it.
- 2) Never rely on this equipment or any equipment totally for your safety. All mechanical and electronic equipment can fail. Always have a safety procedure that will protect you and minimize hazards of such failure.
- 3) This Talkie Tooter® Radio Equipment should be installed by a Factory Authorized installer. Improper installation may result in Safety Hazards, Poor Performance and/or Damage to Equipment, which may not be covered by warranty.
- 4) The 1200-3 Li-Ion Battery Charger is for dry indoor use only. Only use a manufacturer authorized battery charger. Attempting to use an unauthorized battery charger may result in a safety hazard and equipment damage may occur. Disconnect the battery charger from the unit when charging has completed.
- 5) This equipment does not include any internal user serviceable items. Opening the internal cases is strictly prohibited and may result in safety hazards and equipment damage.
- 6) Return the equipment to the manufacturer or authorized service center if has been damaged or is not operating correctly.
- 7) Do not operate the equipment if it has been damaged, is suspected of being damaged, or does not operate correctly.
- 8) Only manufacturer authorized parts and accessories are allowed to be used with this equipment.
- 9) The internal battery is not user replaceable. When battery replacement is necessary, the replacement must be conducted by trained personnel of a manufacturer authorized service center using only factory approved batteries. Use of an unauthorized battery may result in equipment damage and / or a hazardous condition.
- 10) If this equipment is used in a manner not specified by the manufacturer, the protection provided by the equipment may be impaired.

## Limited Warranty

Your *Talkie Tooter*® Radio Equipment is guaranteed for 2 years (batteries - 1 year) against defects and workmanship. If your *Talkie Tooter* equipment should break down during this period, we will repair it at our factory or at the nearest authorized service shop. Only an authorized dealer may perform warranty service on your *Talkie Tooter* equipment. Unauthorized service procedures or parts will void and cancel your warranty, and may cause radio equipment to fail, resulting in accidents and personal injury.

This is a limited warranty and is given in place of legally implied warranties of merchantability and fitness for a particular purpose. Our liability is expressly limited to the cost of repair or replacement of the *Talkie Tooter* under this guarantee, and does not extend to additional or consequential damages resulting from operation of the *Talkie Tooter* equipment.

# **Regulatory Information**

## **UNITED STATES**

### **FCC NOTICE**

This device complies with Part 15 of the FCC regulations. Operation is subject to the following two conditions: (1) That this device may not cause harmful interference, and (2) This device must accept any interference received, including interference that may cause undesired operation of the device.

The radio contained in this device operates in FCC regulated frequency bands. This device must be licensed by the FCC before use. Because this device contains a transmitter, federal law prohibits unauthorized use or adjustments of this radio.

Changes or modifications to this device, not expressly approved by the FCC and Rothenbuhler Engineering, could void the user's authority to operate the equipment.

## **INDUSTRY CANADA NOTIFICATIONS**

This device complies with Industry Canada's license-exempt RSSs. Operation is subject to the following two conditions:

(1) This device may not cause interference; and

(2) This device must accept any interference, including interference that may cause undesired operation of the device.

Le présent appareil est conforme aux CNR d'Industrie Canada applicables aux appareils radio exempts de licence. L'exploitation est autorisée aux deux conditions suivantes:

(1) l'appareil ne doit pas produire de brouillage;

(2) l'utilisateur de l'appareil doit accepter tout brouillage radioélectrique subi, même si le brouillage est susceptible d'en compromettre le fonctionnement.

Under Industry Canada regulations, these radio transmitter models may only operate using an antenna of a type and maximum (or lesser) gain approved for the transmitters by Industry Canada. To reduce potential radio interference to other users, the antenna type and its gain should be so chosen that the

equivalent isotropically radiated power (e.i.r.p.) is not more than that necessary for successful communication.

This radio transmitter model 1200-1 has been approved by Industry Canada (IC 2758A-120001): 1200-1 Whistle Transmitter – Integral Antenna: gain 0dBi

Only Factory accessories are approved for use with this device – e.g. third party holsters, belt clips etc. are not approved for use.

Contact information where the user can obtain Canadian information on RF exposure and compliance.

1. Health Canada Safety Code 6:

[http://www.hc-sc.gc.ca/ewh-semt/pubs/radiation/radio\\_guide-lignes\\_direct-eng.php](http://www.hc-sc.gc.ca/ewh-semt/pubs/radiation/radio_guide-lignes_direct-eng.php)

2. RSS-102:

<http://www.ic.gc.ca/eic/site/smt-gst.nsf/eng/sf01904.html>

En vertu des règlements d'Industrie Canada , ces modèles d'émetteurs de radio ne peuvent fonctionner en utilisant une antenne d'un type et maximale ( ou moins ) Gain approuvé pour les émetteurs par Industrie Canada . Pour réduire les interférences radio potentielles aux autres utilisateurs , le type d'antenne et son gain doivent être choisis afin que la puissance isotrope rayonnée équivalente ( PIRE) ne est pas plus de ce qui est nécessaire pour une communication réussie.

Ces modèles d'émetteurs radio 1200-1 ont été approuvés par Industrie Canada (IC 2758A - 120001 ) pour fonctionner avec les types d'antenne énumérés ci-dessous avec le gain maximal admissible et l'impédance d'antenne requise pour chaque type d'antenne indiqué . Types d'antennes ne figurant pas dans cette liste , ayant un gain supérieur au gain maximum indiqué pour ce type , sont strictement interdits pour une utilisation avec cet appareil .

1200-1 transport émetteur - antenne intégrée : gagner 0dBi

Seuls les accessoires d'usine sont approuvés pour une utilisation avec cet appareil - par exemple étuis de tiers, ceinture clips, etc ne sont pas approuvés pour l'utilisation.

Les coordonnées où l'utilisateur peut obtenir de l'information canadienne sur l'exposition aux radiofréquences et la conformité.

1. Santé Canada Code de sécurité 6:

[http://www.hc-sc.gc.ca/ewh-semt/pubs/radiation/radio\\_guide-lignes\\_direct-eng.php](http://www.hc-sc.gc.ca/ewh-semt/pubs/radiation/radio_guide-lignes_direct-eng.php)

2. RSS-102:

<http://www.ic.gc.ca/eic/site/smt-gst.nsf/eng/sf01904.html>

## RADIATION HAZARD WARNING

This equipment's radiation levels in combination with its output power, antenna gain, and maximum duty cycle are below the safe level limits for general population as specified by Industry Canada. Although the equipment's radiation levels are below the safe level limits, it is a good general practice to minimize any radiation exposure to only that which is necessary.

Les niveaux de rayonnement de cet équipement en combinaison avec sa puissance de sortie , gain d'antenne , et le cycle de service maximal sont inférieures aux limites de niveau de sécurité pour la population générale comme spécifié par Industrie Canada . Bien que les niveaux de radiation de l'équipement sont inférieures aux limites de niveau de sécurité , ce est une bonne pratique générale pour minimiser toute exposition aux rayonnements que ce qui est.

## **Introduction to the 1200 Whistle System**

The Model 1200 Whistle System is latest from the Talkie Tooter™ family of products. The 1200 includes all the features and functionality of historic Talkie Tooters, so you can blow fast whistles and communicate with voice. Gone is the two-tone signaling which has been replaced by a modern highly secure digital signal. The digital signal offers equivalent speed but with improved range and performance in the woods where it counts.

The previous 14.4V Nickel Metal Hydride has been completely replaced with an industrial grade 3.6V Li-Ion system. The Li-Ion battery delivers about twice the run time as the 14.4V and has a very low loss of charge when sitting on the shelf. It features excellent performance in cold weather.

An optional Remote Display can be purchased that provides information on which was the last bug to transmit and if it had a low battery.



## The 1200-2 Whistle Receiver

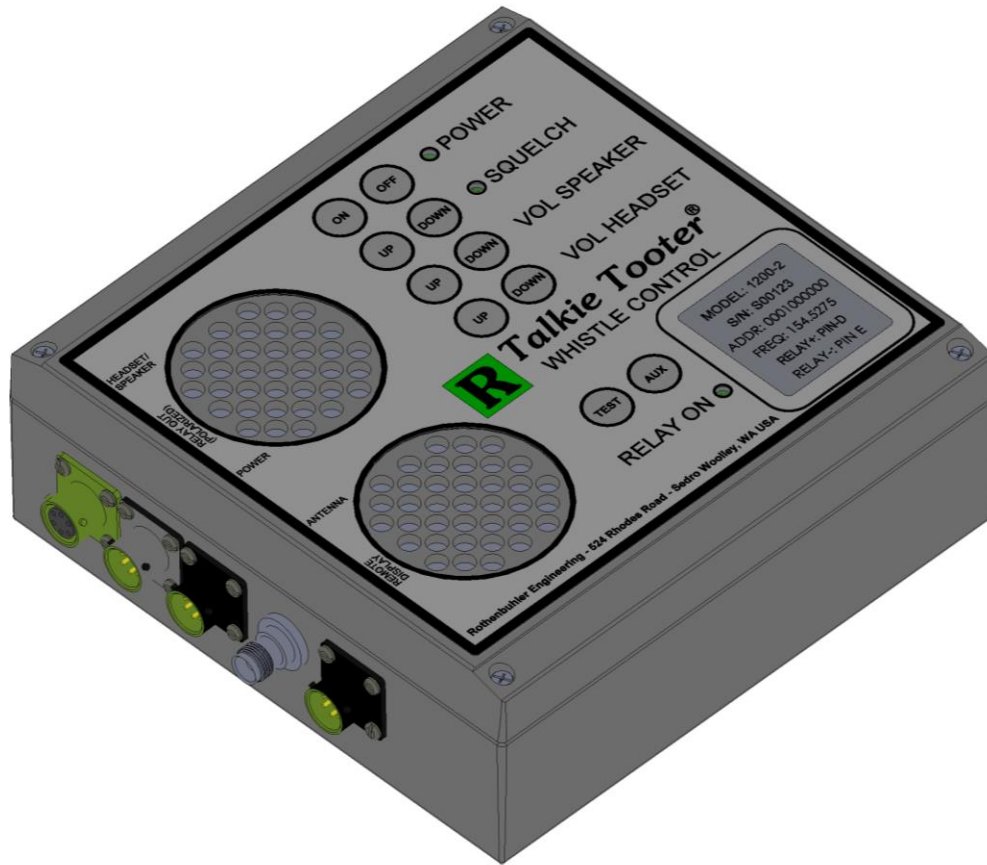

**Figure 1 1200-2 Whistle Receiver**

The 1200 Whistle Receiver is packaged the same waterproof aluminum case used in the Mark III Radio Whistle system. You can use the 1072-4 Mounting Plate Assembly used by previous systems to secure the receiver into the yarder. The 1200 Receiver connections are essentially the same as previous systems, allowing for easy hook-up. The output to the Relay Box however is polarized and some of the older receivers are not polarized. This means you may need to swap the wires at the Relay Box to obtain the correct polarity. The unit will not be damaged if the relay wires are not correctly polarized, but the unit will not blow whistles. The 1200 Receiver features a solid-state relay that is manufactured to provide many years of reliable operation. The receiver runs on both +12V and +24V battery systems.

Traditionally the Whistle Receiver provides a tone on the speaker whenever the whistle is active. This is now an option, and the default is that the tone will not be heard on the speaker, so that only the actual whistle can be heard.

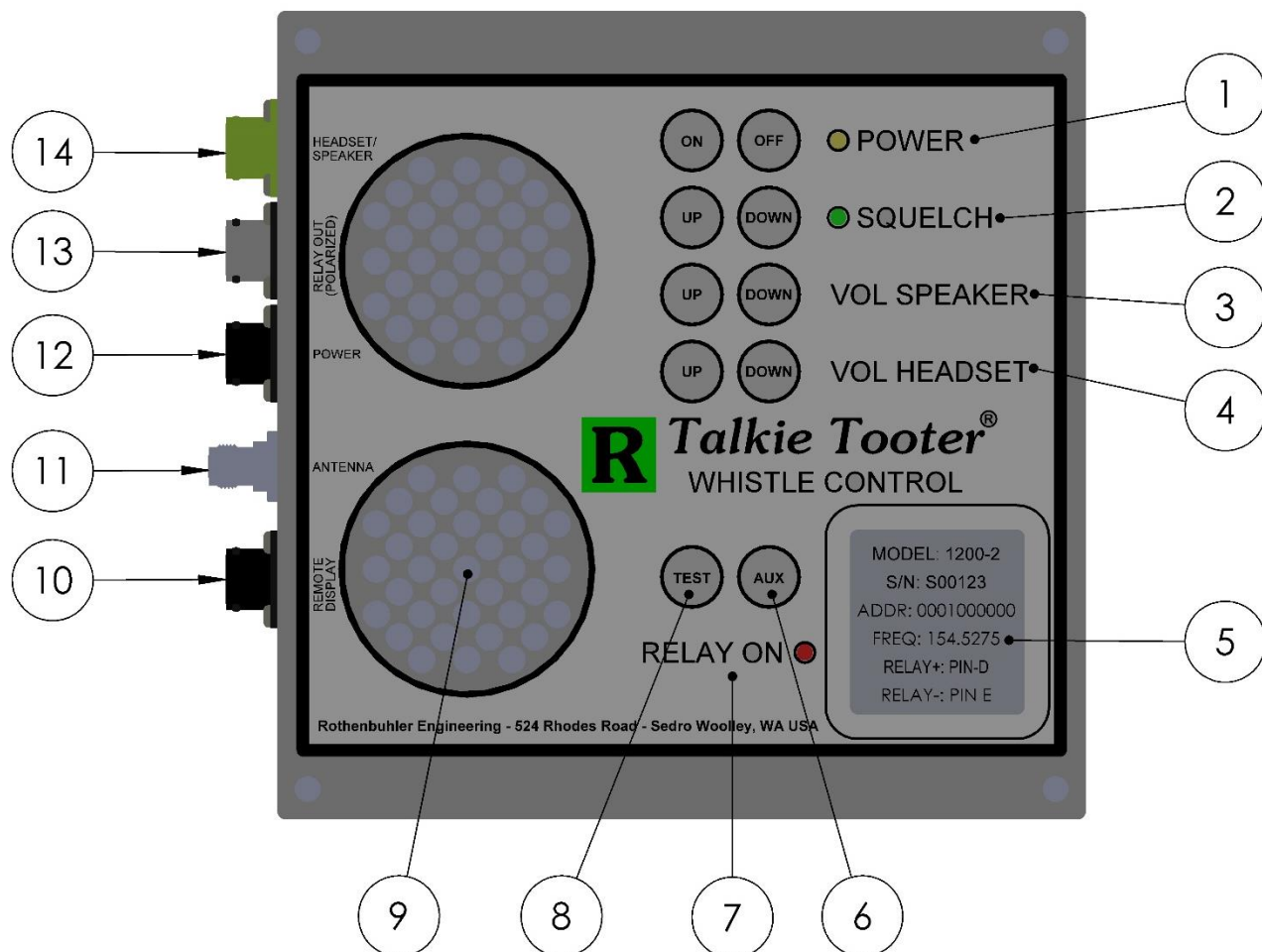

**Figure 2 Whistle Receiver Panel**

Item	Description
1	Power ON/OFF Switches. Yellow POWER light indicates unit is on. Flashes to indicate low battery.
2	Squelch Level Adjust. Green SQUELCH lights green with the signal is active (unmuted).
3	Volume level control of the speaker.
4	Volume level control of a connected headset.
5	Receiver information label.
6	Aux Switch – reserved for future use.
7	Relay On light – red to indicate the whistle output is active.
8	Test Switch – activates the whistle relay for the duration held.
9	Whistle Speaker (x2)
10	Remote Display connection – for optional Remote Display

11	Antenna – TNC connector for VHF antenna (150-174 MHz)
12	Power – Connects +12VDC or +24VDC from yarder battery
13	Relay out- polarized connection or driving Relay Box
14	Headset/Speaker -for driving optional headset audio.

**Table 1 Whistle Receiver Panel**

Also included is a connector for an optional Remote Display Panel (discussed later). The Remote display provides an indication of which bug last signaled and will indicate if it has a low battery. It also has a bright red light that is active whenever a whistle is being blown.

## 1200-1 Whistle Transmitter

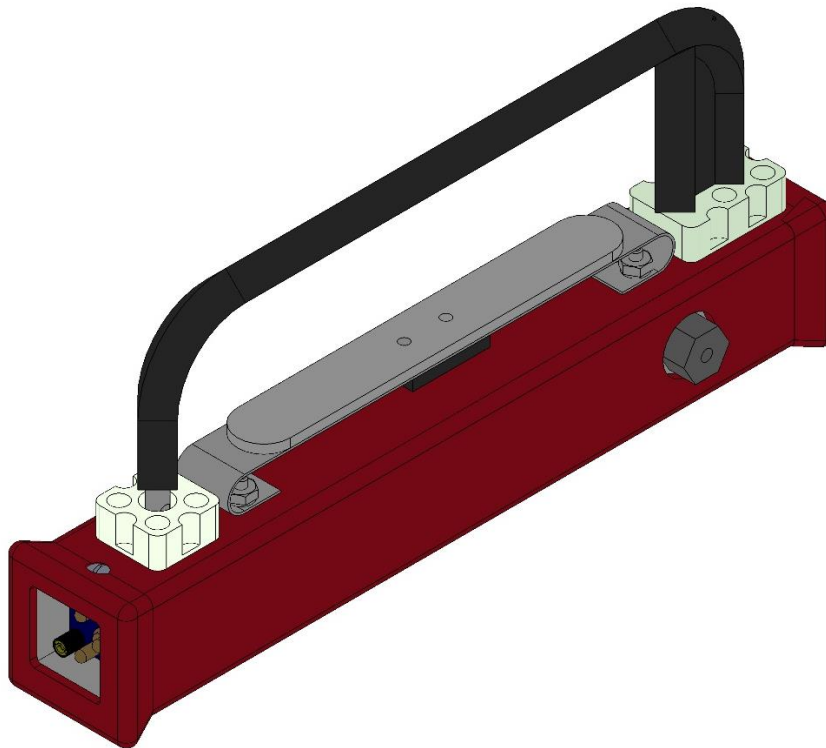

**Figure 3 1200-1 Whistle Transmitter**

Figure 1 Shows the 1200-1 Whistle Transmitter. The transmitter or bug is housed in the familiar 1060 barrel. The ruggedized package features a rubberized boot

that protects the internal electronics against shock and vibration and weather sealing. The transmitter is belt mounted around the user's waist.

There are two modes in which the transmitter operates. The angle of the barrel when the actuator is engaged determines the mode of operation. When the Charge Port end is elevated, the standard whistle mode is engaged. The air whistle will be turned on whenever the actuator is engaged. If the Charge Port is held down below horizontal when the actuator is engaged, the microphone mode is turned on voice audio will be transmitted to the receiver. Once microphone mode is entered, you may raise the microphone end for better sound quality. The microphone circuit has automatic level control and will attempt to adjust the sound level to achieve the best quality. The microphone does not need to be near the face for good quality.

Whenever the transmitter's actuator is not engaged, the unit remains off to save battery power. The 1200-1 Whistle Transmitter will provide many hours of use on a single charge. Actual run-time depends on several factors such as local temperature, how frequently and how long the actuator is engaged, and the health of the battery. The batteries contained within the transmitters are rated for 500 cycles before replacement is required.

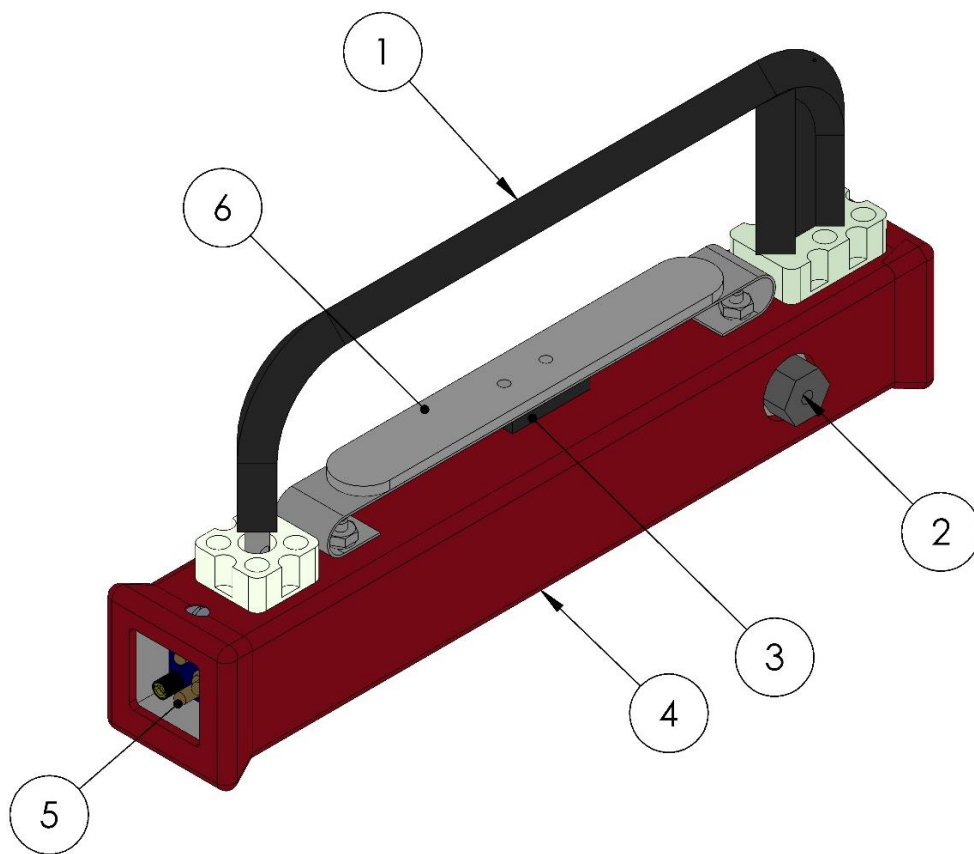

**Figure 4 Whistle Transmitter Anatomy**

Item	Description
1	Antenna
2	Belt Mount
3	Actuator Switch Magnet
4	Protective Neoprene Boot
5	Charging Port
6	Actuator Switch Assembly

**Table 2 Whistle Transmitter Anatomy**

## Li-Ion Battery Charger

The 1200-8 Li-Ion Battery Charger is included with each system. This charger is required to charge the batteries contained within the 1200-1 Whistle Transmitters. Each charger will charge up to 3 bugs simultaneously. The charging rates automatically reduces and then stops as each battery reach full

charge. The charger uses smart technology and temperature detection to ensure maximum battery life.

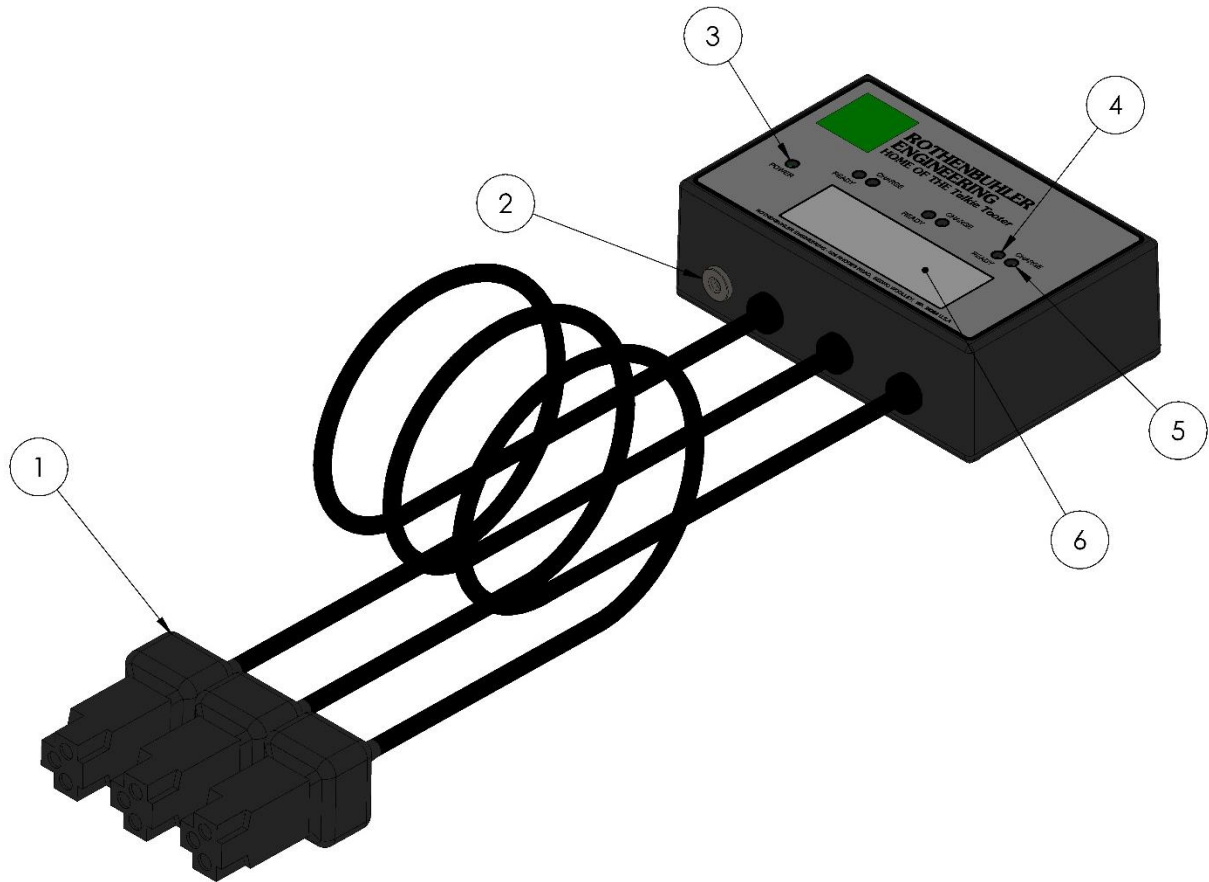

**Figure 5 1200-8 Li-Ion Charger**

Item	Description
1	Charge Connector Plug (x3)
2	+12VDC Power Supply Jack
3	Red POWER light
4	Green READY light – indicates charge is done (x3)
5	Red CHARGE light – indicates connected unit is charging (x3)
6	Label – Model, Serial Number, Regulatory Info

**Table 3 Li-Ion Charger**

Charging Procedure: Plug the charger into each bug to be charged. Plug the supplied +12VDC power adapter into an AC outlet. Plug the +12VDC cord into the jack located on the charger. When the red CHARGE light goes on steady, the unit is being charged. When the red CHARGE light blinks, the charger has determined that the connected unit is near full. When the green READY light turns on, the unit is fully charged and ready for use. Flashing yellow READY light indicates an error. Battery may be too hot for charging.

## 1200-4 Remote Display Panel

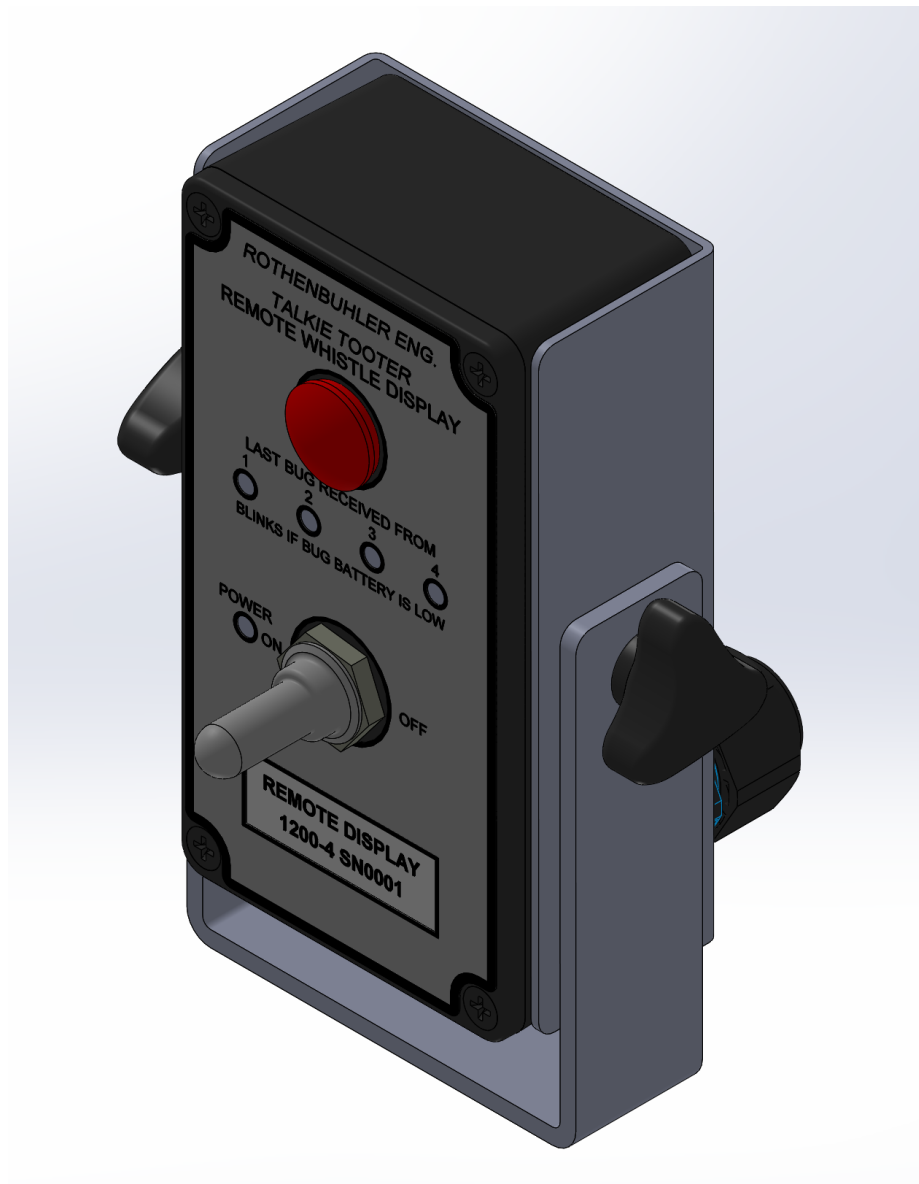

**Figure 6 1200-4 Remote Display Panel**

The Remote Display Panel shown in Figure 6 is an optional accessory that can be used with 1200 Systems. The Remote Display connects to the Remote Display of the Receiver with a cable. The Remote Display provides information regarding the last bug to transmit and whether its battery is low. This can help to troubleshoot problems. The Remote Display is powered by the Receiver and comes with a standard 8' cable.