

SPONGE STUNT REMOTE CONTROL VEHICLE MANUAL

EXPLANATION OF REMOTE CONTROL VEHICLES AND COMPONENTS



Cool light

Forward
Backward

Left/Right
Rotation



Short press: Auto demo function
Long press: Power switch

REMOTE CONTROL VEHICLE AND REMOTE CONTROL BATTERY INSTALLATION

Vehicle battery installation



1. Loosen the screw and open the bottom battery cover.
2. Connect the body plug and battery plug.

Control battery installation



1. Loosen the screw and open the bottom battery cover.
2. Finally, install two 1.5 "AA" batteries

REMOTE CONTROL VEHICLE BATTERY CHARGING

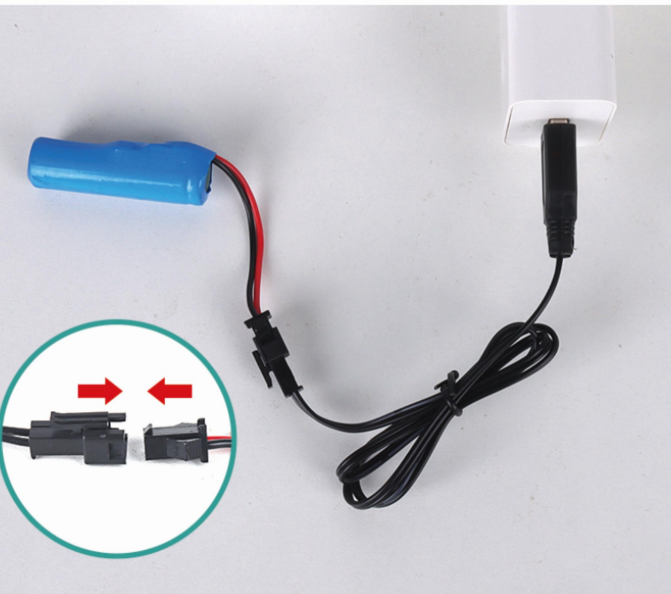

Note: Configure the USB charging cable to connect the household charging head/charging treasure/computer USB socket, etc. The red indicator light is often on when the USB is connected to the battery. When it is full (about 120 minutes), the red indicator is extinguished.

FUNCTIONAL DEMONSTRATION EXPLANATION

Turn on the power supply: turn on the remote control vehicle switch, the front light will always flash, and long press the remote control switch to turn on the frequency. The remote control car stops quickly after the front lights are completed. When the frequency is completed, the red indicator light of the remote control becomes a constant bright state. You can push the corresponding function joystick on the panel to control the remote control car action. Remote control distance: the remote control distance is about 60 meters. Use time: In full power, it can reach about 20-25 minutes.

BATTERY USAGE PRECAUTIONS

1. The car uses one 3.7V rechargeable battery pack; 2. The remote control uses two 1.5V AA non-rechargeable batteries; 3. Insert and remove the battery using the correct method and polarity; 4. Different types of batteries or old and new batteries cannot be mixed; 5. Do not short-circuit, disassemble, or put the battery into fire; 6. If not in use for a long time, please remove the battery. 7. Non-rechargeable batteries cannot be charged. 8. Rechargeable batteries can only be charged under adult supervision; 9. Rechargeable batteries should be removed from toys before charging; 10. The exhausted battery should be removed from the toy; 11. The power terminal must not be short-circuited; 12. Cannot connect to more than the recommended number of power sources; 13. USB charging wires, plugs, casings, and other components must be regularly checked for damage. If any damage is found, it should be stopped from use until it is repaired properly.

FORWARD



BACKWARD



LEFT ROTATION



RIGHT ROTATION

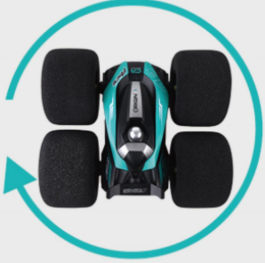

STUNT DRIVING



Using sponge tires to friction is high, it can easily cross the rugged terrain

DOUBLE SIDED DRIVING



The back can also drive normally

360 ° ROTATION



Long press the left or right rotation direction keys to achieve 360 ° rotation

ONE CLICK AUTOMATIC DEMONSTRATION



When the demonstration, you can unlock as long as you do it before or after arbitrarily or the left and right rotation rotation rods



WARNING

When the remote control cannot control the remote control car, first turn off the power supply of the remote control, then turn off the power supply of the remote control, then turn on the power supply, and then pull the remote control to control the rod to the frequency of the frequency.

Remote control unable to align frequency solution: Remove and reinstall the lithium battery of the remote control car, and then power it on for matching.

MATTERS NEEDING ATTENTION

1. Disclosure of small parts should be put well. Do not let children swallow.
2. If there are radio wave interference in the operating site, please select another venue.
3. When the remote control power supply is low, please stop the operation immediately.
4. For the dismantling packaging, please do not discard anywhere to avoid pollution of environmental hygiene.
5. Please store your remote control model in a dry, cool place.
6. Don't store it in the high temperature and humid places near the fire.
7. When the battery is wet by water, wipe the water fully. If there is deformation, stop using it.

PRECAUTIONS FOR SPONGE TIRES



REMINDER:

Automatic demonstration and remote control switch use the same button
Short press: Auto demo function
Long press: Power switch



FCC Warning

This device complies with part 15 of the FCC Rules. Operation is subject to the following two conditions: (1) This device may not cause harmful interference, and (2) this device must accept any interference received, including interference that may cause undesired operation.

Any Changes or modifications not expressly approved by the party responsible for compliance could void the user's authority to operate the equipment.

Note: This equipment has been tested and found to comply with the limits for a Class B digital device, pursuant to part 15 of the FCC Rules. These limits are designed to provide reasonable protection against harmful interference in a residential installation. This equipment generates uses and can radiate radio frequency energy and, if not installed and used in accordance with the instructions, may cause harmful interference to radio communications. However, there is no guarantee that interference will not occur in a particular installation. If this equipment does cause harmful interference to radio or television reception, which can be determined by turning the equipment off and on, the user is encouraged to try to correct the interference by one or more of the following measures:

- Reorient or relocate the receiving antenna.
- Increase the separation between the equipment and receiver.
- Connect the equipment into an outlet on a circuit different from that to which the receiver is connected.
- Consult the dealer or an experienced radio/TV technician for help.

The device has been evaluated to meet general RF exposure requirement. The device can be used in portable exposure condition without restriction.