

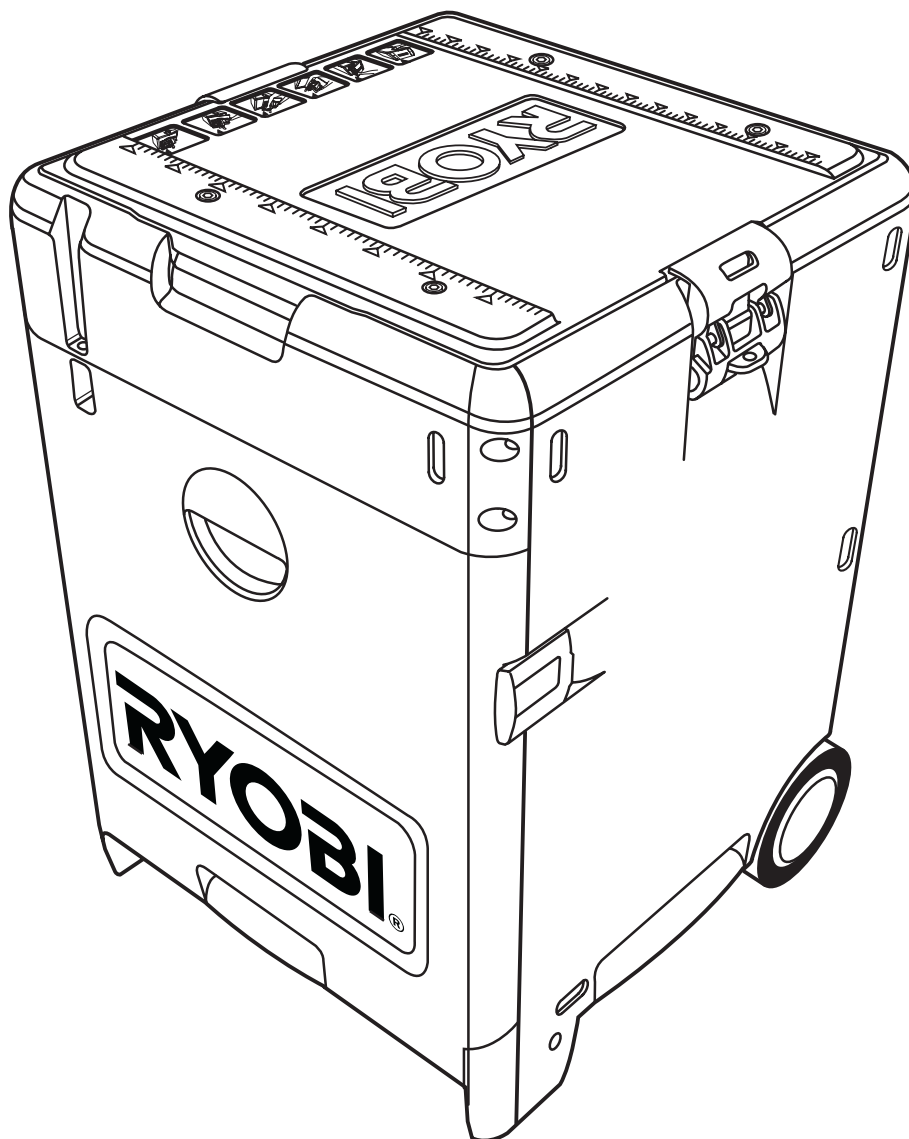

OPERATOR'S MANUAL

18.0 V Cordless “Six Pack”

SPC18



Your new “Six Pack” has been engineered and manufactured to Ryobi's high standard for dependability, ease of operation, and operator safety. Properly cared for, it will give you years of rugged, trouble-free performance.



WARNING: To reduce the risk of injury, the user must read and understand the operator's manual.

Thank you for buying the Ryobi 18.0 V Cordless “Six Pack.”

SAVE THIS MANUAL FOR FUTURE REFERENCE

TABLE OF CONTENTS

■ Introduction	2
■ Rules For Safe Operation	3
■ Symbols	4
■ Specifications	4
■ Unpacking	4
■ Features	5-6
■ Operation	7-10
■ Maintenance	11
■ Parts, Ordering, and Service	12

INTRODUCTION

Your “*Six Pack*” has many features for making the use of this case more pleasant and enjoyable. Safety, performance, and dependability have been given top priority in the design of this product making it easy to maintain and operate.



WARNING:

Do not attempt to use the “*Six Pack*” tools or the case until you have read thoroughly and understand completely the operator’s manuals. Pay close attention to the safety rules, including Dangers, Warnings, and Cautions. If you use your “*Six Pack*” properly and only for what it is intended, you will enjoy years of safe, reliable service.



The operation of any power tool can result in foreign objects being thrown into your eyes, which can result in severe eye damage. Before beginning tool operation, always wear safety goggles or safety glasses with side shields and a full face shield when needed. We recommend Wide Vision Safety Mask for use over eyeglasses or standard safety glasses with side shields. Always wear eye protection which is marked to comply with ANSI Z87.1.



Look for this symbol to point out important safety precautions. It means attention!!! Your safety is involved.

RULES FOR SAFE OPERATION

READ ALL INSTRUCTIONS

- **Know your product.** Read the operator's manual carefully. Learn the product's applications and limitations as well as the specific potential hazards related to this product.
- **Read thoroughly these instructions and the instructions for each tool before using this "Six Pack."**
- **Use safety equipment.** Always wear eye protection. Dust mask, non-skid safety shoes, hard hat, or hearing protection must be used for appropriate conditions.
- **Stay alert and exercise control.** Watch what you are doing and use common sense. **Do not operate tool when you are tired. Do not rush.**
- **Use the right tool.** Do not force the tool or attachment to do a job for which it was not designed. Do not use it for a purpose not intended.
- **Do not overreach.** Keep proper footing and balance at all times.
- **Never stand or sit on the case.** Serious injury could result if the case is tipped, jarred, or rolled.
- **Never stand in the drawers or use the drawers of the Six Pack case as a ladder.**
- **Dress properly.** Do not wear loose clothing, gloves, neckties, rings, bracelets, or other jewelry. They can get caught and draw you into moving parts. Rubber gloves and nonslip footwear are recommended when working outdoors. Also wear protective hair covering to contain long hair.
- **Do not lift the case without help.** The "Six Pack" weighs 70 lbs. Hold it close to your body, keep your knees bent, and lift with your legs. Ignoring these precautions could result in back injury.
- **Keep children and visitors away.** All visitors should wear safety glasses and be kept a safe distance from the work area. Do not let visitors contact tool while operating.
- **Make product child-proof** with padlocks.
- **Keep your work area clean and well lit.** Cluttered benches and dark areas invite accidents.
- **Always place each tool, accessory, and battery in their specific location** in the case to assure proper balance and prevent shifting.
- **Remove battery pack from all tools and place the switch in the locked or off position before storing the tool.** Such preventive safety measures reduce risk of starting the tool accidentally.
- **Always store batteries in the case,** stem side down when not being charged or in use.
- **Always make sure the contents are secure and that all latches are securely latched before moving the "Six Pack."** If transporting, padlock the latches for additional security.
- **Do not place any object on the top surface when the miter saw is in use.** Clutter invites accidents and can interfere with the safe operation of the saw.
- **Maintain tools with care.** Keep tools sharp and clean for better and safer performance. Follow instructions for lubricating and changing accessories.
- **When servicing use only identical Ryobi replacement parts.** Use of any other parts may create a hazard or cause product damage.
- **Use recommended accessories.** The use of improper accessories may cause risk of injury. Refer to this operator's manual for recommended accessories.
- **Save these instructions. Refer to them frequently and use them to instruct others who may use this tool. If you loan someone this tool, loan them these instructions also.** Following this rule will reduce the risk of electric shock, fire, or serious personal injury.

SYMBOLS

The purpose of safety symbols is to attract your attention to possible dangers. The safety symbols, and the explanations with them, deserve your careful attention and understanding. The safety warnings do not by themselves eliminate any danger. The instructions or warnings they give are not substitutes for proper accident prevention measures.

SYMBOL EXPLANATION



SAFETY ALERT SYMBOL: Indicates Danger, Warning, or Caution. May be used in conjunction with other symbols or pictographs.



DANGER: Failure to obey a safety warning will result in serious injury to yourself or to others. Always follow the safety precautions to reduce the risk of fire, electric shock and personal injury.



WARNING: Failure to obey a safety warning can result in serious injury to yourself or to others. Always follow the safety precautions to reduce the risk of fire, electric shock and personal injury.



CAUTION: Failure to obey a safety warning may result in property damage or personal injury to yourself or to others. Always follow the safety precautions to reduce the risk of fire, electric shock and personal injury.

NOTE: Advises you of information or instructions vital to the operation or maintenance of the equipment.

SAVE THESE INSTRUCTIONS

SPECIFICATIONS

Height	28-1/2 in. (72.4 cm)	Maximum Height with handle	41 in. (104.1 cm)
Width	21-3/8 in. (54.3 cm)	Wheel Diameter	6 in. (15.2 cm)
Depth	21-3/8 in. (54.3 cm)	Weight with tools	70 lbs. (32 kg)

UNPACKING

Your "Six Pack" has been shipped completely assembled.

- Carefully remove the tools and accessories from the case. Make sure that all items listed in the packing list are included.
- Inspect the tools, accessories, and case carefully to make sure no breakage or damage has occurred during shipping.
- Do not discard the packing material until you have carefully inspected and satisfactorily operated the tools.
- If any parts are damaged or missing, please call 1-800-525-2579 for assistance.



WARNING:

If any parts are missing, do not operate these products until the missing parts are replaced. Failure to do so could result in possible serious personal injury.

PACKING LIST

"Six Pack" (Case) (SPC18)
 Miter Saw with accessories (MS181)
 Circular Saw with accessories (R10632)
 Drill with accessories (HP1802M)
 Speed Saw™ with accessories (SS180)
 Reciprocating Saw with accessories (RJC181)
 Flashlight (FL1800)
 Battery Packs (3) (Part No. 1322401)
 Battery Charger (Part No. 1423701)
 Miter Saw Extension Rails (Part No. 6953801) with
 Screws (Part No. 5686602)
 Speed Saw circle cutting kit (Part No. 1263301)
 Operator's Manuals (7)

FEATURES

LID STORAGE

The lid provides a work surface and secure storage for the miter saw.

UPPER DRAWER STORAGE

The upper drawer provides storage for three battery packs, the battery charger, and the miter saw work clamp.

LOWER DRAWER STORAGE

The lower drawer provides storage for the circular saw, drill, Speed Saw, reciprocating saw, and flashlight.

FRONT PANEL STORAGE

The front panel provides storage for wood boring bits, screwdriver bits, and drill bits (Bits not included).

SIDE AND BOTTOM STORAGE

Each side of the case provides storage for the miter saw extension rails and the bottom of the case provides storage for the miter saw and circular saw blades.

MISCELLANEOUS STORAGE

Miscellaneous storage is available in the upper drawer and in the front panel.

MOBILITY

The telescopic handle and sturdy wheels make the six pack easy to move.

SECURITY

The lid and the front panel feature lockable latches that allow you to attach padlocks to prevent unauthorized use.

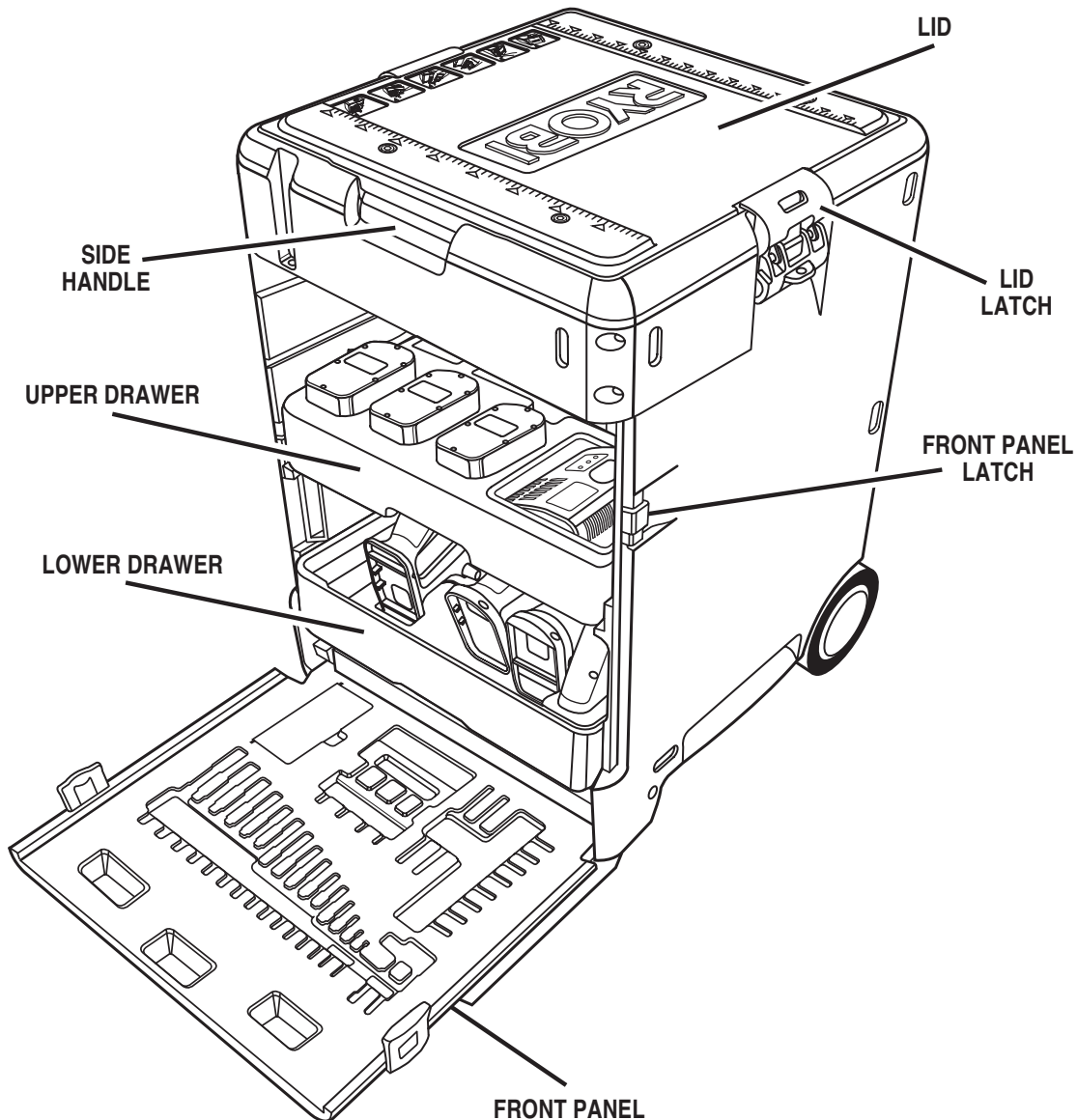

Fig. 1

FEATURES

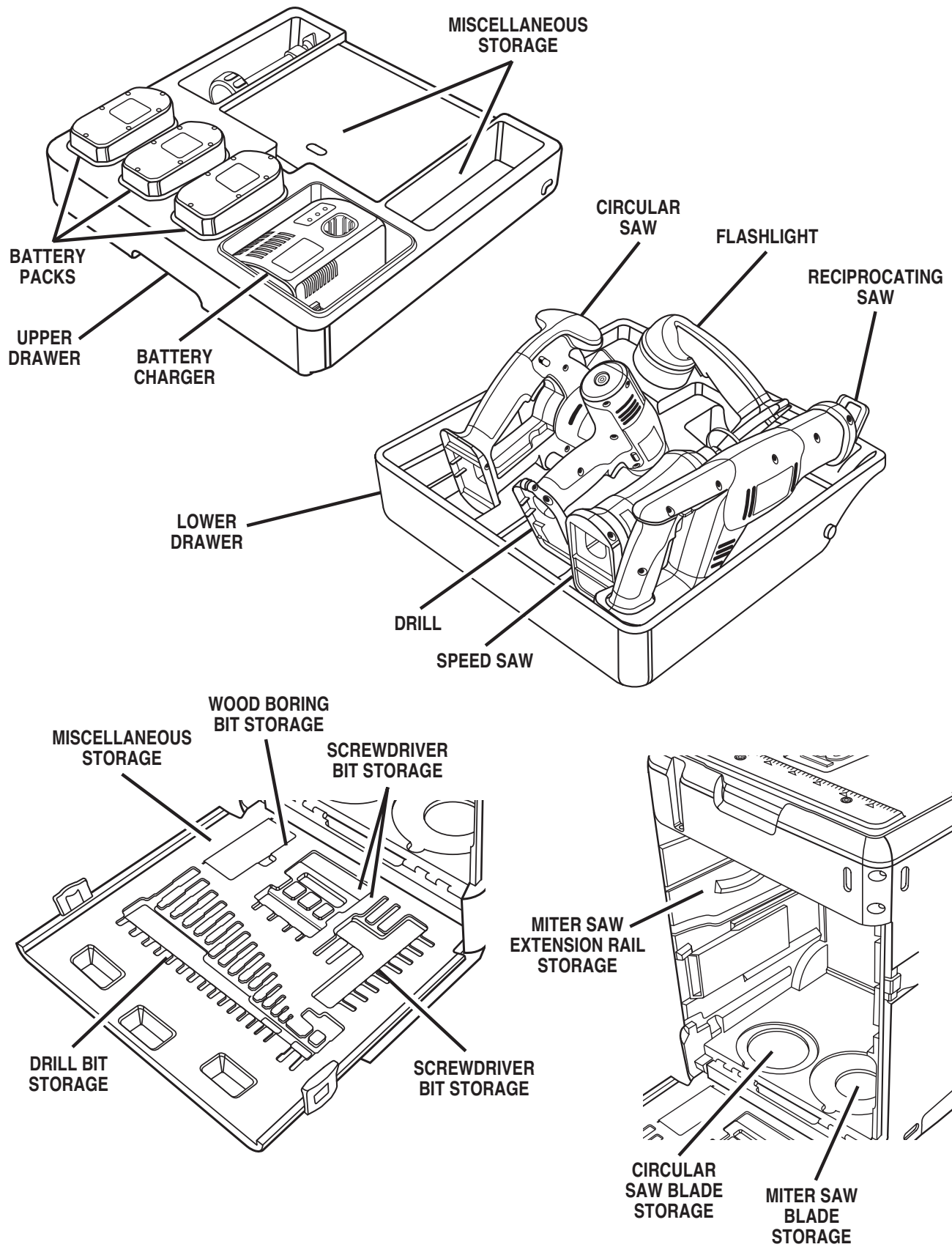

Fig. 2

OPERATION

SETTING UP THE MITER SAW

The MS181 Miter Saw provided in the “Six Pack” has been securely attached to the top lid. This convenient mounting allows a quick and simple set up and stow away procedure. These procedures are illustrated on the top, front surface of the lid for easy reference.

See Figure 3.

Follow these directions to set up the miter saw.

- Loosen each lid latch by pulling out on the bottom of the latch, lifting the latch, and then lowering the top of the latch. (1)
- Stand in front of the case. (The case handle will be on the left.)
- Reach across the lid with your left hand, grasp the right side handle, and raise the lid. (2)
- Grasp the miter saw carrying handle with your right hand. (3)
- Rotate and lower the lid and saw assembly smoothly into position, allowing the lid to sit squarely on the base. (4 and 5)
- Secure the lid latches. (6)

The MS181 Miter Saw is now ready for use on the “Six Pack” work surface. Refer to the MS181 Operator’s Manual for safety rules and operation instruction. Release the lock pin to raise the saw head. Make all necessary set up and adjustments. When ready for the cut, insert a battery and proceed safely.

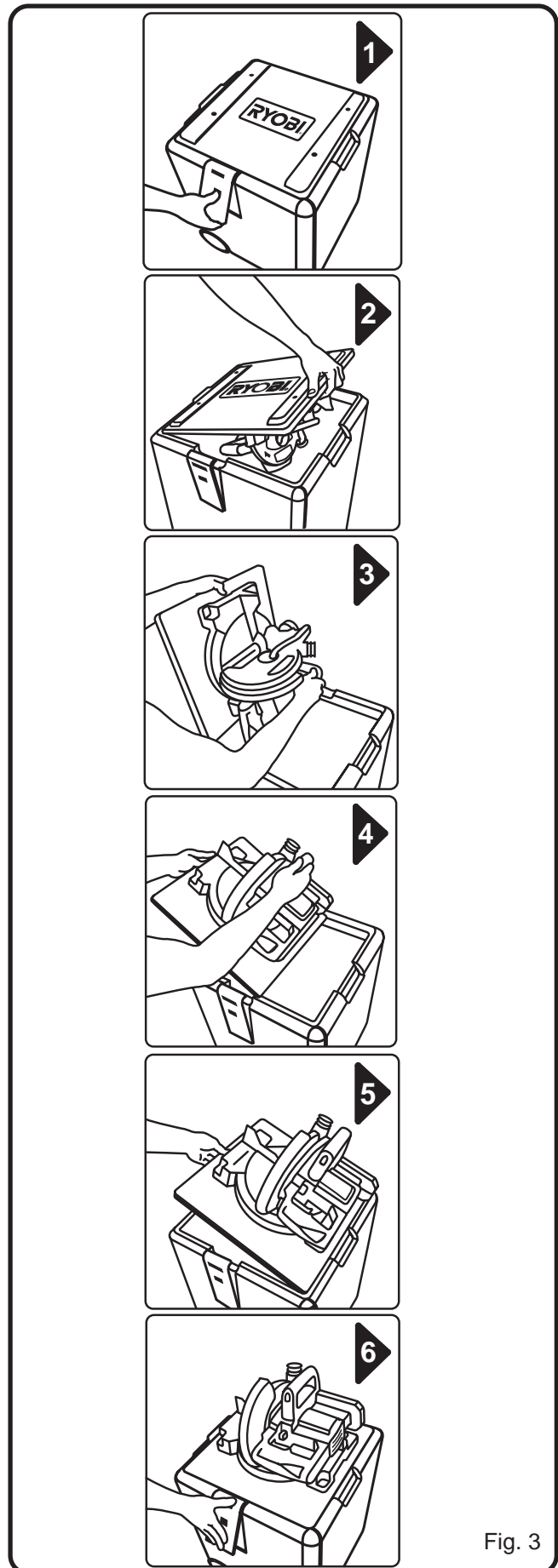

Fig. 3

OPERATION

STORING THE MITER SAW

See Figure 4.

Follow these directions to store the miter saw.

- Remove the battery from the saw.
- Remove the work clamp and any accessories that you have used.
- Place the saw head in a 90° bevel position and secure the bevel lock.
- Place the saw in a 90° position to the fence.
- Lower the saw head and lock it into place.
- Loosen each lid latch by pulling out on the bottom of the latch and then lowering the top of the latch. (1)
- Stand in front of the case. (The case handle will be on the left.)
- Grasp the left side handle with your left hand and raise the lid. (2)
- Grasp the miter saw carrying handle with your right hand. (3)
- Rotate and lower the lid and saw assembly smoothly into position, allowing the lid to sit squarely on the base. (4 and 5)
- Secure the lid latches. (6)

The MS181 Miter Saw is now safely stored. For additional security and to prevent unauthorized use, areas for padlocks have been provided.

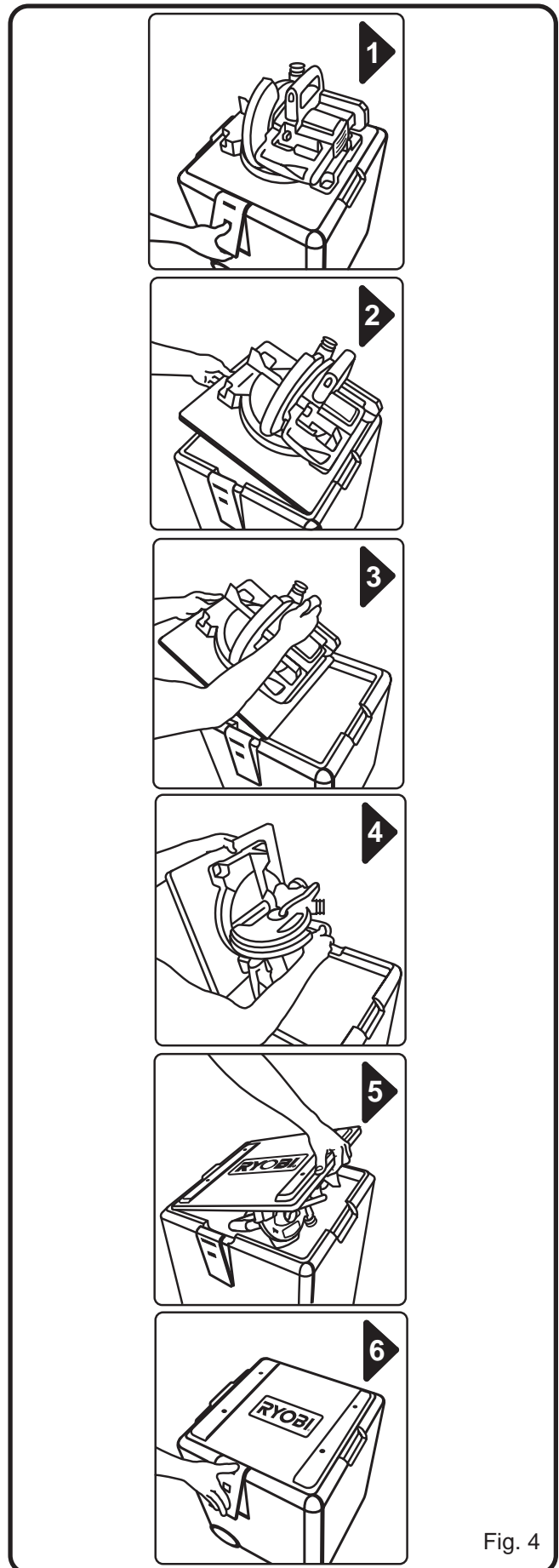

Fig. 4

OPERATION

ATTACHING THE MITER SAW EXTENSION RAILS

See Figure 5.

Follow these directions to attach the miter saw extension rails.

- Remove the extension rails from the side storage area.
- Slide the extension rails into the correct locations on the miter saw.
- Secure the extension rails using the wing screws provided.

OPENING THE FRONT PANEL

See Figure 6.

Follow these directions to open the front panel.

- Pull the front panel latches out.
- Lower the front panel.

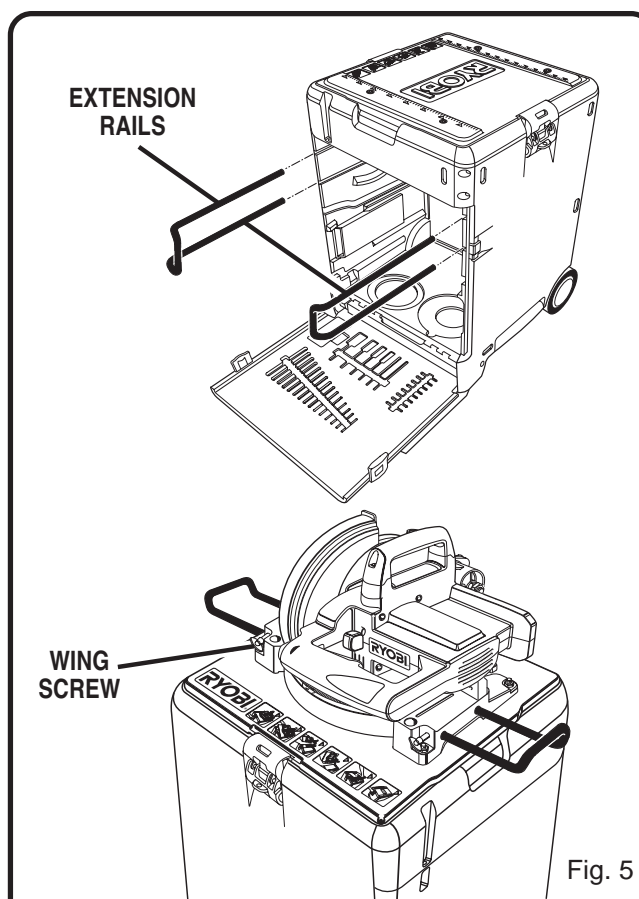

Fig. 5

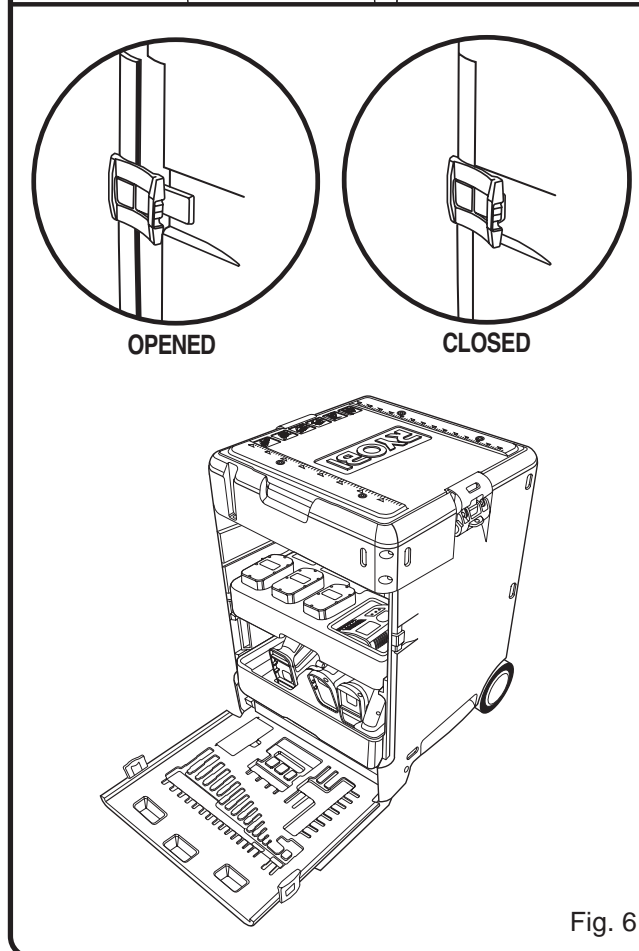

Fig. 6

OPERATION

LIFTING/LOWERING HANDLE

See Figure 7.

Follow these directions to lift and lower the handle.

- **To lift handle:** Push the button located on the top of the handle, pull up the handle, and snap into place.
- **To lower handle:** Push the button located on the top of the handle, lower the handle, and snap into place.



WARNING:

Always make sure the handle is all the way up and firmly in the locked position before you move the “Six Pack.” Failure to heed this warning can result in loss of control and serious personal injury.

SECURING THE “SIX PACK”

See Figure 8.

To prevent unauthorized use of the “Six Pack,” we suggest that you install padlocks in the areas provided. Follow these directions to secure the “Six Pack.”

- Stow safely all the tools and accessories in the “Six Pack” case.
- Secure the latches.
- Install padlocks in the areas provided.
- Store the padlock keys in another location.



WARNING:

Never attempt to move or shift the “Six Pack” until the case is securely packed and the latches firmly secured. We recommend padlocks when transporting the “Six Pack.” Failure to heed these warnings can result in serious personal injury.

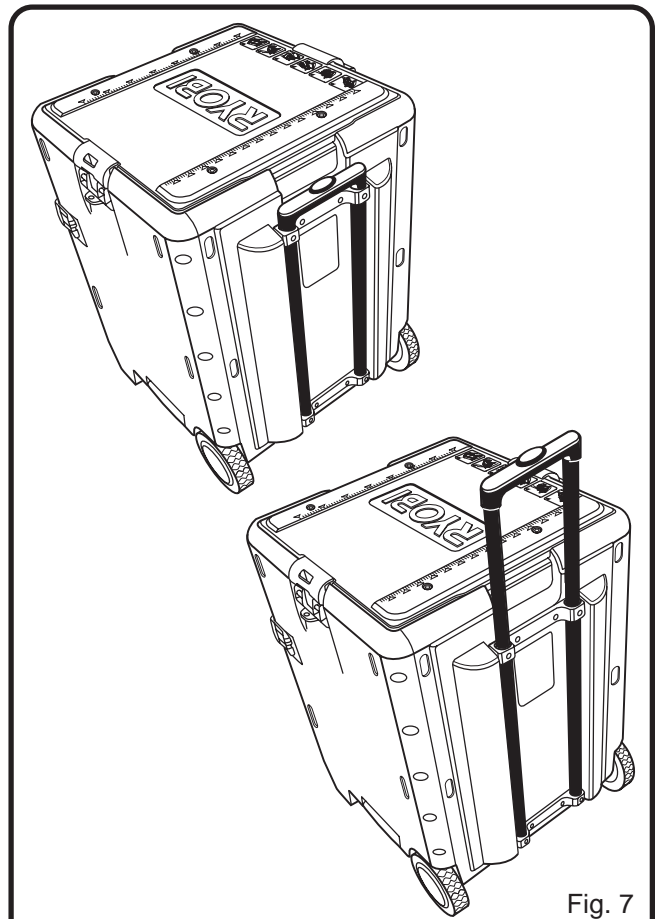

Fig. 7

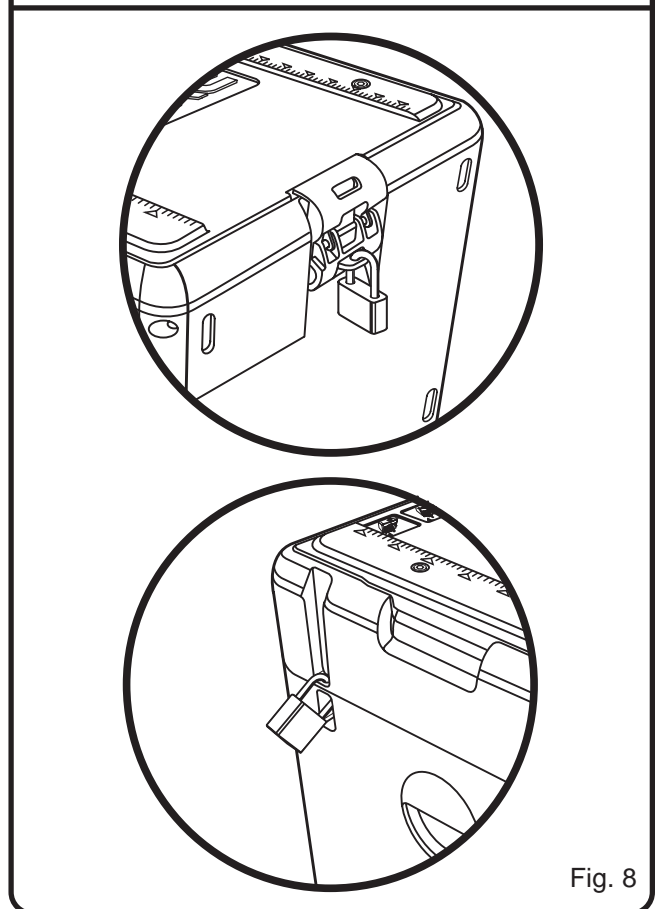

Fig. 8

MAINTENANCE



WARNING:

When servicing use only identical Ryobi replacement parts. Use of any other parts may create a hazard or cause product damage.

GENERAL

Avoid using solvents when cleaning plastic parts. Most plastics are susceptible to damage from various types of commercial solvents and may be damaged by their use. Use clean cloths to remove dirt, carbon dust, etc.



WARNING:

Do not at any time let brake fluids, gasoline, petroleum-based products, penetrating oils, etc. come in contact with plastic parts. They contain chemicals that can damage, weaken, or destroy plastic.

REPLACEMENT PARTS

Top Lid (Part No. 5834101)

Front Panel Latches (Part No. 3076701)

Lid Latches (Part No. 5100102)

Handle (Part No. 6953301)

Upper Drawer (Part No. 3077001)

Lower Drawer (Part No. 5834901)

Wheel Assembly (Part No. 3071601)



OPERATOR'S MANUAL

18.0 V Cordless “Six Pack”

SPC18

- **SERVICE**

Now that you have purchased your tool, should a need ever exist for repair parts or service, simply contact your nearest Ryobi Authorized Service Center. Be sure to provide all pertinent facts when you call or visit. Please call 1-800-525-2579 for your nearest Ryobi Authorized Service Center. You can also check our Web site at www.ryobitools.com for a complete list of Authorized Service Centers.

- **PART NO.**

The part number of this product is found on a plate attached to the rear of the case.

- **HOW TO ORDER REPAIR PARTS**

When ordering repair parts, always give the following information:

PART NUMBER SPC18

RYOBI TECHNOLOGIES INC.

1428 Pearman Dairy Road Anderson, SC 29625
Post Office Box 1207 Anderson, SC 29622
www.ryobitools.com
Phone 1-800-525-2579