

# OPERATING INSTRUCTIONS

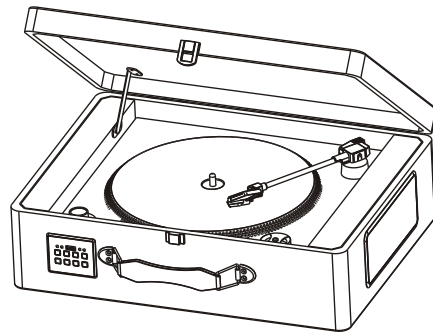

## LEATHERETTE BRIEFCASE TURNTABLE

MODEL : TT-9311-BTM3EJ



### WARNING:

- TO PREVENT FIRE OR SHOCK HAZARD, DO NOT EXPOSE THIS APPLIANCE TO RAIN OR MOISTURE.
- TO REDUCE THE RISK OF ELECTRIC SHOCK, DO NOT REMOVE COVER.

### IMPORTANT SAFETY INSTRUCTIONS

1. READ INSTRUCTIONS-ALL THE SAFETY AND OPERATING INSTRUCTIONS SHOULD BE READ BEFORE THE APPLIANCE IS OPERATED.
2. RETAIN INSTRUCTIONS-THE SAFETY AND OPERATING INSTRUCTIONS SHOULD BE RETAINED FOR FUTURE REFERENCE.
3. HEED WARNINGS-ALL WARNINGS ON THE APPLIANCE AND IN THE OPERATING INSTRUCTIONS SHOULD BE ADHERED TO.
4. FOLLOW INSTRUCTIONS-ALL OPERATION AND USE INSTRUCTIONS SHOULD BE FOLLOWED.
5. WATER AND MOISTURE - THE APPLIANCE SHOULD NOT BE USED NEAR WATER; FOR EXAMPLE NEAR A BATHTUB, WASHBOWL, KITCHEN SINK, LAUNDRY TUB, IN A WET BASEMENT OR NEAR A SWIMMING POOL AND THE LIKE.
6. CARTS AND STANDS - THE APPLIANCE SHOULD BE USED ONLY WITH A CART OR STAND THAT IS RECOMMENDED BY THE MANUFACTURER. AN APPLIANCE AND CART COMBINATION SHOULD BE MOVED WITH CARE. QUICK STOPS, EXCESSIVE FORCE AND UNEVEN SURFACES MAY CAUSE THE APPLIANCE AND CART COMBINATION TO OVERTURN.
7. WALL AND CEILING MOUNTING - THE APPLIANCE SHOULD BE MOUNTED TO A WALL OR CEILING ONLY AS RECOMMENDED BY THE MANUFACTURER.
8. VENTILATION - THE APPLIANCE SHOULD BE SITUATED SO THAT IS LOCATION OR POSITION DOES NOT INTERFERE WITH ITS PROPER VENTILATION. FOR EXAMPLE, THE APPLIANCE SHOULD NOT BE SITUATED ON A BED, SOFA, RUG OR SIMILAR SURFACE THAT MAY BLOCK THE VENTILATION OPENINGS; OR PLACED IN A BUILT-IN INSTALLATION SUCH AS A BOOKCASE OR CABINET THAT MAY IMPEDE THE FLOW OF AIR THROUGH THE VENTILATION OPENINGS.
9. HEAT - THE APPLIANCE SHOULD BE SITUATED AWAY FROM HEAT SOURCES SUCH AS RADIATORS, HEAT REGISTERS, STOVES OR OTHER APPLIANCES (INCLUDING AMPLIFIERS) THAT PRODUCE HEAT.
10. POWER SOURCES - THE APPLIANCE SHOULD BE CONNECTED TO A POWER SUPPLY ONLY OF THE TYPE DESCRIBED IN THE OPERATING INSTRUCTIONS OR AS MARKED ON THE APPLIANCE.
11. GROUNDING OR POLARIZATION - PRECAUTIONS SHOULD BE TAKEN SO THAT THE GROUNDING OR POLARIZATION MEANS OF AN APPLIANCE IS NOT DEFEATED.
12. POWER - CORD PROTECTION - POWER SUPPLY CORDS SHOULD BE ROUTED SO THAT THEY ARE NOT LIKELY TO BE WALKED ON OR PINCHED BY ITEMS PLACED UPON OR AGAINST THEM, PAYING PARTICULAR ATTENTION TO CORDS AT PLUGS, CONVENIENCE RECEPTACLES AND THE POINT WHERE THEY EXIT FROM THE APPLIANCE.

13. PROTECTIVE ATTACHMENT PLUG - THE APPLIANCE IS EQUIPPED WITH AN ATTACHMENT PLUG HAVING OVERLOAD PROTECTION. THIS IS A SAFETY FEATURE. SEE INSTRUCTION MANUAL FOR REPLACEMENT OR RESETTING OF PROTECTIVE DEVICE. IF REPLACEMENT OF THE HAS THE SAME OVERLOAD PROTECTION AS THE ORIGINAL PLUG.
14. CLEANING - THE APPLIANCE SHOULD BE CLEANED ONLY AS RECOMMENDED BY THE MANUFACTURER.
15. POWER LINES - AN OUTDOOR ANTENNA SHOULD BE LOCATED AWAY FROM POWER LINES.
16. OUTDOOR ANTENNA GROUNDING - IF AN OUTSIDE ANTENNA IS CONNECTED TO THE RECEIVER, BE SURE THE ANTENNA SYSTEM IS GROUNDED SO AS TO PROVIDE SOME PROTECTION AGAINST VOLTAGE SURGES AND BUILT UP STATIC CHARGES.
17. NONUSE PERIODS - THE POWER CORD OF THE APPLIANCE SHOULD BE UNPLUGGED FROM THE OUTLET WHEN LEFT UNUSED FOR A LONG PERIOD OF TIME.
18. OBJECT AND LIQUID ENTRY - CARE SHOULD BE TAKEN SO THAT OBJECTS DO NOT FALL AND LIQUIDS ARE NOT SPILLED INTO THE ENCLOSURE THROUGH OPENINGS.
19. DAMAGE REQUIRING SERVICE - THE APPLIANCE SHOULD BE SERVICED BY QUALIFIED SERVICE PERSONNEL WHEN:
  - A. THE POWER SUPPLY CORD OR THE PLUG HAS BEEN DAMAGED OR
  - B. OBJECTS HAVE FALLEN OR LIQUID HAS BEEN SPILLED INTO THE APPLIANCE OR
  - C. THE APPLIANCE HAS BEEN EXPOSED TO RAIN OR
  - D. THE APPLIANCE DOES NOT APPEAR TO OPERATE NORMALLY OR EXHIBITS A MARKED CHANGE IN PERFORMANCE OR
  - E. THE APPLIANCE HAS BEEN DROPPED OR THE ENCLOSURE DAMAGED
20. SERVICING - THE USER SHOULD NOT ATTEMPT TO SERVICE THE APPLIANCE BEYOND THAT DESCRIBED IN THE OPERATING INSTRUCTIONS. ALL OTHER SERVICING SHOULD BE REFERRED TO QUALIFIED SERVICE PERSONNEL.

The device complies with Part 15 of the FCC Rules. Operation is subject to the following two conditions: (1) this device may not cause harmful interference, and (2) this device must accept any interference received, including interference that may cause undesired operation.

Changes or modifications not expressly approved by the party responsible for compliance could void the user's authority to operate the product.

NOTE: This product has been tested and found to comply with the limits for a Class B digital device, pursuant to Part 15 of the FCC Rules. These limits are designed to provide reasonable protection against harmful interference in a residential installation.

This product generates, uses and can radiate radio frequency energy and, if not installed and used in accordance with the instructions, may cause harmful interference to radio communications. However, there is no guarantee that interference will not occur in a particular installation. If the product does cause harmful interference to radio or television reception, which can be determined by turning the equipment off and on, the user is encouraged to try to correct the interference by one or more of the following measures:

- Reorient or relocate the receiving antenna.
- Increase the separation between the product and receiver.
- Connect the product into an outlet on a circuit different from that to which the receiver is connected.
- Consult the dealer or an experienced radio/TV technician for help.

### LOCATION OF CONTROLS

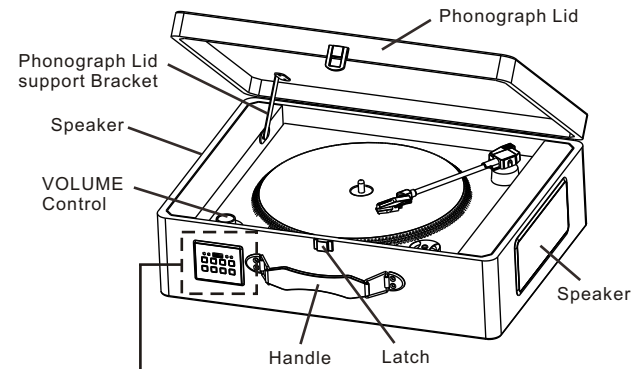

### FRONT PANEL

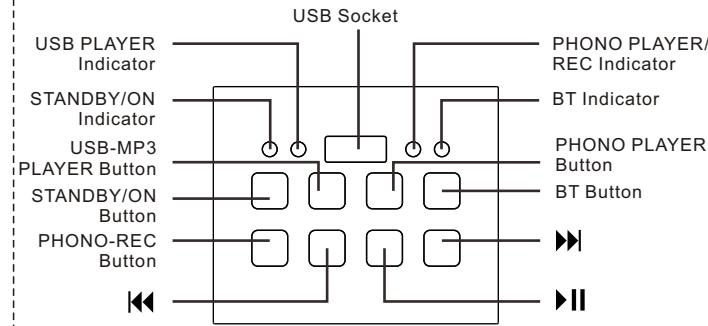

### TURNTABLE PANEL

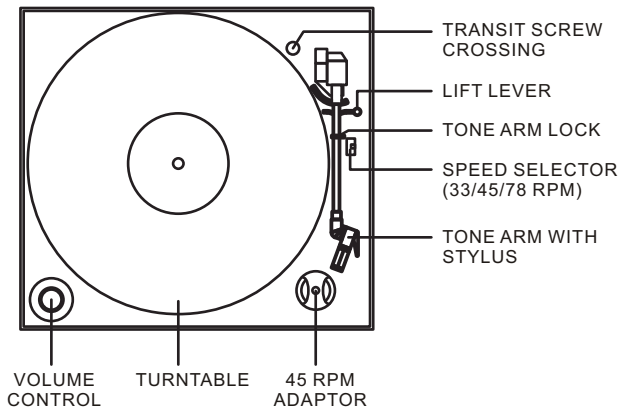

### BACK PANEL

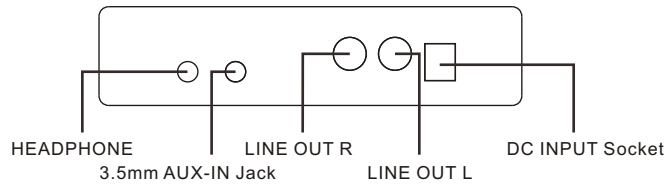

E-5

### UNPACKING AND SET UP

- CAREFULLY REMOVE THE UNIT FROM THE DISPLAY CARTON AND REMOVE ALL PACKING MATERIAL FROM THE UNIT.
- UNWIND THE AC ADAPTOR JACK CABLE AND EXTEND IT TO ITS FULL LENGTH.
- PLACE THE UNIT ON A STABLE, LEVEL SURFACE, CONVENIENT TO AN AC OUTLET OUT OF A STRONG MAGNETIC FIELD.
- CONNECT THE AC ADAPTOR PLUG TO YOUR AC OUTLET.
- REMOVE THE OPAQUE WHITE PLASTIC STYLUS COVER FROM THE PHONOGRAPH STYLUS BY SLIDING IT IN THE DIRECTION OF THE ARROW.
- DURING THIS OPERATION PAY ATTENTION TO THE STYLUS, BECAUSE THE STYLUS DAMAGE IS NOT COVERED BY GUARANTEE.
- REMOVE THE TWIST-TIE THAT WAS USED TO SECURE THE TONE ARM DURING THE SHIPMENT.
- RELEASE THE TONE ARM LOCK LEVEL.

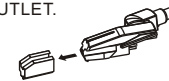

### POWERING ON THE UNIT

- CONNECT THE AC ADAPTER TO THE DC INPUT SOCKET ON THE BACK OF THE UNIT. THEN THE STANDBY/ON INDICATOR WILL LIGHT ON, NOW THE UNIT ON "STANDBY" MODE.
- PRESS STANDBY/ON BUTTON. THE DESIRED PLAYING SOURCE INDICATOR WILL LIGHT ON.
- WHEN YOU HAVE FINISHED USING THE SYSTEM, PRESS STANDBY/ON BUTTON AGAIN, TURN OFF THE UNIT WITH VOICE MESSAGE: POWER OFF.

E-6

### **AUX IN OPERATION**

THIS UNIT PROVIDES AN AUXILIARY AUDIO SIGNAL INPUT JACK FOR CONNECTING EXTERNAL AUDIO DEVICES LIKE MP3 PLAYERS, CD PLAYERS AND OLDER, NON-DOCK-ABLE IPODS, SO YOU CAN LISTEN TO YOUR EXTERNAL SOURCE THROUGH THE SPEAKERS OF THIS SYSTEM.

- USE AN AUDIO CABLE (NOT INCLUDED) WITH ONE 3.5 STEREO JACK ON EACH END OF THE CABLE.
- PLUG ONE END INTO THE AUX-IN JACK ON THE MAIN UNIT AND THE OTHER END TO THE LINE-OUT JACK OF AUDIO DEVICE.
- POWER ON BOTH DEVICES.
- THE VOLUME LEVEL CAN BE CONTROLLED THROUGH THE MAIN UNIT. OPERATE ALL THE FUNCTIONS ON THE AUXILIARY DEVICE AS USUAL.
- PLEASE NOTE THAT AUX IN FUNCTION IS THE FIRST PRIORITY FUNCTION. ONCE THE AUX JACK IS PLUG-IN, ALL INDICATORS ARE LIGHT OFF. THOSE FUNCTIONS DON'T WORK WHILE AUX-IN FUNCTION IS USING. PLEASE UNPLUG THE AUX-IN CABLE BEFORE USING USB-MP3/ PHONO/ BT FUNCTION.

### **NOTE**

- IF THE LINE OUT JACK OF YOUR EXTERNAL DEVICE IS CONNECTED, YOU ONLY NEED TO ADJUST THE VOLUME CONTROL OF THIS SYSTEM.
- MAKE SURE TONE ARM IS SECURELY LOCKED TO THE TONE ARM REST TO AVOID ANY DAMAGE.
- PRESS STANDBY/ON BUTTON TO TURN OFF THE UNIT WHEN YOU ARE DONE. DON'T FORGET TO TURN OFF THE POWER ON YOUR EXTERNAL DEVICE AS WELL.

### **PLAYING RECORDS**

THIS SYSTEM INCLUDES A FULL-SIZE, 3-SPEED, BELT-DRIVE TURNTABLE THAT PLAYS 33, 45 AND 78 RPM RECORDS.

- TO TURN THE SYSTEM ON, PRESS STANDBY/ON BUTTON AND SET THE VOLUME TO A LOW LEVEL.
- PRESS PHONO BUTTON TO TURN PHONO MODE WITH PHONO INDICATOR IS LIGHT ON. PLEASE BE SURE THAT YOU HAVE REMOVED THE STYLUS COVER FROM THE STYLUS AND HAVE RELEASED THE TONE ARM LOCK.
- SET THE TURNTABLE SPEED SWITCH TO THE APPROPRIATE SPEED: 33, 45 OR 78 RPM. SET THE RECORD ONTO THE TURNTABLE. IF YOU ARE PLAYING 45 RPM SINGLES, PLACE THE 45 RPM ADAPTER ON THE CENTER SPINDLE.
- WHEN YOU CHOOSE PLAY A CERTAIN SONG, PUT THE LIFT LEVER BACKWARD AND MOVE THE TONE ARM TO THE RECORD. THEN PULL THE LIFT LEVER GENTLY FORWARD, THE TONE ARM WILL GENTLY MOVE DOWN ONTO THE RECORD. THE SONG WILL START PLAYING SET THE VOLUME CONTROL AS DESIRED.
- WHEN FINISH PLAYING PUT THE LIFT LEVER BACKWARD AND MOVE THE TONE ARM BACK TO THE TONE ARM LOCK.
- IF THE RECORD IS PLAYING TO THE ENDING, THE TONE ARM WILL MOVE BACK TO THE TONE ARM LOCK AUTOMATICALLY.
- PRESS STANDBY/NO BUTTON TO TURN OFF THE SYSTEM WHEN YOU ARE DONE.

### **PHONOGRAPH RECORDING OPERATION**

- PLAY A PHONO RECORD ON THE TURNTABLE. AS YOUR DESIRED.
- PLUG USB DEVICE INTO USB SOCKET. THEN PRESS PHONO-REC BUTTON, THE PHONO INDICATOR IS FLASHING, IT STARTS RECORDING THE MUSIC FROM THE PHONO RECORD.
- PRESS PHONO-REC BUTTON AGAIN WHEN YOU FINISH RECORDING.
- PRESS USB-MP3 BUTTON WITH RED LIGHT IS ON, YOU CAN HEAR THE RECORDING TRACK ON THE USB DEVICE.

### **NOTE**

- PHONO-REC IS ONLY FOR PHONOGRAPH RECORDING.
- PHONO-REC IS FOR RECORDING THE MUSIC FROM THE PHONO RECORD THROUGH USB DEVICE.

### **USB OPERATION**

- PRESS USB-MP3 BUTTON TO TURN ON USB MODE WITH USB INDICATOR IS LIGHT ON.
- INSERT THE USB DEVICE INTO THE USB SOCKET ON THE SYSTEM, THE PLAYER WILL START PLAYING THE TRACKS.
- PRESS THE [◀◀] OR [▶▶] BUTTONS TO CHOOSE YOUR DESIRED TRACK.
- PRESS THE [⏸] BUTTON TO PAUSE OR PLAY THE TRACK.
- PRESS THE [⏻] BUTTON TO TURN OFF THE UNIT WHEN YOU ARE DONE.

### **NOTE**

- THE USB-MP3 PLAYING MODE HAS MEMORY FUNCTION. WHEN RE-INSERTING THE SAME USB DEVICE, IT WILL RESUME THE TRACK PLAYING FROM THE LAST TIME.
- THE UNIT IS ONLY PLAYING THE MP3 FORMAT TRACKS.

### **REMOVING THE USB DRIVE**

- PLEASE BE SURE THE STOP PLAYBACKS AND TURN THE UNIT OFF BEFORE REMOVING THE USB DRIVE TO AVOID DAMAGE TO THE USB AND THE SYSTEM.

### **BLUETOOTH OPERATION**

- PRESS BT BUTTON ON THE FRONT PANEL TO ACTIVATE THE BLUETOOTH MODE WITH BT INDICATOR IS LIGHT ON.
- SET UP THE BLUETOOTH PLAYBACK DEVICE AND SEARCHING FOR "BT TURNTABLE" AND CONNECT.
- IF ASKED FOR A PASS CODE, ENTER "0000"
- \*THIS IS A ONE-TIME EVENT PER DEVICE. TO PAIR YOUR UNIT TO ANOTHER DEVICE, REPEAT THE ABOVE PREPARATION AND CONNECTION STEPS.**
- YOU WILL HEAR A SIGNAL WITH DING-DONG SOUND.
- ENJOY YOUR MUSIC FROM YOUR PLAYBACK DEVICE.

### **NOTE**

- THE NEXT TIME YOU TURN ON THE DEVICE IT WILL AUTOMATICALLY CONNECT TO THE LAST BLUETOOTH PLAYBACK DEVICE CONNECTED. IF YOUR BLUETOOTH PLAYBACK DOES NOT AUTOMATICALLY RECONNECT TO THE DEVICE, YOU WILL HAVE TO RE-ESTABLISH THE CONNECTION TO YOUR BLUETOOTH DEVICE MANUALLY.
- IF YOU USE A SMART-PHONE AS YOUR BLUETOOTH PLAYBACK DEVICE, THE AUDIO FILE WILL MUTED WHEN THERE IS AN INCOMING CALL. ACCEPTANCE/ TERMINATION OF THE CALL IS CARRIED OUT VIA THE SMART PHONE. AFTER FINISHING THE CALL, THE PLAYBACK WILL BE RESUME AUTOMATICALLY.

E-9

### **LINEOUT OPERATION**

- THIS SYSTEM INCLUDED A SET OF LINE OUT JACK WHICH ALLOW TO PLAY FROM THE BT, USB-MP3 AND PHONOGRAPH OF THIS SYSTEM TO AN EXTERNAL PLAYBACK DEVICE.
- INSERT THE AUDIO CABLE (L/R RCA CABLE, NOT INCLUDED) INTO THE "LINE OUT" SOCKET OF THE UNIT.
- OPERATE THE UNIT AS USUAL.
- IN ORDER TO ACHIEVE BEST EFFECT IN SOUND, ADVISE SETTING THE UNIT VOLUME INTO MINIMUM LEVEL.
- THROUGH THE SPEAKERS OF EXTERNAL PLAYBACK DEVICES, WE CAN HEAR THE SOUND FROM THE UNIT.

### **HEADPHONE OPERATION**

- THE STEREO HEADPHONE JACK IS LOCATED ON THE BACK PANEL. CONNECT A SET OF STEREO HEADPHONES (NOT SUPPLIED) TO THIS JACK FOR PRIVATE LISTENING. WHEN HEADPHONE ARE IN USE, THE SPEAKERS WILL BE AUTOMATICALLY MUTED.
- WHEN USING HEADPHONES, ALWAYS SET THE VOLUME CONTROL TO A LOW LEVEL BEFORE YOU PLUG-IN THE HEADPHONE JACK, THEN PLUG-IN THE HEADPHONE JACK AND GRADUALLY INCREASE THE VOLUME TO A COMFORTABLE LISTENING LEVEL.

### **REPLACING THE STYLUS**

- LIFT THE TONE ARM OFF THE TONE ARM REST.
- AT THE FRONT END OF THE TONE ARM, PLACE THE TIP OF YOUR FINGERNAIL BETWEEN THE RED STYLUS HOLDER AND THE BACK CARTRIDGE HOUSING AS SHOWN, PRESS ON THE RED STYLUS HOLDER UNIT IT SEPARATES FORM THE CARTRIDGE HOUSING.
- COMPLETELY REMOVE THE RED STYLUS HOLDER WITH WORN STYLUS AND DISCARD IT.
- PLACE THE NEW RED STYLUS HOLDER WITH STYLUS UNDER THE CARTRIDGE HOUSING. FIRST, PRESS UPWARD ON THE BACK SIDE OF THE STYLUS HOLDER, AND THEN PRESS UP ON THE FRONT EDGE OF THE STYLUS HOLDER UNTIL IT SNAPS INTO PLACE ON THE CARTRIDGE HOUSING.

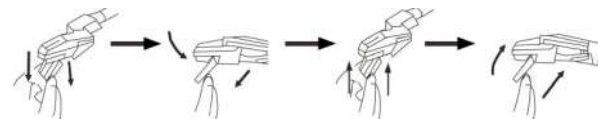

E-10

## **TRANSPORTING THE SYSTEM**

### **IMPORTANT!**

TO PROTECT THE TURNTABLE FROM THE DAMAGE DURING TRANSPORTATION, A SLIVER TRANSIT SCREW IS LOCATED THE UPPER RIGHT THE TURNTABLE PLATFORM.

- BEFORE PLAYING. PLEASE USE A SCREWDRIVER TO TURN THE TRANSIT SCREW IN CLOCKWISE DIRECTION (SCREW GOING DOWN) COMPLETELY TO UNLOCK THE TURNTABLE.
- TO LOCK THE TURNTABLE AGAIN FOR TRANSPORTATION, PLEASE TURN SCREW IN COUNTER- CLOCKWISE DIRECTION.

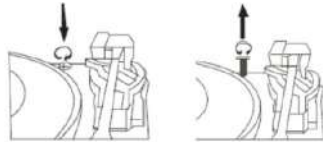

## **CARE OF THE LEATHER CASE**

- CARE OF THE UNIT IS THE SAME AS ANY PIECE OF FURNITURE.
- WHEN THE UNIT IS DUSTY, YOU MAY WIPE IT USING SOFT, NON-ABRASIVE DUST CLOTH.

E-11

## **CARE AND MAINTENANCE**

TO REPLACE THE CARTRIDGE FROM THE TONE ARM PLEASE FOLLOW THE PROCEDURE BELOW.

- GENTLY LIFT OFF THE TONE ARM FROM THE TONE ARM REST.
- BY USING YOUR LEFT HAND TO HOLD THE TONE ARM AND USING YOUR RIGHT HAND TO HOLD THE REAR PORTION OF THE CARTRIDGE. THEN PUSH THE CARTRIDGE BACKWARDS AND DOWNWARDS ACCORDING TO THE DIRECTION AS SHOWN TO THE LEFT TO SEPARATE THE CARTRIDGE FROM THE TONE ARM.
- USING EITHER A TWEEZER OR YOUR FINGERS, CAREFULLY UNPLUG THE TERMINALS TO THE NEW CARTRIDGE.
- CAREFULLY CONNECT THE TERMINALS TO THE NEW CARTRIDGE (NOT INCLUDED).
- TO RE-INSTALL THE NEW CARTRIDGE TO THE TONE ARM. FIRST PLEASE LOCK THE FRONT END OF THE NEW CARTRIDGE ON THE HOOK OF THE TONE ARM.
- PRESS THE REAR SIDE OF THE NEW CARTRIDGE UPWARDS TO LOCK IT ON THE TONE ARM.

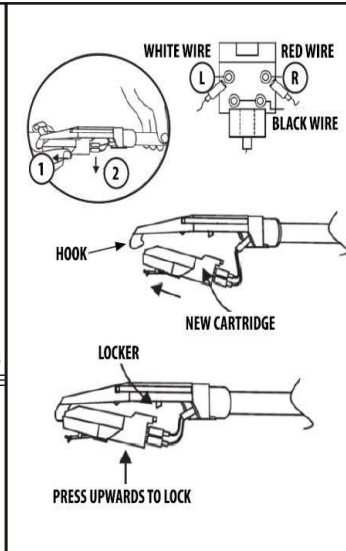

**CAUTION:** PLEASE DON'T DAMAGE THE STYLUS WHEN INSTALLING THE NEW CARTRIDGE.

E-12

