



Model: iB91

FreedomGlow

Wireless rechargable LED color-changing headphones with mic+remote



Introduction

Your new iHome Bluetooth stereo headphones are designed to link with your Bluetooth enabled smartphone or music player to allow you to wirelessly listen to music and answer phone calls within the normal 10 meter (33 feet) Bluetooth operating range. An auxiliary input cable is included so that you can use this Home Bluetooth headphone as a normal wired headphone to listen to non-Bluetooth audio sources, or keep listening even when the internal rechargeable battery is exhausted. Finally your iHome iB91 Bluetooth headphones include multi-color LEDs inside the headband with four selectable color changing modes so you can always be the life of the party, even when there is no party.

What's Included

- Bluetooth Stereo Headphone
- USB Charging Cable
- Cord wrap (Packaging Hangtag)

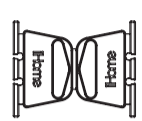
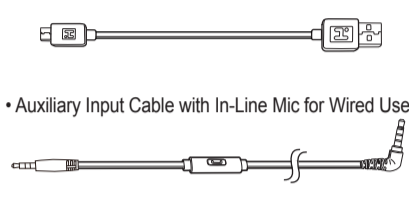

• Auxiliary Input Cable with In-Line Mic for Wired Use

Specifications

Bluetooth specification:	Supports V4.0 + EDR with Handsfree Profile 1.5, Headset Profile 1.1 and A2DP profile 1.2 (Class II) and Audio/Video Remote Control Profile AVRP
Standby time (unpaired):	up to 90 days (with fully charged battery)
Talk time:	up to 15 hours (with fully charged battery)
Music Playing time with LED lighting effects:	up to 12 hours (with fully charged battery)
Operating Distance:	up to 10 meters / 33 feet
Certifications:	FCC, RoHS, BQB

PREPARATION FOR USE

1. Controls and Indicators

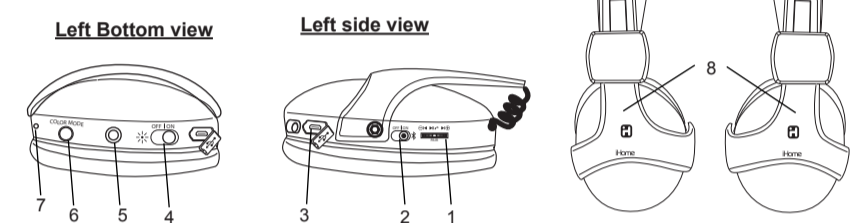

1. Multi-function button: Answer Call/End Call, Pair, Play, Pause, Skip Forward/Back and Volume Up/Down
2. Bluetooth Off/On Switch with LED Indicator
3. USB Charging Port
4. LED Lighting Effects Off/On Switch
5. Auxiliary Input Jack
6. Color Mode Selector Up/Down
7. Microphone
8. LED Lighting Area

2. Charging Your Headphone

IMPORTANT: Your headphone uses a built-in rechargeable lithium-ion battery to receive and play Bluetooth audio streamed from your phone or Bluetooth music player. It also uses the built in battery to power the special LED lighting effects. Although the battery was fully charged when it left our factory, like all rechargeable batteries it can begin to discharge during periods of non-use. We recommend that you charge the battery for at least 2 hours before first time use. For faster charging make sure that the Off/On Switch and Bluetooth Off/On Switch with LED Indicator are set to the Off position while charging.

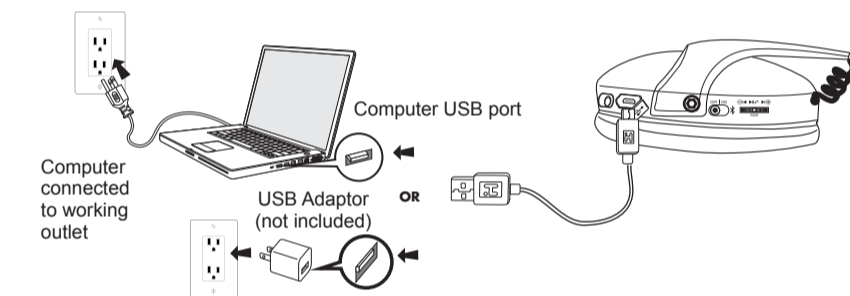

1. Connect the micro USB plug on the charging cable to the micro USB port on the headphone.
2. Connect the standard USB plug on the charging cable to any standard USB power port such as found on a notebook computer, or the charging adapter for an iPod, iPhone, etc.

The LED Indicator in the Bluetooth Off/On Switch will glow RED while the headphone is charging. The glowing red indication will turn Off when the battery is fully charged.

Reminder: Allow the battery to charge for 2 hours before first time use. Normal recharge time after first use should take about 2 hours. When fully charged the battery provides up to 24 hours of working time for the LED Lighting Effects, or 15 hours of Bluetooth audio playback, but if the LED Lighting Effects and Bluetooth audio playback are used together the battery operating time will be reduced to about 12 hours.

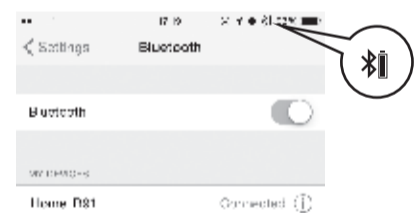

Because your iB91 headphones use Bluetooth version 4.0 the battery level indicator of the headphones may also appear on your smartphone home screen, usually adjacent to the phone's own battery level indicator, if your specific phone supports this display function.

3. Multi-Function Button (MFB) For Bluetooth Operations

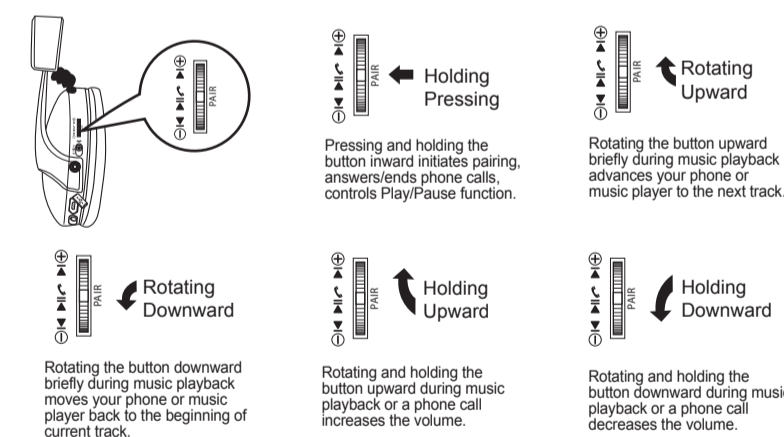

4. Switching Bluetooth On and Off

1. Slide the Bluetooth Off/On Switch to the On position. The voice prompt will say "Power On" and the indicator in the switch turns blue. If your headphones detect a previously paired device that is within range, they will re-link to that device and the voice prompt will say "Your Device Is Connected".
2. Slide the Bluetooth Off/On Switch to the Off position. The voice prompt will say "Power Off". The LED indicator changes from blue to red momentarily and then shuts off.

5. Manually Pairing With a Bluetooth Enabled Smartphone or Music Player For The First Time

If your smartphone or music player, such as the iPod touch, is Bluetooth enabled (supports the A2DP Bluetooth Profile) you may pair these iHome headphones with your phone or music player to listen to music and make or receive calls as long as the two devices are within the Bluetooth operating range of approximately 33-feet of each other.

Note: Your iHome headphones must be in the Bluetooth Power On mode to begin the manual pairing process. Switch indicator is flashing blue color.

1. Press and hold the Multi-function button on your iB91 headphones for about 3 seconds until you hear the "Pairing" voice prompt. The LED indicator begins alternately flashing blue and red to indicate it is trying to pair with a compatible device.
2. If necessary, turn on the Bluetooth function of your phone or music player so that it begins searching for a compatible device.
3. "iHome iB91" should appear on your phone or music player's compatible devices list. You may also see a message such as "Not Paired". Tap on that message to complete the pairing process. If your phone or music player asks for a "password" to complete the pairing process, enter "0000" on the keypad of your phone or music player.
4. When pairing is successful the screen on your phone should show "iHome iB91 Connected" or similar message and the voice prompt will say "Your Device Is Connected". The blue LED indicator on the iB91 headphones will flash once every 5 seconds. Your headphones are now ready for use.

6. Auto-Linking With A Previously Paired Device

If your iB91 headphones were previously paired with a Bluetooth enabled smartphone or music player they will attempt to auto-link with that device again whenever that device is within the Bluetooth operating range.

1. Slide the Bluetooth Power Off/On Switch to the On position. You will hear the "Power On" voice prompt.
2. Make sure that the Bluetooth function of the previously paired device is 'On'. You will hear the voice prompt say "Your Device Is Connected"

Note: If no previously paired device is found after 3 minutes the auto-linking function stops and your iB91 headphones shut off automatically to preserve the battery life.

7. Wearing Your Headphones

Your iHome iB91 Bluetooth headphones are supplied with padded ear cushions for long wearing comfort. The headband can be extended to accommodate almost any head size. There are 'L' and 'R' markings on the inside of the headband. When the headphones are worn properly all of the operation controls will be on your left side facing toward the rear.

8. Using Your Headphones

Note: Some of the functions described below may not be supported on your specific smartphone. Check with your smartphone owner's manual to confirm the features supported by your phone.

Function	Action Required
Turn headphones "On"	Slide the Bluetooth Off/On Switch to the On Position. You will hear the "Power On" voice prompt.
Enter Pairing Mode	When Headphones are 'On' press and hold the MFB for 3 seconds until you hear the "Pairing" voice prompt. The LED indicator flashes alternately blue and red rapidly.
Pairing	Make sure your Bluetooth device is 'On' and in Pairing Mode. When iHome iB91 appears on your device's menu, select it to complete pairing.
Play / Pause	Short press the MFB to start playback. Short press to pause playback. Short press to resume playback.
Skip to beginning of next track	Rotate the MFB button upward once during playback
Skip to beginning of current track	Rotate the MFB button downward once during playback
Increase volume	Rotate and hold the MFB button up during playback. At max volume you will hear the "Maximum Volume" voice prompt.
Decrease volume	Rotate and hold the MFB button down during playback
Answer an incoming phone call	Short press the MFB when you hear the incoming ring sound. NOTE: Music will pause automatically when you are answering a call and resume when you end the call.
Decline an incoming phone call	Double press the MFB to decline the incoming call.
End a call	Short press the MFB to end the call and 'hang up'.
Transfer a call between the phone and the headphones	While the call is in progress double press the MFB to transfer the call between the phone and the headphones.
Last number redial	When phone is paired with headphones but no call is in progress double press the MFB to redial the last number
Answer second call/ call waiting	Short press the MFB to place the current call on hold and answer an incoming 2nd call. Press and hold the MFB for 2 seconds to return to previous call. Short press the MFB to end 2nd current call and return to previous call.
Turn headphones "Off"	Slide the Bluetooth Power Off/On switch to the Off position. You will hear the "Power Off" prompt and LED indicator shuts off

9. Auxiliary Input Jack and Cable with In-Line Mic

The auxiliary input jack allows you to use your iB91 Bluetooth headphones as normal headphones so that you can listen to music on any non-Bluetooth device that is equipped with a 3.5mm headphone jack.

The included stereo audio cable with in-line mic has a straight plug on one end and an "L" shaped plug on the other end. Connect the straight plug to the auxiliary input jack on the bottom of the Left ear piece. Connect the "L" shaped plug to the headphone jack of your phone or music player. Note: When you connect the auxiliary input cable to your iB91 headphones any previously paired Bluetooth device is automatically disconnected and headphones will power Off to save battery life. Use the volume and track navigation controls on your music player as you would with any normal headphones.

When using the Auxiliary Input cable with in-line mic you will be able to answer phone calls and control certain music functions using the button on the in-line mic.

When you receive an incoming call the music mutes automatically. Press the mic button once to answer the call. When finished, press the mic button again to hang up. Music resumes at normal volume.

To decline an incoming call, press the mic button twice.

To begin music playback press the mic button once. Press again to Pause playback. Press once more to resume playback.

When music is playing press the mic button twice to skip to the beginning of the next track, or three times to go back to the beginning of the current track.

NOTE: Not all of the hands free functions are available on all phones. You may find that some functions may work with your phone while others do not. This is due to the design of your specific phone and is not an indication of any problem with the iB91 headphone.

10. Color-Changing Lighting Effects

To turn on the lighting effects slide the Off/On Switch to the 'On' position.

Your iHome iB91 headphones provide 4 different lighting effects that are selected by pressing the Color Mode Selector button. The lighting effects are:

1. Color Spectrum – the colors blend evenly and smoothly.
 2. Favorite Color – press the Color Mode Selector button when your favorite color appears to stop the color blending and select your favorite color.
 3. Strobe to the Beat – the changing colors will flash to the beat of the music.
 4. Color Pulse – rapid changing of colors with no blending.
- You iHome iB91 headphones will remember the mode that was selected before the lighting effect was switched 'Off' and automatically return to that same mode when the lighting effect is switched 'On' again.

When you no longer want your iHome iB91 headphones to display colors, slide the Off/On Switch to the 'Off' position. This will shut off the lighting effects but the headphones will still operate normally.

11. Use of the Hangtag Cord Wrap

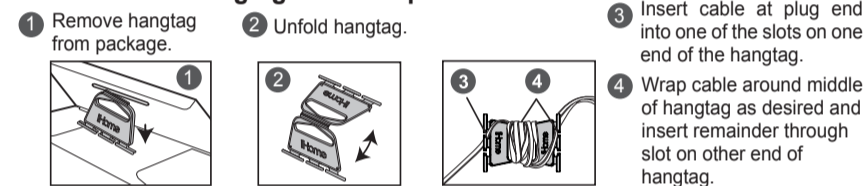

TROUBLESHOOTING

1. Reception is noisy or intermittent
Make sure that the headphones and the paired device are within the Bluetooth operating range of approximately 33 feet.
2. No Sound
Make sure that your headphones are properly paired and connected with your Bluetooth enabled smartphone or music player. Refer to the "Pairing" instructions in this manual and in the manual supplied with your phone or music player if necessary.
The rechargeable battery in your headphones may be exhausted and need to be recharged. Refer to the "Charging Your Headphones" instructions in this manual.
3. Unable to Pair/Connect
The pairing settings between the headphones and your smartphone or music player may have been erased or deleted. Follow the "Pairing" instructions in this manual to re-pair and reconnect the devices.
Turn off any other Bluetooth devices that are not being used to reduce external interference.
4. Some Functions Do Not Work
Your specific model of smartphone may not support some of the functions described in this manual. Refer to the manual supplied with your phone for further information.

CARE AND MAINTENANCE

Always remember to turn your headphones off if they will not be used for a long period of time. Do not expose your headphones to extremely hot or cold temperatures for extended periods. Do not expose them to direct sunlight or leave them in places such as the dashboard of your car on a hot day. Prevent water or any other liquids from entering the cabinets of your headphones.

Protect Your Hearing

Using these, or any headphones at high volume levels for long periods can result in permanent hearing damage. Always start listening with volume controls on your headphones and your paired smartphone or music player at a low level and then gradually increase the volume controls to a comfortable listening level.

Important Notes

- It is dangerous and illegal (in some jurisdictions) to use headphones when you are driving a car, riding a bike or motorcycle, or operating a watercraft. Be aware of local laws and regulations.
- Do not use these headphones in situations where they might cause distractions or prevent you from hearing warning sounds.
- There are no user serviceable parts in these headphones. Do not attempt any service or repairs on your own. Refer to the warranty for service, repair or replacement information.

Internal Rechargeable Lithium-ion Battery

This device uses an internal rechargeable lithium-ion battery that should last the lifetime of the device. If you suspect your battery may be dead, try charging it several times. If the battery does not recharge, please contact us for repair information.

WARNING/DISPOSAL OF UNIT

Please do NOT attempt to change the battery yourself. If the battery has died and you do not want us to replace your battery, you should follow the disposal instructions below:

- Never dispose of used batteries/electronics with ordinary solid wastes, since they contain toxic substances.
- Always dispose of used batteries/electronics in accordance with the prevailing community regulations that apply to the disposal of batteries/electronics. If there are no local regulations concerning battery/electronics disposal, please dispose of the device in a waste bin for electronic devices.
- Many electronics retailers now recycle batteries and other electronic components at no charge. Check to see which ones in your area do so.

CAUTION:

- The battery used in this device may present a risk of fire, explosion or chemical burn if mistreated.
- Never use or charge the battery if it appears to be leaking, discolored, deformed, or in any way abnormal.
- Never disassemble the unit or attempt to remove battery as that could cause leakage of alkaline solution or other electrolytic substance.
- Always confirm that the temperature is 5°C - 35°C (41° - 95° Fahrenheit) before you charge the battery. Leakage or deterioration of the battery may occur if this warning is not heeded.
- Never expose the battery to any liquid.
- Never expose the battery to excessive heat such as direct sunlight or fire. Never use the battery pack in an unventilated vehicle where excessive internal temperatures may be encountered.
- Always keep the battery out of the reach of infants and small children.

FCC & IC Information

This equipment complies with FCC radiation exposure limits set forth for an uncontrolled environment. This device complies with Industry Canada's licence-exempt RSSs. Operation is subject to the following two conditions: (1) this device may not cause interference, and (2) this device must accept any interference, including interference that may cause undesired operation of the device.
Le présent appareil est conforme aux CNR d'Industrie Canada applicables aux appareils radio exempts de licence. L'exploitation est autorisée aux deux conditions suivantes : (1) l'appareil ne doit pas produire de brouillage; (2) l'utilisateur de l'appareil doit accepter tout brouillage radioélectrique subi, même si le brouillage est susceptible d'en compromettre le fonctionnement.

This device complies with FCC radiation exposure limits set forth for an uncontrolled environment. This device complies with Part 15 of the FCC Rules, operation is subject to the following two conditions: (1) This device may not cause harmful interference, and (2) this device must accept any interference received, including interference that may cause undesired operation.

The device meets the exemption from the routine evaluation limits in section 2.5 of RSS 102 and compliance with RSS-102 RF exposure, users can obtain Canadian information on RF exposure and compliance.
Le dispositif rencontre l'exemption des limites courantes d'évaluation dans la section 2.5 de RSS 102 et la conformité à l'exposition de RSS-102 rf, utilisateurs peut obtenir l'information canadienne sur l'exposition et la conformité de rf.

- Warning: Changes or modifications to this unit not expressly approved by the party responsible for compliance could void the user's authority to operate the equipment.
- NOTE: This equipment has been tested and found to comply with the limits for a Class B digital device, pursuant to Part 15 of the FCC Rules. These limits are designed to provide reasonable protection against harmful interference in a residential installation. This equipment generates, uses and can radiate radio frequency energy and, if not installed and used in accordance with the instructions, may cause harmful interference to radio communications.

However, there is no guarantee that interference will not occur in a particular installation. If this equipment does cause harmful interference to radio or television reception, which can be determined by turning the equipment off and on, the user is encouraged to try to correct the interference by one or more of the following measures:

- Reorient or relocate the receiving antenna.
- Increase the separation between the equipment and receiver.
- Connect the equipment into an outlet on a circuit different from that to which the receiver is connected.
- Consult the dealer or an experienced radio/TV technician for help.

FCC ID: EMOIB91
IC: 986B-IB91

LIMITED 1 YEAR WARRANTY

iHome Products, a division of SDI Technologies Inc. (hereafter referred to as SDI), warrants this product to be free from defects in workmanship and materials, under normal use and conditions, for a period of one (1) year from the date of original purchase.
Should this product fail to function in a satisfactory manner, it is best to first return it to the store where it was originally purchased. Should this fail to resolve the matter and service still be required by reason of a defect or malfunction during the warranty period, SDI will repair or, at its discretion, replace this product without charge. This decision is subject to verification of the defect or malfunction upon delivery of this product to the Factory Service Center authorized by Customer Service.

If service is required, please call Customer Service at 1-800-288-2792 to obtain a Return Authorization Number and shipping instructions.
Disclaimer of Warranty
NOTE: This warranty is valid only if the product is used for the purpose for which it was designed. It does not cover (i) products which have been damaged by negligence or willful actions, misuse or accident, or which have been modified or repaired by unauthorized persons; (ii) cracked or broken cabinets, or units damaged by excessive heat; (iii) damage to digital media players, CDs or tape cassettes (if applicable); (iv) the cost of shipping this product to the Factory Service Center and its return to the owner.
This warranty is valid only in the United States of America and does not extend to owners of the product other than to the original purchaser. In no event shall SDI or any of its affiliates, contractors, resellers, their officers, directors, shareholders, members or agents be liable to you or any third party for any consequential or incidental damages, any lost profits, actual, exemplary or punitive damages. (Some states do not allow limitations on implied warranties or exclusion of consequential damages, so these restrictions may not apply to you.) This warranty gives you specific legal rights, and you may also have other rights which vary from state to state.
Your acknowledgment and agreement to fully and completely abide by the above mentioned disclaimer of warranty is contractually binding to you upon your transfer of currency (money order, cashier's check, or credit card) for purchase of your SDI product.

© 2015 SDI Technologies, Inc. All rights reserved.
Questions? Visit www.ihome.com
or call 1-800-288-2792 Toll Free

Bluetooth is a registered trademark of Bluetooth SIG Inc.
Bluetooth technology is incorporated under license from Bluetooth SIG Inc.