

iBT11 IB_US version
Size: 153 x 120 mm (16 pages)
Color: 1C + 1C (Black)
Material: 90gsm WF paper
May 07, 2015

P1

iHome®



Model iBT11

Split

**Rechargeable
Bluetooth Stereo Speakers
with Charging Base**

**CHARGE
BEFORE
USE**



CAUTION: Split speakers have magnets on the bottom. To avoid damage, do not place on laptops, tablets or other electronic equipment.



instruction manual

Questions? Contact Customer Service at 1-800-288-2792

Table of Contents

What's in the Box	1
Product Care	1
Introduction	2
Controls Overview	2-3
Charging Speakers	4-5
Charging Speakers Using Charging Base	4
Charging Speaker Using Micro USB Charging/Audio Port	5
Using Bluetooth	6-8
Pairing Both Speakers to Bluetooth	6
Pairing Speakers Separately (mono)	7
Listening to Bluetooth Audio	8
Using Speakerphone Mode	9
Aux-in Mode	10
Lithium Battery Warning	11
Safety Information	12-13
Troubleshooting	14
Warranty Information	15

What's in the Box

This product ships with the following items. Make sure all are present.

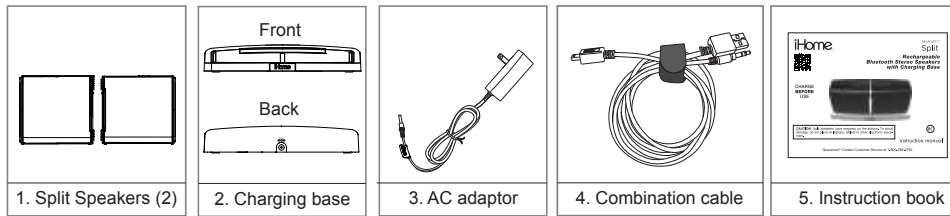

Product Care

- Place the unit on a level surface away from sources of direct sunlight or excessive heat.
- Protect your furniture when placing your unit on a natural wood and lacquered finish. A cloth or other protective material should be placed between it and the furniture.
- Clean your unit with a soft cloth moistened only with mild soap and water. Using stronger chemical cleaning agents or abrasive cleaning materials may damage the finish of your unit.

Introduction

Thank you for purchasing the Split Rechargeable Speakers with Charging Base. The Split is all about options. This unique unit features 2 separate speakers with individual controls which can be used connected together for great stereo sound via Bluetooth or aux in, or separated for even better stereo sound image via True Wireless. Each speaker can also be used as a separate mono speaker. Speakerphone capability allows you to listen to calls from either or both speakers. The included charging base charges speakers for portable use. A micro USB charging/audio port on each speaker lets you charge the speakers when you're away from the charging base, and play audio from any device equipped with a headphone jack. Please read the following instructions carefully before use and save for future reference.

Controls Overview

Each speaker has the same controls and can be used independently (2 mono speakers) or together (stereo). By default, the left speaker (speaker A) is the Master speaker and controls the Slave speaker, the right speaker (speaker B) when the speakers are connected. When speakers are separate, whichever speaker is powered on becomes the master when connected to the other speaker.

NOTE: This instruction book uses Top Panel and Bottom Panel to indicate the position of controls *when a speaker is in the charging dock*. When in use in its upright position, speaker A top becomes right and bottom becomes left, while for speaker B top becomes left and bottom becomes right.

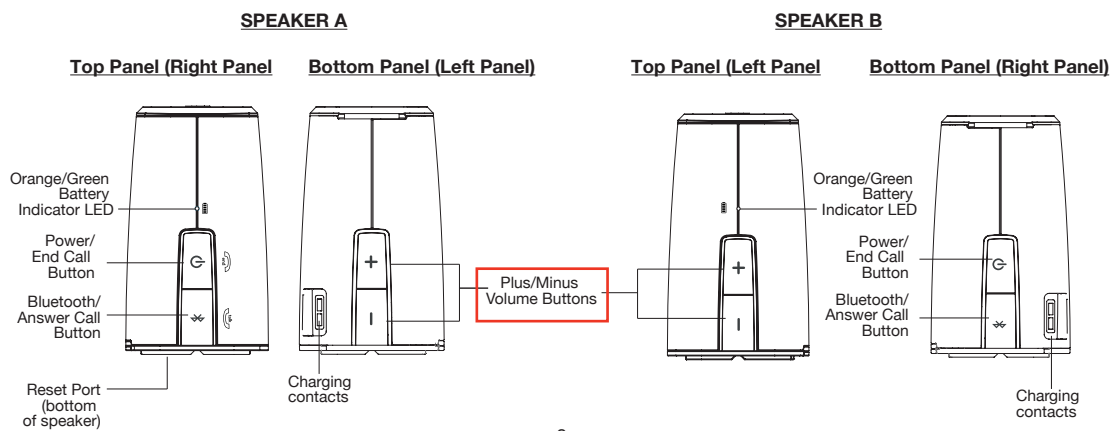

SPEAKER A
Back Panel

SPEAKER B
Back Panel

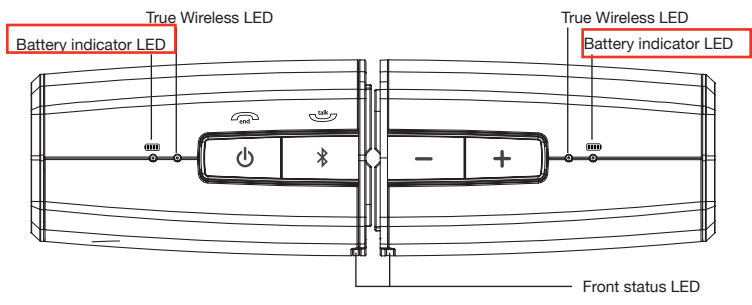
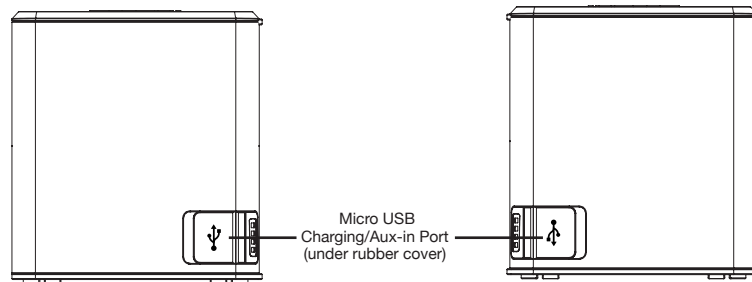

Charging Dock (back panel)

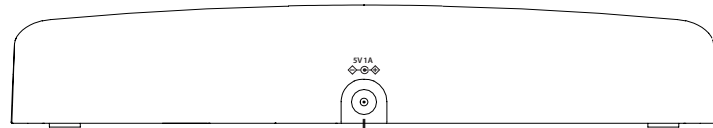

DC Jack

Charging Speakers

CHARGING SPEAKERS USING CHARGING BASE

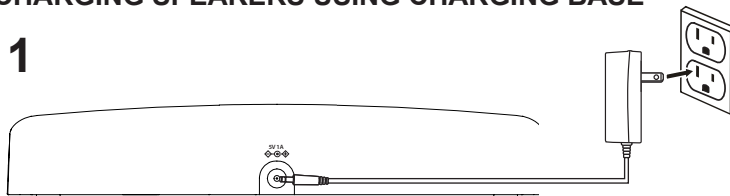
1

CHARGE SPEAKERS BEFORE USE

Connect the AC adaptor to the DC jack located on back of the Charging Base. Connect plug into a working wall outlet that is not controlled by a wall switch.

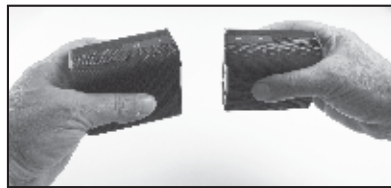
2

Place **Speaker A** and **Speaker B** together as shown to connect them. (Gently pull apart to disconnect.)

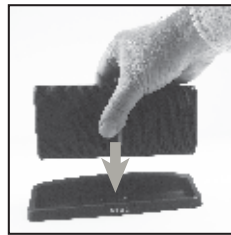
3

Gently place connected speakers on Charging Base with charging contacts facing contacts on dock. The Battery Indicator LED on each speaker will flash orange to indicate charging, and turn green when fully charged. For first time charge, keep docked for 3 hours to charge fully.

4

CHARGING A SPEAKER USING MICRO USB CHARGING/AUDIO PORT

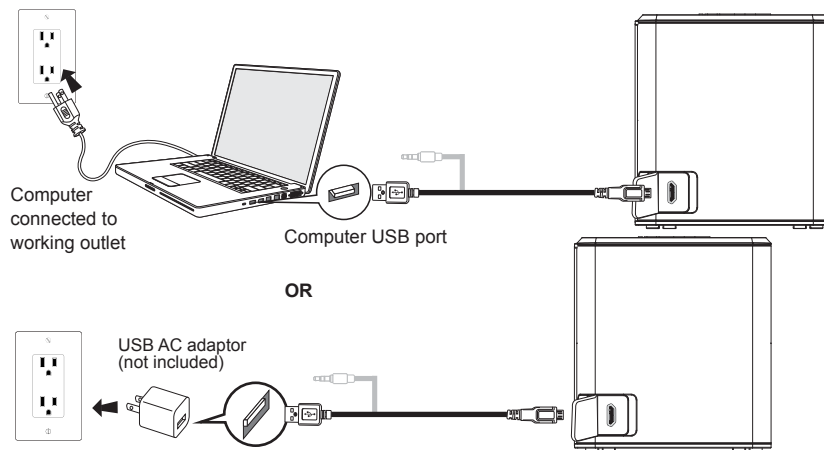

NOTE: WHEN CHARGING VIA USB, ONLY THE SPEAKER CONNECTED TO THE USB CABLE WILL CHARGE

To charge either speaker when away from the Charging Base, connect the included Combination USB Charging/Audio Cable to the Micro USB Charging/Audio Port (located under the rubber cover on each speaker) to one speaker and connect the other end to a USB power source such as a USB AC adaptor or computer USB port. Each speaker must be charged separately. The battery status indicator LED on top of the speaker will flash orange when battery is low, LED will flash orange during charging and become green once fully charged.

Using Bluetooth

PAIRING BOTH SPEAKERS TO BLUETOOTH

Pairing is the set-up process to introduce your Bluetooth-capable device to the Split. Once your device is paired, the Split can recognize it and you can play your audio through it.

1

Make sure your Bluetooth device and the Split are fully charged. Turn on your Bluetooth device and make it "discoverable" by turning on Bluetooth mode (check in Options or Settings).

2

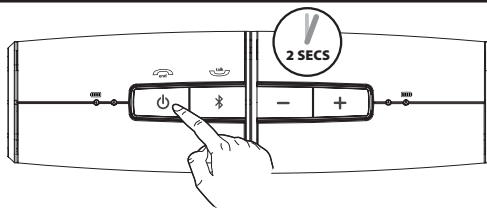

Make sure speakers are connected. Press and hold the **Power Button** on the left speaker (speaker A) for 2 seconds. The white status indicator light on the front will light and the power on tone will sound.

3

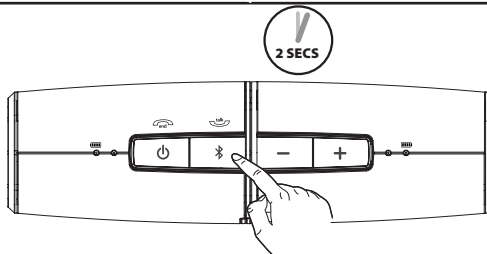

Press and hold the **Bluetooth Button** on the left speaker (speaker A) for 2 seconds. The white status indicator light on the front will flash and the Bluetooth pairing tones will sound, indicating pairing mode

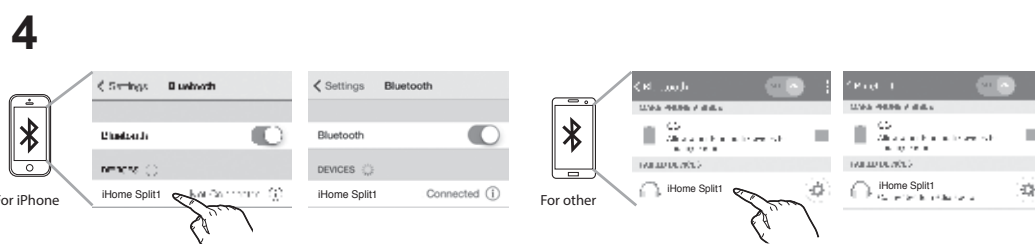

“iHome Split1” should appear on your device’s Bluetooth menu. Tap to select and complete pairing. If pairing is successful a tone will sound and the status indicator LED will turn solid. You can now play Bluetooth audio from the paired device. If no device is paired within 3 minutes, the unit will revert to previous mode. Follow steps 1 - 4 above to try pairing again.

PAIRING A SINGLE SPEAKER TO BLUETOOTH

Each Split speaker can be paired independently provided the speakers are not physically connected nor in range of one another (about 33 feet).

To pair a single speaker, follow steps 1-4 above. “iHome Split1” or iHomeSplit2” will appear on the device’s Bluetooth menu, depending on which speaker is being paired:

Left (speaker A= iHome Split1), Right (speaker B= iHome Split2).

If you then physically connect two independently paired speakers, audio from Split 2 will be replaced with audio from Split 1. The controls on the bottom of connected speakers are then disabled. If only 1 speaker is paired, it becomes the master and its audio will play through both speakers.

LISTENING TO BLUETOOTH AUDIO

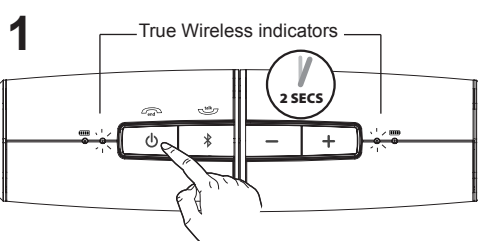

Press and hold the **Power Button** to turn on both connected speakers. (For independent mono listening (speakers are separated), press and hold the **Power Button** on the desired speaker.) The power on tone will sound and the front status LED will flash slowly as the unit looks for a linked Bluetooth device. Once found, the LED will glow solid white. If operating on internal battery, the battery indicator LED will light for five seconds.

True Wireless Mode

Once the blue True Wireless indicators on top of each connected speaker light, separate the speakers for best stereo sound.

When operating in True Wireless mode with speakers separated, **Power** and **+/- Volume Buttons** on either speaker control *both* speakers.

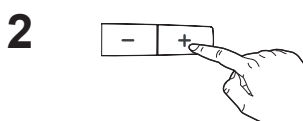
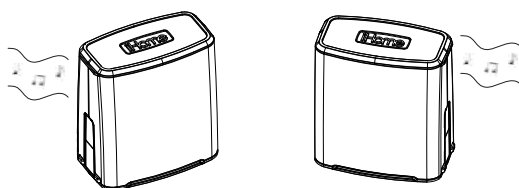

Make sure the volume on your Bluetooth device is at least 50% volume for proper audio detection. If no audio is detected in 5 minutes the unit will turn off to save power.

Press and release the **+ or - Button** to control the speaker volume (hold for rapid adjustment).

4



Press and release the **Power Button** to turn the Split off.

USING SPEAKERPHONE MODE

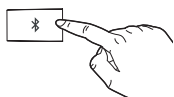

ACCEPT CALL



IGNORE CALL

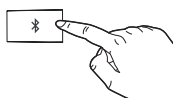

**PLACE EXISTING
CALL ON HOLD,
ACCEPT NEW CALL**



END CALL

The speaker must be ON and paired to a Bluetooth device for speakerphone mode. When a call is received, any playing audio is interrupted for the duration of the call.

- Press and release the **Bluetooth Button** to accept a call
- Press and release the **Power Button** to ignore a call
- Press and release the **Bluetooth Button** to place an existing call on hold and accept a new call
- Press and release the **Power Button** to end call and return to previous function

Using the Aux-in Mode

1

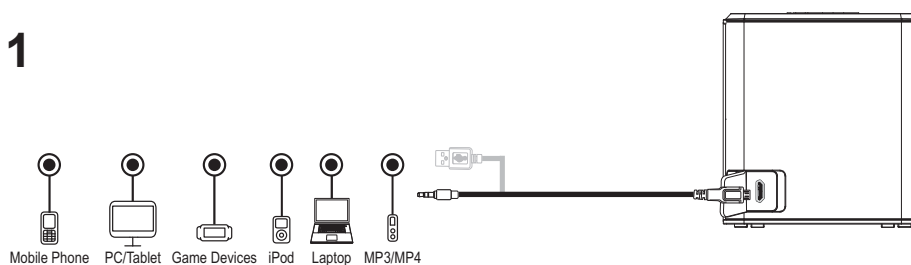

Connect one end of the included micro usb charging/aux audio cable to the Charging/Aux-in jack located on the back of the unit under the rubber cover and connect the 3.5mm audio plug to the headphone or line-out jack of your audio device. Turn on your device and put it in play mode.

2



Press and hold the **Power Button** to turn on the Split. The Status Indicator LED will glow, indicating the unit is powered on. Use track and navigation controls on your device to play audio.

3

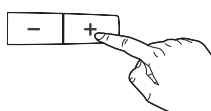

Make sure the volume on your audio device is at least 50% volume for proper audio detection.

Press and release the **+ or - Button** to control the speaker volume (hold for rapid adjustment). The unit will turn off automatically if no audio is detected for **5 minutes**. Otherwise turn off unit using **Power Button**.

Lithium Battery Warning

Each speaker is powered by a rechargeable lithium battery.

- Lithium batteries can explode or cause burns if disassembled, shorted, exposed to water, fire, or high temperatures & not handled appropriately
- Store in cool, dry, ventilated area. Keep away from moisture.
- Follow applicable laws and regulations for transport and disposal.

Troubleshooting

1. The unit does not power ON.

The unit is not connected to AC outlet, the AC outlet has no power, or is controlled by a wall switch that is "OFF". Check AC outlet and wall switch. Battery is too low. Charge battery.

2. Unit shuts "Off" unexpectedly.

AC outlet charging base is connected to is controlled by a wall switch that is turned OFF. Check wall switch. Turn unit on with Power Button. No audio detected for 5 minutes, unit shut off to preserve battery life.

3. Unit doesn't respond (locked up or frozen).

The unit may need to be reset. To do so, unplug the unit from power source if connected. Insert end of paperclip or similar into Reset Port located on bottom of speaker. Reconnect unit to power source. You may need to re-pair your Bluetooth device(s).

IMPORTANT SAFETY INSTRUCTIONS

When used in the directed manner, this unit has been designed and manufactured to ensure your personal safety. However, improper use can result in potential electrical shock or fire hazards. Please read all safety and operating instructions carefully before installation and use, and keep these instructions handy for future reference. Take special note of all warnings listed in these instructions and on the unit.

1. **Water and Moisture** – The unit should not be used near water. For example: near a bathtub, washbowl, kitchen sink, laundry tub, swimming pool or in a wet basement.
2. **Ventilation** – The unit should be situated so that its location or position does not interfere with its proper ventilation. For example, it should not be situated on a bed, sofa, rug or similar surface that may block ventilation openings. Also, it should not be placed in a built-in installation, such as a bookcase or cabinet, which may impede the flow of air through the ventilation openings.
3. **Heat** – The unit should be situated away from heat sources such as radiators, heat registers, stoves or other appliances (including amplifiers) that produce heat.
4. **Power Sources** – The unit should be connected to a power supply only of the type described in the operating instructions or as marked on the appliance.
5. **Power-Cable Protection** – Power supply cables should be routed so that they are not likely to be walked on or pinched by items placed upon or against them. It is always best to have a clear area from where the cable exits the unit to where it is plugged into an AC socket.
6. **Cleaning** – The unit should be cleaned only as recommended. See the Maintenance section of this manual for cleaning instructions.
7. **Objects and Liquid Entry** – Care should be taken so that objects do not fall and liquids are not spilled into any openings or vents located on the product.
8. **Attachments** – Do not use attachments not recommended by the product manufacturer.
9. **Lightning and Power Surge Protection** – Unplug the unit from the wall socket and disconnect the antenna or cable system during a lightning storm or when it is left unattended and unused for long periods of time. This will prevent damage to the product due to lightning and power-line surges.
10. **Overloading** – Do not overload wall sockets, extension cords, or integral convenience receptacles as this can result in a risk of fire or electric shock.
11. **Damage Requiring Service** – The unit should be serviced by qualified service personnel when:
 - A. the power supply cable or plug has been damaged.
 - B. objects have fallen into or liquid has been spilled into the enclosure.
 - C. the unit has been exposed to rain.
 - D. the unit has been dropped or the enclosure damaged.
 - E. the unit exhibits a marked change in performance or does not operate normally.
12. **Antenna** – Do not connect an external antenna to the unit (other than that provided).
13. **Periods of Nonuse** – If the unit is to be left unused for an extended period of time, such as a month or longer, the power cable should be unplugged from the unit to prevent damage or corrosion.
14. **Servicing** – The user should not attempt to service the unit beyond those methods described in the user's operating instructions. Service methods not covered in the operating instructions should be referred to qualified service personnel.

FCC Information

FCC Radiation Exposure Statement

This equipment complies with FCC RF radiation exposure limits set forth for an uncontrolled environment.

iBT11

FCC ID: EMOIBT11
IC: 986B-IBT11

This device complies with Part 15 of the FCC Rules, operation is subject to the following two conditions: (1) This device may not cause harmful interference, and (2) this device must accept any interference received, including interference that may cause undesired operation.

- Warning: Changes or modifications to this unit not expressly approved by the party responsible for compliance could void the user's authority to operate the equipment.
- NOTE: This equipment has been tested and found to comply with the limits for a Class B digital device, pursuant to Part 15 of the FCC Rules. These limits are designed to provide reasonable protection against harmful interference in a residential installation. This equipment generates, uses and can radiate radio frequency energy and, if not installed and used in accordance with the instructions, may cause harmful interference to radio communications. However, there is no guarantee that interference will not occur in a particular installation. If this equipment does cause harmful interference to radio or television reception, which can be determined by turning the equipment off and on, the user is encouraged to try to correct the interference by one or more of the following measures:
 - Reorient or relocate the receiving antenna.
 - Increase the separation between the equipment and receiver.
 - Connect the equipment into an outlet on a circuit different from that to which the receiver is connected.
 - Consult the dealer or an experienced radio/TV technician for help.
- The device has been evaluated to meet general RF exposure requirement. The device can be used in portable exposure condition without restriction.

CAN ICES-3 (B)/NMB-3(B)

IC Statement

This device complies with Industry Canada license-exempt RSS standard(s). Operation is subject to the following two conditions: (1) this device may not cause interference, and (2) this device must accept any interference, including interference that may cause undesired operation of the device.
Le présent appareil est conforme aux CNR d'Industrie Canada applicables aux appareils radio exempts de licence. L'exploitation est autorisée aux deux conditions suivantes : (1) l'appareil ne doit pas produire de brouillage, et (2) l'utilisateur de l'appareil doit accepter tout brouillage radioélectrique subi, même si le brouillage est susceptible d'en compromettre le fonctionnement.

The device meets the exemption from the routine evaluation limits in section 2.5 of RSS 102 and compliance with RSS-102 RF exposure, users can obtain Canadian information on RF exposure and compliance.

Le dispositif rencontre l'exemption des limites courantes d'évaluation dans la section 2.5 de RSS 102 et la conformité à l'exposition de RSS-102 rf, utilisateurs peut obtenir l'information canadienne sur l'exposition et la conformité de rf.

Limited 1 Year Warranty Information

iHome Products, a division of SDI Technologies Inc. (hereafter referred to as SDI), warrants this product to be free from defects in workmanship and materials, under normal use and conditions, for a period of 1 year (one year) from the date of original purchase. Should this product fail to function in a satisfactory manner, it is best to first return it to the store where it was originally purchased. Should this fail to resolve the matter and service still be required by reason of any defect or malfunction during the warranty period, SDI will repair or, at its discretion, replace this product without charge. This decision is subject to verification of the defect or malfunction upon delivery of this product to the Factory Service Center authorized by Customer Service. If service is required, please call Customer Service at 1-800-288-2792 to obtain a Return Authorization Number and shipping instructions.

Disclaimer of Warranty

NOTE: This warranty is valid only if the product is used for the purpose for which it was designed. It does not cover (i) products which have been damaged by negligence or willful actions, misuse or accident, or which have been modified or repaired by unauthorized persons; (ii) cracked or broken cabinets, or units damaged by excessive heat; (iii) damage to digital media players, CD's or tape cassettes (if applicable); (iv) the cost of shipping this product to the Factory Service Center and its return to the owner. This warranty is valid only in the United States of America and does not extend to owners of the product other than to the original purchaser. In no event will SDI or any of its affiliates, contractors, resellers, their officers, directors, shareholders, members or agents be liable to you or any third party for any consequential or incidental damages, any lost profits, actual, exemplary or punitive damages. (Some states do not allow limitations on implied warranties or exclusion of consequential damages, so these restrictions may not apply to you.) This warranty gives you specific legal rights, and you may also have other rights which vary from state to state.

Your acknowledgment and agreement to fully and completely abide by the above mentioned disclaimer of warranty is contractually binding to you upon your transfer of currency (money order, cashier's check, or credit card) for purchase of your SDI product

© 2015 SDI Technologies, Inc. All rights reserved.
Questions? Visit www.ihome.com
or call 1-800-288-2792 Toll Free