

Model: iBT22A  
IB (English)  
Size: 153mm x 120mm  
Printing color: Black  
Date : July 8, 2013

P1

iHome®



iBT22A  
**Bluetooth Wireless  
Dual Alarm Clock**



instruction manual

# iBT22A

## Introduction

Thank you for purchasing the iHome iBT22A. This product is designed to provide high quality wireless sound for your iPad, iPhone, iPod, computer, PDA or other Bluetooth audio device.

Along with the included Quick Bluetooth Connection Guide this instruction booklet explains the basic operation and care of the unit. Please read them carefully and keep for future reference.

## Maintenance

- Place the unit on a level surface away from sources of direct sunlight or excessive heat.
- Protect your furniture when placing your unit on a natural wood and lacquered finish. A cloth or other protective material should be placed between it and the furniture.
- Clean your unit with a soft cloth moistened only with mild soap and water. Stronger cleaning agents, such as benzene, thinner or similar materials can damage the surface of the unit.

## FCC Information

# iBT22A

FCC ID: EMOIBT22A  
IC: 986B-IBT22A

### FCC Radiation Exposure Statement

This equipment complies with FCC RF radiation exposure limits set forth for an uncontrolled environment. This transmitter must not be co-located or operating in conjunction with any other antenna or transmitter.

This Device complies with RSS-210 of the IC Rules; Operation is subject to the following two conditions:

(1) This device may not cause interference and

(2) This device must accept any interference received, including interference that may cause undesired operation

**This device complies with Part 15 of the FCC Rules, operation is subject to the following two conditions: (1) This device may not cause harmful interference, and (2) this device must accept any interference received, including interference that may cause undesired operation.**

- Warning: Changes or modifications to this unit not expressly approved by the party responsible for compliance could void the user's authority to operate the equipment.
- NOTE: This equipment has been tested and found to comply with the limits for a Class B digital device, pursuant to Part 15 of the FCC Rules.

These limits are designed to provide reasonable protection against harmful interference in a residential installation. This equipment generates, uses and can radiate radio frequency energy and, if not installed and used in accordance with the instructions, may cause harmful interference to radio communications.

However, there is no guarantee that interference will not occur in a particular installation. If this equipment does cause harmful interference to radio or television reception, which can be determined by turning the equipment off and on, the user is encouraged to try to correct the interference by one or more of the following measures:

- Reorient or relocate the receiving antenna.
- Increase the separation between the equipment and receiver.
- Connect the equipment into an outlet on a circuit different from that to which the receiver is connected.
- Consult the dealer or an experienced radio/TV technician for help.

This Class B digital apparatus complies with Canadian ICES-003.

The device meets the exemption from the routine evaluation limits in section 2.5 of RSS 102 and compliance with RSS-102 RF exposure, users can obtain Canadian information on RF exposure and compliance.

Le dispositif rencontre l'exemption des limites courantes d'évaluation dans la section 2.5 de RSS 102 et la conformité à l'exposition de RSS-102 rf, utilisateurs peut obtenir l'information canadienne sur l'exposition et la conformité

## Information FCC

### Déclaration FCC quant à l'exposition à la radiation

Cet équipement est conforme aux limites FCC relatives à l'exposition à la radiation par radiofréquences établies pour les environnements non contrôlés. Cet émetteur ne doit pas être colocalisé ou utilisé en conjonction avec tout autre émetteur ou antenne.

Cet appareil est conforme à la norme RSS-210 des règlements relatifs aux circuits intégrés. Le fonctionnement est sujet aux deux conditions suivantes :

- 1) Cet appareil ne doit pas causer d'interférences; et
- 2) Cet appareil doit accepter toute interférence reçue y compris les interférences qui peuvent occasionner un fonctionnement indésiré.

Cet appareil répond aux exigences du paragraphe 15 de la loi de la Commission Fédérale sur les Communications. L'utilisation de cet appareil doit répondre aux deux conditions suivantes: (1) Cet appareil ne doit pas provoquer d'interférences nuisibles, et (2) cet appareil doit accepter toutes les interférences reçues, y compris les interférences pouvant provoquer un fonctionnement non désiré

- Avertissement : Tout changement ou modification apporté à cet appareil sans le consentement expresse de la partie responsable pour la conformité peut annuler le droit de l'utilisateur d'utiliser cet appareil.
- Remarque : Cet équipement a été testé et jugé conforme aux limitations pour un appareil numérique de Classe B, selon la Section 15 de la réglementation FCC.

Ces limites sont conçues pour fournir une protection raisonnable contre les interférences nuisibles dans une installation résidentielle. Cet équipement génère, utilise et peut émettre des fréquences radio et, s'il n'est pas installé et utilisé selon les instructions, peut causer des interférences nuisibles aux communications radio.

Cependant, il n'existe aucune garantie que des interférences ne se produiront pas dans une installation particulière. Si cet équipement produit des interférences nuisibles sur la réception de la radio ou de la télévision, ce que vous pouvez facilement constater en éteignant et en rallumant l'équipement, nous vous encourageons à prendre l'une ou plusieurs des mesures correctives suivantes :

- Réorienter ou déplacer l'antenne réceptrice,
- Éloigner davantage l'appareil du récepteur.
- Branchez l'équipement sur une prise ou un circuit auquel le récepteur n'est pas branché.
- Consultez votre revendeur ou un technicien radio/télévision qualifié pour plus d'informations.

Cet appareil numérique de la classe B est conforme à la norme NMB-003 du Canada

**QDID:B020340**

# iBT22A

FCC ID: EMOIBT22A

IC: 986B-IBT22A

# iBT22A

## Table of Contents

Included/ Meet Your iBT22A.....	1-2
Installing Clock Backup Batteries .....	3
The Display/ Setting Up the Unit/ Turning the Unit ON and OFF.....	4
Setting the Time/ Daylight Saving Time .....	5
Setting the Alarms/ Reviewing, Arming and Disarming Alarms .....	6
Resetting the Alarm to Come on the Next Day .....	6
Snooze Operation/ Sure Alarm .....	7
Using Bluetooth: Pairing Your Device .....	8
Pairing with a Different Device/ Playing Audio Via Bluetooth .....	9
Playing Audio via Aux In.....	10
Sleep Operation/ Dimmer Operation/ USB Charging .....	11
Consumer Product Safety Guide .....	12-13
Troubleshooting .....	14
Warranty.....	15

## Included

- iBT22A Alarm Clock
- 100V-240V universal AC adaptor
- Backrest
- 3 AAA batteries
- 12" patch cord



power adaptor



Patch cord

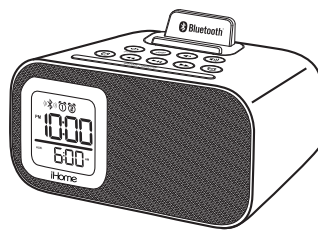

alarm clock



backrest

# iBT22A

## Installing the Backrest

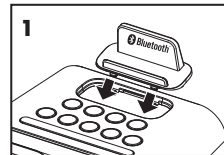

1) Insert the front tabs of the included backrest at a slight angle into the slots on top of the unit (behind the buttons).

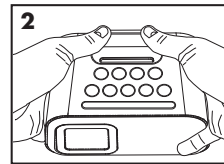

2) Grip the unit in both hands from front to back as shown and squeeze the unit slightly towards you while pressing down firmly on the backrest until it clicks into place.

Once inserted, the backrest is a permanent part of the unit and offers enhanced stability for your devices.

Test your device in the backrest to make sure it is stable. A tablet may not be suitable for use with the backrest.

## Meet Your iBT22A

# iBT22A

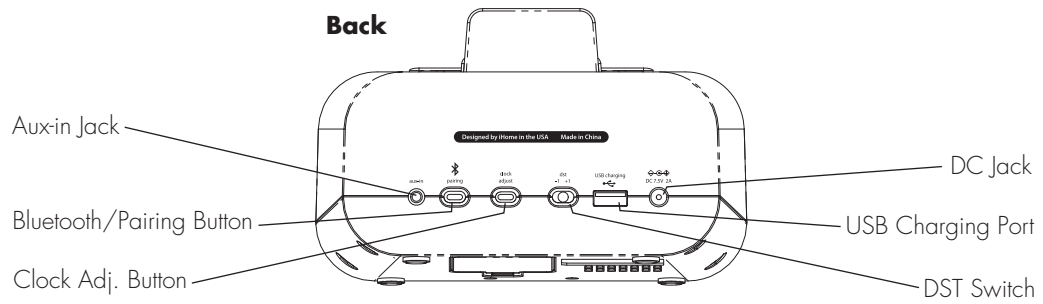
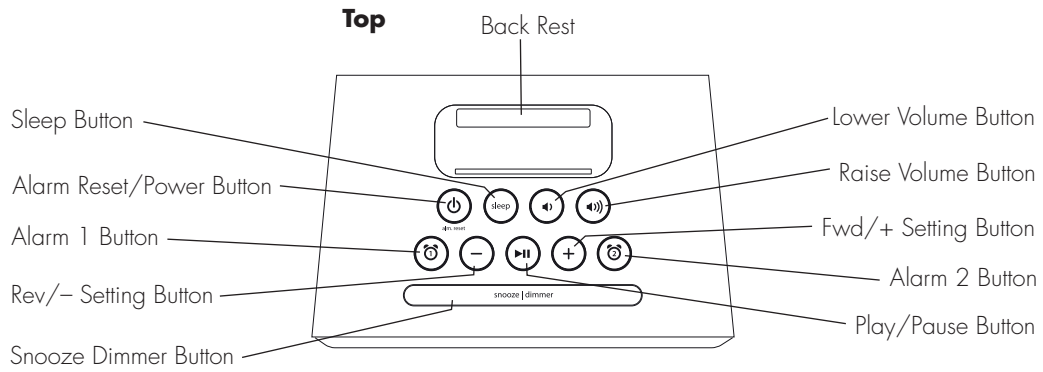

## Replacing & Installing Clock Backup Batteries Using the iBT22A

The iBT22A uses 3 AAA batteries (included) for backup to provide continuous alarm operation and clock settings in the event of a power failure. If the backup batteries have been installed and a power failure occurs or the AC adaptor is accidentally disconnected, the display backlight will not remain lit, but current time and alarm time settings will be temporarily maintained. Otherwise, you must reset the time and alarm settings.

Note: You should replace backup batteries when the Battery Low Indicator appears on the display.

1. Please make sure the AC adaptor is connected. Otherwise all settings may be lost during battery replacement.
2. Open backup battery compartment door located on the bottom of the unit.
3. Insert three "AAA" batteries, checking the + and - ends of the batteries match the diagram inside the compartment. We recommend to use alkaline battery for longer life. Do not mix alkaline, standard (carbon-zinc) or rechargeable (nickel-cadmium) batteries.
4. Close the compartment cover.

Note: Make sure you dispose of batteries properly (see your local regulations).

### **Battery Low Indicator**

The Battery Low Indicator is located at the top left of the display. When it blinks it is time to replace backup batteries.

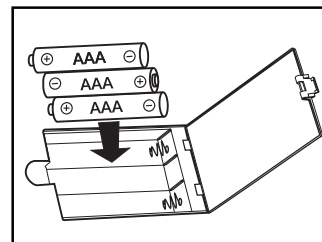



## The Display

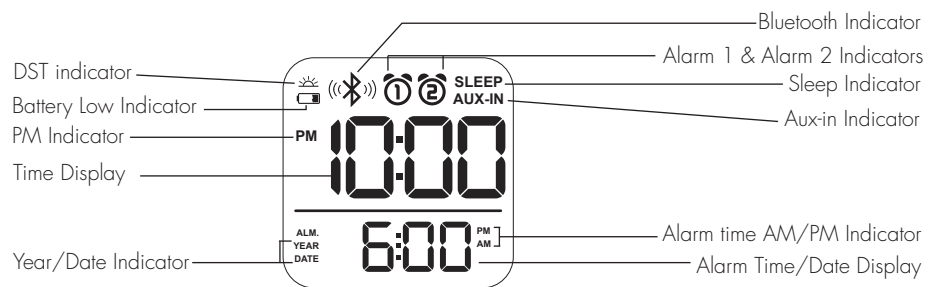

## Using the iBT22A

### Setting Up the Unit

1. Connect the included AC adaptor to the DC jack located on the back of the unit and connect the other end to a working wall outlet.

### Turning the Unit ON and OFF

1. Once the AC adaptor is properly connected, press the **Power Button** located on top of the unit to turn the unit ON. "ON" will appear briefly on the display.
2. Press the **Power Button** to turn the unit OFF. "OFF" will appear briefly on the display.

**NOTE:** The unit has an automatic shut off function: if no audio is detected for 3 minutes, the unit will power off.

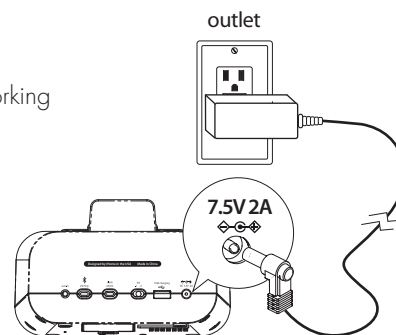

## Setting the Time

## Using the iBT22A

1. Press and hold the **Clock Adjust Button** (located on the back of the unit) until the time flashes in the display and a beep sounds.
2. Press and release the **-** or **+** **Buttons** to adjust the clock to the current time (hold to advance or reverse rapidly). Make sure to set the correct AM/PM time. The PM indicator appears to the left of the time display; there is no AM indicator.
3. Press and release the **Clock Adjust Button**. The year will flash on the display and a beep will sound.
4. Press and release the **-** or **+** **Buttons** until the current year is displayed (hold to advance or reverse rapidly).
5. Press and release the **Clock Adjust Button** again. The date will flash on the display and a beep will sound.
6. Press and release the **-** or **+** **Buttons** until the current date is displayed (hold to advance or reverse rapidly).
7. Press and release the **Clock Adjust Button** again to complete time setting. You will hear 2 beeps to confirm time setting is complete.

**NOTE:** Press the **⌚** or **🕒** **Button** at any time during time setting to toggle between standard 12 hour display and 24 hour ("military") display modes.

## Daylight Saving Time

1. Slide the **DST (Daylight Saving Time) Switch** located on the back of the unit to +1 to add one hour for daylight saving time or slide to -1 to subtract an hour for standard time. The DST icon will appear on the display when switch is set to +1 to indicate daylight saving time.