

Model: iBT28  
Instruction Manual (English)  
Print color : Black text on white paper  
Size of manual: 178mmW x 178mmH  
Date: Nov 5, 2013

Page 1

# iHome®

*Model: **iBT28***  
**Color Changing**  
**Bluetooth Dual Alarm Clock**  
**Speaker System with**  
**USB Charging and FM Radio**



download QR code  
reader app and scan



Questions? Visit [www.ihome.com](http://www.ihome.com)

## Table of Contents

Controls and indicators -----	1
iBT28 Quick Start -----	2
Display / Using Bluetooth -----	3
Setting the Time / Setting the Alarms -----	4
Operating the Alarm / Listening to FM Radio -----	5
Using the Unit in Other Countries / Playing your Aux-in Audio Device / Charging a Device with the USB Port -----	6
Color Change Mode / Dimmer Mode / Bedtime Sleep Mode -----	7
Installing/Replacing the Clock Backup Battery -----	8
A Consumer Guide to Product Safety -----	9
Trouble Shooting -----	10
Warranty Information -----	11

## Maintenance

- Place the unit on a level surface away from sources of direct sunlight or excessive heat.
- Protect your furniture when placing your unit on a natural wood and lacquered finish. A cloth or other protective material should be placed between it and the furniture.
- Clean your unit with a soft cloth moistened only with mild soap and water. Stronger cleaning agents, such as Benzene, thinner or similar materials can damage the surface of the unit.

## Getting Started

Thank you for purchasing the iHome iBT28 Color Changing Bluetooth Dual Alarm Clock FM Radio. This system provides high quality wireless and Aux-in audio performance combined with relaxing colored mood lights. Please read this instruction carefully before operating the unit and keep it for future reference.

## Battery Information

### For models that use Lithium batteries

- Lithium batteries can explode or cause burns if disassembled, shorted, recharged, exposed to water, fire, or high temperatures. & not handled appropriately
- Do not place loose batteries in a pocket, purse, or other container containing metal objects, mix with used or other battery types, or store with hazardous or combustible materials.
- Store in cool, dry, ventilated area.
- Follow applicable laws and regulations for transport and disposal.

## FCC Information

FCC Radiation Exposure Statement

FCC ID: EMOIBT28  
IC: 986B-IBT28

This equipment complies with FCC RF radiation exposure limits set forth for an uncontrolled environment.

This device complies with Part 15 of the FCC Rules, operation is subject to the following two conditions: (1) This device may not cause harmful interference, and (2) this device must accept any interference received, including interference that may cause undesired operation.

- Warning: Changes or modifications to this unit not expressly approved by the party responsible for compliance could void the user's authority to operate the equipment.
- NOTE: This equipment has been tested and found to comply with the limits for a Class B digital device, pursuant to Part 15 of the FCC Rules.

These limits are designed to provide reasonable protection against harmful interference in a residential installation. This equipment generates, uses and can radiate radio frequency energy and, if not installed and used in accordance with the instructions, may cause harmful interference to radio communications.

However, there is no guarantee that interference will not occur in a particular installation. If this equipment does cause harmful interference to radio or television reception, which can be determined by turning the equipment off and on, the user is encouraged to try to correct the interference by one or more of the following measures:

- Reorient or relocate the receiving antenna.
- Increase the separation between the equipment and receiver.
- Connect the equipment into an outlet on a circuit different from that to which the receiver is connected.
- Consult the dealer or an experienced radio/TV technician for help.

CAN ICES-3 (B)/NMB-3(B)

IC Statement

This device complies with Industry Canada licence-exempt RSS standard(s). Operation is subject to the following two conditions: (1) this device may not cause interference, and (2) this device must accept any interference, including interference that may cause undesired operation of the device.

Le présent appareil est conforme aux CNR d'Industrie Canada applicables aux appareils radio exempts de licence.

L'exploitation est autorisée aux deux conditions suivantes : (1) l'appareil ne doit pas produire de brouillage, et (2) l'utilisateur de l'appareil doit accepter tout brouillage radioélectrique subi, même si le brouillage est susceptible d'en compromettre le fonctionnement.

The device meets the exemption from the routine evaluation limits in section 2.5 of RSS 102 and compliance with RSS-102 RF exposure, users can obtain Canadian information on RF exposure and compliance.

Le dispositif rencontre l'exemption des limites courantes d'évaluation dans la section 2.5 de RSS 102 et la conformité à l'exposition de RSS-102 rf, utilisateurs peut obtenir l'information canadienne sur l'exposition et la conformité de rf.

QDID:XXXXXXX

## Controls and Indicators

### Top panel

**Pairing/Mode Button**  
Press and hold to pair Bluetooth devices  
Press to toggle between Bluetooth, FM radio and Aux-in modes

**Power/Alarm Reset Button**  
Press to turn unit ON or OFF, reset alarm when sounding

**Time Set/Sleep Button**  
Press for sleep timer  
Press and hold for time setting

**Reverse/Minus Settings Button**  
Press to lower selected setting

**Forward/ Plus Settings Button**  
Press to raise selected setting

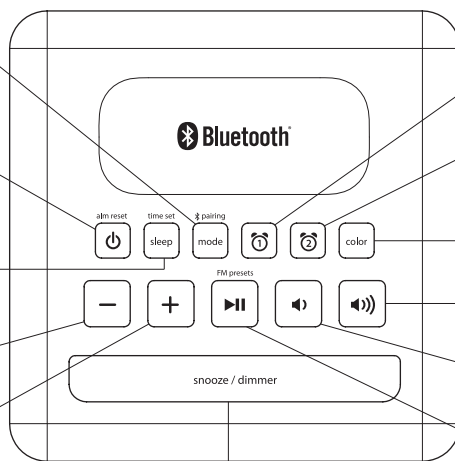

**Alarm 1 Button**  
Set and arm/disarm Alarm 1

**Alarm 2 Button**  
Set and arm/disarm Alarm 2

**Color Button**  
Press to cycle color settings

**Raise Volume Button**  
Raise volume

**Lower Volume Button**  
Lower volume

**Play/Pause and Presets Button**  
Press to play or pause connected Bluetooth devices, in FM mode set and select FM radio presets

**Snooze/Dimmer Button**  
Press to silence alarm for selected time  
Press to adjust brightness during standard operation (not during alarm mode)

### Back panel

**USB charging port**  
Plug in USB cable to charge device

**Backup Battery Compartment**  
Access backup battery

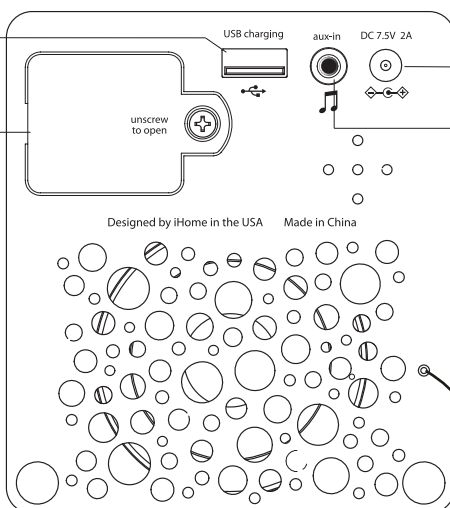

**DC Adapter Jack**  
Plug in AC adaptor cable and connect to outlet

**Aux-in jack**  
Connect an audio device via standard audio cable to headphone jack

**FM radio antenna**  
Extend antenna for best reception (do not strip, alter or attach to other antennas)

# iBT28 Quick Start

## 1: power

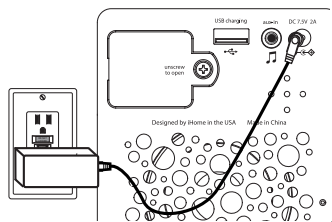

Attach AC adaptor cable to the DC adapter jack on back of the iBT28 and plug the other end into a wall socket to play aux device or radio. Remove the tab from the battery backup compartment.

## 2: Bluetooth pairing: first time use

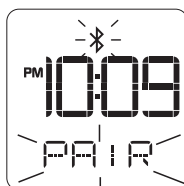

If you experience any trouble pairing your device, see the Using Bluetooth section of this booklet on page 3.

Power on your Bluetooth audio device and turn on Bluetooth capability on your device (Settings>Bluetooth on IOS). Press the **Power Button** on the unit to turn the unit on. The first time the unit is powered on, it will enter Auto-pairing mode and attempt to pair with an available Bluetooth device. "iHome iBT28" should appear on your device's list of Bluetooth devices. Select "iHome iBT28" on the device to complete pairing. "PAIRED" should appear on the display and 2 beeps will confirm pairing is complete. Press the **Play/Pause Button** to play or pause audio.

## 3: time set

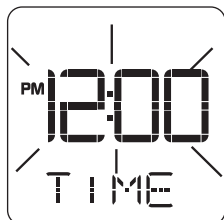

Press and hold the **Time Set/Sleep Button** until the display flashes.

Press **-** or **+** **Button** to set correct time (hold for rapid adjustment). Make sure to set correct AM or PM time.

Press the **Time Set/Sleep Button** again, then press **-** or **+** **Button** to set the correct year.

Press the **Time Set/Sleep Button** again, then press **-** or **+** **Button** to set the correct date.

Press the **Time Set/Sleep Button** again to complete time setting. 2 beeps will confirm time setting is done.

## 4: color change

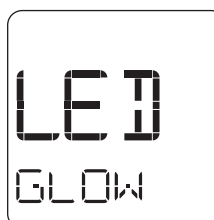

Press and release the **Color Button** as needed to cycle through color mode settings. In *GLow* color change mode, press and release the **Color Button** when a specific color is showing to select that color.

When the unit is OFF and in one color mode, press the **-** or **+** **Button** to change color.

## Display

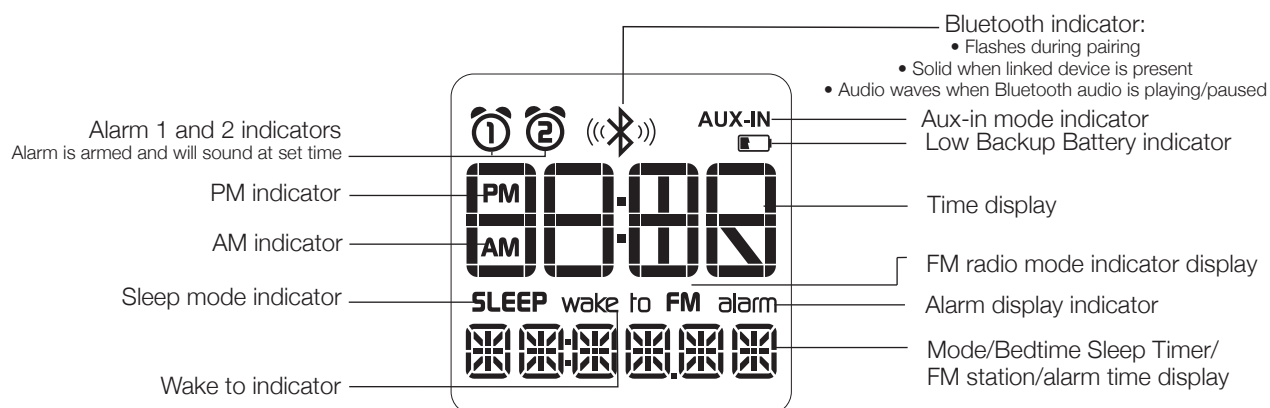

## Using Bluetooth

### Pairing

This unit features an *auto-pair* feature: when powered on for the first time (OR following a reset), the unit will automatically attempt to pair with a new Bluetooth device. After this, Bluetooth devices must be paired using the Pairing/Mode Button.

1. Power on your Bluetooth audio device and turn on Bluetooth capability on your device (check the instructions that came with your device for details)
2. Press and release the **Power Button** located on top of the unit to turn the unit ON. The first time the unit is powered on, the unit will automatically enter pairing mode. Otherwise, *press and hold* the **Pairing/ Mode Button** for 2 seconds to begin pairing. Pairing mode is indicated by the Bluetooth icon and "PAIR" flashing on the display. "iHome iBT28" should appear on your device's list of Bluetooth devices. If "Not Paired", "Not Connected" or similar message appears, or if prompted to confirm that you wish to pair/connect, tap on "iHome iBT28" to confirm/ complete pairing.
3. If pairing is successful, 2 beeps will sound and "PAIRED" will appear on the display. If "FAILED" appears, attempt pairing again by pressing and holding the **Pairing/ Mode Button** for 2 seconds. Once paired, your device will auto-link to the unit whenever you are within range (30 feet).

### Playing Bluetooth Audio

1. Once paired with the unit, you can stream audio to it from our Bluetooth device. Press the **FM presets ►| Button** located on top of the unit to turn the unit ON and begin play. Audio wave icons will appear by the Bluetooth icon to indicate Bluetooth audio mode. Press again to pause play, and again to resume play. **Note:** If unit is ON and in FM radio mode, press and release the **Pairing/ Mode Button** as needed to cycle to Bluetooth mode before pressing the **FM presets ►| Button**.
2. Press the **+ or - Button** to control track selection (press and hold to scan forward or backward within tracks).
3. Press the **◀ or ▶ Button** on the unit to adjust the system volume.

### Resetting Bluetooth Audio

To reset Bluetooth settings (clear all currently paired/linked devices), *press and hold* the **Pairing/ Mode Button** for 10 seconds. 2 beeps will confirm Bluetooth reset.

## Setting the Time

1. *Press and hold* the **Time Set/Sleep Button**. The time will flash and a beep will sound. Press the **-** or **+** **Button** to set the correct time (press and hold for rapid setting). Remember to set the correct AM or PM time. The AM and PM Indicators are located to the left of the time digits.
2. Press either the **11** or **12** **Button** at any time during clock setting to toggle the display between 24 hour (military) and 12 hour (standard) display mode. The AM/PM indicators will not appear when display is in 24 hour mode.
3. Press the **Time Set/Sleep Button** again. The year will flash. Press the **-** or **+** **Button** to set the correct year.
4. Press the **Time Set/Sleep Button** again. The date will flash. Press the **-** or **+** **Button** to set the correct date (press and hold for rapid setting).
5. Press the **Time Set/Sleep Button** again (or no button press within 10 seconds) to exit the clock setting mode. 2 beeps will confirm clock setting is complete.

### Setting 12 or 24 Hour Time Display

1. *Press and hold* the **Time Set/Sleep Button**. The time will flash and a beep will sound.
2. Press either the **11** or **12** **Button** to toggle the display between 24 hour (military) and 12 hour (standard) display mode. The AM/PM indicators will not appear when display is in 24 hour mode.
3. Allow unit to "time out" (no button pressed within 10 seconds) to exit the clock display/time setting mode.

## Setting the Alarms

This unit has a dual alarm system so you can set two separate alarms to different alarm times and sources.

### Setting the Alarms

Note: Alarm 1 and Alarm 2 are set the same way; **Alarm Button** below means the button ( **11** or **12** ) for whichever alarm you are setting.

1. Press and hold the **11** or **12** **Button** until the alarm time flashes on the lower part of the display and a beep sounds. Press and release the **-** or **+** **Button** to set the alarm time (press and hold for faster setting). Remember to set the correct AM or PM time.
2. Press and release the **Alarm Button** again to confirm the set alarm time. The wake to icon will flash.
3. Press and release the **Mode Button** as needed to set the alarm wake-to source: Bluetooth (BT), FM radio or Buzzer.
 

**Waking to Bluetooth audio device:** At the set alarm time the unit will send a play command to the currently linked Bluetooth device. If the unit does not detect a linked Bluetooth device at the set alarm time, the unit will default to buzzer alarm. The alarm cycle lasts for one hour; make sure you have enough music on your audio device to last that long.

**Waking to FM radio:** The default wake to source is the current FM radio station. Press and release the **-** or **+** **Button** to set a different station (press and hold to scan to the next clear station). To wake to a preset station, press the **FM presets ►II Button** to cycle to the desired preset (see page 5 for details on setting presets).
4. Press and release the **Alarm Button** again, then press and release the **-** or **+** **Button** to set the color LED wake cycle: DAWN (amber fade leading up to alarm time), FLASH (flashing red while alarm sounds), GLOW (glowing color sequence while alarm sounds) or NONE (no wakeup LED effect).
5. Press and release the **Alarm Button** again (or no button within 10 seconds) to exit the alarm setting mode. 2 beeps will confirm alarm setting is complete. The alarm will be armed once set and the corresponding alarm icon will light up. The lower part of the display will show the earliest set alarm time.

## Operating the Alarm

At the set time, the alarm will sound for 1 hour. If waking to Aux-in, make sure your device is connected to the aux-in audio cable and has an hour of music in it or is set to repeat.

1. To turn off the sounding alarm and reset it to come on at the same time the following day, press and release the **⏻ Button**. The alarm sound will stop but the alarm icon will remain in the display, indicating the alarm is armed. To turn off the alarm without resetting it for the next day, press and release the **Alarm Button**.
2. Press and release the **Alarm Button** during normal operation (alarm is not sounding) as needed to arm the alarm (alarm icon is present) or to cancel it (no alarm icon).
3. Press and release the **Snooze Button** while alarm is sounding to temporarily silence the alarm for the set snooze time (default is 9 minutes). To adjust the snooze time: press and hold the **Snooze Button** during normal operation. The snooze time will flash on the display and 1 beep sounds. Press the **- or + Button** to adjust the snooze time from 1 - 29 minutes. Press and release the **Snooze Button** again (or no button within 10 seconds). Two beeps will sound to confirm snooze setting and return unit to normal operation.

## Listening to FM Radio

### Setting up the Antenna

Extend the FM wire antenna fully for best reception. Do not strip, alter or attach to other antennas.

### Tuning and Playing the Radio

1. Press and release the **radio/aux Button** as needed to cycle through FM radio and Aux-in modes.
2. When FM mode is selected, press the **+ or - Button** to tune the radio to a desired station. The current radio frequency appears in the lower part of the display. Press and hold the **+ or - Button** for a few seconds to scan for the next clear station.
3. **To memorize a station as a preset:**
  - A. Press the **FM presets ►|| Button** as needed to step through the 6 presets (P1 - P6) to the number you wish to assign, and then hold the **FM presets ►|| Button** until the selected preset number begins flashing in the display and 1 beep sounds.
  - B. Press the **+ or - Button** to tune the radio to a desired station. Hold briefly to have the radio autoscan/search for the next clear station.
  - C. Press the **FM presets ►|| Button** to confirm the setting, two confirmation beeps will confirm the setting and the preset number you wish to assign. Repeat steps A-C to preset up to 6 stations.
4. To listen to a preset station, press the **FM presets ►|| Button** to choose the desired preset.
5. Press the **◀ or ▶) Button** on the unit to adjust the system volume.



### Using the Unit in Other Countries

Different regions of the world use different FM radio frequency steps and ranges. You will need to select the one that matches the standards in your region (USA, EUROPE, JAPAN, AUSTRALIA, or CHINA). The default setting is USA; if you live in the US, you may skip this section.

1. Make sure the unit is OFF (not playing in any mode). Press and hold the **+ AND - Button** together for about 5 seconds until "USA" appears in the lower part of the display and 1 beep sounds. Press and release the **+ or - Button** to set to your region.
2. Allow unit to "time out" (no button pressed within 10 seconds) to exit the radio frequency setting mode. Two beeps will confirm radio frequency setting.

### Playing your Aux-in Audio Device

1. Connect a standard stereo audio cable with 3.5mm plug (not included) to the Aux-in jack located on the back of the unit and connect the other end to the headphone jack or aux-out jack on your audio device.
2. Press and release the **⏻ Button** to turn on the unit. Turn on your aux audio device, too.
3. Press and release the **Pairing/ Mode Button** as needed to cycle to Aux-in mode. Aux in will appear on the display.
4. Control audio playback and navigate tracks and menus from your audio device.
5. Press the **◀ or ▶) Button** to adjust the unit volume. You may need to adjust the volume on your device, too.
6. To turn off the unit, press and release the **⏻ Button**. Make sure to turn off your audio device, too.

### Charging a Device with the USB Port

A USB port is located on the back of the unit for charging devices while the unit is connected to AC power.

Connect one end of a compatible USB cable (not included) into the standard USB port on the unit and the other end into the device you wish to charge. Some devices require proprietary USB charging ports or cables. Monitor the charging status of your device. If the device does not charge, you will need to use the charger that came with your device.

## Color Change Mode

Color Change Mode can be accessed whether the unit is ON or OFF. There are 5 color settings. Press the **Color Button** to cycle through them. The settings are:

- GLOW Slow color change (default): Colors slowly fade in and out continually from one color to the next.
- 1 COLOR Select the current color by pressing the **Color Button** when the desired color is showing in Glow mode.
- PULSE Light flashes/changes to the beat of playing music
- FAST Fast color change: colors change quickly from one to another through the color spectrum.
- OFF Turns off cabinet color effect.

TIP: To adjust the brightness of the colors, press the **Snooze/Dimmer Button** (not active in GLOW mode).

## Dimmer Mode

When unit is in normal mode (no alarm is sounding), press the **Snooze/Dimmer Button** to cycle through High, Medium, Low, and Off brightness settings. Settings affect both the display and cabinet LED. Dimmer function will not work during GLOW color change mode. When LED color mode is set to OFF, pressing the **Snooze/Dimmer Button** will place unit in 1 COLOR mode with white backlight. Press the **Color Button** again to turn color mode to OFF.

## Bedtime Sleep Mode

This unit has a Bedtime Sleep feature which gradually lowers the volume of playing audio over a set time then turns the unit off. The unit will also send a pause command to certain devices connected via the aux-in. Test your device to see if it works.

1. Press and release the **Sleep Button** as needed to cycle to the desired sleep setting: 120, 90, 60, 30, 15 minutes or Off (cancels sleep mode).
2. To set sleep volume, press the **⏮** or **⏭** **Buttons**. Sleep volume does not effect normal or alarm volume settings.
3. During sleep mode, press the **Sleep Button** to view the sleep time remaining. Press again to set sleep to the next lowest setting.
4. To cancel sleep mode and turn the unit off, press and release the **⏻** **Button** at any time during sleep mode.

## Installing/Replacing the Clock Backup Battery

**Note: The CR2450 lithium battery is included in the unit. Please pull out the battery pull tab before you use the unit.**

This model is equipped with a battery backup circuit that will maintain the time and alarm time settings in the event of a temporary power interruption. The battery backup circuit will also operate the buzzer alarm to wake you up at the selected wake up time even if the power is out. The battery backup circuit requires one CR2450 lithium battery, included.

When the backup battery is getting weak the Low Backup Battery Indicator will begin flashing in the display. When you see this flashing indicator you should replace the backup battery as soon as possible. Purchase a replacement CR2450 battery, available wherever batteries are sold, and follow steps 1 through 4 below to install the replacement battery.

To replace the backup battery:

**IMPORTANT:** When replacing the backup battery be sure to have the unit connected to the AC outlet to maintain all of your settings, otherwise it will be necessary to reset the time and alarm time after the battery is replaced.

1. Place unit face down. Locate the battery backup compartment found on the back of the unit.
2. Use a Phillips screwdriver to open the battery compartment cover. Remove the cover and remove the exhausted CR2450 battery.
3. Insert a fresh CR2450 battery in the backup battery compartment with the "+" side facing up, as illustrated.
4. Replace the battery compartment cover and screw the compartment door back in place. Do not overtighten. Confirm that the backup battery indicator is not flashing in the display.

Note: Make sure you dispose of battery properly (see your local regulations).

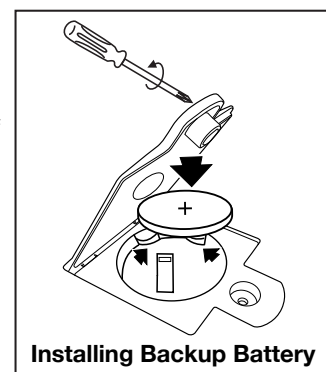

**A Consumer Guide to Product Safety****IMPORTANT SAFETY INSTRUCTIONS**

When used in the directed manner, this unit has been designed and manufactured to ensure your personal safety. However, improper use can result in potential electrical shock or fire hazards. Please read all safety and operating instructions carefully before installation and use, and keep these instructions handy for future reference. Take special note of all warnings listed in these instructions and on the unit.

1. **Water and Moisture** – The unit should not be used near water. For example: near a bathtub, washbowl, kitchen sink, laundry tub, swimming pool or in a wet basement.
2. **Ventilation** – The unit should be situated so that its location or position does not interfere with its proper ventilation. For example, it should not be situated on a bed, sofa, rug or similar surface that may block ventilation openings. Also, it should not be placed in a built-in installation, such as a bookcase or cabinet, which may impede the flow of air through the ventilation openings.
3. **Heat** – The unit should be situated away from heat sources such as radiators, heat registers, stoves or other appliances (including amplifiers) that produce heat.
4. **Power Sources** – The unit should be connected to a power supply only of the type described in the operating instructions or as marked on the appliance.
5. **Power-Cable Protection** – Power supply cables should be routed so that they are not likely to be walked on or pinched by items placed upon or against them. It is always best to have a clear area from where the cable exits the unit to where it is plugged into an AC socket.
6. **Cleaning** – The unit should be cleaned only as recommended. See the Maintenance section of this manual for cleaning instructions.
7. **Objects and Liquid Entry** – Care should be taken so that objects do not fall and liquids are not spilled into any openings or vents located on the product.
8. **Attachments** – Do not use attachments not recommended by the product manufacturer.
9. **Lightning and Power Surge Protection** – Unplug the unit from the wall socket and disconnect the antenna or cable system during a lightning storm or when it is left unattended and unused for long periods of time. This will prevent damage to the product due to lightning and power-line surges.
10. **Overloading** – Do not overload wall sockets, extension cords, or integral convenience receptacles as this can result in a risk of fire or electric shock.
11. **Damage Requiring Service** – The unit should be serviced by qualified service personnel when:
  - A. the power supply cable or plug has been damaged.
  - B. objects have fallen into or liquid has been spilled into the enclosure.
  - C. the unit has been exposed to rain.
  - D. the unit has been dropped or the enclosure damaged.
  - E. the unit exhibits a marked change in performance or does not operate normally.
12. **Antenna** – Do not connect an external antenna to the unit (other than that provided).
13. **Periods of Nonuse** – If the unit is to be left unused for an extended period of time, such as a month or longer, the power cable should be unplugged from the unit to prevent damage or corrosion.
14. **Servicing** – The user should not attempt to service the unit beyond those methods described in the user's operating instructions. Service methods not covered in the operating instructions should be referred to qualified service personnel.

**Questions? Visit [www.ihome.com](http://www.ihome.com)**

## Trouble Shooting

Symptom	Possible Problem	Solution
Unit doesn't respond (no power)	AC adaptor isn't plugged to a wall outlet or the connector is not plugged into the power supply jack on the back of the unit	Make sure the AC adaptor is properly connected to a working wall outlet and to the power supply jack on the unit
	Wall outlet is not functioning	Plug another device into the same outlet to confirm the outlet is working
Playing device but there is no sound	device is not connected properly	Please make sure your device is working properly before connecting it to the unit. Please refer to your manual for details.
	Your device is not playing/device is locked up	Press play button on your device to play it manually. Remove your device from the audio cable and check for any obstruction on the connectors and on your device.
	Volume on unit or device is too low	Adjust the volume settings on your device and on the unit
Device didn't charge up	device is not connected properly	Check all connections to make sure the AC adaptor is properly connected to the unit and to the wall outlet and that the USB cable is the correct fit for your device and is properly connected
	device is locked up/frozen/ battery has a problem	Please make sure your device is working properly before connecting it to the unit. Please refer to your manual for details.
	Device requires a proprietary charging set up	Charge device using the charger that came with it.
Sound is distorted	Volume level is set too high	Decrease the unit volume  If original sound source file is poor quality, distortion and noise are easily noticed with high-power speakers. Try a file from a trusted audio source such as iTunes
	Sound source is distorted	Try reducing the output volume on the device itself. Also, try turning bass boost OFF under settings.
LED color lighting effect is missing/ not working	LED color mode is set to OFF	Press Color Button to cycle to other color LED modes
	Dimmer is set to OFF	Press Snooze/Dimmer Button to cycle to other brightness modes
	Unit is running on backup battery	Make sure the AC adaptor is properly connected to a working wall outlet and to the power supply jack on the unit

## Limited 1 Year Warranty Information

iHome Products, a division of SDI Technologies Inc. (hereafter referred to as SDI), warrants this product to be free from defects in workmanship and materials, under normal use and conditions, for a period of one (1) year from the date of original purchase. Should this product fail to function in a satisfactory manner, it is best to first return it to the store where it was originally purchased. Should this fail to resolve the matter and service still be required by reason of any defect or malfunction during the warranty period, SDI will repair or, at its discretion, replace this product without charge. This decision is subject to verification of the defect or malfunction upon delivery of this product to the Factory Service Center authorized by SDI Customer Service. The product must include proof of purchase, including date of purchase. An out-of-warranty fee for service will be charged for units that are received without proof of purchase.

Before returning this product for service, please first replace the batteries (if applicable) with fresh ones, as exhausted or defective batteries are the most common cause of problems encountered.

If service is still required:

1. Call SDI Customer Service at 1-800-288-2792 for Return Authorization and for the address of the Factory Service Center.
2. Remove the batteries (if applicable) and pack the unit in a well padded, heavy corrugated box. SDI is not responsible for damage that occurs during shipping to the Factory Service Center.
3. Enclose a photocopy of your sales receipt, credit card statement, or other proof of the date of purchase, if within the warranty period. Also include your name and address information, a brief description for why the unit is being returned, and the return authorization number. No unit can be processed without a return authorization number.
4. Write the return authorization number on the side of the shipping package and send the unit prepaid and insured to the Factory Service Center address authorized by SDI Customer Service.

### Disclaimer of Warranty

NOTE: This warranty is valid only if the product is used for the purpose for which it was designed. It does not cover (i) products which have been damaged by negligence or willful actions, misuse or accident, or which have been modified or repaired by unauthorized persons; (ii) cracked or broken cabinets, or units damaged by excessive heat; (iii) damage to digital media players, CD's or tape cassettes (if applicable); (iv) the cost of shipping this product to the Factory Service Center and its return to the owner.

This warranty is valid only in the United States of America and does not extend to owners of the product other than to the original purchaser. In no event will SDI or any of its affiliates, contractors, resellers, their officers, directors,

shareholders, members or agents be liable to you or any third party for any consequential or incidental damages, any lost profits, actual, exemplary or punitive damages. (Some states do not allow limitations on implied warranties or exclusion of consequential damages, so these restrictions may not apply to you.) This warranty gives you specific legal rights, and you may also have other rights which vary from state to state.

Your acknowledgment and agreement to fully and completely abide by the above mentioned disclaimer of warranty is contractually binding to you upon your transfer of currency (money order, cashier's check, or credit card) for purchase of your SDI product.

© 2013 SDI Technologies, Inc. All rights reserved

**Questions? Visit [www.ihome.com](http://www.ihome.com)  
or call 1-800-288-2792 Toll Free**