

# iHome®



iBT37  
***Waterproof  
Rechargeable  
Bluetooth Speaker  
with Speakerphone***

**CHARGE  
BEFORE  
USE**



instruction  
manual

Questions? Contact Customer Service at 1-800-288-2792

# iBT37

## Introduction

Thank you for purchasing the iHome iBT37. This product is designed to provide high quality wireless sound for your iPad, iPhone, iPod, computer, PDA or other Bluetooth audio device.

This instruction booklet explains the basic operation and care of the unit. Please read it carefully and keep for future reference.

## IMPORTANT INFORMATION ABOUT WATERPROOF OPERATION

For proper waterproof operation, make sure the seal on the left side of the unit is completely flush with the unit by pressing along the entire edge of the seal until it is completely and securely in place.

- The unit is IP67 waterproof rated, meaning it is immersible for up to 30 minutes at a depth of 1 meter (3 feet). It will typically withstand rain, snow and being submersed in shallow water. Longer duration or deeper immersion that exceeds the tested limits may cause product failure and void the warranty.
- DO NOT immerse the unit in water for extended periods.
- DO NOT immerse the unit in water deeper than 1 meter (about 3 feet).
- Make sure gasket and surrounding surfaces are completely dry before opening gasket to prevent moisture from damaging the internal electronics.
- Keep rubber gasket free of dirt, sand, or other objects that can interfere with proper sealing. If for any reason the waterproof gasket is not making a tight waterproof seal water may enter the unit.
- Rinse with tap water after immersion in salt water or swimming pool.
- DO NOT clean unit with oily soaps or use chemicals or solvents. Clean with damp cloth.

## Maintenance

- Place the unit on a level surface away from sources of direct sunlight or excessive heat.
- Protect your furniture when placing your unit on a natural wood and lacquered finish. A cloth or other protective material should be placed between it and the furniture.
- Clean your unit with a soft cloth moistened only with mild soap and water. Stronger cleaning agents, such as thinner or similar materials can damage the surface of the unit. Rinse unit with tap water and wipe dry after submersion in salt water or swimming pool.

## Long-term Storage of Your Product

- Store in a cool, dry place.
- Unit should be charged before storing.
- If stored for a long period of time, unit may be unresponsive until charged for a number of hours (depending on discharge level)
- Do not store for more than a year without charging as this can permanently harm the battery.
- After long term storage, if unit is unresponsive after charging, RESET unit while connected to AC and recharge the unit.

## Internal Rechargeable Lithium-ion Battery

This device uses an internal non-replaceable rechargeable lithium-ion battery that should last the lifetime of the device. If you suspect your battery may be dead, try charging it for an extended period of time and try resetting the unit. If this fails, contact Customer Service at 1-800-288-2792.

### WARNING/DISPOSAL OF UNIT

Do NOT attempt to change the battery. Doing so will void the warranty and could cause injury and damage to your device. To dispose of the unit, follow the instructions below:

- Never dispose of used batteries/electronics with ordinary solid wastes, since they contain toxic substances.
- Always dispose of used batteries/electronics in accordance with the prevailing community regulations.
- Many electronics retailers now recycle batteries and other electronic components at no charge.

### GENERAL BATTERY PRECAUTIONS

- Never use or charge a battery if it appears to be leaking, discolored, deformed, or in any way abnormal.
- Never disassemble the unit or attempt to remove battery as that could cause leakage of alkaline solution or other electrolytic substances.
- Avoid charging a rechargeable battery when the temperature is not within 5°C - 35° C (41° - 95° Fahrenheit).
- Never expose a battery to any liquid.
- Never expose a battery to excessive heat such as direct sunlight or fire. Never use a battery pack in an unventilated vehicle where excessive internal temperatures may be encountered.
- Always keep batteries out of the reach of infants and small children.

## Table of Contents

Included/ Meet Your iBT37/Status indicators .....	1-4
Getting Started: Charging the unit .....	5
Using Bluetooth: Pairing Your Device .....	6
Pairing with a Different Device/ Playing Audio Via Bluetooth .....	7
Speakerphone Operation .....	8
Consumer Product Safety Guide .....	9-10
FCC Information.....	11
Troubleshooting.....	12
Warranty.....	13

# iBT37

## Included

- iBT37 speaker
- micro USB charging cable
- carrying strap

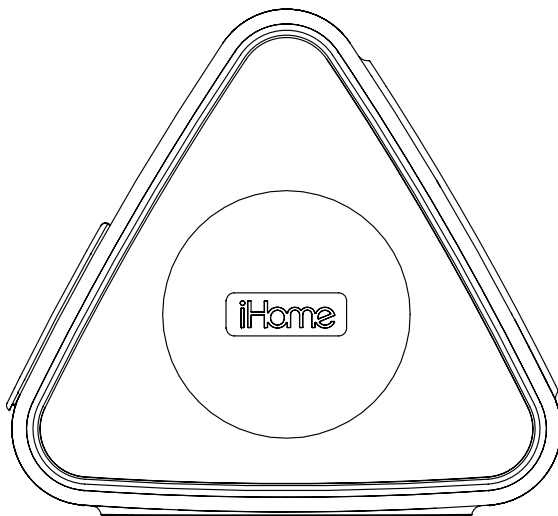

iBT37 speaker



micro USB  
charging cable

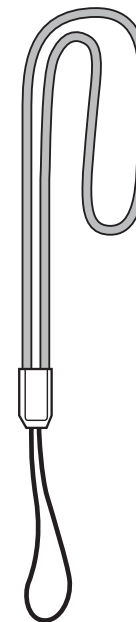

carrying strap

# Meet Your iBT37

# iBT37

## Right Side

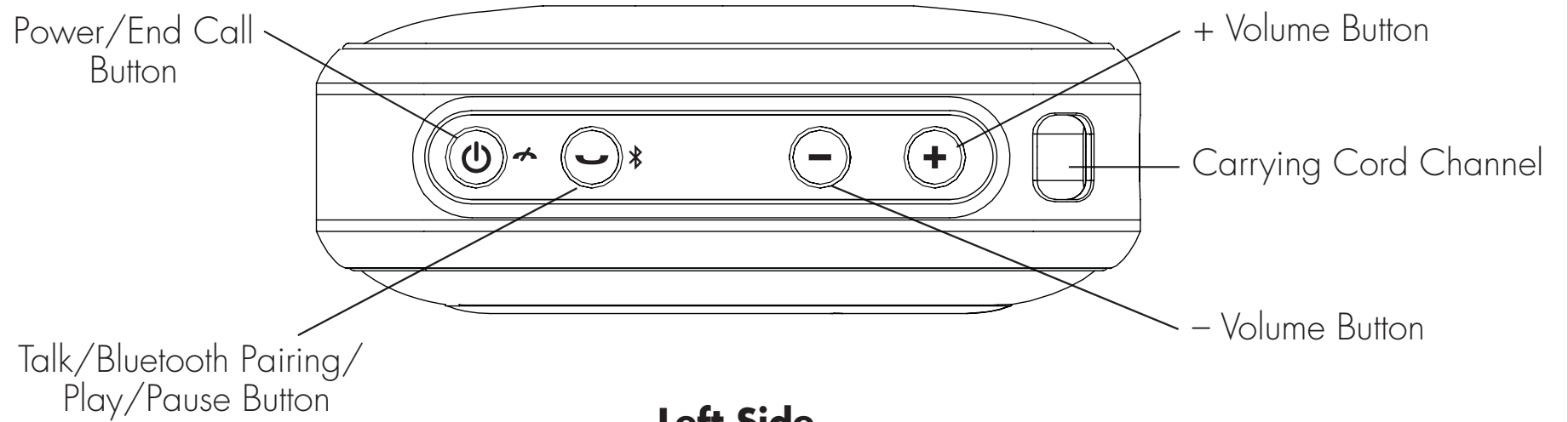

## Left Side

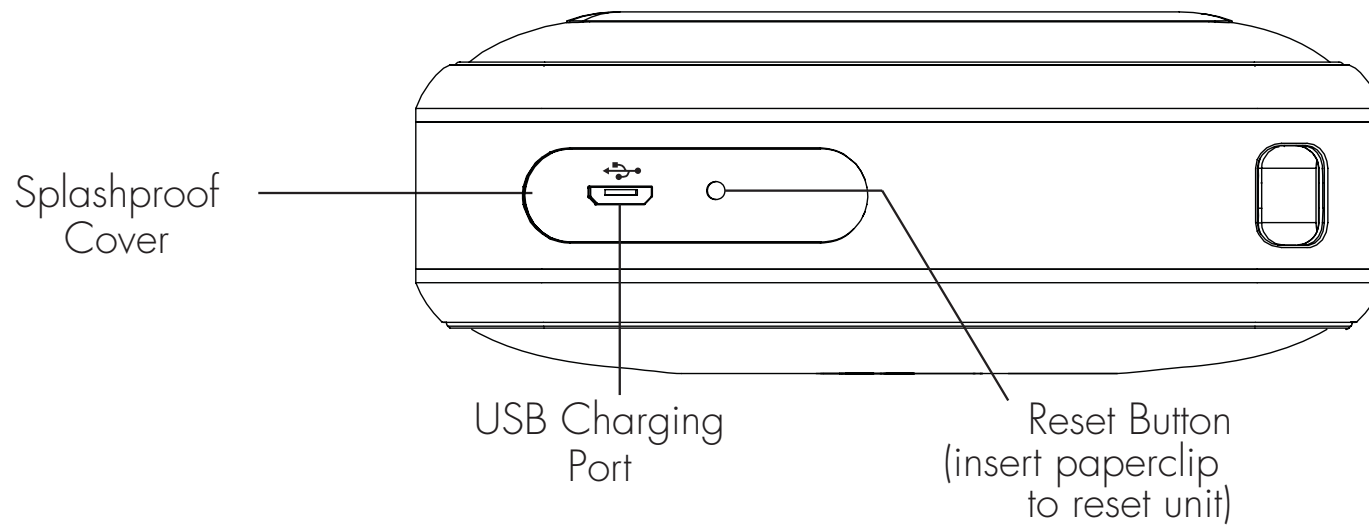

*TIP:* On some iOS (Apple) devices, you can view the iBT37 battery status on your device's screen. When device is paired and connected, look for a vertical battery icon next to the Bluetooth icon on the upper right corner of the device's screen.

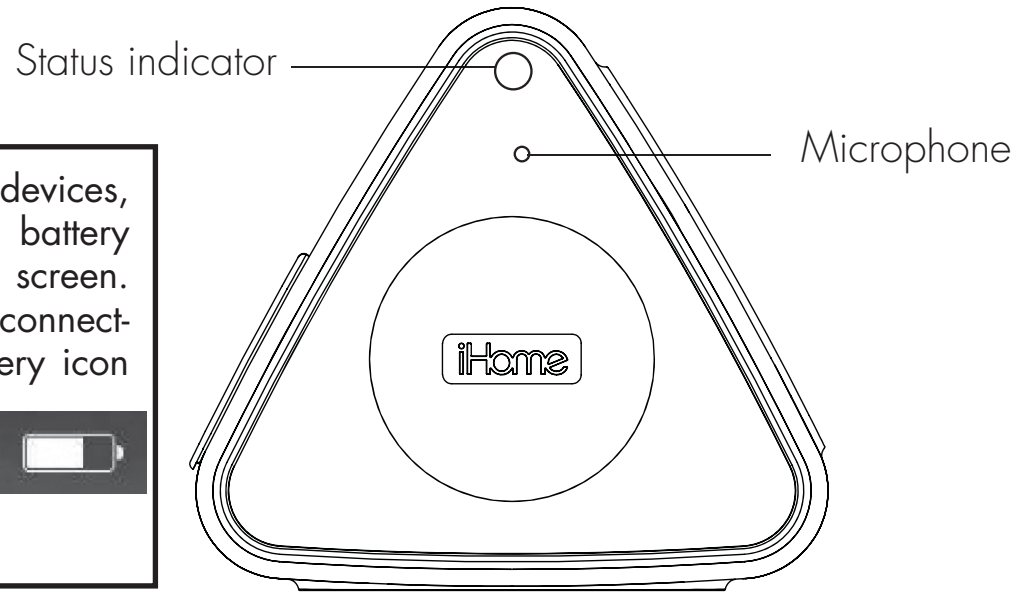

Status indicator	Status
Solid red LED	Unit is charging
Flashing red LED*	Unit needs charging
Solid blue LED	Active Bluetooth connection
Quickly flashing blue LED (while charging would be red LED)	Unit is attempting to pair with Bluetooth device
Slowly flashing blue LED (while charging would be red LED)	Unit is attempting to auto link to already paired Bluetooth device

\*Flashes red 10x every minute

# Using the iBT37

## **Bottom**

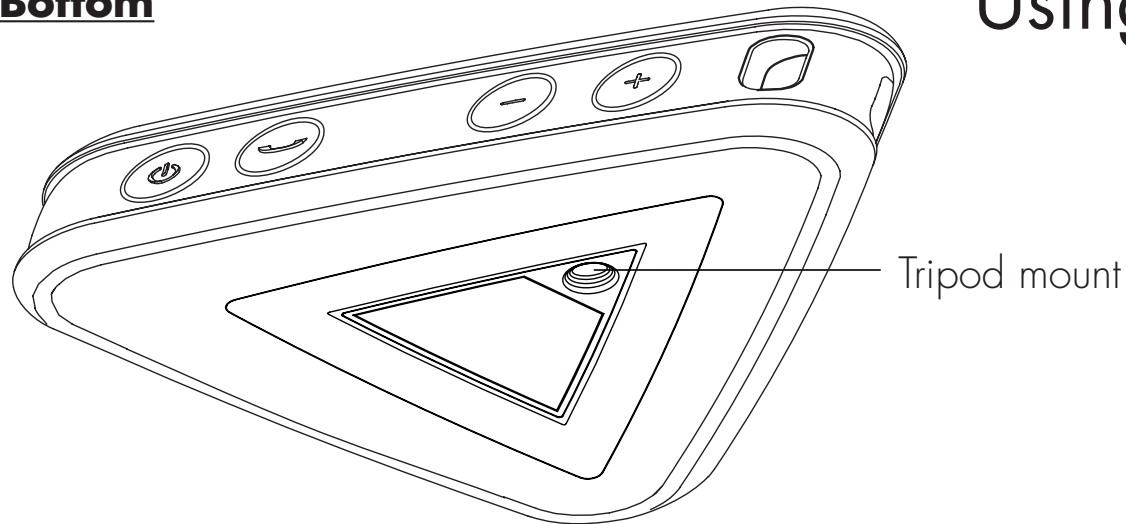

The threaded tripod mount on the bottom of the iBT37 allows you to mount the unit to a bicycle mount (not included, visit [www.ihome.com](http://www.ihome.com) to purchase) for sound on the go. To do so, screw unit clockwise onto camera/tripod mount.

**Caution: Remain aware of your surroundings and do not ride bike or operate unit in an unsafe manner.**

## Getting Started: Attaching the Carry Strap

A carrying strap is included with the iBT37 for easy carrying or attaching to a backpack, etc.

To attach the strap, insert the small loop through the loop channel on top of the unit then pull the large loop through the small loop.

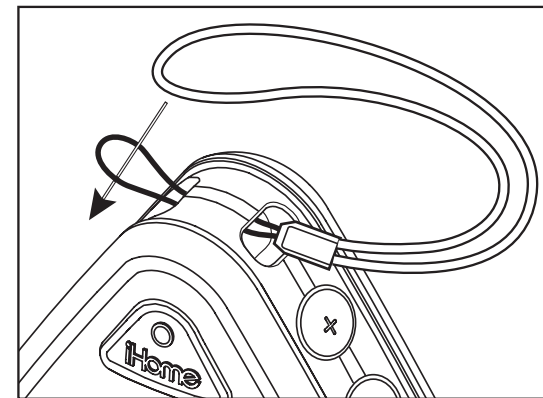



# Using the iBT37

## Getting Started: Charging the Unit

Charge unit before use. For first time charge, charge for at least 8 hours.

Pull back splash-proof seal and connect the included micro USB cable to the USB Charging Port on the left side of the unit and connect the other standard USB plug to a computer, USB AC adaptor (not included) or other USB power source.

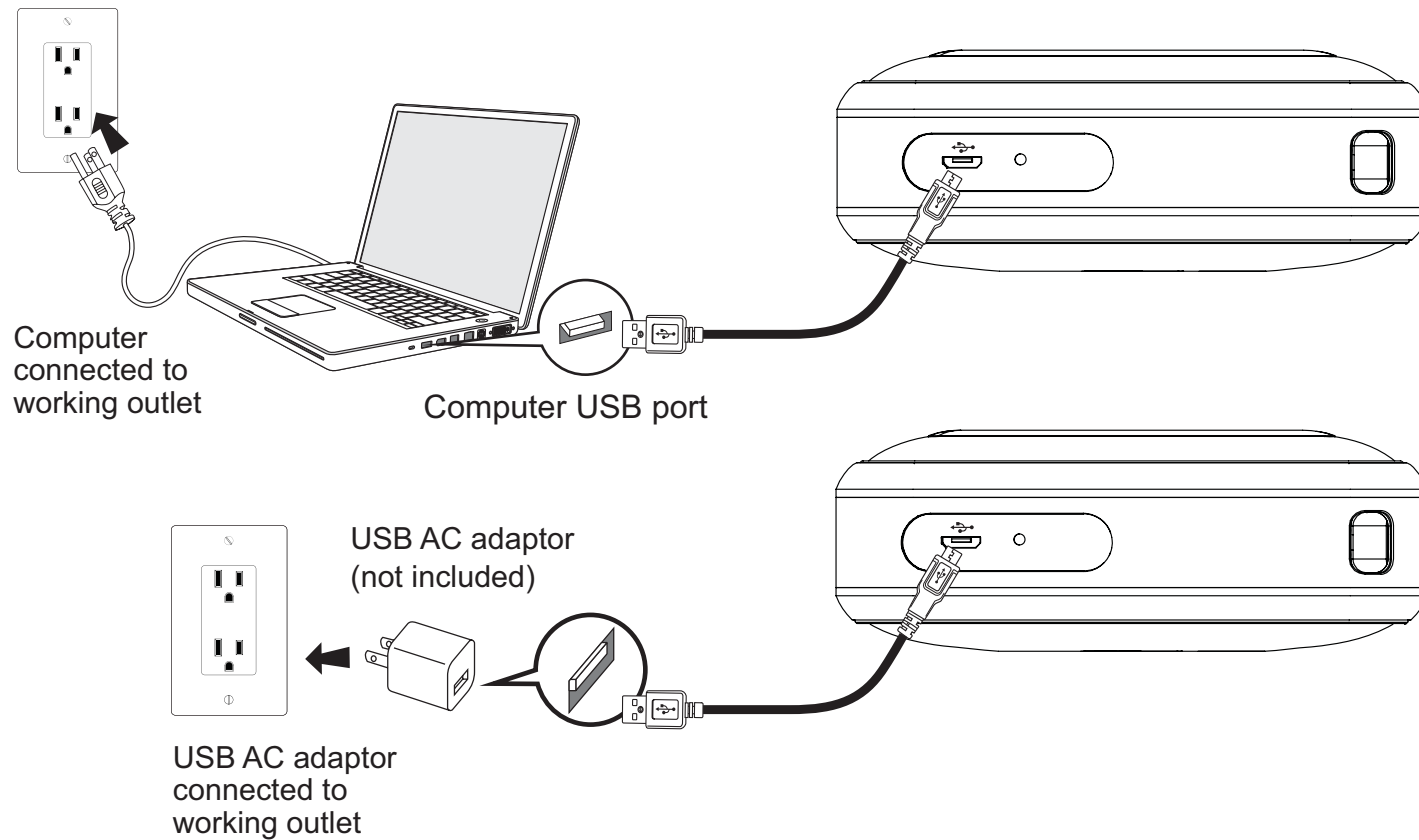

## Pairing Your Device

# Using the iBT37

Pairing is the set-up process to introduce your Bluetooth-capable device to the iBT37. Once your device is paired, the iBT37 can recognize it and you can play your audio through it.



1. Make sure your Bluetooth device is fully charged. Turn on your Bluetooth device and make it "discoverable" by turning on Bluetooth mode (check in Options or Settings).



2. Press the **Power Button** to turn on the iBT37. The first time the unit is powered on, it will enter auto-pairing mode and attempt to connect to a Bluetooth device. Otherwise, follow step 3 to begin pairing.



3. Press and hold the **Talk/Pairing/Play/Pause Button** on the right of the unit for 2 seconds. The unit will beep twice and the status indicator LED will flash blue, indicating the unit is in pairing mode.

4. "iHome iBT37" should appear in your device's Bluetooth menu. If "Not Paired", "Not Connected" or similar message appears, select "iHome iBT37" to connect it. If prompted for a passcode, enter "1234" on your device's keypad.

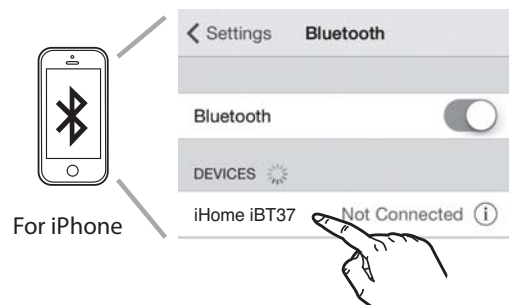

For iPhone

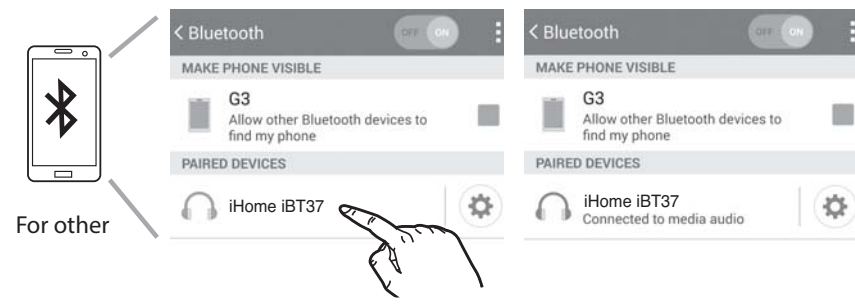
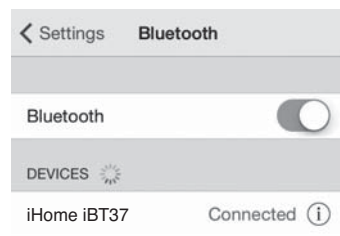

For other



5. If pairing is successful, a tone will sound and the Bluetooth indicator light will glow solid, indicating the iBT37 is ready to play music. There should also be an indication on your device. If no device is successfully paired within 3 minutes the iBT37 will default to previous mode. Once the iBT37 is paired to a device, it will attempt to autolink when the device is within range (about 30 feet).

# Using the iBT37

## Pairing with a Different Device

When you power ON the speaker, it will automatically link with the previously paired Bluetooth device as long as that device is still within range (approx. 30 feet). To pair with a different device follow steps 1 - 4 under "Pairing Your Device" on previous page.





## Playing Audio Via Bluetooth

1. Press the  **Power Button** to turn on the unit. The status indicator will glow solid blue when a linked device is in range and detected. You can then listen to audio streamed wirelessly from your paired iPad, iPhone, iPod or other Bluetooth device.
2. Press the \* **Talk/Pairing/Play/Pause Button** to play audio from your device. Press again to pause play and once more to resume play. When Bluetooth audio is active, the status indicator will glow solid blue.
3. Use menu and track controls on your Bluetooth device to navigate tracks.
4. Press the **-** or **+** **Button** to adjust the iBT37 volume. A confirmation tone will sound when minimum or maximum volume is reached. You can also adjust volume on your device.
5. When done listening, press the  **Power Button** to turn the unit OFF. Remember to turn off your device, too.

# Using the iBT37

## Speakerphone Operation

NOTE: The unit must be powered on and linked to a Bluetooth phone to receive a call.

1. When a call is received, playing music is muted to hear the ring tone. Press the  **Talk/Bluetooth/Play/Pause Button** to answer the call, or press the  **Power/End Call Button** to ignore it. For call waiting function, press the  **Talk/Bluetooth/Play/Pause Button** to switch between calls and the  **Power/End Call Button** to end a call.
2. When a call is completed, press the  **Power/End Call Button** to end the call and resume previous function.

## IMPORTANT SAFETY INSTRUCTIONS

When used in the directed manner, this unit has been designed and manufactured to ensure your personal safety. However, improper use can result in potential electrical shock or fire hazards. Please read all safety and operating instructions carefully before installation and use, and keep these instructions handy for future reference. Take special note of all warnings listed in these instructions and on the unit.

1. **Water and Moisture** – This unit is rated IPX67 (will withstand submersion in 3 feet of water for up to 30 minutes), but should not be operated in or under water.
  - Waterproof cover must be properly sealed before use near water.
  - Dry unit completely before opening waterproof cover.
  - Do NOT open cover if wet or in a wet environment.
2. **Ventilation** – The unit should be situated so that its location or position does not interfere with its proper ventilation. For example, it should not be situated on a bed, sofa, rug or similar surface that may block ventilation openings. Also, it should not be placed in a built-in installation, such as a bookcase or cabinet, which may impede the flow of air through the ventilation openings.
3. **Heat** – The unit should be situated away from heat sources such as radiators, heat registers, stoves or other appliances (including amplifiers) that produce heat.
4. **Power Sources** – The unit should be connected to a power supply only of the type described in the operating instructions or as marked on the appliance.
5. **Power-Cable Protection** – Power supply cables should be routed so that they are not likely to be walked on or pinched by items placed upon or against them.
6. **Cleaning** – The unit should only be cleaned using a warm damp cloth. Do not use solvents, etc.

7. **Objects and Liquid Entry** – Care should be taken so that objects do not fall and liquids are not spilled into any openings or vents located on the product. Keep waterproof cover free of dirt, sand, or objects that could interfere with a proper seal.
8. **Attachments** – Do not use attachments not recommended by the product manufacturer.
9. **Lightning and Power Surge Protection** – Unplug the unit from the wall socket and disconnect the antenna or cable system during a lightning storm or when it is left unattended and unused for long periods of time. This will prevent damage to the product due to lightning and power-line surges.
10. **Overloading** – Do not overload wall sockets, extension cords, or integral convenience receptacles as this can result in a risk of fire or electric shock.
11. **Damage Requiring Service** – The unit should be serviced by qualified service personnel when:
  - A. the power supply cable or plug has been damaged.
  - B. objects have fallen into or liquid has been spilled into the enclosure.
  - C. the unit has been exposed to rain.
  - D. the unit has been dropped or the enclosure damaged.
  - E. the unit exhibits a marked change in performance or does not operate normally.
12. **Periods of Nonuse** – If the unit is to be left unused for an extended period of time, such as a month or longer, make sure to charge the unit before storing and periodically during storage to maintain battery.
13. **Servicing** – The user should not attempt to service the unit beyond those methods described in the user's operating instructions. Service methods not covered in the operating instructions should be referred to qualified service personnel.

Questions? Visit [www.ihome.com](http://www.ihome.com)  
or call 1-800-288-2792 Toll Free

# iBT37

FCC ID: EMOIBT37

IC: 986B-IBT37

## FCC/IC Information

### FCC Radiation Exposure Statement

This equipment complies with FCC RF radiation exposure limits set forth for an uncontrolled environment. This transmitter must not be co-located or operating in conjunction with any other antenna or transmitter.

This device complies with Industry Canada licence-exempt RSS standard(s). Operation is subject to the following two conditions:

- (1) This device may not cause interference, and
- (2) This device must accept any interference, including interference that may cause undesired operation of the device.

**This device complies with Part 15 of the FCC Rules, operation is subject to the following two conditions:**

- (1) This device may not cause harmful interference, and**
- (2) this device must accept any interference received, including interference that may cause undesired operation.**

- Warning: Changes or modifications to this unit not expressly approved by the party responsible for compliance could void the user's authority to operate the equipment.
- NOTE: This equipment has been tested and found to comply with the limits for a Class B digital device, pursuant to Part 15 of the FCC Rules.

These limits are designed to provide reasonable protection against harmful interference in a residential installation. This equipment generates, uses and can radiate radio frequency energy and, if not installed and used in accordance with the instructions, may cause harmful interference to radio communications.

However, there is no guarantee that interference will not occur in a particular installation. If this equipment does cause harmful interference to radio or television reception, which can be determined by turning the equipment off and on, the user is encouraged to try to correct the interference by one or more of the following measures:

- Reorient or relocate the receiving antenna.
- Increase the separation between the equipment and receiver.
- Connect the equipment into an outlet on a circuit different from that to which the receiver is connected.
- Consult the dealer or an experienced radio/TV technician for help.

CAN ICES-3 (B)/NMB-3(B)

The device meets the exemption from the routine evaluation limits in section 2.5 of RSS 102 and compliance with RSS-102 RF exposure, users can obtain Canadian information on RF exposure and compliance.

**Le présent appareil est conforme aux CNR d'Industrie Canada applicables aux appareils radio exempts de licence.**

**L'exploitation est autorisée aux deux conditions suivantes :**

**(1) l'appareil ne doit pas produire de brouillage, et**

**(2) l'utilisateur de l'appareil doit accepter tout brouillage radioélectrique subi, même si le brouillage est susceptible d'en compromettre le fonctionnement.**

Le dispositif rencontre l'exemption des limites courantes d'évaluation dans la section 2.5 de RSS 102 et la conformité à l'exposition de RSS-102 rf, utilisateurs peut obtenir l'information canadienne sur l'exposition et la conformité de rf.



# Troubleshooting

## Unit doesn't respond (no power)

- Check that unit is fully charged.
- Make sure your device is properly paired with the iBT37.
- Make sure the **Power** is ON.

## Unit doesn't respond (locked up or frozen)

If the unit does not respond, insert the end of a paperclip or similar into the Reset Button located under the water proof cover to reset the unit.

## Resetting Bluetooth

If Bluetooth function is not operating properly, you may wish to reset Bluetooth. To do so, *press and hold* the **Power Button** for 10 seconds. You will hear a long high tone. You will need to re-pair your paired devices.

## Trouble pairing device/computer with iBT37

Bluetooth implementation varies depending on your device's hardware and operating system. Please see our website for updates on pairing.

- Make sure you have the latest firmware for your device.
- Make sure your device is working properly. Check your device's manual for details on Bluetooth pairing and linking.
- When you power ON the speaker, it will automatically link with the last previously paired Bluetooth device if the device is still within range (approx. 30 feet). To pair with a different device *press and hold* the **Talk/Pairing/Play/Pause Button** for 2-3 seconds.

For further information and to see the latest instructions, visit [www.ihome.com/support](http://www.ihome.com/support)

# Limited 1 Year Warranty

iHome Products, a division of SDI Technologies Inc. (hereafter referred to as SDI), warrants this product to be free from defects in workmanship and materials, under normal use and conditions, for a period of one (1) year from the date of original purchase. Should this product fail to function in a satisfactory manner, it is best to first return it to the store where it was originally purchased. Should this fail to resolve the matter and service still be required by reason of any defect or malfunction during the warranty period, SDI will repair or, at its discretion, replace this product without charge. This decision is subject to verification of the defect or malfunction upon delivery of this product to the Factory Service Center authorized by Customer Service. If service is required, please call Customer Service at 1-800-288-2792 to obtain a Return Authorization Number and shipping instructions.

## Disclaimer of Warranty

NOTE: This warranty is valid only if the product is used for the purpose for which it was designed. It does not cover (i) products which have been damaged by negligence or willful actions, misuse or accident, or which have been modified or repaired by unauthorized persons; (ii) cracked or broken cabinets, or units damaged by excessive heat; (iii) damage to digital media players, CD's or tape cassettes (if applicable); (iv) the cost of shipping this product to the Factory Service Center and its return to the owner. This warranty is valid only in the United States of America and does not extend to owners of the product other than to the original purchaser. In no event will SDI or any of its affiliates, contractors, resellers, their officers, directors, shareholders, members or agents be liable to you or any third party for any consequential or incidental damages, any lost profits, actual, exemplary or punitive damages. (Some states do not allow limitations on implied warranties or exclusion of consequential damages, so these restrictions may not apply to you.) This warranty gives you specific legal rights, and you may also have other rights which vary from state to state. Your acknowledgment and agreement to fully and completely abide by the above mentioned disclaimer of warranty is contractually binding to you upon your transfer of currency (money order, cashier's check, or credit card) for purchase of your SDI product.

© 2015 SDI Technologies, Inc. All rights reserved  
Questions? Visit [www.ihome.com](http://www.ihome.com)  
or call 1-800-288-2792 Toll Free