

## Internal Rechargeable Lithium-ion Battery

This device uses an internal rechargeable lithium-ion battery that should last the lifetime of the device. If you suspect your battery may be dead, try charging it several times. If the battery does not recharge, please contact Customer Service at 1-800-288-2792.

### WARNING/DISPOSAL OF UNIT

Please do NOT attempt to change the battery yourself. Doing so may damage the unit and will void the warranty.

- Never dispose of used batteries/electronics with ordinary solid wastes, since they contain toxic substances.
- Always dispose of used batteries/electronics in accordance with the prevailing community regulations that apply to the disposal of batteries/electronics. If there are no local regulations concerning battery/electronics disposal, please dispose of the device in a waste bin for electronic devices.
- Many electronics retailers now recycle batteries and other electronic components at no charge. Check to see which ones in your area do so.

### CAUTION

The battery used in this device may present a risk of fire, explosion or chemical burn if mistreated

- Never use or charge the battery if it appears to be leaking, discolored, deformed, or in any way abnormal.
- Never disassemble the unit or attempt to remove battery as that could cause leakage of alkaline solution or other electrolytic substance.
- Always confirm that the temperature is 5°C 35° C (41° - 95° Fahrenheit) before you charge the battery.
- Leakage or deterioration of the battery may occur if this warning is not heeded.
- Never expose the battery to any liquid.
- Never expose the battery to excessive heat such as direct sunlight or fire. Never use the battery pack in an unventilated vehicle where excessive internal temperatures may be encountered.
- Always keep the battery out of the reach of infants and small children.

## Troubleshooting

### True Wireless is not working

If True Wireless link fails or does not work, make sure both speakers are within TWS range (16 feet). Make sure both speakers are powered on within 10 seconds. If problem remains, *press and hold* the **Bluetooth Button** and **- Button together for 10 seconds** to reset the TWS connection.

### Unit doesn't respond

- Make sure each speaker is properly charged.
- Make sure charging cables are properly connected to speakers and to working power sources.
- Make sure your device is properly paired to iBT562. You may need to delete iBT562 from your device menu and pair again.
- Make sure each speaker is on.
- If unit does not respond, insert the end of a paperclip or similar into the Reset port on the back of the unit for a few seconds.

**1 Year Limited Warranty. Visit [www.ihome.com/iBT562](http://www.ihome.com/iBT562) for details**

© 2016 SDI Technologies, Inc. All rights reserved  
Questions? Visit [www.ihome.com](http://www.ihome.com)  
or call 1-800-288-2792 Toll Free

## A Consumer Guide to Product Safety

### IMPORTANT SAFETY INSTRUCTIONS

When used in the directed manner, this unit has been designed and manufactured to ensure your personal safety. However, improper use can result in potential electrical shock or fire hazards. Please read all safety and operating instructions carefully before installation and use, and keep these instructions handy for future reference. Take special note of all warnings listed in these instructions and on the unit.

1. **Water and Moisture** – The unit should not be used near water. For example: near a bathtub, washbowl, kitchen sink, laundry tub, swimming pool or in a wet basement.
2. **Ventilation** – The unit should be situated so that its location or position does not interfere with its proper ventilation. For example, it should not be situated on a bed, sofa, rug or similar surface that may block ventilation openings. Also, it should not be placed in a built-in installation, such as a bookcase or cabinet, which may impede the flow of air through the ventilation openings.
3. **Heat** – The unit should be situated away from heat sources such as radiators, heat registers, stoves or other appliances (including amplifiers) that produce heat.
4. **Power Sources** – The unit should be connected to a power supply only of the type described in the operating instructions or as marked on the appliance.
5. **Power-Cable Protection** – Power supply cables should be routed so that they are not likely to be walked on or pinched by items placed upon or against them. It is always best to have a clear area from where the cable exits the unit to where it is plugged into an AC socket.
6. **Cleaning** – The unit should be cleaned only as recommended. See the Maintenance section of this manual for cleaning instructions.
7. **Objects and Liquid Entry** – Care should be taken so that objects do not fall and liquids are not spilled into any openings or vents located on the product.
8. **Attachments** – Do not use attachments not recommended by the product manufacturer.
9. **Lightning and Power Surge Protection** – Unplug the unit from the wall socket and disconnect the antenna or cable system during a lightning storm or when it is left unattended and unused for long periods of time. This will prevent damage to the product due to lightning and power-line surges.
10. **Overloading** – Do not overload wall sockets, extension cords, or integral convenience receptacles as this can result in a risk of fire or electric shock.
11. **Damage Requiring Service** – The unit should be serviced by qualified service personnel when:
  - A. the power supply cable or plug has been damaged.
  - B. objects have fallen into or liquid has been spilled into the enclosure.
  - C. the unit has been exposed to rain.
  - D. the unit has been dropped or the enclosure damaged.
  - E. the unit exhibits a marked change in performance or does not operate normally.
12. **Periods of Nonuse** – If the unit is to be left unused for an extended period of time, such as a month or longer, charge battery fully before storing.
13. **Servicing** – The user should not attempt to service the unit beyond those methods described in the user's operating instructions. Service methods not covered in the operating instructions should be referred to qualified service personnel.

## Maintenance

- Place the unit on a level surface away from sources of direct sunlight or excessive heat.
- Protect your furniture when placing your unit on a natural wood and lacquered finish. A cloth or other protective material should be placed between it and the furniture.
- Clean your unit with a soft cloth moistened only with mild soap and water. Stronger cleaning agents such as thinner or similar materials can damage the surface of the unit.

# iHome

Model: iBT562

**True Wireless Stereo  
Rechargeable  
Bluetooth Speakers  
with Speakerphone**

**CHARGE  
BEFORE  
USE**



Questions? Visit [www.ihome.com](http://www.ihome.com)



**FCC ID: EMOIBT562  
IC: 986B-IBT562**

### FCC Information

#### FCC Radiation Exposure Statement

This equipment complies with FCC RF radiation exposure limits set forth for an uncontrolled environment.

This device complies with Part 15 of the FCC Rules, operation is subject to the following two conditions: (1) This device may not cause harmful interference, and (2) this device must accept any interference received, including interference that may cause undesired operation.

- Warning: Changes or modifications to this unit not expressly approved by the party responsible for compliance could void the user's authority to operate the equipment.
- NOTE: This equipment has been tested and found to comply with the limits for a Class B digital device, pursuant to Part 15 of the FCC Rules.

These limits are designed to provide reasonable protection against harmful interference in a residential installation. This equipment generates, uses and can radiate radio frequency energy and, if not installed and used in accordance with the instructions, may cause harmful interference to radio communications. However, there is no guarantee that interference will not occur in a particular installation. If this equipment does cause harmful interference to radio or television reception, which can be determined by turning the equipment off and on, the user is encouraged to try to correct the interference by one or more of the following measures:

- Reorient or relocate the receiving antenna.
- Increase the separation between the equipment and receiver.
- Connect the equipment into an outlet on a circuit different from that to which the receiver is connected.
- Consult the dealer or an experienced radio/TV technician for help.

CAN ICES-3 (B)/NMB-3(B)

Canada Statement

This device complies with Industry Canada's licence-exempt RSSs. Operation is subject to the following two conditions: (1) This device may not cause interference; and (2) This device must accept any interference, including interference that may cause undesired operation of the device.  
Le présent appareil est conforme aux CNR d'Industrie Canada applicables aux appareils radio exempts de licence. L'exploitation est autorisée aux deux conditions suivantes :  
(1) l'appareil ne doit pas produire de brouillage; (2) l'utilisateur de l'appareil doit accepter tout brouillage radioélectrique subi, même si le brouillage est susceptible d'en compromettre le fonctionnement.

The device meets the exemption from the routine evaluation limits in section 2.5 of RSS 102 and compliance with RSS-102 RF exposure, users can obtain Canadian information on RF exposure and compliance.  
Le dispositif rencontre l'exemption des limites courantes d'évaluation dans la section 2.5 de RSS 102 et la conformité à l'exposition de RSS-102 rf, utilisateurs peut obtenir l'information canadienne sur l'exposition et la conformité de rf.

### IMPORTANT

Read before proceeding

If you have any question regarding the operation or use of this product, please visit [www.ihome.com](http://www.ihome.com) to view answers to frequently asked questions.

To learn more about this and other iHome products, please visit us online at [www.ihome.com](http://www.ihome.com)

# 1 CHARGE EACH SPEAKER BEFORE USE

**Charging Indicator LED**

- Flashing RED = low battery
- Solid RED = charging
- Off = fully charged

2 USB charging cables included

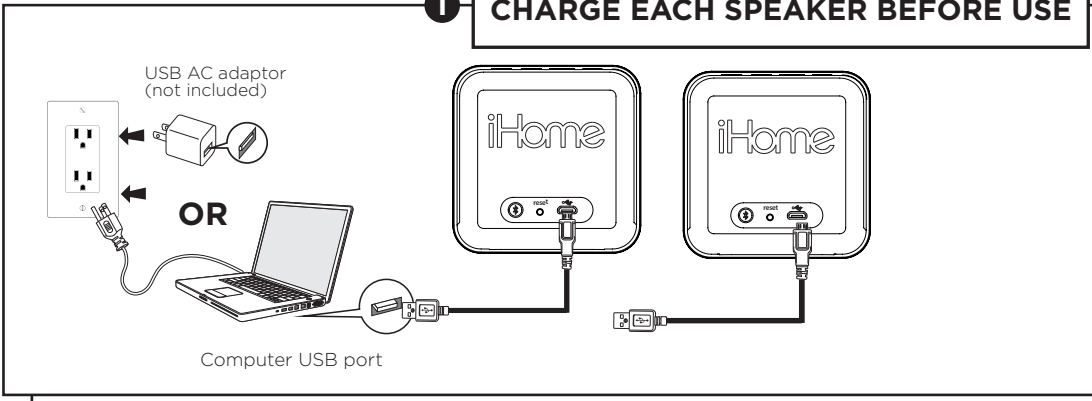
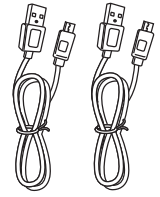

## Charging the iBT562

The iBT562 is powered by a rechargeable battery in each speaker. **MAKE SURE TO CHARGE EACH SPEAKER BEFORE USE**

- Connect a micro-USB plug on one of the included charging cables to the USB Charging Jack on one speaker. Repeat for the remaining speaker.
- Connect each charging cable to a powered USB port, such as that on a computer or USB AC adapter. The computer or USB AC adapter should be connected to a wall outlet when speaker is charging. The Charging LED on each speaker will turn solid red while charging and turn off when fully charged.
- If the LED flashes red, or you notice sound distortion at higher volumes, or there is no sound at all, it's time to recharge the battery.

# 2 GETTING STARTED: TRUE WIRELESS

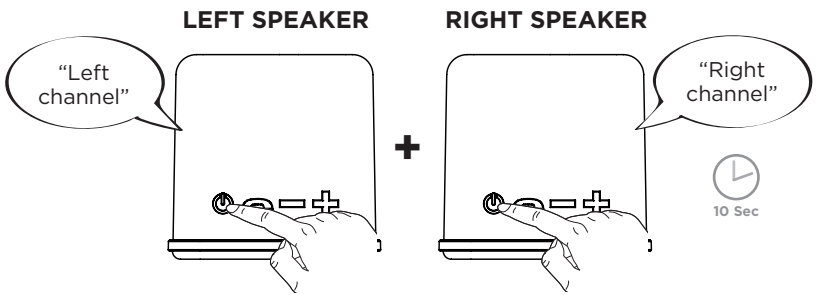

Press the **Power Button** on each speaker within **10 seconds** to establish **True Wireless** link. The GREEN True Wireless indicator on front of each speaker will flash green then turn solid and each speaker will announce a channel identity when the 2 speakers are linked.

The unit will then enter autopairing mode, or search for a previously paired Bluetooth device.

## True Wireless and Bluetooth

Each iBT562 speaker is pre-synced to the other at the factory for True Wireless Stereo (TWS) operation. You just need to turn both speakers on within 10 seconds to establish a TWS link. An audio prompt will identify each channel, and the unit will enter pairing mode.

**Note:** Once speakers are linked, powering off one speaker will also turn the other speaker off.

If speakers are taken out of TWS range (about 16 feet), the link between speakers may fail.

- Once TWS link is established, the Bluetooth indicator will flash blue and pairing tones will sound. Select "iHome iBT562" on the device's Bluetooth menu. If prompted, enter pass code 1234.
- The Bluetooth indicator will glow solid, indicating pairing is successful. You are now ready to stream your audio. Control and navigate tracks on your Bluetooth device. Press the **-/+ Buttons** to control volume. Once the iBT562 is paired it will attempt to autolink when the device is within Bluetooth range (about 33 feet). To reset/clear Bluetooth, press and hold the **Bluetooth Button** for 10 seconds.

**Note:** To save battery power, the unit will power off automatically after 15 minutes with no audio.

**Manual Bluetooth Pairing**  
To pair manually, power on each speaker, then press and hold the **Bluetooth Button** located on the back of the left speaker. Select "iHome iBT562" on the device's Bluetooth menu.

**Pairing with a Single Speaker (Mono Operation)**  
To use a single speaker, just turn one on instead of both. To use both speakers separately, place each outside TWS range (16 feet) then turn on and pair each speaker separately with a different device. When separately paired speakers are returned within TWS range, each will maintain separate pairing unless one is powered off then powered back on, in which case it will attempt TWS linking.

# 3 BLUETOOTH MODE

**Bluetooth Indicator LED**

- Flashing BLUE = pairing
- Solid BLUE = paired

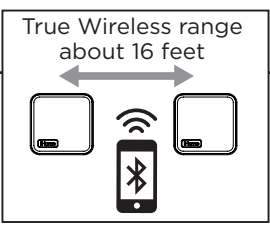

**Adjust Volume**  
(turn up your device first)

## SPEAKERPHONE MODE (Left Speaker only)

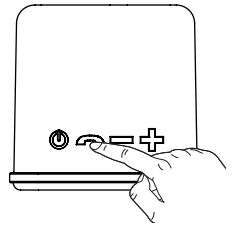

**Press to answer and end calls**  
**Press and hold to ignore calls**

**THE FIRST TIME THE UNIT IS POWERED ON**  
Once the TWS link is established, the speakers enter auto pairing mode, indicated by tones and the Bluetooth indicator flashing BLUE.

Select "iHome iBT562" on your device's Bluetooth menu to complete pairing.

### MANUAL PAIRING/PAIRING SPEAKERS SEPARATELY (MONO)

To pair speakers after first power on or to pair separately



Press **Power Button** to turn speaker(s) ON  
Press and hold **Bluetooth Button** on left speaker  
Select "iHome iBT562"

## Using the iBT562 Speakerphone Mode

The speaker must be on and connected to a paired Bluetooth phone to receive calls. When a call comes in, any playing audio is paused, the Status LED will flash blue 2X and the ringtone associated with the caller may sound, depending on Bluetooth device.

- Press the **Phone Button** to answer or end a call.
- Press and hold to ignore a call.