

Limited 1 Year Warranty

iHome Products, a division of SDI Technologies Inc. [hereafter referred to as SDI], warrants this product to be free from defects in workmanship and materials, under normal use and conditions, for a period of one (1) year from the date of original purchase.

iHome Products, a division of SDI Technologies Inc. [hereafter referred to as SDI], warrants this product to be free from defects in workmanship and materials, under normal use and conditions, for a period of one (1) year from the date of original purchase. Should this product fail to function in a satisfactory manner, it is best to first return it to the store where it was originally purchased. Should this fail to resolve the matter and service still be required by reason of any defect or malfunction during the warranty period, SDI will repair or, at its discretion, replace this product without charge. This decision is subject to verification of the defect or malfunction upon delivery of this product to the Factory Service Center authorized by Customer Service.

If service is required, please call Customer Service at 1-800-288-2792 to obtain a Return Authorization Number and shipping instructions. A copy of the sales receipt is required to validate in-warranty coverage.

Disclaimer of Warranty

NOTE: This warranty is valid only if the product is used for the purpose for which it was designed. It does not cover (i) products which have been damaged by negligence or willful omissions, misuse or accident, or which have been modified or repaired by unauthorized persons; (ii) cracked or broken cabinets, or units damaged by excessive heat; (iii) damage to digital media players, CD's or tape cassettes (if applicable); (iv) the cost of shipping this product to the Factory Service Center and its return to the owner.

This warranty is valid only in the United States of America and does not extend to owners of the product other than to the original purchaser. In no event will SDI or any of its affiliates, contractors, resellers, their officers, directors, shareholders, members or agents be liable to you or any third party for any consequential or incidental damages, any lost profits, actual, exemplary or punitive damages. [Some states do not allow limitations on implied warranties or exclusion of consequential damages, so these restrictions may not apply to you.] This warranty gives you specific legal rights, and you may also have other rights which vary from state to state.

Your acknowledgement and agreement to fully and completely abide by the above mentioned disclaimer of warranty is contractually binding to you upon your transfer of currency [money order, cashier's check, or credit card] for purchase of your SDI product.

© 2016 SDI Technologies, Inc. All rights reserved.
 Questions? Visit www.ihome.com
 or call 1-800-288-2792 Toll Free

iBT68-160726-B (EN)-TT

Printed in China

iHome



Model: iBT68(USA)
 iBT68B(CANADA)
**Color Changing
 Rechargeable
 Bluetooth Speaker
 with Speakerphone**

**CHARGE
 BEFORE
 USE**

instruction manual

Questions? Visit www.ihome.com or call 1-800-288-2792 Toll Free



July 26, 2016

July 26, 2016

July 26, 2016

Introduction

Thank you for purchasing the iHome iBT68. This product is designed to provide high quality wireless sound for your Bluetooth audio device. This instruction booklet explains the basic operation and care of the unit. Please read them carefully and keep for future reference.

iBT68

Maintenance

- Place the unit on a level surface away from sources of direct sunlight or excessive heat.
- Protect your furniture when placing your unit on a natural wood and lacquered finish. A cloth or other protective material should be placed between it and the furniture.
- Clean your unit with a soft cloth moistened only with mild soap and water. Stronger cleaning agents, such as thinner or similar materials can damage the surface of the unit.

What's Included

- iBT68 speaker
- USB charging cable

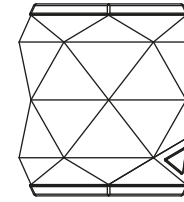

iBT68 speaker



USB charging cable

1

Meet Your iBT68

Top

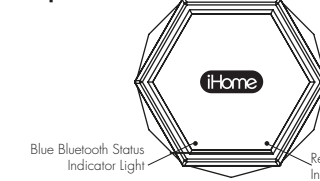

Blue Bluetooth Status Indicator Light

Red Charging Status Indicator Light

Front

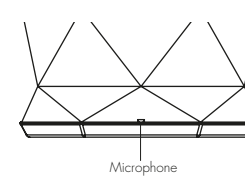

Microphone

Bottom

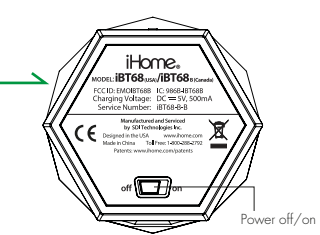

Power off/on Switch

Back

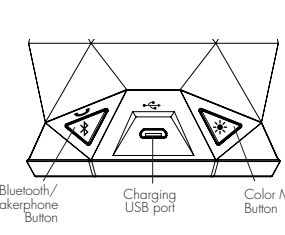

Bluetooth/Speakerphone Button

Charging USB port

Color Mode Button

2

July 26, 2016

July 26, 2016

01/19/2016
 no call waiting
 function

Jan 15, 2016

Jan 15, 2016

Consumer Product Safety Guide IMPORTANT SAFETY INSTRUCTIONS

When used in the directed manner, this unit has been designed and manufactured to ensure your personal safety. However, improper use can result in potential electrical shock or fire hazards. Please read all safety and operating instructions carefully before installation and use, and keep these instructions handy for future reference. Take special note of all warnings listed in these instructions and on the unit.

- Water and Moisture** – DO NOT use near water. Keep away from wash basins, showers, sinks, etc.
- Ventilation** – The unit should be situated so that its location or position does not interfere with its proper ventilation. For example, it should not be situated on a bed, sofa, rug or similar surface that may block ventilation openings.
- Heat** – The unit should be situated away from heat sources such as radiators, heat registers, stoves or other appliances (including amplifiers) that produce heat.
- Power Sources** – The unit should be connected to a power supply only of the type described in the operating instructions or as marked on the appliance.
- Cleaning** – The unit should be cleaned only using a warm damp cloth. Do not use solvents, etc.
- Objects and Liquid Entry** – Care should be taken so that objects do not fall and liquids are not spilled into any openings or vents located on the product.
- Attachments** – Do not use attachments not recommended by the product manufacturer.
- Lightning and Power Surge Protection** – Unplug the unit from the wall socket and disconnect the antenna or cable system during a lightning storm or when it is left unattended and unused for long periods of time. This will prevent damage to the product due to lightning and power-line surges.
- Overloading** – Do not overload wall sockets, extension cords, or integral convenience receptacles as this can result in a risk of fire or electric shock.
- Damage Requiring Service** – The unit should be serviced by qualified service personnel when:
 - the power supply cable or plug has been damaged.
 - objects have fallen into or liquid has been spilled into the enclosure.
 - the unit has been exposed to rain.
 - the unit has been dropped or the enclosure damaged.
 - the unit exhibits a marked change in performance or does not operate normally.

- Periods of Nonuse** – If the unit is to be left unused for an extended period of time, such as a month or longer, fully charge the unit before storing.
- Servicing** – The user should not attempt to service the unit beyond those methods described in the user's operating instructions. Service methods not covered in the operating instructions should be referred to qualified service personnel.

Questions? Visit www.ihome.com
 or call 1-800-288-2792 Toll Free

Internal Rechargeable Lithium-ion Battery

This device uses an internal rechargeable lithium-ion battery that should last the lifetime of the device. If you suspect your battery may be dead, try charging it several times. If the battery does not recharge, please contact Customer Service at 1-800-288-2792.

WARNING/DISPOSAL OF UNIT

- Please do NOT attempt to change the battery yourself. Doing so may damage the unit and will void your warranty.
- Never dispose of used batteries/electronics with ordinary solid wastes, since they contain toxic substances.
 - Always dispose of used batteries/electronics in accordance with the prevailing community regulations that apply to the disposal of batteries/electronics. If there are no local regulations concerning battery/electronics disposal, please dispose of the device in a waste bin for electronic devices.
 - Many electronics retailers now recycle batteries and other electronic components at no charge. Check to see which ones in your area do so.

CAUTION

The battery used in this device may present a risk of fire, explosion or chemical burn if mistreated

- Never use or charge the battery if it appears to be leaking, discolored, deformed, or in any way abnormal.
- Never disassemble the unit or attempt to remove battery as that could cause leakage of alkaline solution or other electrolytic substance.
- Always confirm that the temperature is 5°C – 35°C (41° – 95° Fahrenheit) before you charge the battery. Leakage or deterioration of the battery may occur if this warning is not heeded.
- Never expose the battery to any liquid.
- Never expose the battery to excessive heat such as direct sunlight or fire. Never use the battery pack in an unventilated vehicle where excessive internal temperatures may be encountered.
- Always keep the battery out of the reach of infants and small children.

FCC Information

FCC Radiation Exposure Statement

This equipment complies with FCC RF radiation exposure limits set forth for an uncontrolled environment.

This device complies with Part 15 of the FCC Rules, operation is subject to the following two conditions: (1) This device may not cause harmful interference, and (2) this device must accept any interference received, including interference that may cause undesired operation.

- Warning: Changes or modifications to this unit not expressly approved by the party responsible for compliance could void the user's authority to operate the equipment.
- NOTE: This equipment has been tested and found to comply with the limits for a Class B digital device, pursuant to Part 15 of the FCC Rules.

These limits are designed to provide reasonable protection against harmful interference to a residential installation. This equipment generates, uses and can radiate radio frequency energy and, if not installed and used in accordance with the instructions, may cause harmful interference to radio communications.

However, there is no guarantee that interference will not occur in a particular installation. If this equipment does cause harmful interference to radio or television reception, which can be determined by turning the equipment off and on, the user is encouraged to try to correct the interference by one or more of the following measures:

- Reorient or relocate the receiving antenna.
- Increase the separation between the equipment and receiver.
- Connect the equipment into an outlet on a circuit different from that to which the receiver is connected.
- Consult the dealer or an experienced radio/TV technician for help.

CAN ICES-3 (B)/NMB-3(B)

IC Statement

This device complies with Industry Canada licence-exempt RSS standard(s). Operation is subject to the following two conditions: (1) This device may not cause interference, and (2) This device must accept any interference, including interference that may cause undesired operation of the device.

The device meets the exemption from the routine evaluation limits in section 2.5 of RSS 102 and compliance with RSS-102 RF exposure, users can obtain Canadian information on RF exposure and compliance.

Le présent appareil est conforme aux CNR d'Industrie Canada applicables aux appareils radio exempts de licence. L'exploitation est autorisée aux deux conditions suivantes :

- l'appareil ne doit pas produire de brouillage, et
 - l'utilisateur de l'appareil doit accepter tout brouillage radioélectrique subi, même si le brouillage est susceptible d'en compromettre le fonctionnement.
- Le dispositif rencontre l'exemption des limites courantes d'évaluation dans la section 2.5 de RSS 102 et la conformité à l'exposition de RSS-102 rf, utilisateurs peut obtenir l'information canadienne sur l'exposition et la conformité de rf.

Declaration ID: D029766

Pairing Your Device

Pairing is the setup process to introduce your Bluetooth-capable device to the iBT68. Once your device is paired, the iBT68 can recognize it and you can play your audio through it.



- Turn on your Bluetooth device and make it "discoverable" by turning on Bluetooth mode (check in Options or Settings).
- Slide the **Power Off/On Switch** to ON to turn on the iBT68. *The first time the unit is powered on, it will enter auto-pairing mode and attempt to connect to a Bluetooth device (if so, skip to step 4). Otherwise, follow step 3 to begin pairing.*
- Press and hold the **Bluetooth Button** for 2 seconds. The iBT68 will beep and the Bluetooth status indicator light on top of the unit will flash quickly.

- "iHome iBT68" should appear in your device's Bluetooth menu. If "Not Paired", "Not Connected" or similar message appears, select "iHome iBT68" to connect it. If prompted for a passcode, enter "1234" on your device's keypad.

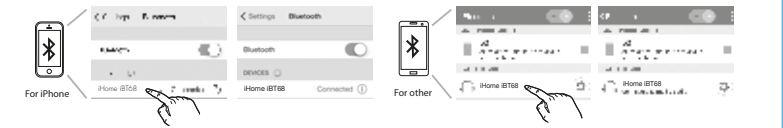

- If pairing is successful, 1 beep will sound and the Bluetooth status indicator light will appear solid blue, indicating the iBT68 is ready to play music. There should also be an indication on your device. If no device is successfully paired within 3 minutes the iBT68 will default to previous mode. Once the iBT68 is paired to a device, it will attempt to autolink when the device is within range (about 30 feet).

4

Pairing with a Different Device

When you power ON the speaker, it will automatically link with the previously paired Bluetooth device as long as that device is still within range (approx. 30 feet). To pair with a different device follow steps 1 - 4 under "Pairing Your Device" on previous page.

Playing Audio Via Bluetooth

- Slide the **Power Off/On Switch** to ON to turn on the unit. The Bluetooth status indicator will glow solid blue when a linked device is in range and detected. You can then listen to audio streamed wirelessly from your paired Bluetooth device.
- Use controls on your Bluetooth device to adjust volume and to play, pause and navigate tracks.
- When done listening, slide the **Power Off/On Switch** to OFF turn the unit OFF.

Speakerphone Operation

NOTE: The unit must be powered on and linked to a Bluetooth phone to receive a call.

- When a call is received, playing music is muted to hear the ring tone and the Bluetooth status indicator flashes 3X. Press the **Bluetooth/Speakerphone Button** to answer the call.
- When a call is completed, press the **Bluetooth/Speakerphone Button** to end the call and resume previous function.

Using Color Modes

There are five color modes, which you cycle through in this order:

- Slow Fade (colors slowly fade from one into the next)
 - Fast Change (colors change rapidly)
 - Pulse to Music (select a favorite color)
 - Pulse to Music (lights flash to the beat of the music)
 - Off (no display)
- Slide the **Power On/Off Switch** to ON to turn the unit ON.
 - Press the **Color Mode Button** repeatedly to cycle to the desired color mode. For One Color mode, first cycle to Fast Change mode then press the Color Mode Button when the desired color appears. For Pulse to Music, make sure the volume on your connected Bluetooth device is above 50%.
 - When done, slide the **Power On/Off Switch** to OFF to turn the unit OFF.

Troubleshooting

Unit doesn't respond (no power)

- Make sure unit is completely charged.
- Check that all connections are correct and properly plugged in.
- Make sure your device is properly paired with the iBT68.
- Make sure the unit is on.

Unit doesn't respond (locked up/ "frozen")

If the unit does not respond, try resetting the unit. Press and hold the **Bluetooth Button** for 10 seconds. Note that doing so will clear settings, and any Bluetooth devices will need to be re-paired.

Trouble pairing device with iBT68

Bluetooth implementation varies depending on your device's hardware and operating system. Please see our website for updates on pairing.

- When you power ON the speaker, it will automatically link with the last previously paired Bluetooth device if the device is still within range (approx. 30 feet). To pair with a different device you must turn off Bluetooth capability on the already paired device, or take it out of range.
- If your device does not auto-link when within range, repair the device. To do so, first delete the iBT68 from your Bluetooth devices menu.
- Make sure your device is working properly. Check your device's manual for details on Bluetooth pairing and linking.

For further information and to see the latest instructions, visit www.ihome.com/support

6

Charging the Unit

CHARGE UNIT BEFORE USE/KEEP UNIT OFF FOR FASTER CHARGING

- Connect the micro USB plug on the included USB cable to the micro USB Charging Port on the side of the unit.
- Connect the standard USB plug end of the cable to a powered USB port on a computer, a USB AC adaptor or other USB charging device. For first time use, charge unit for about 4 hours. The red charge status indicator LED on top right of the unit flashes while charging and turns solid once unit is fully charged.

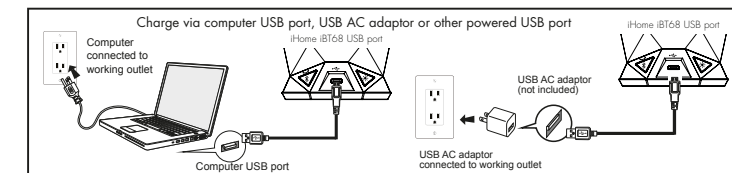

TIP: On some iOS (Apple) devices, you can view the iBT68 battery status on your device's screen. When device is paired and connected, look for a vertical battery icon next to the Bluetooth icon on the upper right corner of the device's screen.

3