

iBT7 IB (English)
17 pages
Size: 153mm x 120mm
Color: Black
Nov. 06, 2015

P1

iHome



iBT7
Waterproof Rechargeable
Bluetooth
Stereo Speaker System

with speakerphone and USB mobile device charging



CHARGE
BEFORE
USE



instruction manual



iBT7

Introduction

Thank you for purchasing the iHome iBT7. This product is designed to provide high quality wireless sound for your iPad, iPhone, iPod, computer, or other Bluetooth audio device.

This instruction booklet explains the basic operation and care of the unit. Please read carefully and keep for future reference.

FCC/IC Information

FCC Radiation Exposure Statement

FCC ID:EMOIBT7
IC:986B-IBT7

This equipment complies with FCC RF radiation exposure limits set forth for an uncontrolled environment. This device complies with Industry Canada's licence-exempt RSSs. Operation is subject to the following two conditions:
(1) This device may not cause interference and
(2) This device must accept any interference received, including interference that may cause undesired operation

This device complies with Part 15 of the FCC Rules, operation is subject to the following two conditions: (1) This device may not cause harmful interference, and (2) this device must accept any interference received, including interference that may cause undesired operation.

- Warning: Changes or modifications to this unit not expressly approved by the party responsible for compliance could void the user's authority to operate the equipment.
- NOTE: This equipment has been tested and found to comply with the limits for a Class B digital device, pursuant to Part 15 of the FCC Rules. These limits are designed to provide reasonable protection against harmful interference in a residential installation. This equipment generates, uses and can radiate radio frequency energy and, if not installed and used in accordance with the instructions, may cause harmful interference to radio communications. However, there is no guarantee that interference will not occur in a particular installation. If this equipment does cause harmful interference to radio or television reception, which can be determined by turning the equipment off and on, the user is encouraged to try to correct the interference by one or more of the following measures:
 - Reorient or relocate the receiving antenna.
 - Increase the separation between the equipment and receiver.
 - Connect the equipment into an outlet on a circuit different from that to which the receiver is connected.
 - Consult the dealer or an experienced radio/TV technician for help.

CAN ICES-3 (B)/NMB-3(B)

The device meets the exemption from the routine evaluation limits in section 2.5 of RSS 102 and compliance with RSS-102 RF exposure, users can obtain Canadian information on RF exposure and compliance.

Le présent appareil est conforme aux CNR d'Industrie Canada applicables aux appareils radio exempts de licence. L'exploitation est autorisée aux deux conditions suivantes : (1) l'appareil ne doit pas produire de brouillage, et (2) l'utilisateur de l'appareil doit accepter tout brouillage radioélectrique subi, même si le brouillage est susceptible d'en compromettre le fonctionnement.

Le dispositif rencontre l'exemption des limites courantes d'évaluation dans la section 2.5 de RSS 102 et la conformité à l'exposition de RSS-102 rf, utilisateurs peut obtenir l'information canadienne sur l'exposition et la conformité de rf.

QDID: B020415

iBT7

Maintenance

- Place the unit on a level surface away from sources of direct sunlight or excessive heat.
- Protect your furniture when placing your unit on a natural wood and lacquered finish. A cloth or other protective material should be placed between it and the furniture.
- Clean your unit with a soft cloth moistened only with mild soap and water. Stronger cleaning agents, such as thinner or similar materials can damage the surface of the unit. Rinse unit with tap water and wipe dry after submersion in salt water or swimming pool.

Long-term Storage of Your Product

- Store in a cool, dry place.
- Unit should be charged before storing.
- If stored for a long period of time, unit may be unresponsive until charged for a number of hours (depending on discharge level)
- Do not store for more than a year without charging as this can permanently harm the battery.
- After long term storage, if unit is unresponsive after charging, RESET unit while connected to AC and recharge the unit.

Internal Rechargeable Lithium-ion Battery

This device uses an internal non-replaceable rechargeable lithium-ion battery that should last the lifetime of the device. If you suspect your battery may be dead, try charging it for an extended period of time and try resetting the unit. If this fails, contact Customer Service at 1-800-288-2792.

WARNING/DISPOSAL OF UNIT

Do NOT attempt to change the battery. Doing so will void the warranty and could cause injury and damage to your device.

To dispose of the unit, follow the instructions below:

- Never dispose of used batteries/electronics with ordinary solid wastes, since they contain toxic substances.
- Always dispose of used batteries/electronics in accordance with the prevailing community regulations.
- Many electronics retailers now recycle batteries and other electronic components at no charge.

GENERAL BATTERY PRECAUTIONS

- Never use or charge a battery if it appears to be leaking, discolored, deformed, or in any way abnormal.
- Never disassemble the unit or attempt to remove battery as that could cause leakage of alkaline solution or other electrolytic substances.
- Avoid charging a rechargeable battery when the temperature is not within 5°C - 35° C (41° - 95° Fahrenheit).
- Never expose a battery to any liquid.
- Never expose a battery to excessive heat such as direct sunlight or fire. Never use a battery pack in an unventilated vehicle where excessive internal temperatures may be encountered.
- Always keep batteries out of the reach of infants and small children.

iBT7

Table of Contents

Included / Meet Your iBT7	1-2
Setting Up the Unit / Turning the Unit ON and OFF.....	3
Waterproof Operation	4
Charging the iBT7/ECO Battery Mode.....	5
Using Bluetooth: Pairing Your Device	6
Playing Audio Via Bluetooth.....	7
Using the Speakerphone feature.....	8
Playing Audio Via Aux line-in	8
Charging Devices Via USB Port.....	9
Consumer Product Safety Guide.....	10-11
Troubleshooting	12
Warranty.....	13

iBT7

Included

1. iBT7 Speaker
2. 100V-240V universal AC adaptor
3. Stereo 3.5 mm audio cable
4. Bottle opener/carabiner clip

To remove carabiner clip:

1. Hold clip sideways to unit.
2. Press clip hinge post inwards and slide strap loop off of hinge post.

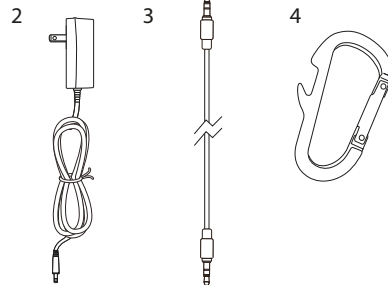
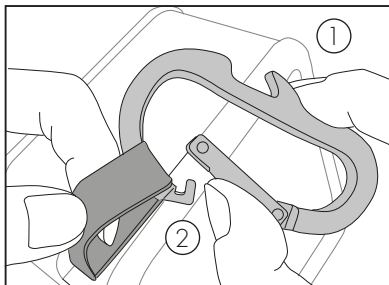
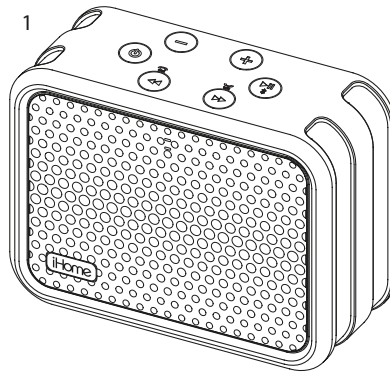

1

Meet Your iBT7

iBT7

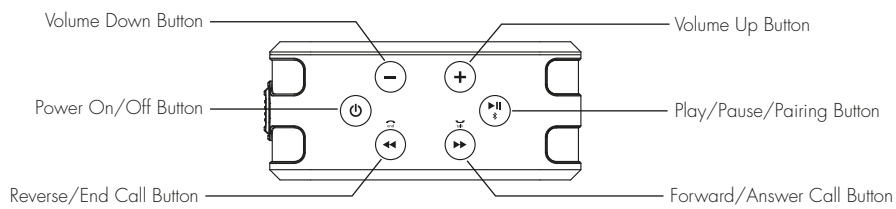

Top view

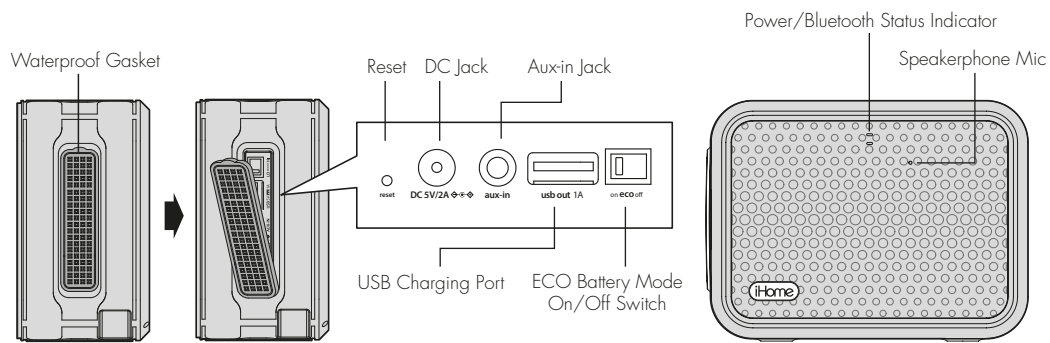

Side view

Front view

Setting Up the Unit

To charge the unit and operate the unit on AC power, connect the included AC adaptor to the DC jack located on the side of the unit and connect the other end to a working wall outlet.

For first time use, make sure to fully charge the internal battery for about 8 hours.

Turning the Unit ON and OFF

1. Press the **Power Button** located on top of the unit to turn the unit ON. The green/red battery status and blue Bluetooth status LED indicators on the front of the unit will light and ascending tones will sound.
2. Press the **Power Button** to turn the unit OFF. Descending tones will sound. **Note:** if no audio is detected for 15 minutes, the unit will power off automatically to save battery life.

Using the iBT7

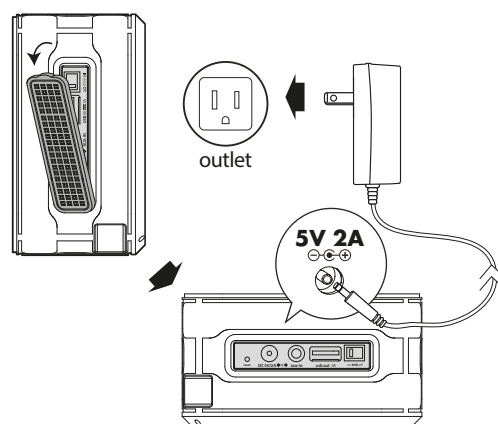

Status Indicators at Power On

Solid Red	Unit is charging
Solid Green	Unit is charged
Flashing Blue	Attempting to pair
Solid Blue	Paired device connected

Using the iBT7

IMPORTANT INFORMATION ABOUT WATERPROOF OPERATION

For proper waterproof operation, make sure the waterproof gasket on the left side of the unit is completely flush with the unit by pressing along the entire edge of the gasket until it is completely and securely in place.



- The unit is IP67 waterproof rated, meaning it is immersible for up to 30 minutes at a depth of 1 meter (3 feet). It will typically withstand rain, snow and being submersed in shallow water. Longer duration or deeper immersion that exceeds the tested limits may cause product failure and void the warranty.
- DO NOT immerse the unit in water for extended periods.
- DO NOT immerse the unit in water deeper than 1 meter (about 3 feet).
- Make sure gasket and surrounding surfaces are completely dry before opening gasket to prevent moisture from damaging the internal electronics.
- Keep rubber gasket free of dirt, sand, or other objects that can interfere with proper sealing. If for any reason the waterproof gasket is not making a tight waterproof seal water may enter the unit.
- Rinse with tap water after immersion in salt water or swimming pool.
- DO NOT clean unit with oily soaps or use chemicals or solvents. Clean with damp cloth.

Charging the Unit

To charge the internal battery for portable operation, connect the included AC adaptor to the DC jack located on the side of the unit and connect the other end to a working wall outlet. While charging, the Battery Charge Indicator light on the front of the unit will glow solid red. Once fully charged the light will glow solid green.

For first time use, make sure to fully charge the internal battery for about 8 hours.

Charging and Battery Status

While operating on the internal battery, when the unit is ON the Battery/Charging Status Indicator light on the front of the unit automatically appears every 5 minutes.

ECO Battery Mode

ECO Battery Mode allows for extended battery life when playing unit for up to 14 hours without charging. In ECO mode, the volume level decreases slightly as the battery discharges. Set **Eco Battery Mode Switch** to **On** for Eco Mode. Set to **Off** for normal listening. **Note:** The ECO switch is disabled while the unit is operating on AC adaptor. The switch position has no effect on the battery charging.

Using the iBT7

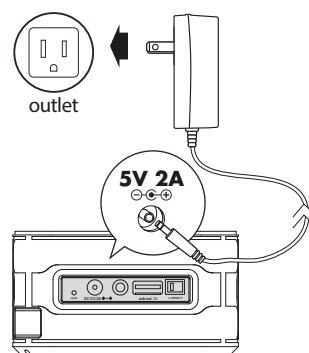



TIP: To check battery status at any time (whether unit is on or off, operating on battery or AC power), press and hold both the **- Button** or **+ Button** at the same time for 2 seconds.

Battery Charge Status Indicator		USB Charge
Flashing Red	LOW needs charging	X
Fading Red	MED partially charged	✓
Fading Green	HIGH fully charged	✓

Using the iBT7

Using Bluetooth: Pairing Your Device

1. Turn on your Bluetooth-enabled device and turn on Bluetooth capability as described in the device's user manual.
2. Press the  **Power Button** located on top of the unit to turn the unit ON. **The first time the unit is turned on it will enter auto pairing mode:** ascending tones will sound and the indicator light on the front of the unit will flash blue while the unit attempts to pair. "iHome iBT7" should appear on your device's menu. If "Not Paired", "Not Connected" or similar message appears, select "iHome iBT7" on device to begin/complete pairing. If your device asks for a password, enter **1234** on the keyboard of your device. If no device is paired within 3 minutes, the unit will revert to its previous state.
3. If auto-pairing is unsuccessful, or if you are trying to pair with a different Bluetooth device, make sure unit is powered on then press and hold the  **Button** (located on top of the unit) for 2 seconds. 2 tones will sound and the indicator light on front of the unit will flash blue while the unit attempts to pair. "iHome iBT7" should appear on your device's menu. If "Not Paired", "Not Connected" or similar message appears, select "iHome iBT7" on device to begin/complete pairing. If your device asks for a password, enter **1234** on the keyboard of your device. To retry pairing, repeat step 3.
4. Once paired with a device, the blue indicator light will glow steadily and a confirmation tone will sound. There should be an indication on your device that pairing is complete. On some devices, you must then select "Use as Audio Device (stereo)" or similar on the device's Bluetooth menu. Once paired, your device should link to the powered on iBT7 whenever within range.

Using the iBT7

Pairing with a Different Device

When you power ON the speaker, it will automatically link with the previously paired Bluetooth device as long as that device is still within range (about 30 feet). To pair with a different device, please follow step 3 on page 6.

Playing Audio Via Bluetooth

1. Press the **Power Button** to turn on the unit. The light on front of the unit will flash blue and ascending tones will sound and the unit will search for a previously paired device. The light will turn solid blue once a previously paired device is detected. You can then listen to audio streamed wirelessly from your paired iPad, iPhone, iPod or other Bluetooth device.
2. Press the **Play/Pause Button** to play or pause audio.
3. Press the **First Button** to go to the start of a track, press again to play the previous track. Press the **Last Button** to advance to the next track. *Press and hold* **Fast Forward** or **Fast Reverse** for rapid search backwards or forwards within a track.
4. Press the **- Button** or **+ Button** to adjust the volume on the unit. Press and hold for rapid volume change. The LED indicator on the front of the unit will flash 3X when the volume is at maximum or minimum. You can also adjust volume on your device.
5. When done listening, press the **Power Button** to turn the unit OFF. Remember to turn off your audio device, too.

Note: Do not play a Bluetooth device while an aux-in device is playing or you will hear both.

Using the iBT7

Using the Speakerphone feature

NOTE: The unit must be powered on to receive a call. A Bluetooth phone must be linked.

1. When a call is received, playing music is muted to hear the ring tone. Press the **Talk Button** to answer the call, or press the **End Button** to ignore it. For call waiting function, press the **Talk Button** to place a currently active call on hold and answer a new call; press the **Talk Button** to switch between the calls.
2. When a call is completed, press the **End Button** to end the call and resume previous function.

Playing Audio via Aux In

1. Connect one end of the included 3.5mm stereo audio cable to the Aux in jack on the side of the unit under the waterproof gasket and connect the other end to the headphone or line-out jack on your audio device.
2. Press the **Power Button** on the unit to turn it on.
3. Power on the audio device and use the controls on the device to play or pause audio, and navigate tracks.
4. Adjust the volume on the unit as described previously.
5. When done listening, press the **Power Button** to turn the unit OFF. Remember to turn off your audio device, too.

Note: Do not play an aux-in device while a Bluetooth device is playing or you will hear both.

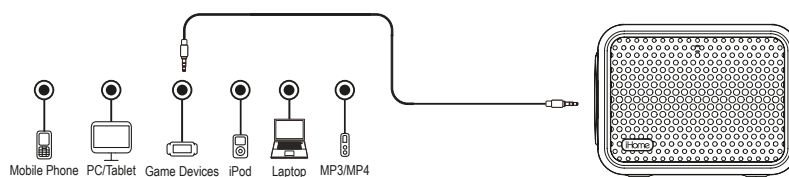

Using the iBT7

Charging Devices via USB Port

Note: When operating on internal battery, the unit must be powered ON to charge devices via the USB Port. The iBT7 will charge devices when connected to AC power OR when operating on the internal battery (provided the battery has enough charge). To charge devices via USB while operating on the internal battery, we recommend that the unit be *fully charged first*. The iBT7 will *not* charge external devices via USB when internal rechargeable battery is too low (red indicator is blinking). To save battery power, USB charging is limited to 1 hour when no audio is playing.

1. Lift water resistant gasket located on the side of the unit to expose the USB Port.
2. Connect the standard size end of a USB cable (not included) to the USB Port and connect the other end to the charging port on your device.
3. Press the **Power Button** on the unit to turn it on.
4. Monitor the charging on your device. If your device does not charge, you must charge your device using the charger that came with it.

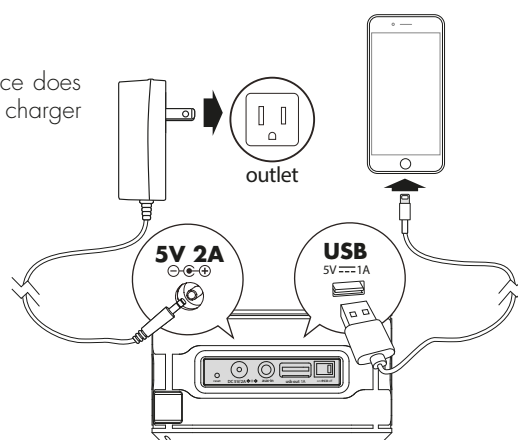
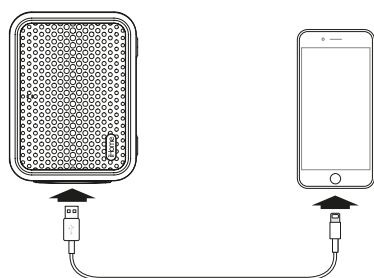

Consumer Product Safety Guide

IMPORTANT SAFETY INSTRUCTIONS

When used in the directed manner, this unit has been designed and manufactured to ensure your personal safety. However, improper use can result in potential electrical shock or fire hazards. Please read all safety and operating instructions carefully before installation and use, and keep these instructions handy for future reference. Take special note of all warnings listed in these instructions and on the unit.

1. **Water and Moisture** – This unit is rated IP67 (will withstand submersion for 30 minutes at a depth of 1 meter (3 feet)), but should not be operated under water. It is also dustproof.
 - Gasket must be properly sealed before use near water.
 - Dry unit completely before opening gasket.
 - Do NOT open gasket if wet or in a wet environment.
2. **Ventilation** – The unit should be situated so that its location or position does not interfere with its proper ventilation. For example, it should not be situated on a bed, sofa, rug or similar surface that may block ventilation openings.
3. **Heat** – The unit should be situated away from heat sources such as radiators, heat registers, stoves or other appliances (including amplifiers) that produce heat.
4. **Power Sources** – The unit should be connected to a power supply only of the type described in the operating instructions or as marked on the appliance.
5. **Power-Cable Protection** – Power supply cables should be routed so that they are not likely to be walked on or pinched by items placed upon or against them. It is always best to have a clear area from where the cable exits the unit to where it is plugged into an AC socket.

6. **Cleaning** – The unit should be cleaned only using a warm damp cloth. Do not use oily solvents or chemicals. Rinse the unit off with tap water after use in salt water or swimming pool.
7. **Objects and Liquid Entry** – Care should be taken so that objects do not fall and liquids are not spilled into any openings or vents located on the product. Keep gasket free of dirt, sand, or objects that could interfere with a proper watertight seal.
8. **Attachments** – Do not use attachments not recommended by the product manufacturer.
9. **Lightning and Power Surge Protection** – Unplug the unit from the wall socket and disconnect the antenna or cable system during a lightning storm or when it is left unattended and unused for long periods of time. This will prevent damage to the product due to lightning and power-line surges.
10. **Overloading** – Do not overload wall sockets, extension cords, or integral convenience receptacles as this can result in a risk of fire or electric shock.
11. **Damage Requiring Service** – The unit should be serviced by qualified service personnel when:
 - A. the power supply cable or plug has been damaged.
 - B. objects have fallen into or liquid has been spilled into the area under the rubber gasket.
 - C. the unit has been dropped or the enclosure damaged.
 - D. the unit exhibits a marked change in performance or does not operate normally.
12. **Periods of Nonuse** – If the unit is to be left unused for an extended period of time, such as a month or longer, the power cable should be unplugged from the unit to prevent damage or corrosion.
13. **Servicing** – The user should not attempt to service the unit beyond those methods described in the user's operating instructions. Service methods not covered in the operating instructions should be referred to qualified service personnel.

Questions? Visit www.ihome.com
or call 1-800-288-2792 Toll Free

Troubleshooting

Unit doesn't respond (no power)

- Check that all connections are correct and properly plugged in.
- For internal battery operation, make sure the unit is fully charged.
- Make sure your device is properly paired with the iBT7.
- Make sure the **Power** is ON.

Unit doesn't respond

- If the unit appears to be "frozen" or locked up or hasn't been used in a long time, you may need to reset it. To do so, use a straightened paper-clip, toothpick, or similar device to press the reset button located under the water resistant gasket on the side of the unit. The blue LED indicator on the front of the unit will flash rapidly 5 times to indicate the unit has been reset. If unit hasn't been used in a long time, charge unit for a number of hours before attempting to reset.

Trouble pairing device with iBT7

Bluetooth implementation varies depending on your device's hardware and operating system. Please see our website for updates on pairing.

- If pairing fails, try to pair again by powering on the unit then pressing and holding the Pairing Button on the top of the unit for 2 seconds.
- Make sure your device is working properly. Check your device's manual for details on Bluetooth pairing and linking.

For further information and to see the latest instructions, visit www.ihome.com/support

Limited 1 Year Warranty

iHome Products, a division of SDI Technologies Inc. (hereafter referred to as SDI), warrants this product to be free from defects in workmanship and materials, under normal use and conditions, for a period of one (1) year from the date of original purchase.

Should this product fail to function in a satisfactory manner, it is best to first return it to the store where it was originally purchased. Should this fail to resolve the matter and service still be required by reason of any defect or malfunction during the warranty period, SDI will repair or, at its discretion, replace this product without charge. This decision is subject to verification of the defect or malfunction upon delivery of this product to the Factory Service Center authorized by Customer Service.

If service is required, please call Customer Service at 1-800-288-2792 to obtain a Return Authorization Number and shipping instructions.

Disclaimer of Warranty

NOTE: This warranty is valid only if the product is used for the purpose for which it was designed. It does not cover (i) products which have been damaged by negligence or willful actions, misuse or accident, or which have been modified or repaired by unauthorized persons; (ii) cracked or broken cabinets, or units damaged by excessive heat; (iii) damage to digital media players, CD's or tape cassettes (if applicable); (iv) the cost of shipping this product to the Factory Service Center and its return to the owner.

This warranty is valid only in the United States of America and does not extend to owners of the product other than to the original purchaser. In no event will SDI or any of its affiliates, contractors, resellers, their officers, directors, shareholders, members or agents be liable to you or any third party for any consequential or incidental damages, any lost profits, actual, exemplary or punitive damages. (Some states do not allow limitations on implied warranties or exclusion of consequential damages, so these restrictions may not apply to you.) This warranty gives you specific legal rights, and you may also have other rights which vary from state to state.

Your acknowledgment and agreement to fully and completely abide by the above mentioned disclaimer of warranty is contractually binding to you upon your transfer of currency (money order, cashier's check, or credit card) for purchase of your SDI product.

© 2016 SDI Technologies, Inc. All rights reserved.

Questions? Visit www.ihome.com

or call 1-800-288-2792 Toll Free