

iKN150 IB (English)
Size: 130 x 102 mm
Color: 1C + 1C (Black text on white paper)
20 pages
Date: Jan. 7, 15.

P1

Model: iKN150

K1 portable stereo speaker system
with speakerphone and removable power

iHome
KINETA



**CHARGE
BEFORE
USE**



instruction manual

Questions?

Contact Customer Service at 1-800-288-2792



K1

Introduction

Thank you for purchasing the iHome Kineta K1. This product is designed to provide high quality wireless sound for your iPad, iPhone, iPod, computer, tablet or other Bluetooth audio device and mobile charging on the go with the included removable K-Cell rechargeable battery.

This unit features NFC (Near Field Communication) technology which allows you to wirelessly connect your NFC-enabled device to instantly 'pair and play'. See your device's user manual for details on how to interact with NFC devices. If your Bluetooth device does not support NFC, you can pair it manually with this unit.

This instruction booklet explains the basic operation and care of the unit. Please read it carefully and keep for future reference.

K1

Maintenance

- Place the unit on a level surface away from sources of direct sunlight or excessive heat.
- Protect your furniture when placing your unit on a natural wood and lacquered finish. A cloth or other protective material should be placed between it and the furniture.
- Clean your unit with a soft cloth moistened only with mild soap and water. Stronger cleaning agents, such as thinner or similar materials can damage the surface of the unit. Rinse unit with tap water and wipe dry after submersion in salt water or swimming pool.

Long-term Storage of Your Product

- Store in a cool, dry place.
- Unit should be charged before storing.
- If stored for a long period of time, unit may be unresponsive until charged for a number of hours (depending on discharge level)
- Do not store for more than a year without charging as this can permanently harm the battery.
- After long term storage, if unit is unresponsive after charging, RESET unit while connected to AC and recharge the unit.

Internal Rechargeable Lithium-ion Battery

This device uses an internal rechargeable lithium-ion battery that should last the lifetime of the device. If you suspect your battery may be dead, try charging it several times and try resetting the unit.

WARNING/DISPOSAL OF UNIT

Please do NOT attempt to change the battery yourself. If the battery has died and you do not want us to replace your battery, you should follow the disposal instructions below:

- Never dispose of used batteries/electronics with ordinary solid wastes, since they contain toxic substances.
- Always dispose of used batteries/electronics in accordance with the prevailing community regulations that apply to the disposal of batteries/electronics. If there are no local regulations concerning battery/electronics disposal, please dispose of the device in a waste bin for electronic devices.
- Many electronics retailers now recycle batteries and other electronic components at no charge. Check to see which ones in your area do so.

GENERAL BATTERY PRECAUTIONS

- Never use or charge a battery if it appears to be leaking, discolored, deformed, or in any way abnormal.
- Never disassemble the unit or attempt to remove battery as that could cause leakage of alkaline solution or other electrolytic substance.
- Always confirm that the temperature is 5°C - 35°C (41° - 95° Fahrenheit) before you charge the battery. Leakage or deterioration of the battery may occur if this warning is not heeded.
- Never expose a battery to any liquid.
- Never expose a battery to excessive heat such as direct sunlight or fire. Never use a battery pack in an unventilated vehicle where excessive internal temperatures may be encountered.
- Always keep batteries out of the reach of infants and small children.

K1**Table of Contents**

Included / Meet Your K1	1-2
Getting Started: Charging the Unit and K-Cell via AC Adaptor	3
Battery Level Meters	4
Charging the K-Cell via USB.....	5
Charging Devices Using the K-Cell	6
Using Bluetooth: Pairing Your Device Using NFC.....	7
Using Bluetooth: Pairing Your Device Manually.....	8
Pairing with a Different Device / Playing Audio Via Bluetooth	9
Speakerphone Operation	10
Playing Audio via Aux In	11
Consumer Product Safety Guide	12-13
FCC Information.....	14
Troubleshooting	15
Warranty.....	16

K1

Included

- K1 system
- K-Cell
- AC adaptor
- USB charging cable

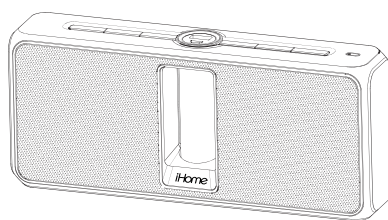

K1 system



K-Cell



USB cable



AC adaptor

Meet Your K1

K1

Top

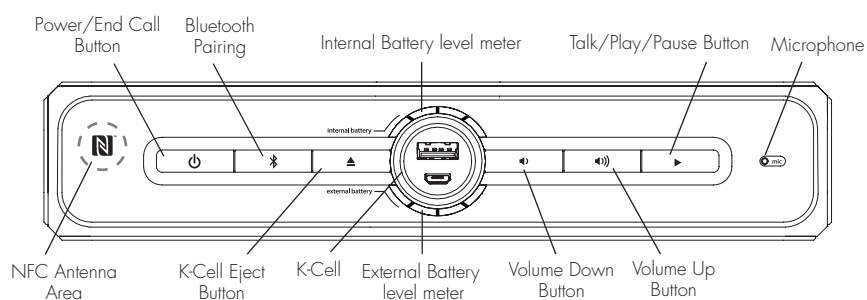

Left Side

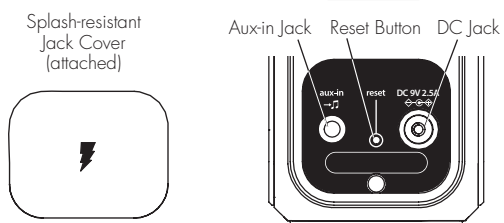

K1

Getting Started: Charging the Unit and K-Cell via AC Adaptor

Charge unit fully with K-Cell inserted before use. For first time charge, charge for at least 8 hours. Use iHome K-Cell battery ONLY. Do NOT attempt to use with/insert other USB battery cells.

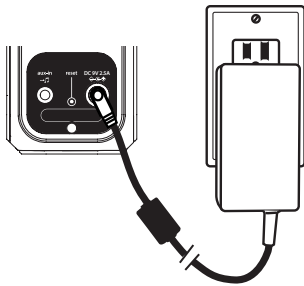

Pull back the jack cover on the left of the unit to access jacks. Connect the included AC adaptor to the DC jack and connect the other end to a working wall outlet. While connected to AC, the unit will charge until both the internal battery AND the docked external K-Cell removable cell are charged.

To insert K-Cell: Make sure the iHome logo on the K-Cell faces the same direction as the iHome logo on the front of the unit (with the channel on the K-cell facing the back) before inserting.

Once charged, press the **K-Cell Eject Button** to release the K-Cell and remove for use as a portable USB charger.

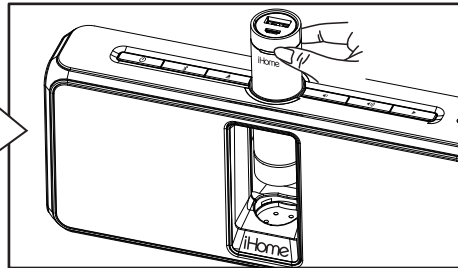

Using the K1

Battery Level Meters

The unit has one battery level meter on top of the unit for the internal battery and one for the removable K-Cell external battery. The table below shows the charge status indicated by each meter when unit is connected to AC power.



Battery Level Meters Internal & External Battery Status (unit is ON)	
0 segments lit	dead, needs charge
1st segment flashing	low, needs charge
1 segment solid, 2nd segment flashing	25 - 50% charged
2 segments solid, 3rd segment flashing	50 - 75% charged
3 segments solid, 4th segment flashing	75 - 100% charged
4 segments solid	100% charged

Using the K1

Charging the K-Cell via USB

Charge K-Cell fully before use. For first time charge, charge for at least 3 hours.

Connect the included micro USB cable to the micro USB Charging Port on the top of the K-Cell and connect the other standard USB plug to a computer, USB AC adaptor (not included) or other USB power source. The LED on the K-Cell flashes while it is charging and becomes solid once fully charged. A charged K-Cell can operate the unit when the internal battery is depleted.

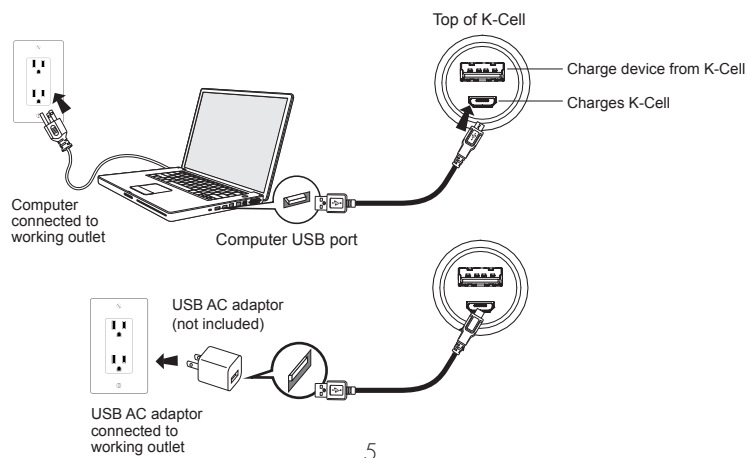

Using the K1

Charging Devices Using the K-Cell

Charge K-Cell fully before use. For first time charge, charge for at least 3 hours.

Connect the USB cable plug included with your device to the standard Charging Port on the top of the K-Cell and connect the other end to the device you wish to charge. To charge an Android or Windows phone you may use the USB to micro USB cable supplied with this model. To charge an Apple IOS iPhone or iPod, with either Lightning or 30-pin connector, use the charging cable that was supplied with your Apple device.

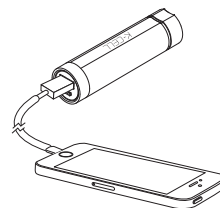

Bypass Charging Mode: To charge a device when the inserted K-Cell is depleted but power remains in the K1 internal battery, *press and hold* the **⏻ Button** for about 5 seconds to bypass the K-Cell and charge directly from the K1.

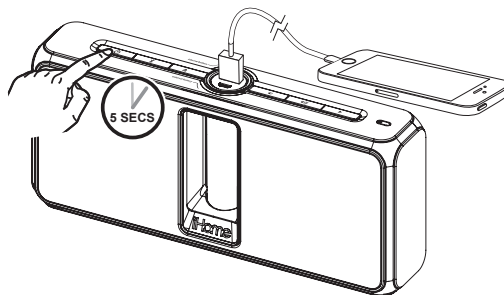

Using Bluetooth: Pairing Your Device Using NFC

Using the K1

This unit features wireless NFC pairing, which allows NFC-enabled devices to pair and play instantly. (For pairing non-NFC devices, please see the following section "Pairing Your Device Manually".)

The first time the unit is powered on, it will enter auto-pairing mode. Follow steps below to pair.

1. Turn on your Bluetooth-enabled/NFC-enabled device and turn on NFC capability as described in the device's user manual.
2. Place your NFC-enabled device in play mode.
3. Touch the **N** area of your playing NFC device against the NFC antenna area on the top left of the unit near the **Power/End Button**. The unit will turn on and enter automatic pairing mode, a tone will sound and the Bluetooth button will flash quickly while the unit attempts to pair.
4. "iHome Kineta K1" should appear on your device's menu. If your device asks if you wish to pair, accept (select "Yes" or similar). Once paired with a device, the Bluetooth button will glow solid, confirmation tones will sound and your music will play through the unit.

Powering off the unit will disconnect Bluetooth device. To disconnect your device without powering the unit off, simply touch it again on the antenna area on top of the unit.

Pairing Your Device Manually

Using the K1



Pairing is the setup process to introduce your Bluetooth-capable device to the K1. Once your device is paired, the K1 can recognize it and you can play your audio through it.



1. Make sure your Bluetooth device is fully charged. Turn on your Bluetooth device and make it "discoverable" by turning on Bluetooth mode (check in Options or Settings).



2. Press the **Power/End Button** to turn on the K1. *The first time the unit is powered on, it will enter auto-pairing mode and attempt to connect to a Bluetooth device. Otherwise, follow step 3 to begin pairing.*

3. *Press and hold the **Bluetooth Button** for 2 seconds. The pairing tone will sound twice and the Bluetooth Button will flash quickly, indicating the unit is in pairing mode.*

4. "iHome Kineta K1" should appear in your device's Bluetooth menu. If "Not Paired", "Not Connected" or similar message appears, select "iHome Kineta K1" to connect it. If prompted for a passcode, enter "1234" on your device's keypad.

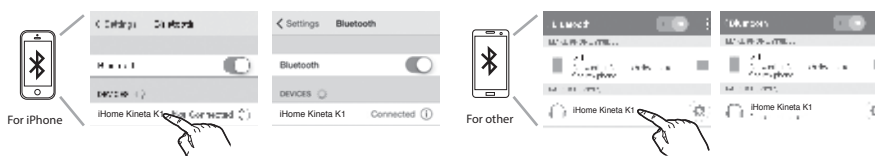

5. If pairing is successful, a tone will sound and the Bluetooth Button light will glow solid, indicating the K1 is ready to play music. There should also be an indication on your device. If no device is successfully paired within 3 minutes the K1 will default to previous mode. Once the K1 is paired to a device, it will attempt to autolink when the device is within range (about 30 feet).

Using the K1

Pairing with a Different Device

When you power ON the speaker, it will automatically link with the most recently connected Bluetooth device as long as that device is still within range (approx. 30 feet). To pair with a different device follow steps 1 - 4 under "Pairing Your Device" on previous page.

Playing Audio Via Bluetooth

1. Press the **⏻ Power/End Button** to turn on the unit. The Bluetooth Button will glow solid when a linked device is in range and detected. You can then listen to audio streamed wirelessly from your paired Bluetooth device.
2. Press the **▶ Talk/Play/Pause Button** to play audio from your device. Press again to pause play and once more to resume play. When Bluetooth audio is active, the Bluetooth Button will glow solid white.
3. Double press the **▶ Talk/Play/Pause Button** to advance to the next track; press three times to go to the previous track. Use controls on your Bluetooth device to search within tracks.
4. Press the **◀ or ▶) Button** to adjust the K1 volume. You can also adjust volume on your device.
5. When done listening, press the **⏻ Power/End Button** to turn the unit OFF. Remember to turn off your device, too.

Using the K1

Speakerphone Operation

NOTE: The unit must be powered on and linked to a Bluetooth phone to receive a call.

When a call is received, playing music is muted to hear the ring tone. The **▶ Talk/Play/Pause Button** will flash green, and the **⊖ Power/End Button** will flash red.

1. Press the **▶ Talk/Play/Pause Button** to answer a call or press the **⊖ Power/End Button** to ignore the call. For call waiting function, press the **▶ Talk/Play/Pause Button** to place a currently active call on hold and answer a new call; press the **▶ Talk/Play/Pause Button** to switch between the calls.
2. When a call is completed, press the **⊖ Power/End Button** to end the call and resume previous function.

Using the K1

Playing Audio via Aux In

1. Connect one end of a 3.5mm stereo audio cable (not included) to the Aux-in jack on the left side of the unit and connect the other end to the headphone or line-out jack on your audio device.
2. Press the **⏻ Button** on the unit to turn it on.
3. Power on the audio device and use the controls on the device to play or pause audio, and navigate tracks.
4. Press the **🔊 or 🔊) Button** to adjust the system volume. You can also adjust volume on your device.
5. When done listening, press the **⏻ Button** to turn the unit OFF. Remember to turn off your device, too.

NOTE: Make sure no Bluetooth device is playing or you will not hear the Aux-in audio playing.

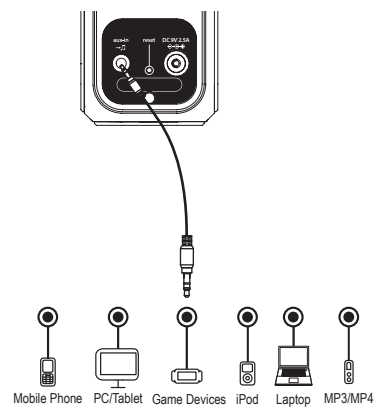

Consumer Product Safety Guide

IMPORTANT SAFETY INSTRUCTIONS

When used in the directed manner, this unit has been designed and manufactured to ensure your personal safety. However, improper use can result in potential electrical shock or fire hazards. Please read all safety and operating instructions carefully before installation and use, and keep these instructions handy for future reference. Take special note of all warnings listed in these instructions and on the unit.

1. **Water and Moisture** – Keep Unit and K-Cell battery away from moisture. Do not operate near water.
 - Do NOT open Jack Cover if wet or in a wet environment.
2. **Ventilation** – The unit should be situated so that its location or position does not interfere with its proper ventilation. For example, it should not be situated on a bed, sofa, rug or similar surface that may block ventilation openings. Also, it should not be placed in a built-in installation, such as a bookcase or cabinet, which may impede the flow of air through the ventilation openings.
3. **Heat** – The unit should be situated away from heat sources such as radiators, heat registers, stoves or other appliances (including amplifiers) that produce heat.
4. **Power Sources** – The unit should be connected to a power supply only of the type described in the operating instructions or as marked on the appliance.
5. **Power-Cable Protection** – Power supply cables should be routed so that they are not likely to be walked on or pinched by items placed upon or against them.
6. **Cleaning** – The unit should be cleaned only using a warm damp cloth. Do not use solvents, etc.
7. **Objects and Liquid Entry** – Care should be taken so that objects do not fall and liquids are not spilled into any openings or vents located on the product. Keep splash-resistant jack cover free of dirt, sand, or objects that could interfere with a proper seal.

8. **Attachments** – Do not use attachments not recommended by the product manufacturer.
9. **Lightning and Power Surge Protection** – Unplug the unit from the wall socket and disconnect the antenna or cable system during a lightning storm or when it is left unattended and unused for long periods of time. This will prevent damage to the product due to lightning and power-line surges.
10. **Overloading** – Do not overload wall sockets, extension cords, or integral convenience receptacles as this can result in a risk of fire or electric shock.
11. **Damage Requiring Service** – The unit should be serviced by qualified service personnel when:
 - A. the power supply cable or plug has been damaged.
 - B. objects have fallen into or liquid has been spilled into the enclosure.
 - C. the unit has been exposed to rain.
 - D. the unit has been dropped or the enclosure damaged.
 - E. the unit exhibits a marked change in performance or does not operate normally.
12. **Periods of Nonuse** – If the unit is to be left unused for an extended period of time, such as a month or longer, make sure to charge the unit before storing and periodically during storage to maintain battery.
13. **Servicing** – The user should not attempt to service the unit beyond those methods described in the user's operating instructions. Service methods not covered in the operating instructions should be referred to qualified service personnel.

Questions? Visit www.ihome.com
or call 1-800-288-2792 Toll Free

K1**FCC/IC Information**

FCC ID: EMOIKN150

IC : 986B-IKN150

FCC Radiation Exposure Statement

This equipment complies with FCC RF radiation exposure limits set forth for an uncontrolled environment. This transmitter must not be collocated or operating in conjunction with any other antenna or transmitter.

This device complies with Industry Canada licence-exempt RSS standard(s). Operation is subject to the following two conditions:

- (1) This device may not cause interference, and
- (2) This device must accept any interference, including interference that may cause undesired operation of the device.

This device complies with Part 15 of the FCC Rules, operation is subject to the following two conditions:
(1) This device may not cause harmful interference, and
(2) this device must accept any interference received, including interference that may cause undesired operation.

- Warning: Changes or modifications to this unit not expressly approved by the party responsible for compliance could void the user's authority to operate the equipment.
- NOTE: This equipment has been tested and found to comply with the limits for a Class B digital device, pursuant to Part 15 of the FCC Rules.

These limits are designed to provide reasonable protection against harmful interference in a residential installation. This equipment generates, uses and can radiate radio frequency energy and, if not installed and used in accordance with the instructions, may cause harmful interference to radio communications.

However, there is no guarantee that interference will not occur in a particular installation. If this equipment does cause harmful interference to radio or television reception, which can be determined by turning the equipment off and on, the user is encouraged to try to correct the interference by one or more of the following measures:

- Reorient or relocate the receiving antenna.
- Increase the separation between the equipment and receiver.
- Connect the equipment into an outlet on a circuit different from that to which the receiver is connected.
- Consult the dealer or an experienced radio/TV technician for help.

CAN ICES-3 (B)/NMB-3(B)

The device meets the exemption from the routine evaluation limits in section 2.5 of RSS 102 and compliance with RSS-102 RF exposure, users can obtain Canadian information on RF exposure and compliance.

Declaration ID : D024962

Troubleshooting

Unit doesn't respond (no power)

- Check that unit is fully charged OR connected to AC power.
- Make sure your device is properly paired with the K1.
- Make sure the **Power** is ON.
- If the unit seems "frozen" or locked up, insert the end of a paperclip or similar into the Reset button under the jack cover on the left of the unit to reset unit.

Resetting Bluetooth

If Bluetooth function is not operating properly, you may wish to reset Bluetooth. To do so, *press and hold* the **Bluetooth Button** 10 seconds. You will hear a long high tone. You will then need to re-pair any previously paired devices.

K-Cell Won't Eject

If the K-Cell won't eject even after pressing the K-Cell Eject Button, you can turn the unit over and insert the end of a paper clip or similar into the Battery Release pinhole port located on the bottom of the unit.

Trouble pairing device/computer with K1

Bluetooth implementation varies depending on your device's hardware and operating system. Please see our website for updates on pairing.

- Make sure you have the latest firmware for your device.
- Make sure your device is working properly. Check your device's manual for details on Bluetooth pairing and linking.
- When you power ON the speaker, it will automatically link with the last previously paired Bluetooth device if the device is still within range (approx. 30 feet). To pair with a different device you must turn off Bluetooth capability on the already paired device, or take it out of range.

For further information and to see the latest instructions, visit www.ihome.com/support

Limited 1 Year Warranty

iHome Products, a division of SDI Technologies Inc. (hereafter referred to as SDI), warrants this product to be free from defects in workmanship and materials, under normal use and conditions, for a period of one (1) year from the date of original purchase. Should this product fail to function in a satisfactory manner, it is best to first return it to the store where it was originally purchased. Should this fail to resolve the matter and service still be required by reason of any defect or malfunction during the warranty period, SDI will repair or, at its discretion, replace this product without charge. This decision is subject to verification of the defect or malfunction upon delivery of this product to the Factory Service Center authorized by Customer Service. If service is required, please call Customer Service at 1-800-288-2792 to obtain a Return Authorization Number and shipping instructions.

Disclaimer of Warranty

NOTE: This warranty is valid only if the product is used for the purpose for which it was designed. It does not cover (i) products which have been damaged by negligence or willful actions, misuse or accident, or which have been modified or repaired by unauthorized persons; (ii) cracked or broken cabinets, or units damaged by excessive heat; (iii) damage to digital media players, CD's or tape cassettes (if applicable); (iv) the cost of shipping this product to the Factory Service Center and its return to the owner. This warranty is valid only in the United States of America and does not extend to owners of the product other than to the original purchaser. In no event will SDI or any of its affiliates, contractors, resellers, their officers, directors, shareholders, members or agents be liable to you or any third party for any consequential or incidental damages, any lost profits, actual, exemplary or punitive damages. (Some states do not allow limitations on implied warranties or exclusion of consequential damages, so these restrictions may not apply to you.) This warranty gives you specific legal rights, and you may also have other rights which vary from state to state. Your acknowledgment and agreement to fully and completely abide by the above mentioned disclaimer of warranty is contractually binding to you upon your transfer of currency (money order, cashier's check, or credit card) for purchase of your SDI product.

© 2014 SDI Technologies, Inc. All rights reserved.
Questions? Visit www.ihome.com
or call 1-800-288-2792 Toll Free