





works with

-  **iHome Connect**
Wi-Fi Network Setup app
-  **iHome+Sleep**
FREE alarm clock app
-  **iHome+Radio**
FREE alarm clock app

available on the App Store

iW1 User Manual

AirPlay wireless speaker system with rechargeable battery



Welcome to the iHome iW1

Thank you for choosing iHome. The iHome Air Series marks a new frontier of product offerings that embrace Wi-Fi connectivity and AirPlay, Apple's new wireless streaming technology.

The iHome iW1 with AirPlay offers the latest experience in home audio entertainment allowing users to stream digital audio over Wi-Fi from iTunes, iPad, iPhone and iPod touch. Featuring Bongiovi Acoustics DPS technology and built-in rechargeable lithium-ion battery, the iW1 enables both fidelity audio that is truly wireless.

You can use the iW1 to:

- Play audio directly from iTunes on your Mac or PC using your home Wi-Fi network
- Stream your favorite music from your iPad, iPhone, or iPod touch from your iPod library or popular music apps like PANDORA® and iheartradio®, available on the App Store
- Dock, charge, and play audio with your iPhone and iPod with included USB sync cable
- Enjoy true wireless audio anywhere around the house with the iW1's rechargeable battery, convenient charging base and carrying handle
- Add Multiple iW1 speakers to enjoy multi-room audio anywhere in the home
- Download and enjoy iHome+apps available on the App Store:
 - iHome+Sleep, a free music alarm clock app
 - iHome+Radio, a internet radio music app
 - iHome Connect, a network setup app for iHome AirPlay enabled products

Keep reading to discover everything you need to know to get the most from your iHome iW1.



iW1 Overview

Contents

1. iW1 speaker
2. Charging base
3. Power adaptor
4. USB sync cable
5. Remote control
6. Document pack



charging base



power adaptor

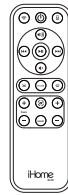

remote



USB sync cable

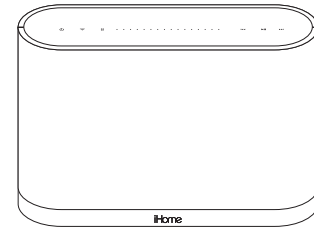

iW1 Speaker

Compatibility



USB connector works with:

iPod touch (1st, 2nd, 3rd, and 4th generation), iPod nano (2nd, 3rd, 4th, 5th, and 6th generation), iPhone 4, iPhone 3GS, and iPhone 3G.



AirPlay works with:

iTunes, iPod touch (2nd, 3rd, and 4th generation), iPhone 4, iPhone 3GS, iPhone 3G, iPad 2, and iPad.

For AirPlay, the iW1 must be connected to Wi-Fi with networked access to a Mac or PC running iTunes 10.1 or later; or an iPad, iPhone, or iPod touch running iOS 4.2 or later.



iHome Apps:

iHome+Sleep and iHome+Radio, and iHome Connect apps only work with iPad, iPhone, iPod touch and requires iOS 4.0 or later

Maintenance

Place the unit on a level surface away from sources of direct sunlight or excessive heat.

Protect your furniture when placing your unit on a natural wood and lacquered finish. A cloth or other protective material should be placed between it and the furniture.

Clean your unit with a soft cloth moistened only with mild soap and water. Stronger cleaning agents, such as Benzene thinner or similar materials can damage the surface of the unit.



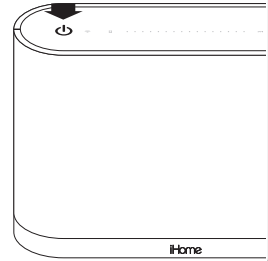
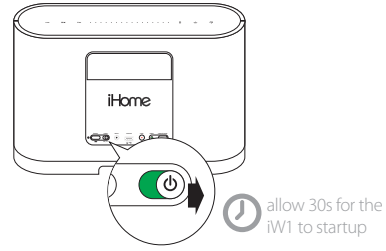
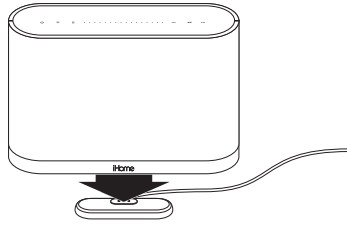
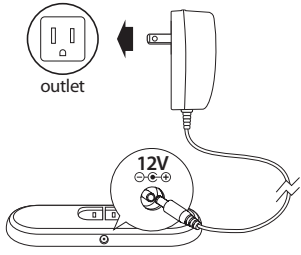

Quick Start

Connect, Charge, & Power On

- 1 Connect to power source
- 2 Place iW1 on charging base
- 3 Turn master power switch ON
- 4 Press  power button



iPod Local Audio Mode

- 1 Dock iPod/iPhone using iPod USB sync cable (iPod and aux-in play in parallel)
- 2 Press  for iPod mode
- 3 Press    buttons on the iW1 or iW1 remote, in iPod mode, to control your iPod music.

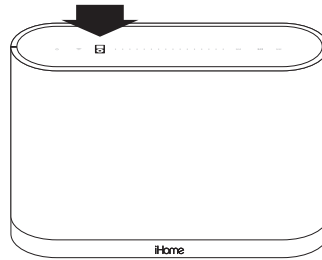
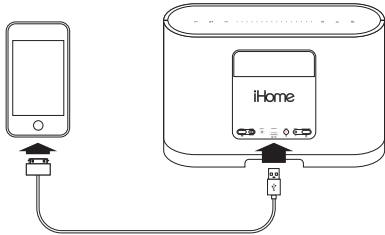

Adjust **volume** by swiping:



Note: Use iPod mode for both iPod docking and Aux-in audio playback.

AirPlay Wireless Audio Mode (visit pages 8-9 for Wi-Fi network configuration)

- 1 Verify that your iW1 speaker is successfully connected to your Wi-Fi network. (visit page for connecting your iW1 speaker to your Wi-Fi network)
- 2 Press  for AirPlay wireless mode
- 3 Launch iTunes or use your iPad, iPhone, iPad touch. Verify iW1 and AirPlay source device is on same Wi-Fi network.

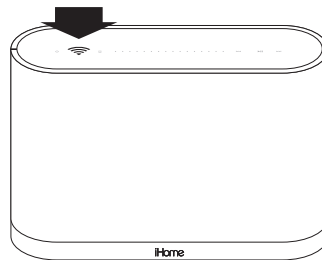
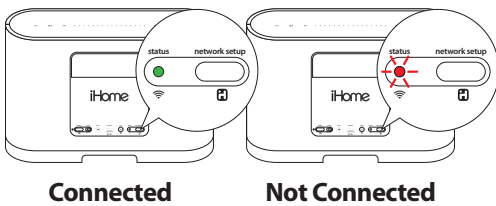

AirPlay only works with iPod touch, iPhone, iPad, or iTunes (Mac or PC)

- 4 Select the iHome iW1 as your AirPlay audio speaker
- 5 Press    buttons on the iW1 or use your iTunes, iPad, iPhone, or iPod touch controls directly.

! *Note:* for AirPlay streaming:

iPad, iPhone, and iPod touch support point-to-point audio streaming to one AirPlay enabled speaker.

iTunes supports point-to-multipoint audio streaming to up to three AirPlay enabled speakers (performance depends on your Wi-Fi network and environment).



Look for the AirPlay logo to select your speaker

iW1 Controls

TOP PANEL

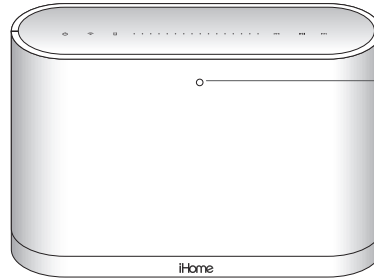
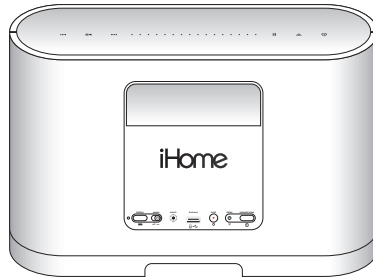
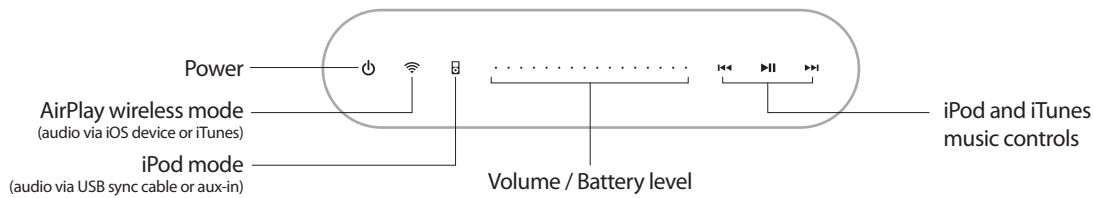

Status LED

- OFF when battery is fully charged
- Green when touching a button on unit/remote
- Green, blinking when volume is muted
- Amber, solid when battery is charging
- Red, blinking when battery needs charging

REAR PANEL

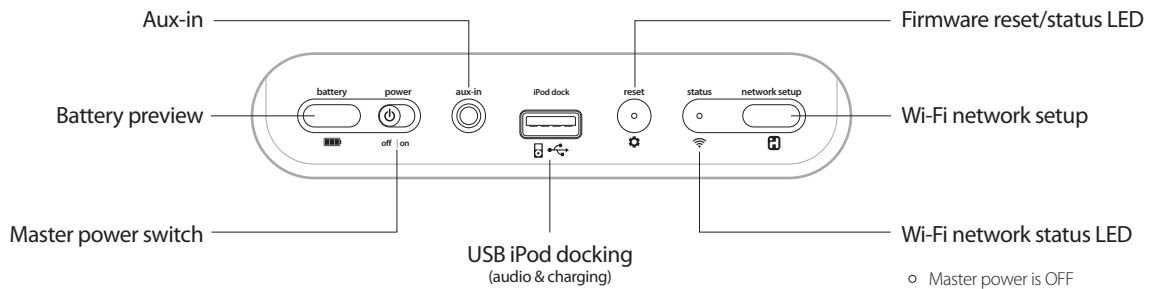

- Master power is OFF
- Green, solid when connected to a Wi-Fi network
- Red, blinking when NOT connected to a Wi-Fi network

REMOTE

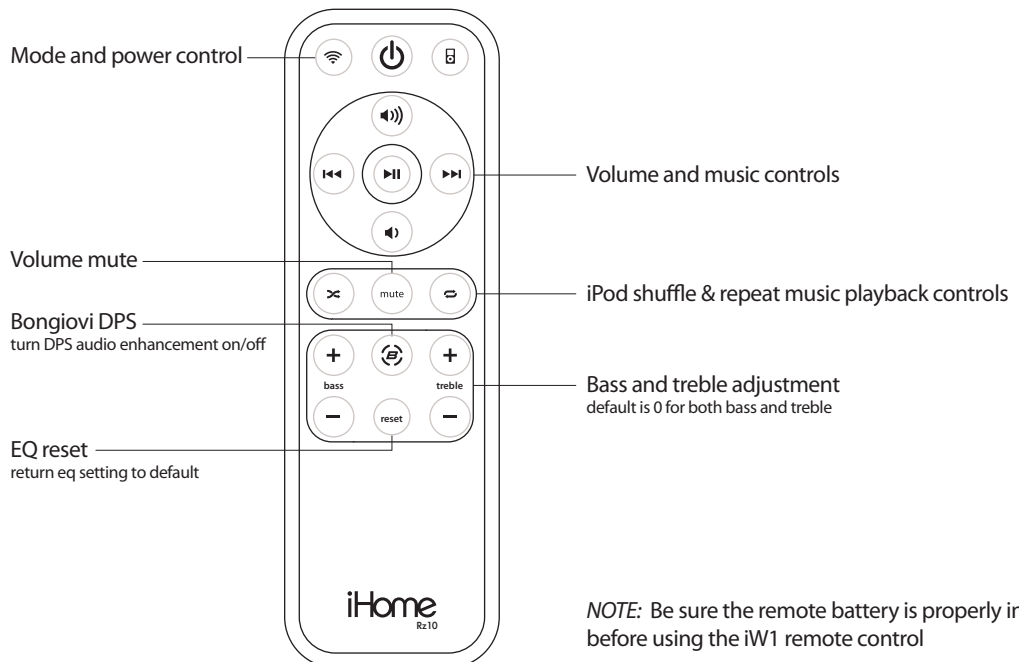

NOTE: Be sure the remote battery is properly installed before using the iW1 remote control

Getting Started

Master Power Switch

The iW1 has a master power switch that is used to power the unit ON or OFF, help conserve battery life, and reset the iW1 speaker. In order for the iW1 speaker to power ON, the battery must be charged or unit must be connect to a AC outlet.

Master Power ON - Slide the **Master Power Switch** to the ON position (on rear panel) to activate your iW1 speaker.
Master Power OFF - Slide the **Master Power Switch** to the OFF position to power the iW1 speaker OFF.



Note: The iW1 in the Master Power OFF state will only allow charging of the iW1's internal battery and will not support iPod/iPhone charging, remote control commands, AirPlay, network setup, nor Firmware Updates.

Powering your iW1 speaker ON

To power the iW1 speaker ON:

1. Plug **AC adaptor** into **Charging Base**, and plug into a live AC wall outlet.
2. Place the **iW1 Speaker** on top of the **Charging Base**.
3. Slide the **Master Power Switch** to the ON position (on rear panel).

Note: Allow 30 seconds for the speaker to startup before interacting with the iW1 speaker.

4. Press the **Power** button to switch between power ON and Standby mode.

The iW1 speaker will power ON to the last state.

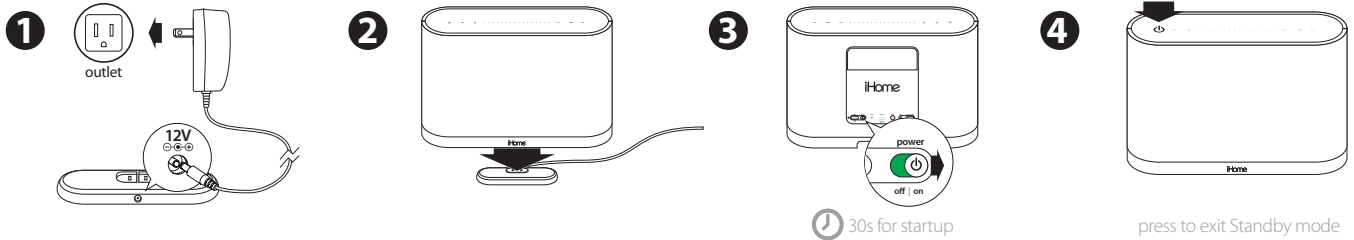

Rechargeable Battery

The iW1 speaker has an internal rechargeable battery and supports audio playback any where in the home when the battery is charged or docked on it's charging base with an AC adaptor.

To Charge the Battery:

1. Plug **AC adaptor** into **Charging Base**, and plug into a live AC wall outlet.
2. Dock **iW1 Speaker** on top of **Charging Base**.

To view the Battery level status:

Press the **Battery Preview** button to view the charge status of the iW1's internal battery on the top volume control panel.

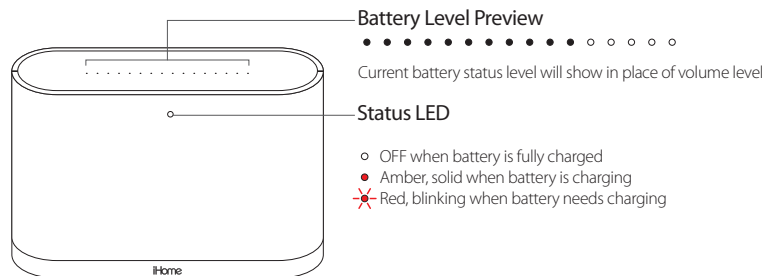

Using your iW1

Capacitance top panel controls

The iW1 speaker has a backlit capacitance touch panel control interface for power, mode, volume, and music controls. Controls will be lit according to the status of the iW1 speaker and the selected mode.

Note: Moisture and wet hands will cause issues with the ability of the iW1 to detect user interactions. Each control will flash once when pressed.

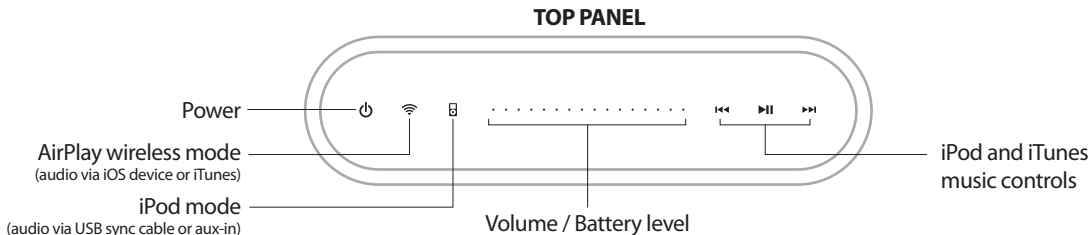

Standby mode

Standby Mode (master power switch is ON):



Press the **Power** button to place the iW1 speaker in standby mode and stop audio playback. The **Power** button will pulse on/off to indicate the unit is in standby mode.

Power ON modes

iPod Mode (iPod/iPhone detected via USB dock connector):

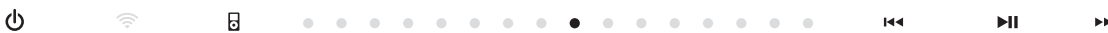

iPod Mode (iPod/iPhone not detected via USB dock connector):



AirPlay Wireless Mode (connected to a Wi-Fi network):



AirPlay Wireless Mode (not connected to a Wi-Fi network):



Note: The **AirPlay Wireless** button will continuously flash on/off to indicate that the iW1 is not linked to a network when ON and in AirPlay Wireless mode.

Volume

Press a specific volume level or slide your finger to the preferred volume level when changing the iW1 speaker's volume on the unit.



Wi-Fi Network Setup for AirPlay

Check list

Please verify the following steps before attempting to connect your iW1 speaker to a Wi-Fi network:

- ✓ To enjoy AirPlay wireless audio, you must have the following:
 - iTunes or an iOS device (iPod touch, iPhone, or iPad).
 - A functioning home network with Wi-Fi.
- ✓ Download the latest software updates for iTunes and your iOS device to ensure that you are able to enjoy the latest AirPlay enhancements and compatibility.
- ✓ Download the iHome Connect app for iPod touch, iPhone and iPad.
- ✓ Have your Wi-Fi network name (SSID) and password (if applicable) available for reference.

Note: AirPlay requires iTunes 10.1 (Mac and PC) or later; OR an iPad, iPad 2, iPhone 4, iPhone 3GS, iPod touch (4th, 3rd, and 2nd generations) with iOS 4.2 or later. The iHome Connect app requires iOS 4.0 or later.

Option A - Connecting with your iPod touch, iPhone, or iPad (Recommended)

If you have an iPod touch, iPhone, or iPad with iOS 4.0 or later, we recommend that you use our free iHome Connect app for the quickest network setup experience.

To connect your iW1 speaker to a Wi-Fi network using an iOS device, follow these steps:

1. Dock your iOS device to the iW1 using the included iPod **USB sync cable**.

2. Download our free  **iHome Connect** app from the App Store and launch the app.

3. Select your preferred Wi-Fi network from the list of available networks and enter password if prompted.

4. Rename your iW1 speaker and press 'Save'.

Note: Connecting to a network may take up to 60 seconds.

Success!

Congratulations, you have successfully connected your iW1 to your wireless network and now you can start enjoying wireless audio anywhere in your home or office. Verify that the Network Status LED is green and then keep reading to learn how to use the iW1 and control your iTunes and iOS audio content using AirPlay.

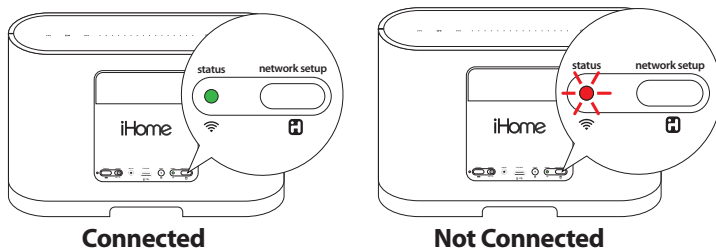

Note: To begin using AirPlay wireless streaming, your AirPlay source devices (Mac or PC with your iTunes library as well as your iPod touch, iPhone or iPad) must be connected to the same Wi-Fi network that the iW1 speaker is connected to.

1

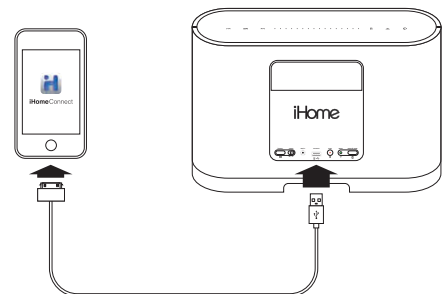

3

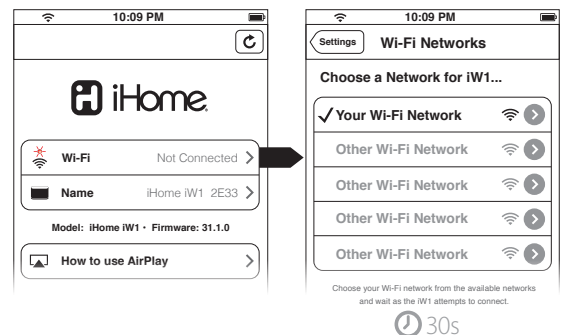

4

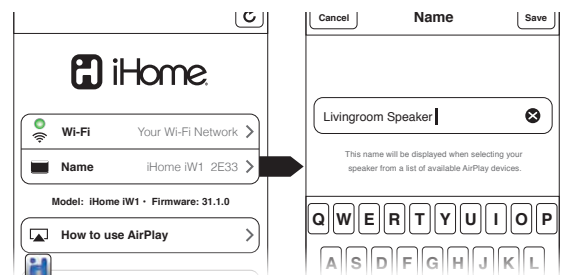

Problem?

Reset the iW1 Speaker:

- Unplug the AC jack/remove the iW1 from the charging base
- Slide the rear Power Switch to the OFF and then ON position
- Reconnect AC jack, place iW1 on charging base and wait 30s
- Repeat iW1 Wi-Fi Network Setup process if necessary

Wi-Fi Network Setup continued...

Option B - Connecting with your Mac or PC over Wi-Fi

To connect your iW1 speaker to a Wi-Fi network using a Mac or PC, follow these steps:

1. iW1 Hardware Reset:

- Unplug the AC jack/remove the iW1 from the charging base.
- Slide the rear Power Switch to the OFF and then ON position.
- Reconnect AC jack, place iW1 on charging base, and wait 30 sec.

2. Press and hold (5 sec.) **Network Setup** button on the back of unit.

Note: The Network Status LED will begin flashing green and the top control panel will also flash.

3. On your Mac or PC, select the network called "iHome Setup XXXX" from Wi-Fi network settings.

Note: This process can take up to 2 minutes. Be patient and refresh your network list if necessary.

4. Launch a web browser (ex. Safari or Explorer) and enter <http://169.254.1.1> in the address bar.

Note: If the page is not initially available or becomes unresponsive, reload the page. See "troubleshooting" if problem persists.

5. Rename the iW1 speaker and click 'Save'. (optional)

6. Select preferred Wi-Fi network from the list of available and click 'Join Network'.

Note: Connecting to a network may take up to 60 seconds.

Success!

Congratulations, you have successfully connected your iW1 to your wireless network and now you can start enjoying wireless audio anywhere in your home or office. Verify that the Network Status LED is green and then keep reading to learn how to use the iW1 and control your iTunes and iOS audio content using AirPlay.

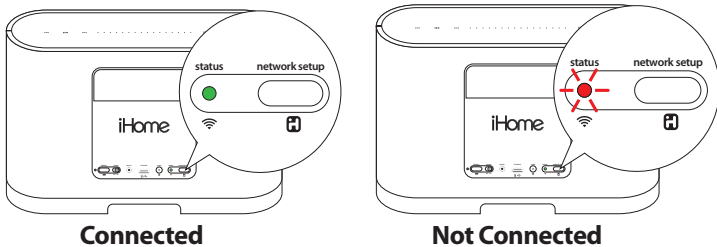

Note: To begin using AirPlay wireless streaming, your AirPlay source devices (Mac or PC with your iTunes library as well as your iPod touch, iPhone or iPad) must be connected to the same Wi-Fi network that the iW1 speaker is connected to.

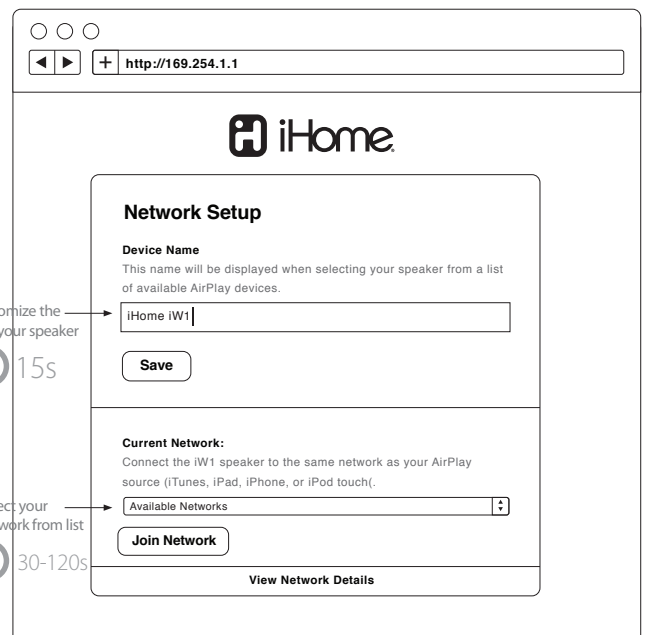
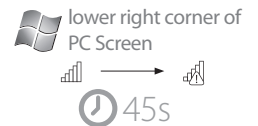
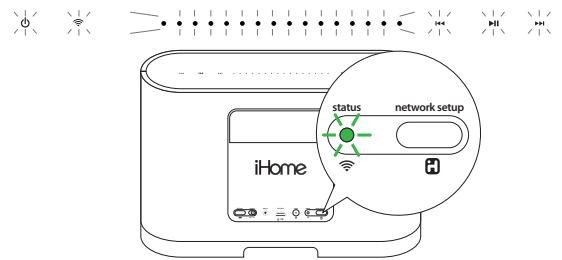

Problem?

Reset the iW1 Speaker:

- Unplug the AC jack/remove the iW1 from the charging base
- Slide the rear Power Switch to the OFF and then ON position
- Reconnect AC jack, place iW1 on charging base and wait 30s
- Repeat iW1 Wi-Fi Network Setup process if necessary

Music Connectivity





Connecting to the iW1 speaker

You can connect to your iHome iW1 speaker three different ways:

1. Using AirPlay® to stream wirelessly from iTunes or your iPad, iPhone, and iPod touch.
2. Using the USB iPod docking port on the rear panel with a iPod USB sync cable for audio and charging your iPod or iPhone.
3. Using an auxiliary audio device (mp3 or CD player) connected to the aux-in port on the rear panel.



AirPlay & iPod touch, iPhone, or iPad

Using an iOS device:

1. Connect your iOS device to the same Wi-Fi network as iW1. Go to  Settings -->  Wi-Fi on your iOS device.
2. Tap on  iPod/Music app, look for the  AirPlay button next to the iPod music transport controls.
3. Tap on the  AirPlay icon and choose iW1 from the list of speakers.
If the iW1 speaker is not available, restart your iOS device and verify that the iW1 is powered on.
4. Press play.





AirPlay & iTunes

Using a Mac or PC with iTunes:

1. Connect your Mac or PC to the same Wi-Fi network as iW1.
2. Open  iTunes on your computer.
3. Within iTunes open "Preferences", Select the "Devices" tab, and activate the following option:
"Allow iTunes control from remote speakers"
4. Click OK, close iTunes preferences.
5. Look for the  AirPlay icon in the bottom right corner of the iTunes window.
6. Click the  AirPlay icon and choose iW1 from the list of speakers. Click "Multiple Speakers..." to select additional AirPlay speakers.
If the iW1 speaker is not available, restart iTunes and verify that the iW1 is powered on.
7. Press play.





AirPlay Wireless Audio Mode

Enjoy AirPlay audio anywhere:

1. Press  to exit standby mode and power the iW1 ON.
2. Press  for wireless audio mode and listen to AirPlay music.
3. Use    buttons on the iW1 or iW1 remote to control streaming AirPlay content.

Local iPod Audio Mode

Dock, Charge, & Play using iPod USB sync cable or dock:

1. Connect USB sync cable to iW1's USB port.
2. Press  Local Playback mode button and enjoy iPod and iPhone charging and audio playback.
3. Using    buttons on the iW1 or iW1 remote, in iPod mode, will control your iPod music.

Note: Use iPod mode for both iPod docking and Aux-in audio playback.

Control

BonGiovì DPS

The iW1 uses a DSP solution provided by BonGiovì Acoustics. This function is on by default and can only be turned off or on with the IR remote. Front Status LED will flash Green when DSP is turned OFF or ON via the remote and then return to last status settings.

EQ

The iW1 has a EQ feature that is controlled via the remote, that adjusts Bass and Treble.

TREBLE +/- buttons: Adjust treble levels between -5 and +5. Default is 0

BASS +/- buttons: Adjust bass levels between -5 and +5. Default is 0

NOTE: The Front Status LED will flash Green 3 times when the eq reaches maximum or minimum and then return to last status settings.

RESET button (remote): Resets EQ adjustments to the following state: Bass:0, Treble:0.

NOTE: When Reset button is pressed, Top Panel LEDs will flash 2 times and then return to last status settings.

Firmware update

iW1 Speaker Firmware Updates

As changes to AirPlay are made over time and new devices are introduced that support AirPlay audio, it may be necessary to update the firmware of your iW1 speaker to ensure the latest compatibility and optimal functionality. The iW1's firmware can be updated using a USB Mass Storage device containing a new firmware image downloaded by the user from ihomeaudio.com

Using a USB Mass Storage device:

1. Download the latest firmware from www.ihomeaudio.com/airplay/support to your computer
2. Load downloaded firmware to a USB mass storage device.
3. Connect USB device
4. Press & Hold  (3 sec).
5. iW1 will scan for firmware file local to the USB device.

If a valid firmware file is found, iW1 firmware will update. If no valid firmware is found user must reset the iW1, load the proper file on USB stick, and attempt Firmware update again.

During Firware Update:

When Firmware is being Updated, All top panel controls will PULSE and be inactive. All buttons are inactive except for Reset button. If firmware update is successful, a confirmation (positive) tone will sound.



Troubleshooting

Problem	Solution
I am unable to connect the iW1 to my home Wi-Fi network.	<ol style="list-style-type: none">1. Verify that your Wi-Fi network is functioning.2. Move the iW1 closer to your network access point; the Wi-Fi signal is weak or the iW1 is out of range of your Wi-Fi network.3. iW1 Hardware Reset:<ul style="list-style-type: none">- Unplug the AC jack/remove the iW1 from the charging base.- Slide the rear Power Switch to the OFF and then ON position.- Reconnect AC jack, place iW1 on charging base and wait 30 sec. for the iW1 speaker to restart.
I've successfully connected the iW1 to my home network, but I cannot select the iW1 speaker from iTunes or my iOS Device.	<ol style="list-style-type: none">1. The iW1 speaker must be on the same Wi-Fi network as your AirPlay source.2. Verify you have the latest version of iTunes and/or iOS.3. Try restarting iTunes or your iOS device. <p><i>Note: The original iPhone, iPhone 3G, and iPod touch (1st generation) do not support AirPlay.</i></p>
I've selected the iW1 speaker as my AirPlay audio source, but I do not hear any music.	<ol style="list-style-type: none">1. Verify that the volume is not muted or set to 0.2. Verify that there is not another iTunes library or iOS device connected to the iW1 speaker.3. Try restarting iTunes or your iOS device.
The iW1 doesn't respond or doesn't turn ON.	<ol style="list-style-type: none">1. Verify that the adaptor is connected and the power outlet is always 'live' (not controlled by a wall switch).2. iW1 Hardware Reset:<ul style="list-style-type: none">- Unplug the AC jack/remove the iW1 from the charging base.- Slide the rear Power Switch to the OFF and then ON position.- Reconnect AC jack, place iW1 on charging base and wait 30 sec.

Questions? Visit www.ihomeaudio.com

Consumer Product Safety Guide

Safety Instructions

- Water and Moisture** – The unit should not be used near water. For example: near a bathtub, washbowl, kitchen sink, laundry tub, swimming pool or in a wet basement.
- Ventilation** – The unit should be situated so that its location or position does not interfere with its proper ventilation. For example, it should not be situated on a bed, sofa, rug or similar surface that may block ventilation openings. Also, it should not be placed in a built-in installation, such as a bookcase or cabinet, which may impede the flow of air through the ventilation openings.
- Heat** – The unit should be situated away from heat sources such as radiators, heat registers, stoves or other appliances (including amplifiers) that produce heat.
- Power Sources** – The unit should be connected to a power supply only of the type described in the operating instructions or as marked on the appliance.
- Power Cable Protection** – Power supply cables should be routed so that they are not likely to be walked on or pinched by items placed upon or against them. It is always best to have a clear area from where the cable exits the unit to where it is plugged into an AC socket.
- Cleaning** – The unit should be cleaned only as recommended. See the Maintenance section of this manual for cleaning instructions.
- Objects and Liquid Entry** – Care should be taken so that objects do not fall and liquids are not spilled into any openings or vents located on the product.
- Attachments** – Do not use attachments not recommended by the product manufacturer.
- Lightning and Power Surge Protection** – Unplug the unit from the wall socket and disconnect the antenna or cable system during a lightning storm or when it is left unattended and unused for long periods of time. This will prevent damage to the product due to lightning and power-line surges.
- Overloading** – Do not overload wall sockets, extension cords, or integral convenience receptacles as this can result in a risk of fire or electric shock.
- Damage Requiring Service** – The unit should be serviced by qualified service personnel when:
 - the power supply cable or plug has been damaged.
 - objects have fallen into or liquid has been spilled into the enclosure.
 - the unit has been exposed to rain.
 - the unit has been dropped or the enclosure damaged.
 - the unit exhibits a marked change in performance or does not operate normally.
- Antenna** – Do not connect an external antenna to the unit (other than that provided).
- Periods of None Use** – If the unit is to be left unused for an extended period of time, such as a month or longer, the power cable should be unplugged from the unit to prevent damage or corrosion.
- Servicing** – The user should not attempt to service the unit beyond those methods described in the user's operating instructions. Service methods not covered in the operating instructions should be referred to qualified service personnel.

FCC Radiation Exposure Statement

FCC ID: EMOIW1.IC: 986B-IW1

This equipment complies with FCC RF radiation exposure limits set forth for an uncontrolled environment. This transmitter must not be co-located or operating in conjunction with any other antenna or transmitter.

This Device complies with RSS-210 of the IC Rules; Operation is subject to the following two conditions:

- This device may not cause interference and
- This device must accept any interference received, including interference that may cause undesired operation

This device complies with FCC radiation exposure limits set forth for an uncontrolled environment and it also complies with Part 15 of the FCC RF Rules. Operation is subject to the following two conditions: (1) this device may not cause harmful interference, and (2) this device must accept any interference received, including interference that may cause undesired operation. (FCC15.19)

Le présent appareil est conforme aux CNR d'Industrie Canada applicables aux appareils radio exempts de licence. L'exploitation est autorisée aux deux conditions suivantes : (1) l'appareil ne doit pas produire de brouillage, et (2) l'utilisateur de l'appareil doit accepter tout brouillage radioélectrique subi, même si le brouillage est susceptible d'en compromettre le fonctionnement.

The device meets the exemption from the routine evaluation limits in section 2.5 of RSS 102 and compliance with RSS-102 RF exposure, users can obtain Canadian information on RF exposure and compliance.

Le dispositif rencontre l'exemption des limites courantes d'évaluation dans la section 2.5 de RSS 102 et la conformité à l'exposition de RSS-102 rf, utilisateurs peut obtenir l'information canadienne sur l'exposition et la conformité de rf.

This equipment complies with the limits for a Class B digital device as specified in Part 15 of FCC Rules. These limits provide reasonable protection against radio and TV interference in a residential area. However, your equipment might cause TV or radio interference even when it is operating properly. To eliminate interference you can try one or more of the following corrective measures:

- Reorient or relocate the receiving antenna.
- Increase the distance between the equipment and the radio or TV.
- Use outlets on different electrical circuits for the equipment and the radio or TV.
- Consult your dealer or an experienced radio/television technician if the problem still exists.

Modifying or tampering with your system's internal components can cause a malfunction and might invalidate the system's warranty and void your FCC authorization to operate it.

This Class B digital apparatus complies with Canadian ICES-003. Cet appareil numérique de la classe B est conforme à la norme NMB-003 du Canada.

Internal Rechargeable Lithium-ion Battery

This device uses an internal rechargeable lithium-ion battery that should last the lifetime of the device. If you suspect your battery may be dead, try charging it several times. If the battery does not recharge, please contact us for repair information.

WARNING/DISPOSAL OF UNIT

Please do NOT attempt to change the battery yourself. If the battery has died and you do not want us to replace your battery, you should follow the disposal instructions below:

- Never dispose of used batteries/electronics with ordinary solid wastes, since they contain toxic substances.
- Always dispose of used batteries/electronics in accordance with the prevailing community regulations that apply to the disposal of batteries/electronics. If there are no local regulations concerning battery/electronics disposal, please dispose of the device in a waste bin for electronic devices.
- Many electronics retailers now recycle batteries and other electronic components at no charge. Check to see which ones in your area do so.

CAUTION

The battery used in this device may present a risk of fire, explosion or chemical burn if mistreated.

- Never use or charge the battery if it appears to be leaking, discolored, deformed, or in any way abnormal.
- Never disassemble the unit or attempt to remove battery as that could cause leakage of alkaline solution or other electrolytic substance.
- Always confirm that the temperature is 5°C – 35°C (41° - 95° Fahrenheit) before you charge the battery. Leakage or deterioration of the battery may occur if this warning is not heeded.
- Never expose the battery to any liquid.
- Never expose the battery to excessive heat such as direct sunlight or fire.
- Never use the battery pack in an unventilated vehicle where excessive internal temperatures may be encountered.
- Always keep the battery out of the reach of infants and small children.

Warranty

Limited 1 Year Warranty Information

iHome, a division of SDI Technologies Inc. (hereafter referred to as SDI Technologies), warrants this product to be free from defects in workmanship and materials, under normal use and conditions, for a period of 1 Year from the date of original purchase.

Should this product fail to function in a satisfactory manner, it is best to first return it to the store where it was originally purchased. Should this fail to resolve the matter and service still be required by reason of any defect or malfunction during the warranty period, SDI Technologies will repair or, at its discretion, replace this product without charge (except for a \$60.00 charge for handling, packing, return UPS/postage, and insurance). This decision is subject to verification of the defect or malfunction upon delivery of this product to the Factory Service Center listed below. The product must include proof of purchase, including date of purchase. The fee for service without proof of purchase is \$100.00.

Before returning this product for service:

Before returning this product for service, please check our support section at www.ihomeaudio.com/support or call our customer service team to resolve any problems you may be experiencing.

If service is still required:

1. Pack unit in a well padded, heavy corrugated box.
2. Enclose a photocopy of your sales receipt, credit card statement, or other proof of the date of purchase, if within the warranty period.
3. Enclose a check or money order payable to the order of SDI Technologies, for the sum of \$60.00 (\$100.00 without proof of purchase).
4. Send the unit prepaid and insured, to the Factory Service Center listed below.

Consumer Repair Department

SDI Technologies Inc.
1330 Goodyear Dr.
El Paso, TX 79936-6420

Questions? Visit www.ihomeaudio.com/airplay/support

Toll Free Customer Service: 1-877-446-6301

©SDI Technologies 2011 All rights Reserved.

Disclaimer of Warranty:

NOTE: This warranty is valid only if the product is used for the purpose for which it was designed. It does not cover (i) products which have been damaged by negligence or willful actions, misuse or accident, or which have been modified or repaired by unauthorized persons; (ii) cracked or broken cabinets, or units damaged by excessive heat; (iii) damage to digital media players, computers, routers, CD's or tape cassettes (if applicable); (iv) the cost of shipping this product to the Factory Service Center and its return to the owner.

This warranty is valid only in the United States of America and does not extend to owners of the product other than to the original purchaser. In no event will SDI Technologies or any of its affiliates, contractors, resellers, their officers, directors, shareholders, members or agents be liable to you or any third party for any consequential or incidental damages, any lost profits, actual, exemplary or punitive damages. (Some states do not allow limitations on implied warranties or exclusion of consequential damages, so these restrictions may not apply to you.) This warranty gives you specific legal rights, and you may also have other rights which vary from state to state.

Your acknowledgment and agreement to fully and completely abide by the above mentioned disclaimer of warranty is contractually binding to you upon your transfer of currency (money order, cashier's check, or credit card) for purchase of your SDI Technologies product.

iHome
AIR SERIES

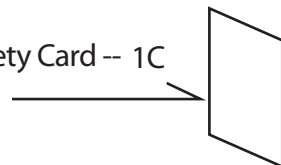

Important Safety Instructions

- Water and Moisture** – The unit should not be used near water. For example: near a bathtub, washbowl, kitchen sink, laundry tub, swimming pool or in a wet basement.
- Ventilation** – The unit should be situated so that its location or position does not interfere with its proper ventilation. For example, it should not be situated on a bed, sofa, rug or similar surface that may block ventilation openings. Also, it should not be placed in a built-in installation, such as a bookcase or cabinet, which may impede the flow of air through the ventilation openings.
- Heat** – The unit should be situated away from heat sources such as radiators, heat registers, stoves or other appliances (including amplifiers) that produce heat.
- Power Sources** – The unit should be connected to a power supply only of the type described in the operating instructions or as marked on the appliance.
- Power Cable Protection** – Power supply cables should be routed so that they are not likely to be walked on or pinched by items placed upon or against them. It is always best to have a clear area from where the cable exits the unit to where it is plugged into an AC socket.
- Cleaning** – The unit should be cleaned only as recommended. See the Maintenance section of this manual for cleaning instructions.
- Objects and Liquid Entry** – Care should be taken so that objects do not fall and liquids are not spilled into any openings or vents located on the product.
- Attachments** – Do not use attachments not recommended by the product manufacturer.
- Lightning and Power Surge Protection** – Unplug the unit from the wall socket and disconnect the antenna or cable system during a lightning storm or when it is left unattended and unused for long periods of time. This will prevent damage to the product due to lightning and power-line surges.
- Overloading** – Do not overload wall sockets, extension cords, or integral convenience receptacles as this can result in a risk of fire or electric shock.
- Damage Requiring Service** – The unit should be serviced by qualified service personnel when:
 - the power supply cable or plug has been damaged.
 - objects have fallen into or liquid has been spilled into the enclosure.
 - the unit has been exposed to rain.
 - the unit has been dropped or the enclosure damaged.
 - the unit exhibits a marked change in performance or does not operate normally.
- Antenna** – Do not connect an external antenna to the unit (other than that provided).
- Periods of None Use** – If the unit is to be left unused for an extended period of time, such as a month or longer, the power cable should be unplugged from the unit to prevent damage or corrosion.
- Servicing** – The user should not attempt to service the unit beyond those methods described in the user's operating instructions. Service methods not covered in the operating instructions should be referred to qualified service personnel.

Questions? Visit www.ihomeaudio.com

iW1 - Consumer Product Safety Guide

FCC Radiation Exposure Statement

FCC ID: EMOIW1 IC: 986B-IW1

This equipment complies with FCC RF radiation exposure limits set forth for an uncontrolled environment. This transmitter must not be co-located or operating in conjunction with any other antenna or transmitter.

This Device complies with RSS-210 of the IC Rules; Operation is subject to the following two conditions:

- This device may not cause interference and
- This device must accept any interference received, including interference that may cause undesired operation

This device complies with FCC radiation exposure limits set forth for an uncontrolled environment and it also complies with Part 15 of the FCC RF Rules. Operation is subject to the following two conditions: (1) this device may not cause harmful interference, and (2) this device must accept any interference received, including interference that may cause undesired operation. (FCC15.19)

Le présent appareil est conforme aux CNR d'Industrie Canada applicables aux appareils radio exempts de licence. L'exploitation est autorisée aux deux conditions suivantes : (1) l'appareil ne doit pas produire de brouillage, et (2) l'utilisateur de l'appareil doit accepter tout brouillage radioélectrique subi, même si le brouillage est susceptible d'en compromettre le fonctionnement.

The device meets the exemption from the routine evaluation limits in section 2.5 of RSS 102 and compliance with RSS-102 RF exposure, users can obtain Canadian information on RF exposure and compliance.

Le dispositif rencontre l'exemption des limites courantes d'évaluation dans la section 2.5 de RSS 102 et la conformité à l'exposition de RSS-102 rf, utilisateurs peut obtenir l'information canadienne sur l'exposition et la conformité de rf.

This equipment complies with the limits for a Class B digital device as specified in Part 15 of FCC Rules. These limits provide reasonable protection against radio and TV interference in a residential area. However, your equipment might cause TV or radio interference even when it is operating properly. To eliminate interference you can try one or more of the following corrective measures:

- Reorient or relocate the receiving antenna.
- Increase the distance between the equipment and the radio or TV.
- Use outlets on different electrical circuits for the equipment and the radio or TV.
- Consult your dealer or an experienced radio/television technician if the problem still exists.

Modifying or tampering with your system's internal components can cause a malfunction and might invalidate the system's warranty and void your FCC authorization to operate it.

The separation distance between the equipment and the user shall not be less than 20 cm

This Class B digital apparatus complies with Canadian ICES-003. Cet appareil numérique de la classe B est conforme à la norme NMB-003 du Canada.

Internal Rechargeable Lithium-ion Battery

This device uses an internal rechargeable lithium-ion battery that should last the lifetime of the device. If you suspect your battery may be dead, try charging it several times. If the battery does not recharge, please contact us for repair information.

WARNING/DISPOSAL OF UNIT

Please do NOT attempt to change the battery yourself. If the battery has died and you do not want us to replace your battery, you should follow the disposal instructions below:

- Never dispose of used batteries/electronics with ordinary solid wastes, since they contain toxic substances.
- Always dispose of used batteries/electronics in accordance with the prevailing community regulations that apply to the disposal of batteries/electronics. If there are no local regulations concerning battery/electronics disposal, please dispose of the device in a waste bin for electronic devices.
- Many electronics retailers now recycle batteries and other electronic components at no charge. Check to see which ones in your area do so.

CAUTION

The battery used in this device may present a risk of fire, explosion or chemical burn if mistreated.

- Never use or charge the battery if it appears to be leaking, discolored, deformed, or in any way abnormal.
- Never disassemble the unit or attempt to remove battery as that could cause leakage of alkaline solution or other electrolytic substance.
- Always confirm that the temperature is 5°C – 35° C (41° - 95° Fahrenheit) before you charge the battery. Leakage or deterioration of the battery may occur if this warning is not heeded.
- Never expose the battery to any liquid.
- Never expose the battery to excessive heat such as direct sunlight or fire.
- Never use the battery pack in an unventilated vehicle where excessive internal temperatures may be encountered.
- Always keep the battery out of the reach of infants and small children.

July 14, 2011
Revised