

There is one audio output on the rear panel: unbalanced 1/4" TRS phone jack. Use shielded audio cable for the connection between the receiver and the mixer or speaker.

Output Connection

For best operation the receiver should be at least 1 meter above the ground and at least 1 meter away from a wall or metal surface to minimize reflection. Keep the receiver antenna away from noise sources such as other digital equipment, microwave ovens, as well as away from large metal objects. Keep DW-24R receiver 9 meters away from wireless access points.

Location

RECEIVER INSTALLATION

- Apply to KTV, Home, Classroom, Conference, Audio Equipment
- Low-cost design
- Power/pairing status indicator
- More than 25 meters transmit distance in open place
- One receiver can match with several transmitters though one transmitter can be used at once
- Memorize matched devices
- Automatic mute in bad channel quality or high error code rate
- Intelligent Frequency Hopping
- GFSK digital modulation/demodulation
- Operating Band: ISM 2.4 GHz free band

FEATURES

Thank you for purchasing the DW-24H/R/P digital wireless system. It works in ISM 2.4 GHz free band. With the intelligent frequency hopping it can help to avoid interference effectively and ensure the working quality. It is intelligent as it can mute automatically in bad channel quality or high error code rate. It uses the GFSK to be digital modulation/demodulation. It can memorize the matched devices and one DW-24R receiver can match with several DW-24H and DW-24P transmitters though only one DW-24H or DW-24P transmitter can be used once. The transmit distance is more than 25 meters in open space. It is suitable for using in KTV, home, classroom, conference and other audio equipment.

INTRODUCTION

DW-24 Installation and Operation

DW-24 Installation and Operation

As the system can memorize the pairing devices, once you paired them together you can use them without re-pairing until you have exit the pairing by pairing DW-24H or DW-24P with other receiver. Though one DW-24R receiver can pair with lots of DW-24H and DW-24P, only one transmitter (either DW-24H or DW-24P) can be used once. The last pairing successful transmitter will be the active transmitter until it powered off or exited the pairing. So if you paired two transmitters with DW-24R and want to use the first transmitter, you should power off the second transmitter.

SPECIFICATIONS

DW-24R Receiver

Frequency	2404 - 2472GHz
RF Sensitivity	-78dBm
Transmission Distance	> 25m (distance insight)
Frequency Response	50Hz ~ 15KHz (16bit ~ 38.4KHz)
Distortion	0.05@1KHz
SNR	>89dB
Transmission Delay	18ms
Power Supply	DC12V --- 200mA

DW-24H /DW-24P Body Pack Transmitter

Carrier Frequency	2404 - 2472GHz
Transmitting Power	8 dBm MAX ERP (Effective Radiated Power)
Transmission Distance	> 25m (distance insight)
Frequency Response	50Hz ~ 15KHz (16bit ~ 38.4KHz)
Distortion	0.05@1KHz
SNR	>89dB
Transmission Delay	18ms
Power Supply	AA* 2
Battery Life	> 20 hours

The apparatus shall be connected to a mains socket outlet with a protective earthing connection.

Never cut off the internal or external protective grounding wire or disconnect the wiring of protective grounding terminal.

Before turning the product ON, make sure that it is connected to Ground. This is to prevent the risk of electric shock. Never cut internal or external Ground wires. Likewise, never remove Ground wiring from the Protective Ground Terminal.

Disposing of this product should not be placed in municipal waste and should be separate collection.

Before replacing the fuse, turn OFF the apparatus and disconnected the power source.

To prevent a fire, make sure to use fuses with specified standard (current, voltage, type). Do not use a different fuse or short circuit the fuse holder.

No user serviceable parts inside.

The cover should be removed by the qualified personnel only.

There are maybe some areas with high voltages inside, to reduce the risk of electric shock, do not remove any cover if the power supply is connected.

The external wiring connected to the output hazardous live terminals requires installation by an instructed person, or the use of ready-made leads or cords.

The symbol is used to indicate that some hazardous live terminals are involved within this apparatus, even under the normal operating conditions.

The symbol is used to indicate that documentation for safety reasons.

Protective grounding terminal.

Alternating current (voltage).

Hazardous live terminal.

ON: Denotes the apparatus turns on.

OFF: Denotes the apparatus turns off.

CAUTION: Describes precautions that should be observed to prevent the danger of injury or death to the user.

WARNING: Describes precautions that should be observed to prevent danger of the apparatus.

Power Supply

Ensure the source voltage matches the voltage of the power supply before plugging.



SAFETY RELATED SYMBOLS

DW-24 Installation and Operation

DW-24

Digital Wireless System
Installation and Operation



DW-24R

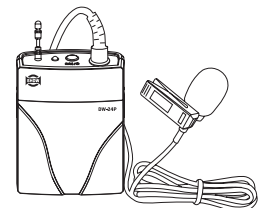

DW-24P

WARNING: changes or modifications not expressly approved by the party responsible for compliance could void the user's authority to operate the equipment.

This device complies with Part 15 of the FCC Rules. Operation is subject to the following two conditions: (1) this device may not cause harmful interference, and (2) this device must accept any interference received, including interference that may cause undesired operation.



DW-24H



Power Connection

Connect the supplied power adapter to the DC power input on the back of the receiver. Please keep the plug from being detached by an accidental tug on the cord.

The receiver has no power Off / On switch. The receiver will be energized whenever the power adapter is connected and plugged into the AC outlet. Unplug the power supply from the AC outlet when the system is not in use-both for safety and conserving energy.

Antenna

Rotate the permanently attached antenna vertically to get the best reception.

DW-24R RECEIVER CONTROLS AND FUNCTIONS**Figure A:**

Front Panel Controls and Functions.

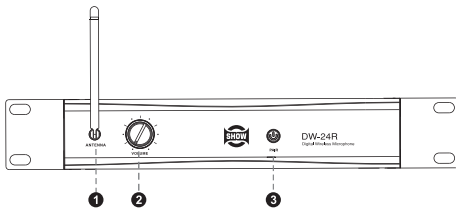

1. Antenna: Position the antenna vertically
2. Volume knob
 - Adjust the volume
 - Indicate pairing status: on ---- connected with DW-24H transmitter
 - off --- not connected with any device
 - blinking --- in pairing status
3. Pair button
 - Indicate the receiver is on by lightening
 - Press and hold for about 5 seconds to enter in pairing status

Two alkaline AA batteries are recommended. When inserting the battery, observe correct polarity as marked inside the battery compartment. Please stop using and change batteries when the led is blinking (not in the pairing status) which indicates short of power.

Press the point 8 and slide out the battery cover. Carefully insert two fresh AA alkaline batteries as the polarity marks indicate. Replace the battery cover and slide it in.

DW-24P TRANSMITTER CONTROLS AND FUNCTIONS**Figure E:**

Controls and Functions.

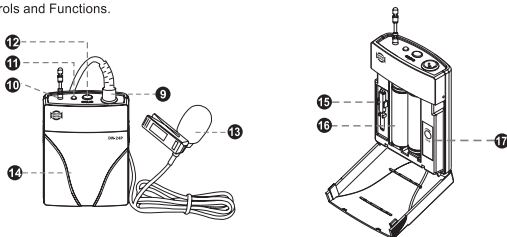
**9. Mini 4P Connector**

This connector is used to connect the unit with the clip microphones, for example, LM-10 clip microphone.

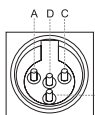

- A: Pin 1, GND
- B: Pin 2, Phantom power supply for Condenser microphone
- C: Pin 3, For Guitar, bass and keyboards
- D: Pin 4, For Dynamic or Condenser microphone

10. Antenna

It is a flexible antenna. To get effective transmission, never cover the antenna with hand, clothes, etc. during operation, and always position the transmitter nearby the receiver.

Figure B:

Rear Panel Controls and Functions.

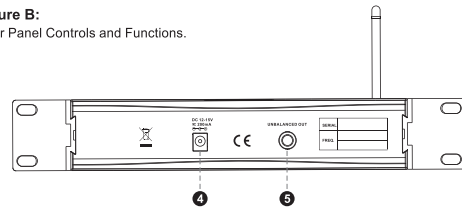

4. Power input jack: Connect the DC plug with the supplied in-line AC adapter
5. Unbalanced audio output jack: 1/4" TRS phone jack which can help to output

DW-24H TRANSMITTER CONTROLS AND FUNCTIONS**Figure C:**

Controls and Functions.

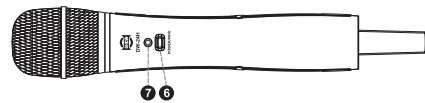

6. Power/Pair button
 - Power on/off the DW-24H by pressing and holding for about 0.5 seconds
 - Pair the transmitter and receiver by pressing and holding for about 5 seconds
7. LED indicator: on --- the DW-24H is on or/ and in pair
- off --- the DW-24H is off
- Blinking --- in pairing status or short of power

Figure D:

DW-24H transmitter battery selection and installation.

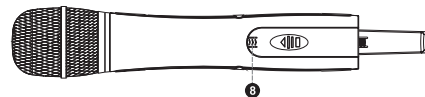

11. LED indicator: on --- the DW-24P is on or/ and in pair
- off --- the DW-24P is off
- Blinking --- in pairing status or short of power

12. Power/Pair button

- Power on/off the DW-24P by pressing and holding for about 0.5 seconds
- Pair the transmitter and receiver by pressing and holding for about 5 seconds

13. Clip microphone

A microphone with a clip which can clip this microphone on ties, shirts, etc...

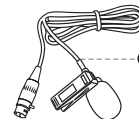

LM-10, Clip microphone
 Preset Impedance: 680 ohm
 Freq. Response: 50-12 kHz;
 Sensitivity: -65 dB ±3 dB at 1kHz
 Directional: ∅ 12×180 mm(∅ 0.47"×7.1")
 Weight: 22g(0.049lb)

14. Battery cover

Press the left and right sides to open the battery cover.

15. Driver

This driver can be used to adjust the gain of the body pack transmitter.

16. Battery compartment

Two alkaline AA batteries are recommended. When inserting the battery, observe correct polarity as marked inside the battery compartment. Please stop using and change batteries when the led is blinking (not in the pairing status) which indicates short of power.

17. Gain level control

The gain level can be adjusted by using the supplied driver to rotate the control.

PAIRING INSTRUCTION

Power on the DW-24R receiver and DW-24H handheld digital wireless microphone or DW-24P body pack transmitter, press and hold the pair button of them at the same time for about 5 seconds, then, the LED of the DW-24H or DW-24P and the volume circle of the DW-24R will blink to show they are in pairing status. After the pairing is successful both indicators will be light constantly.