

**30K**

**Motorcycle Bluetooth Communication System with Mesh Intercom™**



Menu



**Tap** button/Jog Dial the specified number of times



**Press and Hold** button/Jog Dial for the specified amount of time



**Rotate** Jog Dial clockwise (right) or counterclockwise (left).



**Rotate while Pressing** Jog Dial clockwise (right) or counterclockwise (left).



"Hello"

**Audible prompt** from the Bluetooth Module

# TABLE OF CONTENTS

1. [About the Motorcycle Bluetooth Communication System with Mesh Intercom™](#)
  - 1.1. [Product Details](#)
    - 1.1.1. [Headset Main Unit](#)
    - 1.1.2. [Universal Clamp Kit](#)
2. [Installing the Headset on Your Helmet](#)
  - 2.1. [Helmet Installation](#)
  - 2.2. [Using the Glued Surface Mounting Plate](#)
  - 2.3. [Switching the Microphone](#)
    - 2.3.1. [Wired Boom Microphone](#)
    - 2.3.2. [Wired Microphone](#)
  - 2.4. [Earbuds](#)
  - 2.5. [External Mesh Intercom Antenna](#)
3. [Getting Started](#)
  - 3.1. [Button Functions](#)
  - 3.2. [Powering On and Off](#)
  - 3.3. [Charging](#)
  - 3.4. [Checking the Battery Level](#)
  - 3.5. [Volume Adjustment](#)
  - 3.6. [Downloadable Sena Software](#)
    - 3.6.1. [Sena Device Manager](#)
    - 3.6.2. [Sena Smartphone App](#)
  - 3.7. [Configuration Menu](#)
    - 3.7.1. [Basic Configuration Menu](#)
    - 3.7.2. [Advanced Configuration Menu](#)
4. [Pairing the Headset with Other Bluetooth Devices](#)
  - 4.1. [Mobile Phone](#)
  - 4.2. [Additional Mobile Phones, GPS, MP3 Player or Sena SR10 Two-Way Radio Adapter](#)
  - 4.3. [Advanced Selective Pairing: Hands-Free or A2DP Stereo](#)
    - 4.3.1. [Phone Selective Pairing - Hands-Free Profile](#)
    - 4.3.2. [Media Selective Pairing - A2DP Profile](#)
  - 4.4. [GPS Pairing](#)
5. [Mobile Phone Usage](#)
  - 5.1. [Making and Answering Calls](#)
  - 5.2. [Speed Dialing](#)
    - 5.2.1. [Assigning Speed Dial Presets](#)
    - 5.2.2. [Using Speed Dial Presets](#)

- 5.3. [VOX Phone \(Default: Enable\)](#)
- 6. [Stereo Music](#)
  - 6.1. [Playing Music with Bluetooth Devices](#)
  - 6.2. [Music Sharing](#)
  - 6.3. [Audio Boost \(Default: Enable\)](#)
  - 6.4. [Smart Volume Control \(Default: Disable\)](#)
- 7. [Bluetooth Intercom Setup](#)
  - 7.1. [Bluetooth Intercom Pairing](#)
  - 7.2. [Bluetooth Two-Way Intercom](#)
  - 7.3. [Bluetooth Multi-Way Intercom](#)
    - 7.3.1. [Starting a Bluetooth Three-Way Intercom Conference](#)
    - 7.3.2. [Starting a Bluetooth Four-Way Intercom Conference](#)
    - 7.3.3. [Ending Bluetooth Multi-Way Intercom](#)
  - 7.4. [Three-Way Conference Phone Call with Intercom Users](#)
  - 7.5. [Group Intercom](#)
  - 7.6. [Universal Intercom](#)
  - 7.7. [Audio Multitasking \(Default: Enable\)](#)
  - 7.8. [Intercom-Audio Overlay Sensitivity \(Default: 3\)](#)
  - 7.9. [Audio Overlay Volume Management \(Default: Disable\)](#)
  - 7.10. [VOX Intercom \(Default: Disable\)](#)
  - 7.11. [HD Intercom \(Default: Enable\)](#)
  - 7.12. [Advanced Noise Control™ \(Default: Enable\)](#)
- 8. [Mesh Intercom](#)
  - 8.1. [What is Mesh Intercom?](#)
  - 8.2. [Mesh Intercom Mode \(Default: Public Mode\)](#)
    - 8.2.1. [Public Mode](#)
    - 8.2.2. [Private Mode](#)
    - 8.2.3. [Guest Mode \(Default: Disable\)](#)
  - 8.3. [Using the Mesh](#)
    - 8.3.1. [Creating the Mesh](#)
    - 8.3.2. [Join an Existing Mesh](#)
    - 8.3.3. [Accept/Reject Mesh Invitation Request](#)
    - 8.3.4. [Quit the Mesh](#)
    - 8.3.5. [Public Mode/Private Mode Toggle](#)
    - 8.3.6. [Mic Enable/Disable \(Default: Disable\)](#)
- 9. [Using the FM Radio](#)
  - 9.1. [FM Radio On/Off](#)

- 9.2. [Seek and Save Radio Stations](#)
- 9.3. [Scan and Save Radio Stations](#)
- 9.4. [Temporary Station Preset](#)
- 9.5. [Navigating Preset Stations](#)
- 9.6. [Region Selection \(Default: Worldwide\)](#)
- 9.7. [Radio Data System \(RDS\) Alternative Frequency \(AF\) Setting \(Default: Enable\)](#)
- 9.8. [FM Station Guide \(Default: Enable\)](#)
- 10. [Ambient Mode](#)
- 11. [Voice Command](#)
  - 11.1. [Voice Command \(Default: Enable\)](#)
- 12. [General Settings](#)
  - 12.1. [Function Priority](#)
  - 12.2. [Firmware Upgrades](#)
  - 12.3. [Voice Prompts](#)
  - 12.4. [Sidetone \(Default: Disable\)](#)
  - 12.5. [Delete All Bluetooth Pairing Information](#)
- 13. [Remote Control](#)
  - 13.1. [Pairing with the Remote Control](#)
- 14. [Troubleshooting](#)
  - 14.1. [Fault Reset](#)
  - 14.2. [Factory Reset](#)

# 1. About the Motorcycle Bluetooth Communication System with Mesh Intercom™

## 1.1. Product Details

### 1.1.1. Headset Main Unit



- Phone Button
- Jog Dial
- Mesh Intercom Button
- Status LED
- Mesh Intercom Antenna
- Bluetooth Antenna

### 1.1.2. Universal Clamp Kit



- Static Boom Microphone

- Speakers
- MP3 Port
- Ambient Mode Button
- Microphone Port
- Speaker Port
- Earbud Port
- Quick Release Button

## 2. Installing the Headset on Your Helmet

### 2.1. Helmet Installation

To securely install the **headset** on the helmet, please follow this procedure.

1. Insert the back plate of the clamp unit between the internal padding and the external shell of the helmet, and tighten the two screws.

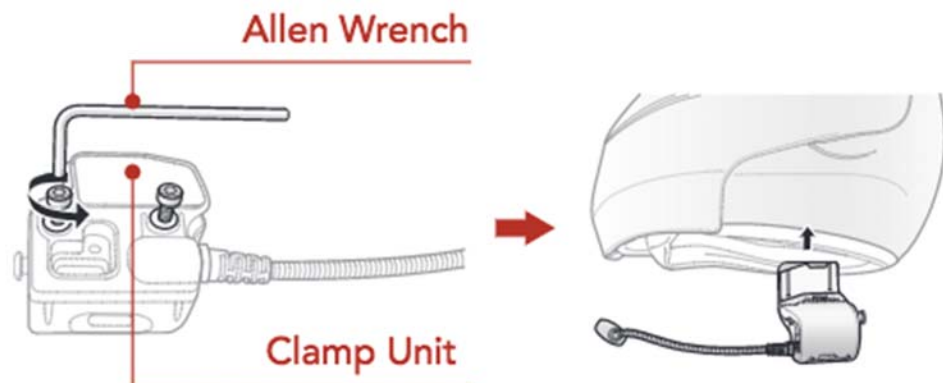

#### Note:

Depending on the size and shape of your helmet, you may need to change the thickness of the rubber pad between the clamp plates using the two extra rubber pads in the box. To increase the overall thickness, attach the thinner one to the original rubber pad or replace the original rubber pad with the thicker one.

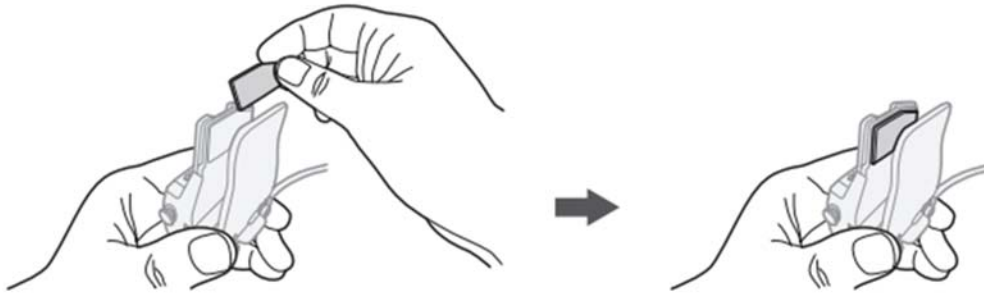

2. Make sure that the microphone is located properly close to your mouth when you wear the helmet. Adjust the direction of the microphone so that the fin side of the microphone is facing outward, away from your lips.

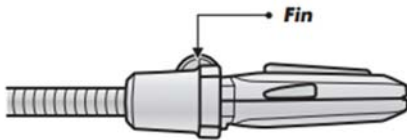

3. Place the helmet speakers along with the hook and loop fasteners, centered to your ear, in the ear pockets of the helmet. If the helmet has deep ear pockets, you can use the speaker pads to place the speakers closer to your ears.

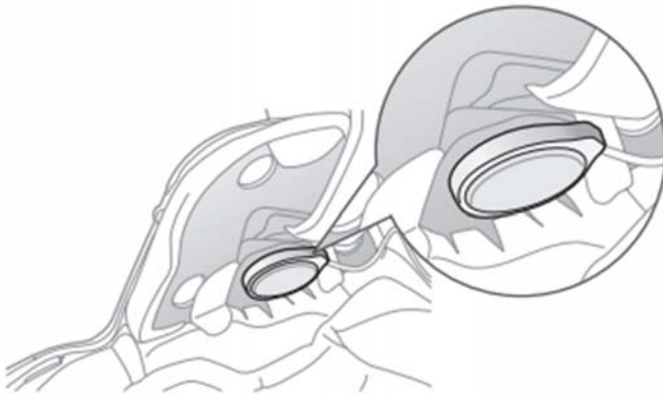

**Note:**

1. The speaker with the shorter wire is for the left ear and the speaker with the longer one is for the right ear.
2. To enhance the audio quality, you can make use of the foam speaker covers. Cover each speaker with the foam and attach the hook fastener at the back of the speaker. Then place the speakers in the helmet as described above. Foam covered speakers work most effectively when they are slightly touching your ears.



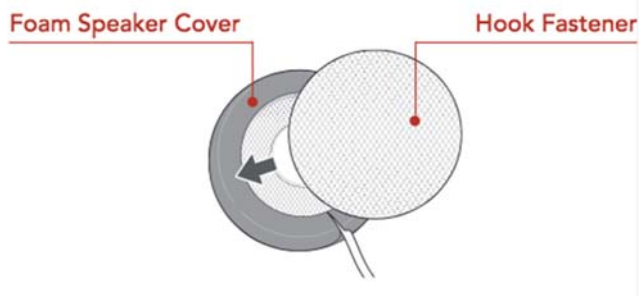

4. Attach the headset main unit to the clamp unit. Slide the main unit down onto the clamp unit until it clicks firmly into the bottom portion of the clamp unit.

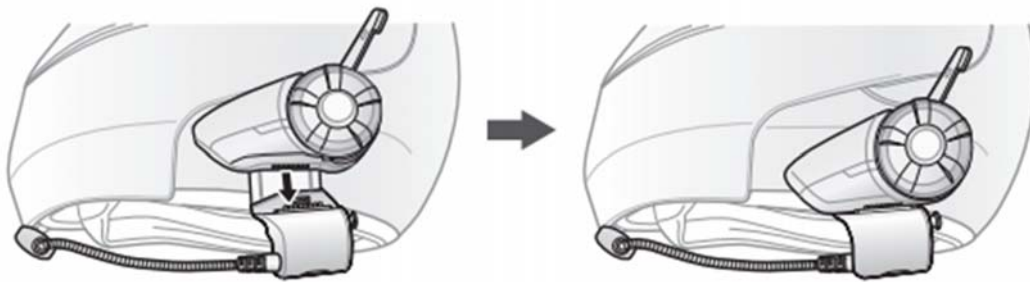

5. To remove the main unit from the clamp unit, press the Quick Release Button to slide it off the clamp unit.

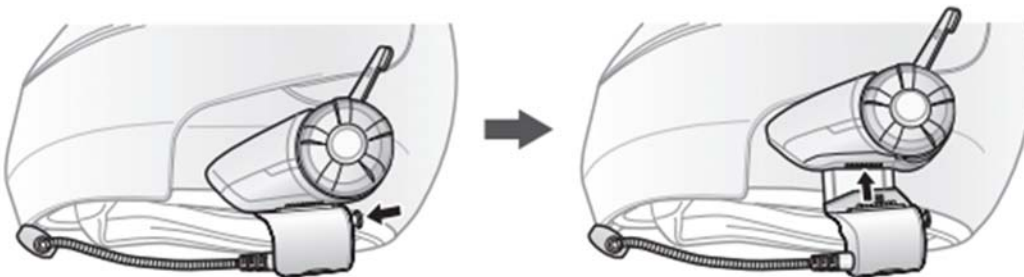

## **2.2. Using the Glued Surface Mounting Adapter**

If you have any problem equipping the clamp unit on the helmet for any reason, you may use the glued surface mounting adapter voice command to attach the clamp unit on the external surface of the helmet.

1. Remove the speaker unit.

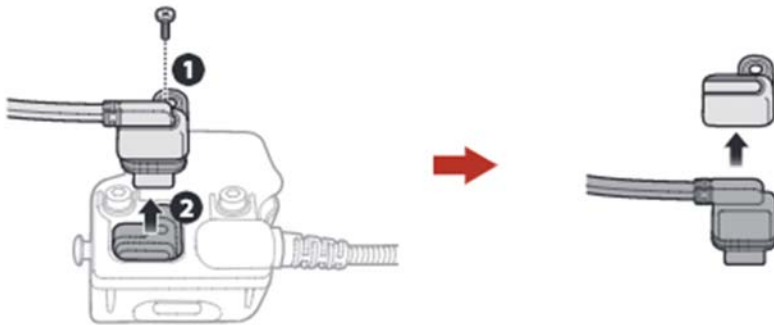

2. Remove the back plate.

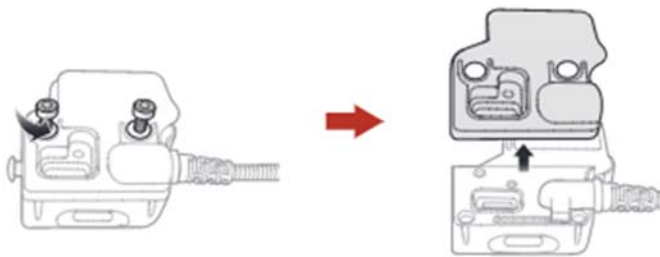

3. Remove the rubber pad and replace it with the thicker rubber pad included in the package.

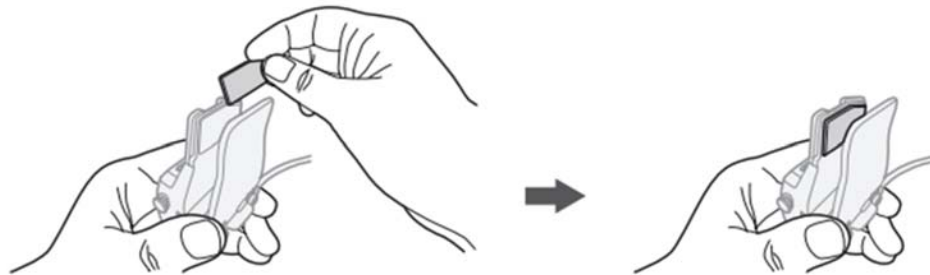

4. Reconnect the speaker cable to the speaker port.

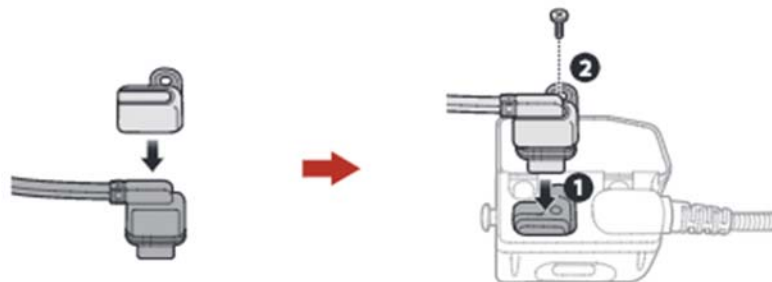

5. Hook on the adapter to the clamp unit then screw in the glued external adapter to the clamp unit.

6. Locate a proper surface on the helmet to attach the unit then clean the helmet surface location with a moistened towel and allow to dry thoroughly.

7. Peel off the cover of the adhesive tape of the adapter and attach the unit on the proper surface of your helmet.



**CAUTION:**

Sena recommends using the clamp unit. The glued surface mounting plate is provided for convenience, but is not the recommended mounting method. Sena is not responsible for its use.

**2.3. Switching the Microphone**

If you want to use a different microphone instead of the static boom microphone, please refer to the following steps.

1. Remove the back plate of the clamp unit.
2. Connect the microphone according to your helmet type.
3. Lock the microphone to the clamp.
4. Reattach the back plate to cover the microphone and the speaker port.

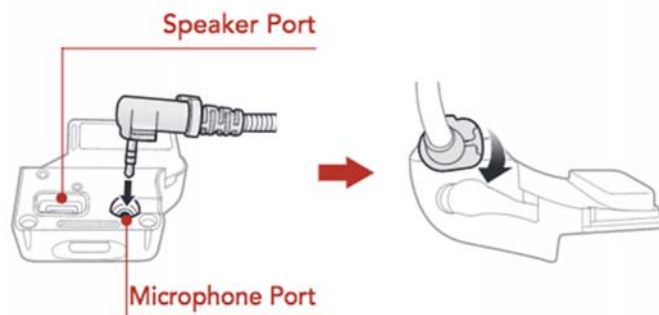

**2.3.1. Wired Boom Microphone**

When installing the included wired boom microphone, place the hook and loop fastener at the end of the boom microphone between the internal helmet cheek pad and the internal wall of the helmet shell. The boom microphone should be mounted so it is facing close to your mouth when you wear the helmet.

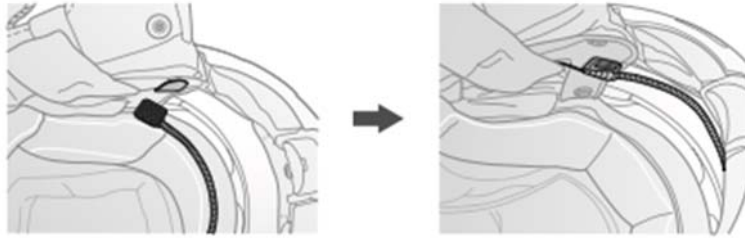

### 2.3.2. **Wired Microphone**

In case of the wired microphone, attach the enclosed hook and loop fastener for the wired microphone to the inside of the chin guard for full-face helmets. Place the wired microphone on the hook and loop fastener and connect it to the connector of the clamp unit.

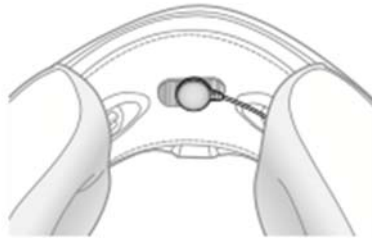

### 2.4. **Earbuds**

You can connect your earbuds to the clamp while having the speakers connected to the clamp. The sound of the earbuds will be active while the sound of the outer speakers becomes inactive.

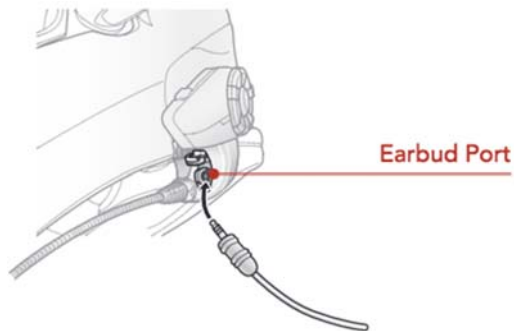

### 2.5. **External Mesh Intercom Antenna**

Pull the **Mesh Intercom** Antenna outwards slightly to unfold it.

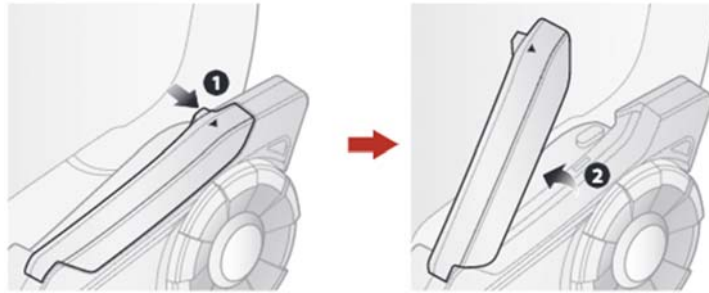

### 3. Getting Started

#### 3.1. Button Functions

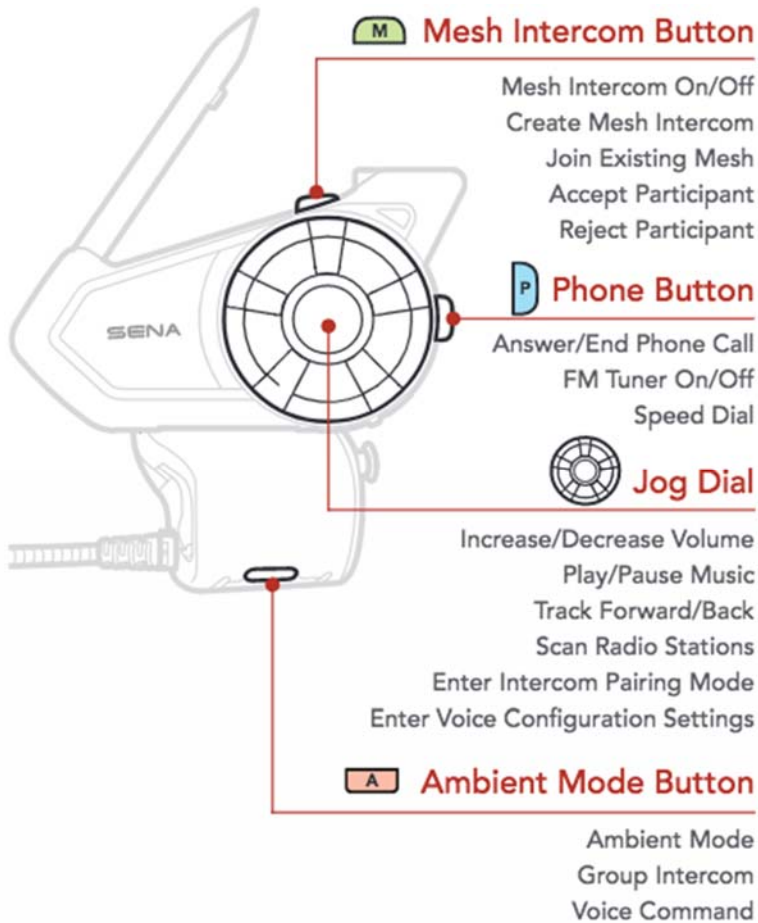

#### Phone Button

- Answer/End Phone Call
- FM Tuner On/Off
- Speed Dial

### Jog Dial

- Increase/Decrease Volume
- Play/Pause Music
- Track Forward/Back
- Scan Radio Stations
- Enter Intercom Pairing Mode
- Enter Voice Configuration Settings

### Mesh Intercom Button

- Mesh Intercom On/Off
- Create Mesh Intercom
- Join Existing Mesh
- Accept Participant
- Reject Participant

### Ambient Mode Button

- Ambient Mode
- Group Intercom
- Voice Command

## 3.2. Powering On and Off

Press and hold the **Jog Dial** and **Phone Button** at the same time to turn the headset on or off.

### Powering On

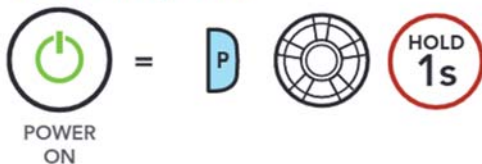

### Powering Off

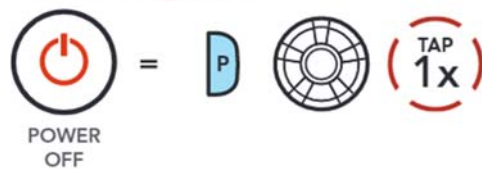

**Note:** If the Voice Command setting is enabled, it will take more time for the “Hello” voice prompt to be heard in the headset. Please refer to **Section 11: “Voice Command”** for more details.

### 3.3. Charging

#### Charging the Headset

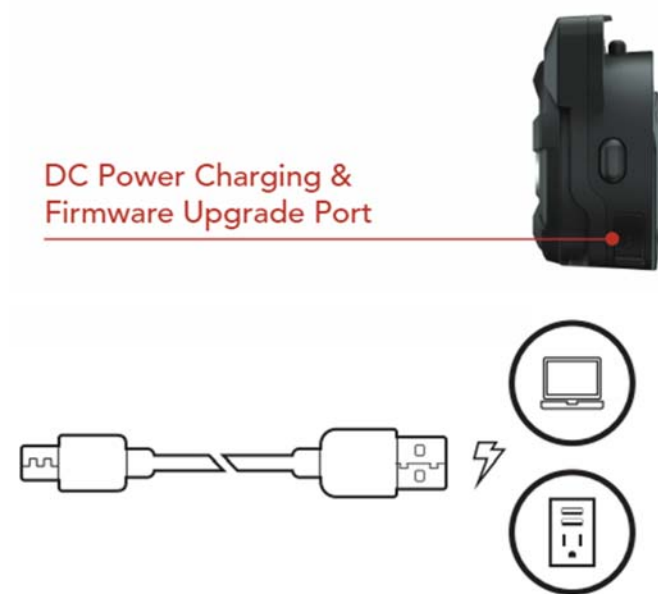

The headset will be fully charged in about 1.5 hours. (The charging time may vary depending on the charging method.) .

**Note:** The headset includes a **Fast Charging** feature which allows it to charge quickly over a short period of time. For example, a user can get 5 hours of talk time after charging the headset for 20 minutes.

### 3.4. Checking the Battery Level

There are two ways to check battery level:

1. Visually, with LEDs when powering on.

### Visual Method

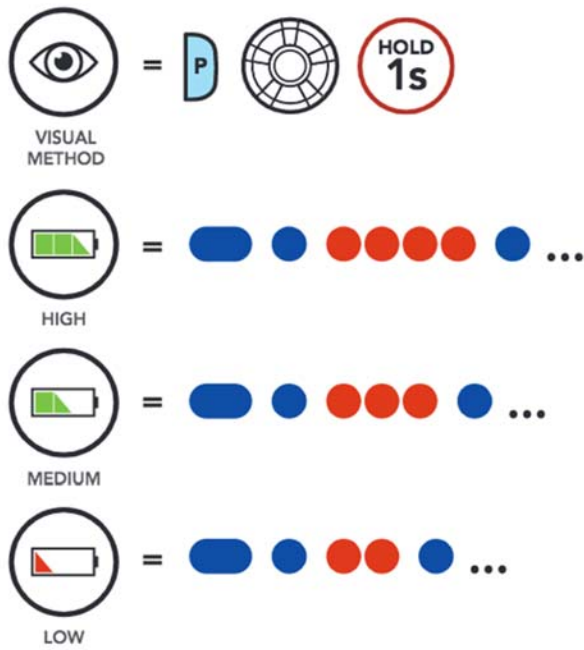

### Visual Method

VISUAL METHOD [icon] = Phone Button + Jog Dial - Hold 1s [icons]

2. Audible method: press and hold the **Phone Button** and **Jog Dial** for **more than 3 seconds** as the headset powers on. A prompt will announce the remaining battery level.

### Audible Method

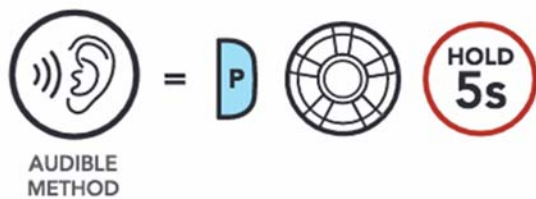

 "Battery level high/medium/low"

### Audible Method

AUDIBLE METHOD [icon] = Phone Button + Jog Dial - Hold 5s [icons]

"Battery level high/medium/low" [Voice Prompt]

**Note:** Blinking LEDs alternate from blue to red when battery power is low.



### 3.5. Volume Adjustment

You can raise or lower the volume by rotating the **Jog Dial** clockwise or counterclockwise. Volume is set and maintained independently at different levels for each audio source (i.e., phone, intercom), even when the headset is rebooted.

#### Volume Up



#### Volume Up

VOLUME UP = Jog Dial - Rotate Right [icons]

#### Volume Down

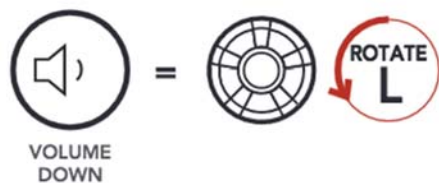

#### Volume Down

VOLUME DOWN = Jog Dial - Rotate Left [icons]

### 3.6. Downloadable Sena Software

#### 3.6.1. Sena Device Manager

The **Sena Device Manager** allows you to upgrade the firmware and configure its settings directly from your PC or Apple computer. Using this software, you can assign speed dial presets, FM radio station presets and more. For more information on downloading the **Sena Device Manager**, please visit [sena.com](http://sena.com).

[Click Here to Visit Sena.com](http://sena.com)

#### 3.6.2. Sena Smartphone App

The **Sena Smartphone App** allows you to configure the headset settings, as well as access the User's Guide and Quick Start Guides. To do so, pair your mobile phone with your headset (please refer to **Section 4: "Pairing the Headset with other Bluetooth Devices"** for more details). Run the **Sena**

**Smartphone App** and configure the settings directly from your smartphone. You can download the **Sena Smartphone App** for Android and Apple operating systems.



**Sena Software Configuration Menu Chart**

Configuration Setting	Enable/Disable or Execute
Speed Dial	Execute
Intercom-Audio Overlay Sensitivity	Execute
Audio Overlay Volume Management	Enable/Disable
Audio Boost	Enable/Disable
Smart Volume Control	Execute
VOX Phone	Enable/Disable
VOX Intercom	Enable/Disable
HD Intercom	Enable/Disable
Guest Mode	Enable/Disable
Voice Prompt	Enable/Disable
Voice Command	Enable/Disable
RDS AF Setting	Enable/Disable
FM Station Guide	Enable/Disable
Sidetone	Enable/Disable
Advanced Noise Control	Enable/Disable

**3.7. Configuration Menu**

The headset can be configured by following a series of voice prompts. Further details about each of these settings will be explained on the following pages.

1. To access the **Configuration Menu**, press and hold the **Jog Dial** for **10 seconds** until you hear the voice prompt, **“Configuration menu.”**

**Accessing the Configuration Menu**

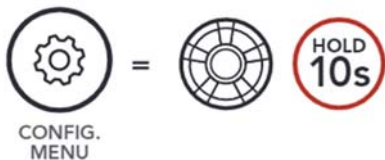

2. Rotate the **Jog Dial** clockwise or counterclockwise to navigate between the menus. You will hear voice prompts for each menu item. The list of functions is shown in the **Configuration Menu Chart** on page 27.

### Navigating Forward through the Menu



### Navigating Backward through the Menu

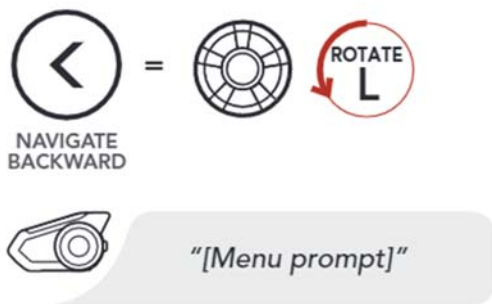

3. You can enable the feature or execute the command by tapping the **Phone Button**.

### Enable or Execute Menu Options

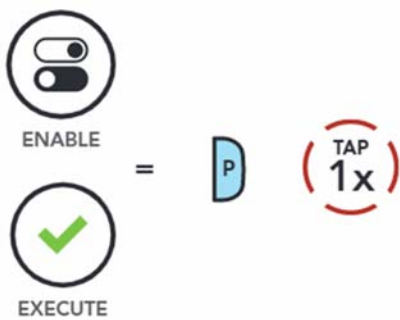

### Headset Configuration Menu Chart

Rotate the Jog Dial clockwise or counterclockwise	Tap the Phone Button
Delete All Pairings	Execute
Remote Control Pairing	Execute
Universal Intercom Pairing	Execute
Exit Configuration	Execute

## 4. Pairing the Headset with Other Bluetooth Devices

When using the headset with other Bluetooth devices for the first time, they'll need to be "paired." This enables them to recognize and communicate with one another whenever they're within range.

The headset can pair with multiple Bluetooth devices such as a mobile phone, GPS, MP3 player or Sena SR10 Two-Way Radio Adapter via **Mobile Phone Pairing** and **Second Mobile Phone Pairing**. The headset can also be paired with up to three other Sena headsets.

Bluetooth  
Communication Module



Pairs with up to three Sena Headsets



Also pairs with:



#### 4.1. Mobile Phone

1. Execute **Phone Pairing** by holding down the **Phone Button** for **5 seconds**.

##### Mobile Phone Pairing



##### Mobile Phone Pairing

START PHONE PAIRING [icon] = Phone Button - Hold 5s [icons]

"Phone pairing" [voice prompt]

2. With your mobile phone in Bluetooth-pairing mode, select the headset in the list of devices detected.
3. If your mobile phone asks for a PIN, enter 0000.

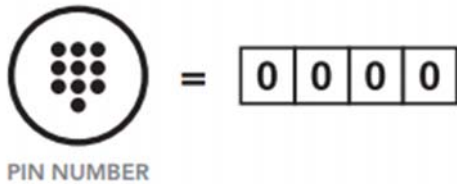

#### 4.2. Additional Mobile Phones, MP3 Player or Sena SR10 Two-Way Radio Adapter

1. Execute **Second Mobile Phone Pairing** by holding down the **Jog Dial** for **5 seconds**. Tap the **Phone Button** once within **2 seconds**.

## Second Mobile Phone Pairing

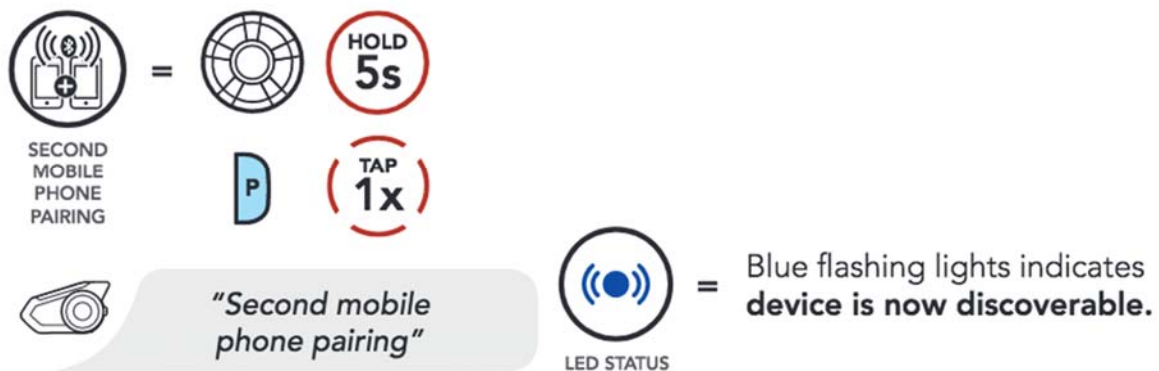

### Second Mobile Phone Pairing

Jog Dial = Hold 5s [icons]

Phone Button = Tap 1x [icons]

"Second mobile phone pairing" [voice prompt]

LED status = Blue flashing lights indicates **device is now discoverable.**

2. With your mobile phone in Bluetooth-pairing mode, select the headset in the list of devices detected.
3. If your mobile phone asks for a PIN, enter 0000.

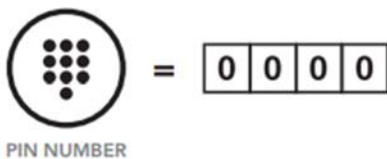

### 4.3. Advanced Selective Pairing: Hands-Free or A2DP Stereo

**Phone Pairing** allows the headset to establish two Bluetooth profiles: **Hands-Free** or **A2DP Stereo**. **Advanced Selective Pairing** allows the headset to separate the profiles to enable connection with two devices.

#### 4.3.1. Phone Selective Pairing - Hands-Free Profile

1. Execute **Phone Selective Pairing** by holding down the **Phone Button** for **5 seconds**. Tap the **Phone Button** once within **2 seconds**.

### Phone Selective Pairing

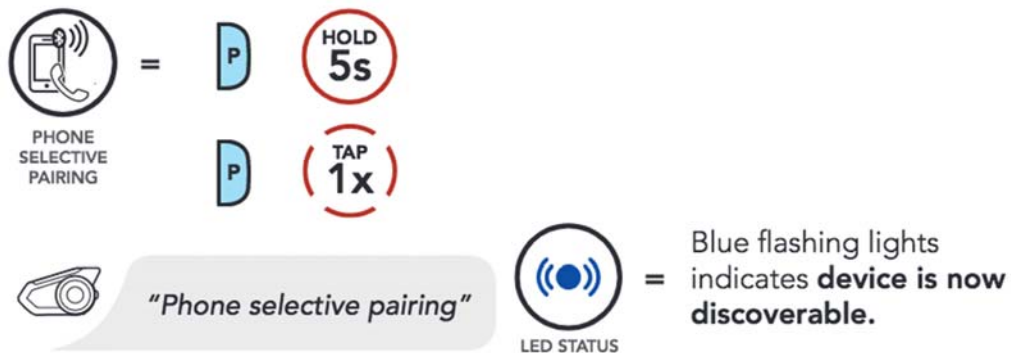

### Phone Selective Pairing

Phone Button = Hold 5s [icons]

Phone Button = Tap 1x [icons]

"Phone selective pairing" [voice prompt]

LED status = Blue flashing lights indicate **device is now discoverable.**

2. With your mobile phone in Bluetooth-pairing mode, select the headset in the list of devices detected.
3. If your mobile phone asks for a PIN, enter 0000.

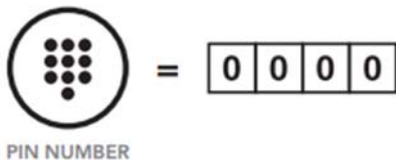

### 4.3.2. Media Selective Pairing - A2DP Profile

1. Execute **Media Selective Pairing** by holding down the **Phone Button** for **5 seconds**. Tap the **Jog Dial** once within **2 seconds**.

### Media Selective Pairing

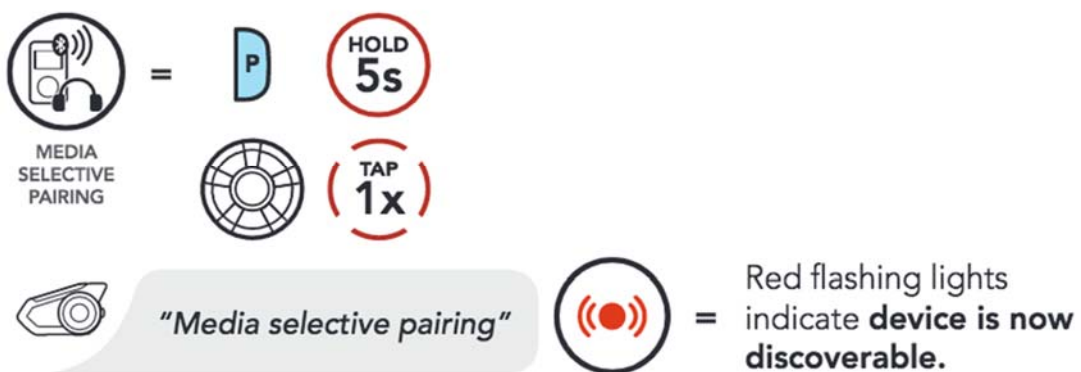

### Media Selective Pairing

Phone Button = Hold 5s [icons]

Jog Dial = Tap 1x [icons]

"Media selective pairing" [voice prompt]

LED status = Red flashing lights indicate **device is now discoverable**.

2. With your mobile phone in Bluetooth-pairing mode, select the headset in the list of devices detected.
3. If your mobile phone asks for a PIN, enter 0000.

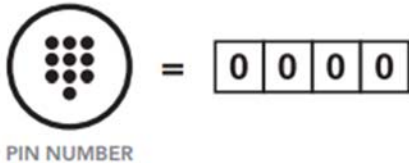

#### 4.4. GPS Pairing

1. Execute **GPS Pairing** by holding down the **Jog Dial** for **5 seconds**. Within **2 seconds**, tap the **Phone Button** once to hear the voice prompt, **“Second mobile phone pairing”**. Again within **2 seconds**, tap the Phone Button to hear the voice prompt, **“GPS pairing”**.

##### GPS Pairing

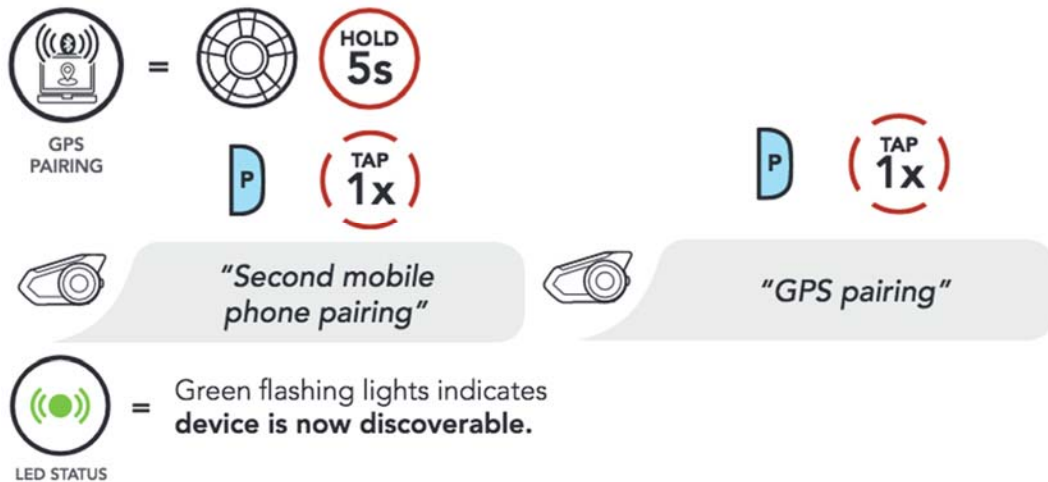

##### GPS Pairing

Jog Dial = Hold 5s [icons]

Phone Button = Tap 1x [icons]

“Second Mobile Phone pairing” [voice prompt]

Phone Button = Tap 1x [icons]

“GPS pairing” [voice prompt]

LED status = Green flashing lights indicates **device is now discoverable**.

2. With your mobile phone in Bluetooth-pairing mode, select the headset in the list of devices detected.
3. If your mobile phone asks for a PIN, enter 0000.



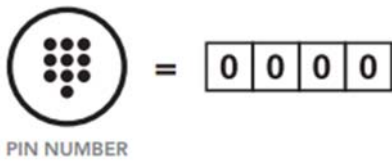

**Note:** If you pair your GPS device via GPS Pairing, its instructions will not interrupt your intercom conversations, but overlay with them.

## 5. Mobile Phone Usage

### 5.1. Making and Answering Calls

#### Answer a Call

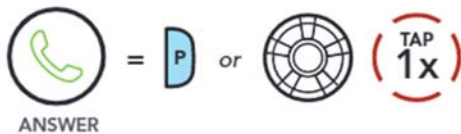

#### Reject a call

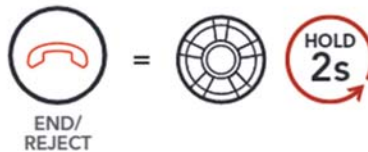

#### End a Call

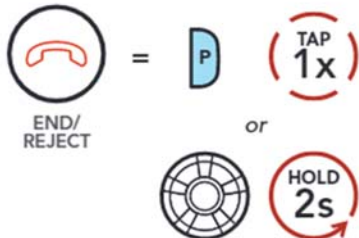

#### Make Call with Voice Dialer

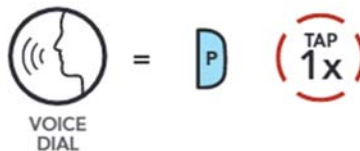

#### Answer a Call

ANSWER = Phone Button or Jog Dial - Tap 1x [icons]

#### End a Call

END = Phone Button - Tap 1x or Jog Dial - Hold 2s [icons]

#### Reject a Call

REJECT = Jog Dial - Hold 2s [icons]

#### Make Call with Voice Dialer

VOICE DIAL = Phone Button - Tap 1x [icons]

**Note:** If you have a GPS device connected, you will not hear its voice navigations during a phone call.

## 5.2. Speed Dialing

### 5.2.1. Assigning Speed Dial Presets

**Speed Dial Presets could be assigned** in the settings menu, accessible through **Sena Device Manager** or **Sena Smartphone App**. Please refer to **Section 3.6: “Downloadable Sena Software”** for more details.

### 5.2.2. Using Speed Dial Presets

1. Tap the **Phone Button** twice to enter into the **Speed Dial** menu. You will hear the voice prompt, **“Speed dial.”**

#### Enter Speed Dial Mode



#### Enter Speed Dial Mode

**SPEED DIAL = Phone Button - tap 2x [icon]**

**“Speed dial” [voice prompt]**

2. Rotate the **Jog Dial** clockwise or counterclockwise to navigate between the **Speed Dial Presets**.

#### Navigate Forward through Speed Dial Preset Numbers

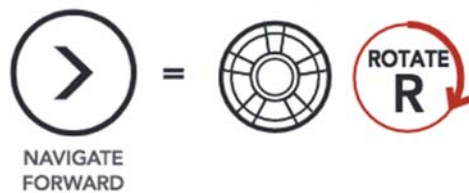

#### Navigate Forward through Speed dial Preset Numbers

**NAVIGATE FORWARD = Jog Dial - rotate clockwise [icon]**

#### Navigate Backward through Speed Dial Preset Numbers

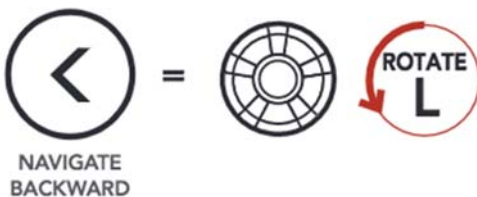

**Navigate Backward through Speed Dial Preset Numbers**

**NAVIGATE BACKWARDS = Jog Dial - rotate counterclockwise [icon]**

3. To redial the last number called, tap the **Phone Button** when you hear the prompt, **“Last number redial.”**

#### Redial Last Number



#### Redial Last Number

**REDIAL = Phone Button - tap 1x [icon]**

**“Last number redial” [voice prompt]**

4. To call one of your **Speed Dial Presets**, tap the **Phone Button** when you hear the prompt, **“Speed dial (#).”**

#### Call a Speed Dial Preset Number

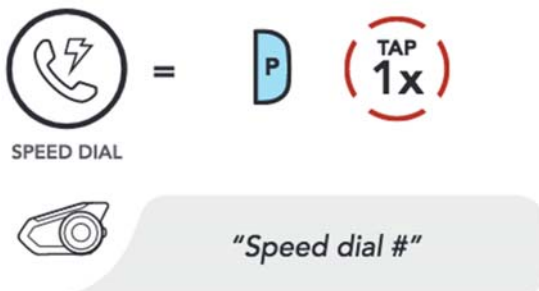

#### Call a Speed Dial Preset Number

**SPEED DIAL] = Phone Button - tap 1x [icon]**

**“Speed dial #” [voice prompt]**

### 5.3. **VOX Phone (Default: Enable)**

An **VOX Phone** setting can be found in the settings menu, accessible through **Sena Device Manager** or **Sena Smartphone App**. Please refer to **Section 3.6: “Downloadable Sena Software”** for more details.

With **VOX Phone** enabled, you can answer incoming calls by simply saying a word loudly enough, unless you are connected to intercom. For example, when you hear a series of beeps for an incoming call, you can answer the phone by saying **“Hello”** or any other word loudly. If this mode is disabled, you have to tap the **Jog Dial** or the **Phone Button** to answer an incoming call.

## 6. Stereo Music

### 6.1. Playing Music with Bluetooth Devices

1. To play or pause music, press and hold the **Jog Dial** for **1 second** until you hear a double beep.

#### Play/Pause



#### Play/Pause

PLAY/PAUSE = Jog Dial - Hold 1s [icons]

"[Beep, Beep]" [voice prompt]

2. To adjust the volume, rotate the **Jog Dial** clockwise or counterclockwise.

#### Volume Up

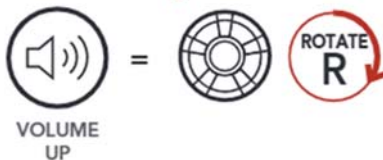

#### Volume Down

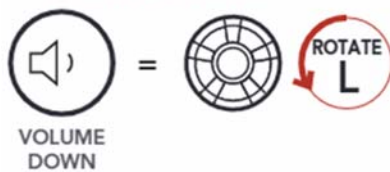

#### Volume Up

VOLUME UP = Jog Dial - Rotate Right [icons]

#### Volume Down

VOLUME DOWN = Jog Dial - Rotate Left [icons]

3. To track forward or back, rotate while pressing the **Jog Dial** clockwise or counterclockwise.

## Track forward



## Track backward



### Track Forward

SKIP TRACK FORWARD = Jog Dial - Rotate Right while Pressing

### Track Backward

SKIP TRACK BACKWARD = Jog Dial - Rotate Left while Pressing

## 6.2. Music Sharing

You can share the music you're listening to with an **Intercom Friend** during an intercom conversation. To start or terminate sharing music, press the **Jog Dial** for **1 second** during an intercom conversation until you hear a double beep. Both you and your **Intercom Friend** can control music playback.

### Sharing Music with an Intercom Friend during Intercom Conversation

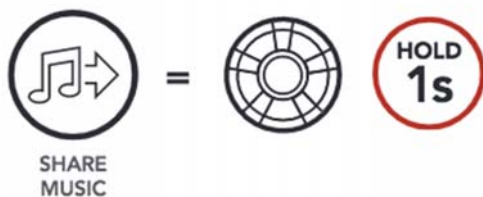

Sharing Music with an Intercom Friend during Intercom Conversation

Share Music = Jog Dial - Hold 1s [icon]

## 6.3. Audio Boost (Default: **Disable**)

An **Audio Boost** setting can be found in the settings menu, accessible through **Sena Device Manager** or **Sena Smartphone App**. Please refer to **Section 3.6: "Downloadable Sena Software"** for more details.

Enabling **Audio Boost** increases the maximum volume limit. Disabling **Audio Boost** reduces the maximum volume limit while delivering more balanced sound.

#### 6.4. Smart Volume Control (Default: Disable)

A **Smart Volume Control** setting can be found in the settings menu, accessible through **Sena Device Manager** or **Sena Smartphone App**. Please refer to **Section 3.6: “Downloadable Sena Software”** for more details.

Enabling **Smart Volume Control** automatically changes the level of the speaker volume based on the level of the environment noise. You can enable it by setting the sensitivity to low, medium or high.

## 7. Bluetooth Intercom Setup

### 7.1. Intercom Pairing

Up to three people can communicate via intercom with the headset simply by pairing their headsets.

#### Pairing with Intercom Friends

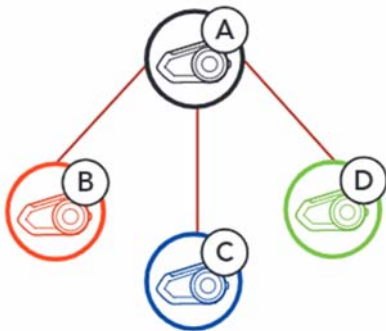

1. Press and hold the **Jog Dials** of two headsets for **5 seconds** until you hear the voice prompt, **“Intercom pairing.”**

## Pairing Headset A with Headset B

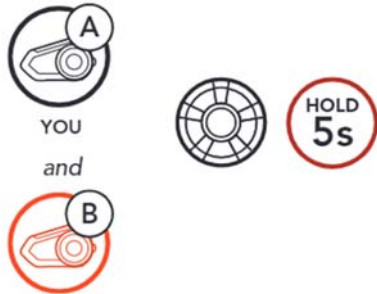

"Intercom pairing"



LED STATUS

= Red flashing light indicates device is now discoverable.

## Pairing Headset A with Headset B

YOU and B = Jog Dial - Hold 5s [icons]

"Intercom pairing" [voice prompt]

LED STATUS = Red flashing light indicates device is now discoverable.

2. Tap the **Jog Dial** on either headset and wait until the LEDs of both turn blue.

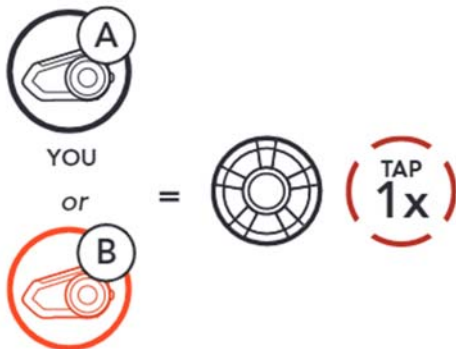

LED STATUS

= Flashing blue LED confirms intercoms are paired.

YOU (A) or B = Jog Dial - Tap 1x [icons]

LED STATUS = Flashing blue LED confirms **intercoms are paired.**[icons]

3. Repeat steps 1 and 2 to pair with **Intercom Friends C & D.**

## Last-Come, First-Served

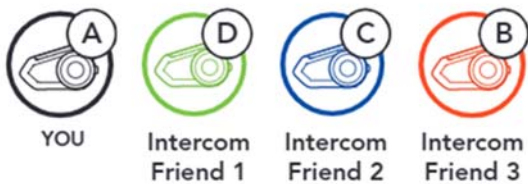
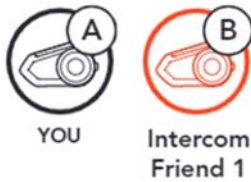

### Last-Come, First Served

YOU (A) Intercom Friend 1 (B)

YOU (A) Intercom Friend 1 (C) Intercom Friend 2 (B)

YOU (A) Intercom Friend 1 (D) Intercom Friend 2 (C) Intercom Friend 3 (B) [icons]

## 7.2. Two-Way Intercom

You can start or end an intercom conversation with an Intercom Friend by tapping the **Jog Dial**.

1. Tap once for Intercom **Friend 1**.

### Start/End with Intercom Friend 1





Start/End with Intercom Friend 1

INTERCOM FRIEND 1(D) = Jog Dial - Tap 1x [icons]

2. Tap twice for Intercom **Friend 2**.

## Start/End with Intercom Friend 2



Start/End with Intercom Friend 2

INTERCOM FRIEND 1(C) = Jog Dial - Tap 2x [icons]

3. Tap three times for Intercom **Friend 3**.

## Start/End with Intercom Friend 3

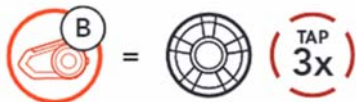

Start/End with Intercom Friend 3

INTERCOM FRIEND 1(B) = Jog Dial - Tap 3x [icons]

### 7.3. Multi-Way Intercom

**Multi-Way Intercom** enables conference-call-style conversations with up to three **Intercom Friends** at the same time. While **Multi-Way Intercom** is in progress, mobile phone connection is temporarily disconnected. However, as soon as **Multi-Way Intercom** terminates, the mobile phone connection will be reestablished.

#### 7.3.1. **Starting a Three-Way Intercom Conference**

**You (A)** can have a **Three-Way Intercom Conference** with two other **Intercom Friends (B & C)** by establishing two intercom connections simultaneously.

1. Pair your headset (A) with those of two other **Intercom Friends (B & C)**. Please refer to **Section 7.1: "Intercom Pairing"** for pairing instructions.

Pair with Intercom Friends B & C

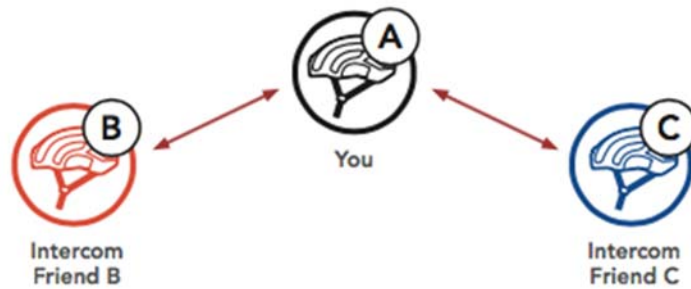

Pair with Intercom Friend B & C

Intercom Friend B <--> YOU (A) <--> Intercom Friend C [icons]

2. Start an intercom conversation with one of the two friends in your intercom group. For example, **you (A)** may start an intercom conversation with the **Intercom Friend (B)**. Or, **Intercom Friend (B)** may start an intercom call with **you (A)**.

Starting an Intercom Conversation with Intercom Friend B

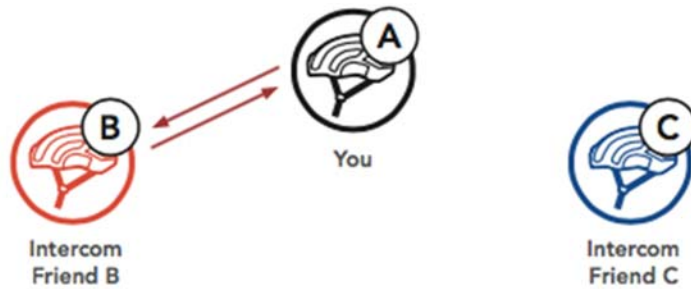

Starting an Intercom Conversation with Intercom Friend B

Intercom Friend B <--> YOU (A) Intercom Friend C [icons]

3. Then, **you (A)** can call the second **Intercom Friend (C)**, or the second **Intercom Friend (C)** may join the intercom by making an intercom call to **you (A)**.

Starting an Intercom Conversation with Intercom Friend C

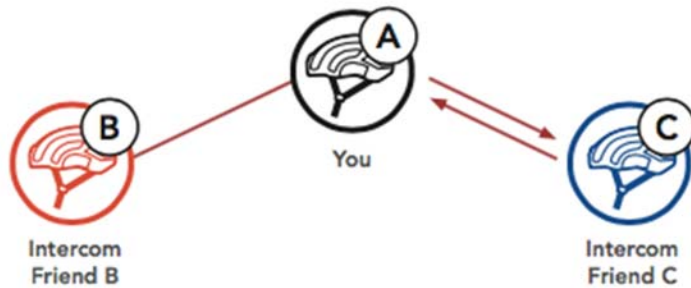

Starting an Intercom Conversation with Intercom Friend C

Intercom Friend B -- YOU (A) <--> Intercom Friend C [icons]

4. Now **you (A)** and two **Intercom Friends (B & C)** are having a **Three-Way Intercom Conference**.

#### Three-Way Conference

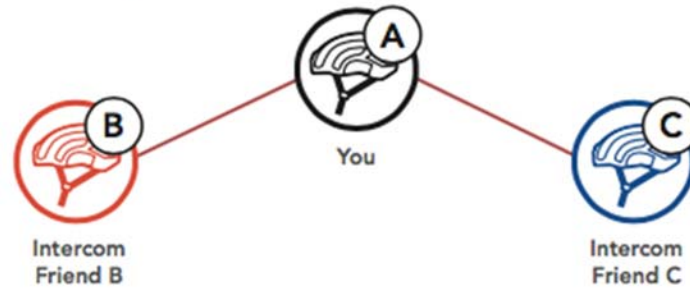

#### Three-Way Intercom

Intercom Friend B -- YOU (A) -- Intercom Friend C [icons]

#### 7.3.2. Starting a Four-Way Intercom Conference

With three **Intercom Friends** connected, a new participant (**D**) can make it a **Four-Way Intercom Conference** by making an intercom call to either (**B**) or (**C**).

#### Starting a Four-Way Intercom

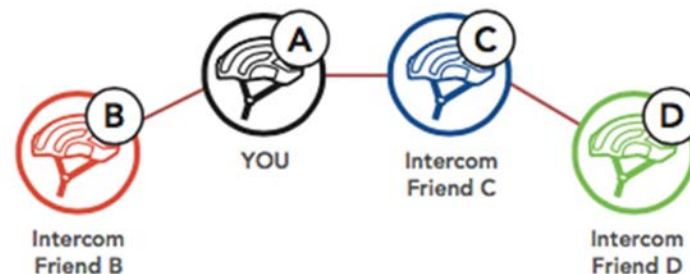

#### Starting a Four-Way Intercom

Intercom Friend B -- YOU (A) -- Intercom Friend C -- Intercom Friend D [icons]

#### 7.3.3. Ending Multi-Way Intercom

1. Press the **Jog Dial** for **1 second** until you hear a beep to terminate all intercom connections.
2. Tap the **Jog Dial** to disconnect from your first **Intercom Friend**. Double tap the Jog Dial to disconnect from your second **Intercom Friend**.

#### 7.4. Three-Way Conference Phone Call with Intercom Users

You can have a **Three-Way Conference Phone Call** by adding an **Intercom Friend** to the mobile phone conversation.

1. During a mobile phone call, tap the **Jog Dial once, twice or, three times** to invite one of your **Intercom Friends** to the conversation.

### Invite an Intercom Friend into Phone Conference

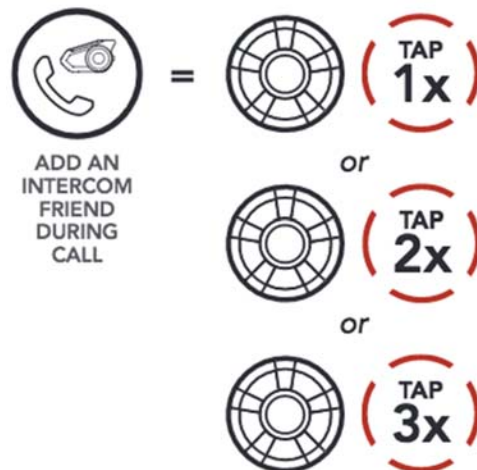

### Invite an Intercom Friend into Phone Conference

ADD AN INTERCOM FRIEND DURING CALL [icon] = Jog Dial - Tap 1x or 2x or 3x [icons]

2. To disconnect the intercom during a conference phone call, tap the **Jog Dial once, twice or three times**.

### Disconnect Intercom Friend from Conference

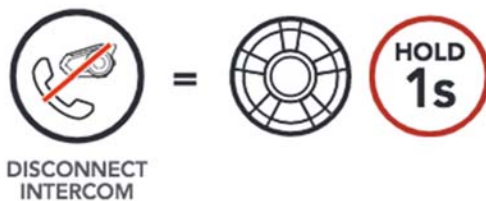

### Disconnect Intercom Friend from Conference

DISCONNECT INTERCOM [icon] = Jog Dial - Hold 1s [icons]

3. To disconnect the mobile phone call during a conference phone call, tap the **Phone Button**.

### End Phone Call from Conference

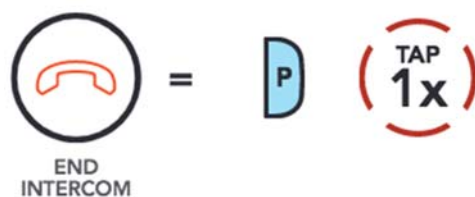

## End Phone Call from Conference

END INTERCOM [icon] = Phone Button - Tap 1x [icons]

**Note:** When you have an incoming intercom call during a mobile phone call, you will hear a voice prompt, **“Intercom requested.”**

### 7.5. Group Intercom

**Group Intercom** allows you to instantly create a **Multi-Way Conference Intercom** with three of the most recently paired headsets.

1. Go through intercom pairing with up to three headsets you want to have **Group Intercom** with.
2. Press the **Ambient Mode Button** for **1 second** to begin **Group Intercom**. The LED will flash green and you will hear a voice prompt, **“Group intercom”**

#### Start Group Intercom

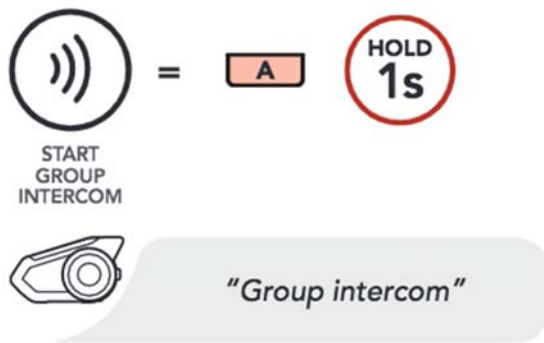

#### Start Group Intercom

START GROUP INTERCOM = Ambient Mode Button - Hold 1s [icons]

“Group intercom” [voice intercom]

3. When all of the headsets are connected together, everyone will hear the voice prompt, **“Group intercom connected.”**



“Group intercom connected” [voice prompt]

BLUETOOTH LED STATUS = Green LED Flashing

4. To terminate **Group Intercom**, press the **Ambient Mode Button** for **1 second** during **Group Intercom**. You will hear a voice prompt, **“Group intercom terminated”**.

#### End Group Intercom

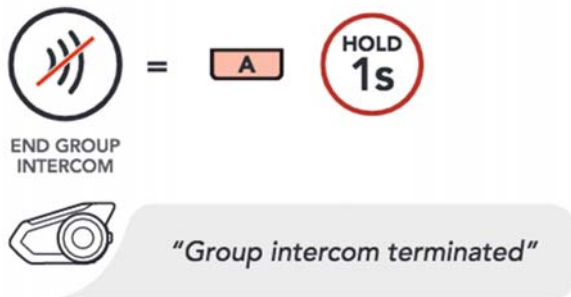

#### End Group Intercom

**END GROUP INTERCOM** = Ambient Mode Button - Hold 1s [icons]

[Voice prompt] "Group intercom terminated"

### 7.6. Universal Intercom

**Universal Intercom** allows you to have intercom conversations with users of non-Sena Bluetooth headsets. You can pair your headset with only one non-Sena headset at a time. The intercom distance depends on the performance of the Bluetooth headset to which it's connected. When a non-Sena Bluetooth headset is paired with the Sena headset, if another Bluetooth device is paired via **Second Mobile Phone Pairing**, it will be disconnected.

1. Execute **Universal Intercom** in the **Configuration Menu**. Please refer to **Section 3.7: "Configuration Menu"** for more details.

#### Access Universal Intercom in the Configuration Menu

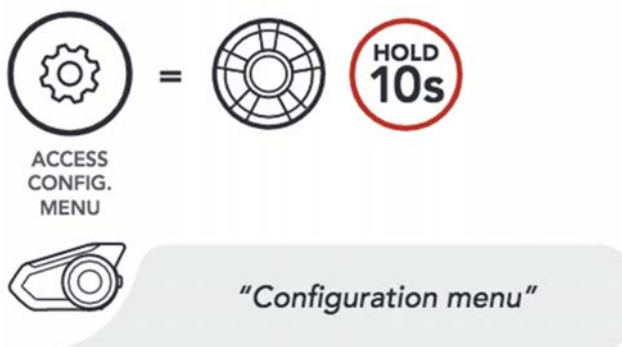

#### Access Universal Intercom in the Configuration Menu

**ACCESS CONFIG. MENU** = Jog Dial - Hold 10s [icons]

"Configuration menu" [voice prompts]

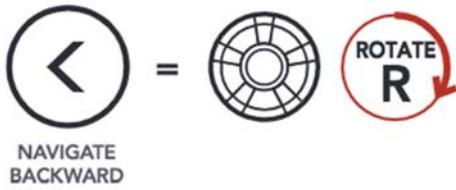

*"Universal intercom"*

NAVIGATE BACKWARD = Jog Dial - Rotate Right

"Universal intercom" [voice prompts]

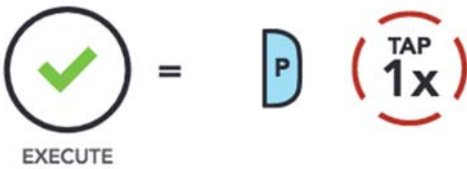

EXECUTE = Phone Button - Tap 1x

- Put the non-Sena Bluetooth headset in Pairing Mode. The headset will automatically pair with a non-Sena Bluetooth headset.
- You can have **Two-Way Intercom** or **Multi-Way Intercom** communication with up to three **Intercom Friends** using non-Sena headsets by following the procedures described below.

### Example of a Three-Way Universal Intercom

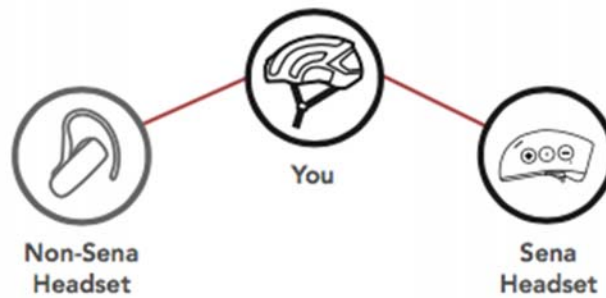

Example of a Three-Way Universal Intercom

Non-Sena Headset -- You -- Sena Headset [icons]

### Example of a Four-Way Universal Intercom

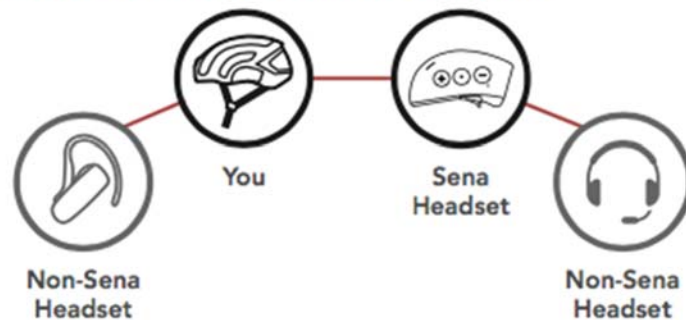

Example of a Four-Way Universal Intercom

Non-Sena Headset -- You -- Sena Headset -- Non-Sena Headset [icons]

#### 7.7. Intercom-Audio Overlay Sensitivity (Default: 3)

The **Intercom-Audio Overlay Sensitivity** setting can be found in the settings menu, accessible through **Sena Device Manager** or **Sena Smartphone App**. Please refer to **Section 3.6: “Downloadable Sena Software”** for more details.

While **Audio Multitasking** is enabled, the music, FM radio and GPS volume will be lowered to play in the background if you talk over the intercom while the-overlaid audio is playing. You can adjust the intercom sensitivity to activate this background audio mode. **Level 1 has the lowest sensitivity and level 5 has the highest sensitivity.**

**Note:** If your voice is smaller than the sensitivity of the selected level, you will not hear anything.

#### 7.8. Audio Overlay Volume Management (Default: Disable)

The **Audio Overlay Volume Management** setting can be found in the settings menu, accessible through **Sena Device Manager** or **Sena Smartphone App**. Please refer to **Section 3.6: “Downloadable Sena Software”** for more details.

While **Audio Multitasking** is enabled, music, FM radio and GPS overlaid audio reduces in volume whenever there is an ongoing intercom conversation. If **Audio Overlay Volume Management** is enabled, the volume level of the overlaid audio will not be reduced during an intercom conversation.

#### 7.9. VOX Intercom (Default: Disable)



The **VOX Intercom** setting can be found in the settings menu, accessible through **Sena Device Manager** or **Sena Smartphone App**. Please refer to **Section 3.6: “Downloadable Sena Software”** for more details.

If **VOX Intercom** is enabled, you can initiate an intercom conversation with the last connected intercom friend by voice. When you want to start intercom, say a word such as **“Hello”** loudly or blow air into the microphone. If you start an intercom conversation by voice, the intercom terminates automatically when you and your intercom friend remain silent for 20 seconds. However, if you manually start an intercom conversation by tapping the **Jog Dial**, you have to terminate the intercom conversation manually.

However, if you start the intercom by voice and end it manually by tapping the **Jog Dial**, you will not be able to start intercom by voice temporarily. In this case, you have to tap the **Jog Dial** to restart the intercom. This is to prevent repeated unintentional intercom connections by strong wind noise. After rebooting the headset, you can start the intercom by voice again.

#### **7.10. Intercom VOX Sensitivity (Default: 3)**

The **Intercom VOX Sensitivity** setting can be found in the settings menu, accessible through **Sena Device Manager** or **Sena Smartphone App**. Please refer to **Section 3.6: “Downloadable Sena Software”** for more details.

The sensitivity can be adjusted depending on your riding environment. Level 5 is the highest sensitivity setting and 1 is the lowest.

#### **7.11. HD Intercom (Default: Enable)**

The **HD Intercom** setting can be found in the settings menu, accessible through **Sena Device Manager** or **Sena Smartphone App**. Please refer to **Section 3.6: “Downloadable Sena Software”** for more details.

**HD Intercom** enhances the two-way intercom audio from normal quality to HD quality. **HD Intercom** will become temporarily disabled when you enter into a multi-way intercom. If this feature is disabled, the two-way intercom audio will change to normal quality.

**Note:** The intercom distance of **HD Intercom** is relatively shorter than that of normal intercom.

## 7.12. Advanced Noise Control™ (Default: Enable)

The **Advanced Noise Control** setting can be found in the settings menu, accessible through **Sena Device Manager** or **Sena Smartphone App**. Please refer to **Section 3.6: “Downloadable Sena Software”** for more details.

If **Advanced Noise Control** is enabled, background noise is reduced during intercom conversations.

If **Advanced Noise Control** is disabled, the background noise is mixed with your voice while using the intercom.

## 8. Mesh Intercom

### 8.1. What is Mesh Intercom?

**Mesh Intercom** is an adaptive and autonomous intercom technology developed by Sena which features self-organizing, self-healing, self-optimizing, and multi-hopping group communication. **Mesh Intercom** allows riders to connect and communicate with nearby users without the need to pair each headset together.

#### Starting Mesh Intercom

When **Mesh Intercom** is enabled, the headset will automatically connect to nearby 30K users and allow them to talk to each other by pressing the **Mesh Intercom Button**.

#### Mesh Intercom On



#### Mesh Intercom Off



## 8.2. Mesh Intercom Mode (Default: Public Mode)

### 8.2.1. Public Mode

When **Mesh Intercom** is enabled, the headset will be in **Public Mode** initially. It can connect with a virtually unlimited number of nearby 30K headsets within a **1.6 km (1.0 mile)** range. Within this range, 6 users can talk at the same time for an optimized, open intercom conversation. Users can freely connect with each other when in **Public Mode**. The audio quality of the intercom conversation will be the best when communicating using **Public Mode**. The headset will not save the connection information from any of the headsets that it is connected to for future open intercom conversations when in **Public Mode**.

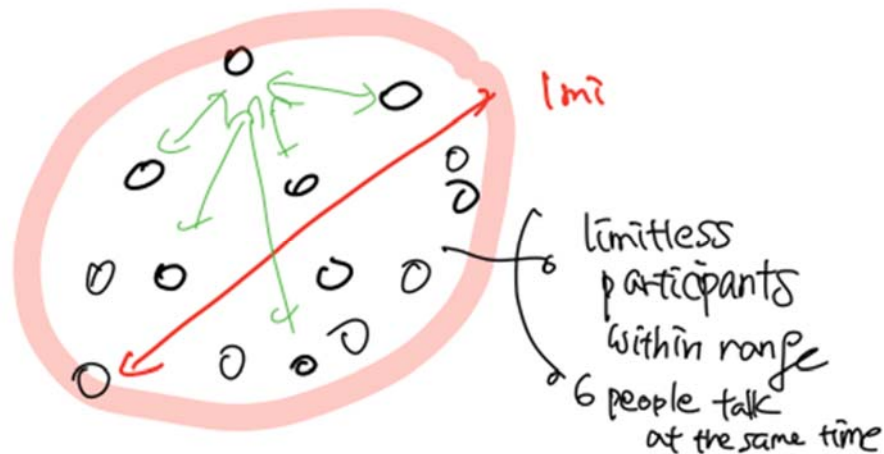

**Mesh Intercom in Public Mode**

[In the Image]

1.0 Mile

Limitless participants within range

6 people talk at the same time

### 8.2.2. Private Mode

#### Mesh

A Mesh is a closed network of headsets where participants can leave, join or rejoin a group intercom conversation without affecting the connection between each of the headsets. For a closed intercom conversation using **Mesh Intercom**, a Mesh needs to be created by a user. When a user creates a Mesh, the headset automatically switches from **Public Mode** to **Private Mode**.

#### Private Mode

When the headset is in **Private Mode**, it can connect with up to 15 other 30K headsets. The range between each headset in **Private Mode** can be up to 2.0 km (1.2 miles). The Mesh can extend up to 8.0 km (5.0 miles) between the two farthest headsets during a closed intercom conversation. Within this group, 6 users can talk at the same time for an optimized closed group conversation. The audio quality when communicating in a Mesh automatically adjusts according to the number of participants. When connected together in a Mesh, the headset will automatically save the connection information from all of the other headsets that it has connected to for future **Mesh Intercom** group communication.

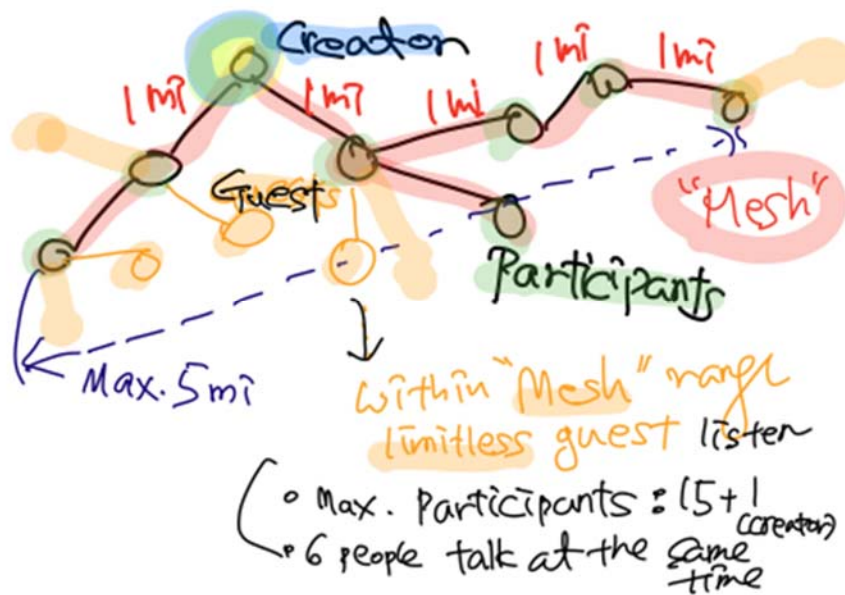

**Diagram of Mesh Intercom in Private Mode**

[In the Image]

1 Mile

Max. 5 Miles

Mesh

Creator

Participants

Guest

Limitless guests only listen

Within "Mesh" range

Max. participants: 15 participants + 1 creator

6 people talk at the same time

### 8.2.3. Guest Mode (Default: Disable)

A **Guest Mode** setting can be found in the settings menu, accessible through **Sena Device Manager** or **Sena Smartphone App**. Please refer to **Section 3.6: “Downloadable Sena Software”** for more details.

**Guest Mode** allows a guest to listen to a closed Mesh conversation. The creator of the Mesh needs to enable **Guest Mode** before creating the Mesh to allow guests. **Guest Mode** can be enabled when the **guest** is in **Public Mode** and the **Mesh Network** connection information has been removed. The guest needs to be within range of the Mesh to listen to the closed Mesh conversation.

#### Toggle Guest Mode from Public Mode

Toggle Guest Mode [icon] = Mesh Intercom Button - Hold 3s

“Guest Mode” [voice prompt]

#### Toggle Public Mode from Guest Mode

Toggle Public Mode [icon] = Mesh Intercom Button - Hold 3s

“Public Mode” [voice prompt]

**Note:** When the creator enables **Guest Mode**, a virtually unlimited number of guests can connect to a Mesh.

## 8.3. Using the Mesh

### 8.3.1. Creating the Mesh

A user can create a Mesh so that they can invite nearby 30K headsets to join in a closed intercom conversation.

#### Creating Mesh

[Creator]

CREATING MESH [icon] = Mesh Intercom Button - Hold 5s [icons]

“Creating mesh ” [voice prompt]

Users within range and in **Public Mode** can accept the invitation sent by the creator of the Mesh to join a closed intercom conversation after hearing the voice prompt **“Would you like to join the mesh?”**.

Accept the invitation During Mesh Creation

[Participant]

“Would like to join the mesh?” [voice prompt]

ACCEPT INVITATION [icon] = Mesh Intercom Button Button - Tap 1x

“Joined the mesh” [voice prompt]

**Note:** A user can join the Mesh within **30 seconds** after hearing the invitation voice prompt.

### 8.3.2. Join an Existing Mesh

Users that did not accept the invitation from the creator or were not invited can request to join the Mesh.

Join an Existing Mesh

[Participant]

JOIN AN EXISTING MESH = Mesh Intercom Button - Tap 2x [icon]

"Searching for Mesh" [voice prompt]

[Creator]

"Would you like to add a new participant?" [voice prompt]

The creator of the Mesh can accept the request for a user to join the closed intercom.

Accept a participant

[Creator]

ACCEPT = Mesh Intercom Button - Tap 1x [icon]

[Participant]

"Joined the mesh" [voice prompt]

The creator of the Mesh can reject the request for a user to join the closed intercom.

Reject a participant

[Creator]

REJECT = Mesh Intercom Button - Hold 1s [icon]

[Participant]

"Mesh intercom denied" [voice prompt]

### 8.3.3. Quit the Mesh

Users that quit the Mesh will automatically return to **Public Mode**.

Quick the Mesh

QUIT MESH [icon] = Mesh Intercom Button - Hold 8s

"Quit the mesh" [voice prompt]

**Note:** When a user quits the Mesh, the headset will automatically switch to **Public Mode** and the stored **Mesh Network** information will be deleted.

### 8.3.4. Toggle Public Mode / Private Mode

A user is able to toggle between **Public Mode** and **Private Mode** without quitting the Mesh. This allows the user to keep the **Mesh Network** connection information while in **Public Mode**. The user can toggle to **Private Mode** to communicate with participants from the stored **Mesh Network** information.

### Toggle Public Mode

Mesh Intercom Button = Hold 3s [icons]

"Public Mode" [voice prompt]

### Toggle Private Mode

Mesh Intercom Button = Hold 3s [icons]

"Private Mode" [voice prompt]

#### 8.3.5. Mic Enable/Disable (Default: Enable)

User's can enable/disable the microphone when communicating in a **Mesh Intercom**. This can be done in either **Public Mode** or **Private Mode**.

#### Enable / Disable the Microphone

Mesh Intercom Button = Hold 1s [icons]

"Mic on / Mic off" [voice prompt]

### 8.4. Mesh Intercom Conference with Bluetooth Intercom Participant

Users can use the existing Bluetooth intercom and **Mesh Intercom** function at the same time. In this case, it is recommended to communicate with other Sena headsets via Bluetooth intercom connection and use **Mesh Intercom** between 30K headsets. Please refer to **Section 7: "Bluetooth Intercom Setup"** for more details.

**Note:** Sena recommends that non-30K headsets not be in a multi-way Bluetooth intercom conference with two or more 30K participants in a Mesh.

## 9. Using the FM Radio

### 9.1. FM Radio On/Off

To turn on or shut off the FM radio, press the **Phone Button** for **1 second** until you hear a double beep.

FM Radio On

FM RADIO OFF = Phone Button - Hold 1s [icons]

"FM on" [voice prompt]

## FM Radio Off

FM RADIO OFF = Phone Button - Hold 1s [icons]

"FM off" [voice prompt]

## 9.2. Seek and Save Radio Stations

The "**Seek**" feature searches for radio stations.

1. Rotate while pressing the **Jog Dial** clockwise or counterclockwise to search for radio stations.

### Seek Stations Forward

SEEK FORWARD = Jog Dial - Press while rotating Right [icons]

### Seek Stations Backward

SEEK BACKWARD [icon] = Jog Dial - Press while rotating Left [icons]

2. To save the current station, press and hold the **Jog Dial** for **1 seconds** until you hear the voice prompt, "**Preset (#).**"

### Enter Preset Selection Mode

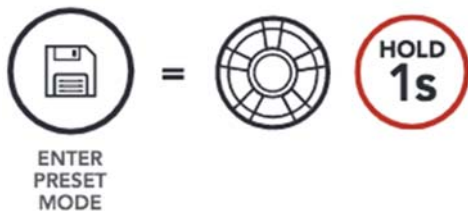

### Enter Preset Selection Mode

ENTER PRESET MODE = Jog Dial - Hold 1s [icons]

"Preset (#)" [voice prompt]

3. Rotate the **Jog Dial** to navigate through the preset numbers that you want to store.

### Navigate Forward through Preset Stations

NAVIGATE FORWARD = Jog Dial - Rotate Right [icons]

### Navigate Backward through Preset Stations

NAVIGATE BACKWARD = Jog Dial - Rotate Left [icons]



4. Tap the **Jog Dial** to save the station in the preset number you choose. Or, tap the **Phone Button** to delete the station from memory.

#### Save Station to the Preset Number

SAVE TO PRESET # = Jog Dial - Tap 1x [icons]

#### Delete Station from Memory

DELETE STATION = Phone Button - Tap 1x [icons]

### 9.3. Scan and Save Radio Stations

The “**Scan**” function automatically searches for radio stations, starting with the current station’s frequency, then up from there.

1. Double tap the **Phone Button** to scan for stations.

#### Save and Save Radio Stations

START SCANNING = Phone Button - Tap 2x [icons]

2. The Sena tuner pauses at each station it finds for **8 seconds** before moving to the next.
3. To save the current station, tap the **Phone Button**. The station will be saved as the next preset number.

#### Save the Current Station

SAVE STATION = Phone Button - Tap 1x [icons]

“Save preset (#)” [voice prompt]

4. To stop scanning, double tap the **Phone Button**.

#### Stop Scanning

STOP SCANNING = Phone Button - Tap 2x [icons]

### 9.4. Temporary Station Preset

The **Temporary Preset** feature automatically finds and saves the nearest 10 radio stations without changing your existing preset stations.

1. Tap the **Phone Button** three times to automatically find and save 10 stations.

## Temporary Stations

**TEMPORARY STATIONS** = Phone Button - Tap 3x [icons]

2. The temporary preset stations will be cleared when the headset reboots.

### 9.5. Navigating Preset Stations

Using the methods above, up to 10 radio stations can be stored. Tap the **Phone Button** to navigate through the saved stations.

## Navigate through Preset Stations

**NAVIGATE FORWARD** = Phone Button - Tap 1x [icons]

**Note:** You can use the **Sena Device Manager** or the **Sena Smartphone App** to save the preset stations.

### 9.6. Region Selection (Default: Worldwide)

You can select the proper FM frequency range for your location from the **Sena Device Manager** or the **Sena Smartphone App**. Using the region setting, you can optimize the seek function to avoid unnecessary frequency ranges.

Region	Frequency range	Step
Worldwide	76.0 ~ 108.0 MHz	± 100 kHz
North America, South America and Australia	87.5 ~ 107.9 MHz	± 200 kHz
Asia and Europe	87.5 ~ 108.0 MHz	± 100 kHz
Japan	76.0 ~ 95.0 MHz	± 100 kHz

### 9.7. Radio Data System (RDS) Alternative Frequency (AF) Setting (Default: Enable)

The **RDS AF** setting can be found in the settings menu, accessible through **Sena Device Manager** or **Sena Smartphone App**. Please refer to **Section 3.6: “Downloadable Sena Software”** for more details.

When radio station signals get too weak for a good reception, with **RDS AF** enabled, the Sena radio receiver re-tunes to a station with better reception. If **RDS AF** is disabled, you'll have to find stronger stations manually.

#### **9.8. FM Station Guide (Default: Enable)**

The **FM Station Guide** setting can be found in the settings menu, accessible through **Sena Device Manager** or **Sena Smartphone App**. Please refer to **Section 3.6: “Downloadable Sena Software”** for more details.

When **FM Station Guide** is enabled, FM station frequencies are given by voice prompts as you select preset stations. When **FM Station Guide** is disabled, the voice prompts on FM station frequencies will not be given as you select preset stations.

## **10. Ambient Mode**

You can hear the ambient sound outside of your helmet by activating the **Ambient Mode**. To activate the **Ambient Mode**, press the **Ambient Mode Button** twice which is placed on the bottom of the clamp unit. To deactivate the **Ambient Mode**, press the **Ambient Mode Button** twice again.

### **Ambient Mode**

**START/STOP AMBIENT MODE [icon] = Ambient Mode Button - Tap 2x**

**Note:** The **Ambient Mode** has higher priority than mobile phone, so you cannot make or answer phone call, listen to music, or have an intercom conversation if the **Ambient Mode** is activated.

## **11. Voice Command**

The voice command of the [headset](#) allows you to operate certain operations by simply using your voice. You can control the [headset](#) completely handsfree using the voice recognition. The voice command function works only with English commands.



### Voice Command

**START VOICE COMMAND = Ambient Mode Button - Tap 1x or "Hello Sena"** [voice command] [icons]

Speak a voice command from the table below:

Mode Status	Function	Voice Command
Standby / Music / FM Radio	Start/End each Intercom	<b>"Intercom [one, two, three]"</b>
	End all intercoms	<b>"End intercom"</b>
	Call last intercom	<b>"Last intercom"</b>
	Group intercom	<b>"Group intercom"</b>
	Intercom pairing	<b>"Pairing intercom"</b>
	Cancelling operations	<b>"Cancel"</b>
Standby	Play/Pause music	<b>"Music" or "Stereo"</b>
	Turn on/off FM radio	<b>"FM radio"</b>
	Check Battery	<b>"Check battery"</b>
	Speed Dialing	<b>"Speed dial [one, two, three]"</b>
	Redial the last call	<b>"Redial"</b>
	Voice command help	<b>"What can I say?"</b>
	Check connected devices	<b>"Connected devices"</b>

	Configuration menus	<b>“Configuration”</b>
Music / FM Radio	Next track (music) / next preset (FM radio)	<b>“Next”</b>
	Previous track (music) / previous preset (FM radio)	<b>“Previous”</b>
	Stop music / FM Radio	<b>“Stop”</b>
Mesh Intercom	Mesh Intercom On/Off	<b>“Mesh Intercom” / “End Intercom”</b>
	Create a Mesh	<b>“Create Mesh”</b>
	Quit the Mesh	<b>“Quit Mesh”</b>

**Note:**

1. Voice command performance may vary based on the environmental conditions including riding speed, helmet type and ambient noise. To improve the performance, minimize wind noise on the microphone by using a large microphone sponge and closing the visor.
2. To activate the voice command during non-standby functions, tap the **Ambient Mode Button** once.
3. If the headset is in standby mode for longer than one minute then the microphone will automatically be disabled and the **Voice Command** feature cannot be activated by saying **“Hello Sena”**. The **Voice Command** feature will need to be activated by tapping the **Ambient Mode Button** once.

### **11.1 Voice Command Setting (Default: Enable)**

A **Voice Command** setting can be found in the settings menu, accessible through **Sena Device Manager** or **Sena Smartphone App**. Please refer to **Section 3.6: “Downloadable Sena Software”** for more details.

When **Voice Command** is enabled, you can use your voice to give a command the headset operate certain operations completely handsfree. If **Voice Command** is disabled, you will need to operate all of the functions using the buttons on the headset.

## 12. General Settings

### 12.1. Function Priority

The headset prioritizes connected devices in the following order:

(highest) Voice command mode

Ambient Mode

Mobile phone

Mesh Intercom / Bluetooth Intercom

Stereo music by audio cable

Music sharing via Bluetooth stereo

FM radio

(lowest) Bluetooth stereo music

A lower-priority function gets interrupted by a higher-priority function. For example, stereo music will be interrupted by an **Intercom Conversation**; an **Intercom Conversation** will be interrupted by an incoming mobile phone call.

### 12.2. Firmware Upgrades

The **headset** supports firmware upgrades. You can upgrade the firmware using the **Sena Device Manager**. Please refer to **Section 3.6.1: “Sena Device Manager”** for more details. Please visit [sena.com](http://sena.com) to check for the latest software downloads.

[Click Here to Visit Sena.com](http://sena.com)

### 12.3. Voice Prompts (Default: Enable)

A **Voice prompt** setting can be found in the settings menu, accessible through **Sena Device Manager** or **Sena Smartphone App**. Please refer to **Section 3.6: “Downloadable Sena Software”** for more details.

If **Voice prompt** is enabled, you can hear **Voice prompts** for different kinds of features. If **Voice prompt** is disabled, **Voice prompts** are silenced except for those in the Configuration Menu, battery level indication, speed dial, and FM radio functions.

### 12.4. Sidetone (Default: Disable)

A **Sidetone** setting can be found in the settings menu, accessible through **Sena Device Manager** or **Sena Smartphone App**. Please refer to **Section 3.6: “Downloadable Sena Software”** for more details.

**Sidetone** is the sound of your own voice as picked up by your headset’s microphone and reproduced in your own ear, by your own speaker. It helps you to naturally speak at the correct level according to varying helmet noise conditions. If this feature is enabled, you can hear what you are speaking during an intercom conversation or a phone call.

### 12.5. Delete All Bluetooth Pairing Information

A **Delete All Bluetooth Pairing Information** setting can be found in the **Configuration Menu**. Please refer to **Section 3.7: “Configuration Menu”** for more details.

Tap the **Phone Button** when in this menu to **Delete All Bluetooth Pairing Information** stored in the headset.

Access Delete All Pairings in the Configuration Menu

ACCESS CONFIG. MENU [icon] = Hold Jog Dial - 10 seconds [icons]

“Configuration Menu” [voice prompt]

NAVIGATE FORWARD [icon] = Jog Dial - Rotate Right

“Delete all pairings” [voice prompt]

EXECUTE [icon] = Phone Button - tap 1x

## 13. Remote Control

You can remotely control the **headset** using Sena Remote Control devices (sold separately) such as a Handlebar Remote or a Wristband Remote. This eliminates the need to remove your hands from the handlebars for button operations.

### 13.1. Pairing with the Remote Control

1. Turn on the **headset** and the Remote Control device.
2. Execute **Remote Control Pairing** in the **Configuration Menu**. Please refer to **Section 3.7: “Configuration Menu”** for more details.

Access Remote Control Pairing in the Configuration Menu

ACCESS CONFIG. MENU [icon] = Jog Dial - Hold 10s [icons]

“Configuration Menu” [voice prompt]

NAVIGATE FORWARD [icon] = Jog Dial - Rotate Right [icons]

“Remote control pairing” [voice prompt]

EXECUTE [icon] = Phone Button - tap 1x

3. Enter pairing mode in the Remote Control device. The **headset** will automatically connect with the Remote Control device in pairing mode. You will hear a voice prompt, “**Remote control connected**”, when they are successfully paired.

Enter Pairing Mode

REMOTE CONTROL = Enter Pairing Mode on Remote Control [icon]

“Remote control connected” [voice prompt]

## 14. Troubleshooting

Please visit **Sena.com** for answers to frequently asked questions. This detailed online FAQ section deals with troubleshooting, illustrates case studies and contains tips on using the **headset**.

[Click Here to Visit Sena.com](#)

### 14.1. Fault Reset

When the **headset** is not working properly, you can easily reset the unit:

1. Locate the pinhole reset button below on the back of the main unit.
2. Gently insert a paperclip into the hole and press the **Fault Reset Button** for **1 second** with light pressure.

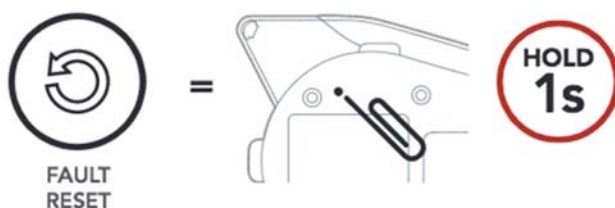

Fault Reset = Hold 1sec

3. The headset will shut down.

**Note:** Fault Reset will not restore the headset to factory default settings.



## 14.2. Factory Reset

To erase all of your settings and start fresh, the headset can be restored to factory default settings using the **Factory Reset** feature.

Phone Button = Hold 10s [icons]  
"Factory Reset" [voice prompt]  
LED status = Solid red.

Jog Dial = Tap 1x [icons]  
"Headset reset, good-bye" [voice prompt]

**Note:** If you press the **Phone Button** or don't press the **Jog Dial** within **5 seconds**, the reset attempt is canceled and the headset returns to **standby** mode. You will hear a voice prompt saying "**Canceled**".

The distance between the antenna of the device and the head surface is at least 30mm and use 30mm or more.  
La distancia entre la antena del dispositivo y la superficie de la cabeza es de al menos 30mm y utilice una parte de 30mm o mas.

## Safety Precautions

Please ensure that the product is properly used by observing the safety precautions below to prevent any risk of serious injury, death and/or damage to property.

### Hazard alert signal words

The following safety symbols and signal words are used in this manual.

**⚠️ WARNING**  
Indicates a potential hazardous situations that, if not avoided, could result in death or serious injury.

**⚠️ CAUTION**  
Indicates a potential hazardous situation that, if not avoided, could result in minor or moderate injury.

**NOTICE**  
Indicates information considered important, but not hazard-related. If not avoided, it could cause damage to your product.

**Note**  
Notes, usage tips, or additional information

### Product Use

Observe the following precautions to avoid injury or damage to your product while using the product.

**⚠️ WARNING**

- Use of the product at a high volume for a long period of time may damage your eardrums or hearing ability.
- If the product emits an unusual smell, feels hot, or appears abnormal in any other way while using or charging, stop using it immediately. It may cause damage, explosion, or fire. Contact your sales location if any of these problems are observed.
- Careless use of the product on the road is risky and may result in serious injury, death or damage. You must heed all safety precautions in all documents that come with this product. This will help minimize the chance these risks may occur while riding.
- In any place where wireless communication is prohibited, such as hospitals or airplanes, turn off the power. In a place where wireless communication is prohibited, electromagnetic waves may cause hazards or accidents.
- Before riding, fasten the product from the helmet, and double-check that it is properly fastened. Separation of the product while riding will cause damage to the product and may result in an accident.
- Do not use the product in an explosive atmosphere. If you are in such a location, turn off the power and heed any regulations, instructions, and signs in the area.
- When you use the product while you operating any vehicle or equipment such as motorcycles, scooters, mopeds, ATVs, or quadbikes (hereinafter called "transportation means"), you need to follow the safety precautions provided by the manufacturer of the vehicle.
- When you use the product, use good judgment; never use it under the influence of alcohol or drugs or when you are extremely tired.



- Ne pas nettoyer le produit avec des solvants de nettoyage, des produits chimiques ou des détergents puissants, car cela pourrait endommager le produit.
- Ne pas peindre le produit. La peinture pourrait obstruer les pièces amovibles ou interférer avec le fonctionnement normal du produit.
- Ne pas laisser tomber ou cogner l'appareil. Cela pourrait endommager le produit ou ses circuits électroniques internes.
- Ne pas démonter, réparer ou modifier le produit, car cela pourrait endommager le produit et annuler sa garantie.
- Ne rangez pas le produit dans un environnement humide, surtout pendant de longues périodes. Cela pourrait endommager ses circuits électroniques internes.
- Les performances de la batterie se dégradent avec le temps en cas d'entreposage pendant une période prolongée.

## CERTIFICATION ET HOMOLOGATION DE SÉCURITÉ

### Déclaration de conformité FCC

Cet appareil est en conformité avec la partie 15 des règles de la FCC. Son fonctionnement est soumis aux deux conditions suivantes:
(1) Cet appareil ne doit pas créer d'interférences préjudiciables et
(2) Cet appareil doit accepter toutes les interférences reçues, y compris celles qui pourraient entraver son bon fonctionnement.

Cet équipement a été testé et jugé conforme aux limites pour un appareil numérique de classe B, conformément à la partie 15 des règles de la FCC. Ces limites sont conçues pour fournir une protection raisonnable contre les interférences nuisibles dans une installation résidentielle. Cet équipement génère et utilise de l'énergie radio fréquence et, s'il n'est pas installé et utilisé conformément aux instructions, il peut occasionner des interférences nuisibles au niveau des communications radios. Cependant, il n'existe aucune garantie que ces interférences ne se produiront pas dans une installation particulière. Si cet équipement génère des interférences nuisibles à la réception de la radio ou de la télévision (ce qui) est possible de déterminer en mettant l'équipement hors tension, puis sous tension), l'utilisateur est invité à suivre une ou plusieurs des mesures suivantes pour corriger le problème des interférences en prenant l'une des mesures suivantes:
• Modifier l'emplacement ou l'orientation de l'antenne de réception.
• Éloigner l'appareil du récepteur.
• Brancher l'appareil sur une prise située sur un circuit différent de celui du récepteur.
• Consulter le revendeur ou un technicien expérimenté pour obtenir de l'aide.

**Énoncé FCC sur l'exposition aux radiations RF**  
Cet équipement est conforme aux réglementations FCC d'exposition aux radiations définies pour un environnement non contrôlé. Les utilisateurs doivent respecter les instructions d'exploitation spécifiques pour répondre aux exigences de conformité sur l'exposition aux RF. L'antenne utilisée pour cet appareil ne doit pas fonctionner en même temps qu'une autre antenne ou émetteur, sauf s'il y a une conformité avec les procédures FCC des produits multi-antennes.

### Précautions FCC

Tout changement ou modification non expressément approuvé par la partie chargée de la mise en conformité peut annuler le droit de l'utilisateur à utiliser l'équipement.

## Déclaration de conformité CE

Ce produit porte un marquage CE, conformément aux dispositions de la directive R&TTE (2014/53/EU). Sena déclare par la présente

- NOTICE**  
• Ataching the product to the helmet is considered a modification to the helmet and may void your helmet's warranty or compromise your helmet's functionality. This may entail risks during an accident, so be fully aware of this fact before using the product. Should you not accept this fact, you may return the product for a full refund.
- In some regions, it is prohibited by law to ride motorcycles while wearing headsets or earbuds. Therefore be certain you are aware of all relevant laws in the region where you are using the product and are sure that you comply with them.
- The headset is for motorcycle helmets only. To install the headset, follow the installation instructions shown in the User's Guide.
- Do not impact the product with sharp tools as this may damage the product.
- Keep product away from pets or small children. They may damage the product.
- Any changes or modifications to the equipment not expressly approved by the party responsible for compliance could void the limited warranty to operate the equipment.

### Battery

Your product has a built-in battery. Be careful to heed all safety information in this guide. Failure to carefully observe the safety precautions can cause battery heat generation, bursting, fire and serious personal injury.

**⚠️ WARNING**  
Do not use the product in direct sunlight for a long period of time. Doing so can damage the product and generate heat that can cause burns.

- Do not use or store the product inside cars in hot weather. It may cause the battery to generate heat, rupture, or ignite.
- Do not continue charging the battery if it does not recharge within the specified charging time. Doing so may cause the battery to become hot, explode, or ignite.
- Do not leave the product near open flames. Do not dispose of the product in a fire. It may cause the battery to become hot, explode, or ignite and cause serious injury.
- Never attempt to charge a battery with the charger which has been physically damaged. It may cause explosion and/or accidents.

### Product Storage and Management

Take the following precautions to avoid personal injury or damage to your product while storing and maintaining the product.

**⚠️ CAUTION**

- Do not dispose of the product with household waste. The built-in battery is not to be disposed of in municipal waste stream and requires separate collection. Disposal of the product should be done in accordance with the local regulations.
- NOTICE**  
• Keep the product free of dust. Dust may damage mechanical and electronic parts of the product.
- The product should be stored at room temperature. Do not expose the product to extremely high or low temperature as this may reduce the life span of electronic devices, damage the battery, and/or melt plastic parts of the product.
- Do not clean the product with cleaning solvents, toxic chemicals, or strong detergents as this may damage the product.
- Do not paint the product. Paint may obstruct moving parts or interfere with the normal operation of the product.
- Do not drop or otherwise shock the product. It may damage the product or its internal electronic circuits.

- Do not disassemble, repair or modify the product as this may damage the product and void the product warranty.
- Do not store the product in humid environments, especially for long periods of time. It may damage the internal electronic circuits.
- Battery performance will deteriorate over time if stored for a long period of time without being used.

## CERTIFICATION AND SAFETY APPROVALS

This device complies with part 15 of the FCC rules. Operation is subject to the following two conditions:
(1) This device may not cause harmful interference, and
(2) This device must accept any interference received, including interference that may cause undesired operation.

This equipment has been tested and found to comply with the limits for a Class B digital device pursuant to part 15 of the FCC rules. These limits are designed to provide reasonable protection against harmful interference in a residential setting. This equipment generates, uses and can radiate radio frequency energy and, if not installed and used in accordance with the instructions, may cause harmful interference to radio communications. However, there is no guarantee that interference will not occur in a particular installation. If this equipment does cause harmful interference to radio or television reception, which can be determined by turning the equipment on and off, the user is encouraged to try to correct the interference by one or more of the following measures:

- Reorient or relocate the receiving antennae
- Increase the separation between the equipment and the receiver
- Connect the equipment into an outlet on a circuit different from that to which the receiver is connected.
- Consult the dealer or an experienced radio/TV technician for help.

### FCC RF Exposure Statement

This equipment complies with FCC radiation exposure limits set forth for an uncontrolled environment. End users must follow the specific operating instructions for satisfying RF exposure compliance. The antenna used for this transmitter must not transmit simultaneously with any other antenna or transmitter, except in accordance with FCC multi-transmitter product procedures.

### FCC Caution

Any changes or modifications to the equipment not expressly approved by the party responsible for compliance could void user's authority to operate the equipment.

### CE Declaration of Conformity

This product is CE marked according to the provisions of the R&TTE Directive (2014/53/EU). Hereby, Sena declares that the radio equipment type SP46 is in compliance with Directive 2014/53/EU. For further information, please consult www.sena.com. Please note that this product uses radio frequency bands not harmonized within EU. Within the EU this product is intended to be used in Austria, Belgium, Denmark, Finland, France, Germany, Greece, Ireland, Italy, Luxembourg, The Netherlands, Portugal, Spain, Sweden, United Kingdom and within EFTA in Iceland, Norway and Switzerland.

**Termination**  
Quality warranty of the product becomes effective on the date of initial purchase. In addition, the quality warranty of the product expires when the warranty period expires. However, in the following cases, the warranty will be terminated prematurely.

- In the event the product has been sold or transferred to a third party.

• In the event the manufacturer's name, serial number, product label, or other markings have been modified or removed.

- In the event any unauthorized person has tried to disassemble, repair, or modify the product.

### Industry Canada Statement

This device complies with Industry Canada license-exempt RSS standard(s). Operation is subject to the following two conditions:
(1) This device may not cause interference.
(2) This device must accept any interference, including interference that may cause undesired operation of the device.

### Bluetooth License

The Bluetooth® word mark and logos are owned by the Bluetooth SIG, Inc. and any use of such marks by Sena is under license. Other trademarks and trade names are those of their respective owners. The product is compliant with and adopts the Bluetooth® Specification 4.1, and has successfully passed all interoperability tests that are specified in the Bluetooth specification. However, interoperability between the device and other Bluetooth®-enabled products is not guaranteed.

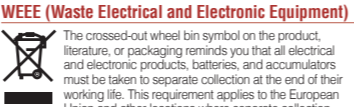

**WEEE (Waste Electrical and Electronic Equipment)**  
The crossed-out wheel bin symbol on the product, literature, or packaging reminds you that all electrical and electronic products, batteries, and accumulators must be taken to separate collection at the end of their working life. This requirement applies to the European Union and other locations where separate collection systems are available. To prevent possible harm to the environment or human health from uncontrolled waste disposal, please do not dispose of these products as unsorted municipal waste, but hand it in at an official collection point for recycling.

## LIMITED PRODUCT WARRANTY DISCLAIMERS, and LIMITATIONS

### Limited Warranty

#### Limited Warranty

Sena Technologies, Inc. ("Sena") guarantees the product quality based on the technical specification stated in the product manual, and data regarding product warranty. Here, product warranty extends to the product only.

#### Warranty Period

Sena warrants that this product shall conform to and perform in accordance with published technical specifications and the accompanying written materials, and shall be free of defects in materials and workmanship, for a period of two (2) years from the date of purchase by the first consumer purchaser of the Product. This limited warranty extends only to the original consumer purchaser of the Product and is not assignable or transferable to any subsequent purchaser/end-user.

Quality warranty of the product becomes effective on the date of initial purchase. In addition, the quality warranty of the product expires when the warranty period expires. However, in the following cases, the warranty will be terminated prematurely.

- In the event the product has been sold or transferred to a third party.

• In the event the manufacturer's name, serial number, product label, or other markings have been modified or removed.

- In the event any unauthorized person has tried to disassemble, repair, or modify the product.

#### Notice and Waiver

By buying and using this product, you relinquish considerable legal rights including any claim for compensation for damages. Therefore, be certain to read and understand the following terms and conditions before using the product. Use of this product will constitute consent to this agreement, and forfeiture of rights to all claims. If you do not consent to all the terms and conditions of this agreement, return the product for a refund.

- You must completely understand and accept all risks (including those occurring due to any careless behavior of yours or others) which may occur during the use of this product.
- You are responsible for ensuring that your medical condition permits usage of the product and that you are in sufficient physical condition for using any device which can be used with it. In addition, you must ensure that the product does not limit your abilities and that you are able to use it safely.
- You must be an adult who can take responsibilities for using the product.
- You must read and understand the following warnings and alerts:
  - Sena, together with employees, managers, partners, subsidiaries, representatives, agents, supporting firms and suppliers, sole sellers of Sena (collectively referred to as "the company") recommend that, before using the product and/or any device of any brand including its derivative models, you collect any relevant information in advance and be entirely prepared in terms of weather, traffic situation, and road conditions.
  - When you use the product while you operating any vehicle or equipment such as motorcycles, scooters, mopeds, ATVs, or quad-bikes (hereinafter called "transportation means"), you need to follow the safety precautions provided by the manufacturer of the vehicle.
  - When you use the product, use good judgment; never use it under the influence of alcohol.
- You must read and completely understand all terms and conditions of legal rights and warnings that are involved in using the product. In addition, usage of the product constitutes acceptance of all terms and conditions regarding waiver of rights.

### Warranty Exclusions

#### Reasons for Limited Liabilities

If you do not return the product after purchasing it, you relinquish all rights to liabilities, loss, claims, and claims for reimbursement of expenses (including attorney's fees). Therefore, Sena will not be liable for physical injury, death, or any loss or damage of transportation means, possessions, or assets which belong to you or third parties that may have occurred while you use the product. Further, Sena will not be liable for any substantial damage not related to the condition, environment, or malfunction of the product. All risks related with the operation of the product depend entirely on the user regardless of its use by the initial purchaser of a third party. Use of this product may violate local or national laws. In addition, be aware once again that correct and safe use of the product is entirely your responsibility.

#### Limitation of Liability

TO THE FULL EXTENT ALLOWED BY LAW, SENA EXCLUDES FOR ITSELF AND ITS SUPPLIERS ANY LIABILITY, WHETHER BASED IN CONTRACT OR TORT (INCLUDING NEGLIGENCE), FOR INCIDENTAL, CONSEQUENTIAL, INDIRECT, SPECIAL, OR PUNITIVE DAMAGES OF ANY KIND, OR FOR LOSS OF REVENUE OR PROFITS, LOSS OF BUSINESS, LOSS OF INFORMATION OR DATA, OR OTHER FINANCIAL LOSS ARISING OUT OF OR IN CONNECTION WITH THE SALE, INSTALLATION, MAINTENANCE, USE, PERFORMANCE, FAILURE, OR INTERRUPTION OF ITS PRODUCTS, EVEN IF SENA OR ITS AUTHORIZED RESELLER HAS BEEN ADVISED OF THE POSSIBILITY OF SUCH DAMAGES, AND LIMITS ITS LIABILITY TO REPAIR, REPLACEMENT, OR REFUND OF



## Deutsch

## Sicherheitsvorkehrungen

Achten Sie darauf, dass Sie das Produkt ordnungsgemäß verwenden, indem Sie die unten stehenden Sicherheitsvorkehrungen beachten, um das Risiko von schweren oder tödlichen Verletzungen und/oder Schäden an Sachgegenständen zu vermeiden.

### Signalwörter für Gefahrenmeldungen

In dieser Anleitung werden folgende Sicherheitssymbole und Signalwörter verwendet.

**⚠️ WARNUNG**  
Kennzeichnet potenzielle Gefahrensituationen, die zu schweren oder sogar tödlichen Verletzungen führen können, sofern sie nicht vermieden werden.

**⚠️ VORSICHT**  
Kennzeichnet potenzielle Gefahrensituationen, die zu leichten oder mittelschweren Verletzungen führen können, sofern sie nicht vermieden werden.

### ZU BEACHTEN

Kennzeichnet Informationen, die wichtig sind, aber sich nicht auf Gefahrensituationen beziehen. Wird eine der geschilderten Situationen nicht verhindert, kann dies zu Schäden am Produkt führen.

#### Hinweis

Hinweise, Tipps für die Verwendung und zusätzliche Informationen

### Produktverwendung

Beachten Sie die folgenden Sicherheitsvorkehrungen, um bei der Verwendung des Produkts Verletzungen oder Schäden am Produkt zu verhindern.

**⚠️ WARNUNG**  
Die Verwendung des Produkts mit hoher Lautstärke über einen langen Zeitraum kann zu Schäden der Trommelfelle oder der Hörfähigkeit führen.

• Sollte das Produkt beim Laden ungewöhnlich riechen, heiß werden oder andere Auffälligkeiten aufweisen, beenden Sie sofort den Ladevorgang. Andernfalls besteht Schadens-, Feuer- oder Explosionsgefahr. Wenden Sie sich an Ihre Verkaufsstelle, falls Sie eines der genannten Probleme bemerken.

- Einem unsichrige Verwendung des Produkts im Straßenverkehr führt zu Risiken und unter Umständen zu schweren oder sogar tödlichen Verletzungen oder Schäden. Beachten Sie alle Sicherheitsvorkehrungen in allen Dokumenten, die diesem Produkt beiliegen. Dadurch minimieren Sie die Wahrscheinlichkeit, dass Sie während der Fahrt eines der genannten Risiken eingehen.
- An Orten, an denen die drahtlose Kommunikation verboten ist (etwa in Krankenhäusern oder Flugzeugen) muss das Produkt ausgeschaltet werden. An Orten, an denen drahtlose Kommunikation verboten ist, können elektromagnetische Wellen zu Gefahren oder Unfällen führen.
- Befestigen Sie das Produkt vor der Fahrt am Helm und vergewissern Sie sich, dass es fest und sicher sitzt. Das Entfernen des Produkts während der Fahrt kann zu Schäden am Produkt und zu Unfällen führen.

THE PURCHASE PRICE PAID, AT SENA'S OPTION, THIS DISCLAIMER OF LIABILITY FOR DAMAGES WILL NOT BE AFFECTED IF ANY REMEDY PROVIDED HEREIN SHALL FAIL OF ITS ESSENTIAL PURPOSE. IN ANY CASE, THE TOTAL COMPENSATION LIABILITIES OF SENA OR ITS SALES AGENTS SHALL NOT EXCEED THE PRICE PAID FOR THE PRODUCT BY THE PURCHASER.

#### Liabilities Disclaimer

- In addition to damages which may occur due to the use of the product, Sena will not be liable for damages of the product which occur due to the following events.
- In the event the product is misused or used for purposes other than its intended purposes.
- In the event the product is damaged because the user does not follow the content of the product manual.
- In the event the product is damaged because it has been left unattended or has undergone any other accident.
- In the event the product is damaged because the user has used any parts or software which are not provided by the manufacturer.
- If the event the product is damaged because the user has disassembled, repaired, or modified it in such way as is not explained in the product manual.
- In the event the product is damaged by a third party.
- In the event the product is damaged due to Acts of God (including fire, flood, earthquake, storm, hurricane or other natural disaster).
- In the event the surface of the product is damaged by use.

### Warranty Service

To obtain product warranty service, send the defective product, at your expense, to the manufacturer or the seller along with proof of purchase (a receipt that shows the purchase date, a product registration certificate of the Website, and other relevant information). Take necessary measures to protect the product. In order to get a refund or replacement, you must include the whole package as it was purchased. Sena will provide free-of-charge repair or replacement service for the product when product defects occur within the scope of the product warranty during the warranty period.

**Sena Technologies, Inc.**  
www.sena.com  
Customer Support: support.sena.com  
E-mail: support@sena.com



**Sena Technologies, Inc.**  
www.sena.com  
Customer Support: support.sena.com  
E-mail: support@sena.com

- Verwenden Sie das Produkt nicht in einer Umgebung mit explosionsfähiger Atmosphäre. Sollten Sie sich in einer solchen Umgebung befinden, deaktivieren Sie das Gerät und beachten Sie alle Vorschriften, Anweisungen und Schilder vor Ort.
- Wenn Sie das Produkt bei der Fahrt mit einem Fahrzeug wie einem Motorrad, Motorroller/Scooter, Moped, ATV oder Quad (nachfolgend „Transportmittel“ genannt) verwenden, müssen Sie die Sicherheitsvorschriften des Fahrzeugherstellers einhalten.
- Verwenden Sie das Produkt mit Bedacht und nutzen Sie es nie in alkoholisiertem Zustand, unter Drogeneinfluss oder wenn Sie sich nicht mehr selbst kontrollieren können.

#### ZU BEACHTEN

- Das Anbringen des Produkts am Helm gilt als Modifikation des Helms und kann dazu führen, dass die Garantie des Helms erlischt oder die Funktionalität des Helms beeinträchtigt wird. Dies birgt ein erhöhtes Risiko im Falle eines Unfalls. Sie sollten sich daher darüber im Klaren sein, bevor Sie das Produkt verwenden. Sollten Sie dies nicht akzeptieren, können Sie das Produkt zurückgeben. Der Kaufpreis wird vollständig erstattet.
- In manchen Regionen ist es gesetzlich untersagt, auf Motorrädern Headsets oder Hörnhörer zu verwenden. Stellen Sie daher sicher, dass Sie alle geltenden Gesetze kennen, die in der Region gelten, in der Sie das Produkt verwenden, und dass Sie diese Gesetze einhalten.
- Das Headset ist nur für die Verwendung mit Motorradhelmen vorgesehen. Befolgen Sie beim Anbringen des Headsets die Installationsanleitung im Benutzerhandbuch.
- Wirken Sie nicht mit scharfen Werkzeugen auf das Produkt ein, da dies zu Schäden am Produkt führen kann.
- Halten Sie das Produkt von Haustieren und kleinen Kindern fern. Andernfalls kann es zu Schäden am Produkt kommen.
- Jegliche Änderung oder Modifikation der Ausrüstung, die nicht ausdrücklich durch diejenige Partei genehmigt wurde, die für die Einhaltung der Vorschriften verantwortlich ist, kann die Garantie beim Betrieb des Geräts unwirksam machen.

### Akku

Das Gerät verfügt über einen integrierten Akku. Beachten Sie alle Sicherheitsvorkehrungen in dieser Anleitung. Falls Sie die Sicherheitsvorkehrungen nicht genau beachten, kann dies zu einer Wärmeentwicklung am Akku oder einer Explosion, einem Brand oder schweren Verletzungen führen.

- ⚠️ WARNUNG**  
• Nutzen Sie das Gerät nicht über einen längeren Zeitraum, wenn es direkter Sonneneinstrahlung ausgesetzt ist. Andernfalls kann es zu Schäden am Produkt oder zu einer starken Wärmeentwicklung am Akku oder einer Explosion, einem Brand oder schweren Verletzungen führen.
- Verwenden und lagern Sie das Produkt bei hohen Temperaturen nicht im Auto. Andernfalls kann sich der Akku erhitzen, entzünden oder platzen.
- Laden Sie den Akku nicht weiter, wenn er nicht innerhalb der angegebenen Ladedauer geladen wird. Andernfalls kann sich der Akku erhitzen, entzünden oder platzen.
- Bewahren Sie das Produkt nicht in der Nähe von offenem Feuer auf. Entorgen Sie das Produkt nicht durch Verbrennen. Andernfalls kann sich der Akku erhitzen, entzünden oder explodieren und schwere Verletzungen verursachen.
- Versuchen Sie nie, den Akku mit einem beschädigten Ladegerät zu laden. Andernfalls kann es zu einer Explosion und/oder Unfällen kommen.

### Lagerung und Handhabung des Produkts

Treffen Sie die folgenden Sicherheitsvorkehrungen, um bei der Aufbewahrung des Produkts Verletzungen oder Schäden am Produkt zu verhindern.

## Français

## Consignes de Sécurité

Veuillez vous assurer que ce produit est utilisé de manière adéquate et que les consignes de sécurité énumérées ci-dessous sont respectées afin d'éviter tout risque de blessures graves ou mortelles, voire de dommages matériels.

### Signallement d'un danger

Les symboles et termes de sécurité suivants sont utilisés dans le présent manuel.

**⚠️ AVERTISSEMENT**  
Indique une situation potentiellement dangereuse qui, si elle n'est pas évitée, peut entraîner un décès ou des blessures graves.

**⚠️ ATTENTION**  
Indique une situation potentiellement dangereuse qui, si elle n'est pas évitée, peut entraîner des blessures légères à modérées.

**RAPPEL**  
Indique des informations considérées comme importantes, mais ne présentant pas de risques particuliers. Si elles ne sont pas respectées, cela pourrait endommager votre produit.

**Remarque**  
Notes, conseils d'utilisation ou information complémentaire.

### Utilisation du produit

Respectez les précautions suivantes pour éviter de vous blesser ou d'endommager votre produit lors de son utilisation.

**⚠️ AVERTISSEMENT**

- L'utilisation du produit à volume élevé pendant une période prolongée peut endommager les tympans ou la capacité auditive.
- Si le produit dégage une odeur inhabituelle, paraît chaud ou semble se comporter de manière anormale lors de son utilisation ou de sa mise en charge, arrêtez immédiatement de l'utiliser. Cela pourrait entraîner des dommages, une explosion ou un incendie. Contactez le point de vente dans lequel ce produit a été acheté si l'un de ces problèmes venait à être observé.
- Toute négligence lors de l'utilisation de ce produit sur la route est risquée et peut entraîner des dommages matériels ou des blessures graves, voire mortelles. Veillez à respecter toutes les consignes de sécurité indiquées dans les documents fournis avec ce produit. Cela aidera à réduire les facteurs de risque qui peuvent se produire pendant le pilotage.
- Dans les endroits où les communications sans fil sont interdites comme les hôpitaux ou les avions, votre produit doit être mis hors tension. Les ondes électromagnétiques peuvent entraîner des risques ou des accidents dans les endroits où la communication sans fil est interdite.
- Avant de prendre la route, installez le produit sur le casque moto et assurez-vous qu'il est bien fixé. Le retrait du produit durant la conduite peut provoquer des dommages au produit ou entraîner des accidents.
- N'utilisez pas ce produit en présence d'une atmosphère explosive. En cas de risques d'explosion à proximité, éteignez le produit et respectez toute réglementation, instruction ou panneau présent dans la zone.
- Lors de l'utilisation du produit tout en conduisant un véhicule tel que des motos, scooters, cyclomoteurs, quatre-quatx ou quads (ci-après dénommés « moyens de transport »), veillez à respecter les consignes de sécurité indiquées par le fabricant du véhicule.



**⚠️ VORSICHT**  
• Entorgen Sie das Produkt nicht mit dem Hausmüll. Der integrierte Akku darf nicht über den herkömmlichen Hausmüll entsorgt werden und muss gesondert gesammelt werden. Die Entsorgung des Produkts muss den örtlichen Vorschriften entsprechend erfolgen.

#### ZU BEACHTEN

- Halten Sie das Produkt staubfrei. Staub kann mechanische und elektronische Teile des Produkts beschädigen.
- Das Produkt sollte bei Raumtemperatur aufbewahrt werden. Setzen Sie das Produkt nicht sehr hohen oder sehr niedrigen Temperaturen aus, da sich andernfalls die Lebensdauer des Elektronikgeräts verringern und der Akku beschädigt werden kann und/oder Kunststoffteile des Produkts schmelzen können.
- Reinigen Sie das Produkt nicht mit Reinigungsöstungen, giftigen Chemikalien oder aggressiven Reinigungsmitteln, da dies zu Schäden am Produkt führen kann.
- Lackieren Sie das Gerät nicht. Lack kann bewegliche Teile blockieren oder den ordnungsgemäßen Betrieb des Produkts beeinträchtigen.
- Lassen Sie das Produkt nicht fallen und setzen Sie es auch anderweitig keinem Stößen aus. Andernfalls können das Produkt oder seine internen elektrischen Schaltkreise beschädigt werden.
- Demontieren, reparieren oder modifizieren Sie das Produkt nicht, da es andernfalls beschädigt werden und die Gewährleistung erlöschen kann.
- Bewahren Sie das Produkt nicht in einer feuchten Umgebung auf, insbesondere nicht über längere Zeit. Andernfalls können die internen elektrischen Schaltkreise beschädigt werden.
- Die Akkuleistung verschlechtert sich im Laufe der Zeit, falls das Gerät über einen längeren Zeitraum nicht verwendet wird.

### CE-Conformitätserklärung

Dieses Produkt ist gemäß den Bestimmungen der R&TTE-Richtlinie (2014/53/EU) CE-gemärkezeichnet. Sena erklärt hiermit, dass die Funkausrüstung vom Typ SP46 mit der Richtlinie 2014/53/EU konform ist. Weitere Informationen finden Sie unter www.sena.com/ de. Bitte beachten Sie, dass dieses Produkt Radiofrequenzbander nutzt, die innerhalb der EU nicht harmonisiert sind. Innerhalb der EU darf dieses Gerät in Österreich, Belgien, Dänemark, Finnland, Frankreich, Deutschland, Griechenland, Irland, Italien, Luxemburg, den Niederlanden, Portugal, Spanien, Schweden, im Vereinigten Königreich und innerhalb der EFTA in Island, Norwegen und der Schweiz genutzt werden.

## ZULASSUNGEN UND SICHERHEITZERTIFIKATE

### Erklärung zur Einhaltung der FCC-Vorschriften

Dieses Gerät entspricht Abschnitt 15 der FCC-Vorschriften (Federal Communications Commssion – Amerikanische Bundeskommision zur Regelung der Kommunikationswege). Der Betrieb unterliegt den folgenden Bedingungen:

- (1) Dieses Gerät darf keine schädlichen Interferenzen verursachen.
- (2) Das Gerät darf nicht anfällig gegenüber Interferenzen sein, einschließlich solcher, die einen unerwünschten Betrieb verursachen.

Dieses Gerät wurde getestet und hält die Grenzwerte für ein digitales Gerät der Klasse B gemäß Abschnitt 15 der FCC-Vorschriften ein. Diese Grenzwerte wurden festgelegt, um einen umfassenden Schutz vor schädlichen Interferenzen in Wohngebieten zu gewährleisten. Dieses Gerät strahlt Energie in Form von Radiofrequenzen ab, welche bei unsachgemäßer Nutzung Störungen an der Radiokommunikation verursachen kann. Es besteht jedoch keine Garantie dahingehend, dass in einem bestimmten Wohnbereich keine Störungen auftreten. Sollte dieses Gerät Störungen beim Radio- oder Fernsehempfang verursachen, wird Sie durch das Ein-/Ausstellen des Geräts testen können, wird dem Benutzer empfohlen, die Störung durch eine oder mehrere der folgenden Maßnahmen zu beheben:

- Empfangsantenne neu ausrichten oder versetzen
- Abstand zwischen Gerät und Empfänger vergrößern
- Gerät an eine andere Steckdose bzw. einen anderen Stromkreis anschließen als den Empfänger.

- Faire preuve de discernement lors de l'utilisation de ce produit ; ne l'utilisez jamais sous l'emprise d'alcool ou de drogues, ou en cas d'extrême fatigue.

