

Smart Socket
User Manual

Technological Specifications :

Rated Current: 10A(Max)
Rated Voltage: AC100V~240V(50-60Hz)
Rated Power: 2200W
USB Output: 5V/1A
Wireless Standard: IEEE802.11b/g/n
Working frequency: 2.412~2.462MHz
Safety: WEP/WPA-PSK/WPA2-PSK
Encryption: WEP/AES/TKIP
Static power loss: <0.3W
Working Temp: -20° C~75° C
Humidity: 10%-80%
Dimensions: 73x69x36.5MM
Gift box size : 96x93x78MM
Unit package: Gift Box
Unit weight: 100g
Accessories: User Manual Warranty Card

Smart socket introduction

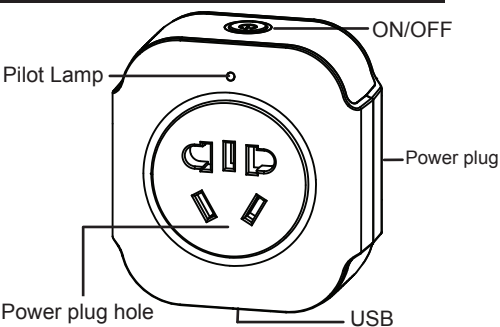

Function introduction :

- 1、 Remote control 2、 Timing switch function
3、 USB 4、 ON/OFF
5、 Universal Sckolet

Download APP

- 1、 Scan below Qrcode or scan Qrcode
onthebox name: e-welink
IOS system please download from APP
store name: e-welink



Android



IOS

- 2、 Open APP and login. Firstly should registered
account(android system the same as IOS system),
after registered successful then log in app. (Please
choose your country area code then enter the phone
number (ex: China +86) when you registered.)

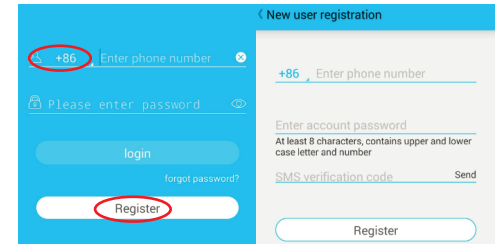

- 3、 Please make sure your home network is working
phone and wifi connect success.----If network is not
working or you phone cannot connect with wifi, you
will not connect success with wifi socket

- 4、 When the green light flash slowly ----long press
the on/off button 5seconds----the green light flash
quickly (90seconds) , now socket is connecting
the network.
5、 Login in App search add device.

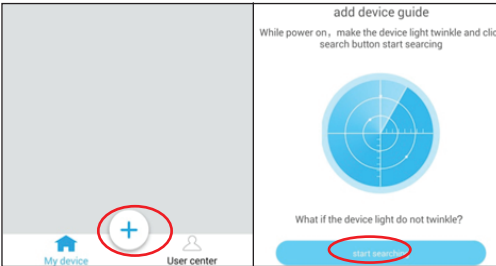

- 6、 If search the socket success go to next step input
the wifi account and passwords (please remember
the passwords) check (P1)

IOS APP have some differences

- 1、 Login in APP and click“+”Search add the
device

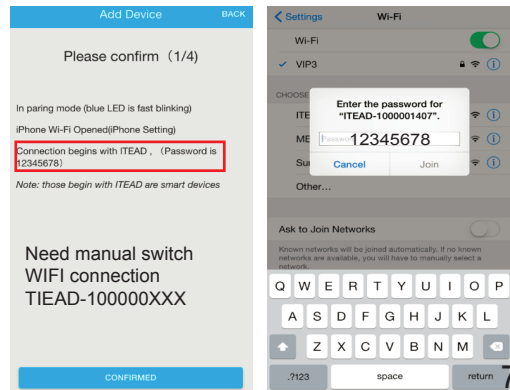

- 2、 Long press the socket on/off 5 seconds, when
Green Pilot light is continous brightnes,choose the wifi
name ITEAD(ex:ITEAD-1000xxx), Password is
12345678, connect success, pleas click confirmed. Go
to next step.

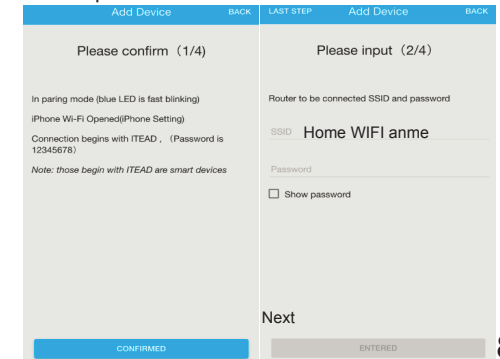

- 3、 Now please back choose your home wifi and
input the password connect success .
4、 Now if the socket green light brightness ,socket
is connect success.
5、 Change the device name ,click complete pairing.

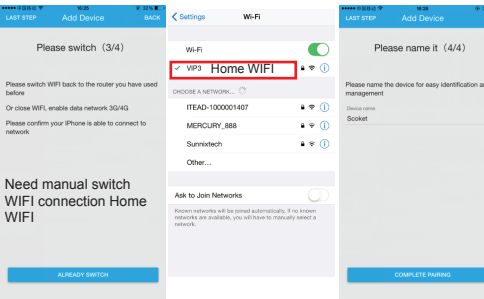

IOS system operation interface

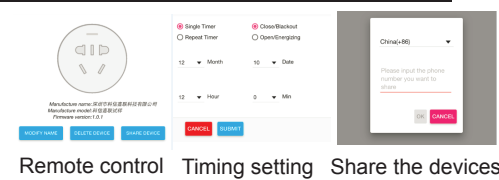

Remote control Timing setting Share the devices

Android system operation interface

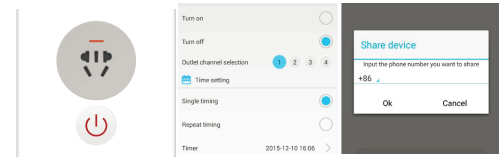

Remote control Timing setting Share the devices

Pilot lamp status

- 1、 Red Pilot light is continous brightness :
socket is connect normally
2、 Green Pilot light is continous brightness :
socket closed
3、 Green pilot light flash quickly :
socket is connecting the network.
4、 Green pilot light flash slowly :
connection failure or network is cut off



- 7: Connect success with socket----Rename the socket
(P2)the name use alphanumeric is better,do not use
special symbols.

- 8: If the socket offline,please make sure if the wifi
account and passwords are correct and search add
device when the green light flash quickly (90 seconds)
,If make sure 2 step all no problem still offline,please
after 2 mins search add device again.

FCC Statement

This equipment has been tested and found to comply with the limits for a Class B digital device, pursuant to Part 15 of the FCC Rules. These limits are designed to provide reasonable protection against harmful interference in a residential installation. This equipment generates uses and can radiate radio frequency energy and, if not installed and used in accordance with the instructions, may cause harmful interference to radio communications. However, there is no guarantee that interference will not occur in a particular installation. If this equipment does cause harmful interference to radio or television reception, which can be determined by turning the equipment off and on, the user is encouraged to try to correct the interference by one or more of the following measures:

- Reorient or relocate the receiving antenna.
- Increase the separation between the equipment and receiver.
- Connect the equipment into an outlet on a circuit different from that to which the receiver is connected.
- Consult the dealer or an experienced radio/TV technician for help.

This device complies with part 15 of the FCC Rules. Operation is subject to the following two conditions: (1) This device may not cause harmful interference, and (2) this device must accept any interference received, including interference that may cause undesired operation.

Changes or modifications not expressly approved by the party responsible for compliance could void the user's authority to operate the equipment.

This equipment should be installed and operated with minimum distance 20cm between the radiator & your body.