

SOAIY®

Bluetooth Hands-free Car Kit

S-61



Quick Start Guide

CONTENTS

WELCOME	2
S-61 OVERVIEW	3
POSITIONING	4
CHARGING	5
GETTING STARTED	6
HOW TO USE YOUR S-61	8
OTHER FUNCTIONS	11
TECHNICAL SPECIFICATIONS	12
FAQ & HOW TO TAKE CARE OF YOUR S-61	13
LIMITED WARRANTY	14

WELCOME

Dear customers

Thank you for purchasing SOAIY Bluetooth Handsfree Car Kit S-61. We hope you enjoy it ! To ensure correct operation, please read this quick start guide carefully before operation.

Package Contents



S-61



Quick Start Guide

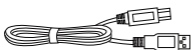

USB cable



Car Charger



Metal Clip

SOAIY S-61 OVERVIEW

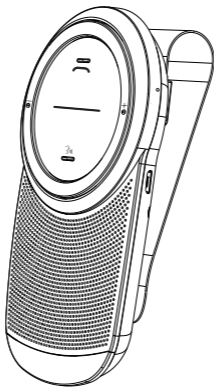

WHAT YOUR SOAIY S-61 CAN DO

- Answer, end, decline incoming calls.
- Deliver great sound and noise cancellation with the HD voice microphone.
- Last number redial.
- Connect with two mobile phones simultaneously.
- Voice notification for incoming call number.
- Voice commands to allow easy call interaction while driving (Say "YES" to answer or say "NO" to decline an incoming call).
- Voice guidance for pairing instructions and connection status.
- Play music and GPS via your connected mobile device.
- Power ON / OFF automatically.
- Activate Siri on iPhone or Android phone commands. (Phone dependent)

POSITIONING YOUR S-61

Insert the metal clip into the back groove of your S-61.

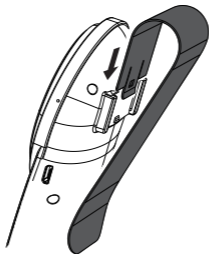

Clip the S-61 to the sun visor in your vehicle.

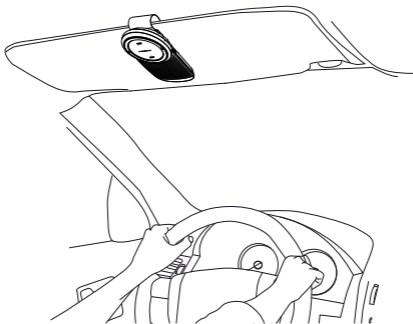

CHARGING YOUR S-61

IN-CAR CHARGING

Connect your S-61 with the USB cable to the Car Charger before plugging the Charger into the car lighter socket equipped in your vehicle

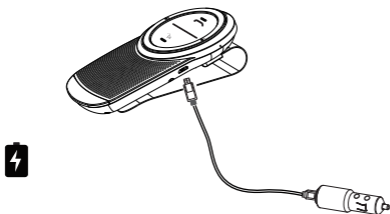

PC CHARGING

Connect your S-61 with the USB cable to any powered USB slot on your PC.

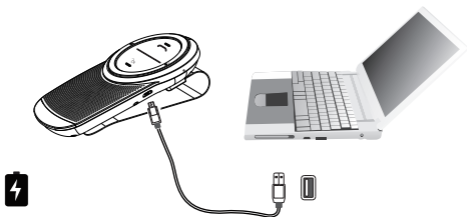

GETTING STARTED

TURNING ON YOUR S-61

Slide the **ON/OFF** button to turn the S-61 on or off.

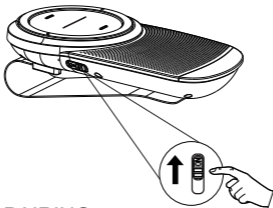

FIRST TIME PAIRING

The first time the S-61 is turned on, voice guidance will guide you through pairing with your mobile phone.

1. Turn on the S-61.

2. The answer key flashes red and blue alternatively, you will then hear a voice prompt "Power on, Pairing". Bluetooth will need to be activated on your mobile phone. If asked for a passkey or PIN during pairing, please enter 0000.

NOTE: After the S-61 and a mobile phone have been paired, they will automatically connect whenever the S-61 is switched on and the mobile phone has Bluetooth activated within range.

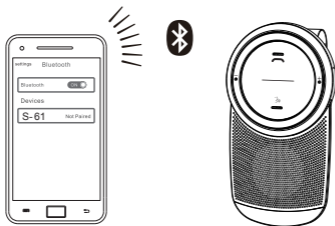

PAIRING WITH ANOTHER MOBILE PHONE

1. Turn on your S-61.

2. Long press the **Volume +** and **Volume -** button simultaneously for 2.5 seconds to disconnect the Bluetooth link with the first mobile phone and waiting for pairing the second Bluetooth enabled mobile phone.

3. Activate Bluetooth on the second mobile phone and select S-61. If asked for a passkey or PIN during pairing, please enter 0000.

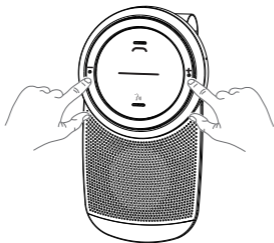



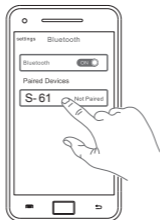

4. Select the S-61 from the list of My Devices or Paired Devices on the first mobile to connect the S-61 again.

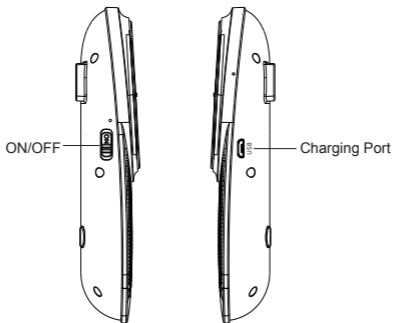
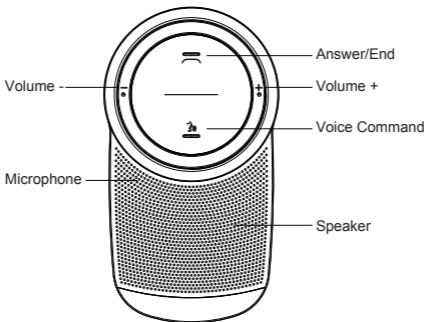

HOW TO USE YOUR S-61 WITH YOUR MOBILE PHONE



HOW TO USE YOUR S-61

	Make call	Start a call with your mobile phone. The call will automatically transfer to the S-61.
	Answer call	Press the Answer/End button or say "YES"
	End call	Press the Answer/End button
	Decline call	Press the Answer/End button for 2.5 seconds or say "NO"
	Activate the voice commands on phone	Press the Voice Command button (Phone dependent)
	Redial last number	Double-press the Answer/End button
	Speaker volume up/down	Long press the Volume + or Volume - button
	Disconnect Bluetooth	Press the Volume + and Volume - button simultaneously for 2.5 seconds
	Empty the paired list of the S-61	Press the Volume + and Volume - button simultaneously for 5 seconds

ANSWERING/ENDING A CALL

1. When there is an incoming call, the S-61 will alert you by reading out loud the incoming phone numbers. You can say either " Yes " to answer the incoming call or say "NO" to decline it after you hear the incoming phone numbers.
2. When there is an incoming call, short press the **Answer/End** button to answer the call, long press to decline, short press again to end the call.
3. When putting through, long press the **Volume +** or **Volume -** button, there will be a tone alert for reaching the max volume or min volume.

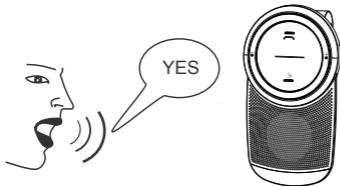

POWER OFF AUTOMATICALLY

In pairing state, if there is no mobile phone connected in 180 seconds, the device will turn off automatically (soft off) and make alert tone, the switch is in the ON position at this moment. In addition, if the Bluetooth connection of the device disabled and do not connect again in 180 seconds, the S-61 will power off automatically.

POWER ON FROM STANDBY MODE

In the standby model (soft off), if you want to restart the device, you just need to shake anything nearby (like closing the car door) that can awake the S-61 back to active mode.

PLAY MUSIC OR GPS

You can play music or hear GPS through the S-61 Music or GPS played on your connected mobile phone will automatically transfer to the S-61.

OTHER FUNCTIONS

VOICE GUIDANCE

Voice guidance guides you through using the S-61.

What you hear	What it means
"Power on, Pairing"	The S-61 is powered on and in pairing mode. Follow the instructions to pair your mobile phone with the S-61
"Connected"	S-61 is connected to a phone/ device
"Disconnected"	A connected phone/ device is turned off, out of range, or has Bluetooth disabled while in range
"Last number redial"	Redial the last number
"Low battery"	The S-61 battery level is low, please charge your unit in time
"Power off"	The system of S-61 is powered off

MOBILE PHONE VOICE COMMANDS (E.G. SIRI)

To activate your mobile phone's voice commands (e.g. Siri), press the **Voice Command** button on the S-61. For a full list of voice commands refer to your mobile phone's user manual. (Phone dependent)

LOW BATTERY ALERT

The red indicator flashes quickly for three time every 3 seconds.

CHARGING INDICATOR

When charging, the red indicator glows solidly, and will be turned off after fully charged. It takes around 3 hours to get fully charged.

EMPTY THE BLUETOOTH PAIRED LIST

Long press the **Volume +** and **Volume -** button simultaneously for 5 seconds can empty the paired list of the S-61.

TECHNICAL SPECIFICATIONS

Dimensions	W72xD26xH130mm
Weight	120g including the metal clip
Microphone	HD Omni-directional microphone
Speaker	3W
Frequency response	150Hz~18KHz
Impedance	4Ω
SNR	≥70dB
Bluetooth version	4.1
Operating range	10m
Paired devices	Up to 8 paired devices. Two active Devices connected simultaneously
Battery	Internal rechargeable 1000mAh Li-ion battery
Talk time	Up to 18 hours
Standby time	Up to 1200 hours
Charging time	3 hours
CLA power adapter	DC 12V input, 5V 500mAh output
Charging plug dimensions	Micro-USB
Operating temperature	Charging 0° C to 40° C (32° F to 104° F) Discharging -10° C to 60° C (14° F to 140° F)
Pairing passkey or PIN	0000

FAQ

Q I hear crackling noises

A Bluetooth is a radio technology that is sensitive to objects between the S-61 and the connected device. Ensure the S-61 and the connected device are within 33 feet (10 meters) of each other, with no major objects in the way (walls, etc.).

Q I cannot hear anything

A - Increase the speaker volume.
- Ensure the S-61 is paired to a device that is playing.
- Make sure your phone is connected to the S-61.

Q I am having pairing problems

A You may have deleted the S-61 pairing connection in your mobile phone. Follow the pairing instructions.

Q Will the S-61 work with other Bluetooth equipment?

A The S-61 is designed to work with Bluetooth mobile phones. It can also support other Bluetooth devices that are compliant with Bluetooth version 2.1 or higher and support a headset, hands-free and/or advance audio distribution profile.

Q I cannot activate the phone commands by pressing the Voice Command button?

A This feature requires your mobile phone to support voice commands. Refer to your mobile phone user manual for more details.

Q I cannot connect the bluetooth successfully

A Long press the **Volume +** and **Volume -** button simultaneously for 5 seconds to empty the paired list of the S-61. Forget the S-61 from the paired devices list of your mobile phone and try again.

HOW TO CARE FOR YOUR S-61.

Always store the S-61 with the power off and safely protected.

- If do not use the S-61 for long time, please charge at least once within one month, in order to prevent the lithium battery from getting damaged because of excessive consumption.
- Avoid storage at extreme temperatures (above 45°C/113°F or below -10°C/14°F). This can shorten battery life and may affect operation. High temperatures may also degrade performance.
- Do not expose the S-61 to rain or other liquids.

LIMITED WARRANTY

Soaiy One Year Manufacturer Warranty

This limited warranty starts on the date of your purchase and lasts for one year (the "Warranty Period"). The Warranty Period is not extended if we repair or replace the product. We may change the availability of this limited warranty at our discretion, but any changes will not be retroactive.

This limited warranty covers defects in materials and workmanship of the Soaiy product (the "product") for the Warranty Period as defined below. Soaiy does not warrant, and is not responsible for any product or device made by anyone other Soaiy.

More information can be found at : <http://www.soaiyaudio.com>

SOAIY®

FCC NOTE

This device complies with part 15 of the FCC Rules. Operation is subject to the condition that this device does not cause harmful interference (1) this device may not cause harmful interference, and (2) this device must accept any interference received, including interference that may cause undesired operation.

Changes or modifications not expressly approved by the party responsible for compliance

could void the user's authority to operate the equipment.

NOTE: This equipment has been tested and found to comply with the limits for a Class B digital device, pursuant to Part 15 of the FCC Rules. These limits are designed to provide reasonable protection against harmful interference in a residential installation. This equipment generates, uses and can radiate radio frequency energy and, if not installed and used in accordance with the instructions, may cause harmful interference to radio communications. However, there is no guarantee that interference will not occur in a particular installation.

If this equipment does cause harmful interference to radio or television reception, which can be determined by turning the equipment off and on, the user is encouraged to try to correct the interference by one or more of the following measures:

- Reorient or relocate the receiving antenna.
- Increase the separation between the equipment and receiver.
- Connect the equipment into an outlet on a circuit different from that to which the receiver is connected.
- Consult the dealer or an experienced radio/TV technician for help.

The device has been evaluated to meet general RF exposure requirement. The device can be used in portable exposure condition without restriction.

Visit our web site at www.soaiyaudio.com

MADE IN CHINA
FCC ID: 2AECY-S-61

