

Bluetooth FM transmitter quick start guide

Please read this guide to make the best use of this bluetooth FM transmitter

Specifications:

Bluetooth specification: V4.0

Bluetooth profiles: HSP, HFP A2DP and AVRCP

FM frequency range: 88.1~107.9MHz

Bluetooth Operating distance: 30 feet

FM Operating distance: 15 feet

USB1 output: 5V/2.4A(MAX)

USB2 output:5V/1A

Product Diagram:

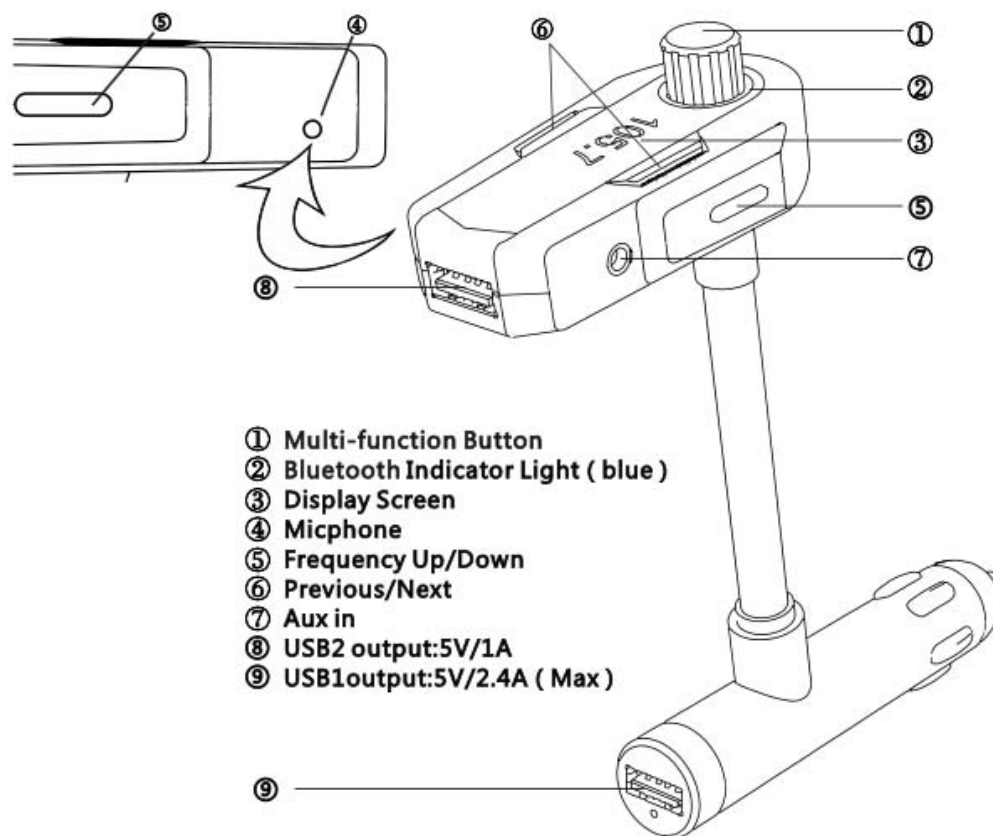

Power on/off the FM transmitter:

Power on: Plug the transmitter into the car cigarette socket.

Power off: Press the multifunction button for about 2 seconds until the blue indicator light goes off.

Instruction:

1. Plug the transmitter into the car cigarette socket, the product will power on and the indicator flashes means it's ready to pair.
2. Turn on the Bluetooth function of your phone.
3. Search for the Bluetooth devices and select "BT FM".
4. If pairing is successful, the blue indicator light will be always on.
5. Tune the car FM radio frequency to an unused FM station.
6. Tune the FM transmitter into the same frequency with the car FM radio.
7. Now you can enjoy your music through the car stereo.

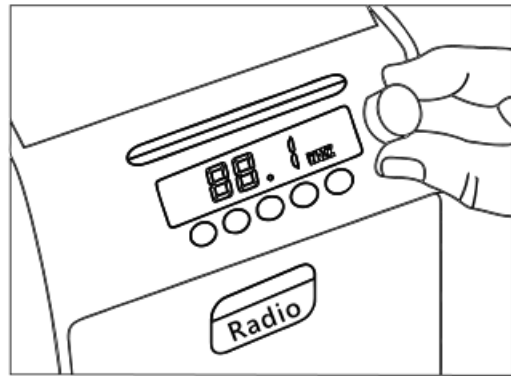
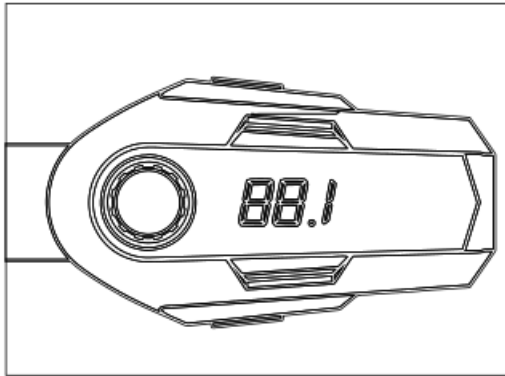

Remark:

1. It will connect to the pre-set phone automatically when turns on. (Turn on the Bluetooth of your cell phone first, and then turn on the product.)
2. For the best audio quality, please turn the volume of the cell phone and FM transmitter into the max level.
3. If the noisy is too loud, please try other FM frequency.

Answering a call:

For iPhone users:

Selection 1. Press the Multi-function button.

Selection 2. Press the "Answer" button of your iPhone and check your iPhone call menu. Look for the audio source and select the transmitter " FM25 ".

For Android User (such as Samsung, HTC, Sony etc.):

Selection 1. Press the Multi-function button.

Selection 2. Press the "Answer" button of your phone.

Ending a call:

1. Press the Multi-function button.

Rejecting a call:

1. Double press the Multi-function button.

Playing music:

1. Play/Pause: Short press the Multi-function button.
2. Next Song: Short press the button "Next ".

3. Previous Song: Short press the button “Previous ”.

Volume Control:

1. Volume down---turn the knob(multi-function) to the left,
2. Volume up—turn the knob(multi-function)to the right.

FCC Statement

This equipment has been tested and found to comply with the limits for a Class B digital device, pursuant to part 15 of the FCC rules. These limits are designed to provide reasonable protection against harmful interference in a residential installation. This equipment generates, uses and can radiate radio frequency energy and, if not installed and used in accordance with the instructions, may cause harmful interference to radio communications. However, there is no guarantee that interference will not occur in a particular installation. If this equipment does cause harmful interference to radio or television reception, which can be determined by turning the equipment off and on, the user is encouraged to try to correct the interference by one or more of the following measures:

- Reorient or relocate the receiving antenna.
- Increase the separation between the equipment and receiver.
- Connect the equipment into an outlet on a circuit different from that to which the receiver is connected.
- Consult the dealer or an experienced radio/TV technician for help.

To assure continued compliance, any changes or modifications not expressly approved by the party.

Responsible for compliance could void the user’s authority to operate this equipment. (Example- use only shielded interface cables when connecting to computer or peripheral devices).

This equipment complies with Part 15 of the FCC Rules. Operation is subject to the following two conditions:

- (1) This device may not cause harmful interference, and
- (2) This device must accept any interference received, including interference that may cause undesired operation.

RF warning statement:

The device has been evaluated to meet general RF exposure requirement. The device can be used in portable exposure condition without restriction.