

Rhein Tech Laboratories, Inc.  
360 Herndon Parkway  
Suite 1400  
Herndon, VA 20170  
<http://www.rheintech.com>

Client: STI  
Model: 34072  
Standards: FCC 15.231/IC RSS-210  
ID's: TXL34072/6335A-34072  
Report #: 2012204

**Appendix J:     Manual**

Please refer to the following page.



**Safety Technology International, Inc.**  
2306 Airport Road • Waterford, Michigan 48327-1209  
Phone: 248-673-9898 • Fax: 248-673-1246  
Toll Free: 800-888-4784 • E-mail: info@sti-usa.com  
Web: www.sti-usa.com

**Safety Technology International (Europe) Ltd.**  
Unit 49G Pipers Road • Park Farm Industrial Estate • Redditch  
Worcestershire • B98 0HU • England • Tel: 44 (0) 1527 520 999  
Fax: 44 (0) 1527 501 999 • Freephone: 0800 085 1678 (UK only)  
E-mail: info@sti-europe.com • Web: www.sti-europe.com

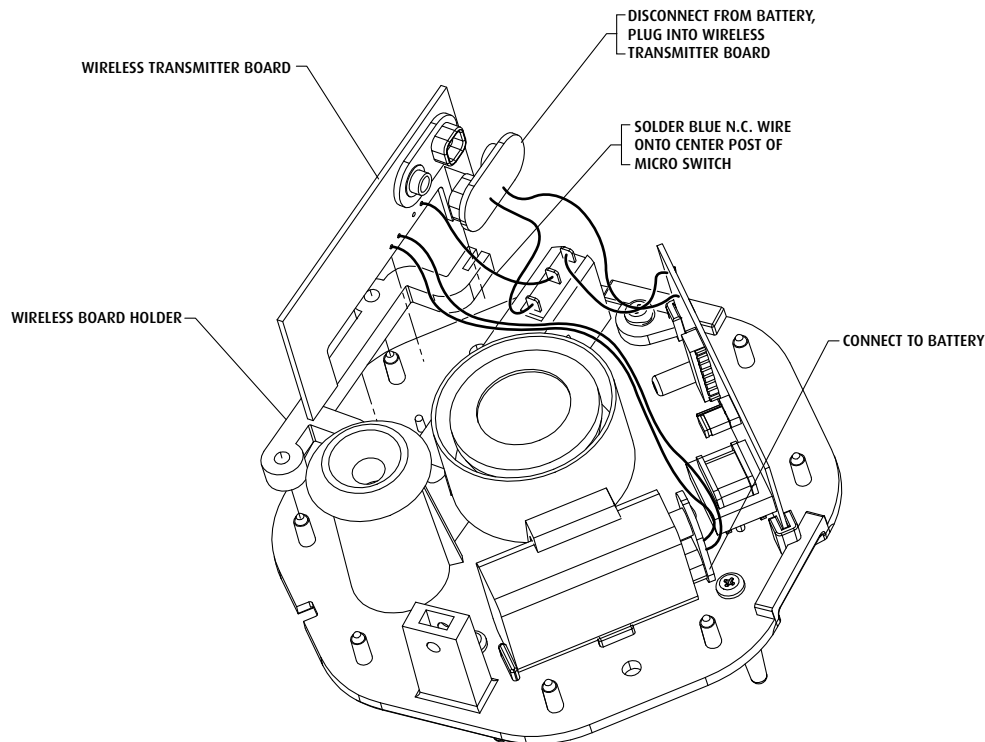

#### WIRELESS OPERATION:

The STI WIRELESS RETRO PCB will send a wireless signal to an STI 433MHz 4-Channel Receiver or 8-Channel Receiver. The STI WIRELESS RETRO PCB sends an alert signal when the "NC" device status changes to open. It sends a restore-to-normal signal when the switch is closed.

**NOTE:** To enroll the wireless device signal into the receiver, please see the receiver installation instructions.

#### IMPORTANT NOTICE:

Changes or modifications not expressly approved by the manufacturer could void the user's authority to operate this equipment.

This device complies with Part 15 of the FCC rules. Operation is subject to the following two conditions:

1. This device may not cause harmful interference.
2. This device must accept any interference that may be received, including interference that may cause undesired operation.

Le présent appareil est conforme aux CNR d'Industrie Canada applicables aux appareils radio exempts de licence. L'exploitation est autorisée aux deux conditions suivantes : (1) l'appareil ne doit pas produire de brouillage, et (2) l'utilisateur de l'appareil doit accepter tout brouillage radioélectrique subi, même si le brouillage est susceptible d'en compromettre le fonctionnement.

#### STANDARD STI-6200 INSTALLATION:

1. Insert wireless board holder onto pegs.
2. Insert wireless transmitter board with 9 Volt connector facing inward.
3. Solder blue NC wire onto center post of micro switch.
4. Disconnect 9 Volt battery, connect onto wireless transmitter board.
5. Connect 9 Volt connector wires coming off of transmitter board to 9 Volt battery.

### INSTALLATION OF STI-34072 STI Wireless Conversion Board for STI-6200 SERIES Extinguisher Stopper®

All specifications and information shown were current as of publication and are subject to change without notice.