

1.6 User Manual

(Cover)



Sagem BT H4



User Guide
Version 2.0
11-Nov-2006
Sagem Model Number: 189459673

[Inside Cover]

Sagem BT H4 Bluetooth Headset gives you more freedom on the move. Pair with compatible Bluetooth mobile phones and this headset makes it easier for you to carry on with your tasks whilst making a call.

Sagem BT H4 Bluetooth Headset is compliant with Bluetooth Version 1.2 Class 2 specifications, and is compatible with the latest mobile phones supporting Bluetooth Headset or Handsfree and Object Push Profiles.

(Page 0)

Contents

Title

Page

Sagem BT H4 Bluetooth Headset Overview	1
Getting Started	2
Charging Your Headset	3-4
Normal Charging Time	4
Talk and Standby Time	4
Battery Low Indication	4
Turning Your Headset On and Off	5
Pairing Your Headset	6-7
Using Your Sagem BT H4 Headset	8-10
Answering a Call	8
Ending a Call	8
Adjusting the Volume	8
Muting a Built-in Microphone	8
Dialing from Your Mobile Phone	9
Voice Dialing from Your Headset	9
Last Number Redialing from Your Headset	9
Rejecting a Call (Handsfree Profile ONLY)	10
Transferring a Call (Handsfree Profile ONLY)	10
Resetting or Removing Pairing	11
Care and Maintenance	12-13
Headset	12
Built-in Battery	13
Charger	13
Safety Information	14
Troubleshooting	15
Product Specifications	16

(Page 1)
Sagem BT H4 Bluetooth Headset Overview



Figure 1

- 1 Status Indicator (This small light will flash red, blue or purple dependant on pairing mode and operation) and Multi-function Button (MFB)
- 2 Earpiece
- 3 Volume Button (+/-)
- 4 Favourite key
- 5 Built-in Microphone
- 6 Built-in Rechargeable Battery
- 7 DC Jack

Getting Started (Page 2)

To use your Sagem BT H4 Bluetooth Headset (“the headset”), please follow the steps below:

1. Ensure your headset is fully charged
2. Pair your charged headset with a Bluetooth-enabled mobile phone

(Page 3)
Charging Your Headset



Sagem MyC / MyG and
Mini USB Charger

Sagem MyC / MyG and
Mini USB Charger
Adaptor

Sagem BT H4 Headset

Figure 3

The headset comes with a built-in rechargeable battery. Prior to using the headset for the first time, it is recommended to fully charge the battery first.

(Page 4)

Insert the Sagem charger plug into the charger adaptor and then Charger Adaptor plug into the Sagem BT H4 Headset for Charging. The light on the Sagem BT H4 Headset (status indicator) will stay red during charging.

IMPORTANT: Charging indication will be delayed for a few seconds if the headset has not been used for a long time or the battery is drained.

Normal Charging Time

It takes about three hours to fully charge the battery. When the battery is fully charged, the status indicator will turn blue and remain on. Unplug the mains charger from the AC wall outlet and the charger plug from the headset. Press and hold the MFB (refer to Figure 1) for two seconds to turn on the headset. Please refer to "Turning Your Headset On and Off" on the next page for further details.

Important: The headset will turn off and no operation while in charging mode. For details, please refer to "Charging your headset" section.

Talk and Standby Time

A fully charged battery can offer up to 12 hours of talk time and up to 180 hours of standby time. When there are no calls the headset should remain turned on in standby mode.

Battery Low Indication

When the battery has become low when the headset is on, the **status** indicator will flash red and the headset will emit a beep* every minute. Please follow the instructions described above to recharge the battery.

**If you are pairing your headset and your mobile phone in a noisy environment, we advise you to put on the earphone first so that the beep will be more audible.*

(Page 5)

Turning Your Headset On and Off

Turning On the Headset

Press and hold the **MFB** (see Figure 1) for two seconds until you hear a short beep. The status indicator will then flash blue.

IMPORTANT: Press the MFB again when you want to turn on the headset to re-activate pairing and ensure the connection between the headset and the mobile phone is resumed. For pairing, please refer to “Pairing Your Headset” on page 6 of this user guide.

Turning Off the Headset

Press and hold the **MFB** for two seconds until you hear a long beep. The **status** indicator will turn red and the headset will turn off.

IMPORTANT: To disconnect the Bluetooth connection, press the headset’s MFB firmly to turn it off. If you will not be using the headset for a while, we advise you turn off the Bluetooth function on your mobile phone as well.

(Page 6)

Pairing Your Headset

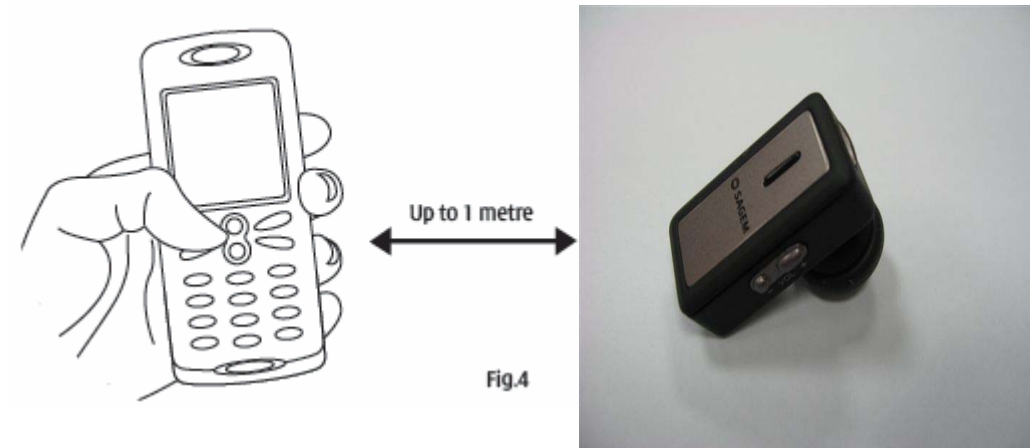

The headset works with Bluetooth-enabled mobile phones only. Prior to using and pairing your headset for the first time, please check if your mobile phone is Bluetooth-enabled. This information will normally feature on the packaging or user guide that is provided with your mobile phone.

The pairing instructions for a typical Bluetooth-enabled mobile phone are explained on the next page. The headset pairing procedure may vary depending on the model of your mobile phone. Please contact the manufacturer of your mobile phone or its agent for further information.

(Page 7)

Pairing Your Headset

1. Place the headset and the mobile phone where they are no more than one metre apart.
2. Ensure the headset is off. (The status indicator is unlit and does not flash.)
3. Press and hold the MFB until the headset's status indicator flashes blue and red alternately.
4. Activate your mobile phone's Bluetooth function. Please refer to your mobile phone user guide for details.
5. Set the mobile phone to search for Bluetooth devices within the one metre range, as instructed in the mobile phone user guide, and select "Sagem BTH4" from the list.
6. Enter the pre-programmed passkey "0000" and press "OK" to pair your headset and mobile phone. When the pairing is completed, the headset's status indicator will flash blue rapidly for five times followed by a long beep.
7. Go back to your mobile phone's main menu. For certain mobile phone models, once the headset is activated, a headset icon will be shown on the screen. You should now be able to make and receive calls using your headset.

IMPORTANT: If the pairing cannot be completed within two minutes after the pairing mode has been activated, the headset's status indicator will flash purple-red accompanied by three beeps and will then turn off automatically. Please repeat steps 2 to 7 above to pair the headset and the mobile phone again.

(Page 8)

Using Your Sagem BT H4 Headset

Answering a Call

When there is an incoming call, you will hear the ring through the earphone. Press the **MFB** **once** to accept the call or answer the call via your mobile phone in the normal way.

Ending a Call

Press the **MFB** once to end your call, or end the call via your mobile phone in the normal way.

Adjusting the Volume

Press the volume UP or DOWN key repeatedly until you reach the desired volume level. The volume may be affected by the volume setting of the caller's phone as well. Re-adjust the listening volume again when necessary.

(Page 9)
Using Your Headset

Call Muting During Conversation

During conversation, press and hold the Volume Key for 2 seconds to mute the built in microphone, when the mute function is activated, you will hear a short beep every 5 seconds accompanied by the headset's status indicator flashing every 5 seconds.

To cancel, press the Volume Key for 2 seconds to deactivate the muting function whilst in conversation.

Dialing from Your Mobile Phone

Simply make calls on your mobile phone in the normal way.

Voice Dialing from Your Headset

If your mobile phone is equipped with the voice dialing function, simply press the **MFB on your headset, and when you hear a beep say the voice tag.**

IMPORTANT: For voice dialing, you must record the voice tag (the person's name) into your mobile phone before using the voice dialing function on the Arrow Lite headset. Please refer to your mobile phone's user guide on how to record the voice tag.

(Page 10)

Using Your Headset

Last Number Redialing from Your Headset

Press the **MFB** on your headset twice.

IMPORTANT: The above functions are only applicable to mobile phones with Bluetooth Handsfree Profile. Functionality varies depending on the mobile phone model you have. Please refer to your mobile phone user guide for additional information.

Rejecting a Call (Handsfree Profile ONLY)

Press and hold the Volume Key then press the MFB key to reject the incoming call

Transferring a Call (Handsfree Profile ONLY)

Press and hold the Volume Key then press the MFB key to transfer the call from headset to your mobile handset.

Favourite key Function (Object Push & Handsfree Profile Only)

Send the phone number from the mobile phone to headset, then the headset will dial out this number.

(Page 11)

Resetting or Removing Pairing

You may reset the headset to its original settings anytime. To do this you also clear all current pairing settings.

1. Insert the charger plug into the headset's charging socket
2. Press and hold either of the volume keys for 20 seconds until the status indicator flashes purple rapidly.
3. Release the volume key.
4. Press and hold the volume key again until the status indicator is purple.
5. The headset is reset and will resume the charging mode.

Note: After resetting, all previous pairing settings are cleared.

(Page 12)

Care and Maintenance

Headset

- ✧ Turn off your headset before placing it in your pocket or bag. If the MFB is accidentally depressed, your mobile phone may place an unintended call.
- ✧ Do not expose the headset to liquid, moisture or humidity as it is not waterproof.
- ✧ Do not use abrasive cleaners to clean the headset.
- ✧ Do not expose the headset to extremely high or low temperatures.
- ✧ Do not leave your headset under the hot sun for a long time.
- ✧ Do not leave your headset near open flames such as cooking burners.
- ✧ Do not dispose of the headset in a fire as it will result in explosion.
- ✧ Do not bring your headset into contact with any sharp objects as this will cause scratches and damage.
- ✧ Do not stick anything inside the headset as this may damage internal components.
- ✧ Do not attempt to disassemble the headset as it does not contain serviceable components.
- ✧ Do not pull or drag the earphone-wire with force.
- ✧ If you will not use the headset for a long period, please store it in a dry place that is free from extreme temperatures and dust.

(Page 13)

Built-in Battery

- ✧ Do not attempt to replace the headset's battery as it is in-built and is not changeable.
- ✧ Charge the battery in accordance with the instructions supplied with this user guide.
- ✧ Use only the charger supplied by the headset's original manufacturer to charge the battery.
- ✧ Dispose of batteries according to local regulations. Do not dispose as household waste

Charger

- ✧ Use only the charger supplied by the headset's original manufacturer to charge the headset. Other chargers may look the same, but they could be dangerous.
- ✧ Do not attempt to disassemble the charger as it may expose you to dangerous voltages or other risks. Incorrect reassembly can cause electric shock when the headset is subsequently used.
- ✧ Do not use the charger outdoors or in damp areas.
- ✧ Only charge the headset's built-in battery in accordance with the instructions described in this user guide.
- ✧ Avoid charging the headset in extremely high or low temperatures.

(Page 14)

Safety Information

- ✧ Check and observe local laws regarding the use of a mobile phone and headset while driving. If you use the headset while driving, ensure your full attention and focus. It is your responsibility to drive safely. Consider to pull off the road before making or answering a call.
- ✧ Never leave your headset above any air bag deployment area inside your car as serious injury may result when an air bag deploys.
- ✧ Never allow children to play with the headset – small parts may be of choking hazard.
- ✧ Observe all signs and displays that require an electrical device or RF radio product to be switched off in designated areas. These could include hospitals, blasting areas, and potentially explosive atmospheres.
- ✧ Turn off your headset prior to boarding an aircraft. Do not use your headset inside an aircraft.
- ✧ To prevent damage to your hearing, please do not set the listening volume too high.
- ✧ Never use the headset while taking a bath.
- ✧ Do not use the headset in a sauna or steam room.
- ✧ Do not keep your headset near a wash basin or other wet places.
- ✧ Do not use the headset outdoors in the rain.
- ✧ Do not clean the headset while it is being charged. Always unplug the charger first before cleaning the headset.
- ✧ Do not attempt to modify the headset for other purpose.
- ✧ Do not attempt to force open or mutilate the built-in battery.
- ✧ Replace the earphone when it shows signs of breaking from the wire.
- ✧ Disposal of the packaging and the headset should be done in accordance with the local regulations.

(Page 15)

Troubleshooting

If you are unable to connect your headset and mobile phone, please try the following:

- ✧ Ensure your the battery is fully charged. Turn off your headset, and then turn it on again.
- ✧ Ensure the headset is paired with your mobile phone.
- ✧ Ensure your mobile phone's Bluetooth function is activated. (For some phone models, a headset icon will appear on the phone's screen.) Please refer to your mobile phone user guide for specific instructions.
- ✧ Ensure the headset is within 10 metres of your mobile phone and there are no obstructions, such as walls or other electronic devices, in between.

If the above suggestions do not solve your problem, please recharge the headset and remove your mobile phone battery for a while. Then start pairing again.

(Page 16)

Product Specifications

Bluetooth Specification:	Version 1.2 Class 2
Bluetooth Profile Supported:	Headset and Handsfree Profiles
Range of Frequency:	2.4GHz spectrum
Nominal Charging Time:	Within 2hours
Talk Time*:	Up to 5hours
Standby Time*:	Up to 120 hours
Dimensions:	35 mm (L) x 18mm (W) x 12mm (H)
Weight:	6.1 grams

*May vary due to the user's habit, different modes of operation, and mobile phone settings.

This device complies with Part 15 of the FCC Rules. Operation is subject to the following two conditions:

- (1) this device may not cause harmful interference, and
- (2) this device must accept any interference received, including interference that may cause undesired operation.

Cautions: Changes or modifications not expressly approved by the party responsible for compliance could void the user's authority to operate the equipment.

Dispose of the packaging and this product in accordance with the latest provisions.



Notes on Environmental Protection

After the implementation of the European Directive 2002/96/EU in the national legal system, the following applies: Electrical and electronic devices **must not** be disposed of with domestic waste. Consumers are obliged by law to return electrical and electronic devices at the end of their service lives to the public collection points that are set up for this purpose or designated points of sale. However, such details are defined by the national law of the respective country. This symbol on the product, the instruction manual or the **packaging** indicates that the product is subject to these regulations. By recycling, reusing the materials, or other forms of utilizing old devices, you are making an important contribution in protecting our environment.

Printed in China