

Installation guide AELEMENT ANSI Lock



SALTO
inspiredaccess

AE i 0 xxx... series
(NO electronic privacy)

- (Eng) Installation guide
- (E) Guía de instalación
- (F) Guide d'installation

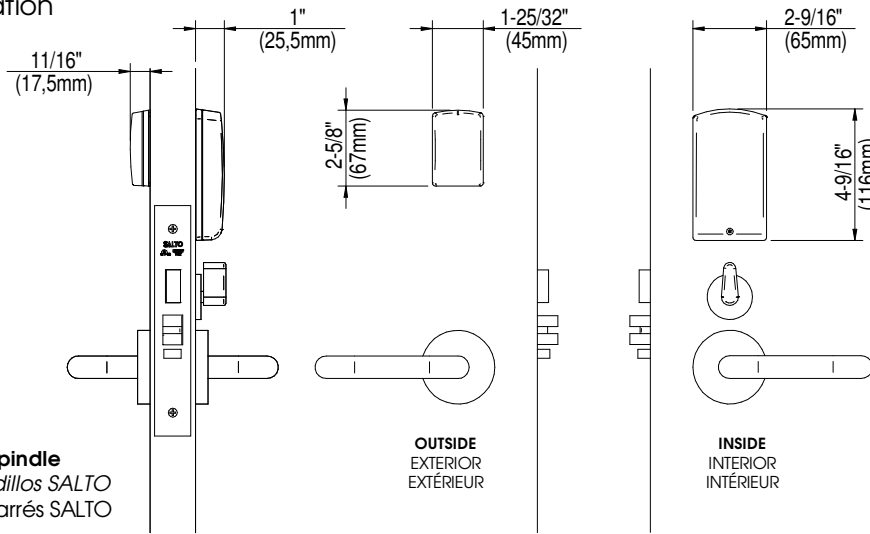

Only SALTO spindle
Solo cuadradillos SALTO
Seulement carrés SALTO

- * Only for door > 2-9/16" thickness.
- * Solo para puertas > 65mm de espesor.
- * Uniquement pour portes > 65mm d'épaisseur.

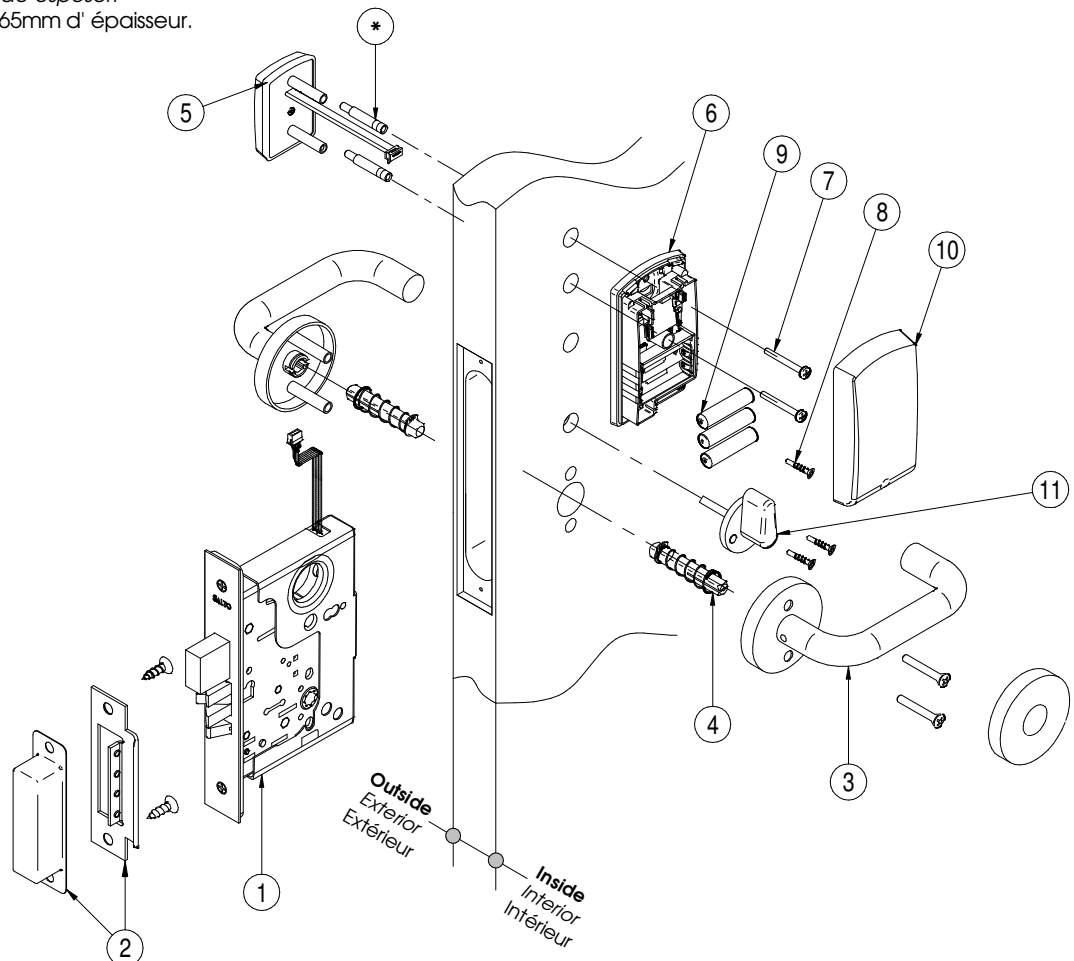

The mounting with other spindles voids the warranty.
El montaje de otros cuadradillos anula la garantía.
Le montage d'autres carrés annule la garantie.

NOTE: Screws and spindles are included in the box of the reader.
NOTA: Los tornillos y cuadradillos están incluidos en la caja del lector.
NOTE: Les vis et les carrés sont inclus dans la boîte du lecteur.

Recommendation for Customer's lever set installation on SALTO AElement.
See : 4MO01300

Recomendaciones para la instalación de manillas Cliente en SALTO AElement.
Ver: 4MO01300

Recommandation pour l'installation des béquilles client sur Salto AElement.
Voir: 4MO01300

Installation guide AELEMENT ANSI Lock



SALTO
inspiredaccess

1

2

3

Metal door
Puerta metálica
Porte métallique

Wood door
Puerta madera
Porte en bois

INSIDE
INTERIOR
INTÉRIEUR

* CUT
CORTE

! The groove must be on the same side than the grub screw.
La ranura en el lado del prisionero.
La rainure doit être du côté de la vis.

4

5

REMOVE
QUITAR
RETIRER

OUTSIDE
EXTERIOR
EXTÉRIEUR

INSIDE
INTERIOR
INTÉRIEUR

6

Screw driver
PZ2

6

Aligned
OUTSIDE & INSIDE
Alinear
EXTERIOR - INTERIOR
Aligner
EXTÉRIEUR - INTÉRIEUR

7

LR03

!

Fasten with screw to keep it aligned
Fijar tornillo para mantener el alineamiento
Fixant le vis pour maintenir l'alignement

8

READER CABLE
CABLE LECTOR

WIRELESS CABLE *
*Only available in AE9W model

LOCK CABLE
CABLE CERRADURA

9

(Eng) **AT THIS POINT DO NOT CLOSE THE DOOR. PROGRAM THE LOCK FIRST**

(E) **NO CIERRE LA PUERTA. PROGRAMAR ANTES LA CERRADURA**

(F) **NE PAS FERMEZ LA PORTE DE PROGRAMMER LA SERRURE**

! Follow user manual.

10

11

Screw driver
Torx T10 TAMPER

PRODUCTS DESCRIPTION

PRODUCT		TECHNOLOGY			SOFTWARE		
COMMERCIAL NAME	MODEL	RFID 13.56MHz Output max. power	BLUETOOTH SMART 2400–2483.5 MHz Output max. power	IEEE802.15.4 2400–2483.5 MHz Output max. power	CONTROL	BLUETOOTH MODULE(S)	RF2MODULE
AElement Fusion E1723	AF0B	+25 dBm	+8 dBm		0141	0136	
	AF0J	+25 dBm	+8 dBm		0145	0136	
	AF0D	+25 dBm	+8 dBm		0146	0136 / -	
AElement Original E1009	AEB	+25 dBm	+8 dBm		0135	0136	
	AEJ	+25 dBm	+8 dBm		0147	0136	
	AES	+25 dBm	+8 dBm		0139	-	
XS4 One E1722	E97	+25 dBm	+8 dBm		0128		
	EB7	+25 dBm	+8 dBm		0134	0136	
	EJ7	+25 dBm	+8 dBm		0150	0136	
XS4 mini ANSI E1722	CB2	+25 dBm	+8 dBm		0134	0136	
	CJ2	+25 dBm	+8 dBm		0150	0136	
SALTO Neo G1824	NOB	+25 dBm	+8 dBm		0158	0136	
	NOJ	+25 dBm	+8 dBm		0159	0136	

EU COMPLIANCE STATEMENT

- EN Hereby, SALTO Systems S.L. (Arkotz Kalea (Pol. Lanbarren), 9 – 20180 Oiartzun– Spain), declares that this access control equipment is in compliance with the essential requirements and other relevant provisions of Directive 2014/53/EU (RED) and 2011/65/EU (RoHS). You will be able to find a copy of the original declaration of conformity at the following Internet address: <http://www.saltosystems.com/certificate>
- ES Por medio de la presente SALTO Systems S.L. (Arkotz Kalea (Pol. Lanbarren), 9 – 20180 Oiartzun– Spain) declara que este equipo de control de accesos cumple con los requisitos esenciales y cualesquiera otras disposiciones aplicables o exigibles de la Directiva 2014/53/UE (RED) y 2011/65/UE (RoHS). Podrá encontrar una copia de la declaración de conformidad original en la siguiente dirección de internet: <http://www.saltosystems.com/certificate>
- FR Par la présente SALTO Systems S.L. (Arkotz Kalea (Pol. Lanbarren), 9 – 20180 Oiartzun– Spain) déclare que l'appareil équipement pour le contrôle d'accès est conforme aux exigences essentielles et aux autres dispositions pertinentes de la directive 2014/53/UE (RED) et 2011/65/UE (RoHS). Vous pouvez télécharger une copie de la déclaration de conformité originale à travers l'adresse suivante: <http://www.saltosystems.com/certificate>
- DE Hiermit erklärt SALTO Systems S.L. (Arkotz Kalea (Pol. Lanbarren), 9-20180 Oiartzun-Spain) dass sich das Gerät Zutrittskontrollgeräte im Übereinstimmung mit den grundlegenden Anforderungen und den übrigen einschlägigen Bestimmungen der Richtlinie 2014/53/EU (RED) befindet und 2011/65/EU (RoHS). Eine Kopie der originalen Konformitätserklärung finden Sie auf der folgenden Internetseite: <http://www.saltosystems.com/certificate>
- NL Hierbij verklaart SALTO Systems S.L. (Arkotz Kalea (Pol. Lanbarren), 9 – 20180 Oiartzun– Spain) dat het toestel toegangscontroleapparatuur in overeenstemming is met de essentiële eisen en de andere relevante bepalingen van richtlijn 2014/53/EU (RED) en 2011/65/EU (RoHS). U kunt een kopie van de originele verklaring van overeenstemming vinden op het volgende internetadres: <http://www.saltosystems.com/certificate>
- PT A SALTO Systems S.L. declara que este equipamento de controlo de accesos está conforme os requisitos essenciais e outras disposições da Diretiva 2014/53/UE (RED) e 2011/65/EU (RoHS). Poderá encontrar uma cópia da declaração de conformidade original na seguinte direção de internet: <http://www.saltosystems.com/certificate>

ELECTRICAL WARNINGS

Caution: Risk of explosion if battery is replaced by an incorrect type. Dispose of used batteries according to the instructions.

Recommended batteries:

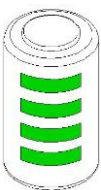

- Duracell Plus Power **AAA** (MN2400)
- Duracell Ultra Power **AAA** (MX2400)
- Varta Industrial **AAA** (04003)
- Varta High Energy **AAA** (04903)
- Varta Max Tech **AAA** (MN2400)
- Duracell Plus Power **AA** (MN1500)
- Duracell Ultra Power **AAA** (MX1500)
- Varta Industrial **AA** (04006)
- Varta High Energy **AA** (04906)
- Varta Max Tech **AA** (MN1500)
- Duracell Ultra **CR2** Lithium (DLCR2)
- Panasonic **CR2** Lithium
- Panasonic **CR2** Lithium Industrial
- GP Batteries **LR1** (910A)
- Varta **LR1** (V4001)

Distance between this device and human body must be higher than 20 cm.

MECHANICAL WARNINGS

In order to confirm the correct operation of this electronic device, SALTO recommends using it in combination with a lock destined for that use (door mass, frequency of use, fire door, etc) and that is in good operational conditions. The SALTO product should be treated with care during the installation process to avoid any aggressive contact that may damage the unit. It may be necessary to loosen the trims mounting during installation. Do not bring the device into contact with oil, paints or acids. Do not paint the door with the mortise lock or electronic device already mounted on the door. **CLEANING THE ELECTRONIC DEVICE:** a damp cloth with mild soapy water can be used. Never use abrasive soaps or sprays. For best performance, stainless steel should be cleaned regularly. Note that when the door is closed without the lock having been already programmed, the lock will automatically lock and can only be opened with a Portable Programming Device (PPD). If you have questions or doubts on this, please contact your authorized SALTO supplier.

LEGAL WARNINGS

The user shall be responsible for the correct use and maintenance of the access control equipment according to the instructions herein. SALTO shall not be responsible for any defect, malfunction, loss or damage, whether direct or indirect, caused by or arisen from any improper installation or utilization of the equipment or which contravenes, transgresses or infringes in any manner the abovementioned instructions.

SALTO's liability concerning the equipment is limited to the warranty provided. The warranty does not cover product failures due to repairs, modifications or product manipulations performed in the access control equipment or in the inner electromechanical structure by anyone other than authorized SALTO dealers or personnel.



FCC COMPLIANCE STATEMENT

This device complies with Part 15 of the FCC Rules. Operation is subject to the following two conditions: (1) this device may not cause harmful interference, and (2) this device must accept any interference received, including interference that may cause undesired operation. Changes or modifications not expressly approved by the party responsible for compliance could void the user's authority to operate the equipment.

Note: This equipment has been tested and found to comply with the limits for a Class B digital device, pursuant to part 15 of the FCC Rules. These limits are designed to provide reasonable protection against harmful interference in a residential installation. This equipment generates, uses, and can radiate radio frequency energy and, if not installed and used in accordance with the instructions may cause harmful interference to radio communications. However, there is no guarantee that interference will not occur in a particular installation. If this equipment does cause harmful interference to radio or television reception, which can be determined by turning the equipment off and on, the user is encouraged to try to correct the interference by one or more of the following measures:

- Reorient or relocate the receiving antenna.
- Increase the separation between the equipment and receiver.
- Connect the equipment into an outlet on a circuit different from that to which the receiver is connected.
- Consult the dealer or an experienced radio/TV technician for help.

This product is a radio transmitter and receiver to be used in **mobile** conditions.

Supplier's Declaration of Conformity

47 CFR § 2.1077 Compliance Information

We, SALTO Systems, S.L., hereby declare that the equipment bearing the model number specified above was tested conforming to the applicable FCC Rules.

Responsible Party – U.S. Contact Information

Salto Systems Inc. USA
1780 Corporate Drive, Suite 400
Norcross, GA
30093
l.saldana@saltosystems.com



CANADIAN COMPLIANCE STATEMENT

This device complies with Industry Canada license-exempt RSS standard(s). Operation is subject to the following two conditions: (1) this device may not cause harmful interference, and (2) this device must accept any interference received, including interference that may cause undesired operation. Changes or modifications not expressly approved by the party responsible for compliance could void the user's authority to operate the equipment.

Le présent appareil est conforme aux CNR d'Industrie Canada applicables aux appareils radio exempts de licence. L'exploitation est autorisée aux deux conditions suivantes: (1) l'appareil ne doit pas produire de brouillage, et (2) l'utilisateur de l'appareil doit accepter tout brouillage radioélectrique subi, même si le brouillage est susceptible d'en compromettre le fonctionnement.

This device has been tested and found to comply with the limits for a Class B digital device, pursuant to ICES-003.