

# SALUS<sup>®</sup>

CONTROLS PLC

## *iT500 Internet Thermostat*



USER MANUAL

## Product compliance & safety information

These instructions are applicable to the SALUS Controls model stated on the front cover of this manual only, and must not be used with any other make or model.

This accessory must be fitted by a competent person, and installation must comply with the guidance provided in the current IEE Wiring Regulations and current Building Regulations. Failure to comply with the requirements of these publications could lead to prosecution.



**Always isolate the AC Mains supply before installing or working on any components that require 230 VAC 50Hz supply.**

**When fitting batteries, do not mix old and new batteries together.  
Do not use rechargeable batteries.**

Please leave these instructions with the end user where they should be kept in a safe place for future reference.

## Contents of the box



iT500TR Thermostat



iT500RX Receiver



iTG500 Gateway



Optional Stand



ADSL Cable



iT500 Power adaptor



Fixing screws & plugs



Wall mount



Wall mount

iT500 User Manual 03

## Installation

Please refer to the installation guide.  
The installation guide also shows how to  
connect your iT500 thermostat to the internet.





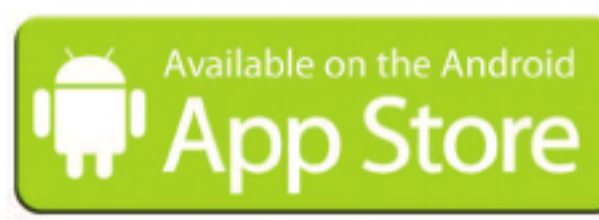





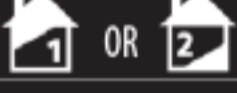

## Connection & Control



[www.salus-controls.com](http://www.salus-controls.com)

For details please refer to page 18 in the installation manual.

## LCD Overview

LCD ICONS	DESCRIPTION	FUNCTION
1 2 3 4 5 6 7	Day of the week	Displays the number of the day of the week. 1 being Monday
88.8	Temperature indicator	Displays set or measured temperature
88:88	Clock display	Displays time
1 2 3 4 5 6	Program number indicator	Displays the number of the active (selected) program
	Heat mode indicator	Indicates heating output is turned on*
	Heat zone indicator	Indicates heating zone*
	Hot water indicator	Indicates hot water control*
	Hot water mode indicator	Indicates hot water output is turned on*
	RF signal indicator	Indicates the unit is transmitting a wireless signal to the iT500RX or is receiving the signal from the iT300*
	Touch lock indicator	Indicates touch lock is activated
	Battery status	Indicates battery is low
	Holiday indicator	Indicates holiday operation mode is selected
	Internet indicator	Indicates connection to iTG500 and SALUS server
	Cooling indicator	Indicates cooling output is on*
ON	ON indicator	Hot water continuously on*
1	Once indicator	Hot water is on once*
AUTO	AUTO indicator	Automatic program mode
OFF	OFF indicator	Off mode
	Setting indicator	Manual override or settings mode

\* System configuration specific.

## Controls



## Identify your system type

The system type is unique to your system configuration.  
The system will be set by your installer and should only be changed by your installer.



**1** One central heating zone only.



iT500 Display

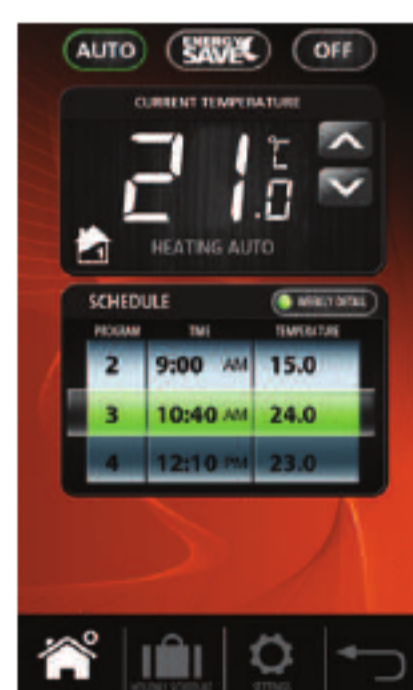

Smartphone Display



PC Display



**2** Two central heating zones.



iT500 Display

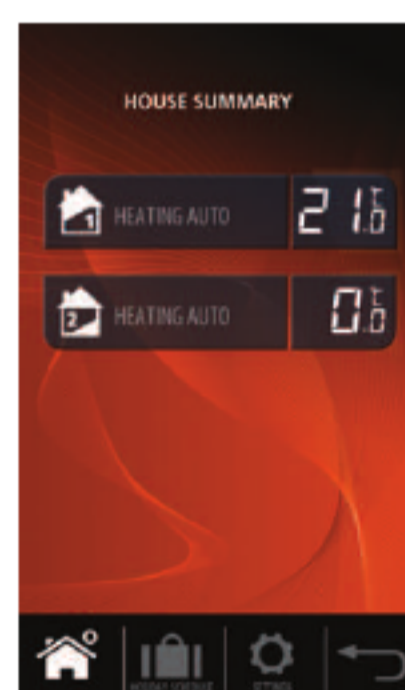

Smartphone Display



PC Display



**3** One central heating zone plus hot water.



iT500 Display

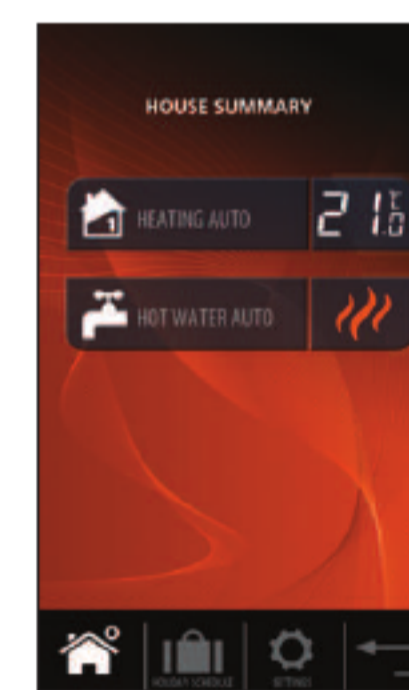

Smartphone Display



PC Display

## One Central Heating Zone System PC & Smartphone Control

Now that you have identified your system type, you can use your PC or smartphone to fully control your iT500.

**ENERGY SAVE** Energy save will use the lowest set temperature on your daily schedule.

 Will be displayed when the current program has been manually overridden

**AUTO** \*Press AUTO to cancel temporary override of program temperature.



**1** One central heating zone only.

Follows weekly schedule    Energy save mode    Heating continuously off





## One Central Heating Zone System Local Control

Control available on your Smartphone or PC is also available locally on the iT500.

### Temporary override of your temperature

Press the power button to start and use the buttons indicated to change the SET temperature. Then press the tick to accept.

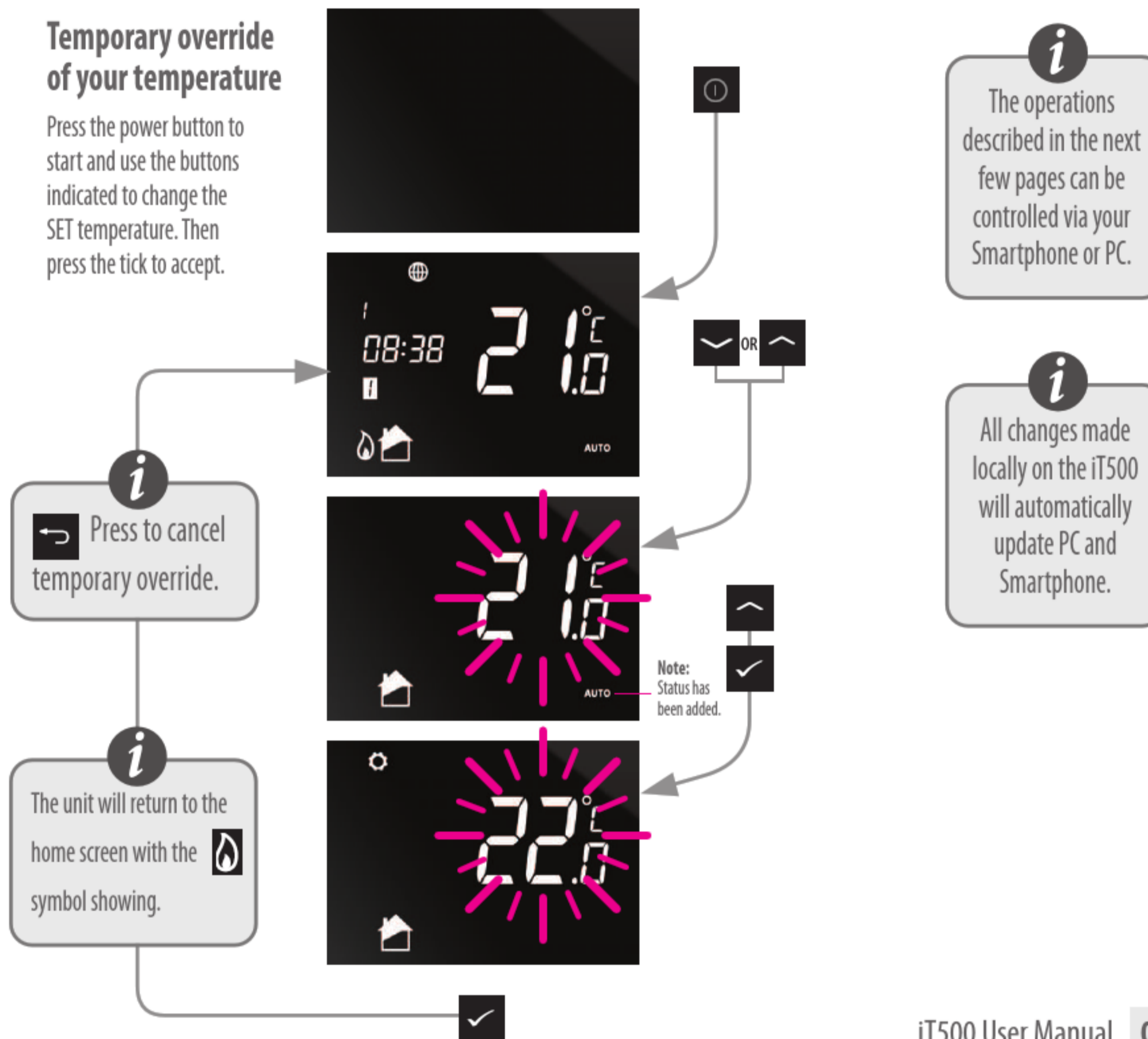

## One Central Heating Zone System Local Control

### Switching your heating from AUTO to OFF.

Press the power button to start and use the buttons indicated to switch from AUTO to OFF.

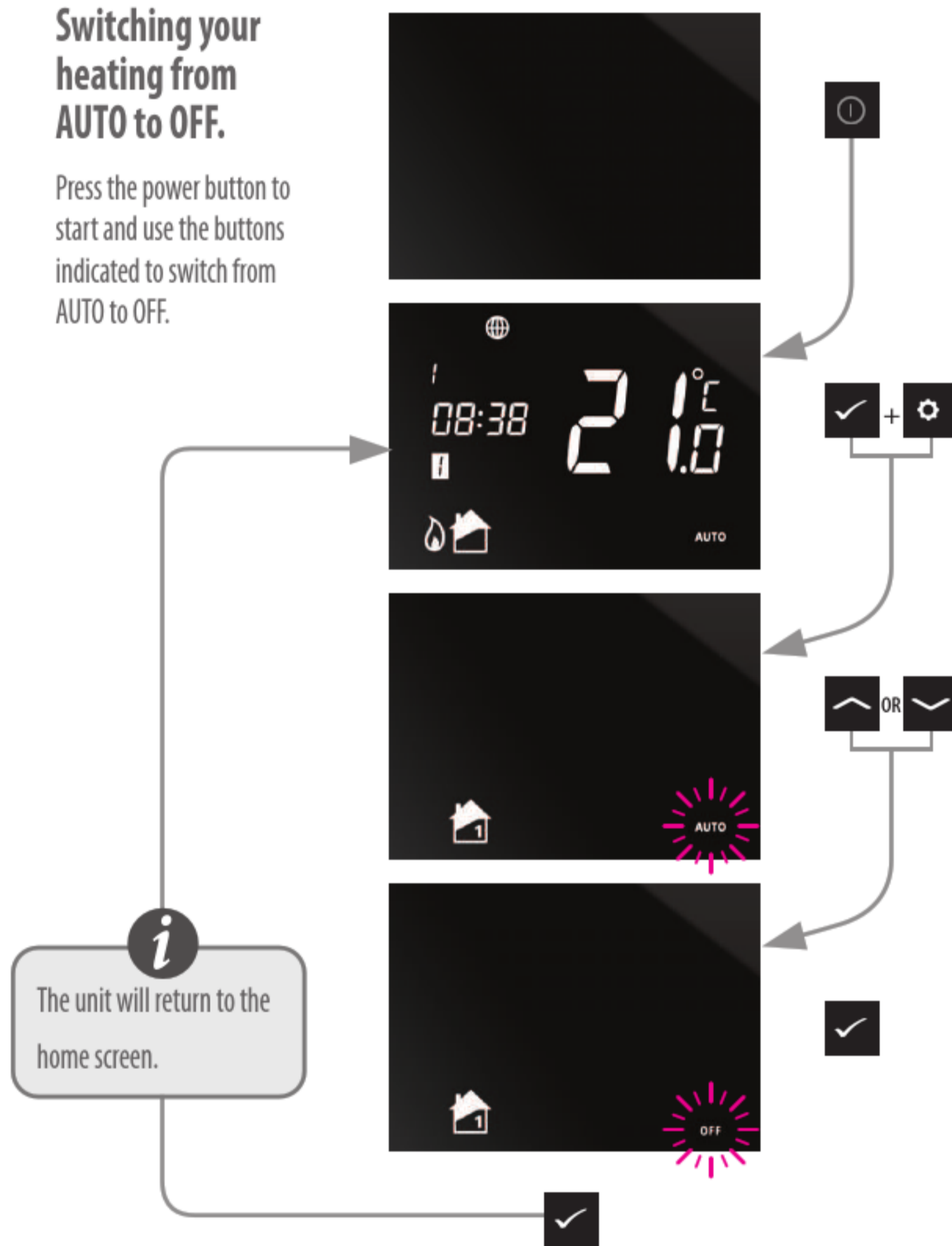

**i**  
The unit will return to the home screen.

## Two Central Heating Zones System PC & Smartphone Control



**2** Two central heating zones.

Now that you have identified your system type, you can use your PC or smartphone to fully control your iT500.



For information regarding the control of an individual zone via Smartphone or PC, please refer to page 8.



## Two Central Heating Zones System Local Control

### Temporary override of your temperature Zones 1 & 2.

Press the power button to start and use the buttons indicated to change the SET temperature. Then press the tick to accept.

 Press to cancel temporary override.

**Note:** Gear wheel is now illuminated indicating manual override of set temperature.

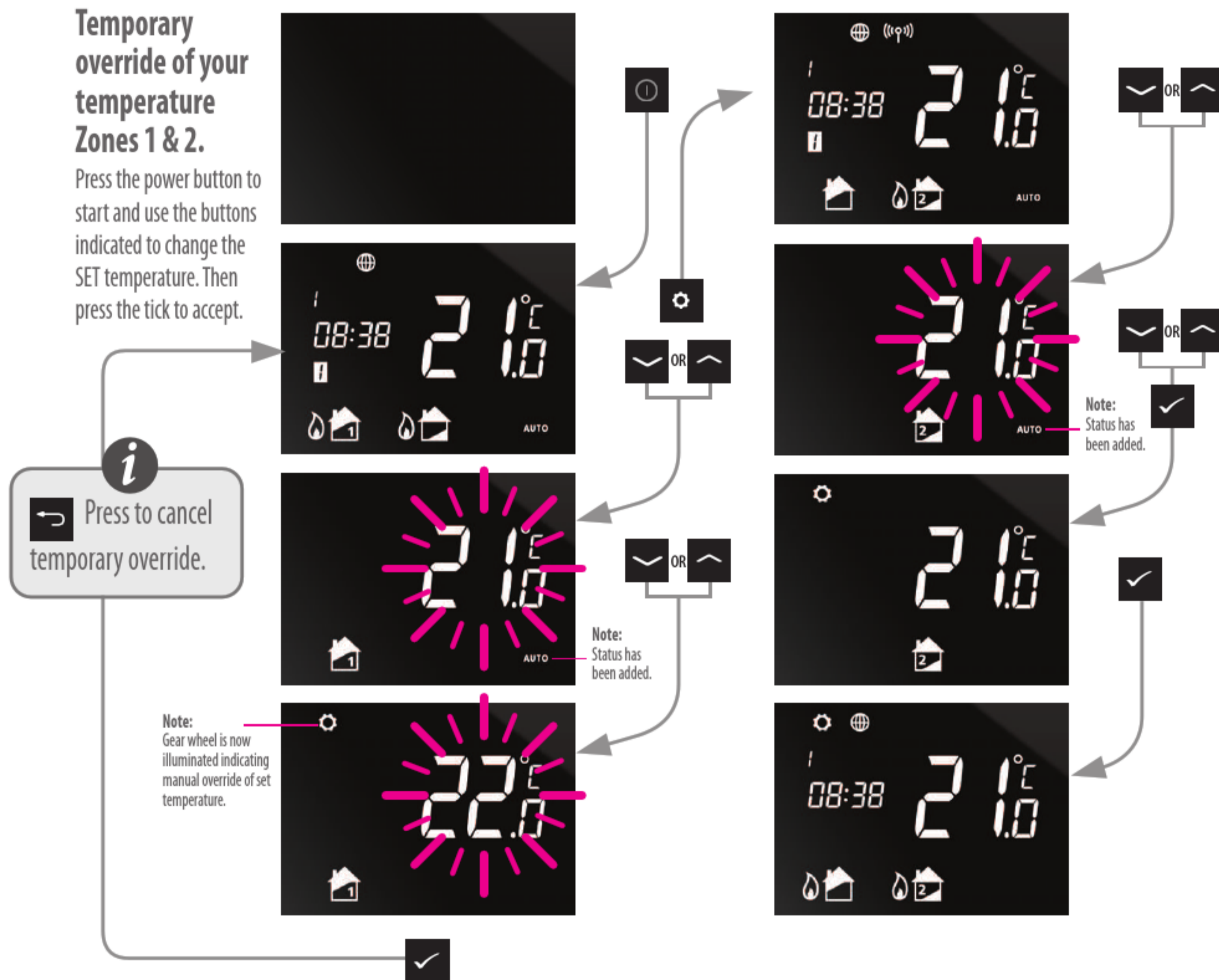

## Two Central Heating Zones System Local Control

### Switching your heating from AUTO to OFF. Zones 1 and 2.

Press the power button to start and use the buttons indicated to switch from AUTO to OFF.

**i** To go straight to zone two, short press 



## One Central Heating Zone + Hot Water System PC & Smartphone Control

Now that you have identified your system type, you can use your PC or smartphone to fully control your iT500.

**ENERGY SAVE** Energy save will use the lowest set temperature on your daily schedule.

 Will be displayed when the current program has been manually overridden

**AUTO** \*Press AUTO to cancel temporary override of program temperature.



**3** One central heating zone plus hot water.

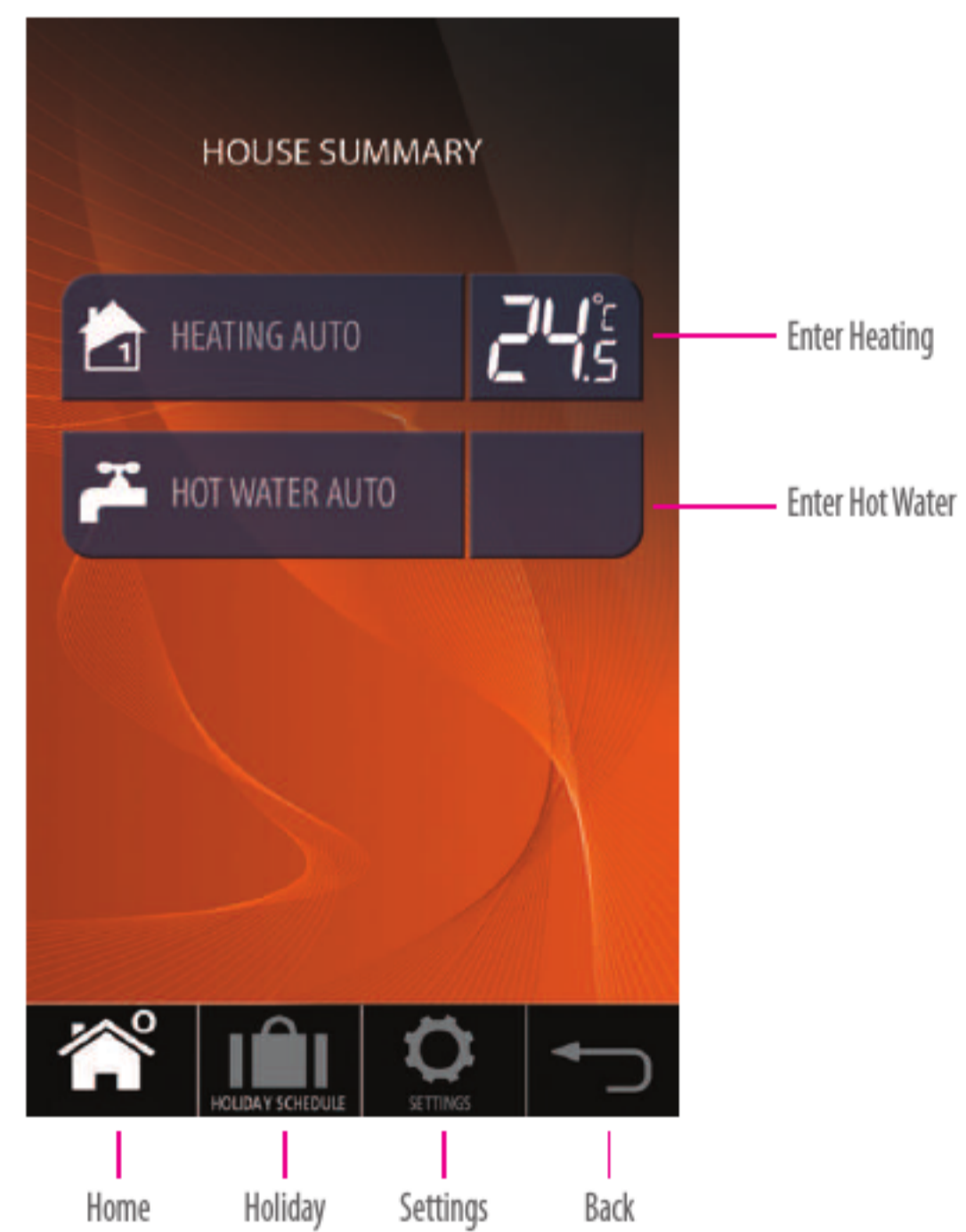

## One Central Heating Zone + Hot Water System PC & Smartphone Control



## One Central Heating Zone + Hot Water System Local Control

### Temporary override of your temperature and boosting your hot water.

Press the power button to start and use the buttons indicated to change the SET temperature. Then press the tick to accept.

**i** To go straight to hot water, short press

**i** Press to cancel temporary override.

**Note:** Gear wheel is now illuminated indicating manual override of set temperature.

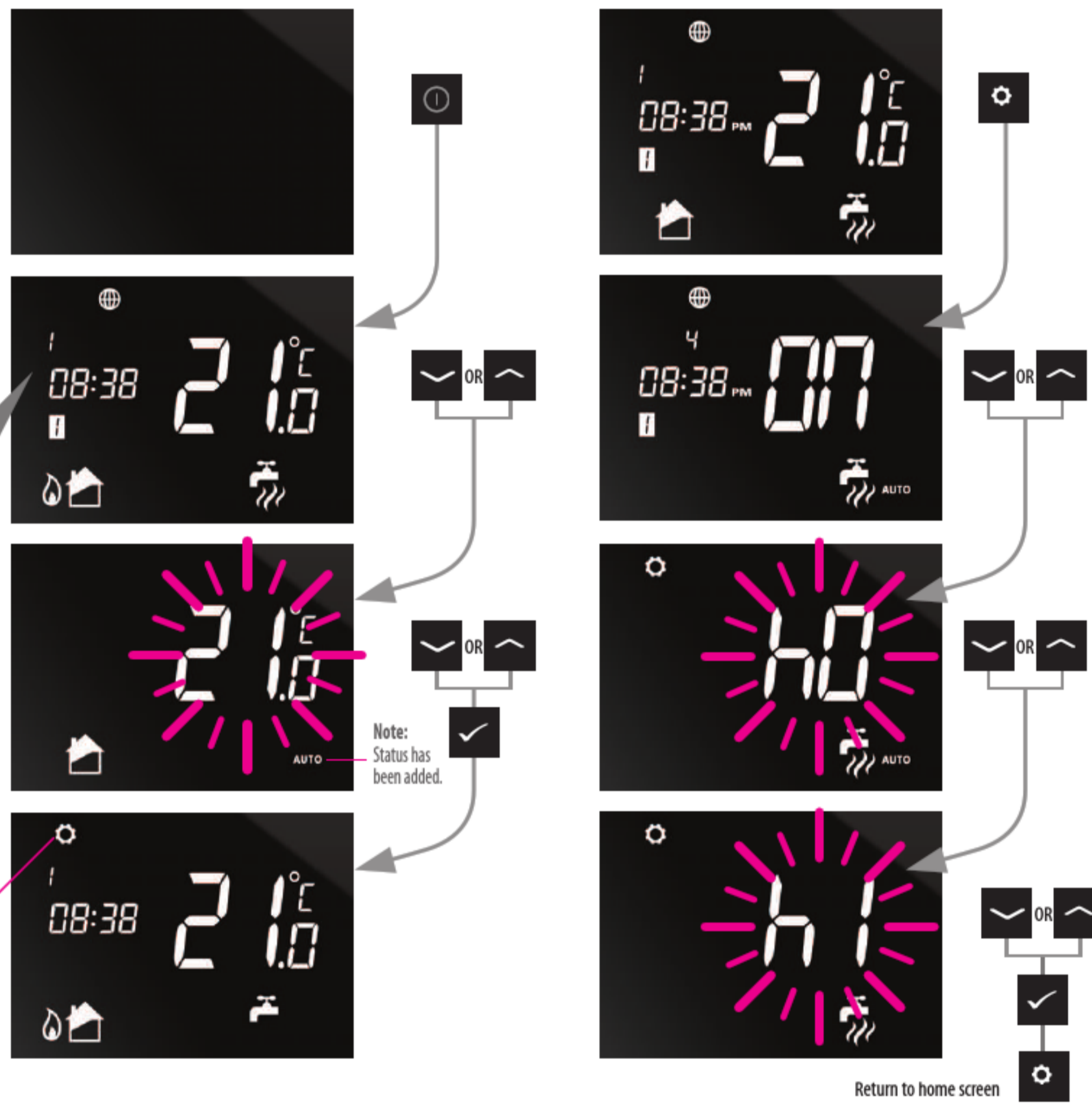



## One Central Heating Zone + Hot Water System Local Control

Switching your heating from AUTO to OFF and overriding hot water AUTO mode.

**i**  
To go straight to hot water, short press

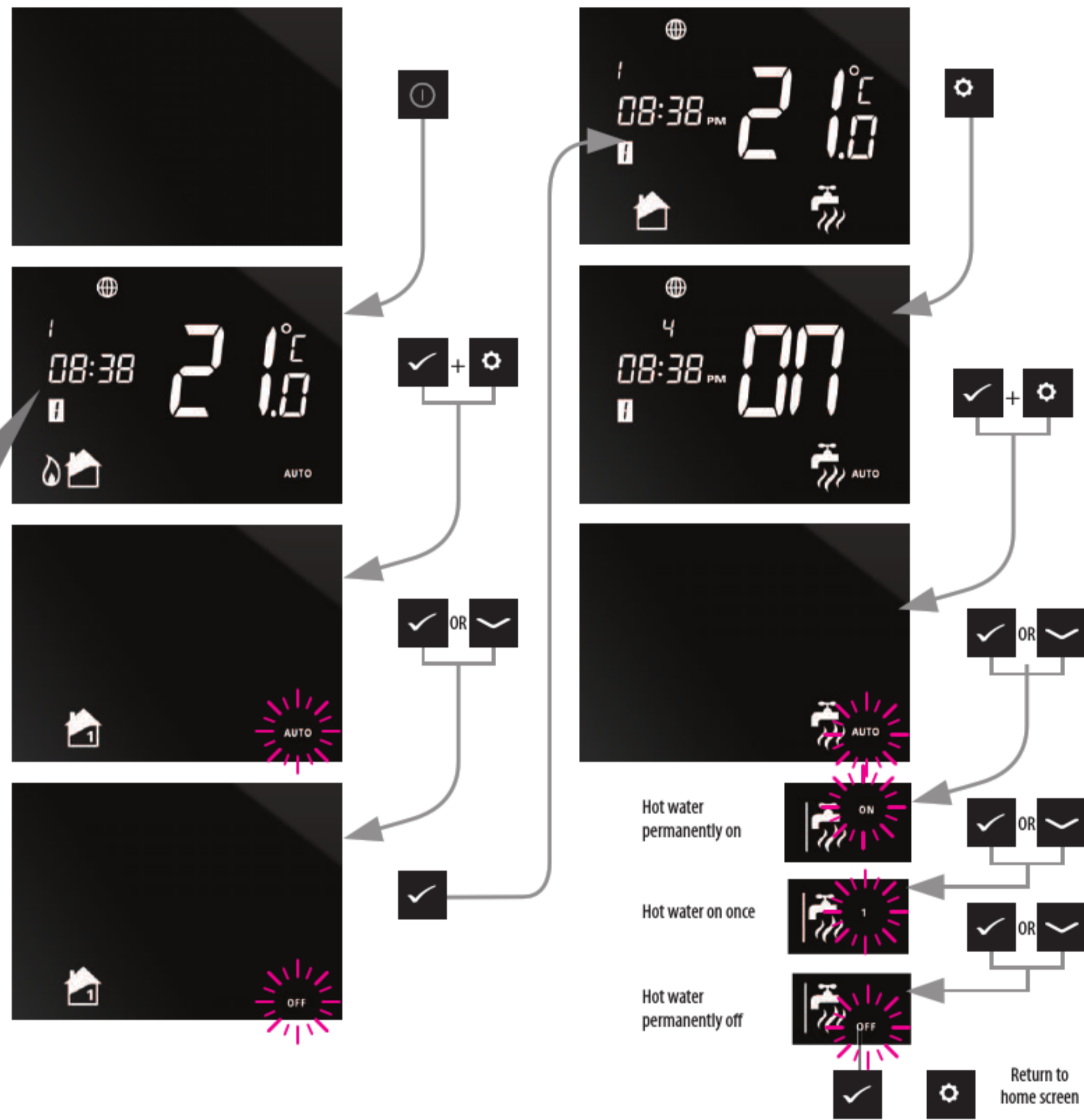

## Default Program Schedules

### Central Heating

PROGRAM	WEEKDAY (1 to 5)	WEEKDAY (6 to 7)
1	Time 6:00am Setpoint Temp 21°C	Time 6:00am Setpoint Temp 21°C
2	Time 8:00am Setpoint Temp 14°C	Time 8:00am Setpoint Temp 14°C
3	Time 11:00am Setpoint Temp 21°C	Time 11:00am Setpoint Temp 21°C
4	Time 1:00pm Setpoint Temp 14°C	Time 1:00pm Setpoint Temp 14°C
5	Time 4:00pm Setpoint Temp 21°C	Time 4:00pm Setpoint Temp 21°C
6	Time 9:00pm Setpoint Temp 14°C	Time 9:00pm Setpoint Temp 14°C



Your iT500 comes pre-set with these default program schedules. These can be easily changed via the PC or Smartphone App.

### Hot Water

PROGRAM	OP	WEEKDAY (1 to 5)	WEEKDAY (6 to 7)
1	ON OFF	6:00am 8:00am	6:00am 8:00am
2	ON OFF	10:00am 12:00pm	10:00am 12:00pm
3	ON OFF	6:00pm 10:00pm	6:00pm 10:00pm

## Viewing or changing your program schedule

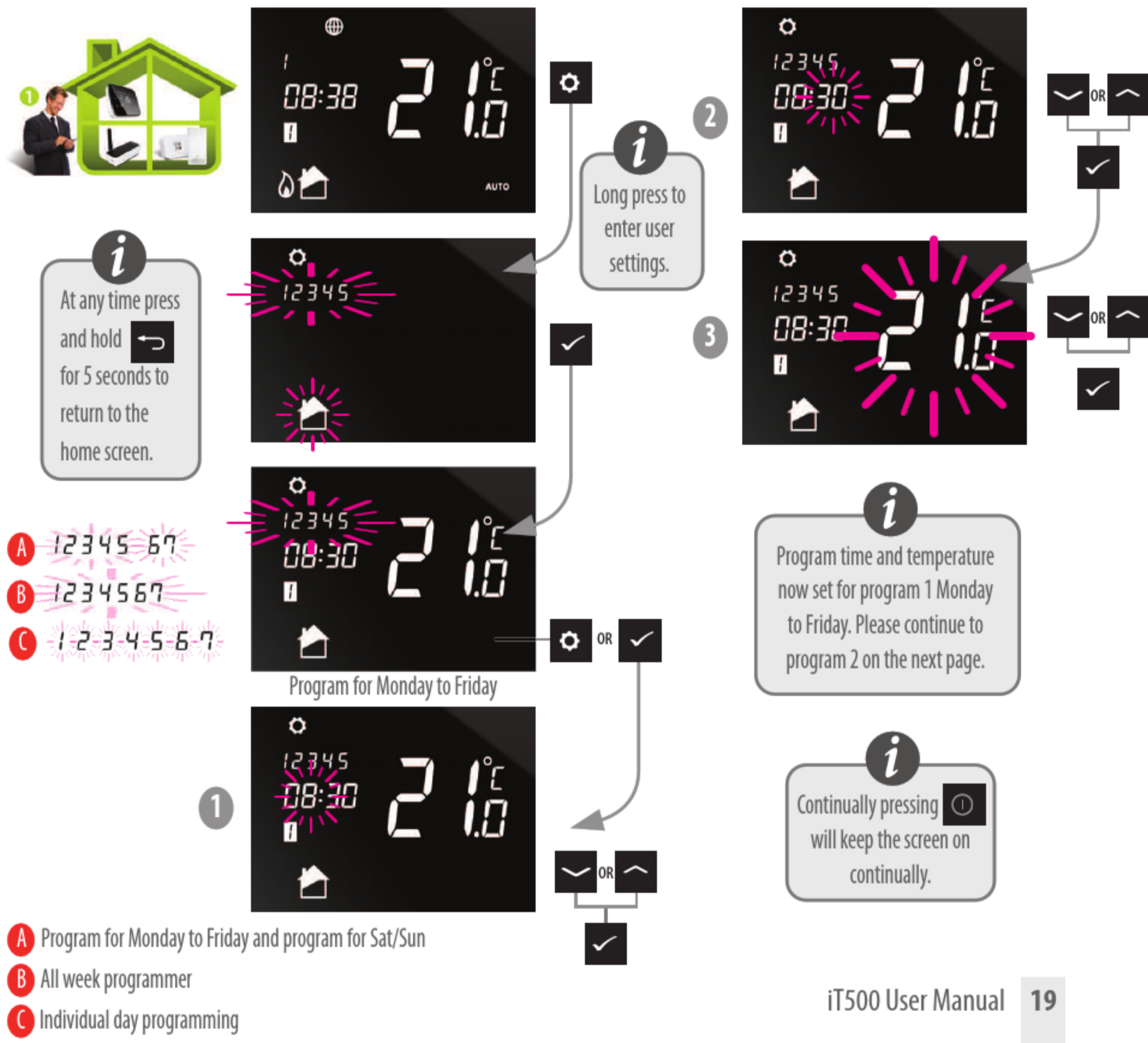

## Viewing or changing your program schedule



## Viewing or changing your program schedule



Central heating and hot water



Long press



To enter Central Heating program

OR

To select Hot Water program

Follow steps 1 to 5 on previous two pages



Please follow steps 1 to 5 starting on previous two pages



Note: Hot Water has ON and OFF for specific program times rather than temperatures

### Program Menu: Setting Time and Date

**i** When connected to the internet, the iT500 will set the time and date automatically. However this can also be set manually.

**i** Long press to enter user settings.

**i** At any time press and hold  for 5 seconds to return to the home screen.

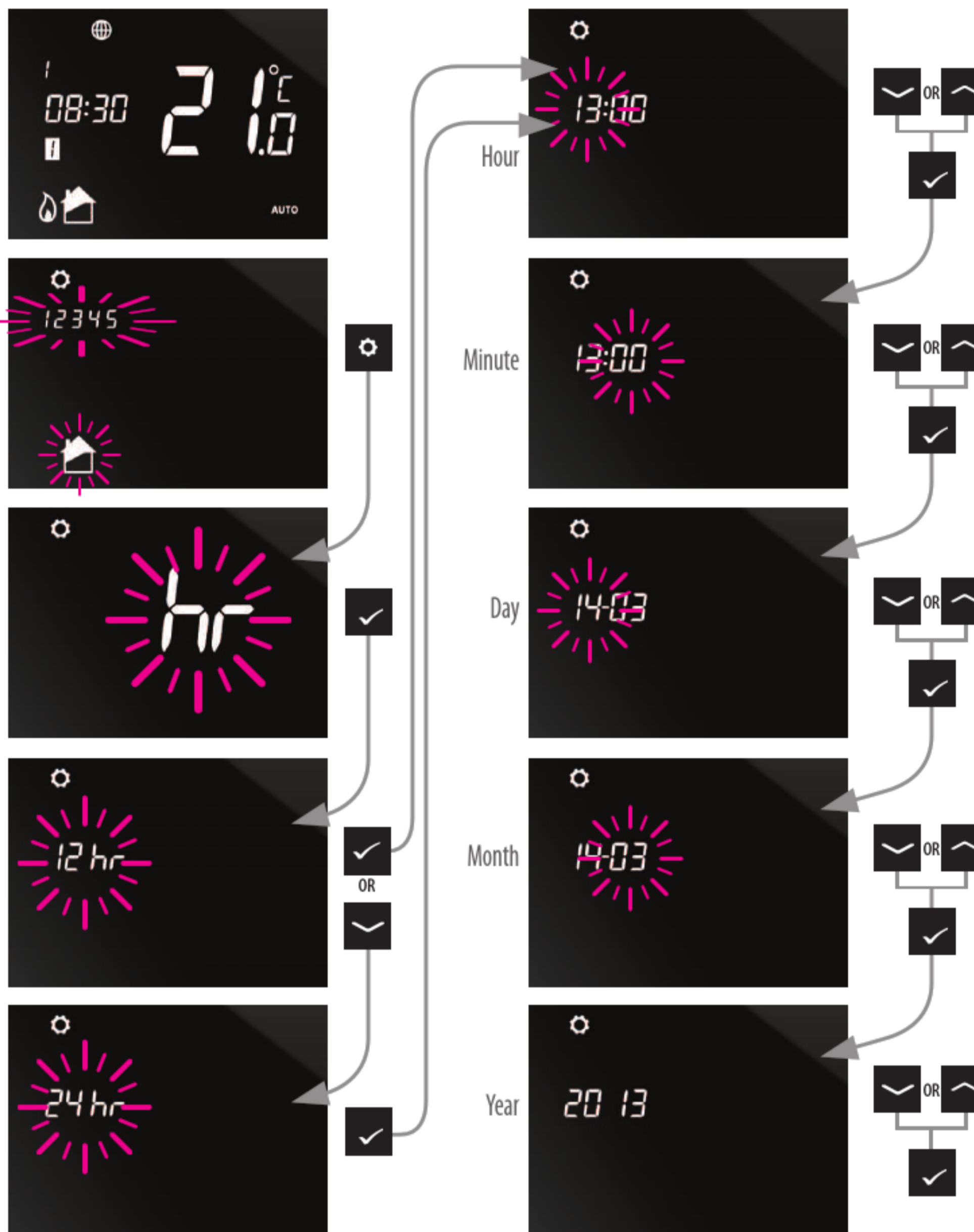

## Useful information



You can only activate holiday function via the Web App and Smartphone App.

### Exiting Holiday Mode

To exit holiday mode, press and hold the  button.



### Cancel Temporary Override

To cancel temporary override of set temperature press and hold  button.





### Exiting Energy Mode

To enter or exit energy mode, press and hold the  button.



### Lock Function

To enable or disable lock function press  and  together.



**SALUS Controls plc**

SALUS House  
Dodworth Business Park South,  
Whinby Road,  
Dodworth, Barnsley S75 3SP  
UK.

**SALES:** T: +44 (0) 1226 323961  
E: sales@salus-tech.com

**TECHNICAL:** T: +44 (0) 1226 323961  
E: tech@salus-tech.com

[www.salus-controls.com](http://www.salus-controls.com)



SALUS Controls is a member of the Computime Group

Maintaining a policy of continuous product development SALUS Controls plc reserve the right to change specification, design and materials of products listed in this brochure without prior notice.

**Issue Date: Sept 2013**

00086/2