

Digital Video Camcorder

Mini DV Digital
Video
Cassette

SC-D453/D455/D457

AF Auto Focus
CCD Charge Coupled Device
LCD Liquid Crystal Display

Owner's Instruction Book

Before operating the unit, please read this Instruction Book thoroughly, and retain it for future reference.

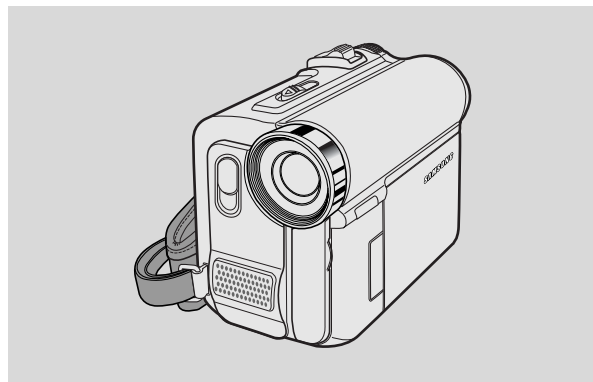



SAMSUNG

ELECTRONICS

US PATENT 4415844

Notices and Safety Instructions

Safety Instructions

	CAUTION RISK OF ELECTRIC SHOCK DO NOT OPEN	
CAUTION: TO REDUCE THE RISK OF ELECTRIC SHOCK, DO NOT REMOVE COVER(OR BACK). NO USER SERVICEABLE PARTS INSIDE, REFER SERVICING TO QUALIFIED SERVICE PERSONNEL.		

To prevent electric shock, match wide blade of plug to wide slot and fully insert.



This symbol is intended to alert the user to the presence of uninsulated dangerous voltage within the product's enclosure that may be of sufficient magnitude to constitute a risk of fire or electric shock.



This symbol is intended to alert the user to the presence of important operating and maintenance instructions in the literature accompanying this product.

1. READ INSTRUCTIONS:

All the safety and operating instructions should be read before the CAMCORDER is operated.

2. RETAIN INSTRUCTIONS:

The safety and operating instructions should be retained for future reference.

3. HEED WARNINGS:

All warnings on the CAMCORDER and in the operating instructions should be adhered to.

4. FOLLOW INSTRUCTIONS:

All operating and maintenance instructions should be followed.

5. CLEANING:

Unplug this CAMCORDER from the wall outlet before cleaning.
Do not use liquid or aerosol cleaners.
Use a dry cloth used for dusting cabinets.

6. ATTACHMENTS:

Do not use attachments not recommended by the CAMCORDER product manufacturer as they may be hazardous.

7. WATER AND MOISTURE:

Do not use this CAMCORDER near water;
for example, near a bathtub, wash bowl, kitchen sink, laundry tub, in a wet basement, near a swimming pool or lake.

8. ACCESSORIES:

Do not place this CAMCORDER on an unstable cart, stand, tripod, bracket or table. The CAMCORDER may fall, causing serious injury to a child or adult, and serious damage to the unit.
Use only with a cart, stand, tripod, bracket, or table recommended by the manufacturer or sold with the CAMCORDER. Any mounting of the unit should follow the manufacturer's instructions and should use a mounting accessory recommended by the manufacturer.

A. An appliance and cart combination should be moved with care. Quick stops, excessive force and uneven surfaces may cause the appliance and cart combination to overturn.
PORTABLE CART WARNING
(Symbol provided by RETAC)



Notices and Safety Instructions

9. VENTILATION:

Slots and openings in the cabinet are provided for ventilation to ensure reliable operation of the CAMCORDER and to protect it from overheating. These openings must not be blocked or covered. Never place your CAMCORDER on a bed, sofa, rug, or other similar surface: on or near a radiator or heat register. This CAMCORDER should not be placed in a built-in installation such as a bookcase or rack unless proper ventilation is provided or the manufacturer's instructions have been adhered to.

10. POWER SOURCES:

The CAMCORDER should be operated only from the type of power source indicated on the label. If you are not sure of the type of power supply at your home, consult your appliance dealer or local power company. A CAMCORDER is intended to be operated from battery power, or other sources, refer to the operating instructions.

11. GROUNDING OR POLARIZATION:

This CAMCORDER may be equipped with either a polarized 2-wire AC line plug (a plug having one blade wider than the other) or a 3-wire grounding type plug, a plug having a third (grounding) pin.

If you are unable to insert the plug fully into the outlet, try reversing the plug. If the plug still fails to fit, contact your electrician to replace your outlet. Do not defeat the safety purpose of the polarized plug.

12. POWER-CORD PROTECTION:

Power-supply cords should be routed so that they are not likely to be walked on or pinched by items placed upon or against them, paying particular attention to cords or plugs, convenient receptacles, and the point where they exit from the unit.

13. OUTDOOR ANTENNA GROUNDING:

If an outside antenna or cable system is connected to the CAMCORDER, be sure the antenna or cable system is grounded to provide some protection against voltage surges and built-up static charges, Section 810 of the National Electrical Code, ANSI/NFPA No. 70-1984, provides information with respect to proper grounding of the mast and supporting structure, grounding of the lead-in wire and supporting structure, grounding of the mast and supporting structure, grounding of the lead-in wire to an antenna discharge unit, size of grounding to conductors, location of antenna-discharge unit, connection to grounding electrodes and requirements for the grounding electrode. See figure below.

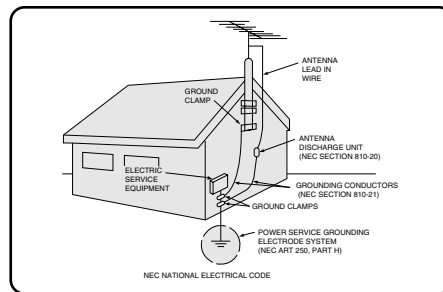

Notices and Safety Instructions

14. LIGHTNING:

For added protection of this CAMCORDER during a lightning storm or when it is left unattended and unused for long periods of time, unplug it from the wall outlet and disconnect the antenna or cable system.

This will prevent damage to the CAMCORDER due to lightning and power-line surges.

15. POWER LINES:

An outside antenna system should not be located in the vicinity of overhead power lines or other electric light or power circuits where it can fall into such power lines or circuits. When installing an outside antenna system, extreme care should be taken to keep from touching such power lines or circuits as contact with them might be fatal.

16. OVERLOADING:

Do not overload wall outlets and extension cords as this can result in a risk of fire or electric shock.

17. OBJECTS AND LIQUIDS:

Never push objects of any kind into this CAMCORDER through openings as they may touch dangerous voltage points or short out a part that could result in a fire or electric shock.

Never spill liquids of any kind onto the CAMCORDER. Should spillage occur, unplug unit and have it checked by a technician before use.

18. SERVICING:

Do not attempt to service this CAMCORDER yourself. Opening or removing covers may expose you to dangerous voltage or other hazards.

Refer all servicing to qualified service personnel.

19. DAMAGE REQUIRING SERVICE:

Unplug this CAMCORDER from the wall outlet and refer servicing to qualified service personnel under the following conditions:

- When the power-supply cord or plug is damaged.
- If any liquid has been spilled onto, or objects have fallen into the CAMCORDER.
- If the CAMCORDER has been exposed to rain or water.
- If the CAMCORDER does not operate normally by following the operating instructions, adjust only those controls that are covered by the operating instructions. Improper adjustment of other controls may result in damage and will often require extensive work by a qualified technician to restore the CAMCORDER to its normal operation.
- If the CAMCORDER has been dropped or the cabinet has been damaged.
- When the CAMCORDER exhibits a distinct change in performance, this indicates a need for service.

20. REPLACEMENT PARTS:

When replacement parts are required, be sure the service technician has used replacement parts specified by the manufacturer and having the same characteristics as the original part.

Unauthorized substitutions may result in fire, electric shock or other hazards.

21. SAFETY CHECK:

Upon completion of any service or repairs to this CAMCORDER, ask the service technician to perform safety checks to determine that the CAMCORDER is in safe operating order.

Notices and Safety Instructions

22. To prevent damage which may result in fire or shock hazard, do not expose this appliance to rain or moisture.
23. If this power supply is used at 240V ac, a suitable plug adapter should be used.

NOTE TO CATV SYSTEM INSTALLER:

This reminder is provided to call the CATV system installer's attention to Article 820-40 of the NEC that provides guidelines for proper grounding and, in particular, specifies that the cable ground shall be connected to the grounding system of the building as close to the point of cable entry as practical.

USER INSTALLER CAUTION:

Your authority to operate this FCC certified equipment could be voided if you make changes or modifications not expressly approved by this party responsible for compliance to part 15 FCC rules.

NOTE:

(Hg) LAMP(S) INSIDE THIS PRODUCT CONTAIN MERCURY AND MUST BE RECYCLED OR DISPOSED OF ACCORDING TO LOCAL, STATE OR FEDERAL LAWS For details see lamprecycle.org, eiae.org, or call 1-800-Samsung

NOTE: This equipment has been tested and found to comply with the limits for a Class B digital device, pursuant to part 15 of the FCC Rules. These limits are designed to provide reasonable protection against harmful interference in a residential installation. This equipment generates, uses and can radiate radio frequency energy and, if not installed and used in accordance with the instructions, may cause harmful interference to radio communications. However, there is no guarantee that interference will not occur in a particular installation. If this equipment does cause harmful interference to radio or television reception, which can be determined by turning the equipment off and on, the user is encouraged to try to correct the interference by one or more of the following measures:

- Reorient or relocate the receiving antenna.
- Increase the separation between the equipment and receiver.
- Connect the equipment into an outlet on a circuit different from that to which the receiver is connected.
- Consult the dealer or an experienced radio/TV technician for help and for additional suggestions.

The user may find the following booklet prepared by the Federal Communications Commission helpful : "How to Identify and Resolve Radio-TV Interference Problems."

This Booklet is available from the U.S. Government Printing Office, Washington, D.C. 20402, Stock No. 004-000-00345-4.

FCC Warning

The user is cautioned that changes or modifications not expressly approved by the manufacturer could void the user's authority to operate the equipment.

FCC ID : A3L05TIGER

This device complies with Part 15 of FCC Rules.

Operation is subject to the following two conditions;

- (1) This device may not cause harmful interference, and
- (2) This device must accept any interference received, including interference that may cause undesired operation.

Notes and Safety Instructions

Notes regarding the Rotation of the LCD Screen

Please rotate the LCD screen carefully as illustrated.

Over rotation may cause damage to the inside of the hinge that connects the LCD screen to the Camcorder.

1. LCD screen closed.
2. Standard recording using the LCD screen.
 - Open the LCD screen with your finger.
3. Recording when looking at the LCD screen from the top.
4. Recording when looking at the LCD screen from the front.
5. Recording when looking at the LCD screen from the left.
6. Recording with the LCD screen closed.

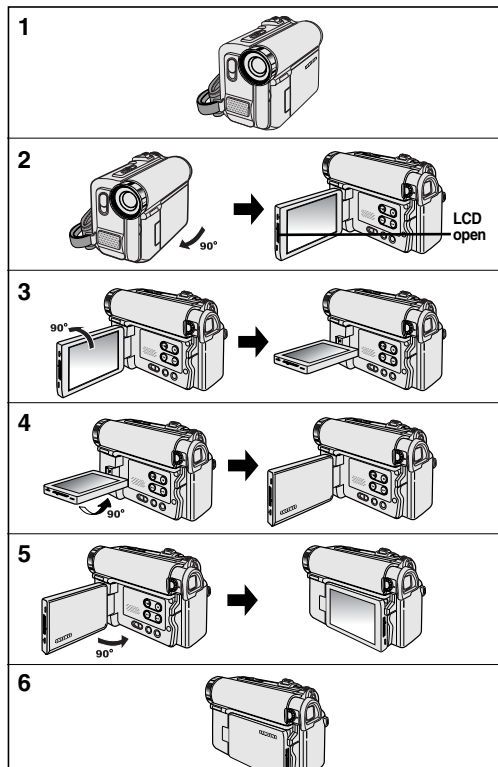

Notes and Safety Instructions

Notices regarding Copyright

Television programs, video tapes, DVD titles, films, and other program materials may be copyrighted.

Unauthorized copying of copyrighted material may be against the law.

All the trade names and registered trademarks mentioned in this manual or other documentation provided with your Samsung product are trademarks or registered trademarks of their respective holders.

Notes regarding Moisture Condensation

1. A sudden rise in atmospheric temperature may cause condensation to form inside the Camcorder.

for example:

- When you move the Camcorder from a cold location to a warm location (e.g. from outside to inside during winter.)
 - When you move the Camcorder from a cool location to a hot location (e.g. from inside to outside during the summer.)
2. If the  (DEW) protection feature is activated, leave the Camcorder for at least two hours in a dry, warm room with the cassette compartment opened and the Battery pack removed.

Notes regarding Camcorder

1. Do not leave the Camcorder exposed to high temperatures (above 60°C or 140°F).
For example, in a parked car in the sun or exposed to direct sunlight.
2. Do not let the Camcorder get wet.
Keep the Camcorder away from rain, sea water, and any other form of moisture.
If the Camcorder gets wet, it may get damaged.
Sometimes a malfunction due to exposure to liquids cannot be repaired.

Notes and Safety Instructions

Notes regarding the Battery Pack

- It is recommended to use original battery pack that is available at SAMSUNG service center.
- Make sure that the Battery pack is fully charged before starting to record.
- To preserve battery power, keep your Camcorder turned off when you are not operating it.
- If your Camcorder is in CAMERA mode, and it is left in STBY mode without being operated for more than 5 minutes with a tape inserted, it will automatically turn itself off to protect against unnecessary battery discharge.
- Make sure that the Battery pack is fitted firmly into place.
Do not drop the Battery pack. Dropping the Battery pack may damage it.
- A brand new Battery pack is not charged.
Before using the Battery pack, you need to charge it completely.
- Fully discharging a Lithium-Ion battery damages the internal cells. The Battery pack may be prone to leakage when fully discharged.

When the battery reaches the end of its life, please contact your local dealer.
The batteries have to be dealt with as chemical waste.

Notes regarding the Video Head Cleaning

- To ensure normal recording and a clear picture, clean the video heads regularly.
If a square block-shape distorts playback, or only a blue screen is displayed, the video heads may be dirty.
If this happens, clean the video heads with a dry type cleaning cassette.
- Do not use a wet-type cleaning cassette. It may damage the video heads.

Notes and Safety Instructions

Note regarding the Lens

Do not film with the camera lens pointing directly at the sun.
Direct sunlight can damage the CCD (Charge Coupled Device).

Notes regarding electronic Viewfinder

1. Do not position the Camcorder such that the Viewfinder is pointing towards the sun.
Direct sunlight can damage the inside of the Viewfinder. Be careful when placing the Camcorder under sunlight or near a window exposed to sunlight.
2. Do not pick up the Camcorder by holding the Viewfinder.
3. Applying excessive force to the Viewfinder may damage it.

Notes regarding 'Record' or 'Playback' Using the LCD Screen

1. The LCD screen has been manufactured using high precision technology. However, there may be tiny dots (red, blue or green in color) that appear on the LCD screen. These dots are normal and do not affect the recorded picture in any way.
2. When you use the LCD screen under direct sunlight or outdoors, it may be difficult to see the picture clearly.
If this occurs, we recommend using the Viewfinder.
3. Direct sunlight can damage the LCD screen.

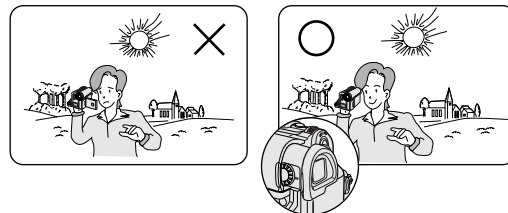

Notes regarding the Hand Strap

- To ensure a steady picture while filming, check that the hand strap is properly adjusted.
- Do not force your hand into the hand strap as you could damage it.

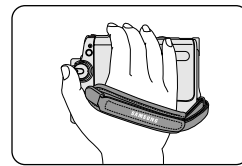

Notes and Safety Instructions

Precautions regarding the Lithium battery

1. The camcorder's built-in lithium battery maintains the clock function and user settings, even if the battery pack or AC adapter is removed.
2. The lithium battery for the camcorder lasts about a one month under normal operation from the time of installation.
3. When the lithium battery becomes weak or is dead, the date/time indicator will display "12:00 AM JAN.1,2005" when you set the DATE/TIME to On.
When this occurs, connect the camcorder to power to fully recharge the built-in lithium battery. If the same problem occurs with a fully recharged battery, contact a Samsung authorized Service Center to replace the battery.

Precautions regarding the external lithium battery for the remote control

Warning:

- Keep the LITHIUM BATTERY(Remote Control) out of reach of children.
Should a battery be swallowed, consult a doctor immediately.
- Danger of explosion if battery is incorrectly replaced.
Replace only with the same or equivalent type.

Servicing

Do not attempt to service this Camcorder yourself.
Opening or removing covers may expose you to dangerous voltage or other hazards.
Refer all servicing to qualified service personnel.

Replacement Parts

When replacement parts are required, be sure the service technician has used replacement parts specified by the manufacturer and having the same characteristics as the original part.
Unauthorized substitutions may result in fire, electric shock or other hazards.

System Menu Setting

Setting the Clock

- ❖ Clock setup works in Camera/Player/M.Cam/M.Player modes.
- ❖ The Date/Time is automatically recorded onto a tape.
Before recording, please set the Date/Time.

1. Set the **Power** switch to **CAMERA** or **PLAYER**.
2. Set the **Mode** switch to **TAPE** or **MEMORY**.
3. Press the **MENU** button.
 - The menu list will appear.
4. Move the **Menu selector** to the left or right to select **System**, then press the **Menu selector**.
5. Move the **Menu selector** to the left or right to select **Clock Set**, then press the **Menu selector**.
The year will highlight first.
6. Move the **Menu selector** to the left or right to set current Year, then press the **Menu selector**.
The month will be highlighted.
7. You can set the month, day, hour and minute following the same procedure for setting the year.
8. Press the **Menu selector** after setting the minutes.
 - The message **Complete!** will be displayed.
 - To adjust the clock, select the Year, Month, Day, Hour or Min by pressing the **Menu selector**, then move the **Menu selector** to the left or right to set respective values.
9. To exit, press the **MENU** button.

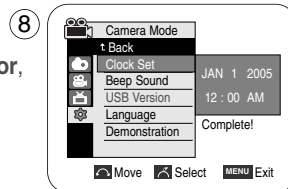
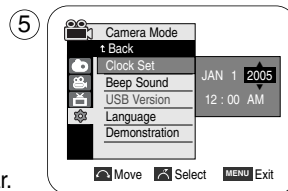
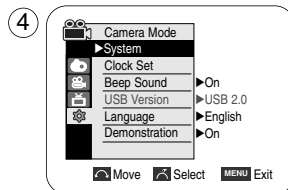

[Notes]

- Date/Time is memorized and maintained by the built-in Lithium battery installed in the camcorder. If you don't use the camcorder for a long period of time, charge the Lithium battery at least once a month. To charge the built-in Lithium battery, supply power to the camcorder and set the Power Switch to CAMERA or PLAYER.
- After the Lithium battery loses its charge (after about 3 month), the date/time appears on the screen as 12:00 AM JAN.1,2005.
- You can set the year up to 2037.
- If the built-in lithium battery is not charged, any input data will not be backed up.

System Menu Setting

Setting the Wireless Remote Control Acceptance (Remote) (SC-D457 only)

- ❖ The Remote function works in Camera/Player/M.Cam/M.Player modes.
- ❖ The Remote option allows you to enable or disable the remote control for use with the Camcorder.

1. Set the **Power** switch to **CAMERA** or **PLAYER**.
2. Set the **Mode** switch to **TAPE** or **MEMORY**.
3. Press the **MENU** button.
 - The menu list will appear.
4. Move the **Menu selector** to the left or right to select **System**, then press the **Menu selector**.
5. Move the **Menu selector** to the left or right to select **Remote**, then press the **Menu selector**.
6. Move the **Menu selector** to the left or right to select **On** or **Off**, then press the **Menu selector**.
7. To exit, press the **MENU** button.

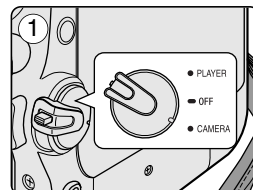

4

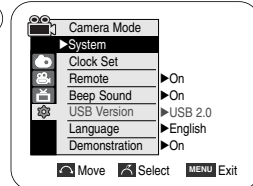

6

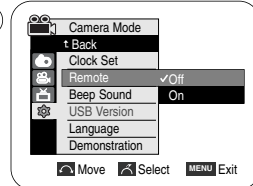

[Note]

If you set the Remote to Off in the menu and try to use it, the remote control icon (📶) will blink for 3 seconds on the LCD screen and then disappear.

System Menu Setting

Setting the Beep Sound

- ❖ The Beep Sound function works in Camera/Player/M.Cam/M.Player modes.
- ❖ You can turn the Beep Sound on or off, when on, each press of a button sounds a beep.

1. Set the **Power** switch to **CAMERA** or **PLAYER**.
2. Set the **Mode** switch to **TAPE** or **MEMORY**.
3. Press the **MENU** button.
 - The menu list will appear.
4. Move the **Menu selector** to the left or right to select **System**, then press the **Menu selector**.
5. Move the **Menu selector** to the left or right to select **Beep Sound**, then press the **Menu selector**.
6. Move the **Menu selector** to the left or right to select **On** or **Off**, then press the **Menu selector**.
7. To exit, press the **MENU** button.

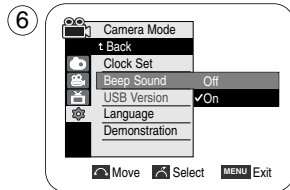
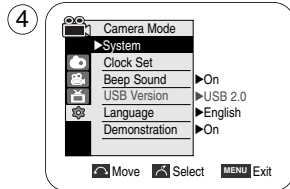
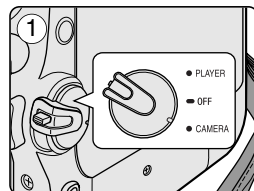

[Note]

When you are recording, the Beep Sound is automatically set to Off so you can't hear it until you stop the recording.

System Menu Setting

Setting the Shutter Sound

- ❖ The Shutter Sound function works in both Player and M.Cam modes.
- ❖ You can turn the Shutter Sound on or off, when on, with each press of the PHOTO button the Shutter will Sound.

1. Set the **Power** switch to **CAMERA** or **PLAYER**.
2. If the **Power** switch is set to **CAMERA** mode, set the **Mode** switch to **MEMORY**.
If the **Power** switch is set to **PLAYER** mode, set the **Mode** switch to **TAPE**.
3. Press the **MENU** button.
 - The menu list will appear.
4. Move the **Menu selector** to the left or right to select **System**, then press the **Menu selector**.
5. Move the **Menu selector** to the left or right to select **Shutter Sound**, then press the **Menu selector**.
6. Move the **Menu selector** to the left or right to select **On** or **Off**, then press the **Menu selector**.
7. To exit, press the **MENU** button.

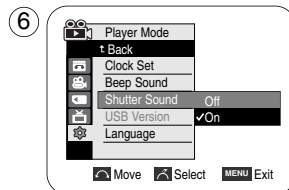
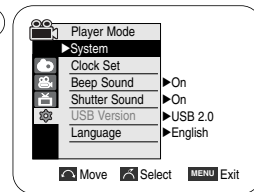
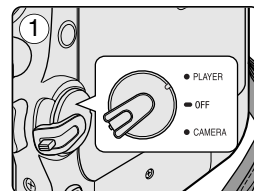

System Menu Setting

Viewing the Demonstration

- ❖ Before you begin: Make sure that there is no tape inserted in the Camcorder. (See page 36)
- ❖ Demonstration automatically shows you the major functions that are included with your Camcorder so that you may use them more easily.
- ❖ The Demonstration function may only be used in the Camera mode without a tape inserted in the Camcorder.
- ❖ The Demonstration operates repeatedly until the Demonstration mode switched off.

1. Set the **Power** switch to **CAMERA**.
2. Set the **Mode** switch to **TAPE**.
3. Press the **MENU** button.
 - The menu list will appear.
4. Move the **Menu selector** to the left or right to select **System**, then press the **Menu selector**.
5. Move the **Menu selector** to the left or right to select **Demonstration**, then press the **Menu selector**.
6. Move the **Menu selector** to the left or right to select **On**, then press the **MENU** button.
 - The Demonstration will begin.
7. To quit the Demonstration, press the **MENU** button.

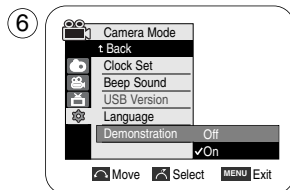
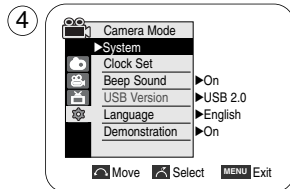
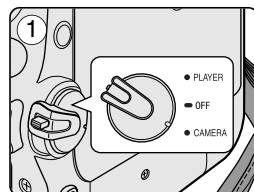

[Notes]

- The Demonstration mode is automatically activated when the Camcorder is left idle for more than 10 minutes after switching to the Camera mode (no tape is inserted in the Camcorder).
- If you press other buttons (FADE, BLC, PHOTO, EASY.Q, COLOR NITE/PB ZOOM) during the Demonstration mode, the demonstration stops temporarily and resumes 10 minutes later if you do not operate any other functions.

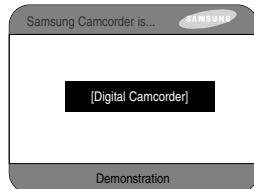

Display Menu Setting

Adjusting the LCD Screen

- ✱ This function works in Camera/Player/M.Cam/M.Player modes.
- ✱ Your Camcorder is equipped with a 2.5 inch color Liquid Crystal Display(LCD) screen, which enables you to view what you are recording or playing back directly.
- ✱ Depending on the conditions under which you are using the Camcorder (indoors or outdoors for example), you can adjust;
 - LCD Bright
 - LCD Color

1. Set the **Power** switch to **CAMERA** or **PLAYER**.
2. Set the **Mode** switch to **TAPE** or **MEMORY**.
3. Press the **MENU** button.
 - The menu list will appear.
4. Move the **Menu selector** to the left or right to select **Display**, then press the **Menu selector**.
5. Move the **Menu selector** to the left or right to select the item you want to adjust (LCD Bright or LCD Color), then press the **Menu selector**.
6. Move the **Menu selector** to the left or right to adjust the value of the selected item (LCD Bright or LCD Color), then press the **Menu selector**.
 - You can set values for **LCD Bright** and **LCD Color** between 0~35.
7. To exit, press the **MENU** button.
 LCD BRIGHT & LCD COLOR functions do not affect the brightness and color of the image to be recorded.

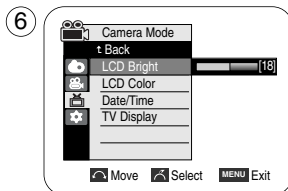
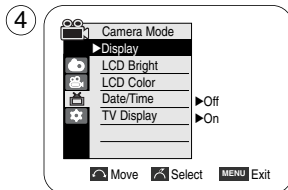
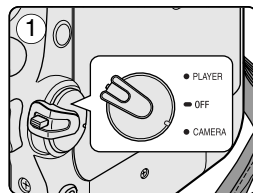

Display Menu Setting

Displaying the Date/Time

- ❖ The Date/Time function works in Camera/Player/M.Cam/M.Player modes.
- ❖ The date and time are automatically recorded on a special data area of the tape.

1. Set the **Power** switch to **CAMERA** or **PLAYER**.
2. Set the **Mode** switch to **TAPE** or **MEMORY**.
3. Press the **MENU** button.
 - The menu list will appear.
4. Move the **Menu selector** to the left or right to select **Display**, then press the **Menu selector**.
5. Move the **Menu selector** to the left or right to select **Date/Time**, then press the **Menu selector**.
6. Move the **Menu selector** to the left or right to select the display type of the Date/Time, then press the **Menu selector**.
 - Display type of the Date/Time: Off, Date, Time, Date&Time.
7. To exit, press the **MENU** button.

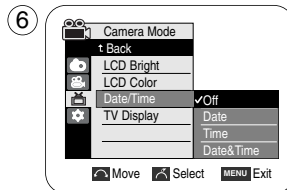
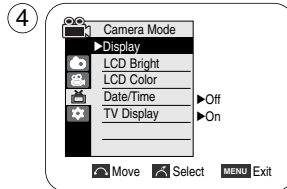
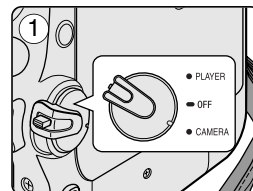

[Notes]

- The Date/Time will read **12:00 AM JAN.1,2005** in the following conditions.
 - During playback of a blank section of a tape.
 - If the tape was recorded before setting the Date/Time in the Camcorder.
 - When the Lithium battery becomes weak or dead.
- Before you use the Date/Time function, you must set the clock. See Setting the Clock on page 27.

Display Menu Setting

Setting the TV Display

- ❖ The TV Display function works in Camera/Player/M.Cam/M.Player modes.
- ❖ You can select the output path of the OSD (On Screen Display).
 - Off: The OSD appears in the LCD screen and Viewfinder only.
 - On: The OSD appears in the LCD screen, Viewfinder and TV.
- Use the DISPLAY button located at the left side of the Camcorder to turn the OSD on/off on the LCD screen/Viewfinder/TV.

1. Set the **Power** switch to **CAMERA** or **PLAYER**.
2. Set the **Mode** switch to **TAPE** or **MEMORY**.
3. Press the **MENU** button.
 - The menu list will appear.
4. Move the **Menu selector** to the left or right to select **Display**, then press the **Menu selector**.
5. Move the **Menu selector** to the left or right to select **TV Display**, then press the **Menu selector**.
6. To activate TV Display function, move the **Menu selector** to the left or right to select **On** or **Off**, then press the **Menu selector**.
7. To exit, press the **MENU** button.

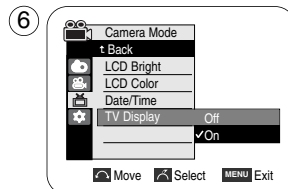
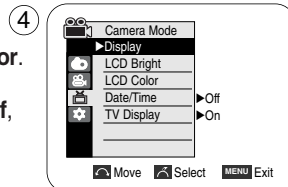
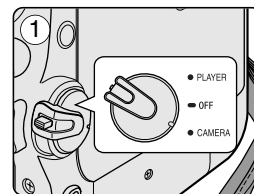

Basic Recording

Using the Viewfinder

- ❖ The Viewfinder will work when the LCD screen is closed.

Adjusting the Focus

The focus adjustment knob of the Viewfinder enables individuals with vision problems to see clearer images.

1. Close the LCD screen and pull out the Viewfinder.
2. Use the focus adjustment knob of the Viewfinder to focus the picture.

[Notes]

- Viewing the sun or any strong light source through the Viewfinder for a prolonged period may be harmful, or cause temporary impairment.
- The Viewfinder will work either in PLAYER mode with LCD screen closed or in CAMERA mode with LCD screen closed.

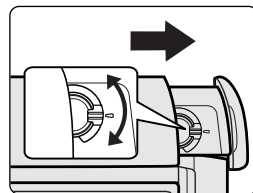

Basic Recording

Inserting and Ejecting a Cassette

- ✦ When inserting a tape or closing the cassette compartment, do not apply excessive force.
As it may cause a malfunction.
- ✦ Do not use any tape other than Mini DV cassettes.

1. Turn on your Camcorder, then slide the **TAPE EJECT** switch on the upper of the Camcorder and open the cassette door until it clicks.
 - The cassette holder automatically rises and opens forward.
2. Insert a tape into the cassette compartment with the tape window facing outward and the protection tab toward the top. (Inserting a Cassette)
 - Remove the cassette tape, which is automatically ejected by pulling the cassette out. (Ejecting a Cassette)
3. Press the **PUSH** label on the cassette holder and wait until it clicks and goes back into place.
 - Do not apply excessive force or pressure on the cassette holder.
 - Do not forcibly push the cassette holder into the Camcorder.
 - The cassette is automatically loaded.
4. Close the cassette door.

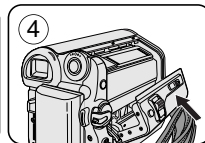
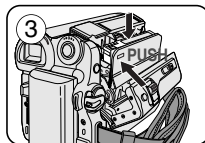
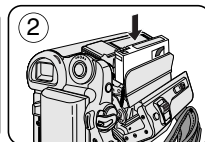
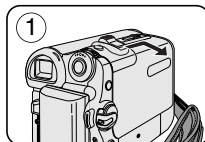

[Note]

When you have recorded something that you wish to keep, you can protect it so that it will not be accidentally erased.

a. Protecting a tape:

Push the safety tab on the cassette so that the hole is uncovered.

b. Removing the tape protection:

If you no longer wish to keep the recording on the cassette, push the safety tab back so that it covers the hole.

How to store a tape

- a. Avoid places with magnets or magnetic interference.
- b. Avoid humidity and dust prone places.
- c. Keep the tape in an upright position and avoid storing it in direct sunlight.
- d. Avoid dropping or knocking your tapes.

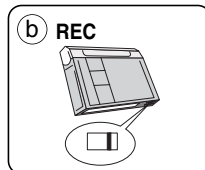
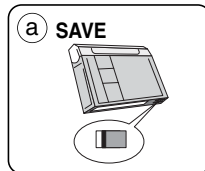

Basic Recording

Hints for Stable Image Recording

- ❖ While recording, it is very important to hold the Camcorder correctly.
- ❖ Fix the lens cover firmly by clipping it to the hand strap. (see page 18)

Recording with the LCD Screen

1. Hold the Camcorder firmly using the hand strap.
2. Place your right elbow against your side.
3. Place your left hand under or beside the LCD screen to support and adjust it.
Do not touch the built-in microphone.
4. Choose a comfortable, stable position for the shots that you are taking.
You can lean against a wall or on a table for greater stability.
Do not forget to breathe gently.
5. Use the LCD frame as a guide to determine the horizontal plane.
6. Whenever possible, use a tripod.

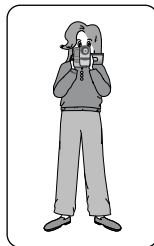

Recording with the Viewfinder

1. Hold the Camcorder firmly using the hand strap.
2. Place your right elbow against your side.
3. Place your left hand under the Camcorder to support it.
Be sure not to touch the built-in microphone.
4. Choose a comfortable, stable position for the shots that you are taking.
You can lean against a wall or on a table for greater stability.
5. To view an object through the Viewfinder, pull it out until you hear the click sound.
Excessive force may cause damage to the Viewfinder.
6. Place your eye firmly against the Viewfinder eyecup.
7. Use the Viewfinder frame as a guide to determine the horizontal plane.
8. Whenever possible, use a tripod.



Basic Recording

Various Recording Techniques

✦ In some situations different recording techniques may be required for more dramatic results.

1. General recording.

2. Downward recording.

Making a recording with a top view of the LCD screen.

3. Upward recording.

Making a recording viewing the LCD screen from below.

4. Self recording.

Making a recording viewing the LCD screen from the front.

5. Recording with the Viewfinder.

In circumstances where it is difficult to use the LCD screen, the Viewfinder can be used as a convenient alternative.

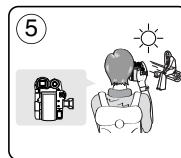
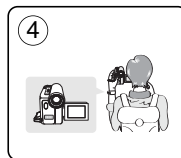
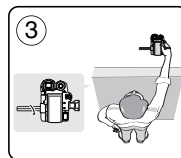
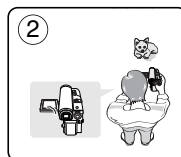
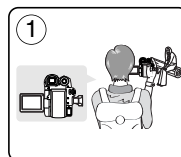

[Note]

Please rotate the LCD screen carefully as excessive rotation may cause damage to the inside of the hinge that connects the LCD screen to the Camcorder.

Basic Recording

Making your First Recording

1. Connect a power source to the Camcorder. (see page 20)
(A Battery pack or a AC Power adapter)
Insert a cassette. (see page 36)
2. Remove the Lens cover.
3. Set the **Power** switch to **CAMERA**.
 - Open the LCD screen.
 - Set the **Mode** switch to **TAPE**.
Make sure that **STBY** is displayed.
 - If the write protection tab of the cassette is open(set to save),
STOP and **Protection!** will be displayed.
Release the write protection tab to record.
 - Make sure the image you want to record appears on the LCD screen or Viewfinder.
 - Make sure the battery level indicates that there is enough remaining power for your expected recording time.
4. To start recording, press the **Start/Stop** button.
 - **REC ●** is displayed on the LCD screen.

To stop recording, press the **Start/Stop** button again.

 - **STBY** is displayed on the LCD screen.

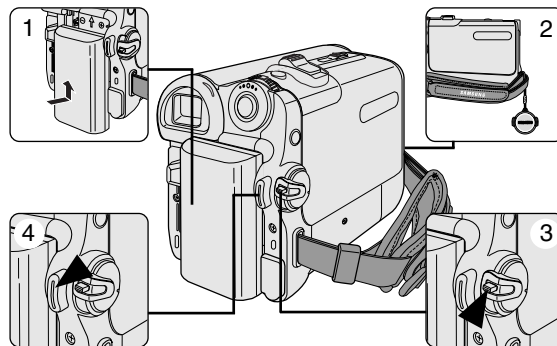

[Note]

Detach the Battery pack when you are finished recording to prevent unnecessary battery power consumption.

Basic Recording

Using EASY.Q Mode (for Beginners)

- ✦ The EASY.Q mode works only in Camera mode.
- ✦ The EASY.Q mode allows a beginner to easily make good recordings.

1. Set the **Power** switch to **CAMERA**.
2. Set the **Mode** switch to **TAPE**.
3. By pressing the **EASY.Q** button, all functions on the camera will be set to off and the recording settings will be set to the following basic modes:
 - Battery level, recording mode, counter, date/time, and DIS (📷) will be displayed.
 - The word **EASY.Q** will appear on the LCD screen at the same time.

However, the Date/Time will only be seen if it has been previously set. (see page 33)
4. Press the **Start/Stop** button to start recording.
Recording will begin using the basic automatic settings.
5. Press the **EASY.Q** button again in the **STBY** mode and then turn the EASY.Q mode off.
 - The EASY.Q function will not turn off while you are recording.
 - The camera will return to the settings that were set prior to activating EASY.Q mode.

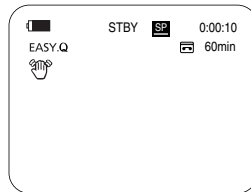
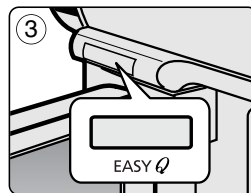
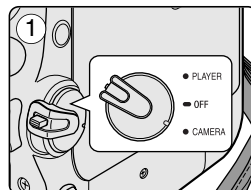

[Notes]

- In EASY.Q mode, certain functions are not available, such as Menu, BLC, Manual focus. If you want to use these functions, you must first turn the EASY.Q mode off.
- The EASY.Q mode settings are deleted when the Battery pack is removed from the Camcorder and must be reset when the Battery pack is replaced.
- EASY.Q mode will not turn off during a recording.
- Taking a photo image using the PHOTO button while EASY.Q is set releases DIS function.
- Digital Zoom, COLOR NITE or Digital Effect is not available in the EASY.Q mode.

Basic Recording

When a cassette is loaded and the Camcorder is left in the STBY mode for more than 5 minutes without being used, it will switch off automatically.

To use it again, press the Start/Stop button or set the Power switch to OFF and then back to CAMERA.

This auto power off feature is designed to save battery power.

Record Search (REC SEARCH)

- You can view a recording using the **REC SEARCH +, -** function in **STBY** mode.
REC SEARCH - enables you to play the recording backwards and
REC SEARCH + enables you to play it forwards, for as long as you keep each button pressed down.
- If you press the **REC SEARCH -** button in **STBY** mode, your Camcorder will play in reverse for 3 seconds and return to the original position automatically.

[Note]

Mosaic shaped distortion may appear on the screen while in Record Search mode.

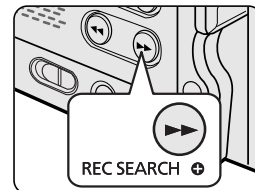
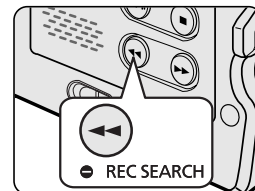

Basic Recording

Setting the Zero Memory (SC-D457 only)

- ❖ The ZERO MEMORY function works in both Camera and Player modes.
- ❖ You can mark a point on a tape that you want to return to following playback.

1. Set the **Power** switch to **CAMERA** or **PLAYER**.
2. Set the **Mode** switch to **TAPE**.
3. Press the **ZERO MEMORY** button on the remote control before the recording or during playback at the point where you wish to return.
 - The time code is changed to a tape counter that is set to ZERO MEMORY with the **0:00:00** (ZERO MEMORY indicator).
 - If you want to cancel the ZERO MEMORY function, press the **ZERO MEMORY** button again.
4. Finding the zero position.
 - When you have finished playback, fast forward or rewind the tape in stop mode. The tape stops automatically when it reaches the zero position.
 - When you have finished recording, set the **Power** switch to **PLAYER** and press the **◀◀** (REW) button. The tape stops automatically when it reaches the zero position.
5. The tape counter with the **0:00:00** (ZERO MEMORY indicator) disappears from the display and the tape counter is changed to the time code.

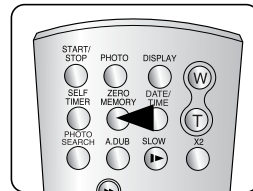
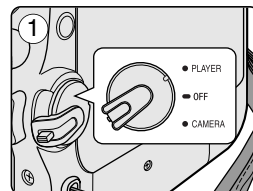

[Notes]

- In the following situations, ZERO MEMORY mode may be canceled automatically:
 - At the end of the section marked with the ZERO MEMORY function.
 - When the tape is ejected.
 - When you remove the Battery pack or power supply.
- The ZERO MEMORY may not function correctly where there is a break between recordings on the tape.

Basic Recording

Self Record using the Remote Control (SC-D457 only)

- ❖ The SELF TIMER function works only in Camera mode.
- ❖ When you use the Self Timer function on the remote control, the recording begins automatically in 10 seconds.

1. Set the **Power** switch to **CAMERA**.
2. Set the **Mode** switch to **TAPE**.
3. Press the **SELF TIMER** button until the appropriate indicator is displayed in the LCD screen.
4. Press the **Start/Stop** button to start the timer.
 - Self Timer starts counting down from 10 with a beep sound.
 - In the last one second of the countdown, the beep sound gets faster, then recording starts automatically.
 - If you want to cancel the Self Timer function before recording, press the **SELF TIMER** button.
5. Press the **Start/Stop** button again when you wish to stop recording.

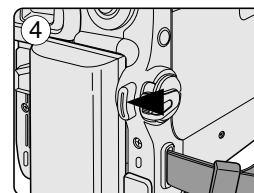
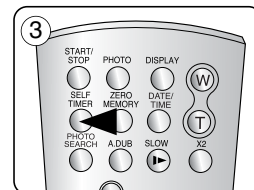
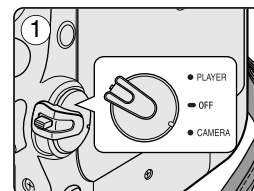

[Notes]

- Do not obstruct the remote control sensor by putting obstacles between the remote control and Camcorder.
- The remote control range is 4~5m (13~17 ft).
- The effective remote control angle is up to 30 degrees left /right from the center line.
- Using a tripod is recommended for delayed recording.

Basic Recording

Zooming In and Out

- ❖ The ZOOM function works in both Camera and M.Cam modes.
- ❖ Zooming is a recording technique that lets you change the size of the subject in a scene.
- ❖ You can zoom using variable zoom speeds.
- ❖ Use these features for different shots. Please note that over-use of the zoom feature can lead to unprofessional looking results and a reduction of battery usage time.

1. Move the Zoom lever slightly for a gradual zoom, move it further for a high-speed zoom.

- Your zooming is monitored on the OSD.

2. T(Telephoto) side: Subject appears closer.

3. W(Wide angle) side: Subject appears farther away.

- You can record a subject that is about 10mm (about 0.5 inch) away from the lens surface in the Wide position.

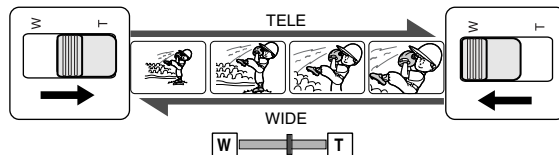

Basic Recording

Using the Tele Macro

- ❖ Tele Macro Function works in both Camera and M.Cam mode.
- ❖ Effective focal distance in Tele Macro mode is 50 Cm (19.7 inches) ~ 100 Cm (39.4 inches).

1. Set the **Power** switch to **CAMERA**.
2. Set the **Mode** switch to **TAPE** or **MEMORY**.
3. Press the **MENU** button.
 - The menu list will appear.
4. Move the **Menu selector** to the left or right to select **Camera**, then press the **Menu selector**.
5. Move the **Menu selector** to the left or right to select **Macro**, then press the **Menu selector**.
6. Move the **Menu selector** to the left or right to select **On** or **Off**, then press the **Menu selector**.
7. To exit, press the **MENU** button.
 - Tele Macro Icon(📷) will be displayed.

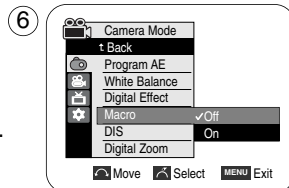
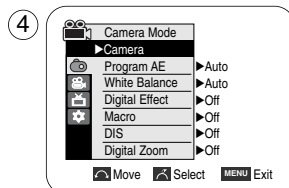

[Notes]

- When recording in Tele Macro mode, the focus speed may be slow.
- When you operate the Zoom function in the Tele Macro mode, the recording subject may be out of focus.
- Use a tripod to prevent hand shake in the Tele Macro mode.
- Avoid shadows when recording in the Tele Macro mode.
- As the distance to the subject decreases, focusing area narrows.
- When you can not get proper focus, use the Zoom lever.

Basic Recording

Using Quick Menu: Tele Macro

- ✦ Quick menu is used to access Camcorder functions by simply using the Menu selector.
- ✦ Quick menu provides easier access to the frequently used menus without using the MENU button.

1. Press the **Menu selector**.
2. Move the **Menu selector** to the left or right to select **Macro**, then press the **Menu selector**.
3. Move the **Menu selector** to the left or right to select **On** or **Off**, then press the **Menu selector**.
4. To exit, press the **MENU** button.

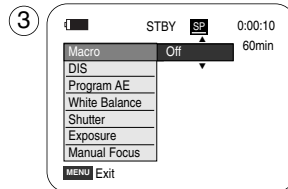
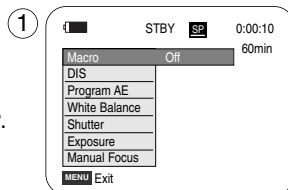

Basic Recording

Using the Fade In and Out

- ❖ The FADE function works only in Camera mode.
- ❖ You can give your recording a professional look by using special effects such as fade in at the beginning of a sequence or fade out at the end of a sequence.

To Start Recording

1. Set the **Power** switch to **CAMERA**.
2. Set the **Mode** switch to **TAPE**.
3. Before recording, hold down the **FADE** button.
 - The picture and sound gradually disappear (fade out).
4. Press the **Start/Stop** button and at the same time release the **FADE** button.
 - Recording starts and the picture and sound gradually appear (fade in).

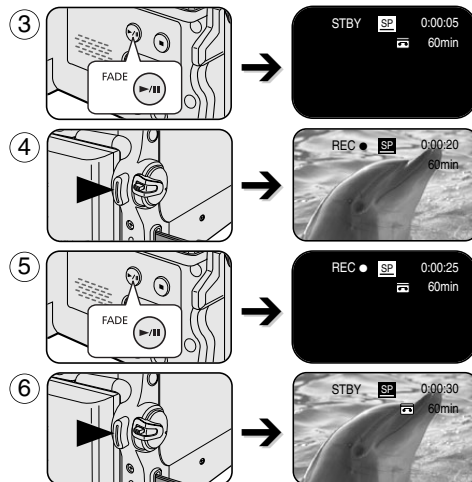

To Stop Recording (use Fade In/Fade Out)

5. When you wish to stop recording, hold down the **FADE** button.
 - The picture and sound gradually disappear (fade out).
6. When the picture has disappeared, press the **Start/Stop** button to stop recording.

- a. **Fade Out**
(Approx. 4 seconds)

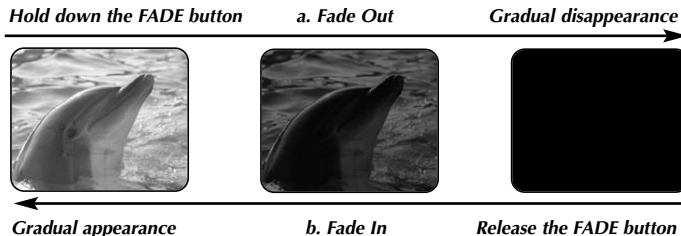

- b. **Fade In**
(Approx. 4 seconds)

Basic Recording

Using Back Light Compensation Mode (BLC)

- ❖ BLC works in both Camera and M.Cam modes.
- ❖ Back lighting exists when the subject is darker than the background:
 - The subject is in front of a window.
 - The person to be recorded is wearing white or shiny clothes and is placed against a bright background; the person's face is too dark to distinguish his/her features.
 - The subject is outdoors and the background is overcast.
 - The light sources are too bright.
 - The subject is against a snowy background.

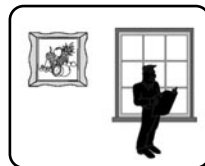

<BLC off>

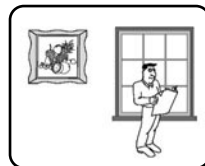

<BLC on>

1. Set the **Power** switch to **CAMERA**.
2. Set the **Mode** switch to **TAPE** or **MEMORY**.
3. Press the **BLC** button.
 - BLC icon () will be displayed.
4. To exit BLC mode, press the **BLC** button again.
 - Each press of the **BLC** button toggles: Normal → BLC → Normal.

[Note]

The BLC function will not operate in EASY.Q mode.

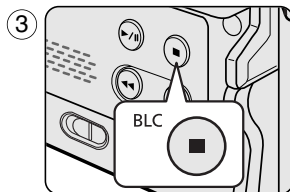

Basic Recording

Using the Color Nite/LED Light (SC-D455/D457 only)

- ✦ COLOR NITE function works only in Camera mode.
- ✦ Shutter speed can be controlled, allowing you to record slow moving objects.
- ✦ COLOR NITE function may produce a brighter image.
- ✦ The LED light can be used with COLOR NITE function only. (SC-D455/D457 only)
- ✦ The LED light enables you to record a subject in dark places without sacrificing color. (SC-D455/D457 only)

1. Set the **Power** switch to **CAMERA**.
2. Set the **Mode** switch to **TAPE**.
3. Press the **COLOR NITE** button.
4. Each time you press the **COLOR NITE** button, shutter speed is changed to;
 - ▶ **Color N. 1/30, Color N. 1/15** and off. (SC-D453 only)
 - ▶ **Color N. 1/30, Color N. 1/15, Color N. 1/15** (⏏) and off. (SC-D455/D457 only)

[Notes]

- The COLOR NITE will not turn ON or OFF while you are recording.
- When using COLOR NITE the image takes on a slow motion like effect.
- While using the COLOR NITE function, you cannot use the following functions: Program AE, DIS, Digital Zoom, Shutter Speed, Exposure, 16:9 wide (among of the Digital Effect function).
- When using the COLOR NITE function, the focus adjusts slowly and the white dots may appear on the screen, this is not a defect.
- COLOR NITE is not available while DIS, Photo image recording or EASY.Q is in use.
- The range of the LED light is limited (up to 6.6ft (2m)). (SC-D455/D457 only)
- Digital Zoom, Photo image recording, 16:9 Wide, Emboss2, Pastel2, Mirror or Mosaic is not available in the COLOR NITE mode.
- If DIS or EASY.Q is set, COLOR NITE mode will be released.

Danger (SC-D455/D457 only)

- The LED light can become extremely hot.
- Do not touch it while in operation or soon after turning it off, otherwise serious injury may result.
- Do not place the Camcorder into the carrying case immediately after using the LED light, since it remains extremely hot for some time.
- Do not use near flammable or explosive materials.

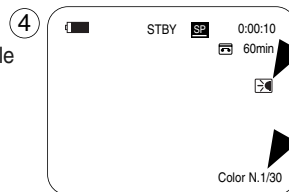
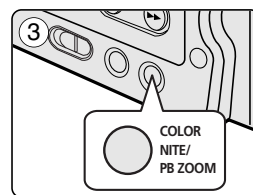
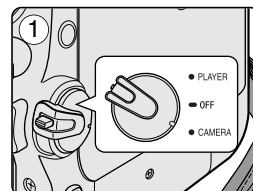

Playback

Playing back a Tape you have recorded on the LCD Screen

- ❖ The playback function works only in Player mode.
 - ❖ You can monitor the playback picture on the LCD screen.
1. Set the **Power** switch to **PLAYER**.
 2. Set the **Mode** switch to **TAPE**.
 3. Insert the tape you wish to view. (see page 36)
 4. Open the LCD screen.
 - Adjust the angle of the LCD screen and set the brightness or color if necessary.
 5. Press the ◀◀(REW) button to rewind the tape to the starting point.
 - To stop rewinding, press the ■ (STOP) button.
 - The Camcorder stops automatically after rewinding is complete.
 6. Press the ▶▶(PLAY/STILL) button to start playback.
 - You can view the picture you recorded on the LCD screen.
 - To stop the play operation, press the ■ (STOP) button.

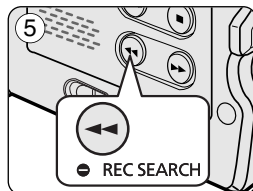
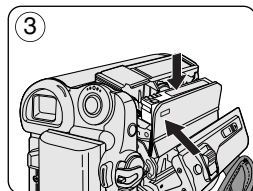
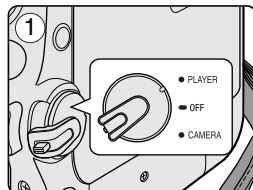

Adjusting the LCD Bright/Color during Playback

- ❖ You can adjust the LCD Bright/Color during playback.
- ❖ The adjustment method is the same procedure as used in Camera mode. (see page 32)

[Notes]

- You can also view the picture on a TV screen, after connecting the Camcorder to a TV or VCR. (see page 70~71)
- Various functions are available in Player mode. (see page 72)
- For searching and viewing still images recorded onto tape. (see page 67)

Playback

Tape Playback

- ❖ The playback function works only in Player mode.

Playback on the LCD Screen

- ❖ It is practical to view a tape using the LCD screen when in a car or outdoors.

Playback on a TV Monitor

- ❖ To play back a tape, the television must be NTSC compatible. (see page 113)
- ❖ We recommend that you use the AC Power adapter as the power source for the Camcorder.

Connecting to a TV which has Audio/Video Input Jacks

1. Connect the Camcorder to your TV with the Multi-AV cable.
 - The yellow jack: Video
 - The white jack: Audio(L)-mono
 - The red jack: Audio(R)If you connect to a monaural TV, connect the yellow jack (Video) to the video input of the TV and the white jack (Audio L) to the audio input of the TV.
2. Set the **Power** switch to **PLAYER**.
3. Set the **Mode** switch to **TAPE**.
4. Turn on the TV and set the TV/VIDEO selector on the TV to Video.
 - Refer to the TV user's manual.
5. Play the tape.

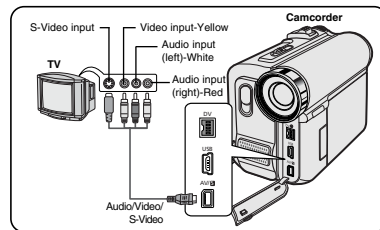

[Notes]

- You may use an S-Video cable to obtain better quality pictures if you have a S-Video connector on your TV.
- Even if you use an S-Video cable, you need to connect an audio cable.
- If you connect the cable to the Audio/Video jack, you will not hear sound from the Camcorder's speakers.
- If only a mono audio input is available on the TV set, use the Audio cable with the white jack (Audio L).

Playback

Frame Advance (To play back frame by frame) (SC-D457 only)

- Press the **F.ADV** button on the remote control while in still mode.
 - Video sequence advances frame by frame each time you press the **F.ADV** button.
 - The F.ADV function works in still mode only.
- To resume normal playback, press the **▶/||** (PLAY/STILL) button.
 - Forward frame advance
Press the **F.ADV** button on the remote control in still mode.
 - Reverse frame advance
Press the **◀|| (-)** button on the remote control to change the direction in F.ADV mode.
Press the **F.ADV** button on the remote control.

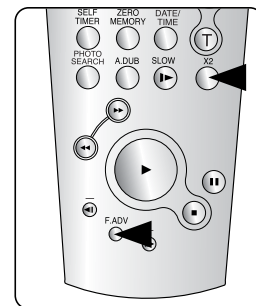

<SC-D457 only>

X2 Playback (Forward/Reverse) (SC-D457 only)

- Forward X2 playback
 - Press the **X2** button on the remote control during playback.
 - To resume normal playback, press the **▶/||** (PLAY/STILL) button.
- Reverse X2 playback
 - Press the **◀|| (-)** button during forward X2 playback.
 - To resume normal playback, press the **▶/||** (PLAY/STILL) button.

Reverse Playback (SC-D457 only)

- To playback in reverse at normal speed, press the **◀|| (-)** button during normal forward playback.
- Press the **▶/||** (PLAY/STILL) or **||> (+)** button to return to normal forward playback.

[Notes]

- Mosaic shaped distortion may appear on the screen while in some of the various playback modes.
Mosaic shaped distortion or noise may be experienced when you play back tapes recorded in LP which contain various playback functions.
- Sound will only be heard during normal SP or LP playback.

Playback

AV In/Out (SC-D457 only)

- ❖ AV In/Out function works only in Player mode.
- ❖ AV in/out setting enables you to record signal from external sources and display it on LCD screen.
Also, you can direct your video or image to external devices to record or play back.

1. Connect the Camcorder to your VCR or TV with the Multi-AV cable. (See pages 70~71)
2. Set the **Power** switch to **PLAYER**.
3. Set the **Mode** switch to **TAPE**.
4. Turn on the VCR or TV.
5. Insert the blank tape with protection tab closed into the Camcorder.
 - If you want to record from a connected VCR, insert a recorded VHS tape into the VCR.
6. Press the **MENU** button.
 - The menu list will appear.
7. Move the **Menu selector** to the left or right to select **Record**, then press the **Menu selector**.
8. Move the **Menu selector** to the left or right to select **AV In/Out**, then press the **Menu selector**.
9. Move the **Menu selector** to the left or right to select **AV In** or **S-Video In**, then press the **Menu selector**.
 - If you want to see the Camcorder picture with a TV, set AV In/Out menu to Out.
10. To exit, press the **MENU** button.
11. Press the **Start/Stop** button to set the Camcorder to REC PAUSE mode.
PAUSE appears on the LCD screen.
12. Select the TV program or playback the VHS tape.
13. Press the **Start/Stop** button to start recording.
 - If you want to pause recording for a while, press the **Start/Stop** button again.
14. To stop recording, press the **■** (STOP) button.

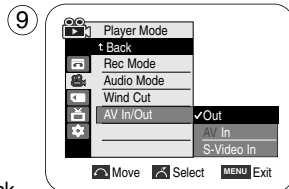
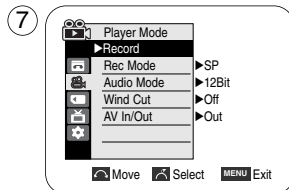
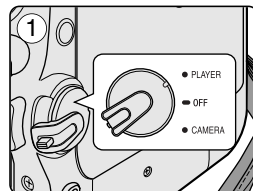

[Note]

- When you record the images being played back on an analog VCR, if they are not being played back at normal speed, (for example, more than double speed or slow playback), only a gray image appears on the Camcorder.

Troubleshooting

Self Diagnosis Display in M.Cam/M.Player Modes

Display	Blinking	Informs that...	Action
No Memory Card !	slow	There is no Memory card in the Camcorder.	Insert a Memory card.
Memory Full !	slow	There is not enough memory to record.	Change to a new Memory card. Erase recorded image.
No image !	slow	There are no images recorded on the Memory card.	Record new images.
Write protect !	slow	The Memory card is record protected.	Release the write protect tab on the Memory card.
Protect !	slow	When you try to delete to protected image.	Cancel the protection of image.
Read error !	slow	The Camcorder can not playback.	Format a Memory card or insert Memory card recorded on this Camcorder.
Write error !	slow	The Camcorder can not record.	Format a Memory card or change to a new Memory card.
Not Formatted !	slow	The Memory card needs to format.	Format a Memory card. (see page 100)
Now deleted...	slow	When progressing file delete.	Wait until delete has been finished.
Memory Card error !	slow	If inserted Memory Card is not recognized by the Camcorder.	Eject and re-insert the memory card. Try another Memory Card.

Troubleshooting

✦ If these instructions do not solve your problem, contact your nearest Samsung authorized service center.

Symptom	Explanation/Solution
You cannot switch the Camcorder on.	Check the Battery pack or the AC Power adapter.
Start/Stop button does not operate while recording.	Check the Power switch is set to CAMERA. You have reached the end of the cassette. Check the record protection tab on the cassette.
The Camcorder shuts off automatically.	You have left the Camcorder set to STBY for more than 5 minutes without using it. The Battery pack is fully exhausted.
Charge runs out quickly.	The atmospheric temperature is too low. The Battery pack has not been charged fully. The Battery pack is completely dead, and cannot be recharged. Use another Battery pack.
When you see a blue screen during playback.	The video heads may be dirty. Clean the head with a cleaning tape.
A vertical strip appears on the screen when recording a dark background.	The contrast between the subject and the background is too great for the Camcorder to operate normally. Make the background bright to reduce the contrast or use the BLC function while you are recording in bright Surroundings.
The image in the Viewfinder is blurred.	The Viewfinder lens has not been adjusted. Adjust the Viewfinder control lever until the indicators displayed on the Viewfinder come into sharp focus.
Auto focus does not work.	Check the Manual Focus menu. Auto focus does not work in the Manual Focus mode.
Play, FF or REW button does not work.	Check the Power switch. Set the Power switch to PLAYER. You have reached the beginning or end of the cassette.
When you see a mosaic pattern during playback search.	This is normal operation and it is not a failure or defect. The tape may be damaged. Replace the tape. Cleaning the video heads (see page 112).

Specifications

Model Name: SC-D453/D455/D457

System	
Video signal	NTSC
Video recording system	2 rotary heads, Helical scanning system
Audio recording system	Rotary heads, PCM system
Usable cassette	Digital video tape (6.35mm width): Mini DV cassette
Tape speed	SP: approx. 18.81mm/s LP: approx. 12.56mm/s
Tape recording time	SP: 60 minutes (when using DVM 60), LP: 90 minutes (when using DVM 60)
FF/REW time	Approx. 150 sec. (using DVM60 tape)
Image device	CCD (Charge Coupled Device) (680k pixels)
Lens	F1.6 10x(Optical), 900x(Digital) Electronic zoom lens
Filter diameter	Ø30
LCD screen/Viewfinder	
Size/dot number	2.5inchs 123k
LCD screen Method	TFT LCD
Viewfinder	Color LCD
Connectors	
Video output	1Vp-p (75Ω terminated)
S-Video output	Y: 1Vp-p, 75Ω, C: 0. 286Vp-p, 75Ω
Audio output	-7.5dBs (600Ω terminated)
DV input/output	4pin special in/out connector
USB output	Mini-B type connector
External mic	Ø3.5 stereo
General	
Power source	DC 8.4V, Lithium Ion Battery Pack 7.4V
Power source type	Lithium Ion Battery Pack, Power supply (100V~240V) 50/60Hz
Power consumption (Recording)	4.2W(LCD), 4.0W(Viewfinder)
Operating temperature	0°~40°C (32°F~104°F)
Storage temperature	-20°C ~ 60°C (-4°F ~ 140°F)
External dimension	Height 2.93 inches(74.5 mm), Length 4.02 inches(102 mm), Width 2.13 inches(54mm)
Weight	0.793lb (360g) (Except for Lithium Ion Battery Pack and tape)
Internal MIC	Omni-directional stereo microphone
Remote control (SC-D457 only)	Indoors: greater than 49ft(15m) (straight line), Outdoors: about 16.4ft(5m) (straight line)

- These technical specifications and design may be changed without notice.

Warranty (SEA users only)

SAMSUNG LIMITED WARRANTY

SAMSUNG Electronics America Inc. (SEA), warrants that this product is free from defective material and workmanship. SEA further warrants that if product fails to operate properly within the specified warranty period and the failure is due to improper workmanship or defective material, SEA will repair or replace the product at it's option.

All warranty repairs must be performed by a SEA authorized service center. The name and address of the location nearest you can be obtained by calling toll free: 1-800 SAMSUNG (1-800-726-7864).

Labor

90 days carry-in

Parts

1 year

On carry-in models, transportation to and from the service center is the customer's responsibility.

The original dated sales receipt must be retained by the customer and is the only acceptable proof of purchase. It must be presented to the authorized service center.

EXCLUSIONS (WHAT IS NOT COVERED)

This warranty does not cover damage due to accident, fire, flood and/or other acts of God; misuse, incorrect line voltage, improper installation, improper or unauthorized repairs, commercial use, or damage that occurs in shipping.

Exterior and interior finish, lamps, and glass are not covered under this warranty.

Customer adjustments which are explained in the instruction manual are not covered under the terms of this warranty.

This warranty will automatically be voided for any unit found with a missing or altered serial number. This warranty is valid only on products purchased in the United States and Puerto Rico.

Some States do not allow the exclusions or limitations of incidental or consequential damages, or allow limitations on how long an implied warranty lasts, so the above limitations or exclusions may not apply to you.

This warranty gives you specific legal rights, and you may also have other rights which vary from State to State.

ENGLISH

THIS CAMCORDER IS MANUFACTURED BY:



SERVICE DIVISION
400 Valley Road, Suite 201, Mt. Arlington N.J. 07856
Tel: 1-800-SAMSUNG
(1-800-726-7864)