

Pico Projector

User manual

Please read all Safety precautions before using your device to ensure safe and proper use.

Samsung is not responsible for injuries or damages that result from improper usage or failure to follow safety precautions.

Safety precautions

Do not touch the power cord with wet hands, or disconnect the charger by pulling on the cord

- It may cause electric shock.

Be careful When you use the battery

- Do not apply strong pressure to or pierce the battery.
- Avoid exposing your device and batteries to very cold or very hot temperatures.
- Do not allow your device to get wet: liquids can cause serious damage.
- Do not allow your child or pet to suck or bite the device.
- Do not let the battery contacts touch metal object.

Do not use if the product overheats

- Prolonged exposure of your skin to an overheated device may cause low temperature burn symptoms, such as red spots and pigmentation

Do not store your device near or in heaters, microwaves, hot cooking equipment, or high pressure containers

- Your device may overheat and cause a fire.

Do not expose your device to direct sunlight for extended periods of time

Do not drop your device or cause impacts to your device

Do not allow children to use it as they could hurt themselves and others, or damage the device

- This may damage the device or cause a fire.
- If children use the device, make sure that they use the device properly

Keep your device in a dry place away from moisture or water

- Dust can cause your device to malfunction.
- Humidity and all types of liquids may damage device parts or electronic circuits.

If you use the product for a long time, it may cause seizures and fainting symptoms. If you feel discomfort, stop using it immediately

For service, take your device to a Samsung Service Centre

- Any changes or modifications to your device can void your manufacturer's warranty.

RiskGroup 2



CAUTION. Possibly hazardous optical radiation emitted from this product. Do not stare at operating lamp. May be harmful to the eye.

Product tested against IEC62471

Graphics used in this manual are for illustration purposes. The actual products may vary.

Unpack



Projector

Battery

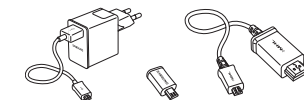

Travel adapter

*5 to 11 pin connector

5 pin MHL cable

* Data synchronization is unavailable when you connect 5 to 11 pin connectors to your PC via a data cable.

Copyright

Copyright © 2012 Samsung Electronics
This user manual is protected under international copyright laws.

No part of this user manual may be reproduced, distributed, translated, or transmitted in any form or by any means, electronic or mechanical, including photocopying, recording, or storing in any information storage and retrieval system, without the prior written permission of Samsung Electronics.

Trademarks

- SAMSUNG, and the SAMSUNG logo are registered trademarks of Samsung Electronics.
- Bluetooth® is a registered trademark of the Bluetooth SIG, Inc. worldwide. More information about Bluetooth is available at www.bluetooth.com.
- All other trademarks and copyrights are the property of their respective owners.

Charging time and standard operating time

Connection	Projector	Multimedia relay function
Operating time	About 2 hours	About 5 hours
Charging time	About 3 hours (when powered off)	



- Depending on the status of the charge and the environment, the actual time may vary.
- Charging automatically pauses if the projector is being used at the same time.
- When overheating, status LED blinks purple.

Checking the battery level

Press the two focus adjustment buttons simultaneously.

Depending on the battery level, the status LED will automatically blink in the following colours.

Battery level	Status LED color
Above 80%	Blue
80%~10%	Purple
Below 10%	Red



When using the projector with the travel adapter connected, the status LED turns purple.



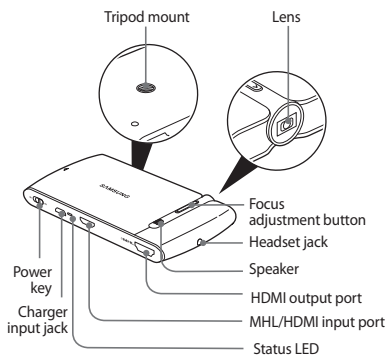

- The supplied items may vary.
- Tripod and HDMI cables are sold separately.

Overview



Buttons functions

	Slide the power key left or right to turn the projector on or off.
	Press the button to adjust the focus and definition of the screen.

Charging the device

Installing the battery

Install the battery before charging the projector.

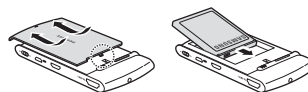

- 1 Press and slide the battery cover with both thumbs.
- 2 Insert the new battery as shown in the above drawing.
- 3 Close the battery cover.



As the battery is consumable, the battery life will drain gradually. When the battery life is significantly depleted, replace the new battery.

Charging the battery

This projector has a rechargeable battery. Make sure the projector is fully charged before using it for the first time.



Use only Samsung-approved chargers and cables.

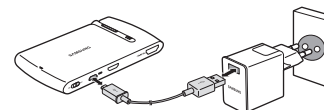

- 1 Connect the travel adapter to the charger input jack on the projector. During charging, the status LED will turn red. If charging does not begin, unplug the charger and plug it in again.
- 2 When fully charged, the status LED changes to blue. Unplug the charger from the wall outlet and the projector.

Using the projector

You can enjoy a variety of multimedia on your HDMI supported device (TV, monitor).



- The projector may not be compatible or may intermittently lose connection depending on some product/OS versions.
- Using the projector for extended periods will drain the battery quickly. Turn the projector off when not in use to avoid wasting power.
- When you use the projector, connect to a charger. Although the battery is not fully charged, the projector is supplied with the necessary power for stable use.
- Part of screen may be cut if its projection is too big or small compared to the stored image on the mobile device or laptop.
- The screen may be distorted if it is projected in at angle or used with some lenses.

13

Connecting the projector to a mobile device

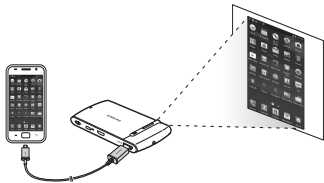

- Slide the power key ON and turn the projector on.
- Using a 5 to 11 pin cable, connect the projector to a mobile device.
- Adjust the distance between the projector and the screen to fit projected screen size.
- Press the focus adjustment button and adjust the focus and definition for screen.

14



- The projected screen displays the same orientation as the connected mobile device screen. If the mobile device is in landscape mode, the projector displays in full screen. This may differ depending on the mobile device.
- If a call comes in during the playback, the multimedia automatically pauses and switches to the call screen.
- If a message or dialogue box related to the battery appears during playback, it is projected on the screen.

15

- Adjust the media volume on your mobile device.
- If your mobile device is 11 pin, connect the 5-to-11 pin connector to the 5pin MHL cable provided and then reconnect the projector to the mobile device.



16

Connecting the projector to a laptop computer.

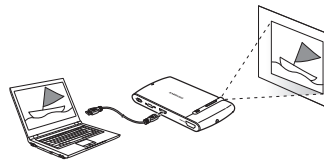

- Slide the power key ON and turn the projector on.
- Using the HDMI cable, connect the projector to a laptop computer. Select the clone or dual mode on the control or resolution panel of the laptop computer. (recommendation : Dual mode).

17

- Adjust the distance between the projector and the screen to fit projected screen size.
- Press the focus adjustment button and adjust the focus and definition of the screen.



- You can configure the sound path from your laptop computer.
- Using the multi adapter, do not connect to the projector and mobile device or laptop computer at the same time. It may confuse an incoming signal and cause a problem with your projector.

18

Distance and screen size

-Recommended projection distance

Set the projected screen size and adjust the distance.

Distance (cm)	Screen Size (cm)
38.1 cm	22.15 x 12.46 cm
57.2 cm	33.26 x 18.71 cm
76.0 cm	44.19 x 24.85 cm
114.3 cm	66.45 x 37.38 cm
152.2 cm	88.49 x 49.77 cm
190.4 cm	110.7 x 62.27 cm



- Use the projector in a dark place. Projected images may not be visible in bright surroundings.
- The farther the device is placed from the screen, the more likely images are to be blurred.

19

Connecting a HDMI device and a mobile device with the projector

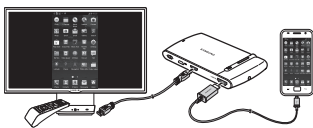

- Slide the power key ON and turn the projector on.
- Using a MHL cable, connect the mobile device to the MHL/HDMI input port on the projector.
- Using a HDMI cable, connect the HDMI supported devices (HDTV, monitor) to the MHL/HDMI output port on the projector.
- When you connect an HDMI supported devices to the projector, the device will automatically display the projector screen.



If you connect the projector to an HDTV, you can control the mobile device menu with the TV remote control keys.

20

Using a tripod stand

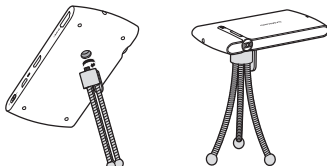

- Connect the screw on the tripod to the tripod mount on the back of the projector.
- Turn the screw to the right to attach the tripod to the projector.
- Adjust the position of the tripod.



- Adjust the position of the tripod.
- Make sure the tripod is firmly attached to the projector.

21

Specifications

Product name	Pico Projector
Supported interface	MHL or HDMI
Dimensions	60.4(W) x 116(L) x 12.2(H)
Weight	108g
Power supply	AC100 ~ 240V, 50/60Hz
Operating temperature	-10 ~ +50
Color temperature	6,500 ~ 7,700K
Screen resolution	640 X 360(nHD)
Brightness	Up to 20 Lumen (when connected to power supply)



Depending on the device type and usage, the actual time may vary.

22

FCC

This device complies with part 15 of the FCC Rules. Operation is subject to the following two conditions:

- This device may not cause harmful interference, and
- this device must accept any interference received, including interference that may cause undesired operation.

Users are not permitted to make changes or modify the device in any way.

Changes or modifications not expressly approved by Samsung will void the user's authority to operate the equipment.

Recycling Direct

To dispose electronics properly, follow the recycling process regulated in your area or go to Samsung website to find the nearest recycling location: www.samsung.com/recyclingdirect Or call, (877) 278 - 0799.

Samsung Telecommunications America, LLC

1301 E. Lookout Drive
Richardson, Texas 75082
Phone: 1-800-SAMSUNG
Phone: 1-888-987-HELP (4357)

