

# Wireless Charging System

Please read all Safety precautions before using your device to ensure safe and proper use.

Samsung is not responsible for injuries or damages that result from improper usage or failure to follow safety precautions.

## Safety Precautions

**Do not use damaged power cords or plugs, or loose electrical sockets**

**Do not touch the power cord with wet hands, or disconnect the charger by pulling on the cord**

**Do not use damaged power cables and bend or damage power cables**

**Do not use your device while charging or touch your device with wet hands**

**Do not use your device close to metal objects such as coins, keys, or accessories**

- Your device may overheat.
- If you must use your device, keep it at least 30 cm away from metal products.

**If the product overheats, remove the device from the product, disconnect the charger, and stop using the product for a while**

Prolonged exposure of your skin to an overheated device may cause low temperature burn symptoms, such as red spots and pigmentation.

**Do not store your device near or in heaters, microwaves, hot cooking equipment, or high pressure containers**

Your device may overheat and cause a fire.

**Do not drop your device or cause impacts to your device**

- Do not store your device on slopes.
- Your device may be damaged or parts may malfunction.

**Do not allow your child or pet to suck or bite the device**  
It may damage the device or cause a fire.

**Do not use the device for anything other than its intended use**

**Keep your device dry place away from moisture or water**

- Humidity and all types of liquids may damage device parts or electronic circuits.
- If your device is wet, dry the device with a towel and take it to a service centre.

**Do not disassemble, modify, or repair your device**

- It may cause electrical shocks.
- For service, take your device to a Samsung Service Centre.
- Any changes or modifications to your device can void your manufacturer's warranty.

**Do not use your device near other electronic devices**

- Most electronic devices use radio frequency signals. Your device may interfere with other electronic devices.
- Do not use your device in a hospital or near medical equipment that can be interfered with by radio frequency.
- If you personally use any medical equipment, contact the manufacturer of the equipment to ensure the safety of your equipment from radio frequency.

Graphics used in this manual are for illustration purposes. The actual products may vary.

## Unpack

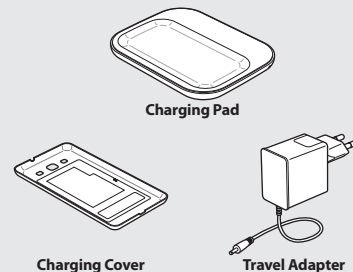

 Travel adapter appearance may vary depending on your region.

## Using the Wireless Charging System

- 1 Connect the travel adapter to a mains outlet and plug the charging jack into the Wireless charging pad. The buzzer will beep twice. If the buzzer doesn't beep, disconnect and connect the travel adapter again.

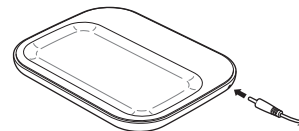

- 2 Replace your device's the battery cover with the Wireless charging cover, then place it on the Wireless charging pad to charge.

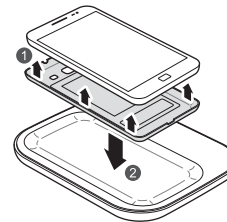

- 3 The buzzer will beep and charging status indicators are displayed on your device. When your device is fully charged, unplug the travel adapter from the wall outlet and the Wireless charging pad.



- The buzzer sounds when an abnormal situation occurs while charging. Disconnect the travel adapter from the Wireless charging pad and stop using it for a while.
- Only use the provided pad and cover with the dedicated mobile phone.
- Not compatible with WPC certified products.
- Charging efficiency might be reduced if there's an object between the mobile device and the Wireless charging pad.

**Do not place the wireless charging cover separately on the wireless charging pad.**

The wireless charging cover will have electrical currents when positioned on the wireless charging pad. If the wireless charging cover is in contact with the wireless charging pad, it may cause a fire.

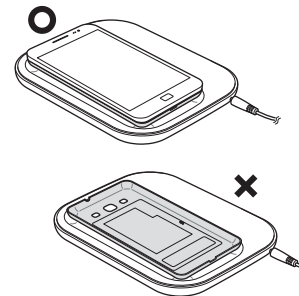

FCC

1. Statement related Part15.21

Cautions  
Changes or modifications made in the device, not expressly approved by Samsung, will void the user’s authority to operate the equipment.  
The use of any unauthorized accessories may be dangerous and void the device warranty if said accessories cause damage or a defect to the device. Although your device is quite sturdy, it is a complex piece of equipment and can be broken. Avoid dropping, hitting, bending or sitting on it.

2. Statement related Part15.105

FCC Notice and Cautions

This device complies with Part 15 of the FCC Rules. Operation is subject to the following two conditions:  
(1) this device may not cause harmful interference, and  
(2) this device must accept any interference received, including interference that may cause undesired operation.  
This equipment has been tested and found to comply with the limits for a Class B digital device, pursuant to part 15 of the FCC Rules. These limits are designed to provide reasonable protection against harmful interference in a residential installation.  
This equipment generates, uses and can radiate radio frequency energy and, if not installed and used in accordance with the instructions, may cause harmful interference to radio communications.

However, there is no guarantee that interference will not occur in a particular installation. If this equipment does cause harmful interference to radio or television reception, which can be determined by turning the equipment off and on, the user is encouraged to try to correct the interference by one or more of the following measures:

- Reorient or relocate the receiving antenna.
- Increase the separation between the equipment and receiver.
- Connect the equipment into an outlet on a circuit different from that to
- which the receiver is connected.
- Consult the dealer or an experienced radio/TV technician for help.

The device may cause TV or radio interference if used in close proximity to receiving equipment. The FCC can require you to stop using the device if such interference cannot be eliminated.

RFx information

The RF field strength of the wireless device or devices that may be embedded in your device are well below all international RF exposure limits as known at this time. Because the wireless devices (which may be embedded into your device) emit less energy than is allowed in radio frequency safety standards and recommendations, manufacturer believes these devices are safe for use. Regardless of the power levels, care should be taken to minimize human contact during normal operation. As a general guideline, a separation of 20 cm (8 inches) between the wireless device and the body, for use of a wireless device near the body (this does not include extremities) is typical.  
This device must be used more than 20 cm (8 inches) from the body when wireless devices are on and transmitting in order to comply with FCC RF exposure requirements.  
This transmitter must not be collocated or operate in conjunction with any other antenna or transmitter. The Part 15 radio device operates on a non-interference basis with other devices operating at this frequency. Any changes or modification to said product not expressly approved by Samsung could void the user’s authority to operate this device.

Recycling Direct

To dispose electronics properly, follow the recycling process regulated in your area or go to Samsung website to find the nearest recycling location:  
www.samsung.com/recyclingdirect  
Or call, (877) 278 – 0799.  
**Samsung Telecommunications America, LLC**  
1301 E. Lookout Drive  
Richardson, Texas 75082  
Phone: 1-800-SAMSUNG  
Phone: 1-888-987-HELP (4357)